



FIUS0901G111



JOHN DEERE

EN

USE AND CARE

ES

EMPLEO Y MANUTENCION

FR

UTILISATION ET ENTRETIEN

NOTE: Included rechargeable 12 volt battery located under hood.

NOTA: Batería recargable incluida de 12 voltios situada debajo de la capó.

NOTE: Batterie rechargeable incluse de 12 volts située sous le capot.



12V

John Deere

TURF TRACTOR with TRAILER

Model Number IGOR0040

SEE VERBAL INSTRUCTIONS
AFTER THE PICTURES

VER LAS INSTRUCCIONES
DESPUÉS DE LOS DISEÑOS

VOIR LES INSTRUCTIONS
APRÈS LES DESSINS

ASSEMBLY

MONTAJE

MONTAGE

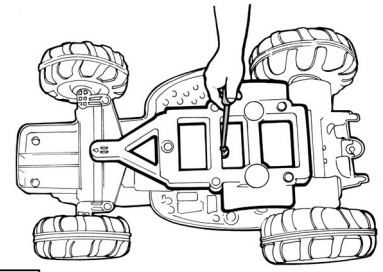

1

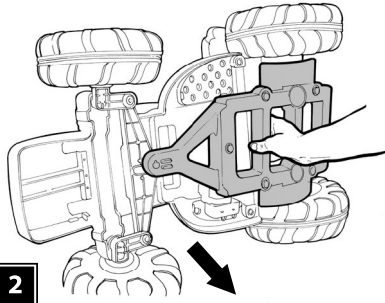

2

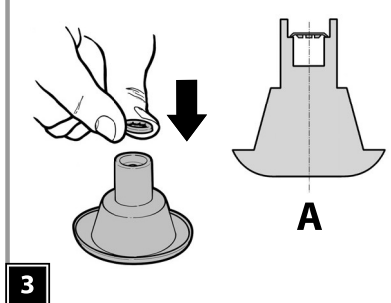

3

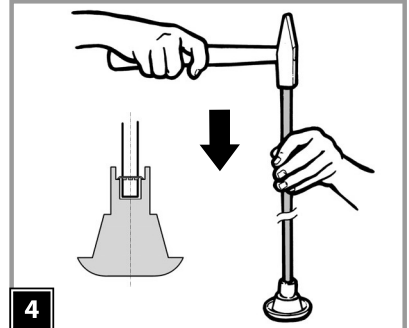

4

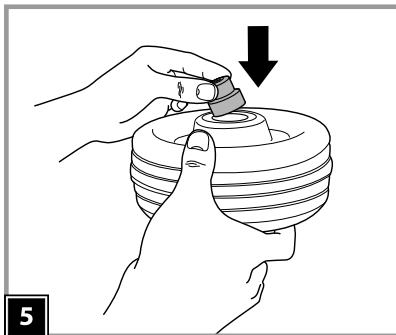

5

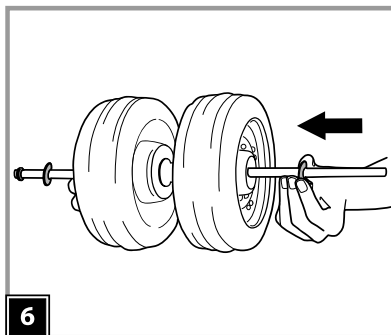

6

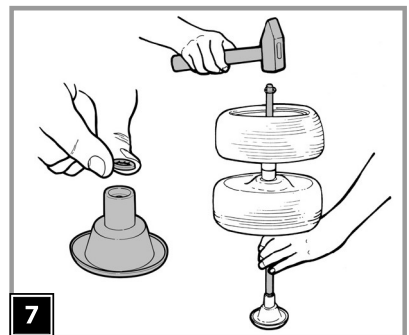

7

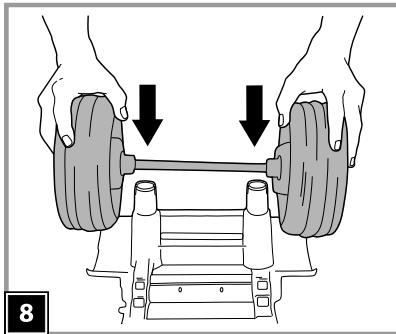

8

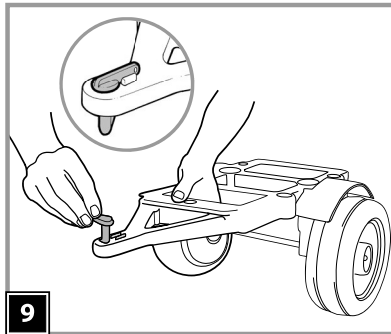

9

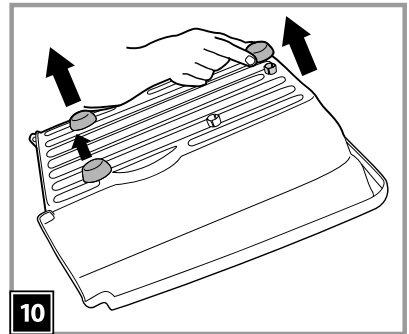

10

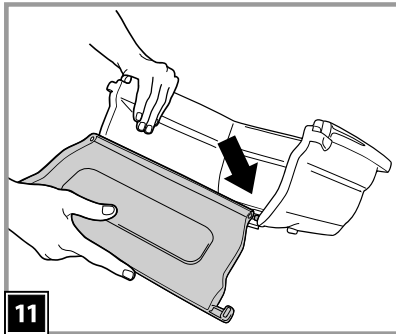

11

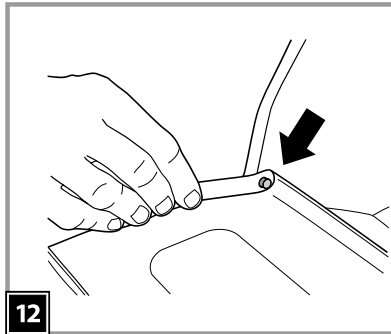

12

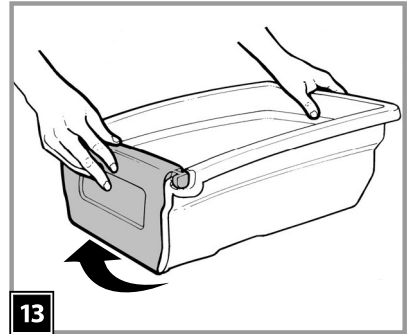

13

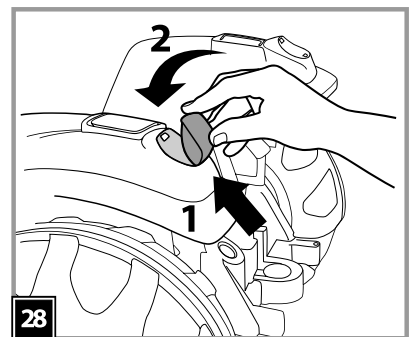
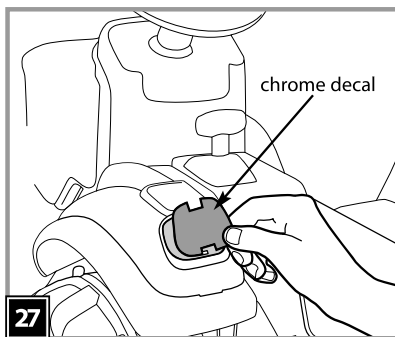
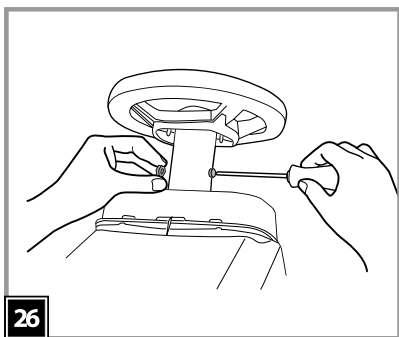
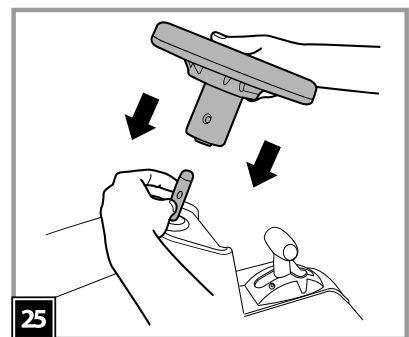
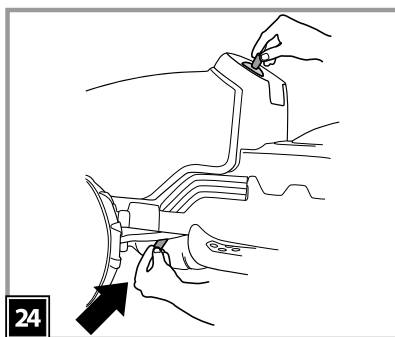
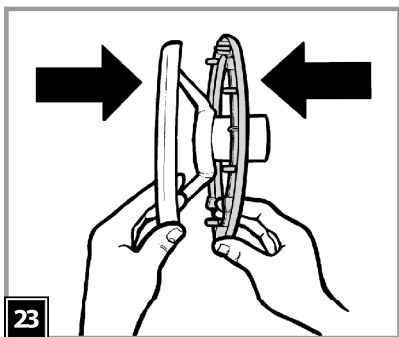
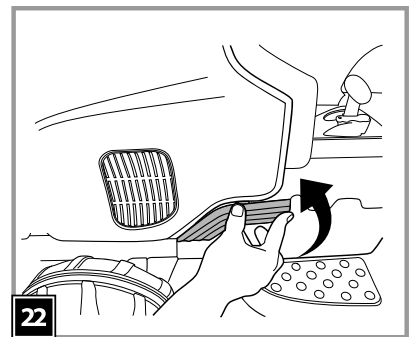
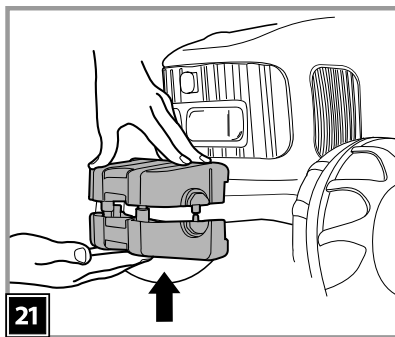
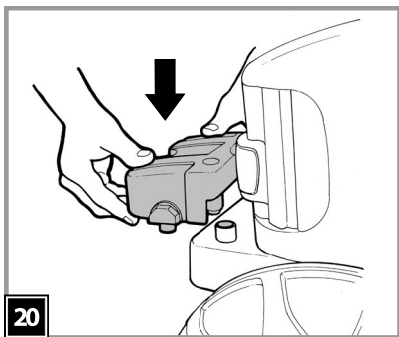
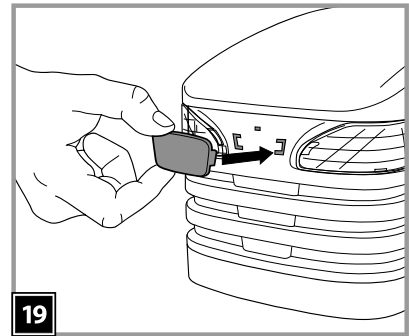
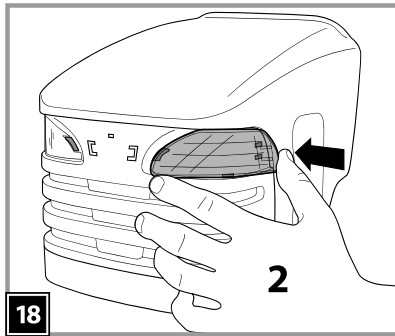
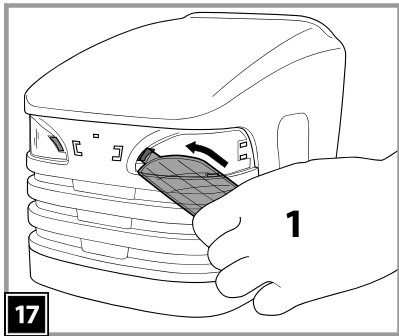
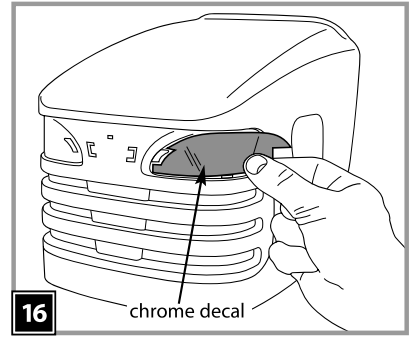
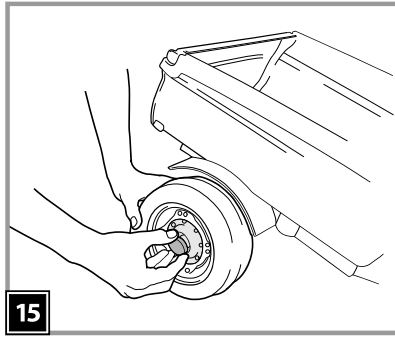
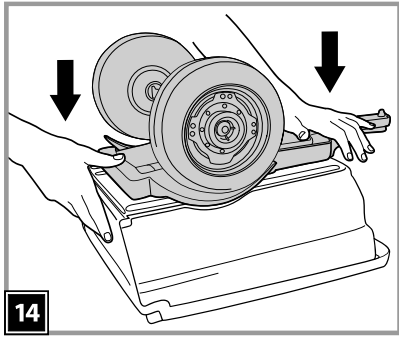

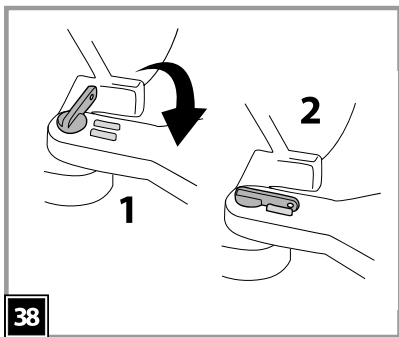
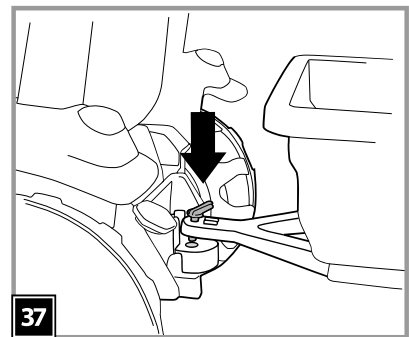
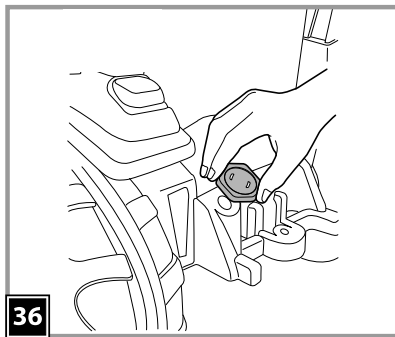
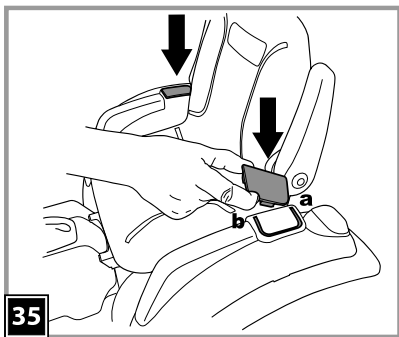
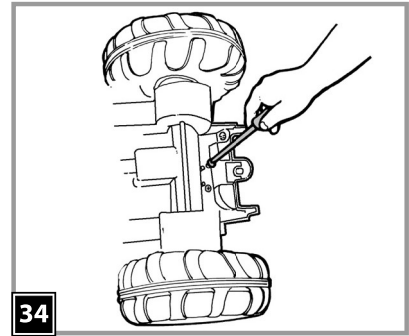
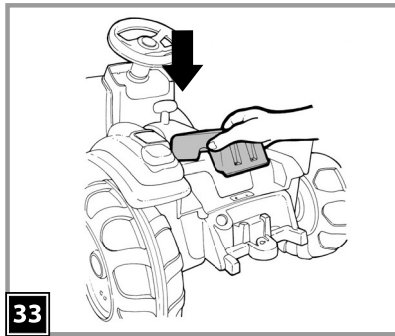
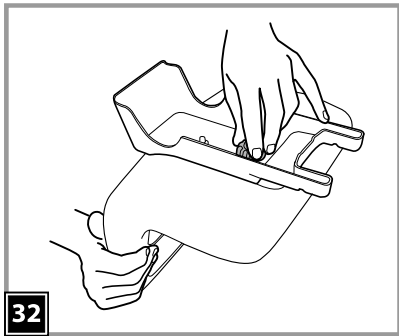
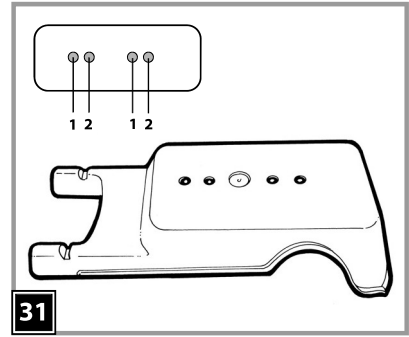
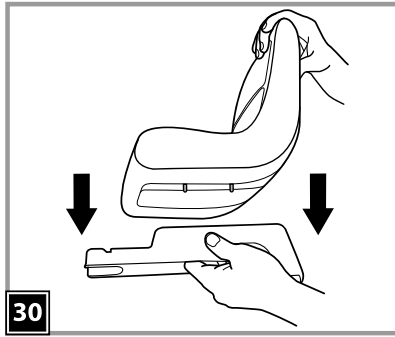
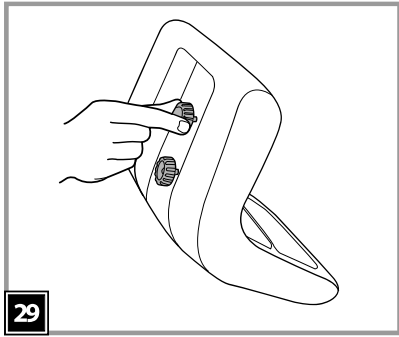

VEHICLE FEATURES AND INSTRUCTIONS FOR USE

CARACTERÍSTICAS Y USO DEL VEHÍCULO

CARACTÉRISTIQUES ET UTILISATION DU VÉHICULE

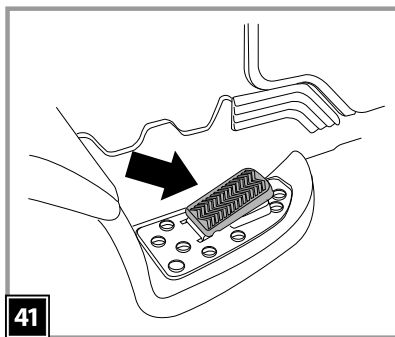
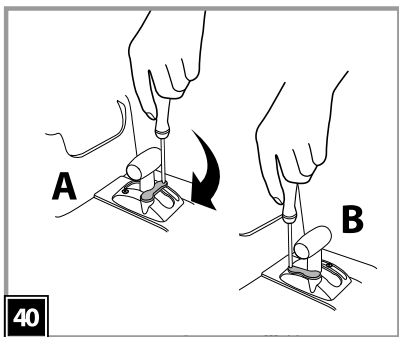
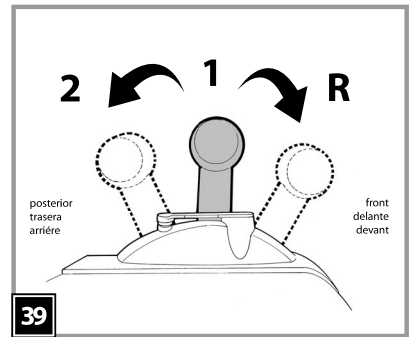

BATTERY CHARGING
CARGA DE LA BATERÍA
CHARGE DE LA BATTERIE

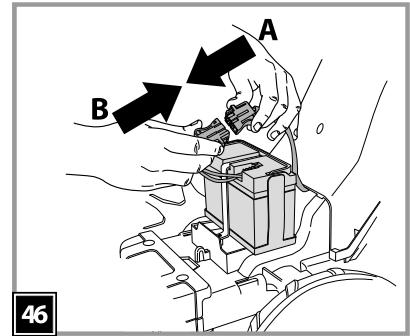
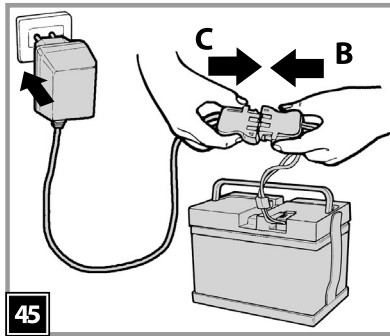
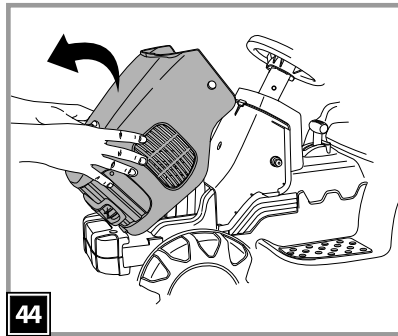
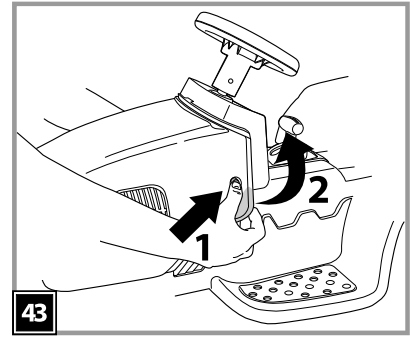
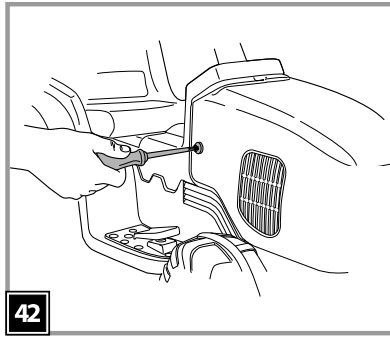

REMOVING THE BATTERY
CAMBIO DE LA BATERÍA
REPLACEMENT DE LA BATTERIE

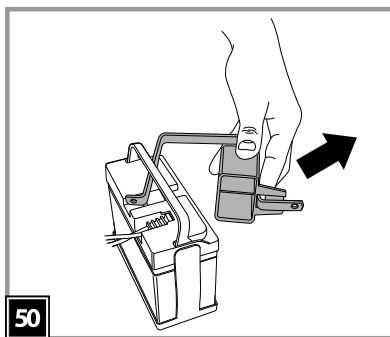
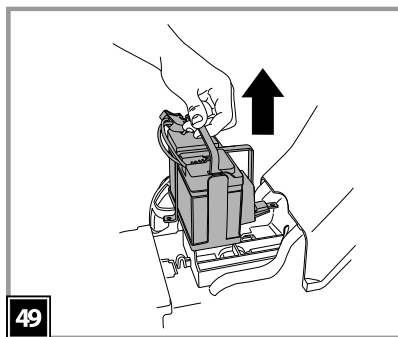
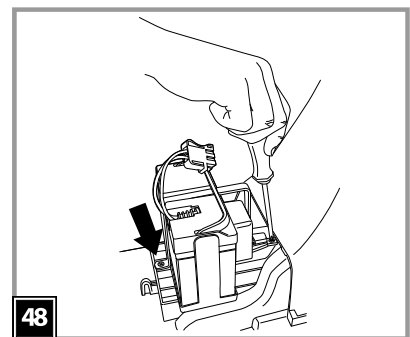
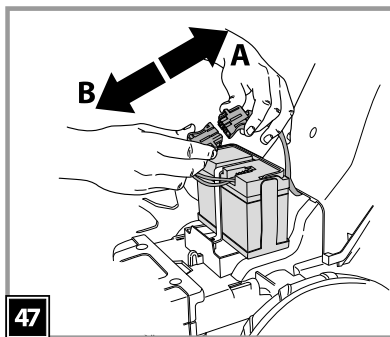

INSTALLING BATTERY
INSTALACIÓN DE LA BATERÍA
INSTALLATION DE LA BATTERIE

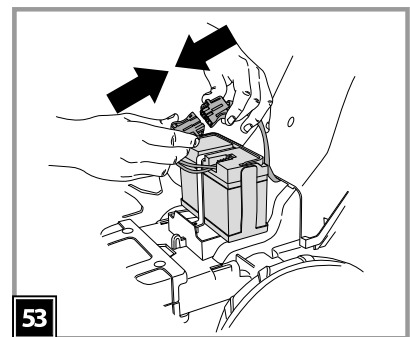
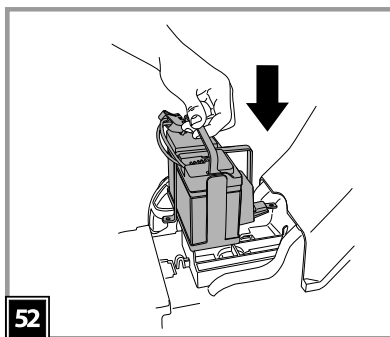
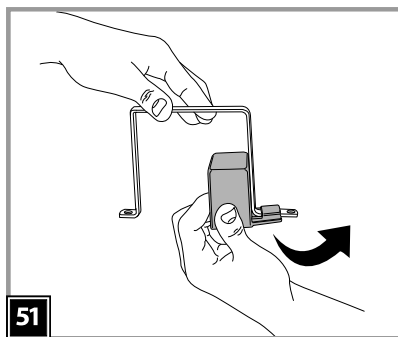

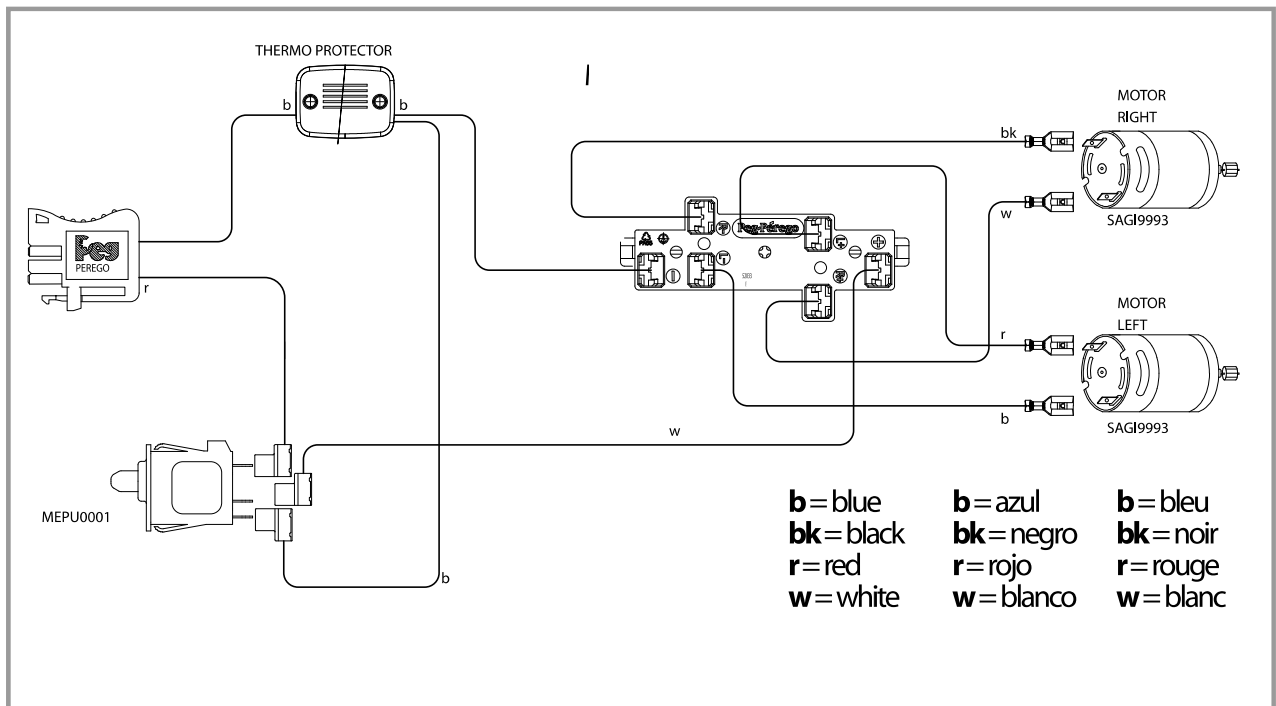
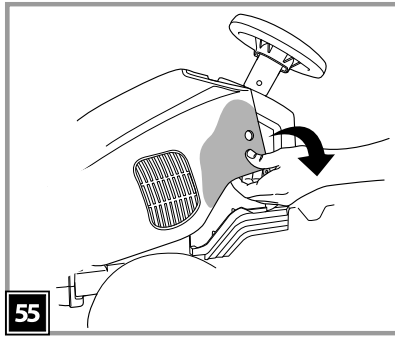
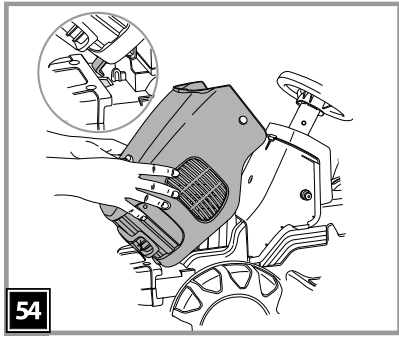

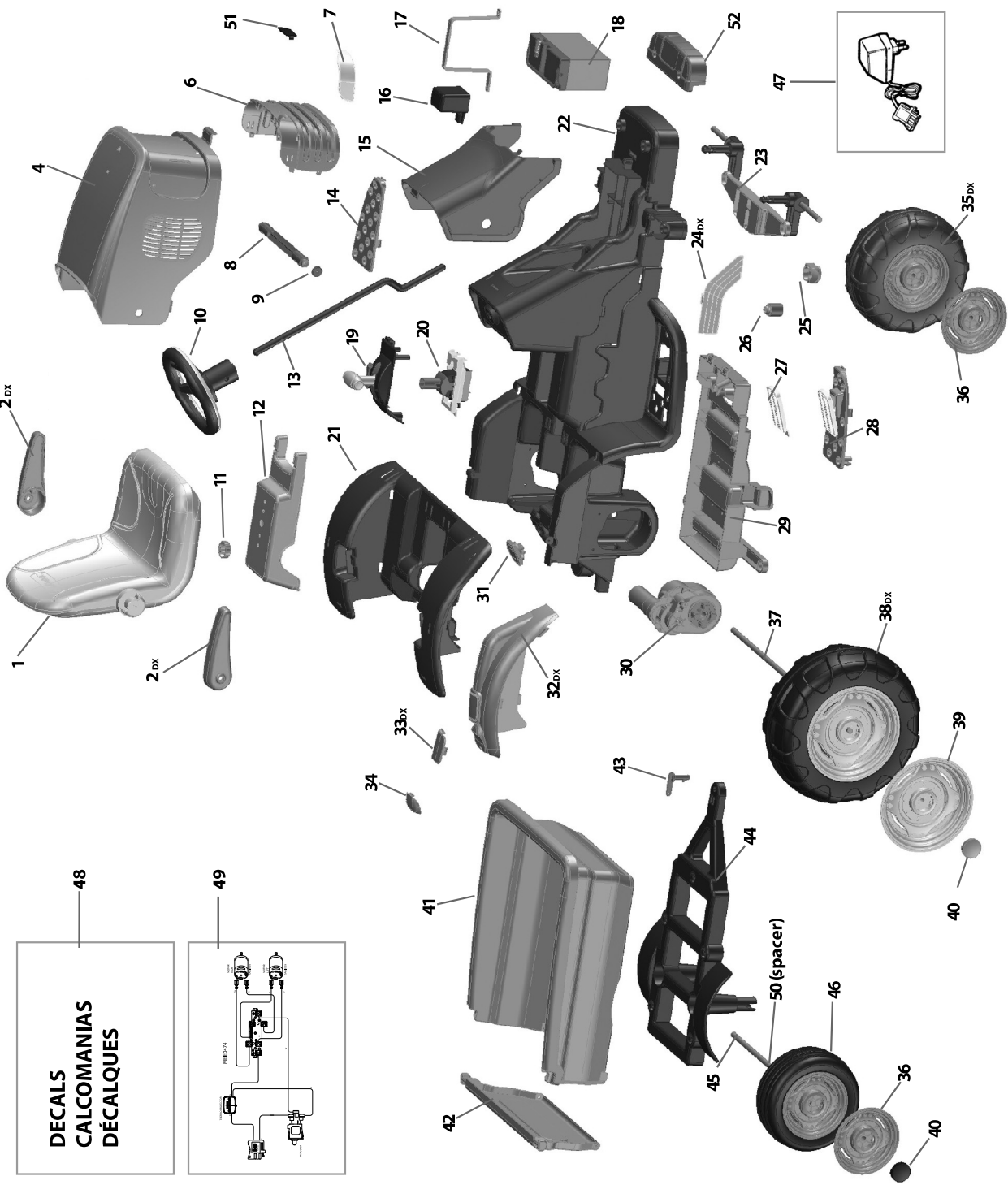

- 1 • SARP8826Y
- 2 2 dx • ASGI8827DN
- 2 2 sk • ASGI88275N
- 4 • SPST8287VB

- 6 • SPST8791N
- 7 7 dx • SPST8729D
- 7 7 sk • SPST8729S
- 8 • ASGI0156N
- 9 • SPST8506N
- 10 • ASGI0134NY
- 11 • SPST8207R
- 12 • SPST8296VB
- 13 • SOTF0128L30
- 14 • SPST8300GR
- 15 • SPST8502VB
- 16 • SPST8508N
- 17 • SOPF0047L30
- 18 • IAK80501 (12V-12Ah)
- 19 • ASGI0140NY
- 20 • MECE0020
- 21 • SPST8294N
- 22 • SPST8279KN
- 23 • SAGI8280N
- 24 24 dx • SPST8306DVB
- 24 24 sk • SPST8306SVB
- 25 • SPST8308N
- 26 • SPST8509N
- 27 • SPST3978N
- 28 • ASGI0139GRN
- 29 • SPST8317N
- 30 • SAGI9951KWN
- 31 • SPST8299R
- 32 32 dx • SPST8295DVB
- 32 32 sk • SPST8295SVB
- 33 33 dx • SPST8833DN
- 33 33 sk • SPST8833SN
- 34 • SPST8307A
- 35 35 dx • SARP8302DNY
- 35 35 sk • SARP8302SNY
- 36 • SPST8304Y
- 37 • SOFF0165Z
- 38 38 dx • SARP8303DNY
- 38 38 sk • SARP8303SNY
- 39 • SPST8395Y
- 40 • SPST8112N
- 41 • SPST8312VB
- 42 • SPST8314VB
- 43 • SPST0397R
- 44 • SPST8313N
- 45 • SOFF0164Z
- 46 • SARP8311NY
- 47 • MECE0034
- 48 • MMEV0381
- 49 • Call
- 50 • SPST8048
- 51 • SPST8793N
- 52 • SPST8507VB

ENGLISH

•PEG PEREGO® thanks you for choosing this product. For over 50 years, PEG PEREGO has been taking children for an outing: first with its famous baby carriages and strollers, later with its pedal and battery operated toy vehicles.

•Read this instruction manual carefully to learn the use of this vehicle and to teach your child safe and enjoyable driving. Please keep this manual for use as a reference in the future.

•Our toys conform with the safety requirements provided by the Council of the EEC, of the T.Ü.V.; of the I.I.S.G. Istituto Italiano Sicurezza Giocattoli, and the U.S. Consumer Toy Safety Specification F963.



Peg Perego S.p.A. is an ISO 9001 certified company.

The fact that we are certified provides a guarantee of our honesty for our customers, and fosters trust in the company's way of working.

•Peg Perego reserves the right to modify or change their product. Price, literature, manufacturing processes or locations or any combination of these above mentioned entities may change at any time for any reason without notice with impunity.

Years 2-7 Weight capacity 85 lbs

⚠ CAUTION:

ELECTRIC VEHICLE NOT RECOMMENDED FOR CHILDREN UNDER 2 YEARS OF AGE. AS WITH ALL ELECTRIC PRODUCTS, PRECAUTIONS SHOULD BE OBSERVED DURING HANDLING AND USE TO PREVENT ELECTRIC SHOCK. RECHARGER INCLUDED. 120 VOLTS, 60Hz, 30W INPUT, 12 VOLTS (DC) OUTPUT.

CUSTOMER SERVICE

PEG PEREGO offers after-sales services, directly or through a network of authorized service centers for repairs or replacement parts. See the back cover of this instruction manual for contact information.

ASSEMBLY INSTRUCTIONS

⚠ CAUTION:

ADULT ASSEMBLY REQUIRED. USE CARE WHEN UNPACKING AS COMPONENTS TO BE ASSEMBLED MAY POSE A SMALL PARTS/SHARP EDGE HAZARD. BATTERY ALREADY INSTALLED IN VEHICLE.

ASSEMBLY

- 1-2 • Unscrew and remove the bottom of the trailer from the bottom of the tractor.
- 3 • Insert one of the 4 self-locking washers (the tractor comes with 2 spare washers) into the special tool provided with the tractor. ATTENTION: the tabs on the self-locking washer must be turned towards the interior of the tool (see detail A).
- 4 • Remove the axle from the packing. Insert the axle by pounding the special tool all the way in using a hammer. Remove the tool.
- 5 • Insert white bushing into each trailer wheel as shown.
- 6 • Slip the following components onto the axle in this order: washer, wheel, second wheel, washer

(four washers come with the tractor; two of them are spares). ATTENTION: Check to make sure that the wheels have been inserted correctly on the axle. The hubcaps must be facing away from the toy.

- 7 • Place a self-locking washer in the special tool, and insert the prepared axle, pounding it all the way in.
- 8 • Attach the wheel unit to the base of the trailer by pressing on it.
- 9 • Insert the red pin into the end of the trailer.
- 10 • Remove the three protective caps from the bottom of the bed.
- 11 • Attach the tailgate by inserting the longest pin first.
- 12 • Finish inserting the tailgate by pressing on the short pin.
- 13 • Lift the tailgate to close the bed.
- 14 • Attach the bottom of the trailer (prepared beforehand) to the bed by pressing, as shown in the figure.
- 15 • Attach the 2 nut caps to the wheels on the trailer (Attention, in the packaging you will find 6 nut caps; the remaining 4 are to be attached to the wheels of the tractor).
- 16 • Apply the chrome decals to the headlights positions as shown.
- 17 • Position the headlight lens by attaching the outer side.
- 18 • Press as shown in the figure to snap the lens into place. Repeat the previous 2 steps for the other front headlight.
- 19 • Snap the small plastic detail piece into place on the front grill as shown in the figure.
- 20 • Position one of the two parts of the weight on the front of the tractor.
- 21 • Join the other part of the weight by pressing the two parts together.
- 22 • Press the side inserts into place on the body.
- 23 • Press the trim piece into place under the steering wheel.
- 24 • Push the steering column through the bottom of the tractor to the upper part of the body.
- 25 • Hold the column in place and slip the steering wheel onto it.
- 26 • Fasten the steering wheel with its screw and nut, being careful to insert the screw into the circular hole and to insert the nut into the hexagonal hole.
- 27 • Apply the chrome decals to the taillight positions as shown in the figure.
- 28 • Attach the taillight lenses by pressing from the bottom upwards.
- 29 • Unscrew the knobs on the bottom of the seat.
- 30 • Line the seat up with the two holes on the seat support.
- 31 • The seat can be adjusted to 2 positions to suit the height of the child (see figure).
- 32 • After adjusting the seat, tighten the 2 knobs that hold it in place.
- 33 • Position the seat support on the body of the tractor.
- 34 • Tighten the seat support from under the tractor with the 2 screws.
- 35 • Snap the two black plastic cover pieces into place on each rear fender as shown.
- 36 • Press the gas tank cap into place on the back of the tractor.
- 37 • Attach the trailer to the tractor as follows: insert the trailer coupling into the opening on the back of the tractor, and rotate it (see fig. 43).
- 38 • Position 1: the trailer can be removed. Position 2: the trailer is locked into place. WARNING: The trailer will hold a load weighing up to 10 kg/22 lbs.

VEHICLE FEATURES AND INSTRUCTIONS FOR USE

- 39 • GEAR SHIFT LEVER. The vehicle has 3 speeds. ATTENTION: when the vehicle is taken out of the box, it runs only in first gear and reverse gear. To use the second speed, follow the instructions in figure 41.
- 40 • Loosen the lock screw for the second speed (fig. A). Turn the lock screw to the next notch (fig. B), and tighten it. All of the gears are now ready for use.
- 41 • ACCELERATOR PEDAL/ELECTRIC BRAKE. When the foot is lifted from the accelerator pedal, the electric brake automatically stops the tractor.

CHARGE BATTERY BEFORE USING BATTERY CHARGING

⚠ WARNING:

WARNING: BATTERY CHARGING AND ANY OTHER OPERATION ON THE ELECTRICAL SYSTEM MUST BE CARRIED OUT BY ADULTS ONLY.

THE BATTERY CAN ALSO BE CHARGED WITHOUT REMOVING IT FROM THE VEHICLE.

- 42 • Loosen the two safety screws from the sides of the hood, and remove the two plastic disks (save the disks for putting the hood back on).
- 43 • Press the two buttons and at the same time widen the hood to detach it, as shown in the figure.
- 44 • Lift the hood off.
- 45 • Insert the battery charger plug into an electrical outlet. Connect point B to point C on the battery charger. When the battery has been completely recharged, disconnect the battery charger from the electrical outlet, and disconnect point C from point B.
- 46 • Insert point B into point A, pressing until it clicks into place. Replace the battery brace. Always remember to close and fasten the hood on the battery compartment when you have finished working on the battery.

REMOVING THE BATTERY

- 47 • Open the hood, as described above. Disconnect the battery from the electrical system by squeezing the sides of the plugs.
- 48 • Loosen the 2 screws on the battery brace, as shown in the figure.
- 49 • Remove the battery.
- 50 • Remove the battery clamp from the dead battery.

INSTALLING BATTERY

CHARGE BATTERY BEFORE USING.

- 51 • If you have bought or own a Peg Perego 12V/12Ah battery, you will have to remove the plastic filler (A) by slipping it off the battery clamp.
- 52 • Reposition the new battery with the battery clamp in its housing. Fasten the clamp with the two screws.
- 53 • Connect the battery plug to the electrical system.
- 54 • Reposition the hood by inserting the front hook into the opening on the bottom of the tractor (see detail).
- 55 • Slightly widen the cab, and lower it to its original position. Replace the two plastic disks and fasten everything down with the screws.

BATTERY MAINTENANCE AND SAFETY

Before riding, charge your battery for 18 hours to initiate them. Failure to do this will result in permanent battery damage.

⚠ CAUTION:

Only adults should recharge batteries, never children. Never allow children to handle batteries. Only use the batteries specified by the manufacturer. Only use the charger specified by the manufacturer. Do not mix old and new batteries. Do not mix alkaline, standard (carbon-zinc), or rechargeable (nickel-cadmium) batteries.

CHARGING THE BATTERY

- Charge the batteries no longer than 24 hours, following the instructions enclosed with the battery charger.
- Charge the battery, as the vehicle shows low power, in this way you will avoid damage to the battery.
- If you don't use your vehicle for a long period of time unplug the

battery from the main wire harness of the vehicle. Remember to charge the battery at least every three months.

- Never charge the battery upside down.
- Do not forget batteries during charging! Check them periodically.
- Never use a replacement recharger or batteries unless they are approved by PEG PEREGO.
- Batteries are sealed and maintenance free.
- Battery polarity must be observed when connecting battery to wiring.

⚠ WARNING:

- BATTERIES CONTAIN TOXIC AND CORROSIVE SUBSTANCES. DO NOT TAMPER WITH THEM.
- Batteries contain an acid-based electrolyte.
- Do not make direct contact between battery terminals, as this can cause an explosion or fire.
- Charging produces explosive gases. Charge batteries in a well ventilated area away from sources of heat and flammable materials.
- Exhausted batteries are to be removed from the vehicle.
- Do not place the batteries near clothing to avoid damage.

IF A LEAK DEVELOPS

Shield your eyes. Avoid direct contact with the electrolyte, protect your hands.

Place battery in a plastic bag and follow directions listed below.

IF ELECTROLYTE COMES IN CONTACT WITH SKIN OR CLOTHING

Flush with cool water for at least 15 minutes.

See a physician at once.

IF ELECTROLYTE IS INGESTED

Give tap water, milk of magnesia or egg whites at once.

Do not induce vomiting.

See a physician at once.

DISPOSAL OF BATTERIES

Help protect the environment!

Do not throw used batteries in your regular, household trash.

Dispose of the old batteries in an approved dumping station; contact your local environmental protection agency office for further information.



VEHICLE MAINTENANCE AND SAFETY

This product conforms to EN 71 and conforms to EN 50088 safety standard for electric toys.

This vehicle is not intended for use on streets, around traffic or parked cars.

This product meets and/or exceeds all ASTM TOY SAFETY STANDARDS, including F 963, Consumer Toy Safety Specifications.

MAINTENANCE AND CARE

- Regularly check the conditions of the vehicle, particularly the electrical system, the plug connections, the covering caps and the charger. In case of fault, do not try to use the vehicle and the charger. For repair use only original PEG PEREGO's spare parts.
- PEG PEREGO assumes no liability if the electrical system is tampered with.
- Do not leave vehicle or batteries near sources of heat such as radiators, stoves, fireplaces, etc.
- Protect vehicle from water, rain, snow, etc.
- It can operate on grass, dirt or hard surfaces.
- When operating in overload conditions, such as soft deep sand, mud or rough uneven terrain, the overload circuit breaker will automatically disconnect the power. After 10 or more seconds, the circuit breaker will automatically reset, however you must eliminate overload conditions to resume normal driving.
- Periodically lubricate (with a light weight oil) moving parts, such as wheel bearings, steering linkages, where they rotate or touch one another.
- The vehicle's surface can be cleaned with a dampcloth. Do not use abrasive cleaners. The cleaning must be carried out by adults only.
- Never disassemble the vehicle mechanisms or motor unless authorized by PEG PEREGO.

Conforms a EN 50088

Rechargeable battery 12V 8Ah sealed lead-acid battery.

Two 140W motors

SAFETY

⚠ WARNING:

- To reduce the risk of injury, adult supervision is required. Never use in roadways, near motor vehicles, on or near steep inclines or steps, swimming pools or other bodies of water; always wear shoes, and never allow more than one rider.

- Surfaces that are appropriate for safe use: grass, gravel, hard surfaces, inclines up to 10%.
- Not suitable for children under the age of 36 months. The small pieces could be swallowed or inhaled.
- The trailer is not designed to support a child's weight. Do not place loads over 10 Kg/22 lbs. on the trailer.
- Never use the vehicle on steep slopes or near steps or stairs. This vehicle is not suitable for use on public highways.
- Do not allow children to place their hands, feet or any part of their body, clothing or other articles near the moving parts while vehicle is in operation.
- Do not allow the electrical components, motors, wiring, switches of your motorized vehicle to become wet and never wash it with a hose.
- Never use gasoline or other flammable substances near the vehicle.
- The vehicle is designed just for one child: never allow more than one rider.

RULES FOR SAFE DRIVING

DON'T STOP THE FUN: always have freshly charged, back-up batteries on hand.

For your child's safety: please read and follow all instructions below before operating.

2nd SPEED

Initially we suggest using only the 1st speed and the reverse gear. Before moving into 2nd speed be sure that the child has become familiar with operating the vehicle.

- 1ST SPEED slow speed (beginner drivers):
With both hands on the steeringwheel, press down on the accelerator pedal; the vehicle goes forward at 2.25 mph.
- 2ND SPEED fast speed (experienced drivers):
With both hands on the steeringwheel, press down on the accelerator pedal; the vehicle goes forward at 4.5 mph.
- REVERSE:
Place the left hand on the steeringwheel. With the right hand holding the gearshift in reverse, press your foot down on the accelerator; the vehicle reverses at 2.25mph. (Reverse is spring-loaded for safety).
- BRAKE:
The electric braking system stops

the vehicle automatically when your child lifts his foot off the pedal.

Teach your child the proper use of this vehicle for a safe and fun play time.

- Before starting be sure that the way is free from people and objects.
- Drive with both hands on the steeringwheel and keep your eyes on the road at all times.
- Stop in time to avoid accidents.
- Use the 2nd speed only after your child has the maturity and the reflexes to operate the vehicle safely.

⚠ CAUTION:

- **In first gear, the vehicle has a differential effect like real cars; on smooth terrain and with one child, the two wheels may turn at different speeds, resulting in possible sliding/deceleration.**
- **When operating in overload conditions, such as soft deep sand, mud or rough uneven terrain, the overload circuit breaker will automatically disconnect the power. After 10 or more seconds, the circuit breaker will automatically reset, however you must eliminate overload conditions to resume normal driving.**

PROBLEMS?

IF THE VEHICLE DOES NOT OPERATE?

- Check that all the plugs are properly connected.
- Check to make sure that no wires are disconnected from the reduction gears.
- Check the accelerator switch, if vehicle runs replace switch.
- Check that the battery is connected to the electrical system.

IF THERE IS NO POWER?

- Fully recharge the batteries. If the problem persists, check with an Authorized PEG PEREGO Service Center.

ESPAÑOL

•PEG PEREGO® le agradece que haya elegido este producto.
Hace más de 50 años que PEG PEREGO lleva a pasear a los niños: al nacer, con sus famosos cochecuna y coches de paseo, después con los fantásticos vehículos de juguete a pedal y con batería.

•Lea atentamente este manual de instrucciones para familiarizarse con el uso del modelo y enseñar a su niño un modo de conducir correcto, seguro y divertido. Conserve después el manual para cualquier consulta futura.

•Nuestros juguetes respetan los requisitos de seguridad previstos por el Consejo de la EEC, por el "U.S. Consumer Toy Safety Specification" y están aprobados por el T.U.V. y por el I.I.S.G. Istituto Italiano Sicurezza Giocattoli.



Peg Perego S.p.A. cuenta con la certificación ISO 9001.

Dicha certificación ofrece tanto a los clientes como a los consumidores la garantía de una transparencia y confianza por lo que concierne al modo de trabajar de la empresa.

•Peg Perego podrá modificar los modelos descritos en este prospecto, por razones técnicas o comerciales.

Años 2-7

Peso trasportable

85 lbs/38,6 kg

⚠ PRECAUTION:

LOS VEHICULOS ELECTRICOS NO SON RECOMENDABLE PARA NIÑOS MENORES DE 2 AÑOS. COMO TODOS LOS PRODUCTOS ELECTRICOS, CUANDO SE ESTA MANEJANDO OBSERVE LAS MEDIDAS DE PRECAUCION PARA PREVENIR UN CHOQUE ELECTRICO. EL CARGADOR ESTA INCLUIDO. 120 VOLTS, 60Hz, 30W DE ENTRADA, 12 VOLTS (DC) DE SALIDA.

SERVICIO DE ASISTENCIA

PEG PEREGO ofrece un servicio de asistencia post-venta, directamente o a través de una red de centros de asistencia técnica autorizados, para eventuales reparaciones o sustituciones y venta de recambios originales. Para contactar con los centros de asistencia véase la parte de atrás de la cubierta de este manual de instrucciones.

INSTRUCCIONES DE MONTAJE

⚠ PRECAUTION:

REQUIERE MONTAJE DE UN ADULTO. ALGUNOS COMPONENTES AL SER ENSAMBLADOS PODRÍAN TENER PARTES PEQUEÑAS/RIESGO POR BORDES CONTANTES.

MONTAJE

- 1-2 • Destornillar y quitar del tractor el fondo del remolque.
- 3 • Meter una de las 4 arandelas autobloqueantes (2 son de repuesto) en la herramienta que se entrega. ATENCIÓN: las lengüetas de la arandela autobloqueante tienen que estar hacia el interior de la herramienta (véase el detalle A).
- 4 • Quitar el eje del embalaje. Meter el eje golpeando con un martillo en la herramienta hasta el fondo; quitar luego la herramienta.
- 5 • Introduzca el casquillo blanco en cada una de

This document was created with Win2PDF available at <http://www.win2pdf.com>.
The unregistered version of Win2PDF is for evaluation or non-commercial use only.
This page will not be added after purchasing Win2PDF.