

Peg-Pérego

FIUS1001G148



Model Number IGOR0044

POLARIS Model Number IGOR0045

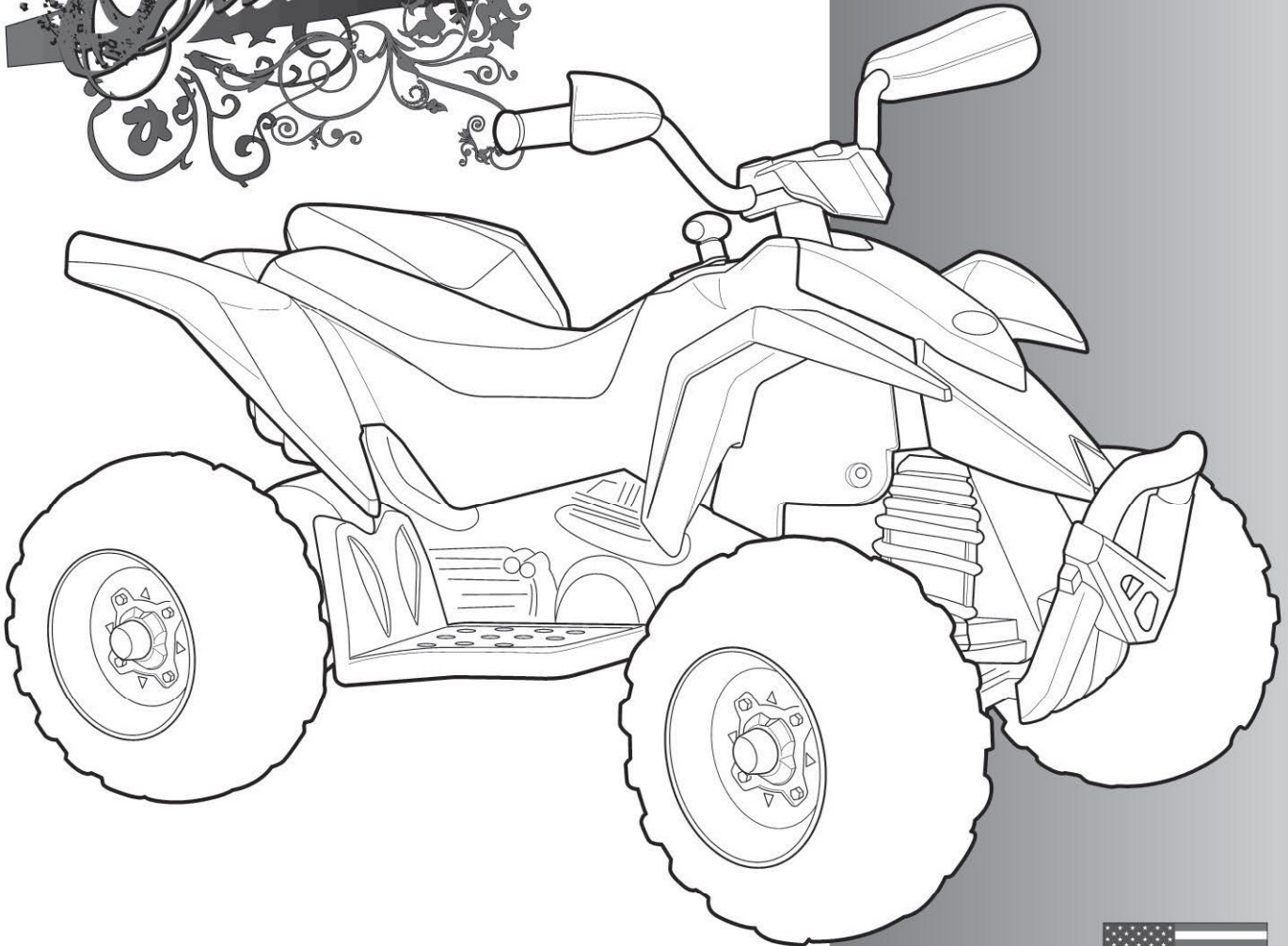

12VOLT



POLARIS
LICENSED MERCHANDISE

USE AND CARE **EN**

EMPLEO Y MANUTENCION **ES**

UTILISATION ET ENTRETIEN **FR**

See separate insert sheet for more information

Vea la hoja separada del separador de millares para más información

Voir la feuille séparée d'insertion pour plus d'information



2 YEARS*

*CONSUMER PARTICIPATION REQUIRED



MADE in USA

SEE VERBAL INSTRUCTIONS
AFTER THE PICTURES

VER LAS INSTRUCCIONES
DESPUÉS DE LOS DISEÑOS

VOIR LES INSTRUCTIONS APRÈS
LES DESSINS

INITIAL BATTERY CHARGE

PRIMERA CARGA DE LA
BATERÍA

PREMIÈRE CHARGE DE
BATTERIE

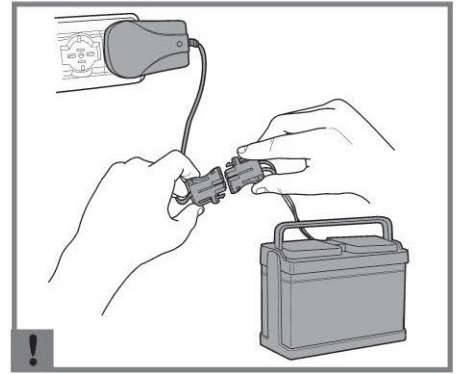

ASSEMBLY

MONTAJE

MONTAGE

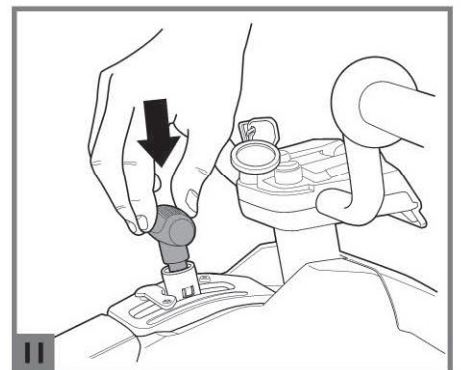
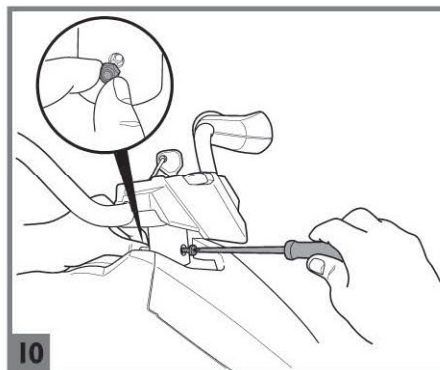
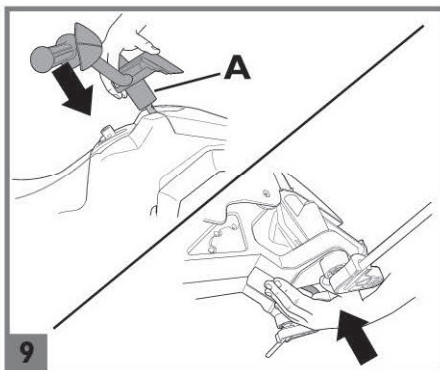
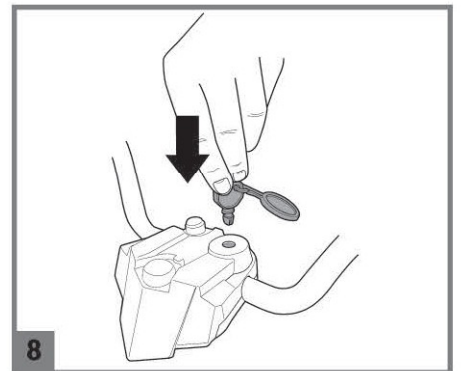
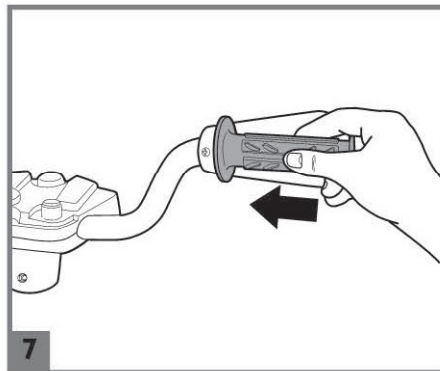
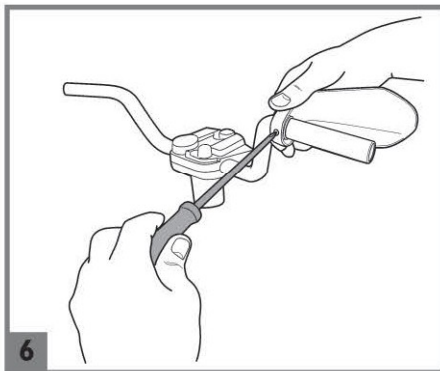
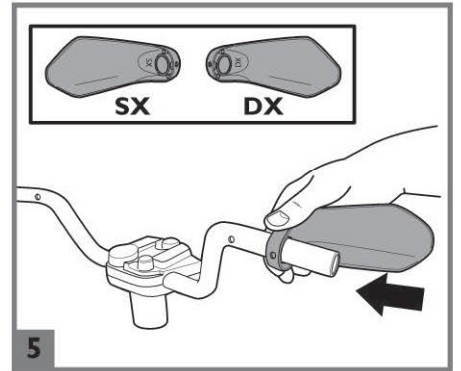
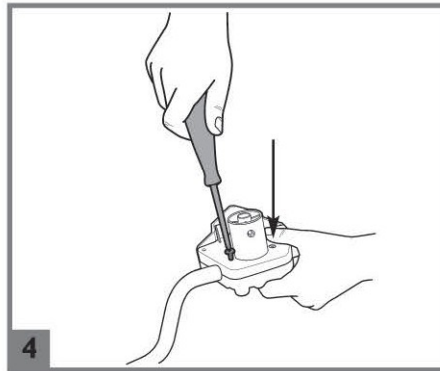
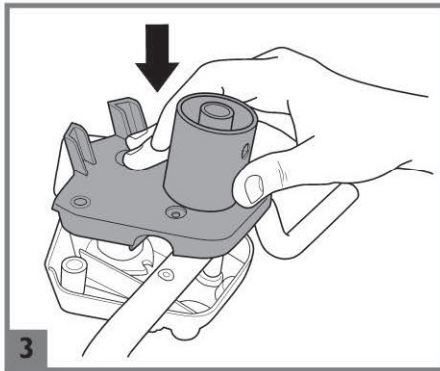
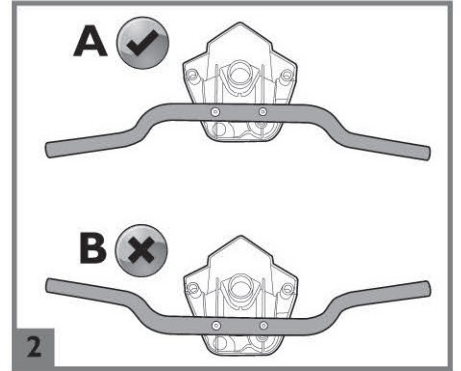
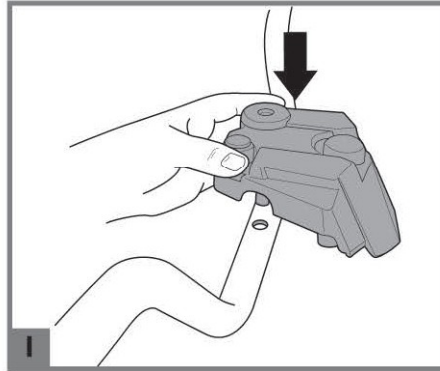

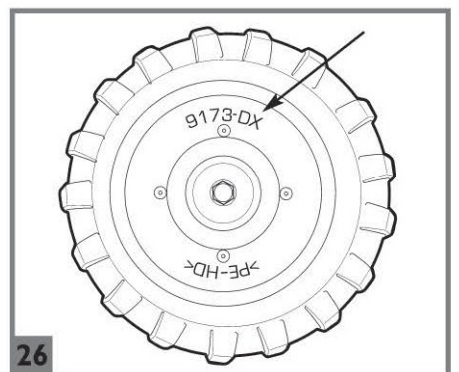
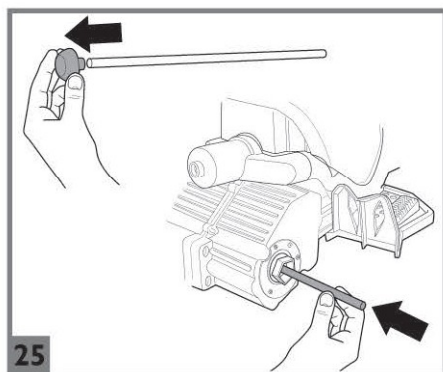
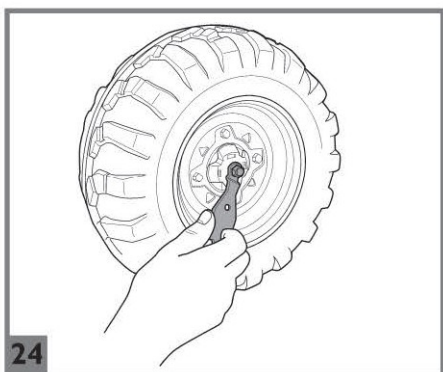
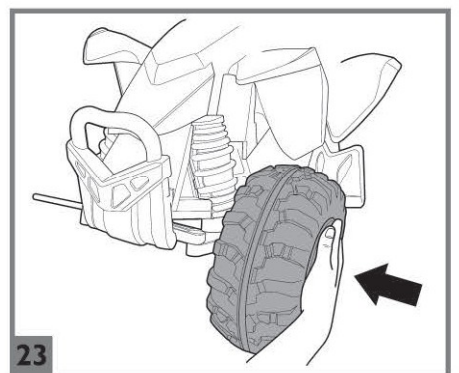
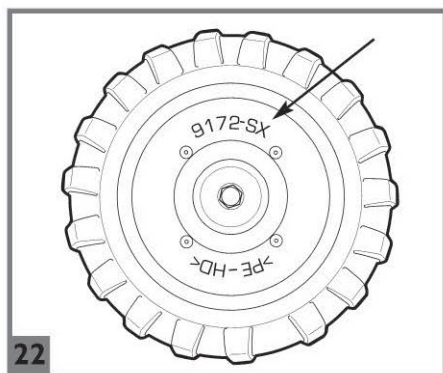
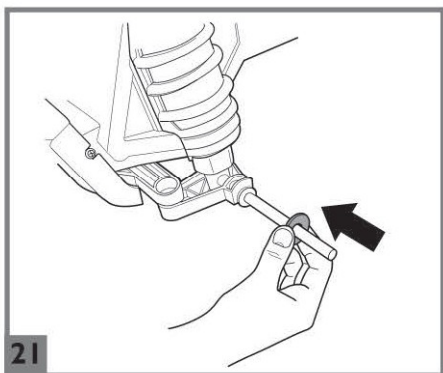
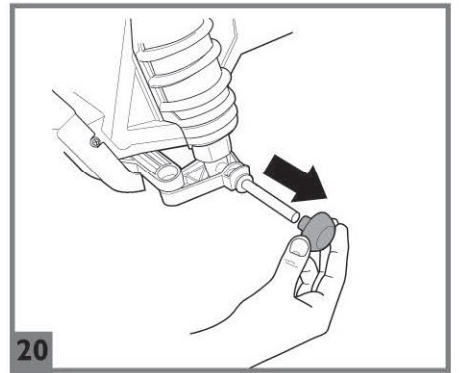
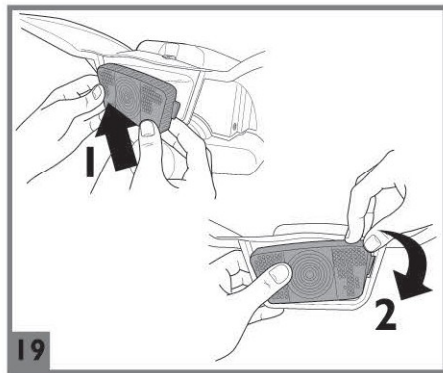
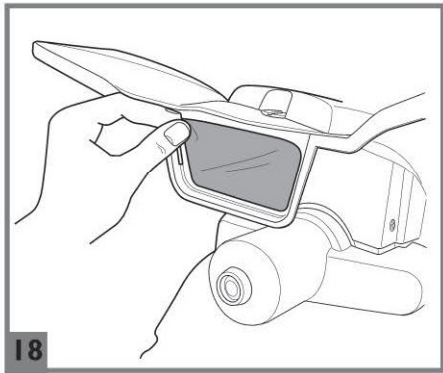
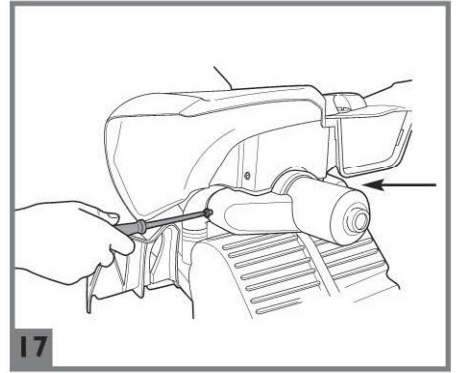
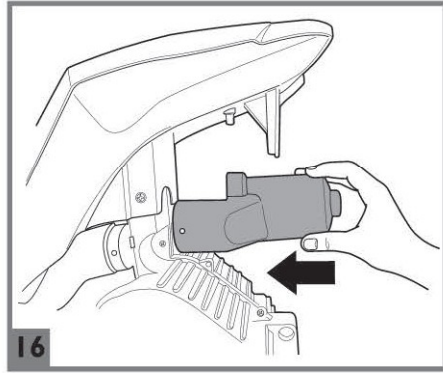
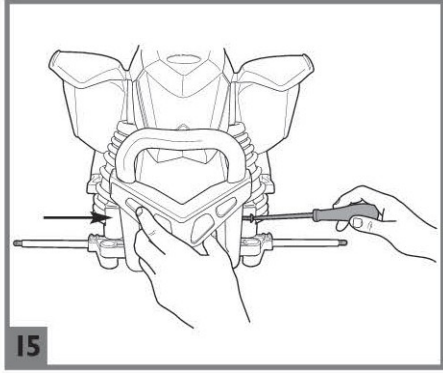
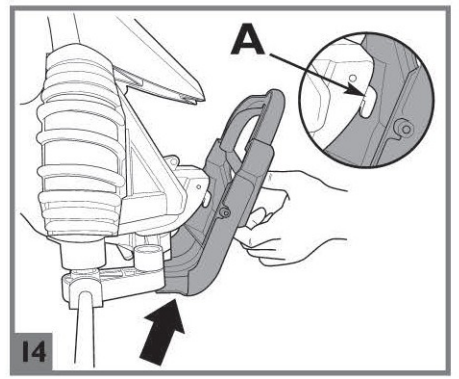
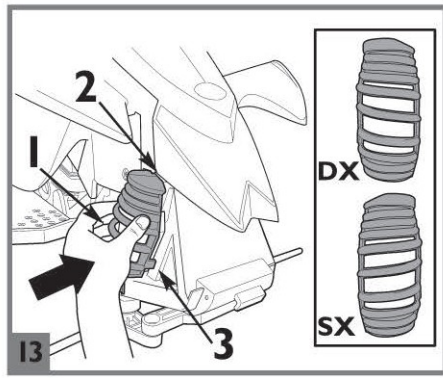
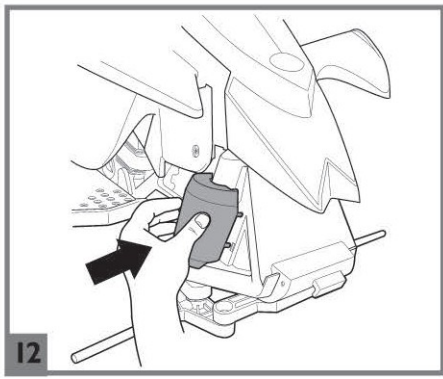

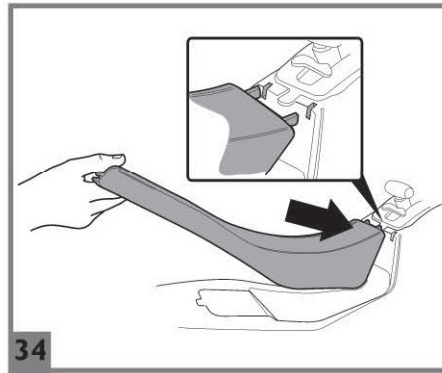
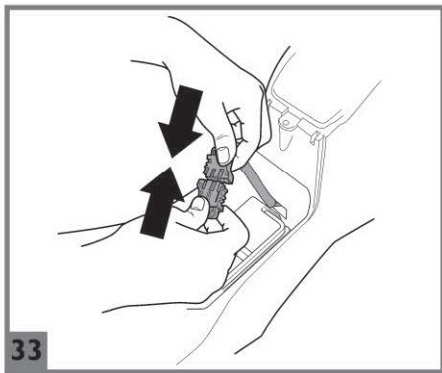
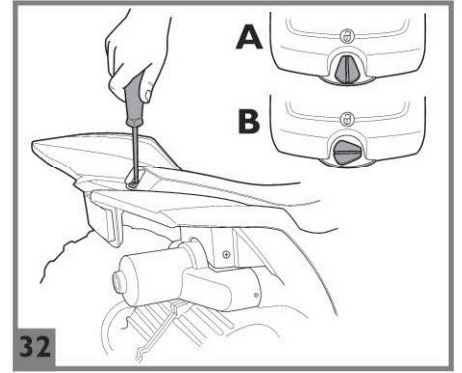
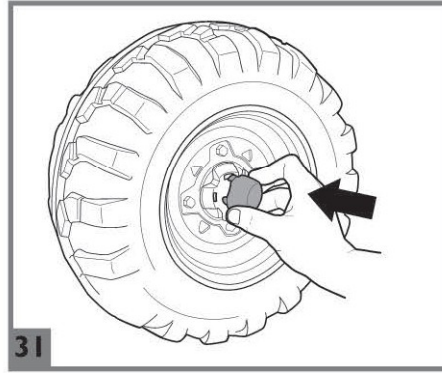
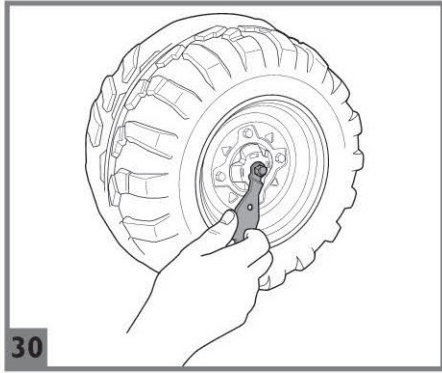
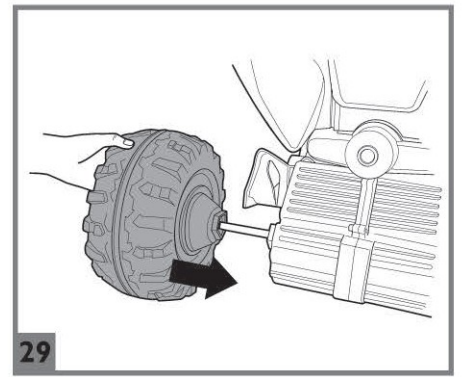
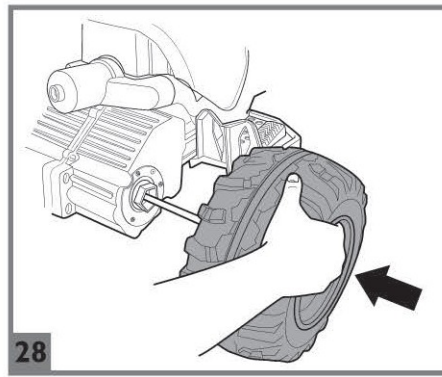
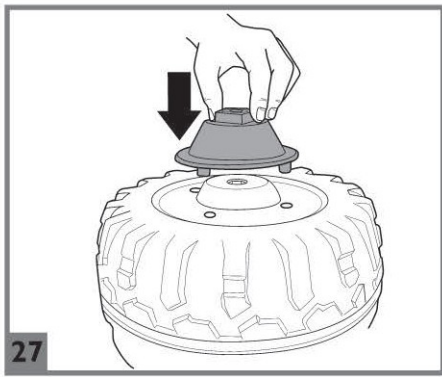

**VEHICLE FEATURES AND
INSTRUCTIONS FOR USE**

**CARACTERÍSTICAS Y USO DEL
VEHÍCULO**

**CARACTÉRISTIQUES ET
UTILISATION DU VEHICULE**

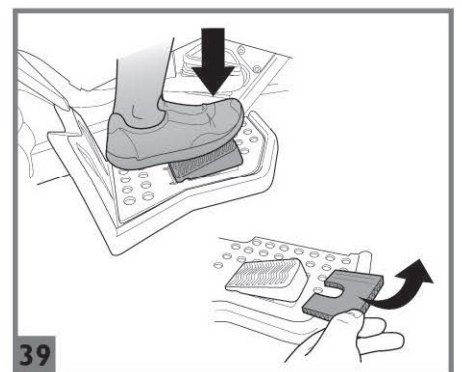
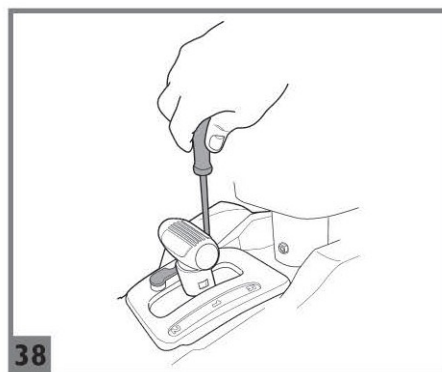
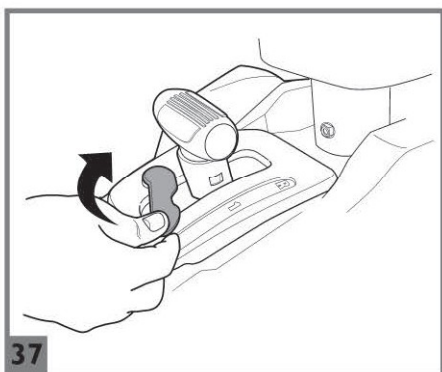
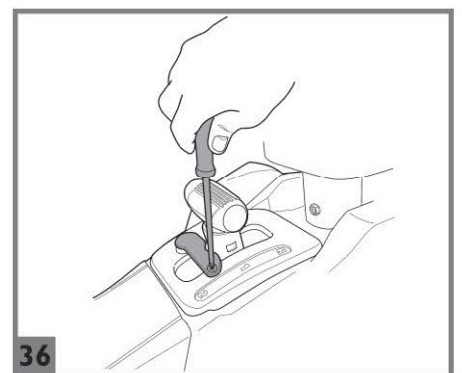
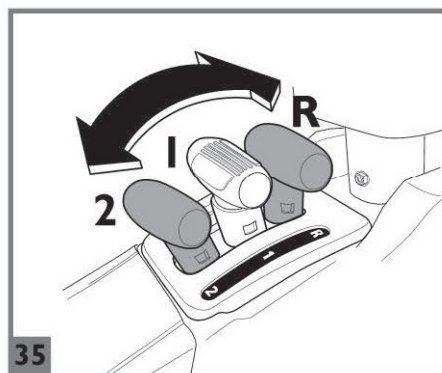

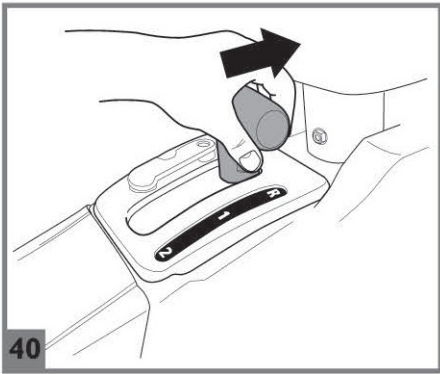

BATTERY REPLACEMENT
CAMBIO DE LA BATERÍA
REPLACEMENT DE LA BATTERIE

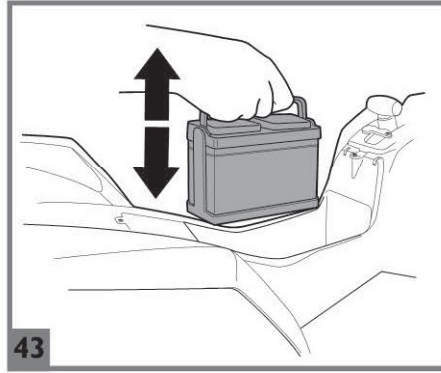
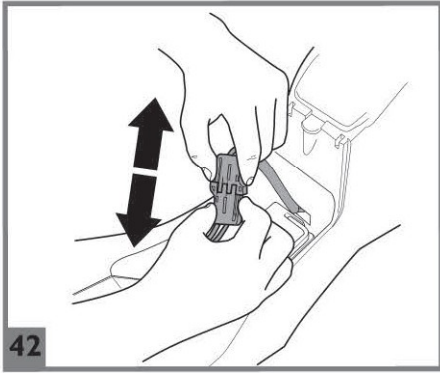
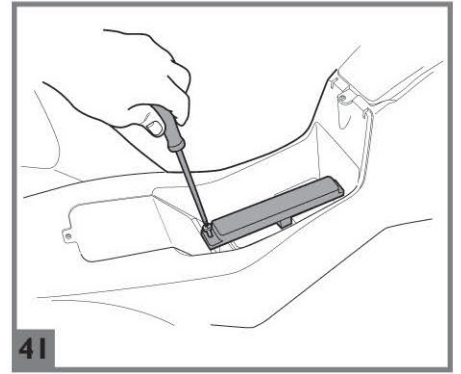

BATTERY RECHARGE
CARGA DE LA BATERÍA
CHARGE DE LA BATTERIE

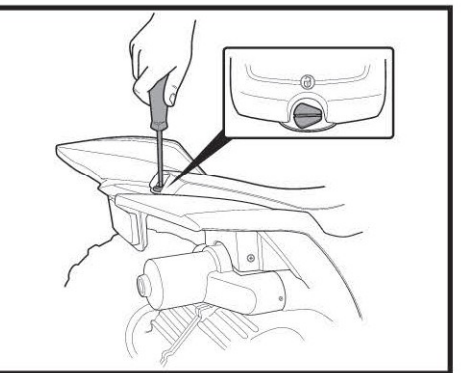
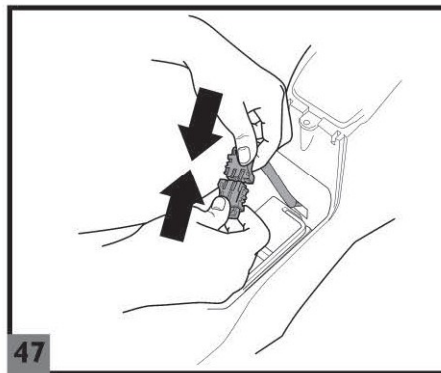
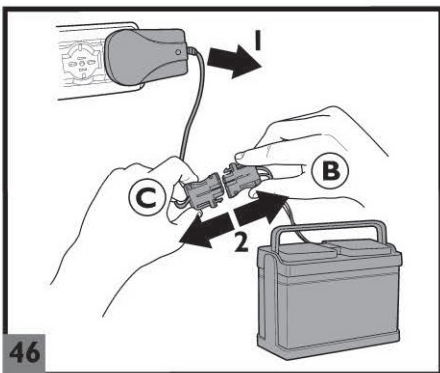
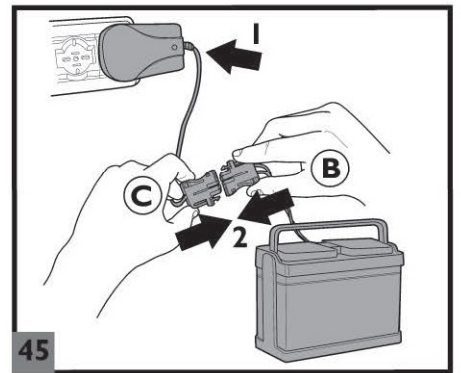
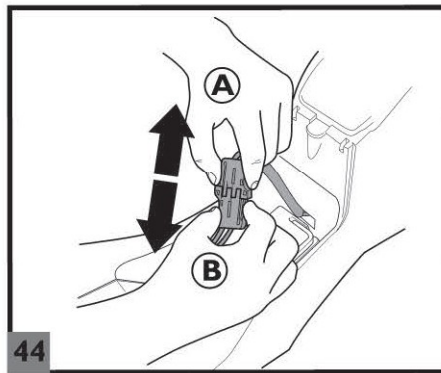

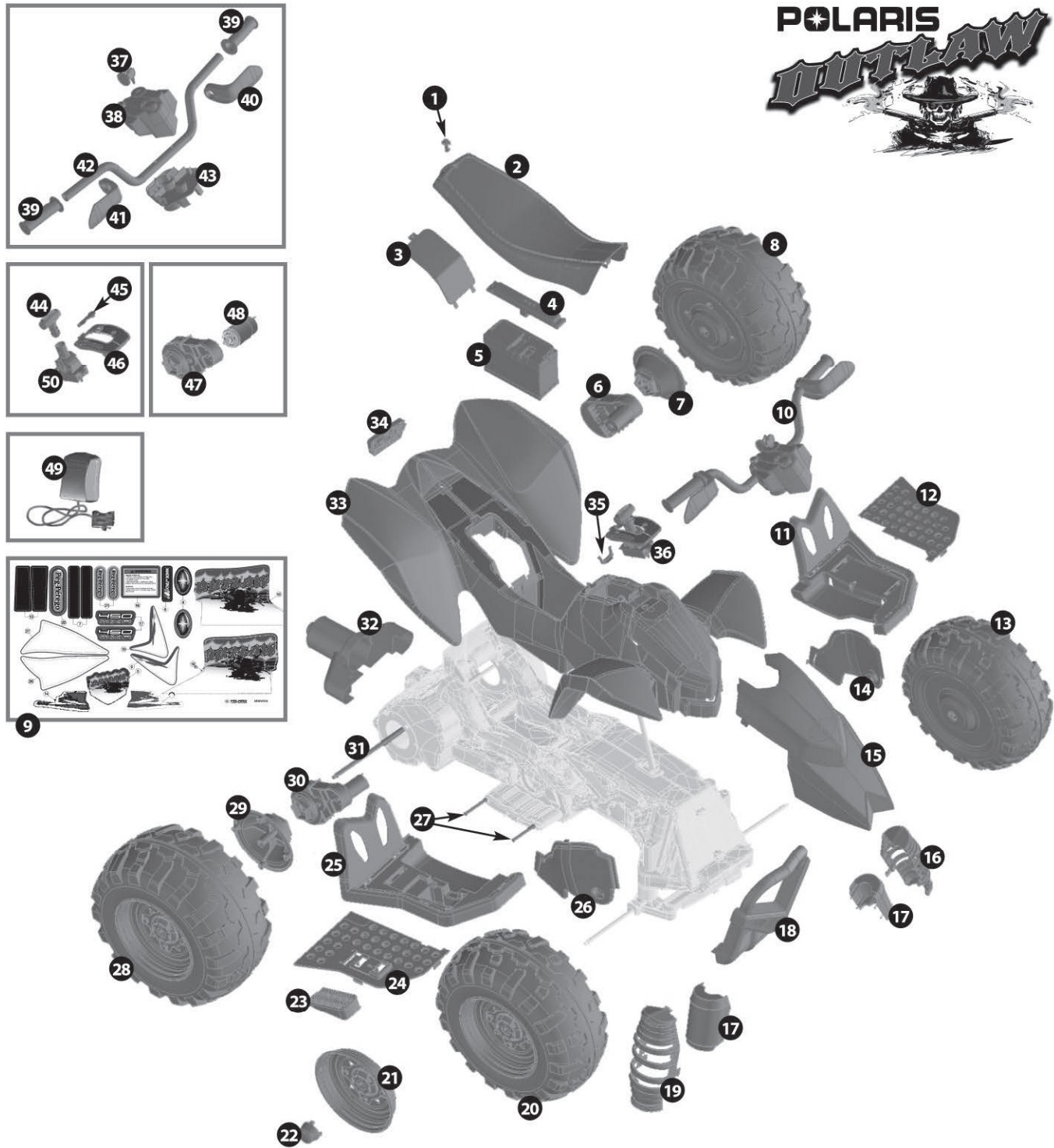

- | | | | |
|-----------------|-----------------|----------------|----------------|
| 1 SPST8500RC | 15 SPST9176N | 29 SPST9185N | 43 SPST9184N |
| 2 SPST9170N | 16 SPST9186SR | 30 SAGI9962XXG | 44 SPMV8914GR |
| 3 SPST9182N | 17 SPST9188GR | 31 SOFF0280Z | 45 SPST8937R |
| 4 SPST9177N | 18 SPST9171GR | 32 SPST9175GR | 46 SPST8915NS |
| 5 IAKB0014 | 19 SPST9186DR | 33 SPST9169R | 47 SAGI0021XXG |
| 6 SAGI9962XXG | 20 SARP9172DNDR | 34 SPST8396RF | 48 SAGI9997J |
| 7 SPST9185N | 21 SPST8397GR | 35 SPST9187N | 49 IKCB |
| 8 SARP9173SNGR | 22 SPST8398N | 36 ASGI0220GRN | 50 SAGI8779GR |
| 9 MMEV0724 | 23 SPST8863GL | 37 SAGI8056NP | |
| 10 ASGI0219RN | 24 SPST9180GR | 38 SPST9183R | |
| 11 SPST9179GR | 25 SPST9178GR | 39 SPST9198N | |
| 12 SPST9181GR | 26 SPST9174DB | 40 SPST9099SB | |
| 13 SARP9172SNGR | 27 SOFF0215Z | 41 SPST9099DB | |
| 14 SPST9174SB | 28 SARP9173DNDR | 42 SOTF0272L30 | |

SERIAL NUMBER

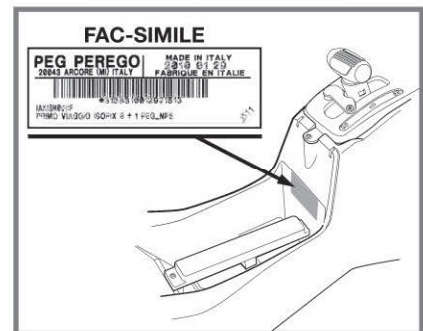

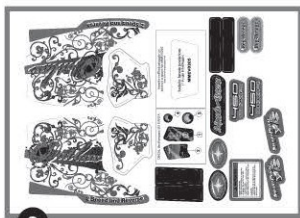
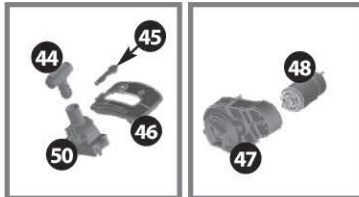
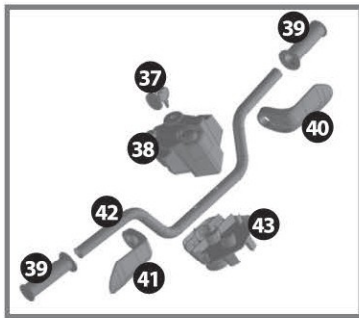

- | | | | |
|-----------------|-----------------|----------------|----------------|
| 1 SPST8500RC | 15 SPST9176N | 29 SPST9185N | 43 SPST9184N |
| 2 SPST9170N | 16 SPST9186SRR | 30 SAGI9962XXG | 44 SPMV8914GR |
| 3 SPST9182N | 17 SPST9188GR | 31 SOFF0280Z | 45 SPST8937R |
| 4 SPST9177N | 18 SPST9171GR | 32 SPST9175GR | 46 SPST8915NS |
| 5 IAKB0014 | 19 SPST9186DRR | 33 SPST9169RR | 47 SAGI0021XXG |
| 6 SAGI9962XXG | 20 SARP9172DNGR | 34 SPST8396RF | 48 SAGI9997J |
| 7 SPST9185N | 21 SPST8397GR | 35 SPST9187N | 49 IKCB |
| 8 SARP9173SNGR | 22 SPST8398N | 36 ASGI0220GRN | 50 SAGI8779GR |
| 9 MMEV0725 | 23 SPST8863GL | 37 SAGI8056NP | |
| 10 ASGI0219RRN | 24 SPST9180GR | 38 SPST9183RR | |
| 11 SPST9179GR | 25 SPST9178GR | 39 SPST9198N | |
| 12 SPST9181GR | 26 SPST9174DB | 40 SPST9099SB | |
| 13 SARP9172SNGR | 27 SOFF0215Z | 41 SPST9099DB | |
| 14 SPST9174SB | 28 SARP9173DNGR | 42 SOTF0272L30 | |

SERIAL NUMBER

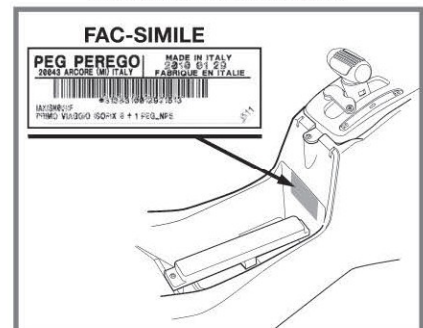

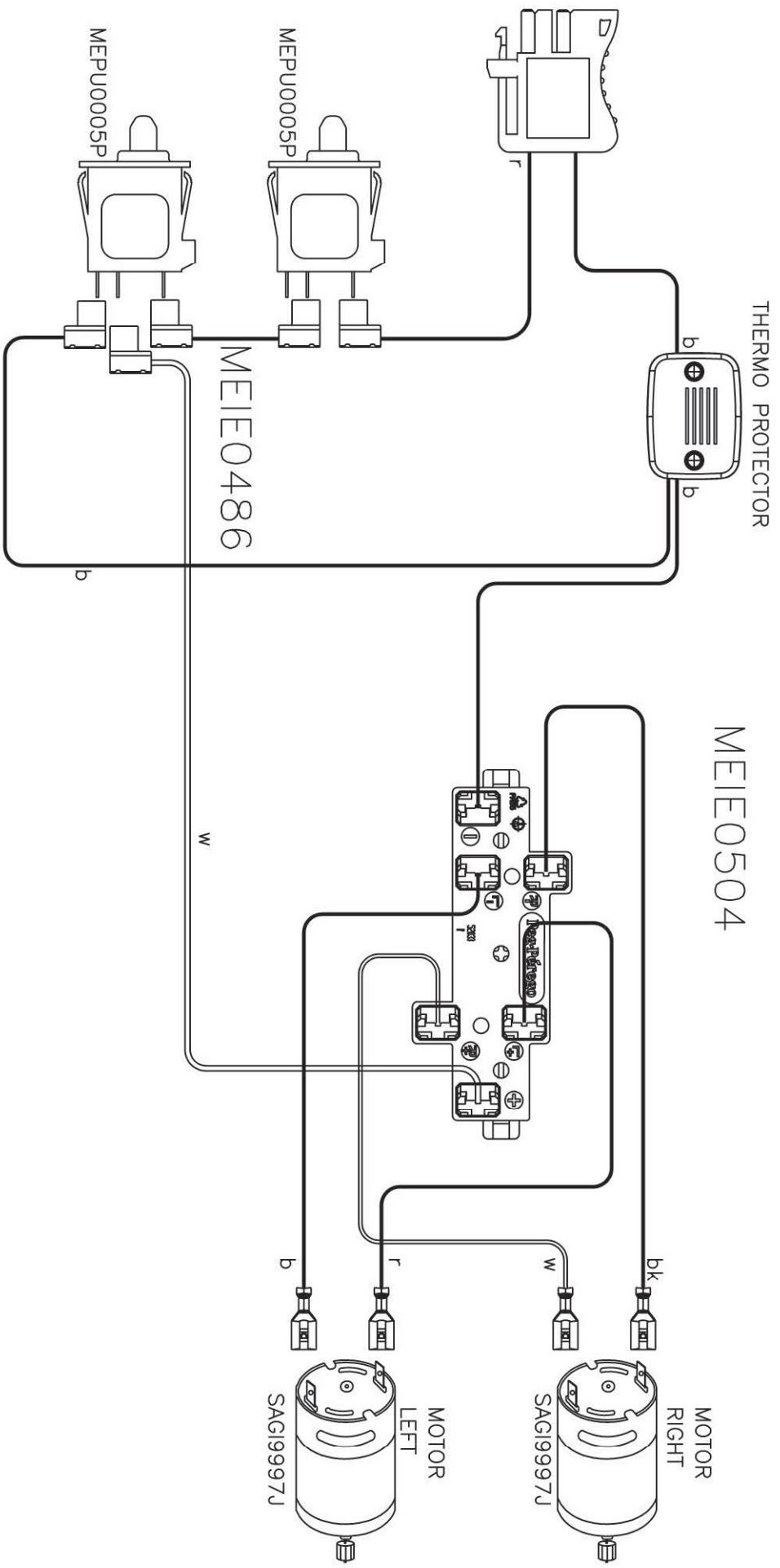

PEG PEREGO® thanks you for choosing this product. For more than 60 years, PEG PEREGO have been taking children for an outing: first with its famous baby carriages and strollers, later with its pedal and battery operated toy vehicles.

Discover our complete range of products, news and other information about the Peg Perego world on our web site www.pegperego.com

IMPORTANT INFORMATION

- Read this instruction manual carefully to learn the use of the vehicle and to teach your child safe and enjoyable driving. Please keep this manual (with your original sales receipt) for use as a reference in the future.
- **DO NOT RETURN YOUR VEHICLE TO THE STORE. This product cannot be returned for a refund after it has been used. If you have ANY questions, need replacement parts or need assistance, call us toll-free; U.S.A. , call 1-800-728-2108 / CANADA, call 1-800-661-5050**
- This product meets and/or exceeds all ASTM (American Society for Testing and Materials) TOY SAFETY STANDARDS, including F 963, Consumer Toy Safety Specifications as well as C.R.C, c.931, the Canadian Hazardous Products (Toys) Regulations.
- Tools needed for assembly: medium phillips screwdriver and pliers.
- Your new vehicle is partially pre-assembled. It will require adult assembly. Please set aside at 45 minutes for assembly.
- Before the vehicle is used for the first time, charge the battery for 18 hours to initiate it. Failure to do this can result in permanent battery damage.
- Use only with the included Peg Perego 12 Volt lead-acid, rechargeable battery and a Peg Perego 12 Volt Charger (both included).

- **Year 3+**
- **Weight capacity 85 lbs**

- Do not exceed the maximum total weight capacity of 85 lbs (38,6 Kg).

Contents:

- 1 Polaris Outlaw Red or 1 Polaris Outlaw Pink riding vehicle -- partially assembled
- 1 Rechargeable 12V 8Ah sealed lead-acid battery
- 1 Charger 12V
- two 165 W motors -- pre installed
- assembly hardware
- parts to be assembled
- decals

- Speed in 1st gear 4,1 km/h - 2,5 MPH
- Speed in 2nd gear 8,2 km/h - 5 MPH
- Speed in reverse gear 4,1 km/h - 2,5 MPH
- On vehicles that have forward & reverse; please teach your child to stop the vehicle before switching directions to prevent damage to the drive mechanism.
- Peg Perego reserves the right to modify or change its products. Price, literature, manufacturing processes or locations or any combination of the above mentioned entities may change at any time for any reason without notice with impunity.

⚠ CAUTION:

ELECTRIC VEHICLE NOT RECOMMENDED FOR CHILDREN UNDER 3 YEARS OF AGE. AS WITH ALL ELECTRIC PRODUCTS, PRECAUTIONS SHOULD BE OBSERVED DURING HANDLING AND USE TO PREVENT ELECTRIC SHOCK. RECHARGER INCLUDED. 120 VOLTS, 60Hz, 30W INPUT, 12 VOLTS (DC) OUTPUT.

⚠ CAUTION:

Only adults should recharge batteries never children.

Never allow children to handle batteries.

Only use the batteries specified by the manufacturer. Only use the charger specified by the manufacturer.

Do not mix old and new batteries.

Do not mix alkaline, standard (carbon-zinc), or rechargeable (nickel-cadmium) batteries.

CHARGING THE BATTERY

- Charge the batteries no longer than 24 hours, following the instructions enclosed with the battery charger.
- Charge the battery, as the vehicle shows low power, in this way you will avoid damage to the battery.
- If you don't use your vehicle for a long period of time unplug the battery from the main wire harness of the vehicle. Remember to charge the battery at least every three months.
- Never charge the battery upside down.
- Do not forget batteries during charging! Check them periodically.
- Never use a replacement recharger or batteries unless they are approved by PEG PEREGO.
- Batteries are sealed and maintenance free.
- Battery polarity must be observed when connecting battery to wiring.

⚠ WARNING:

- BATTERIES CONTAIN TOXIC AND CORROSIVE SUBSTANCES. DO NOT TAMPER WITH THEM.
- Batteries contain an acid-based electrolyte.
- Do not make direct contact between battery terminals, as this can cause an explosion or fire.
- Charging produces explosive gases. Charge batteries in a well ventilated area away from sources of heat and flammable materials.
- Exhausted batteries are to be removed from the vehicle.
- Do not place the batteries near clothing to avoid damage.

IF A LEAK DEVELOPS

Shield your eyes. Avoid direct contact with the electrolyte, protect your hands.

Place battery in a plastic bag and follow directions listed below.

IF ELECTROLYTE COMES IN CONTACT WITH SKIN OR CLOTHING

Flush with cool water for at least 15 minutes.

See a physician at once.

IF ELECTROLYTE IS INJECTED

Give tap water, milk of magnesia or egg whites at once.

Do not induce vomiting.

See a physician at once.

DISPOSAL OF BATTERIES

Help protect the environment!

Do not throw used batteries in your regular, household trash.

Dispose of the old batteries in an approved dumping station; contact your local environmental protection agency office for further information.



INITIAL BATTERY CHARGE

!• Remove battery and charger from packaging. Connect battery charger to a 120vac wall recepticle. Connect battery charger to battery.

ASSEMBLY INSTRUCTIONS

CAUTION:

ADULT ASSEMBLY REQUIRED.

USE CARE WHEN UNPACKING AS COMPONENTS TO BE ASSEMBLED MAY POSE A SMALL PARTS/SHARP EDGE HAZARD.

BATTERY ALREADY INSTALLED IN VEHICLE.

- 1 • To mount the upper section of the handlebar, insert the two pins in the two holes on the steel handlebar, taking care to position it correctly (see next figure).
- 2 • Figures A and B show the correct and incorrect assembly of the components.
- 3 • Press the lower section of the handlebar into place.
- 4 • Secure the two assembled components using the two screws provided.
- 5 • Insert the handguards, taking care to insert the handguard marked internally with the inscription DX on the right hand side of the handlebar and the one marked SX on the left hand side. Note: the drawing shows the right-hand guard, marked DX.
- 6 • Secure the handguards using the screws provided.
- 7 • Use water and soap (or a light lubricant) to moisten the inside of the rubber handles, to facilitate their application onto the handlebar. The handles may be fitted without distinction onto the left and right hand side.
- 8 • Insert the key into the dashboard. The key is purely for aesthetic purposes.
- 9 • Place the handlebar onto the steering tube, ensuring the holes (A) are aligned with those on the tube. Note: for ease of installation, place one hand under the bodywork, level with the tube, to avoid its descent.
- 10 • Secure the handlebar in place using the screw and nut provided. Note: the nut is to be inserted into the hexagonal hole, and the screw into the circular one.
- 11 • Press the upper section of the gear lever into place.
- 12 • Press the inner part of the suspensions into place on the front section of the vehicle.
- 13 • Click one suspension into place level with the fastening tongues. Repeat for the other suspension. Note: the drawing shows the right-hand suspension, marked DX.
- 14 • Hook the front bumper onto the bodywork at position A.
- 15 • Secure the bumper to the frame using the two screws provided.
- 16 • Place the exhaust pipe on the rear of the vehicle, directing it as shown in the figure.
- 17 • Secure the exhaust pipe in place using the two screws provided.
- 18 • Apply the silver decal contained in the decal polybag.
- 19 • Fasten the rear tail light on one side and rotate it downwards.
- 20 • Remove the plastic plugs from the front axles.
- 21 • Insert a large washer on the left hand axle.
- 22 • Take the front left hand wheel, which is easily recognizable as it is narrower and contains the inscription SX on the inside.
- 23 • Slide the wheel onto the axle.
- 24 • Place a large and a small washer on the section of the axle that projects beyond the wheel. Tighten in place with a nut, using the wrench provided. Repeat the same operations on the right hand side, using the narrow wheel marked DX.
- 25 • Remove the plastic plugs from the steel axle. Slip the axle through the holes of the gearmotors.
- 26 • Take the rear right hand wheel, which is easily recognizable as it contains the inscription DX on the inside.
- 27 • Position the driver, aligning its pins with the holes on the wheel.
- 28 • Slide the wheel onto the axle until the pentagon on the gearmotor fits into the wheel.
- 29 • Position the remaining driver on the last wheel and slide this onto the other side of the axle.
- 30 • Place a large and a small washer on each of the two sections of the axle that project beyond the wheels. Tighten in place with a nut. Note: for ease of installation, use a wrench or pliers to keep the opposite nut still while screwing in the first.
- 31 • Press the four small hubcaps into place.
- 32 • Rotate the lock behind the saddle to position A (A: saddle unlocked; B: saddle locked). Remove the saddle.
- 33 • Connect the battery terminal to the electrical system.
- 34 • Reposition the saddle, inserting the front tongues into the holes on the bodywork. Lock it in place by rotating the lock behind the saddle to position B. The vehicle is now ready for use.
 - IMPORTANT NOTE: Charge the battery fully before using the first time.

VEHICLE FEATURES AND INSTRUCTIONS FOR USE

- 35 • GEAR LEVER. The vehicle comes with two forward gears and one reverse gear. WARNING: when first removed from the packaging, the vehicle only travels in one forward gear and in reverse. To use the second gear, follow the instructions below.
- 36 • Unscrew the lock.
- 37 • Rotate the lock to the next position.
- 38 • Screw the lock back in. All the gears are now available.
- 39 • ELECTRICAL ACCELERATOR/BRAKE PEDAL. With both hands on the handlebar, press on the accelerator pedal. The vehicle will travel at a speed of 2,5 mph (in 1st gear) and 5 mph (in 2nd gear).
 - The brake engages automatically, bringing the vehicle to a stop, when the foot is lifted off the pedal. Note: remove the protective cardboard before using the accelerator pedal.
- 40 • REVERSE GEAR: unlike the two forward gears, the lever must be held in the reverse position in order to drive in reverse. As soon as the lever is released, it returns to 1st gear. To drive in reverse, push the gear lever forwards and at the same time press down on the accelerator pedal. When the maneuver is complete, lift the foot off the accelerator pedal and release the gear lever.

BATTERY REPLACEMENT

WARNING:

WARNING: BATTERY CHARGING AND ANY OTHER OPERATION ON THE ELECTRICAL SYSTEM MUST BE CARRIED OUT BY ADULTS ONLY.

THE BATTERY CAN ALSO BE CHARGED WITHOUT REMOVING IT FROM THE VEHICLE.

- 41 • Open the saddle as described above. Unscrew the battery holder. Remove the battery holder.
- 42 • Disconnect the battery terminal from that of the electrical system, pushing them sideways as shown in the figure.
- 43 • Remove and replace the battery. Reposition the battery holder and tighten the screw. Reconnect the terminals. Reposition the saddle and lock it back in place.

BATTERY RECHARGER

- 44 • Open the saddle as described above. Disconnect the battery terminal (B) from that of the electrical system (A), pushing them sideways.
- 45 • Plug the battery charger into a wall outlet following the instructions enclosed. Connect terminal B to the battery charger terminal C.
- 46 • Once charging is complete, unplug the charger from the wall outlet, then unplug terminal C from terminal B.
- 47 • Insert terminal B into terminal A, pushing until it clicks. Once completed, always remember to close and secure the saddle.

RULES FOR SAFETY DRIVING

DON'T STOP THE FUN: purchase a spare battery to have a freshly charged back-up available. For your child's safety: please read and follow all instructions below before operating.

• **ATTENTION:**

- Check the fastening retainers to be sure they are tight.
- 1st SPEED slow speed (beginner drivers):
With both hands on the handlebar, press down on the accelerator pedal; the vehicle goes forward at 2 1/2 mph.
- 2nd SPEED: fast speed (experienced drivers):
With both hands on the handlebar, press down on the accelerator pedal; the vehicle goes forward at 5 mph.
- REVERSE:
Place the left hand on the handlebar. With the right hand holding the gearshift in reverse, press your foot down on the accelerator; the vehicle reverses at 2 1/2 mph. (Reverse is spring-loaded for safety).
- BRAKE:
The electric braking system stops the vehicle automatically when your child lifts his foot off the pedal.

Teach your child the proper use of this vehicle for a safe and fun play time.

- Before starting be sure that the way is free from people and objects.
- Drive with both hands on the handlebar and keep your eyes on the road at all times.
- Please teach your child to stop in time to avoid running into objects or people and to immediately release the accelerator pedal if they do run into an object or person.

⚠ CAUTION:

- **If the vehicle is overloaded, as can happen on soft sand, mud, or very uneven ground, the overload switch will immediately disconnect the power. The power supply will be restored after a few seconds.**

VEHICLE MAINTENANCE AND SAFETY

This product meets and/or exceeds all ASTM (American Society for Testing and Materials) TOY SAFETY STANDARDS, including F 963, Consumer Toy Safety Specification.

This vehicle is not intended for use on streets, around traffic or parked cars.

MAINTENANCE AND CARE

- Regularly check the conditions of the vehicle, particularly the electrical system, the plug connections, the covering caps and the charger. In case of fault, do not try to use the vehicle and the charger. For repair use only original PEG PEREGO's spare parts.
- PEG PEREGO assumes no liability if the electrical system is tampered with.
- Do not leave vehicle or batteries near sources of heat such as radiators, stoves, fireplaces, etc.
- Protect vehicle from water, rain, snow, etc.
- When operating in overload conditions, such as soft deep sand, mud or rough uneven terrain, the overload circuit breaker will automatically disconnect the power. After 10 or more seconds, the circuit breaker will automatically reset, however you must eliminate overload conditions to resume normal driving.
- Periodically lubricate (with a light weight oil) moving parts, such as wheel bearings, steering linkages, where they rotate or touch one another.
- The vehicle's surfaces can be cleaned with a damp cloth. Do not use abrasive cleaners. The cleaning must be carried out by adults only.
- Never disassemble the vehicle mechanisms or motor unless authorized by PEG PEREGO.

SAFETY

⚠ WARNING:

- To reduce the risk of injury, adult supervision is required. Never use in roadways, near motor vehicles, on or near steep inclines or steps, swimming pools or other bodies of water; always wear shoes, and never allow more than one rider.
- Surfaces that are appropriate for use: grass, dirt or hard surfaces with slopes not to exceed 10%.
- A child must be 3 years of age or older for the necessary coordination and maturation to operate this motorized vehicle safely.
- Never use the vehicle on steep slopes or near steps or stairs. This vehicle is not suitable for use on public highways.
- Children should always wear shoes when riding in or driving a riding vehicle.
- The use of a certified bicycle helmet is strongly recommended.
- Do not allow children to place their hands, feet or any part of their body, clothing or other articles near the moving parts while vehicle is in operation.
- Do not allow the electrical components, motors, wiring, switches of your motorized vehicle to become wet and never wash it with a hose.
- Never use gasoline or other flammable substances near the vehicle.
- The vehicle is designed just for one child: never allow more than one rider

PROBLEMS?

IF THE VEHICLE DOES NOT OPERATE?

- **When operating in overload conditions, such as running the vehicle against a fixed object, through soft deep sand or mud, or over rough or uneven terrain, the overload circuit breaker will automatically disconnect the power. After 10 or more seconds, the circuit breaker will automatically reset, however-you must eliminate overload conditions to resume normal driving.**
- Check that all plugs are properly connected.
- Check electrical switches. Replace if necessary.
- Check that the battery is connected to the electrical system.

IF THERE IS NO POWER?

- Fully recharge the battery. If the problem persists, check with an Authorized PEG PEREGO Service Center.

CUSTOMER SERVICE

For your convenience, PEG PEREGO offers after-sales service, directly or through a network of authorized service centers for repairs or replacement parts.

If you have any questions about your Peg Perego vehicle, please call our toll-free service lines at;

U.S.A , call 1-800-728-2108

CANADA, call 1-800-661-5050

Trained customer service representatives are available to take your call in English or Spanish.

This document was created with Win2PDF available at <http://www.win2pdf.com>.
The unregistered version of Win2PDF is for evaluation or non-commercial use only.
This page will not be added after purchasing Win2PDF.