



FIUS1001G96



- EN** USE AND CARE
- ES** EMPLEO Y MANUTENCION
- FR** UTILISATION ET ENTRETIEN

See separate insert sheet for more information



Vea la hoja separada del separador de millares para más información

Voir la feuille séparée d'insertion pour plus d'information



*CONSUMER PARTICIPATION REQUIRED

Requires 2 AA batteries (not included)
Requerir 2 AA baterías (no inclusa)
Exige 2 batteries de AA (ne pas inclus)

24V



GAUCHO SUPERPOWER

Model Number IG0D0501US

SEE VERBAL
INSTRUCTIONS AFTER
THE PICTURES

VER LAS INSTRUCCIONES
DESPUES DE LOS DISEÑOS

VOIR LES INSTRUCTIONS
APRES LES DESSINS

ASSEMBLY

MONTAJE

MONTAGE

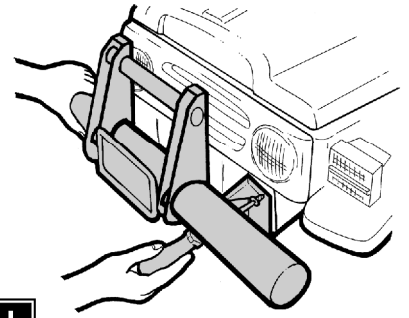

1

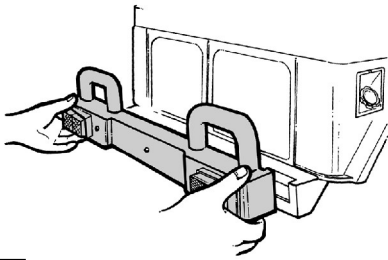

2

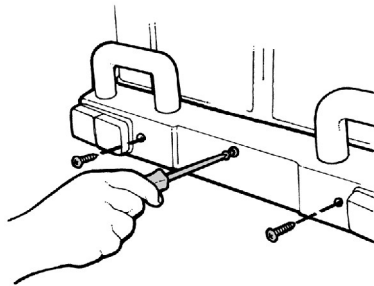

3

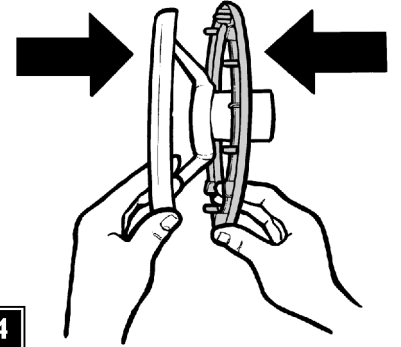

4

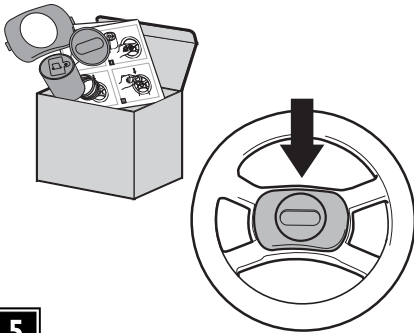

5

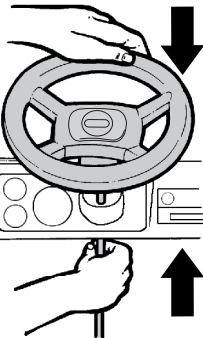

6

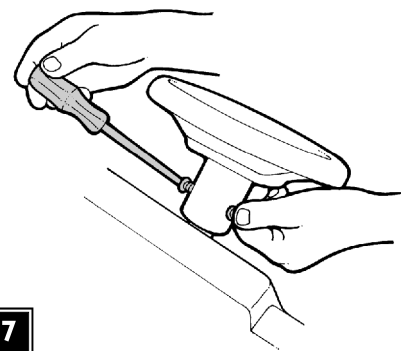

7

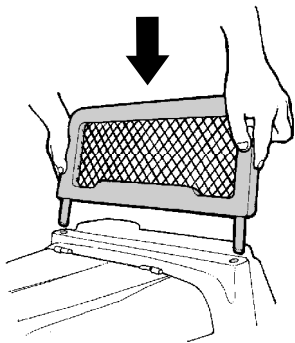

8

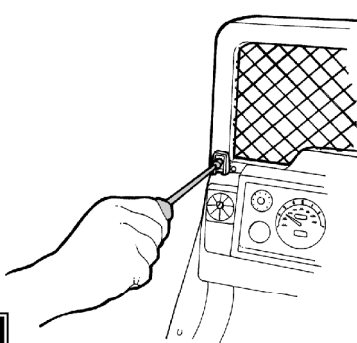

9

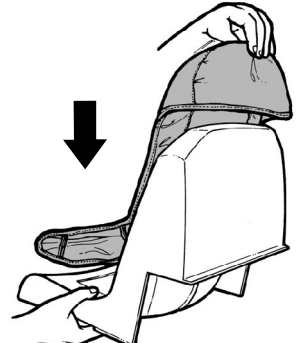

10

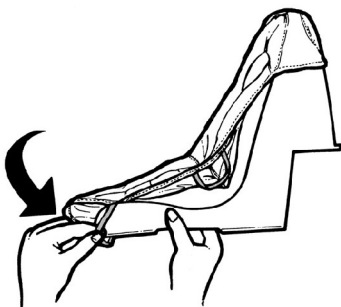

11

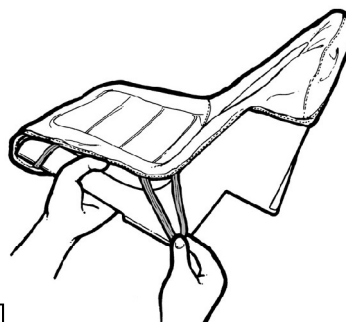

12

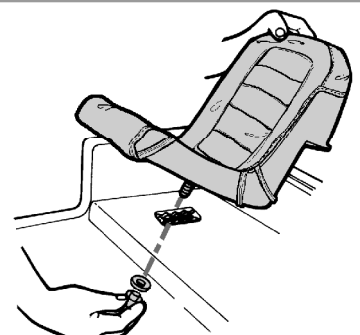

13

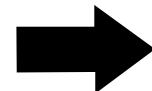
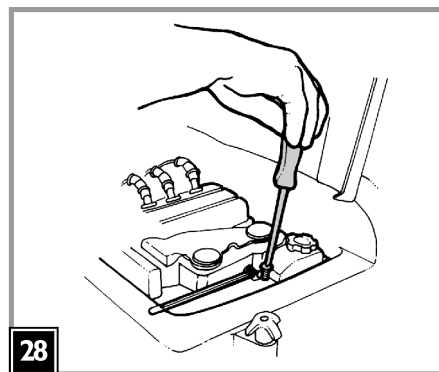
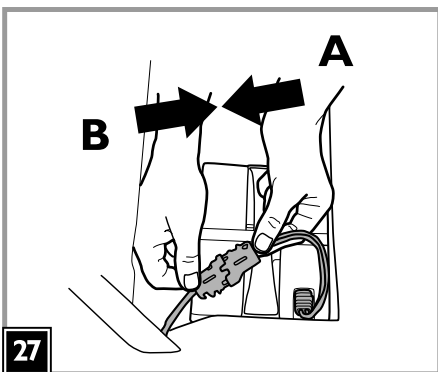
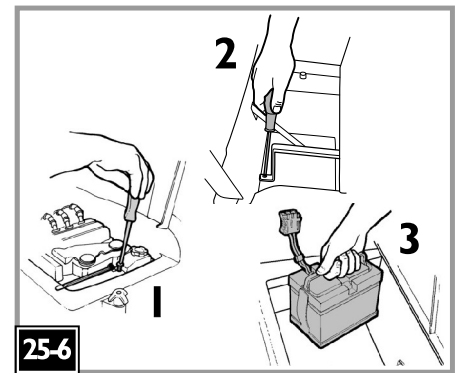
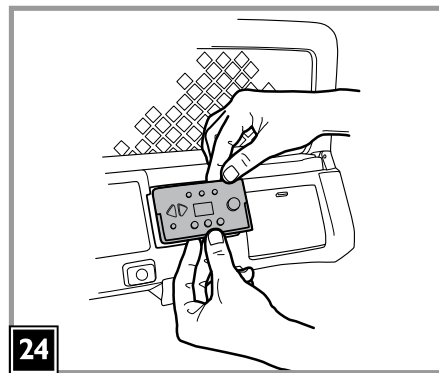
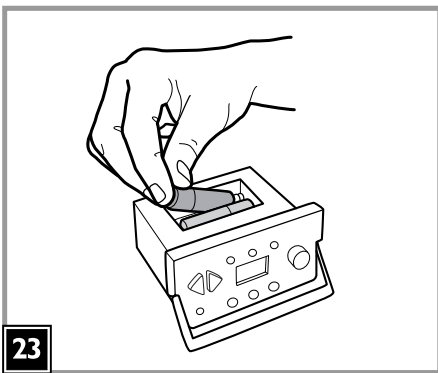
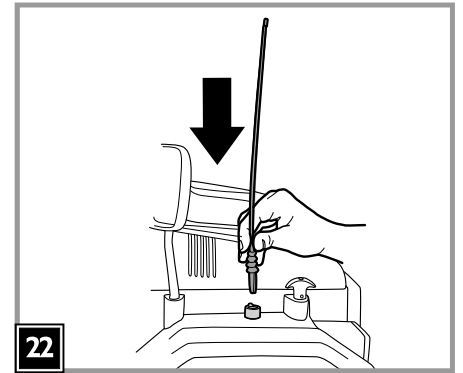
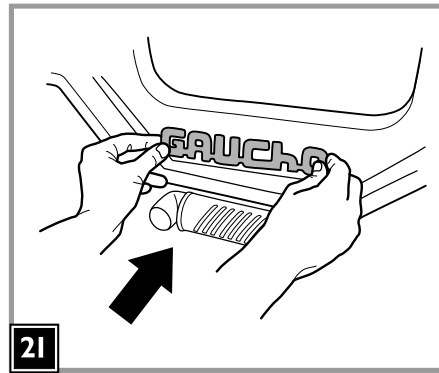
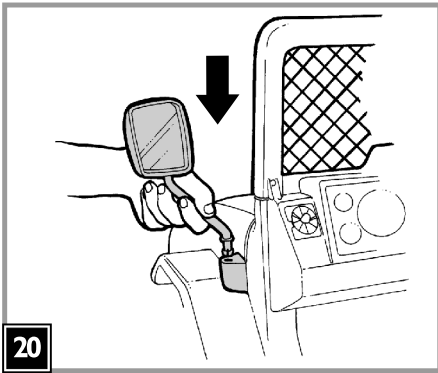
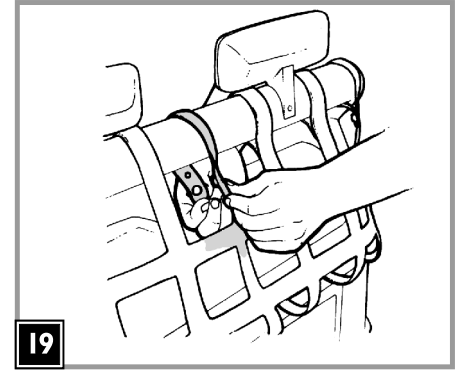
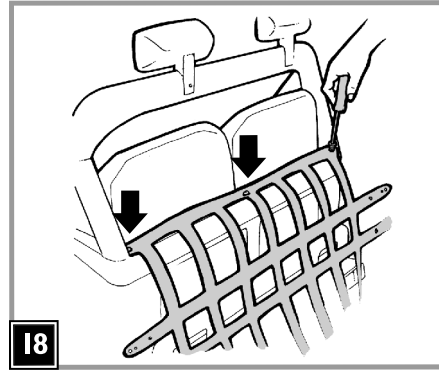
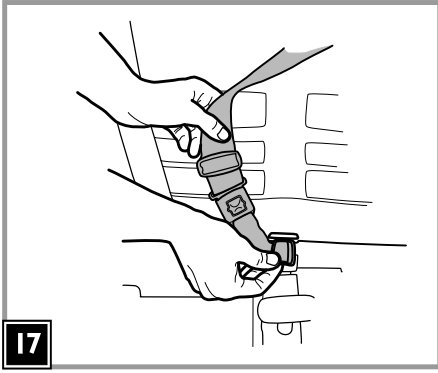
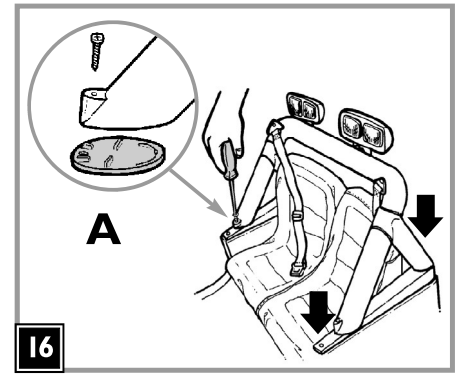
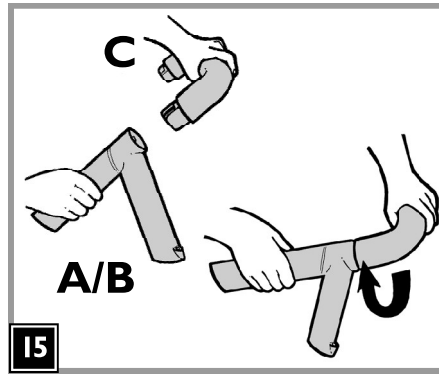
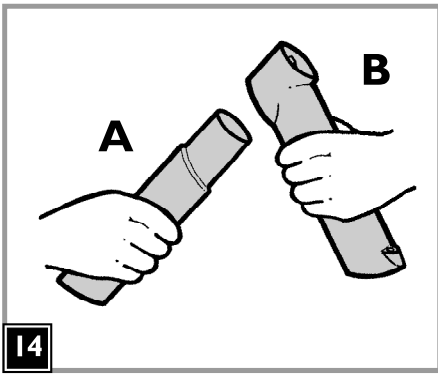

VEHICLE FEATURES AND INSTRUCTIONS FOR USE

CARACTERÍSTICAS Y USO DEL VEHÍCULO

CARACTÉRISTIQUES ET UTILISATION DU VEHICULE

29

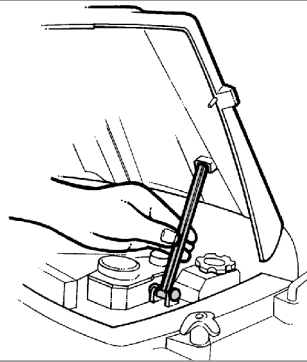

30

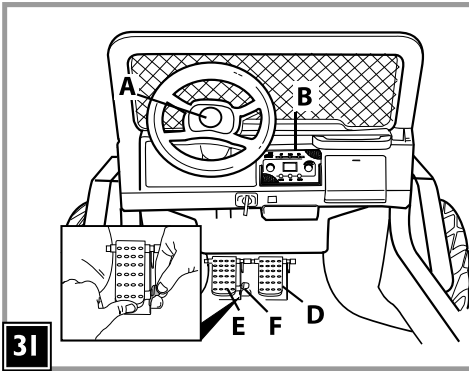
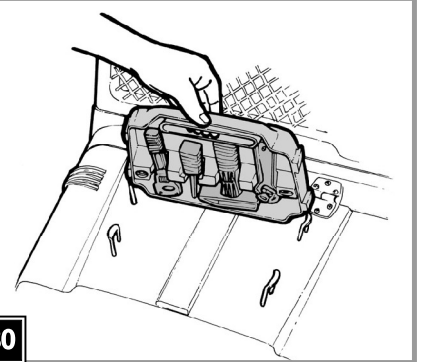

31

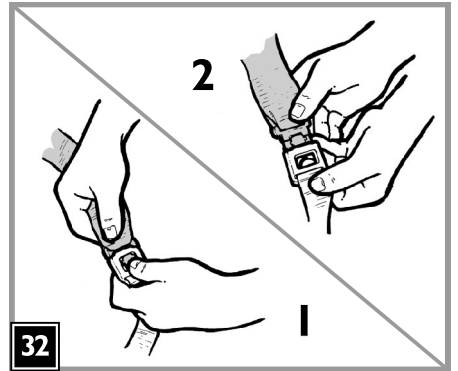
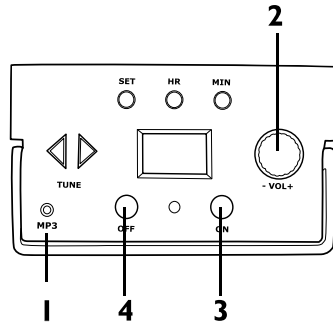

32

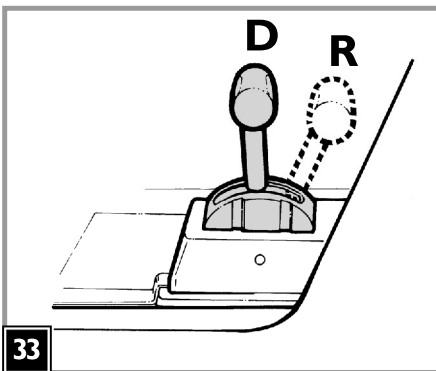

33

PARENTAL SPEED CONTROL
CONTRÔLE PARENTAL DE LA VITESSE
CONTROL DE VELOCIDAD PATERNO

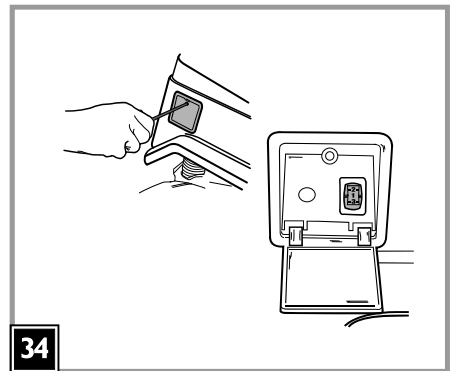

34

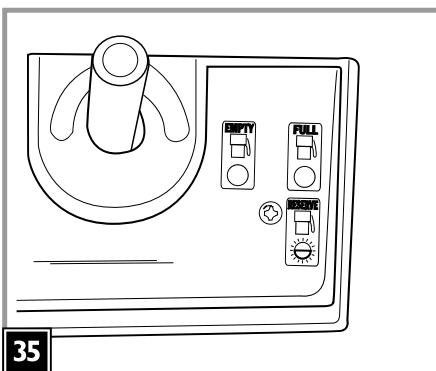

35

REGULATING REAR BRAKE
RÉGLAGE FREIN ARRIÈRE
REGULACIÓN DEL FRENO POSTERIOR

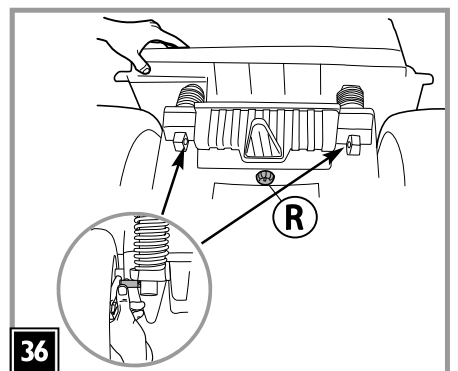

36

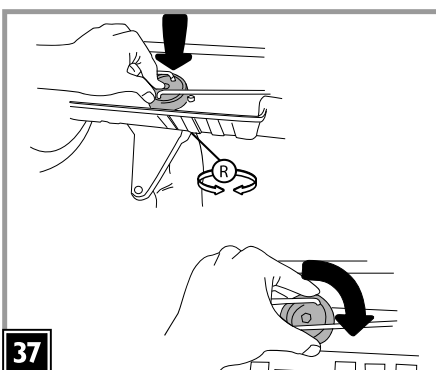

37

REPLACING THE BATTERY
CAMBIO DE LA BATERÍA
REPLACEMENT DE LA BATTERIE

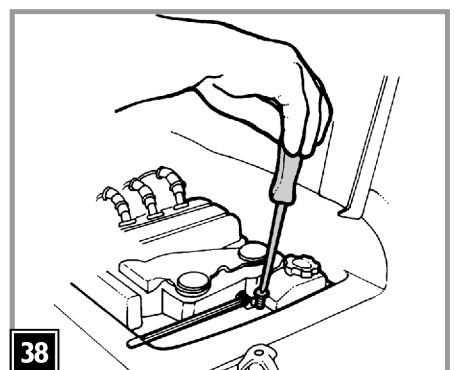

38

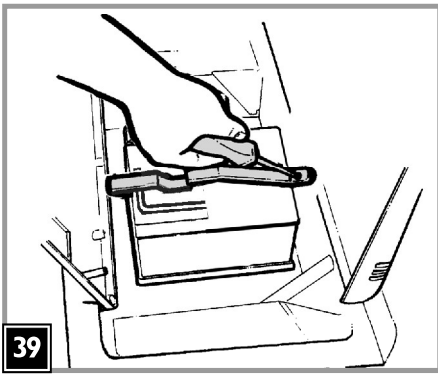

39

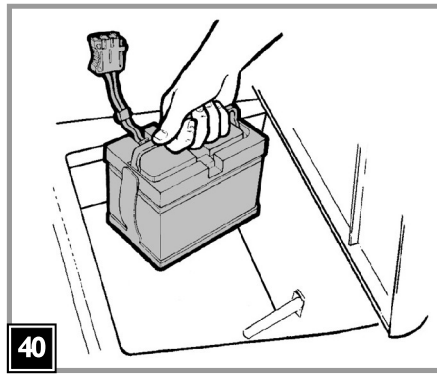

40

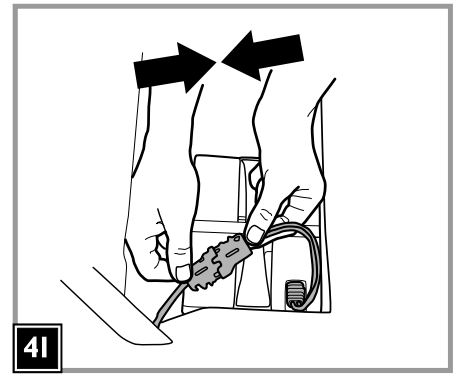

41

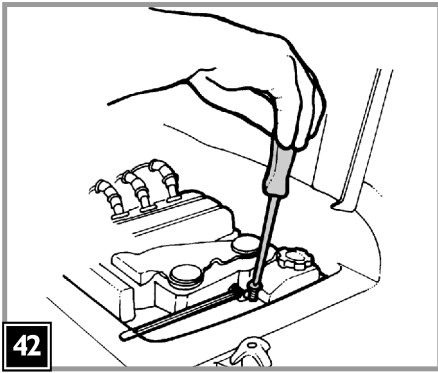

42

BATTERY CHARGING
CARGA DE LA BATERÍA
CHARGE DE LA BATTERIE

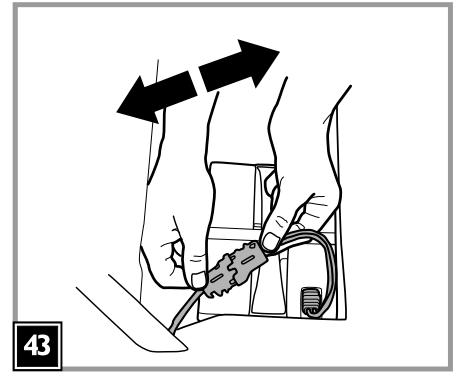

43

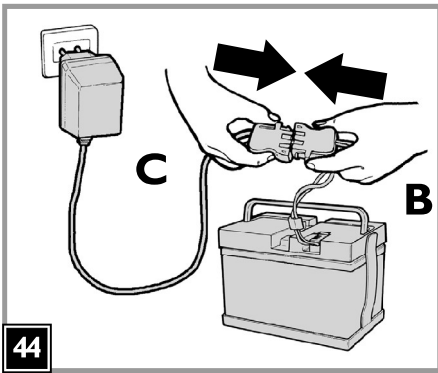

44

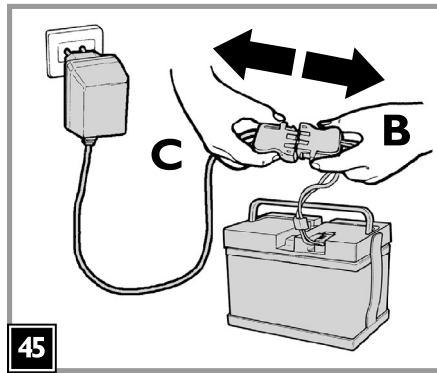

45

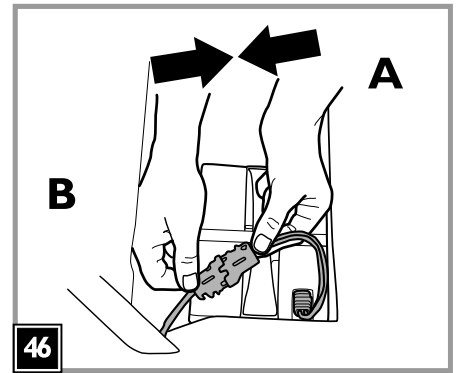

46

ELECTRICAL DIAGRAM DIAGRAMA ELÉCTRICO DIAGRAMME ÉLECTRIQUE GAUCHO SUPERPOWER cod.IGMC0010US

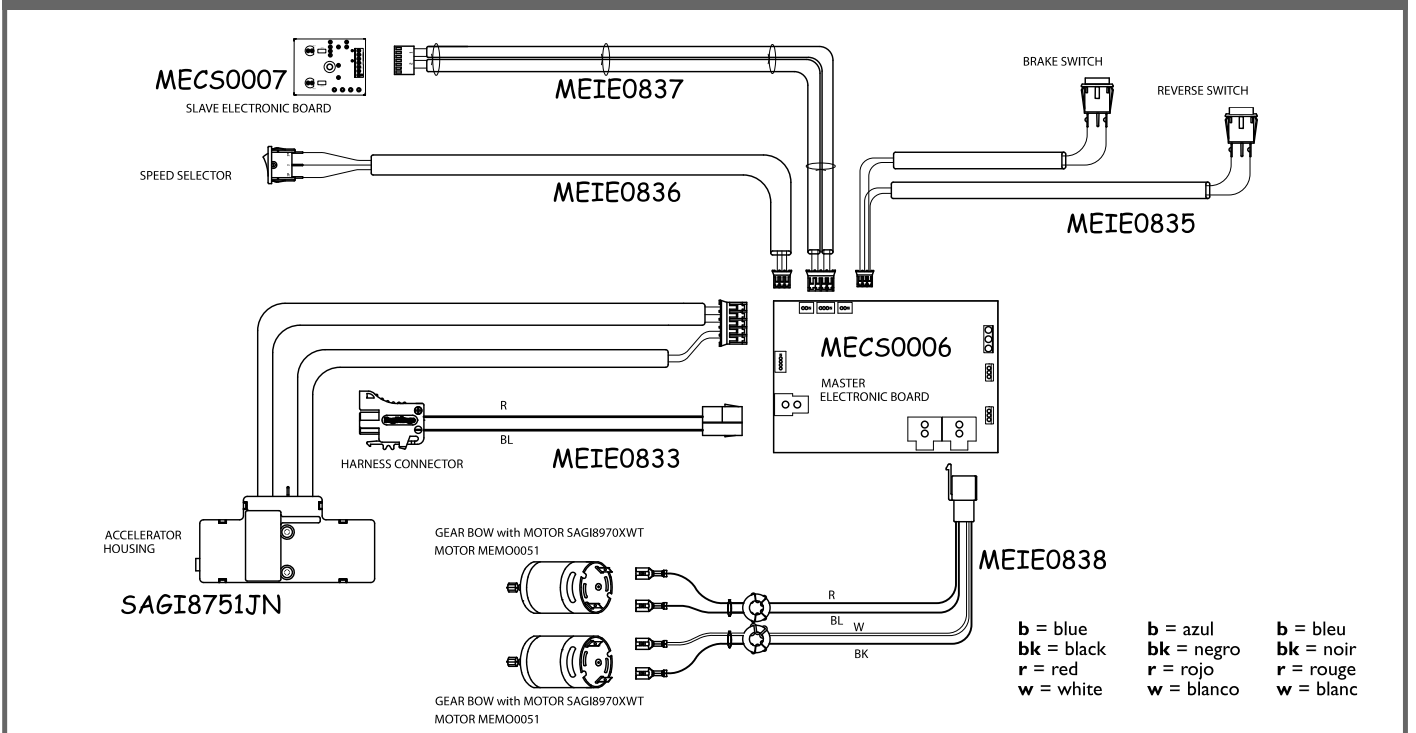

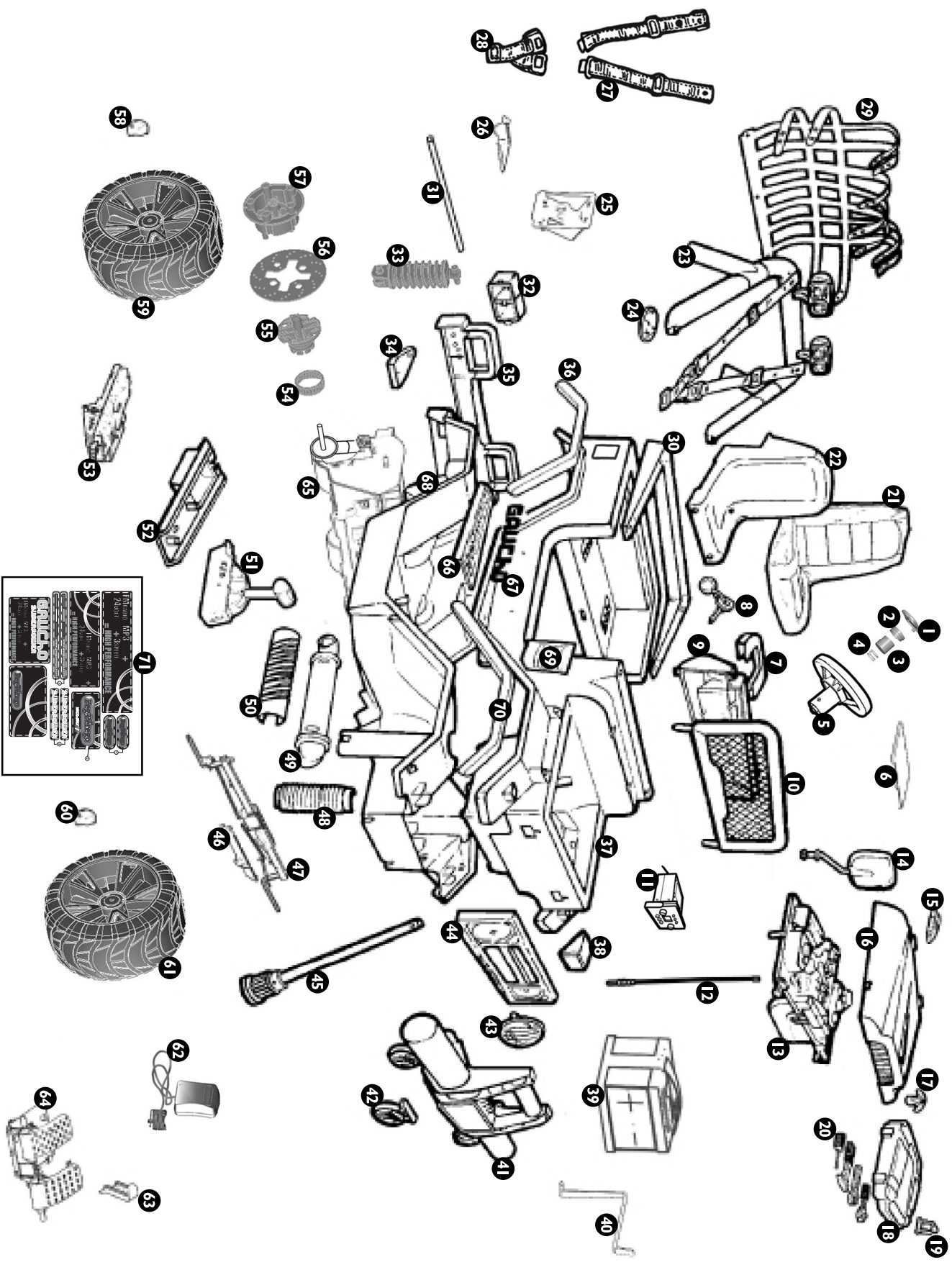

- 1 SPST91922N
- 2 SPST9193Y
- 3 SAGI91922NY
- 4 MIM00151
- 5 ASSG10217N/GP
- 6 SPST8767N
- 7 SPST04522N
- 8 SAGI01622N
- 9 SAGI04451J/GP
- 10 SAGI3822K/GP
- 11 MEVA0050
- 12 SPST8335N
- 13 SAGI3029GR
- 14 SAGI0127DM
- 14sx SAGI0127SM
- 15 SAGI0054DN
- 15sx ASSG10054SN
- 16 ASSG10122N/1
- 17 ASSG10024GP
- 18 ASSG10118GPGR
- 19 SPST8210N
- 20 SAGI0183GR
- 21 CCGAUC00-4153
- 22 SAGI0321N
- 23 ASSG1043K/GP
- 24 SPST87562N
- 25 SPST87562N
- 26 SPST8750N
- 27 MUCI1012GRN
- 28 MUCI1009GR
- 29 SPST8967N
- 30 SPST3508N
- 31 SCFH0285Z
- 32 SPST3055A /RE
- 32dx SAGI8045DNGR
- 33 SAGI8045SNGR
- 33dx SAGI8045SNGR
- 34 SPST3522N
- 35 SAGI01518K/GP
- 36 SAGI3824DN
- 36dx SPST3824SN
- 37 SPST0315KN
- 38 ASSG10053A
- 39 IAKB001US
- 40 SOPH0054L30
- 41 SAGI263GPA
- 42 ASSG10135GPA
- 43 SPST10132
- 44 SAGI3821JM
- 45 SAGI0283L30
- 46 SPST8741N
- 47 SAGI8744KN
- 48 SPST3511R
- 49 SAGI3827DM
- 49dx SPST3827SM
- 50 SAGI3522DG
- 50dx SPST3522DG
- 51 SAGI8808KN/GP
- 52 SPST3546N
- 53 SAGI8751JN
- 54 MIMV0035
- 55 SPST9143GL
- 56 SONNF0050Z
- 57 SPST8936GL
- 58 SPST8812N
- 59 SAGI8878XDMN
- 59dx SAGI8878XDMN
- 60 SPST8812N
- 61dx SAGI8878XDMN
- 61 SAGI8878XDMN
- 62 ICKB00111
- 63 SPST8768R
- 64 SAGI87621NR
- 65 SAGI3510KKN
- 66 SAGI3507DGP
- 66dx SPST3507DGP
- 67 SPST3507SGP
- 68 SPST3053M
- 69 SAGI3833DM
- 69dx SPST3833SM
- 70 SAGI3823DM
- 70dx SPST3823SM
- 71 MMEV0720

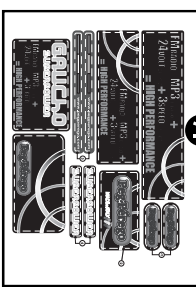

PEG PEREGO® thanks you for choosing this product. For more than 60 years, PEG PEREGO have been taking children for an outing: first with its famous baby carriages and strollers, later with its pedal and battery operated toy vehicles.

Discover our complete range of products, news and other information about the Peg Perego world on our web site www.pegperego.com

IMPORTANT INFORMATION

- Read this instruction manual carefully to learn the use of the vehicle and to teach your child safe and enjoyable driving. Please keep this manual (with your original sales receipt) for use as a reference in the future.
- **DO NOT RETURN YOUR VEHICLE TO THE STORE. This product cannot be returned for a refund after it has been used. If you have ANY questions, need replacement parts or need assistance, call us toll-free; U.S.A. , call 1-800-728-2108 / CANADA, call 1-800-661-5050**
- This product meets and/or exceeds all ASTM (American Society for Testing and Materials) TOY SAFETY STANDARDS, including F 963, Consumer Toy Safety Specifications as well as C.R.C, c.931, the Canadian Hazardous Products (Toys) Regulations.
- Tools needed for assembly: medium phillips screwdriver and pliers.
- Your new vehicle is partially pre-assembled. It will require adult assembly. Please set aside at 45 minutes for assembly.
- Before the vehicle is used for the first time, charge the battery for 18 hours to initiate it. Failure to do this can result in permanent battery damage.
- Use only with the included Peg Perego 24 Volt lead-acid, rechargeable battery and a Peg Perego 24 Volt Charger (both included).
- Requires 2 "AA" batteries (not included) for operation of radio/clock:

• Year 3+

• Weight capacity 150 lbs

- Do not exceed the maximum total weight capacity of 150 lbs (68 Kg).

Contents:

- 1 Gaucho Superpower ride-in vehicle -- partially assembled
- 1 Rechargeable 24V 12Ah sealed lead-acid battery
- 1 Charger 24V
- two 440 W motors -- pre installed
- 1 FM radio with mp3 input (connection cord not included) -- pre installed
- assembly hardware
- parts to be assembled
- decals
- Speed in 1st gear 2,7 MPH - 4,5 Km/h
- Speed in 2nd gear 4,5 MPH - 7,2 Km/h
- Speed in 3rd gear 6,2 MPH - 10 Km/h
- Speed in reverse gear 4,5 MPH - 7,2 Km/h
- For safety, this vehicle has been pre-set so it will only operate in LOW speed. See step 34 to remove the HIGH speed lock-out.
- To prevent damaging the motor and gears, teach your child to stop the vehicle before switching directions.
- Use this vehicle ONLY outdoors. Most interior flooring can be damaged by riding this vehicle indoors. Peg Perego will not be responsible for damage to the floor if the vehicle is used indoors.
- Peg Perego reserves the right to modify or change its products. Price, literature, manufacturing processes or locations or any combination of the above mentioned entities may change at any time for any reason without notice with impunity.

⚠ CAUTION:

ELECTRIC VEHICLE NOT RECOMMENDED FOR CHILDREN UNDER 3 YEARS OF AGE. AS WITH ALL ELECTRIC PRODUCTS, PRECAUTIONS SHOULD BE OBSERVED DURING HANDLING AND USE TO PREVENT ELECTRIC SHOCK. RECHARGER INCLUDED. 120 VOLTS, 60Hz, 33W INPUT, 24 VOLTS (DC) OUTPUT.

⚠ CAUTION:

Only adults should recharge batteries never children.

Never allow children to handle batteries.

Only use the batteries specified by the manufacturer. Only use the charger specified by the manufacturer.

Do not mix old and new batteries.

Do not mix alkaline, standard (carbon-zinc), or rechargeable (nickel-cadmium) batteries.

CHARGING THE BATTERY

- Charge the batteries no longer than 24 hours, following the instructions enclosed with the battery charger.
- Charge the battery, as the vehicle shows low power, in this way you will avoid damage to the battery.
- If you don't use your vehicle for a long period of time unplug the battery from the main wire harness of the vehicle. Remember to charge the battery at least every three months.
- Never charge the battery upside down.
- Do not forget batteries during charging! Check them periodically.
- Never use a replacement recharger or batteries unless they are approved by PEG PEREGO.
- Batteries are sealed and maintenance free.
- Battery polarity must be observed when connecting battery to wiring.

⚠ WARNING:

- BATTERIES CONTAIN TOXIC AND CORROSIVE SUBSTANCES. DO NOT TAMPER WITH THEM.
- Batteries contain an acid-based electrolyte.
- Do not make direct contact between battery terminals, as this can cause an explosion or fire.
- Charging produces explosive gases. Charge batteries in a well ventilated area away from sources of heat and flammable materials.
- Exhausted batteries are to be removed from the vehicle.
- Do not place the batteries near clothing to avoid damage.

IF A LEAK DEVELOPS

Shield your eyes. Avoid direct contact with the electrolyte, protect your hands.

Place battery in a plastic bag and follow directions listed below.

IF ELECTROLYTE COMES IN CONTACT WITH SKIN OR CLOTHING

Flush with cool water for at least 15 minutes.

See a physician at once.

IF ELECTROLYTE IS INJECTED

Give tap water, milk of magnesia or egg whites at once.

Do not induce vomiting.

See a physician at once.

DISPOSAL OF BATTERIES

Help protect the environment!

Do not throw used batteries in your regular, household trash.

Dispose of the old batteries in an approved dumping station; contact your local environmental protection agency office for further information.



⚠ CAUTION AA BATTERIES

The insertion of batteries must only be carried out or supervised by adults. Do not let children play with the batteries.

- The batteries should be replaced by an adult.
- Use only the type of battery specified by the manufacturer.
- Respect the polarity +/-
- Do not allow the batteries to be in contact with metal parts (risk of fire or explosion).
- Always remove the batteries if the toy is not in use for a long period.
- Never attempt to charge batteries that are not rechargeable.
- Remove dead batteries from the toy.
- Dispose of dead batteries into appropriate containers provided for their recycling.



INITIAL BATTERY CHARGE

!• Remove battery and charger from packaging. Connect battery charger to a 120vac wall recepticle. Connect battery charger to battery.

ASSEMBLY INSTRUCTIONS

CAUTION:

ADULT ASSEMBLY REQUIRED.

USE CARE WHEN UNPACKING AS COMPONENTS TO BE ASSEMBLED MAY POSE A SMALL PARTS/SHARP EDGE HAZARD.

BATTERY ALREADY INSTALLED IN VEHICLE.

- 1 • Place from bumper on body and tighten four screws as shown in the drawing.
- 2 • Place rear bumper on body.
- 3 • Tighten three screws as shown in the drawing.
- 4 • Assemble the two parts of the steering wheel.
- 5 • Place the horn in the steering wheel's central hole, following the instructions in its packaging.
- 6 • Insert the steering wheel on the steering wheel column.
- 7 • Align steering wheel column holes with steering wheel: nut fits into hexagon hole, bolt into round hole.
- 8 • Insert the windscreen.
- 9 • Secure it by means of the two screws.
- 10 • Fit the removable seat cover as shown in the figure.
- 11 • Hook the front elastic bands.
- 12 • Position the other two elastic bands.
- 13 • Place seat on body. Adjust seat position. Secure it with washer and thumb nut.
- 14 • Join A to part B of the Roll-Bar.
- 15 • Join A-B to the upper section of the Roll-Bar C, insert and rotate to secure.
- 16 • Insert the 2 plates in the slots at the base of the Roll-Bar and hold them in place. Secure the plates and the Roll-Bar with the 2 screws provided (detail A).
- 17 • Insert the end of the safety belt in the slot situated centrally in the bottom of the seat, as shown in the figure.
- 18 • Screw the net down to the body.
- 19 • Snap it around the roll-bar as shown in the drawing.
- 20 • Insert the rearview mirrors in the direction shown by the arrow.
- 21 • Place the 2 plastic signs, pressing down as you do so.
- 22 • Insert the antenna, pressing down as you do so, into its appropriate housing, situated on the right rear mudguard.
- 23 • Remove the radio from its packaging. Unscrew the cover from the battery chamber. Insert two 1.5 Volt AA batteries (not supplied with the vehicle) into the compartment, taking care to position the positive and negative poles correctly. Close the battery compartment cover and screw into place.
- 24 • Insert the wire from the antenna and the radio into their appropriate housing on the dashboard, making sure to place them the right way up, as shown in the figure.
- 25/6 • Open the hood. Remove the two screws from the simulated engine. Remove the simulated engine. Proceed as follows:
 - Remove the battery from the packaging;
 - unscrew the battery block screw;
 - position the battery;
 - lock it down using the special battery block.
- 27 • Plug battery terminal A into vehicle wiring terminal B.
- 28 • Lower the imitation motor and screw it down again. Close the hood, securing it in place with the 2 hooks. The vehicle is now ready for use.

FEATURES AND INSTRUCTIONS FOR USE

- 29 • Hood support shaft.
- 30 • Below the box you can find four removable toy tools. To remove the box, pull out and unfasten the four couplings.
- 31 • A: HORN. Push the yellow button the horn will sound.
B: FM RADIO: a real removable car radio that works independently. Press button 3 to turn it on. Press button 4 to turn it off. Use the triangular buttons to change the frequency with automatic tuning. The station will not be memorized when the radio is turned off. Use knob 2 to adjust the volume. To adjust the time, hold down the SET button and push the HR and MIN buttons as appropriate.
The AUX (I) socket on the radio can be used for connecting MP3 devices.
D: ACCELERATOR PEDAL. To activate the vehicle's driving wheels, press the accelerator pedal. N.B.: The speed of the vehicle increases when the accelerator pedal is progressively pressed.
E: BRAKE PEDAL. The disk brakes are activated by pressing down on the brake pedal which will stop the vehicle.
F: PARKING BRAKE. The parking brake is activated by pressing the brake pedal and locking it in place with a special latch, see figure. To lock, lift the latch located on the vehicle base all the way up and insert the pedal housing in it.
- 32 • To unfasten the safety belts: 1 push towards the middle and simultaneously press the button; 2 detach the buckle.
- 33 • GEAR SHIFT LEVERS: GEAR SHIFT: D drive, R reverse.
- 34 • SECOND SPEED: SPEED REGULATION The vehicle is equipped with 3 speed adjustments:
 - 1st speed 2,7 MPH - 4,5 Km/h
 - 2nd speed 4,5 MPH - 7,2 Km/h
 - 3rd speed 6,2 MPH - 10 Km/hThe speed selector is located inside the fuel cap (screwed shut), on the right rear side of the vehicle.
- 35 • DASHBOARD READING.
There are 2 lights which indicate the battery charge status on the dashboard:
GREEN LIGHT: indicates that the battery is charged and the vehicle may be used.
BLINKING GREEN LIGHT: indicates that the battery is on back up and recharging the vehicle is recommended.
RED LIGHT: indicates that the battery is flat and recharging is necessary to prevent jeopardizing functionality. As soon as the red light comes on the vehicle turns off. It is possible to reactivate the vehicle which has 100 m of battery life to bring it to be recharged.
N.B. • At the time of ignition, both lights are activated for check-in.
• If the red light also comes on during correct driving function (green light), it is because the safety system which indicates that electrical parts are overheating has been activated. In this case, the child must momentarily release the accelerator pedal.

REGULATING REAR BRAKE

Make sure that the vehicle is off before proceeding.

If rear brake pads are worn, regulation shall be carried out as follows:

- 36 • Press the tabs and pull out the 2 pins at the bottom of the engine, as shown in the figure.
- 37 • Keep the engine bottom open and unscrew the red knob (marked "R" in figure 36), then hold still the brake regulation ring and turn it clockwise by half a notch. Next, tighten the red knob, close the engine bottom and reinsert the 2 rear pins, ensuring that they are in the same position as when they were removed.

BATTERY REPLACEMENT

WARNING:

WARNING: BATTERY CHARGING AND ANY OTHER OPERATION ON THE ELECTRICAL SYSTEM MUST BE CARRIED OUT BY ADULTS ONLY.

THE BATTERY CAN ALSO BE CHARGED WITHOUT REMOVING IT FROM THE VEHICLE.

38 • Open the hood. Remove the two screws from the simulated engine. Remove the simulated engine.

39 • Unscrew and remove the battery fastener.

40 • Replace the battery. Replace the battery fastener.

41 • Connect the two plugs.

42 • Replace simulated engine in vehicle and secure with screw.

BATTERY RECHARGE

43 • Disconnect the electrical unit plug A from the battery plug B by pressing at the sides.

44 • Insert the battery charger plug into a household outlet following the enclosed instructions. Connect plug B to battery charger plug C

45 • Once the battery has been recharged, unplug the battery charger from the wall outlet, then disconnect terminals C and B.

46 • Connect terminal B and A till you hear the final click. Once recharging is complete, don't forget to close the simulated motor with the screw.

RULES FOR SAFETY DRIVING

For the safety of the child, before starting up the vehicle read and carefully follow the following instructions.

- Teach the child how to use the vehicle properly for safe and enjoyable driving.
- Before starting, check that there are no people or objects obstructing the vehicle's path.
- Drive with hands on the handlebars/steering wheel and always watch the road ahead.
- Teach your child to step on the brake pedal to stop quickly to avoid collisions.

Parential SPEED CONTROL

It is recommended that beginners only use 1st gear until they become familiar with the safe operation of the vehicle. To access faster speeds, parents can follow instruction # 34.

WARNING!

- Check wheel/axle nuts periodically to ensure they remain tight
- If the vehicle becomes overloaded as can happen on soft surfaces such as sand or mud, or steep inclines, the overload switch will temporarily disconnect the power. If this happens, avoid driving on these surfaces.
- If the overload disconnect occurs while climbing a steep incline, the vehicle can roll backwards; To control the speed of decent or to stop, instruct your child to remove their foot from the accelerator and step on the brake pedal.
- On 12-Volt and 24 Volt vehicles: in 1st gear, the drive wheels have a differential effect like your car; on smooth terrain, with a single child on board, the drive wheels can turn at different speeds; this is necessary for turning and operating on slippery surfaces where one wheel will spin while the other wheel continues to achieve traction. This will cause the vehicle to slow down momentarily.

LONGER DRIVING TIME: Purchase a spare battery to avoid Down Time when your initial battery requires recharging.

VEHICLE MAINTENANCE AND SAFETY

This product meets and/or exceeds all ASTM (American Society for Testing and Materials) TOY SAFETY STANDARDS, including F 963, Consumer Toy Safety Specification.

This vehicle is not intended for use on streets, around traffic or parked cars.

MAINTENANCE AND CARE

- Regularly check the conditions of the vehicle, particularly the electrical system, the plug connections, the covering caps and the charger. In case of fault, do not try to use the vehicle and the charger. For repair use only original PEG PEREGO's spare parts.
- PEG PEREGO assumes no liability if the electrical system is tampered with.
- Do not leave vehicle or batteries near sources of heat such as radiators, stoves, fireplaces, etc.
- Protect vehicle from water, rain, snow, etc.
- When operating in overload conditions, such as soft deep sand, mud or rough uneven terrain, the overload circuit breaker will automatically disconnect the power. After 10 or more seconds, the circuit breaker will automatically reset, however you must eliminate overload conditions to resume normal driving.
- Periodically lubricate (with a light weight oil) moving parts, such as wheel bearings, steering linkages, where they rotate or touch one another.
- The vehicle's surfaces can be cleaned with a dampcloth. Do not use abrasive cleaners. The cleaning must be carried out by adults only.
- Never disassemble the vehicle mechanisms or motor unless authorized by PEG PEREGO.

SAFETY

WARNING:

- To reduce the risk of injury, adult supervision is required. Never use in roadways, near motor vehicles, on or near steep inclines or steps, swimming pools or other bodies of water; always wear shoes, and never allow more than 2 riders.
- Surfaces that are appropriate for safe use: grass, gravel, hard surfaces, slopes moderate.
- Not suitable for children under the age of 36 months. The small pieces could be swallowed or inhaled.
- Never use the vehicle on steep slopes or near steps or stairs. This vehicle is not suitable for use on public highways.
- Children should always wear shoes when riding in or driving a riding vehicle.
- Do not allow children to place their hands, feet or any part of their body, clothing or other articles near the moving parts while vehicle is in operation.
- Do not allow the electrical components, motors, wiring, switches of your motorized vehicle to become wet and never wash it with a hose.
- Never use gasoline or other flammable substances near the vehicle.
- Please note that the seat belts are designed for play use only and DO NOT provide any protection.

PROBLEMS?

IF THE VEHICLE DOES NOT OPERATE?

- **When operating in overload conditions, such as running the vehicle against a fixed object, through soft deep sand or mud, or over rough or uneven terrain, the overload circuit breaker will automatically disconnect the power. After 10 or more seconds, the circuit breaker will automatically reset, however-you must eliminate overload conditions to resume normal driving.**
- Make sure that the battery is hooked up to the electrical unit.
- If the green LED does not come on after having properly carried out all the procedures:
 1. Check the circuit board connector found on the dashboard (START).
 2. Charge the batteries. If the problem persists after recharging, have the battery and battery charger checked by a service centre.
- If the vehicle does not move when the accelerator pedal is pressed remember to:
 1. Make sure that the brake pedal is not activated.
 2. Check that the accelerator pedal's steel wire is intact and that it is running properly.
- If the vehicle does not brake when the brake pedal is pressed remember to:
 1. Regulate the brake pads.
 2. Check that the brake pedal's steel wire is intact and that it is running properly.
- Contact the Service Centre for any problem related to changing gears.
- The vehicle should never go forward by itself. If the contrary occurs, contact a service centre.
- If the red LED comes on when the vehicle is started contact a service centre.
- If it is difficult to move the steering wheel, we recommend greasing the steering bar (located underneath the vehicle) and the wheel joints with grease or light oils.
- If the vehicle does not work in spite of all verifications, contact a service centre.

IF THERE IS NO POWER?

- Fully recharge the battery. If the problem persists, check with an Authorized PEG PEREGO Service Center.

CUSTOMER SERVICE

For your convenience, PEG PEREGO offers after-sales service, directly or through a network of authorized service centers for repairs or replacement parts.

If you have any questions about your Peg Perego vehicle, please call our toll-free service lines at;

U.S.A , call 1-800-728-2108

CANADA, call 1-800-661-5050

Trained customer service representatives are available to take your call in English or Spanish.

This document was created with Win2PDF available at <http://www.win2pdf.com>.
The unregistered version of Win2PDF is for evaluation or non-commercial use only.
This page will not be added after purchasing Win2PDF.