

This Owner's Manual is provided and hosted by [Appliance Factory Parts](#).



Proteam LV100 Owner's Manual

[Shop genuine replacement parts for Proteam LV100](#)



[Find Your Proteam Vacuum Cleaner Parts - Select From 40 Models](#)

----- Manual continues below -----

LINEVACER PARTS

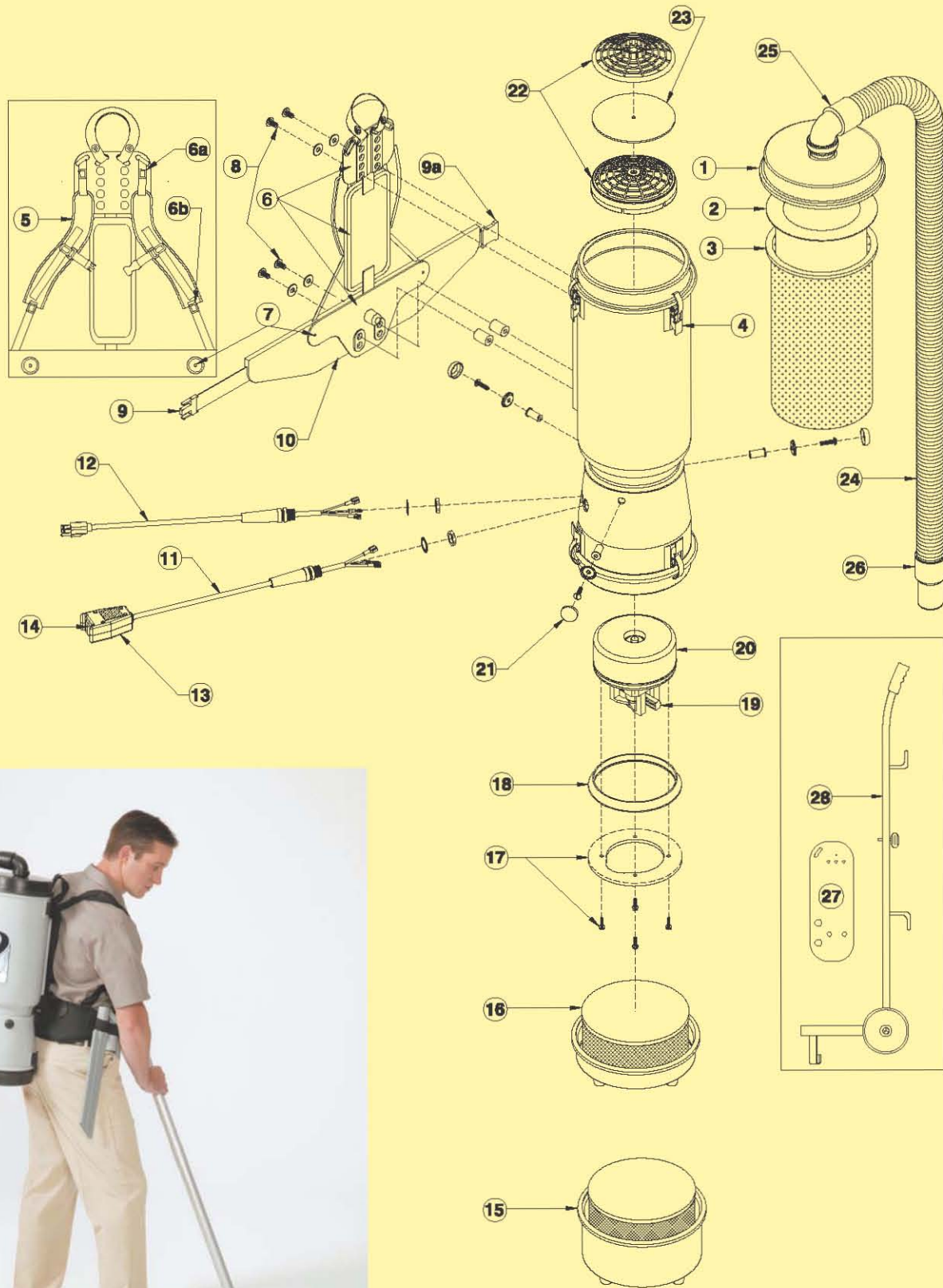

Electrical cord not shown

Order #	LineVacer	Quantity
1	100284 Latch Cap w/Cuff (Black)	1 each
2	100291 564 Sq. In. Intercept Micro Filter	10/pack
3	100565 Micro Cloth Filter	1 each
4	100286 Top or Bottom Cap Latch Set: 3 Latches and 3 Locks w/6 Fastening Rivets and 6 Washers	1 set
5	100356 Shoulder Straps	1 set
6	103257 Backplate (2 Pieces) w/Center Pad	1 set
6a	100358 Shoulder Strap Plastic Adjustment (Top)	1 each
6b	100357 Shoulder Strap Plastic Adjustment (Bottom)	1 each
7	100375 Barrel Nut Connection Set for Backplate (Replacement)	1 set
8	100374 Backplate (Black) Connection Set: 2 Upper and 2 Lower Bolts w/2 Lower Stand-Offs and 4 Lock Washers	1 set
9	100363 Waist Belt Keeper	1 each
9a	100364 Waist Belt Latch	1 each
10	100359 Waist Belt	1 each
	100354 Strap Assembly Complete (6, 6a, 6b, 10, 10a, 11)	1 set
	103166 2-Piece Backplate (Black) System Complete (5, 6, 6a, 6b, 7, 8, 9, 10, 10a, 11)	1 set
11	101610 Switch Cord Assembly Complete w/Switch and Box	1 set
	101714 Switch Cord w/Crimps	1 each
	101716 26" Switch Cord Assembly Complete w/Switch and Box	1 set
12	100641 Power Cord (18" 16/3) Assembly Complete w/Strain Relief	1 set
	100299 15' Cart power Supply Cord Complete w/Crimps (100279, 100282)	1 set
13	101472 Switch Box w/Velcro and Screws	1 set
	101718 Switch Box w/Belt Clip (for cart) (100279, 100282)	1 set
14	100743 Double Pole On/Off Switch	1 each
15	100462 ULPA Filter Assembly Complete w/Bottom Cap (100280, 100282)	1 set
16	100295 HEPA Filter Assembly Complete w/Bottom Cap (100277, 100279)	1 set
17	100335 Motor Compression Ring w/Connection Screws	1 set
	100378 Compression Ring Connection Screw Set: 4 Screws	1 set
18	100014 Tetraseal	1 each
19	100424 Carbon Brush Set for 928 Watt Motor	1 set
20	100422 928 Watt Motor/Fan (120 V) w/Crimps	1 each
	100420 928 Watt Motor/Fan (220 V) w/Crimps	1 each
	100380 Motor Crimp Set: 5 female, 3 Male and a Ground Crimp Connector	1 set
	100379 Motor Ground Connection and Wire Clamp Set: Wire Clamp and Ground Crimp w/Connection Screws	1 set
21	100368 Motor Mounting System Set: 3 Well Nuts, 3 Bolts, 3 Washers and 3 Covers	1 set
22	100030 Dome Filter w/Foam Media	1 each
23	100343 Foam Filter media for Dome Filter	1 each
24	101176 Static-Dissipating Hose w/Cuffs (Black)	1 each
25	101929 Replacement Double Swivel Elbow Cuff (Black)	1 each
26	100636 Replacement Swivel Cuff (Black) 1.5"	1 each
27	100718 Cart Plate for Cart Assembly	1 each
28	100287 LineVacer Cart Assembly Complete	1 set
	101678 50' Extension Cord (Not Shown)	1 each