



1990-05	

# ASKO CYLINDA

Datum 1990-05 Date		HÖLJE MACH 1402, 1502			
Fig.	Antal Qty				Detalj nr
	1402	1502			Part No.
1	1	1			88 008 80
2	1	1			80 515 08
3	1	1			80 515 09
4	1	1			80 073 47
5	2	2			80 073 49
6	1	1			80 051 54-A0
7	2	2			80 521 74
8	2	2			80 052 86
9	1	1			80 097 22
10	2	2			80 527 90
11	2	2			80 073 60
12	Er	As	100		80 521 50

22



# ASKO CYLINDA

Datum <b>1990-05</b> Date		HÖLJE CASING 1402, 1502			
Fig.	Antal Qty		Detail nr		
	1402	1502	Part No.		
<b>38</b>	<b>Erf.-As</b>	<b>required</b>	<b>80 099 08</b>		
<b>39</b>	<b>5</b>	<b>5</b>	<b>89 003 27</b>		
<b>39a</b>	<b>13</b>	<b>13</b>	<b>89 003 52</b>		
<b>40</b>	<b>10</b>	<b>10</b>	<b>89 014 13</b>		
<b>41</b>	<b>1</b>	<b>1</b>	<b>80 053 42</b>		
<b>42</b>	<b>2</b>	<b>2</b>	<b>80 510 88</b>		
<b>43</b>	<b>3</b>	<b>3</b>	<b>89 013 33</b>		
<b>44</b>	<b>Erf</b>	<b>Erf</b>	<b>80 093 54</b>		
<b>45</b>	<b>1</b>	<b>1</b>	<b>80 515 12-</b>		
	<b>1</b>	<b>1</b>	<b>80 053 51-</b>		

9

1000000

22



# ASKO CYLINDA

Datum <b>1990-05</b> Date		LUCKA		DOOR	
		1402, 1502			
Fig.	Antal Qty				Detalj nr
	1402	1502			Part No.
1	1	1			80 522 43-0
1a	8	8			80 097 69
2	1	1			88 007 54
3	2	2			74 802 66
4	2	2			80 045 88
5	2	1			80 052 99
		1			80 500 03
6	1	1			80 053 28
7	1	1			80 514 83
8	1	1			80 510 77
9	1	1			80 053 33
10	1	1			80 089 98

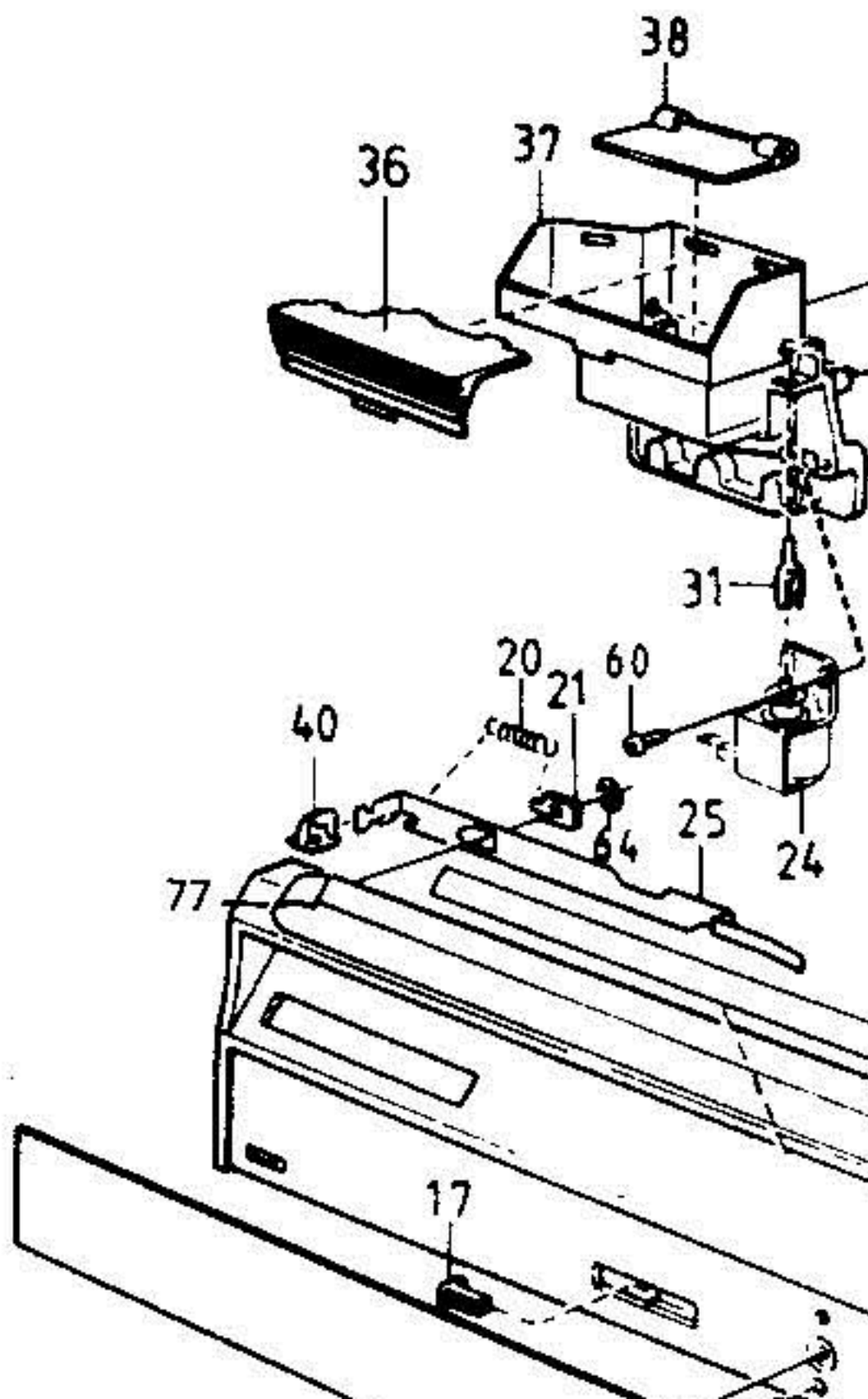

# ASKO CYLINDA

Datum		LUCKA		DOC
1990-05		1402, 1502		
Fig.	Antal Qty			Detalj nr
	1402	1502		Part No.
36	1	1		80 530 18
	1	1		80 521 78-33
37	1	1		80 061 64
38	1	1		80 056 71
39	1	1		80 070 76-
40	1	1		80 077 90-
41	1	1		80 079 36
42	1	1		80 085 01
43	1	1		80 079 86
44	1			80 533 87
	1			80 534 38
	1			80 541 86

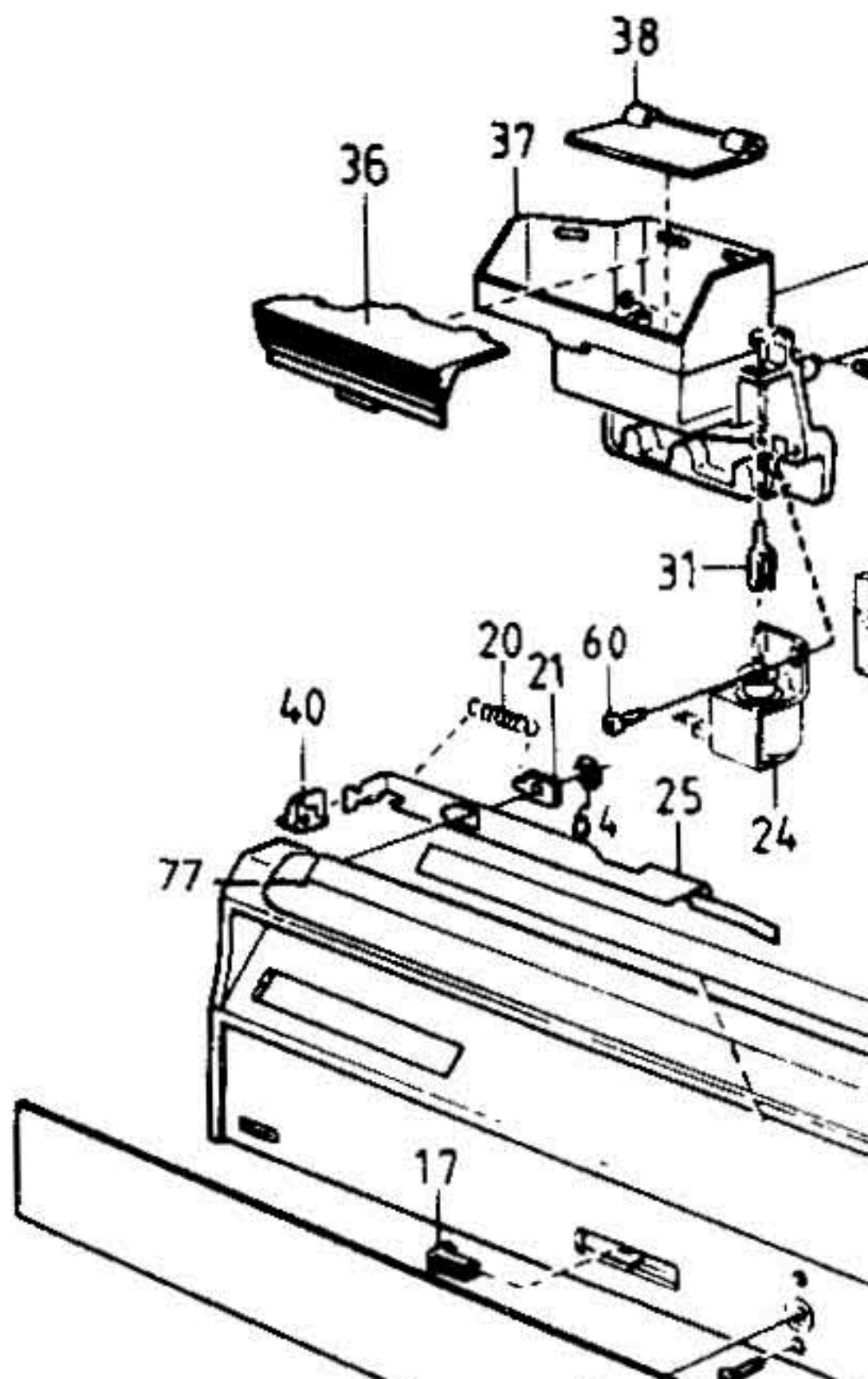

# ASKO CYLINDA

Datum		LUCKA		DOOR	
1990-05		1402, 1502			
Date					
Fig.	Antal Qty		Detalj nr		
	1402	1502	Part No.		
66	4	4	89 009 44		
67	2	2	89 009 44		
68	2	2	89 017 59		
69	2	2	73 820 87		
70	1	1	80 040 37		
71	1	1	88 007 64		
72	1	1	80 040 38		
73	1	1	80 024 05		
74	2	2	89 006 44		
75	1	1	89 015 32		
76	2	2	89 010 97		
77	1	1	80 541 84		
	1	1	80 538 14		

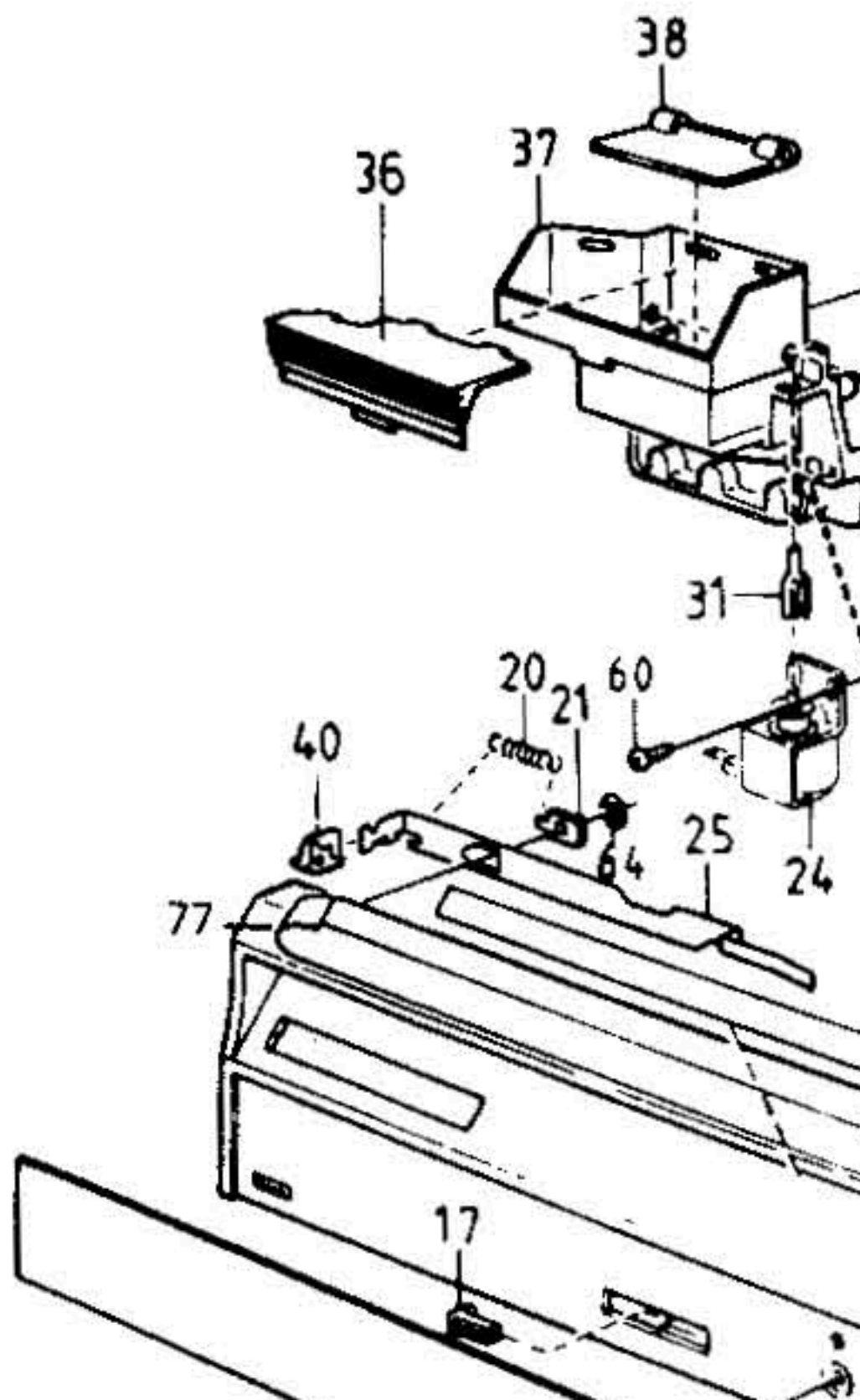

# ASKO CYLINDA

Datum <b>1990-05</b> Date		DISKSYSTEM				DI
		1402, 1502				
Fig.	Antai Qty				Detalj nr	
	1402	1502			Part No.	
1	1	1			80 058 72	
2	10	10			80 095 16	
3	1	1			80 050 71	
4	1	1			80 082 61	
5	1	1			80 520 87-33	
6	1	1			80 523 44	S
7	1	1			80523 45	S
8	2	2			80 520 79	S
9	2	2			80 520 80	S
10	2	2			80 521 08	I
11	2	2			80 520 95	I

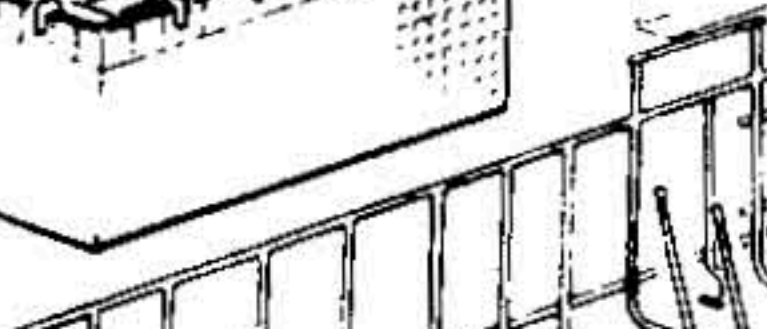
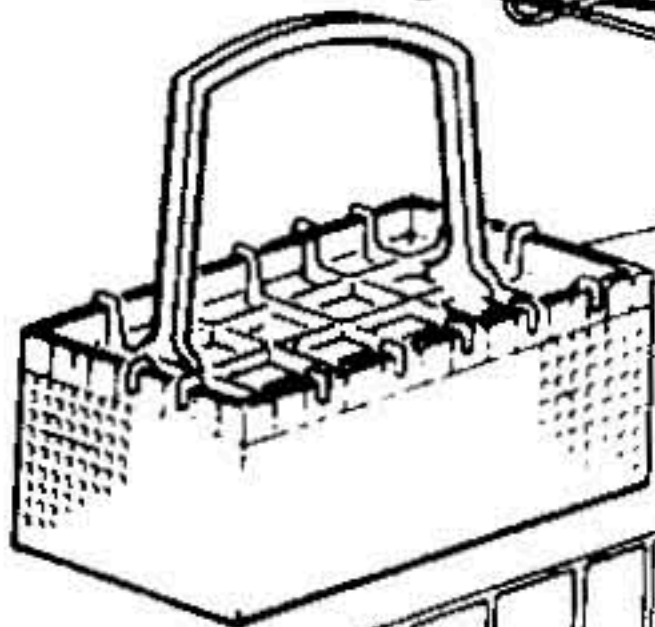
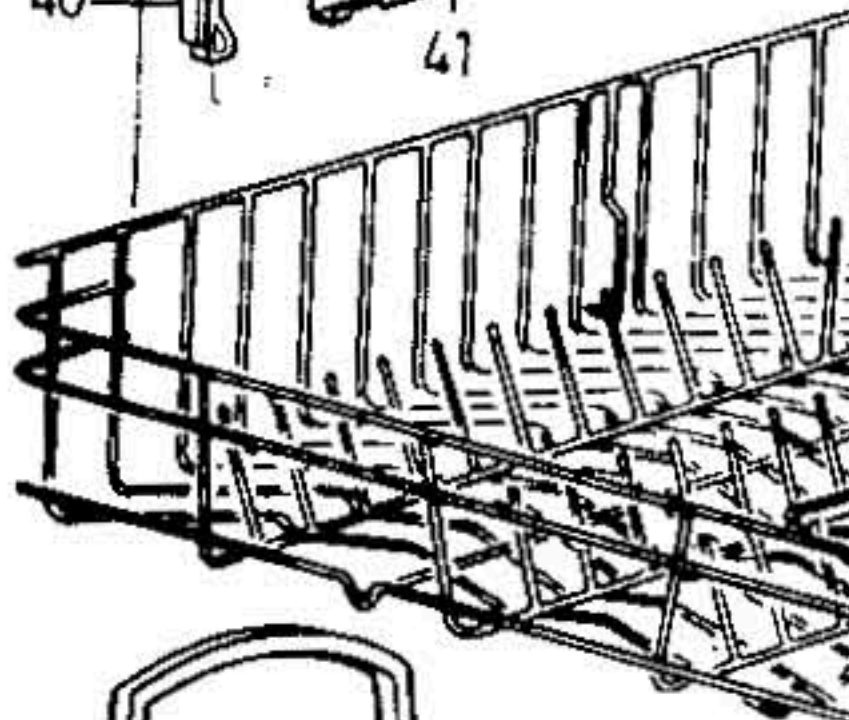
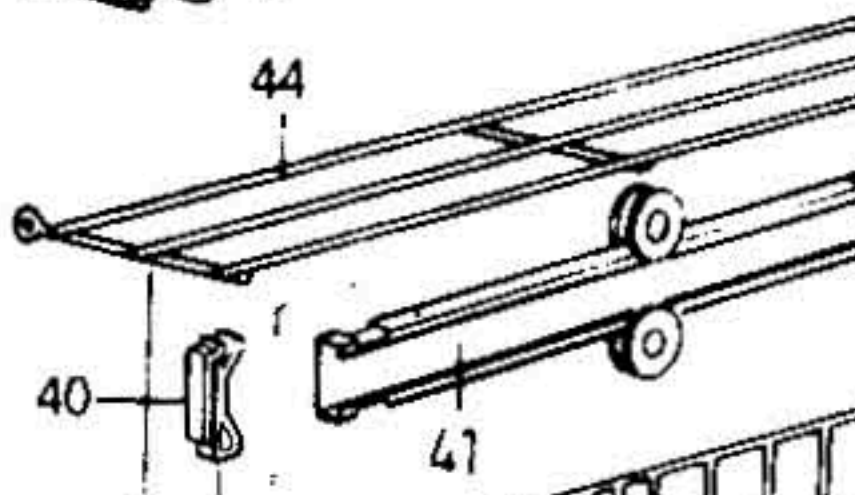
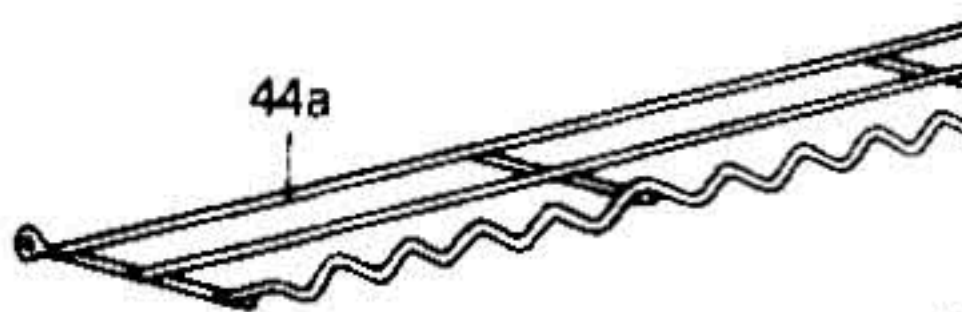

# ASKO CYLINDA

Datum		DISKSYSTEM			
1990-05		1402, 1502			
Fig.	Antal Qty				Detail nr
	1402	1502			Part No.
44	1	1			80 098 25
44A	1	1			80 537 98
45	1	1			80 053 01
46	1	1			80 038 89
47	1	1			80 040 75
49	1	1			89 006 43
48	1	1			80 094 69
50	1	1			80 521 59
51	5	5			89 012 42
52	3	3			89 000 26
53	1	1			80 072 11

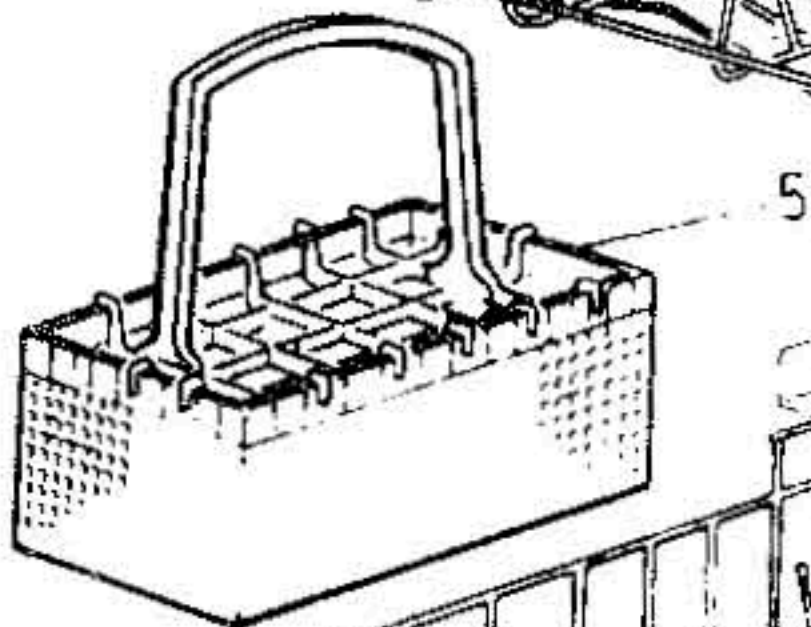
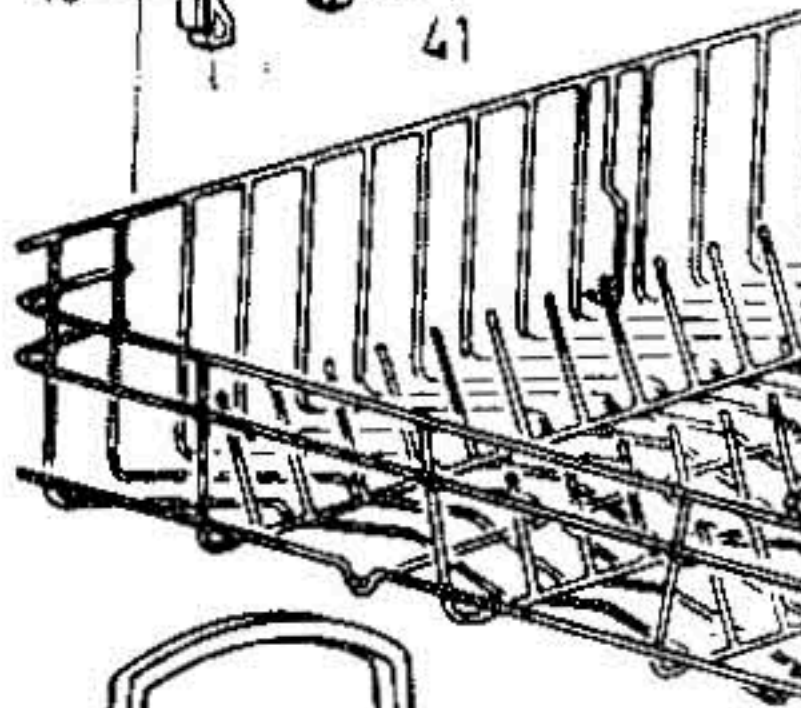
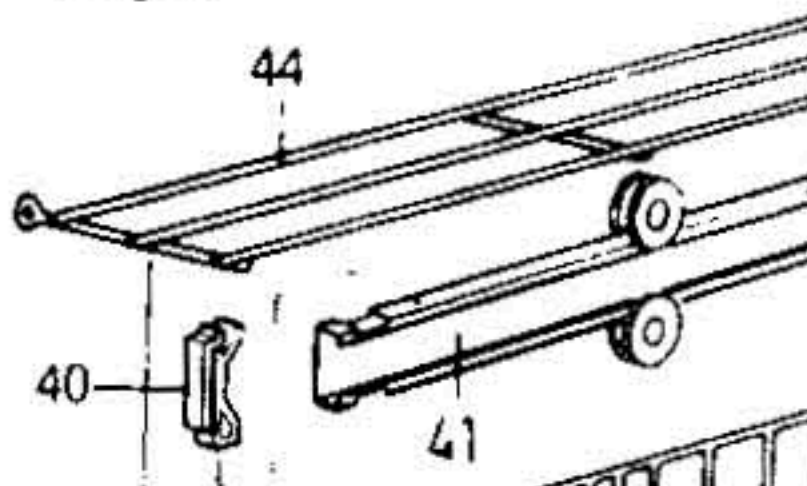
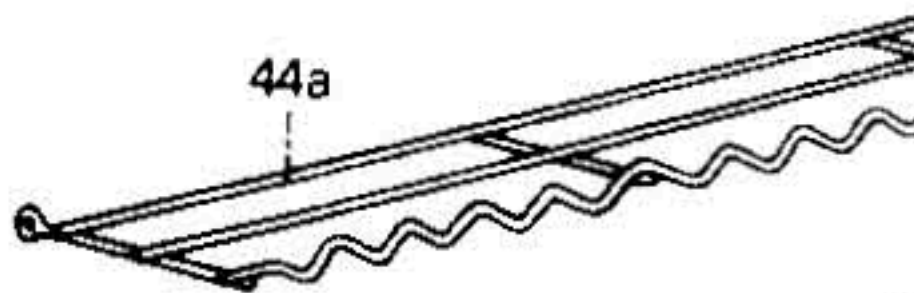

# ASKO CYLINDA

Datum <b>1990-05</b> Date		ELEKTRISK UTRUST <b>1402, 1502</b>			
Fig.	Antal Qty				Detail nr Part No.
	1402	1502			
1	1	1			80 512 70
2	1				80 517 99
3	1	1			80 515 20
4	2	2			80 508 93
5	1				80 509 14
		1			80 509 15
6	1				80 508 20
		1			80 532 59-33
7	1				80 535 93
8	1				80 532 57
9	1				80 053 88
10	2	2			89 010 97



5

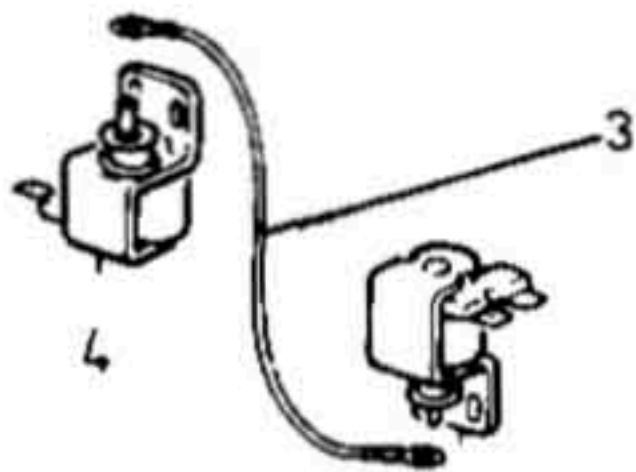

4

4

3



6

# ASKO CYLINDA

Datum 1990-05 Date		ELEKTRISK UTRU 1402, 1502			
Fig	Antal Qty				Detail nr
	1402	1502			Part No.
36	1				80 509 13
37	1	1			89 014 15
38	1	1			89 012 53
39	4	4			89 014 13
40	1	1			80 514 79
41	3	3			89 015 29
42	2	2			89 003 50
43	1	1			88 005 89
44	1	1			73 828 11
45	3	3			89 015 50



5

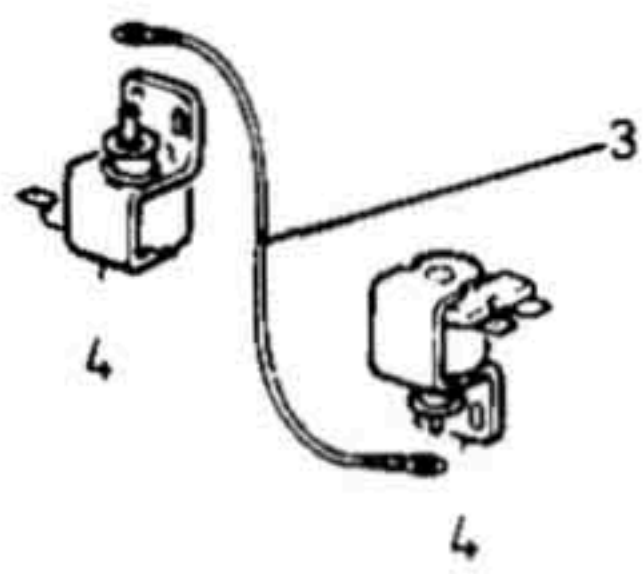

# ASKO CYLINDA

Datum 1990-05 Date		DETALJER FÖR CIRC PUMP OCH AVLOPPS 1402, 1502			
Fig.	Antal Qty				Detail nr  Part No.
1	1				88 009 33
2	1				88 009 35
3	1				88 009 38
4	1				88 005 83
5	1				88 009 34
6	1				88 009 36
7	1				88 009 37
8		1			80 025 80
9		1			88 007 02
10		1			88 007 33
11		1			80 025 82
12		1			88 007 35
13		1			88 007 36

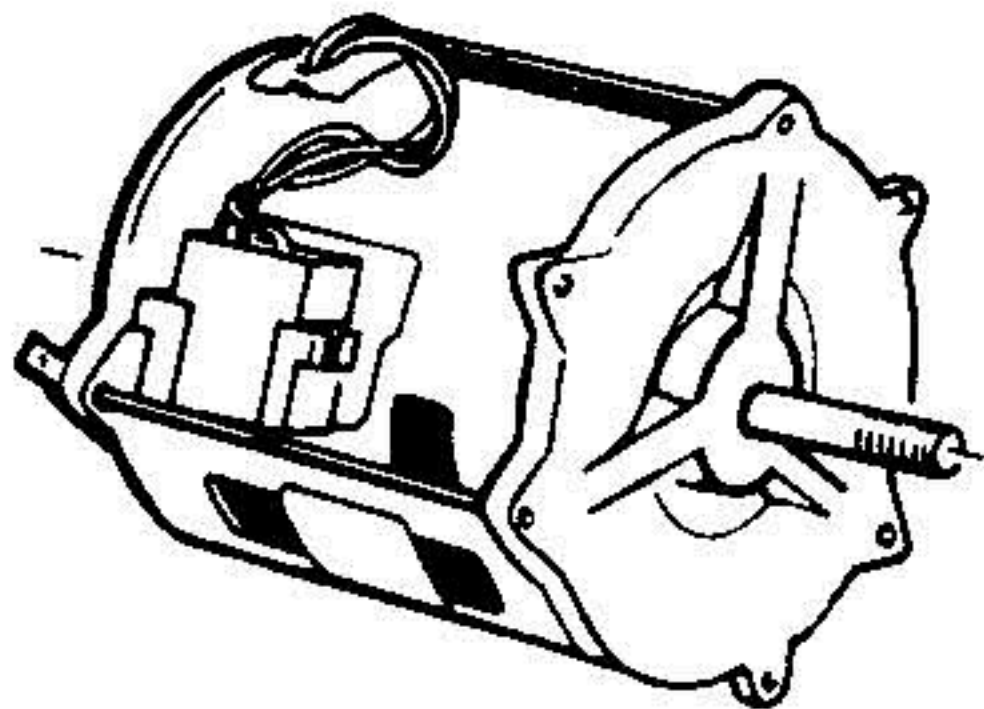

# ASKO CYLINDA

Datum <b>1990-05</b> Date		STYRUTRUSTNING <b>1502</b>			
Fig.	Antal Qty			Detalj nr	
		1502		Part No.	
1		1		80 537 81	
		1		80 541 90	
2		1		80 537 80	
		1		80 541 91	
3		1		80 538 82	
		1		80 537 79	
4		1		80 532 40	
		1		80 524 36-	
5		2		33450536	
6		1		80 527 22	

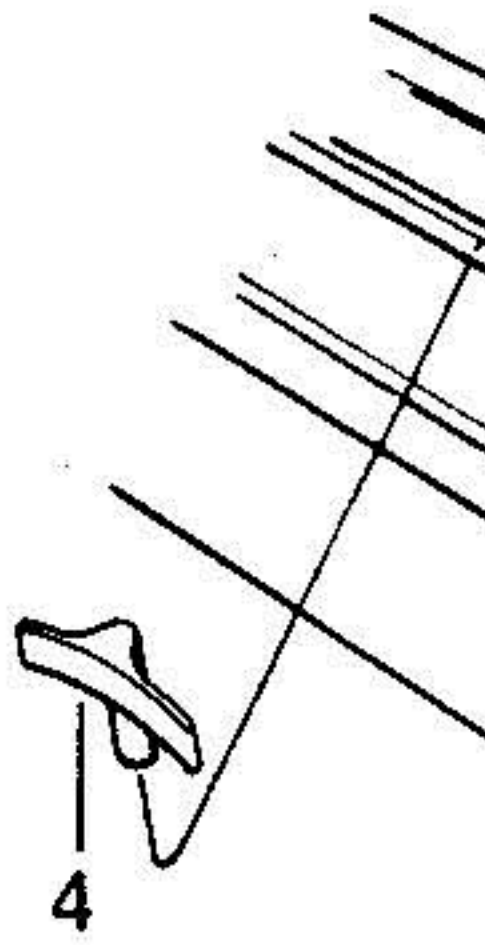

# ASKO CYLINDA

Datum <b>1988-05</b> Date		TILLBEHÖR <b>1402, 1502</b>			
Fig.	Antal Qty				Detalj nr
					Part No.
1					80 097 47- 80 097 46- 80 097 45-  80 097 44-
2					80 097 81-
3					80 097 82- 80 097 49 80 097 48
4					80 096 16
5					80 070 29
6					80 070 30