

REPLACEMENT PARTS LIST & SPECS

Manufactured By HP Products

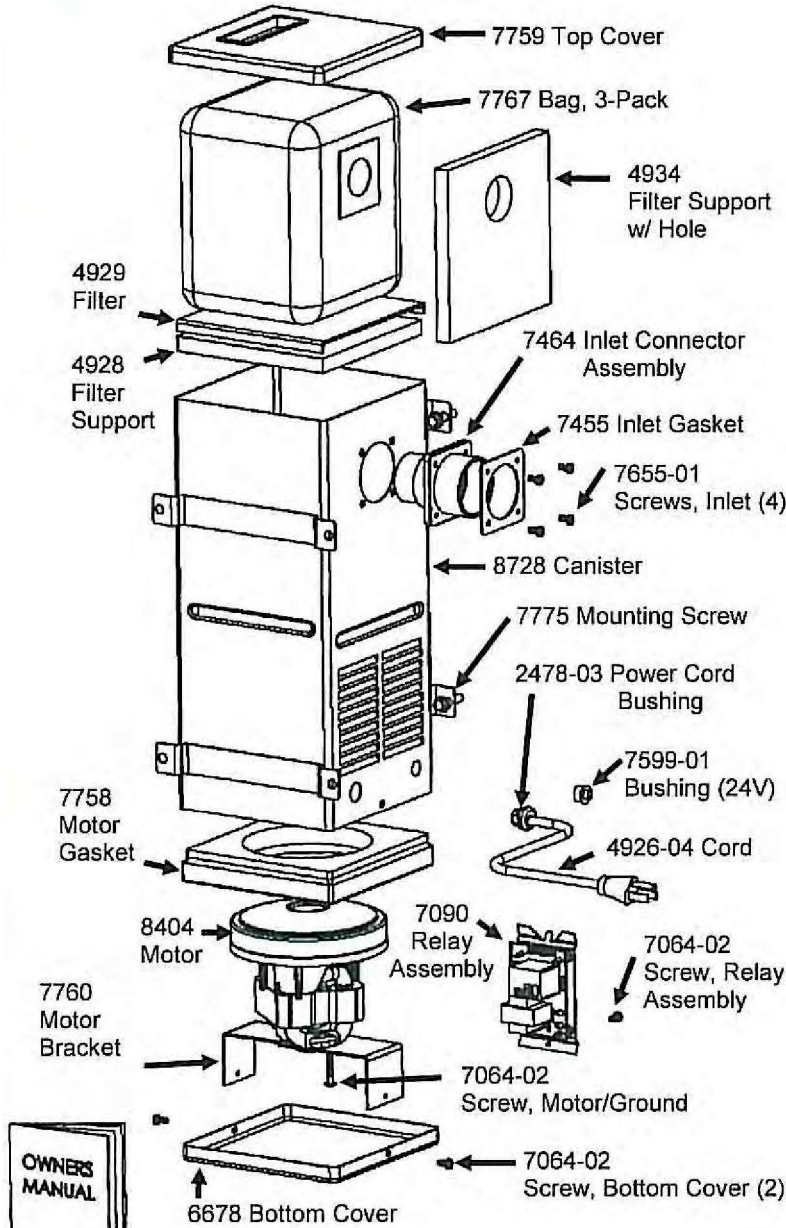

7762 Owner's Manual

Part# Description MSRP

Part#	Description	MSRP
7759	Top Cover	
7767	Bag (3-Pack)	
4934	Fitter Support w/ Hole	
4929	Filter	
4928	Filter Support	
7464	Inlet Connector Assembly	
7455	Inlet Gasket	
7655-01	Screw, Inlet (4)	
8728	Canister	
7775	Mounting Screw (4}	
2478-03	Bushing, Power Cord	
7599-01	Bushing (24V)	
4926-04	Power Cord	
7090	Relay Assembly	
7064-02	Screw (4)	
7758	Motor Gasket	
8404	Motor	
7760	Motor Bracket	
6678	Bottom Cover	
7762	Owner Manual	

(Qty.)

\$

a.

Product Specifications

Model..... Dirt Devil® CV950
 Weight..... 14 pounds
 Dimensions.... 6.25" x 7" x 14.5"
 Voltage..... 120 volts (AC)
 Amperes..... 11.3

Dirt Capacity.... 1 gallon
 CFM..... 120
 Air Watts..... 450
 Water Lift..... 105"

Motor has a thermal protector and automatically resets when cooled.

