

shop-vac®

# Model - QAM70

Catalog 8710300 (2 Gal.)

8710500 (2 Gal. Deluxe)

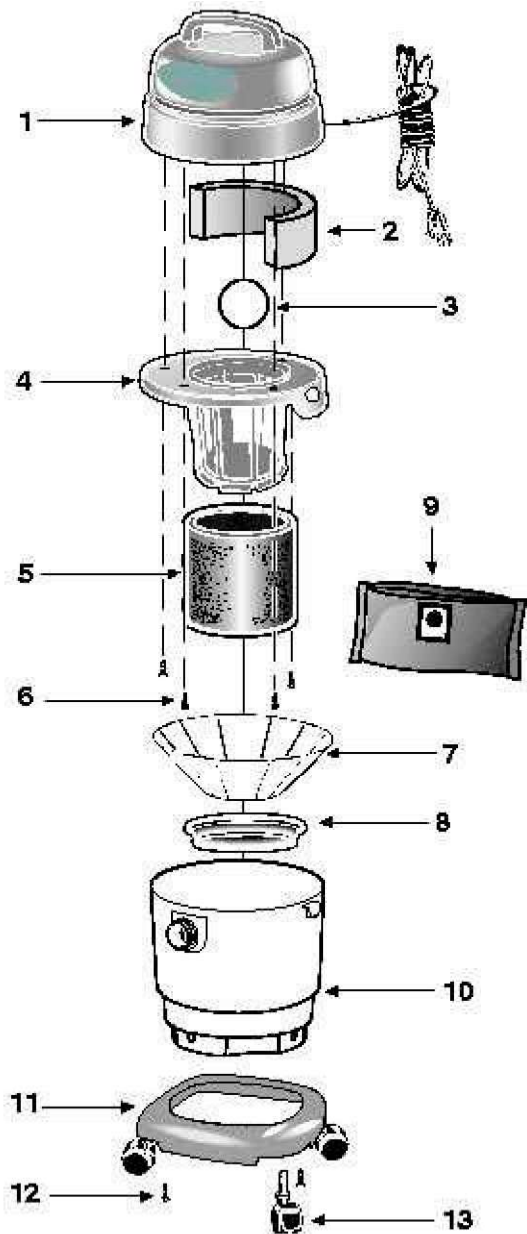

n°EM	DESCRIPTION	PART NO.
1	Power Unit Assembly	6115397
2	Foam Insert	1290507
3	Ball Float	0061100
4	Lid Cage	3161400
	Foam Sleeve	9056562
6	Screw Hex Head #10 x 3/4 Type AB	1503999
7	Reusable Dry Filter	9010762
8	Filter Ring	3006500
9	Collection Filter Gag (9710500 only)	9066600
10	Tank Assembly	3151697
11	Dolly	3153400
12	Screw x 1/2 Ph Pan Hd Type A	1501599
13	Carter	6774-210

### STANDARD ACCESSORIES

#### 9710300

- 7' x 1 1/4" hose with extension nozzle
- 2 - 1 1/4" extension wands
- 10' wet/dry nozzle
- 10' squeegee insert
- Crevice tool
- Gulper Nozzle

#### 9710500

- 7' x 1 1/4" hose with extension nozzle
- 2 - 1 1/4" extension wands
- 12' deluxe wet/dry nozzle
- 12' squeegee insert
- 12' brush insert
- Round brush
- Crevice tool
- Gulper Nozzle

### THREE-YEAR HOME USE WARRANTY

Your Shop-Vac® vacuum cleaner is warranted in normal household use, in accordance with the User Manual, against original defects in material and workmanship for a period of three years from date of purchase. Should this product be used for commercial or rental use, a 90 day limited warranty will apply. Shop-Vac Corporation warrants placing this vacuum cleaner in correct operating condition, by repair or parts replacement, during the warranty period, without charge. This warranty does not cover accessories. Use of non-recommended filters and/or accessories may void the manufacturer's warranty.