

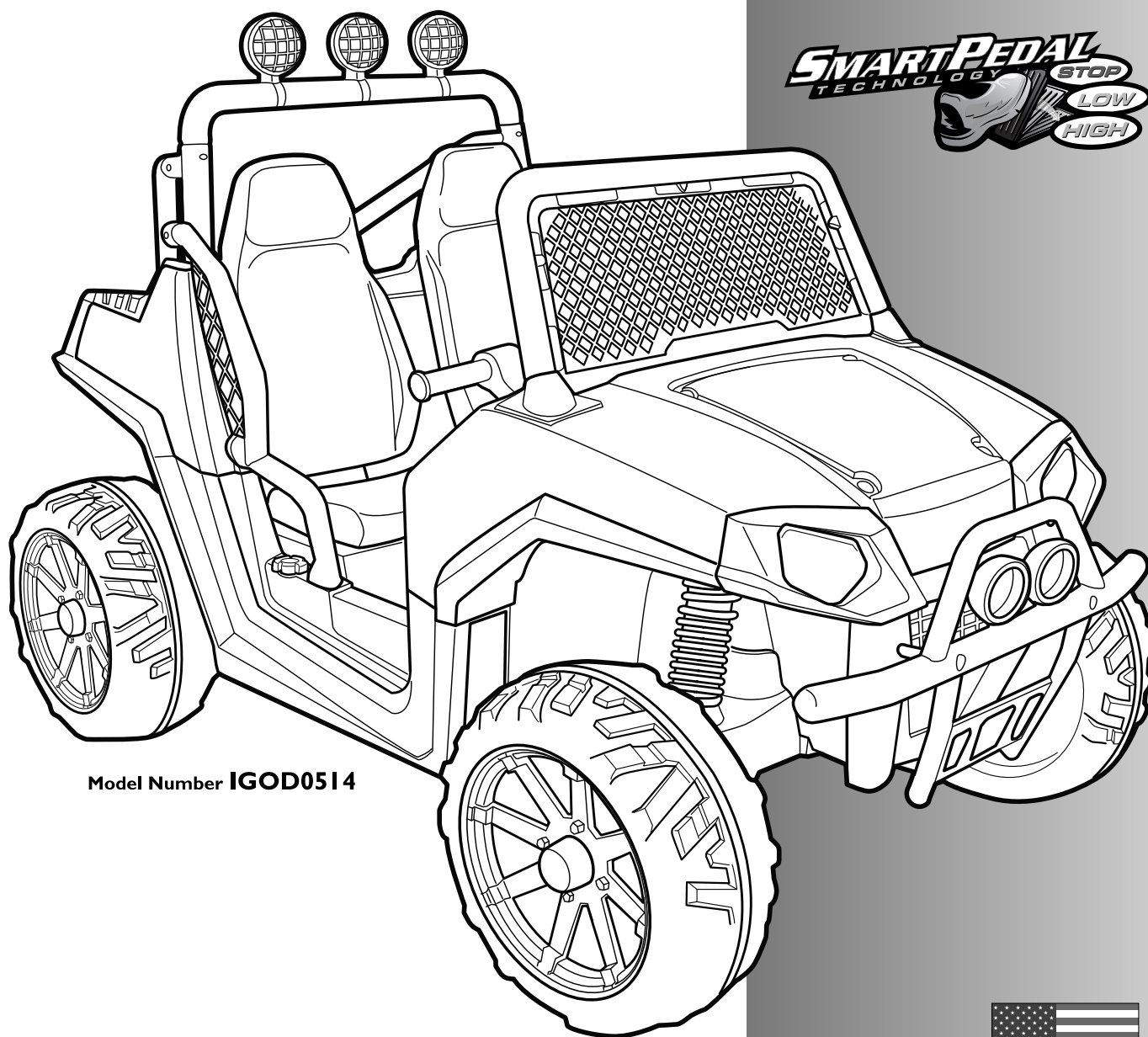

FIUS100IG153

**RANGER**  
**RZR<sup>TM</sup>S**



Model Number **IGOD0514**

USE AND CARE **EN**

EMPLEO Y MANUTENCION **ES**

UTILISATION ET ENTRETIEN **FR**

See separate insert  
sheet for more  
information

Vea la hoja separada del  
separador de millares  
para más información

Voir la feuille séparée  
d'insertion pour plus  
d'information



**2 YEARS\***

\*CONSUMER PARTICIPATION  
REQUIRED



**24 VOLT**



**POLARIS**  
LICENSED MERCHANDISE

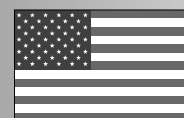

MADE in USA

**SEE VERBAL INSTRUCTIONS  
AFTER THE PICTURES**

**VER LAS INSTRUCCIONES  
DESPUÉS DE LOS DISEÑOS**

**VOIR LES INSTRUCTIONS APRÈS  
LES DESSINS**

**INITIAL BATTERY CHARGE**

**PRIMERA CARGA DE LA  
BATERÍA**

**PREMIÈRE CHARGE DE  
BATTERIE**

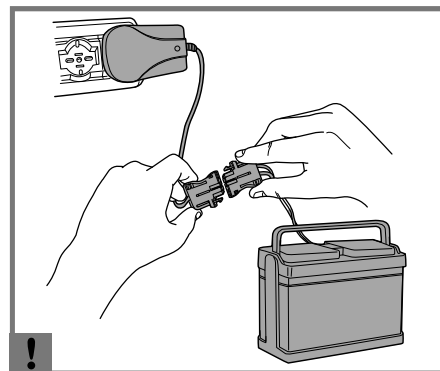

**ASSEMBLY**

**MONTAJE**

**MONTAGE**

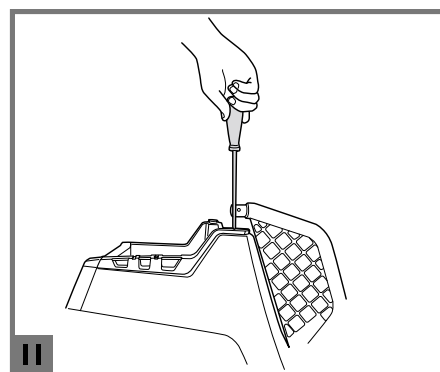
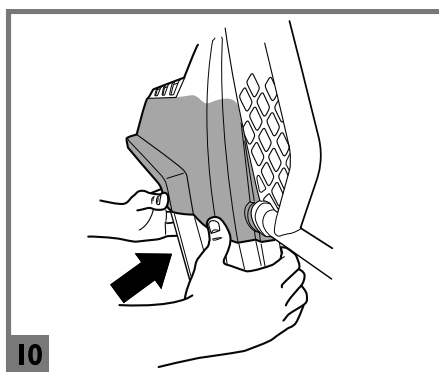
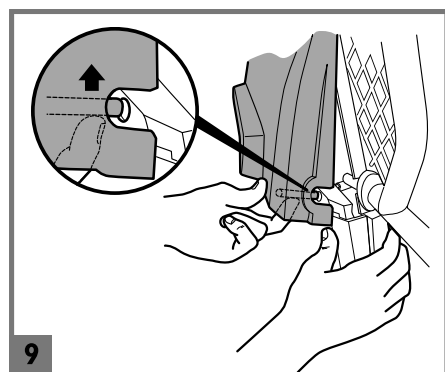
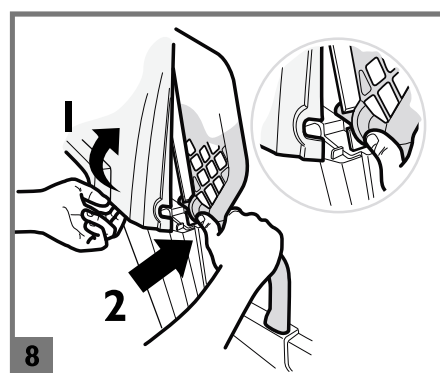
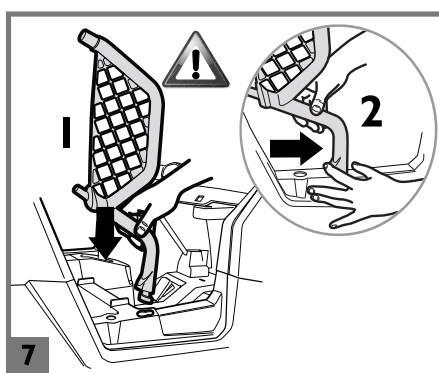
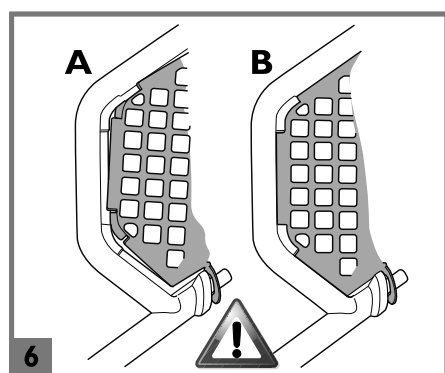
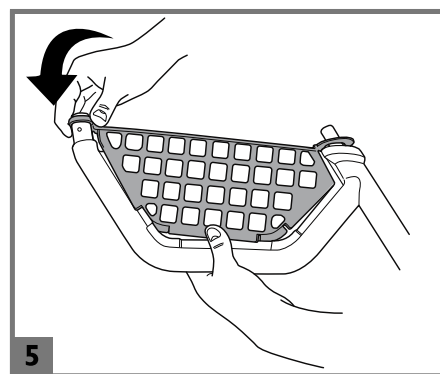
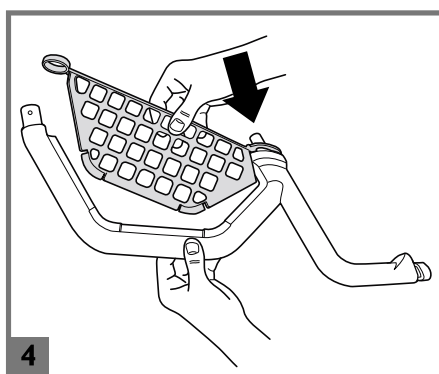
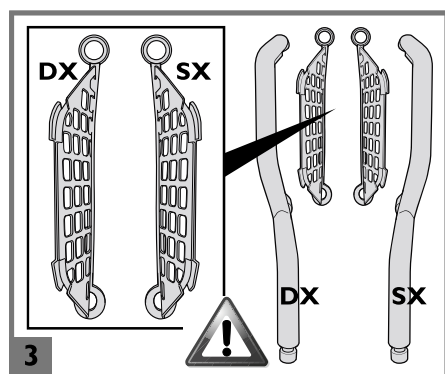
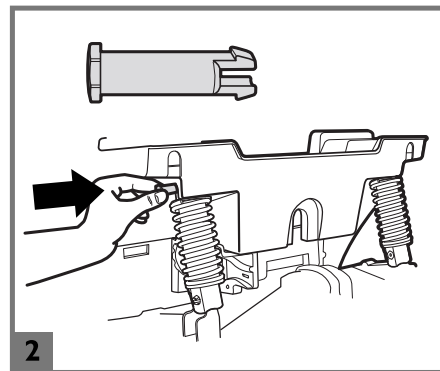
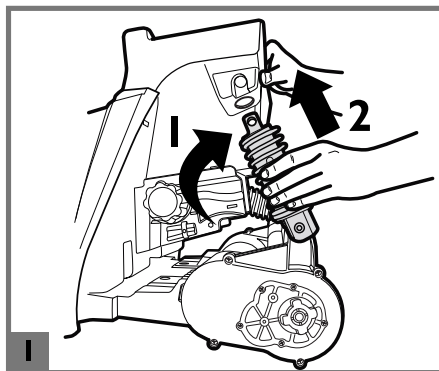

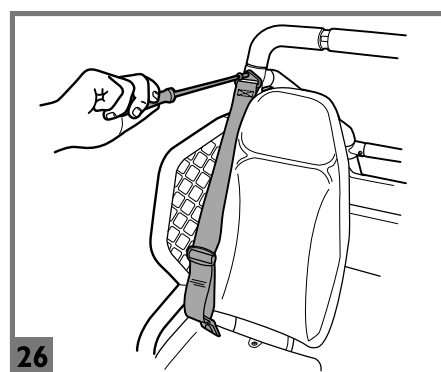
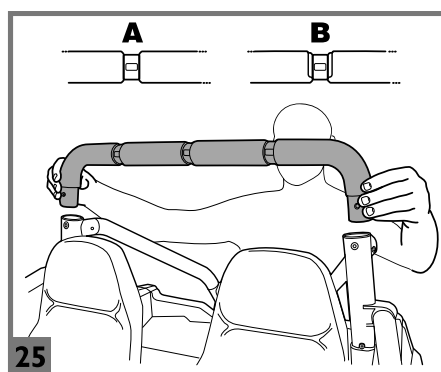
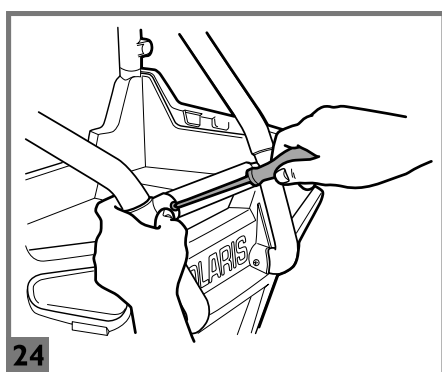
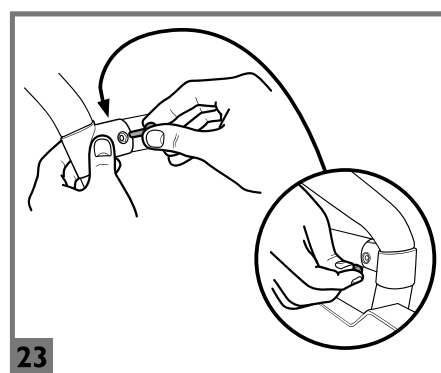
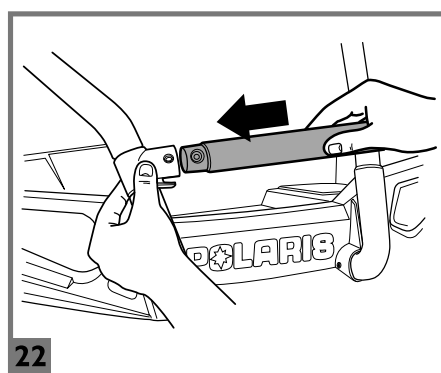
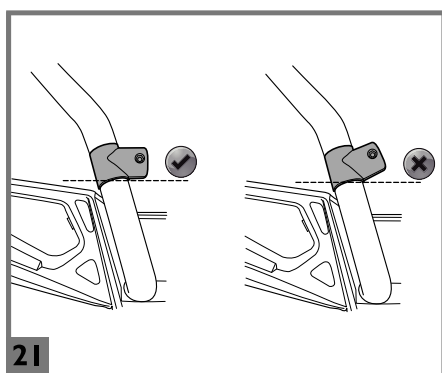
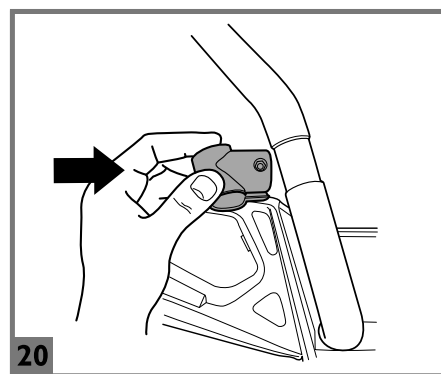
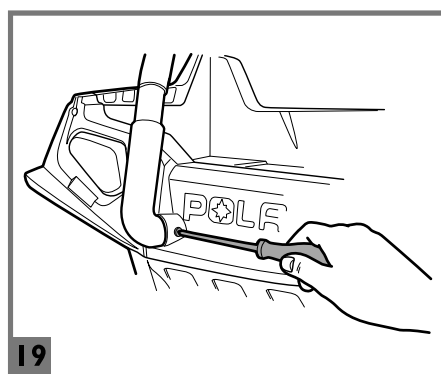
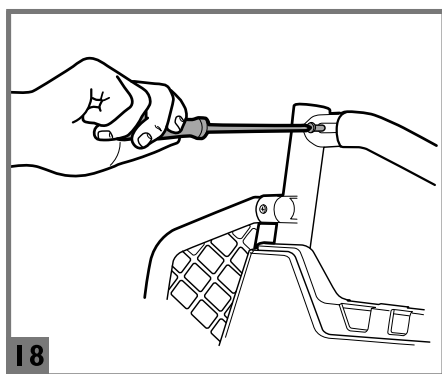
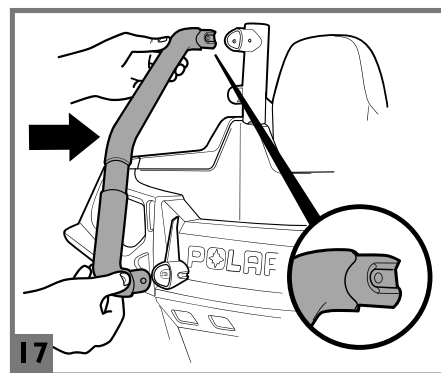
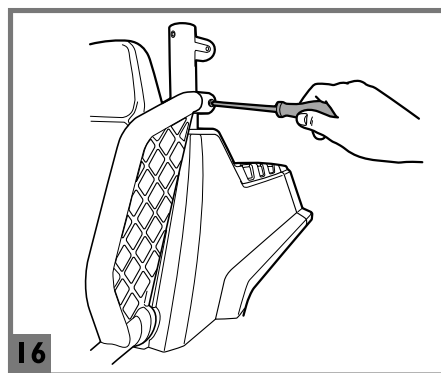
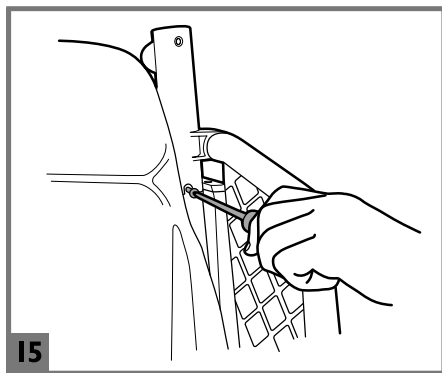
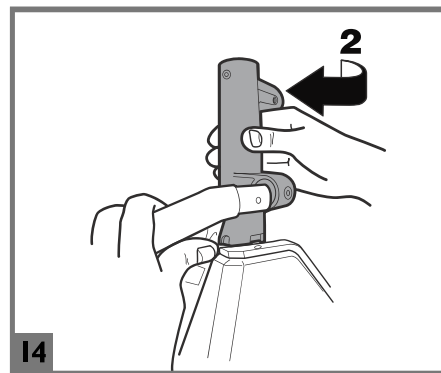
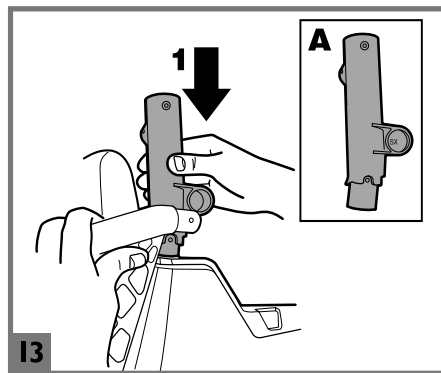
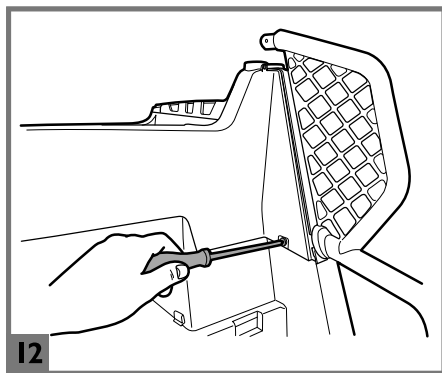

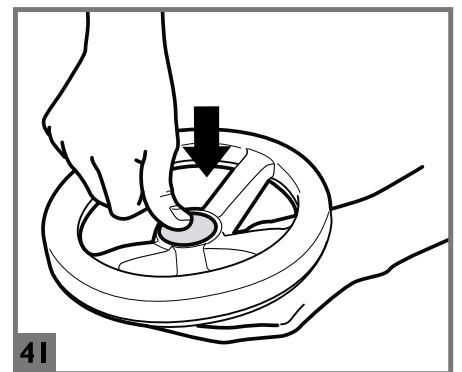
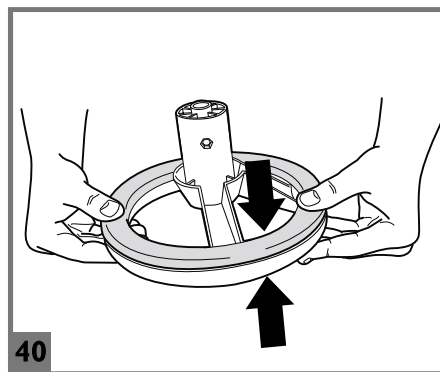
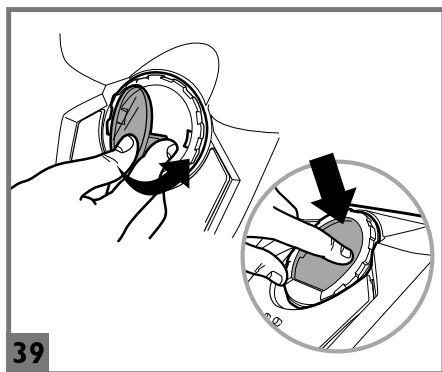
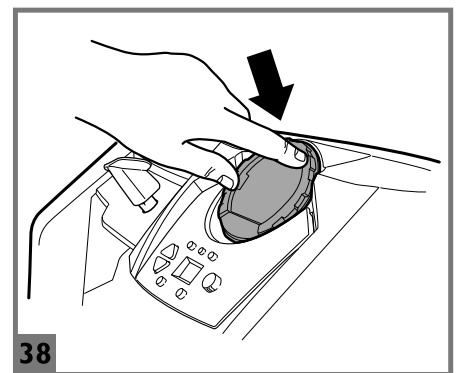
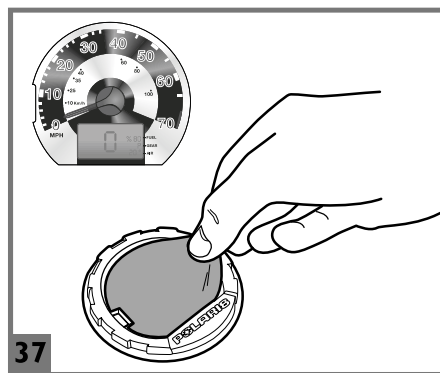
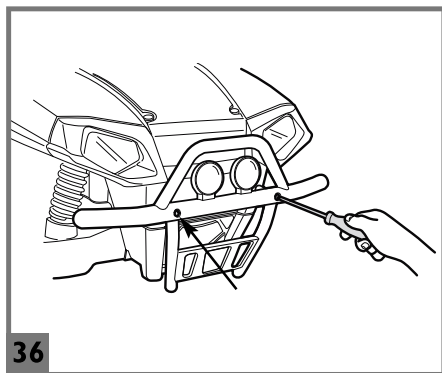
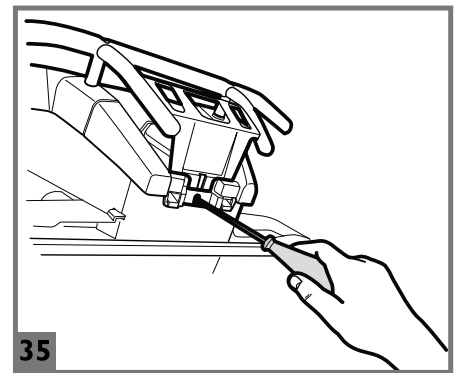
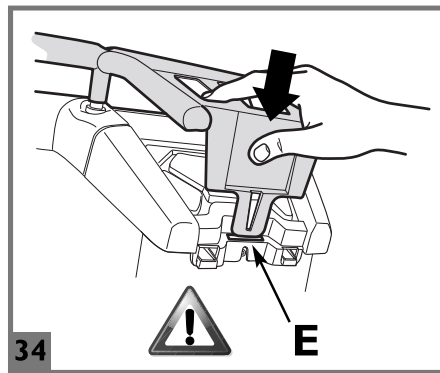
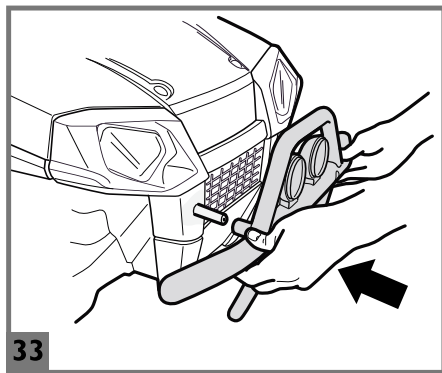
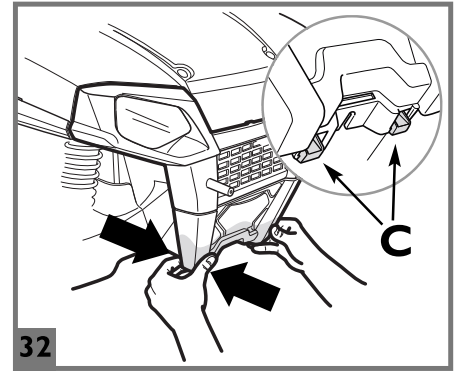
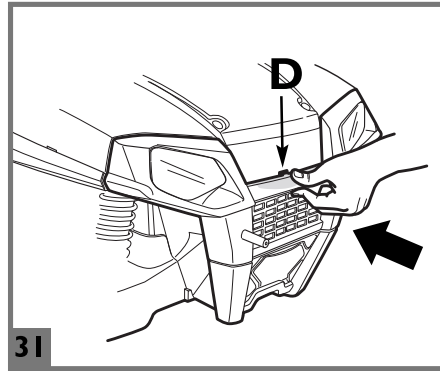
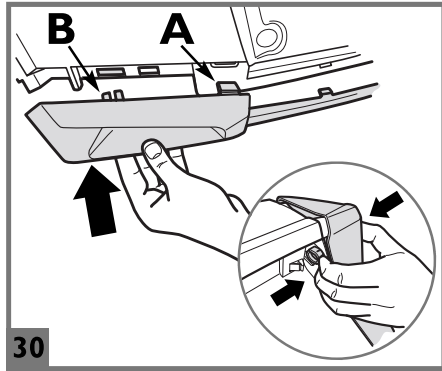
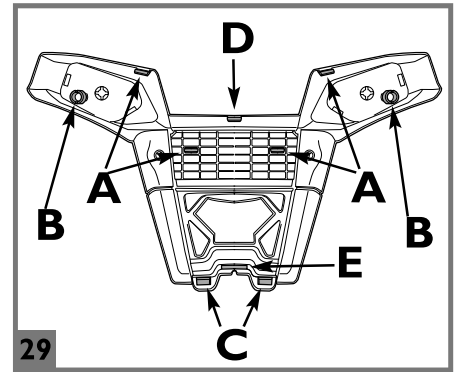
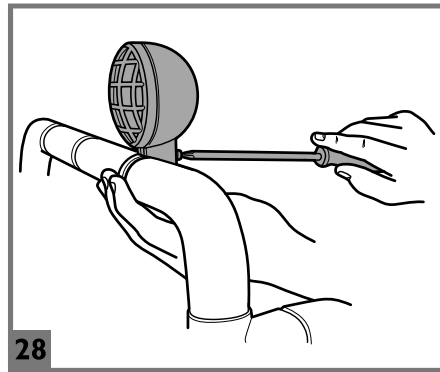
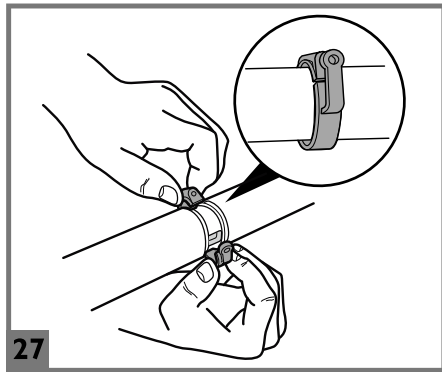



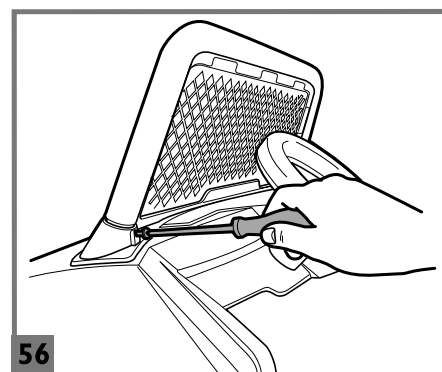
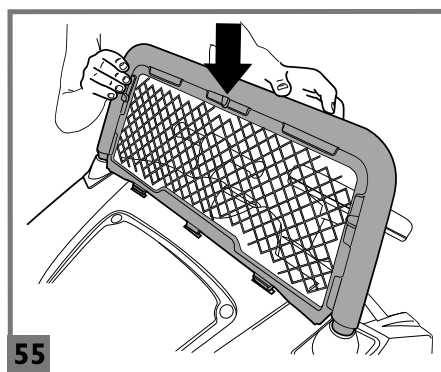
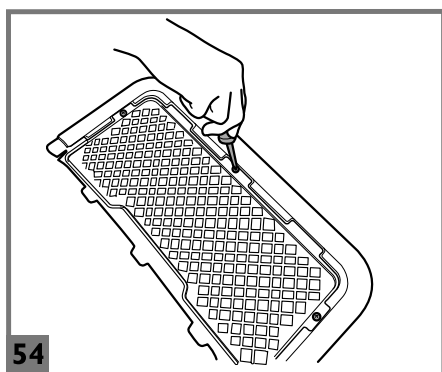
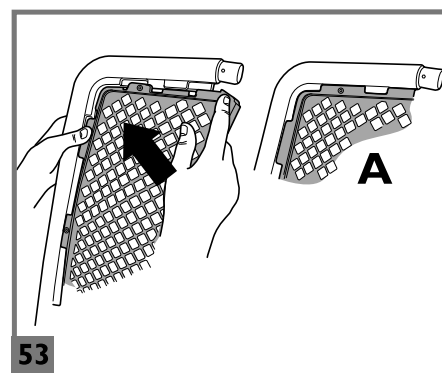
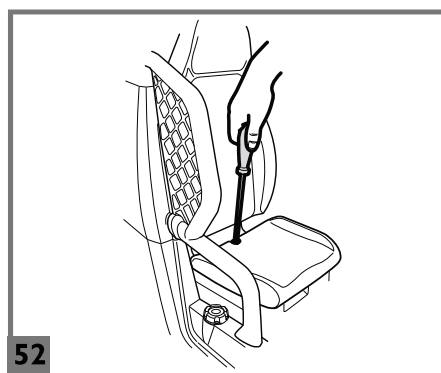
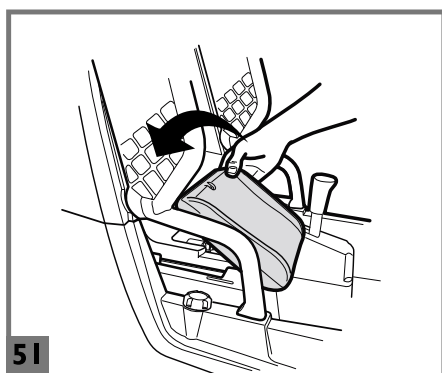
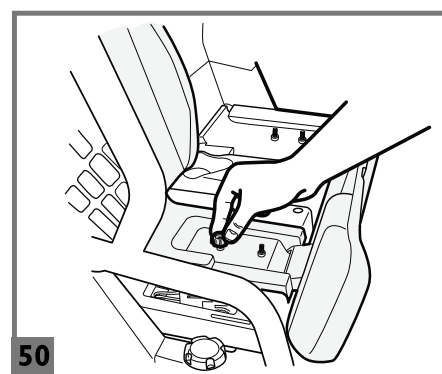
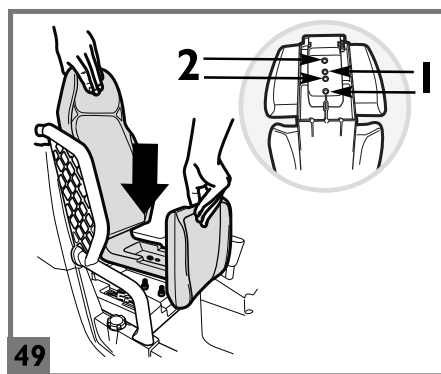
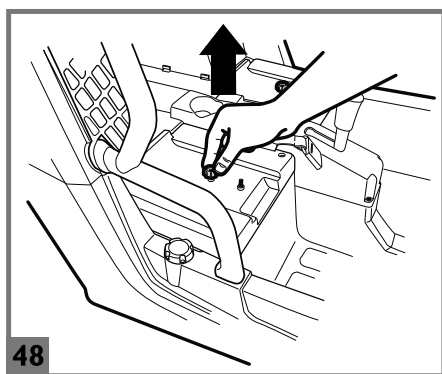
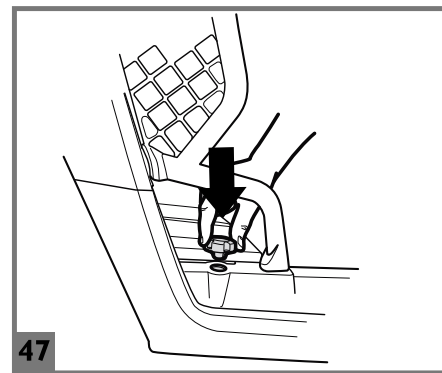
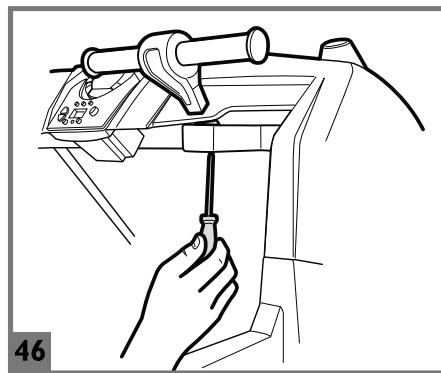
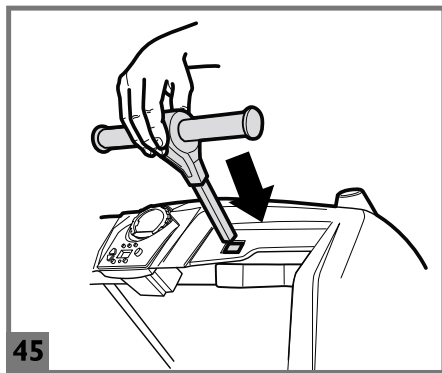
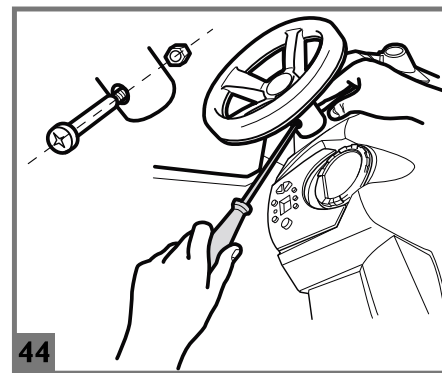
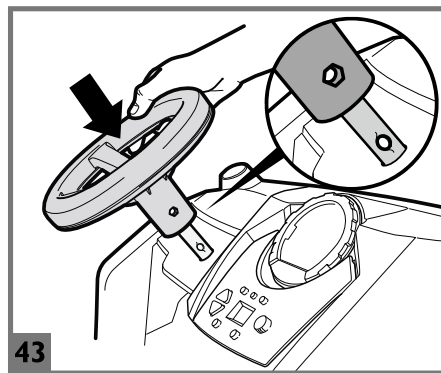
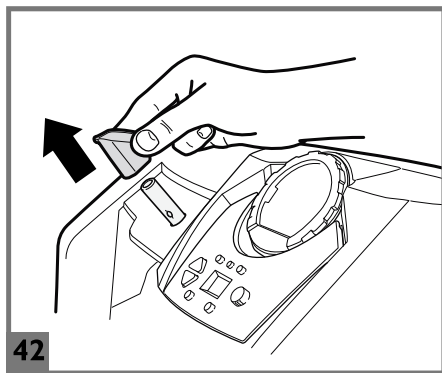

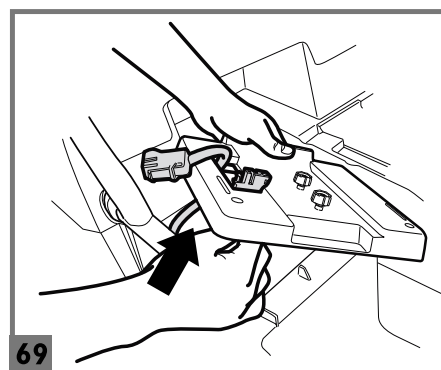
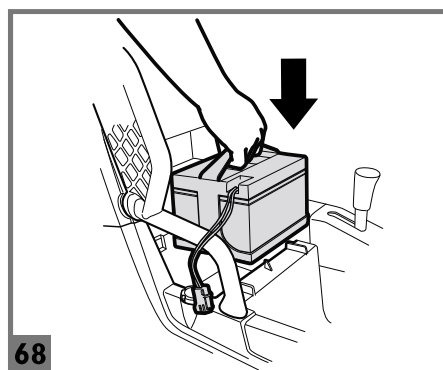
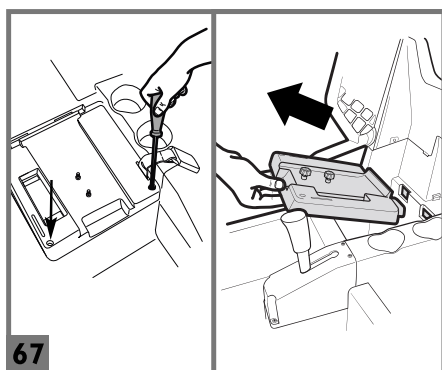
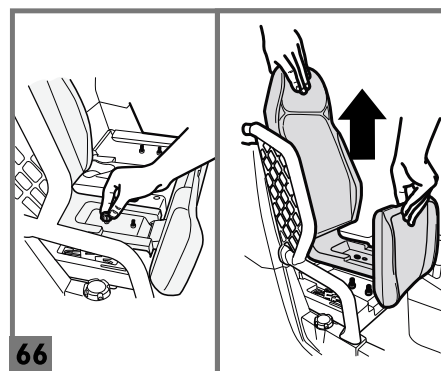
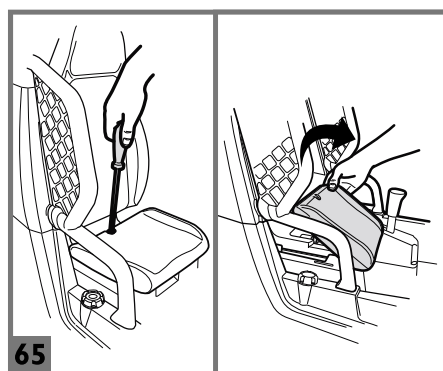
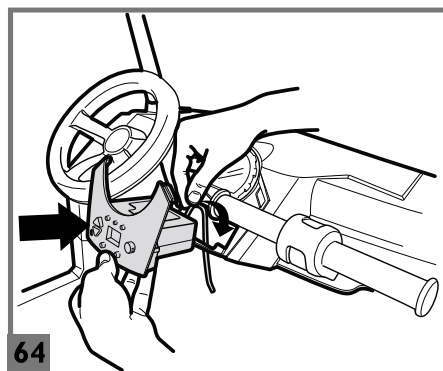
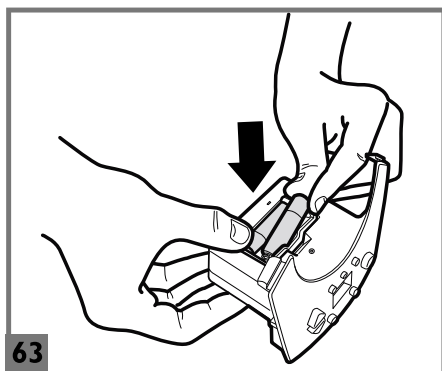
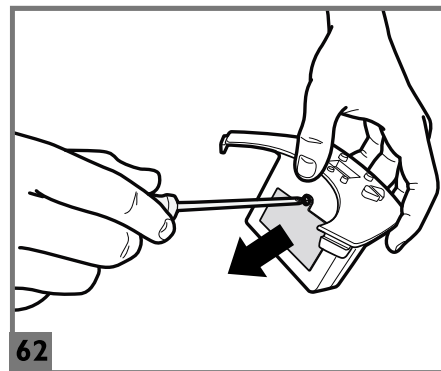
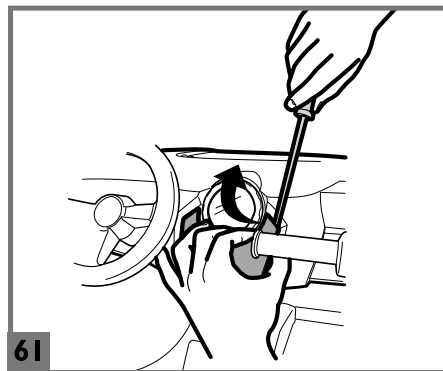
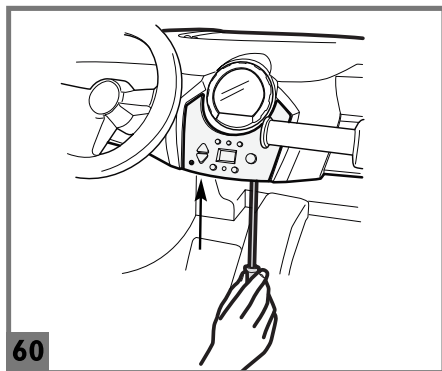
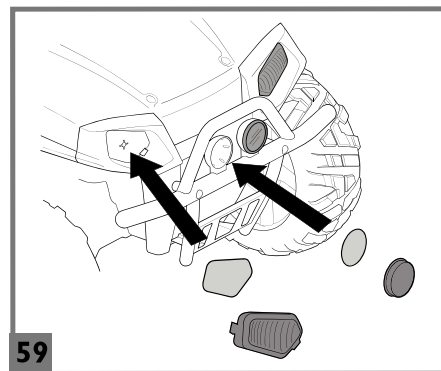
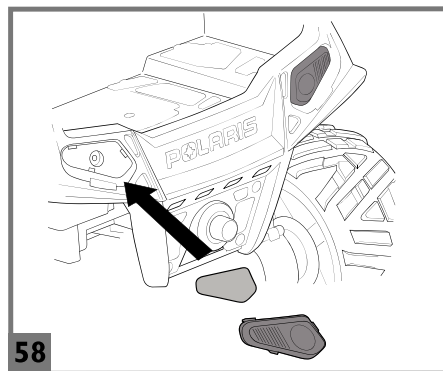
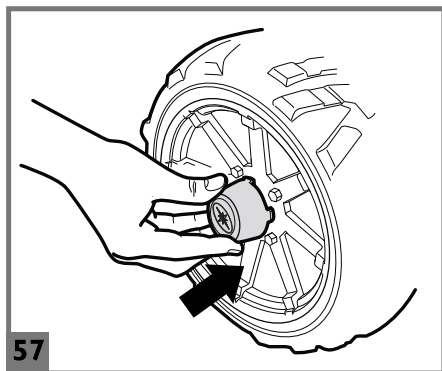

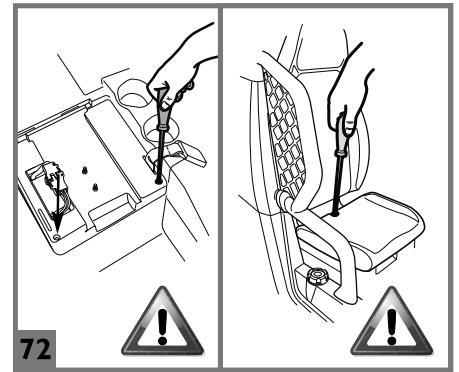
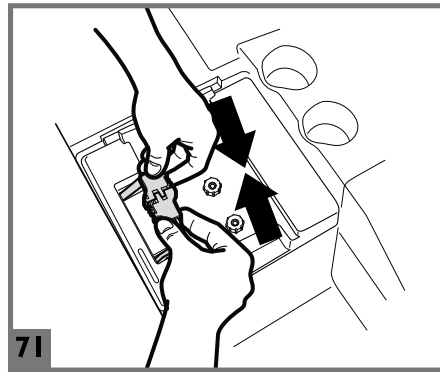
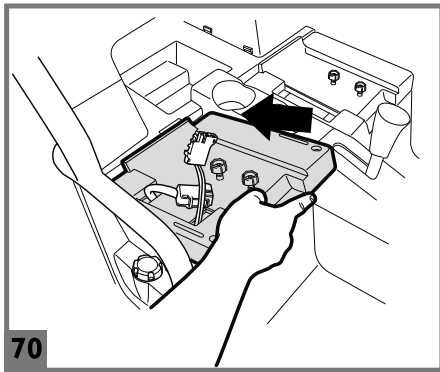

**VEHICLE FEATURES AND INSTRUCTIONS FOR USE**

**CARACTERÍSTICAS Y USO DEL VEHÍCULO**

**CARACTÉRISTIQUES ET UTILISATION DU VEHICULE**

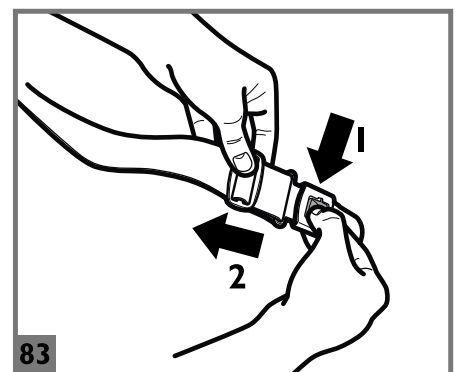
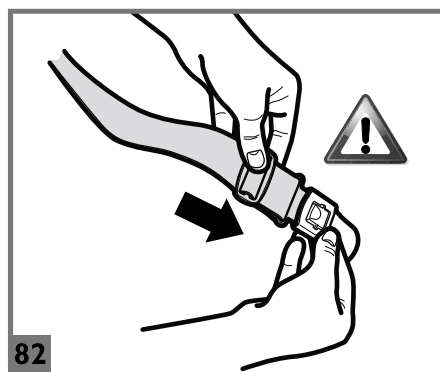
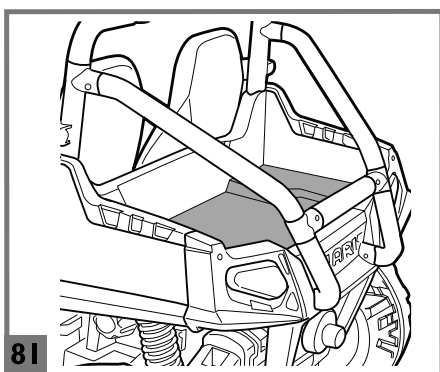
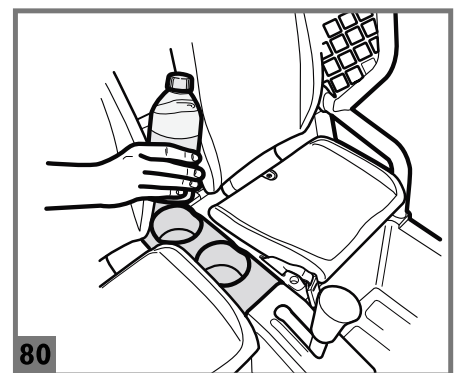
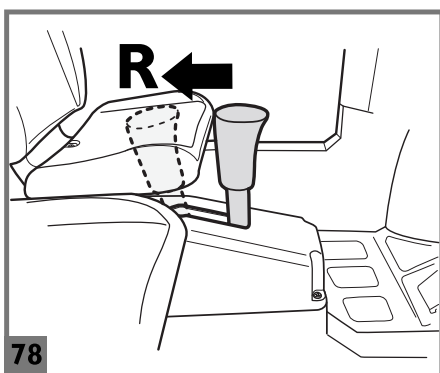
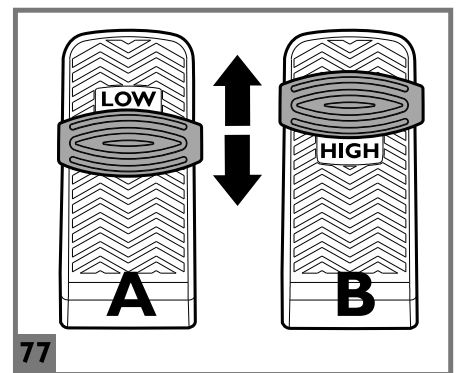
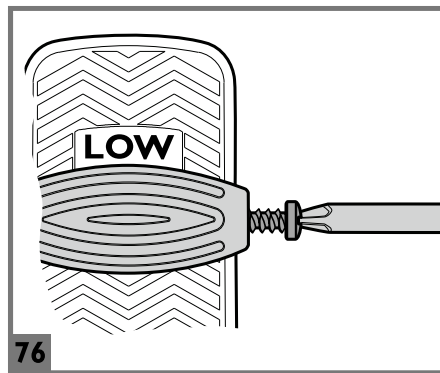
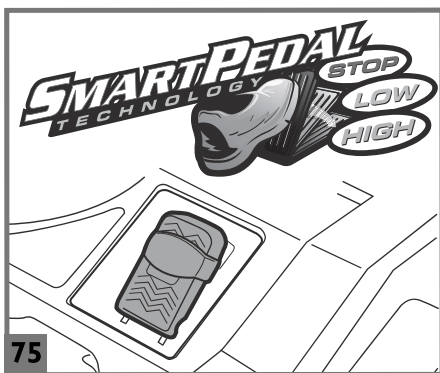
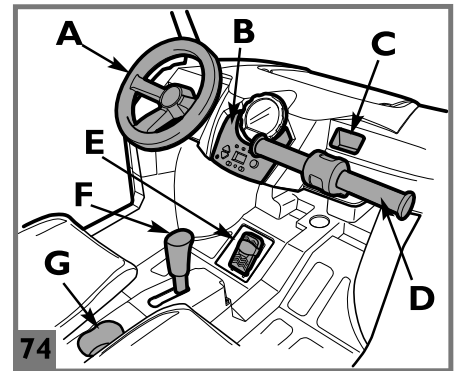
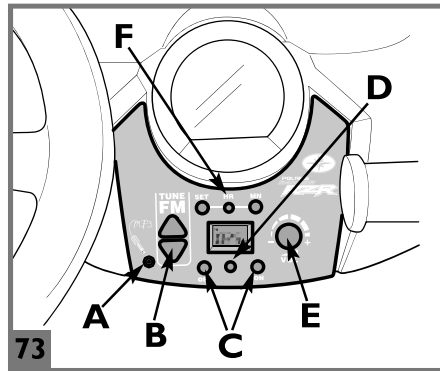

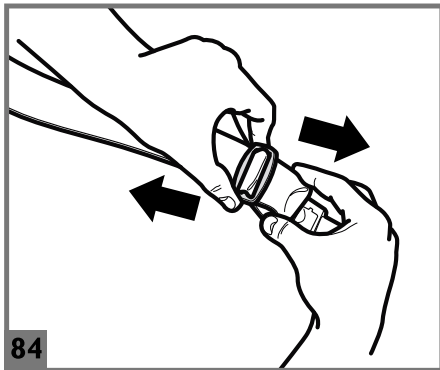

**BATTERY RECHARGE**

**CARGA DE LA BATERÍA**

**CHARGE DE LA BATTERIE**

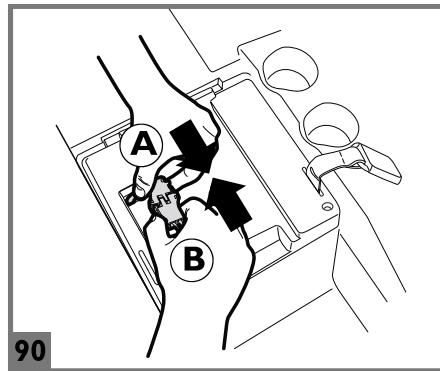
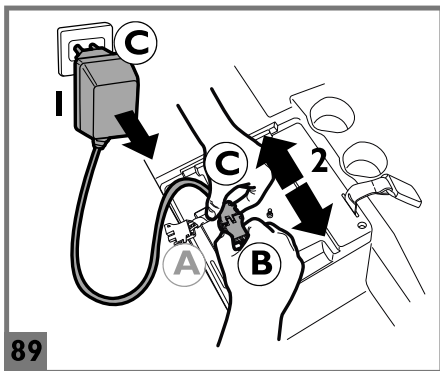
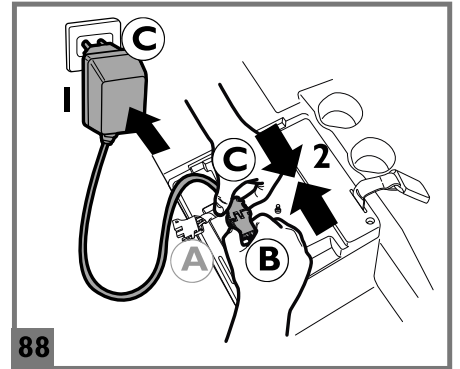
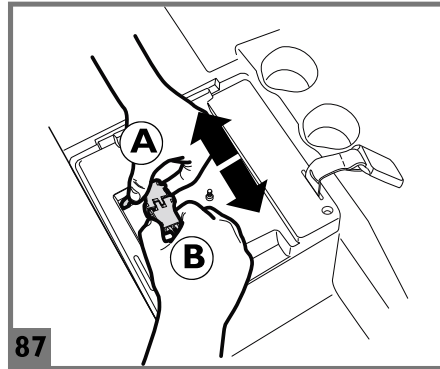
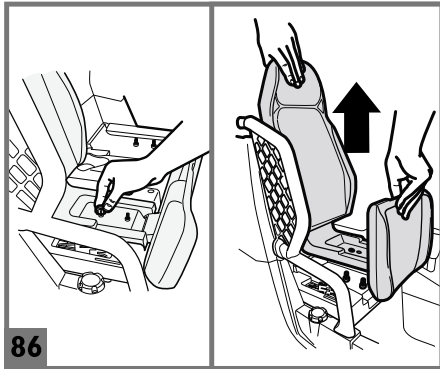
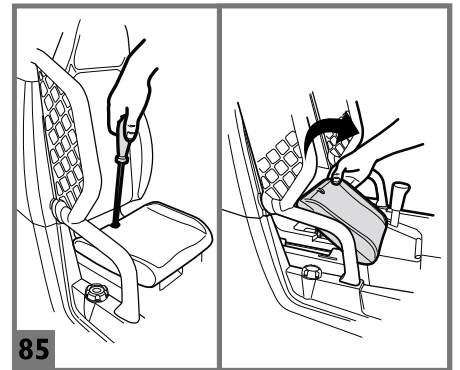

**BATTERY REPLACEMENT**

**CAMBIO DE LA BATERÍA**

**REPLACEMENT DE LA BATTERIE**

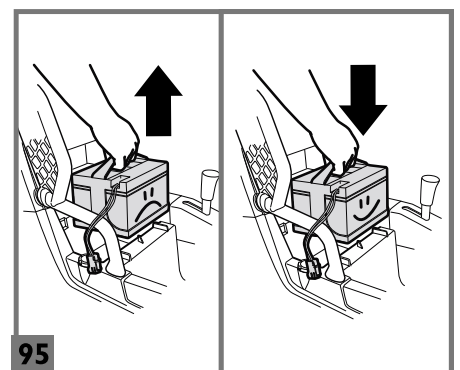
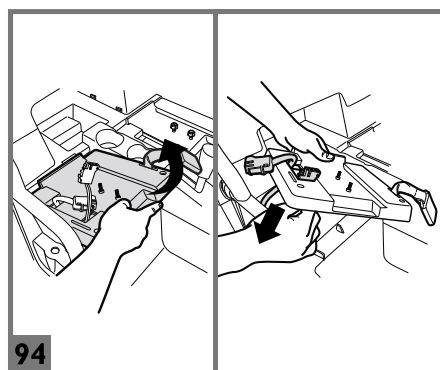
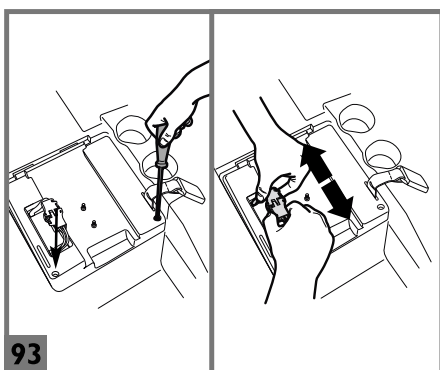
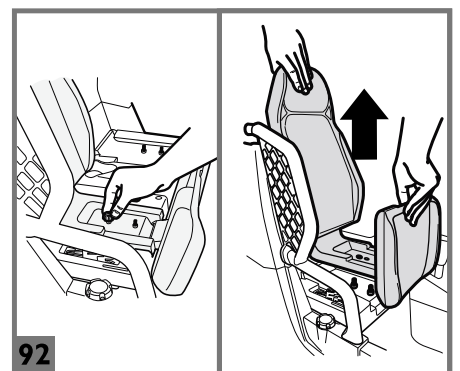
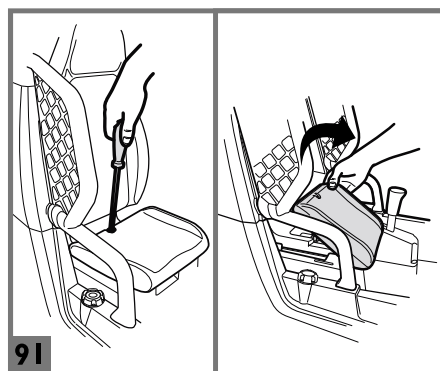



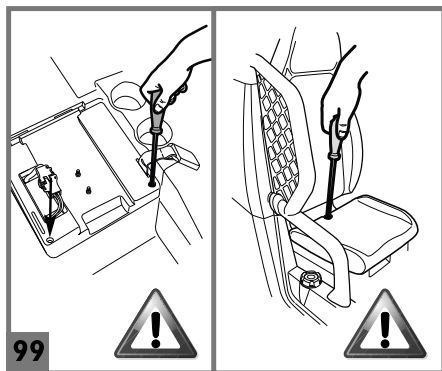
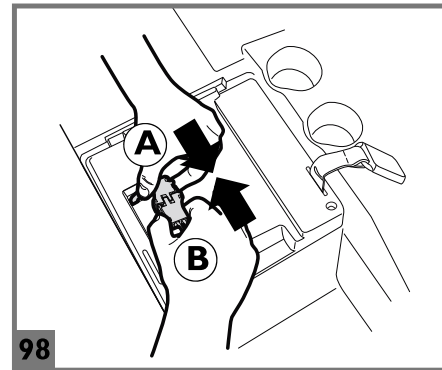
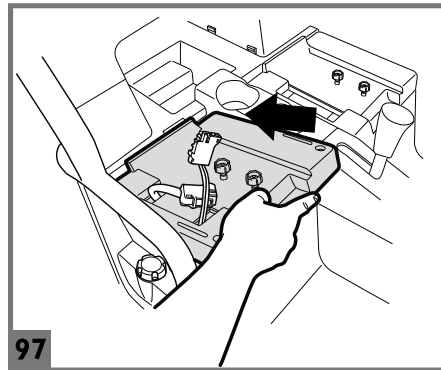
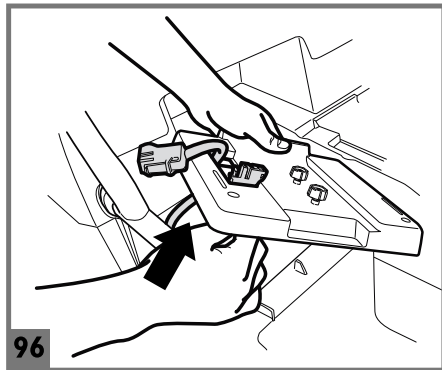

# ELECTRICAL DIAGRAM

# DIAGRAMA ELÉCTRICO

# DIAGRAMME ÉLECTRIQUE

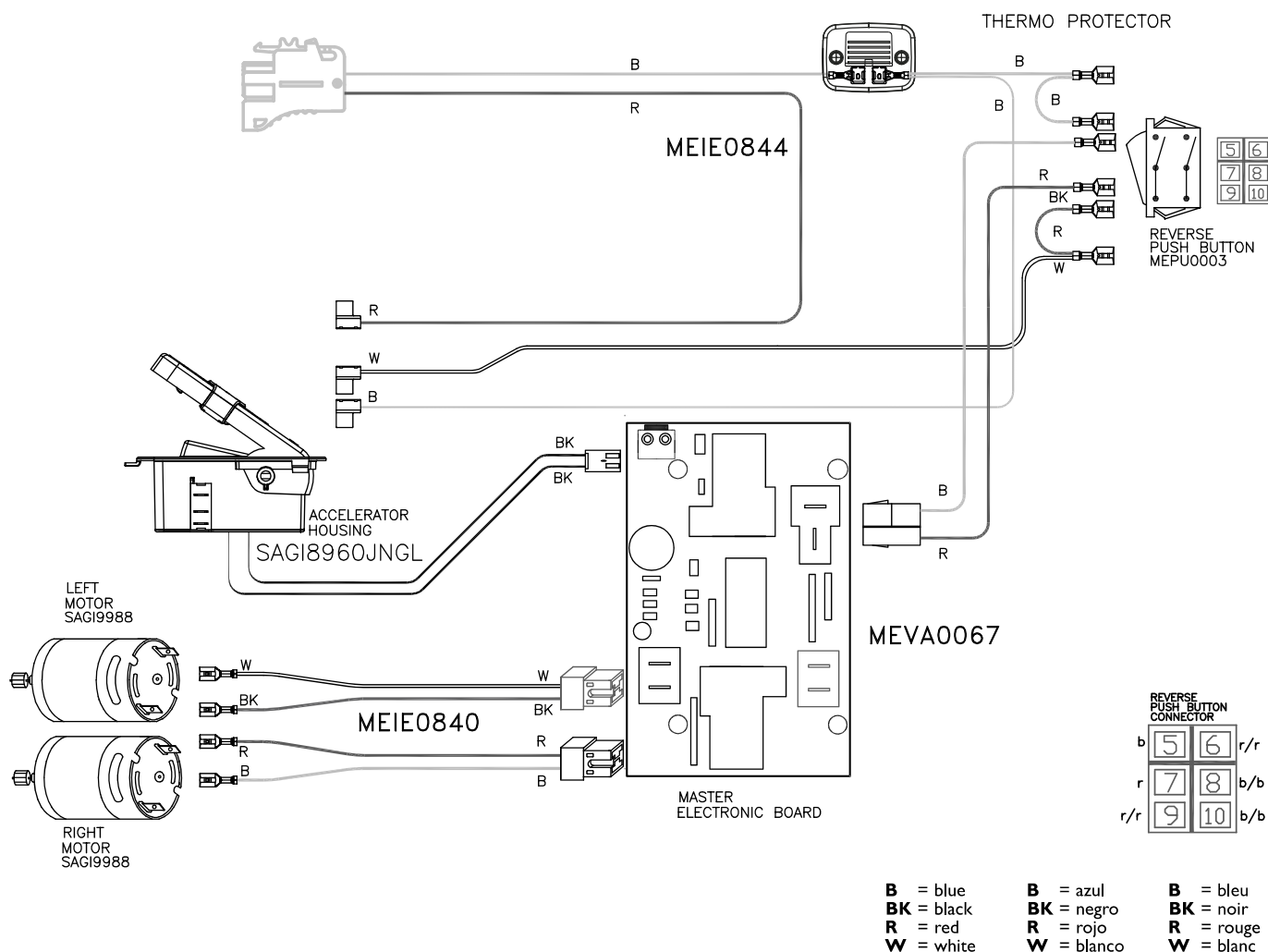

**USA**

Call toll free:  
1-800-728-2108  
Llame gratis:  
1-800-225-1558

**Mexico**

Llame gratis:  
1-800-710-1369

**Canada**

Call toll free:  
Appelez le péage libre:  
1-800-661-5050

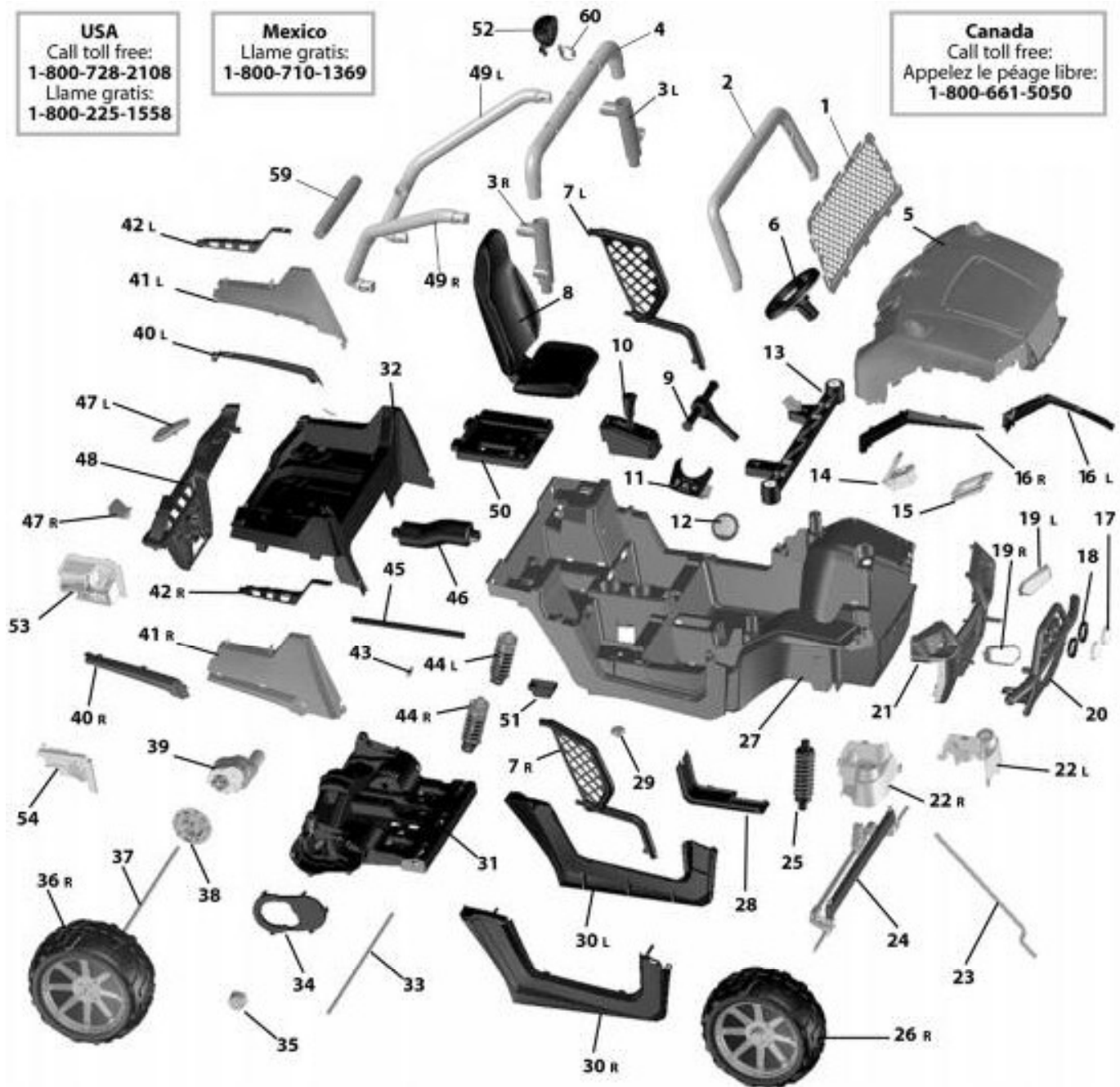
**55**
**ELECTRICAL SYSTEM  
INSTALACION ELECTRICA  
CIRCUIT ELETRIQUE**

1	SPST9200N	15	SPST8921N
2	SPMV9199N	16 R	SPST8882DN
3 R	SPST9202DN	16 L	SPST8882SN
3 L	SPST9202SN	17	SPST8903
4	SPMV9201N	18	SPST8902N
5	SPST8880GR	19 R+L	SPST8919
6	Please Call	20	SPST8901N
7 R	ASGI0221DN	21	SPST8881N
7 L	ASGI0221SN	22 R	SPST8924DGR
8	SARP8889RV	22 L	SPST8924SGR
9	SPMV8916RV	23	SOTF0253L30
10	Please Call	24	Please Call
11	SAGI8999N	25	Please Call
12	ASGI0222RV	26	SARP8997NGR
13	Part Not Available	27	Part Not Available
14	SAGI8960KNGL	28	SPST8934N

**56**
**DECALS  
CALCOMANIAS  
DECALCOMANIES**

29	SPST8922N
30 R	SPST8884JDN
30 L	SPST8884JSN
31	Please Call
32	SPST8885N
33	SOTF0248Z
34	SPST8927N
35	SPST8932N
36	SARP9024NGR
37	SOTF0247L30
38	SPST8931N
39	SAGI8969XWTN
40 R	SPST8888DN
40 L	SPST8888SN
41 R	SPST8887DGR
41 L	SPST8887SGR

**57**
**BATTERY  
BATERIA  
BATTERIE**

42 R	SPST8918DN
42 L	SPST8918SN
43	SPST9060GR
44 R	SAGI8405KDNGR
44 L	SAGI8405KSNGR
45	SOTF0254L30
46	SPMV8930N
47 R	SPST8920DRF
47 L	SPST8920SRF
48	SPST8886N
49 R	ASGI0223DN
49 L	ASGI0223SN
50	SPST8891N
51	SPST8925N
52	SAGI0132JN
53	SPST8903GR

**58**
**BATTERY CHARGER  
CARGADOR DE BATERIA  
CHARGEUR DE BATTERIE**

54	SPST8905GR
55	See Previous Page
56	MMEV0747
57	IAKB0021
58	IKCB0111
59	SPMV9204N
60	SPST9069N

PEG PEREGO® thanks you for choosing this product. For more than 60 years, PEG PEREGO have been taking children for an outing: first with its famous baby carriages and strollers, later with its pedal and battery operated toy vehicles.

Discover our complete range of products, news and other information about the Peg Perego world on our web site [www.pegperego.com](http://www.pegperego.com)

## IMPORTANT INFORMATION

- Read this instruction manual carefully to learn the use of the vehicle and to teach your child safe and enjoyable driving. Please keep this manual (with your original sales receipt) for use as a reference in the future.
- **DO NOT RETURN YOUR VEHICLE TO THE STORE. This product cannot be returned for a refund after it has been used. If you have ANY questions, need replacement parts or need assistance, call us toll-free; U.S.A. , call 1-800-728-2108 / CANADA, call 1-800-661-5050**
- This product meets and/or exceeds all ASTM (American Society for Testing and Materials) TOY SAFETY STANDARDS, including F 963, Consumer Toy Safety Specifications as well as C.R.C, c.931, the Canadian Hazardous Products (Toys) Regulations.
- Tools needed for assembly: phillips screwdriver (medium and small), pliers. (not included)
- Your new vehicle is partially pre-assembled. It will require adult assembly. Please set aside at least 60 minutes for assembly.
- Before the vehicle is used for the first time, charge the battery for 18 hours to initiate it. Failure to do this can result in permanent battery damage.
- Use only with the included Peg Perego 24 Volt lead-acid, rechargeable battery and a Peg Perego 24 Volt Charger (both included).
- Requires 2 "AA" batteries (not included) for operation of radio/clock:

## • Year 5+

## • Weight capacity 150 lbs

- Do not exceed the maximum total weight capacity of 150 lbs (68 Kg). This includes both riders and cargo.

### Contents:

- 1 Polaris Ranger RZR children's ride-in vehicle -- partially assembled
- 1 Rechargeable 24V 12Ah sealed lead-acid battery
- 1 Charger 24V
- 2 heavy duty 360 W motors -- pre installed
- 1 FM radio with mp3 input (connection cord not included) -- pre installed
- assembly hardware
- parts to be assembled
- decals

- LOW speed: 3.5 mph - HIGH speed: 7 mph - Reverse: 3.5 mph

- For safety, this vehicle has been pre-set so it will only operate in LOW speed. See steps 75-77 to remove the HIGH speed lock-out.
- To prevent damaging the motor and gears, teach your child to stop the vehicle before switching directions.
- Use this vehicle ONLY outdoors. Most interior flooring can be damaged by riding this vehicle indoors. Peg Perego will not be responsible for damage to the floor if the vehicle is used indoors.
- Peg Perego reserves the right to modify or change its products. Price, literature, manufacturing processes or locations or any combination of the above mentioned entities may change at any time for any reason without notice with impunity.

## ⚠ CAUTION:

ELECTRIC VEHICLE NOT RECOMMENDED FOR CHILDREN UNDER 5 YEARS OF AGE. AS WITH ALL ELECTRIC PRODUCTS, PRECAUTIONS SHOULD BE OBSERVED DURING HANDLING AND USE TO PREVENT ELECTRIC SHOCK. RECHARGER INCLUDED. 120 VOLTS, 60Hz, 33W INPUT, 24 VOLTS (DC) OUTPUT.

### **⚠ CAUTION:**

Only adults should recharge batteries never children.

Never allow children to handle batteries.

Only use the batteries specified by the manufacturer. Only use the charger specified by the manufacturer.

Do not mix old and new batteries.

Do not mix alkaline, standard (carbon-zinc), or rechargeable (nickel-cadmium) batteries.

#### CHARGING THE BATTERY

- Charge the batteries no longer than 24 hours, following the instructions enclosed with the battery charger.
- Charge the battery, as the vehicle shows low power, in this way you will avoid damage to the battery.
- If you don't use your vehicle for a long period of time unplug the battery from the main wire harness of the vehicle. Remember to charge the battery at least every three months.
- Never charge the battery upside down.
- Do not forget batteries during charging! Check them periodically.
- Never use a replacement recharger or batteries unless they are approved by PEG PEREGO.
- Batteries are sealed and maintenance free.
- Battery polarity must be observed when connecting battery to wiring.

### **⚠ WARNING:**

- BATTERIES CONTAIN TOXIC AND CORROSIVE SUBSTANCES. DO NOT TAMPER WITH THEM.
- Batteries contain an acid-based electrolyte.
- Do not make direct contact between battery terminals, as this can cause an explosion or fire.
- Charging produces explosive gases. Charge batteries in a well ventilated area away from sources of heat and flammable materials.
- Exhausted batteries are to be removed from the vehicle.
- Do not place the batteries near clothing to avoid damage.

#### IF A LEAK DEVELOPS

Shield your eyes. Avoid direct contact with the electrolyte, protect your hands.

Place battery in a plastic bag and follow directions listed below.

#### IF ELECTROLYTE COMES IN CONTACT WITH SKIN OR CLOTHING

Flush with cool water for at least 15 minutes.

See a physician at once.

#### IF ELECTROLYTE IS INJECTED

Give tap water, milk of magnesia or egg whites at once.

Do not induce vomiting.

See a physician at once.

#### DISPOSAL OF BATTERIES

Help protect the environment!

Do not throw used batteries in your regular, household trash.

Dispose of the old batteries in an approved dumping station; contact your local environmental protection agency office for further information.



### **⚠ CAUTION AA BATTERIES**

The insertion of batteries must only be carried out or supervised by adults. Do not let children play with the batteries.

- The batteries should be replaced by an adult.
- Use only the type of battery specified by the manufacturer.
- Respect the polarity +/-
- Do not allow the batteries to be in contact with metal parts (risk of fire or explosion).
- Always remove the batteries if the toy is not in use for a long period.
- Do not throw batteries on the fire.
- Never attempt to charge batteries that are not rechargeable.
- Remove dead batteries from the toy.
- Dispose of dead batteries into containers provided for the recycling of dead batteries.





## INITIAL BATTERY CHARGE

!• Remove battery and charger from packaging. Connect battery charger to a 120vac wall receptacle. Connect battery charger to battery.

## ASSEMBLY INSTRUCTIONS

### CAUTION:

ADULT ASSEMBLY REQUIRED.

USE CARE WHEN UNPACKING AS COMPONENTS TO BE ASSEMBLED MAY POSE A SMALL PARTS/SHARP EDGE HAZARD.

BATTERY ALREADY INSTALLED IN VEHICLE.

- 1 • Lift both rear shock absorbers and line them up with the openings in the chassis.
- 2 • To fasten the shock absorbers to the chassis, insert the pins into the top holes on the shocks and press firmly into place.
- 3 • Before assembling the doorway "side nets" to the "side net tubes", check picture # 4 to establish left & right components. 8899DX = passenger side, 8899SX = drivers side.
- 4 • Assemble side nets onto side net tubes by placing the thin ring onto the small middle tube extension.
- 5 • And place the thick ring onto large (top) tube extension. The side net should snap onto the tube contour.
- 6 • Picture A shows front part of side net as it is being assembled. Picture B shows side net after it has been assembled.
- 7 • When installed on vehicle, side net tubes should angle away from body. Place notched tube into slotted door sill hole and push forward into slot.
- 8 • Pull out slightly on silver body panel (1) and flex side net tube to insert small middle tube extension into the hole in the body (2).
- 9 • Align silver body panel by inserting small extrusion into hole in chassis.
- 10 • Press firmly to snap silver panel back into place.
- 11 • Secure the profiles of the cargo box with the screws provided.
- 12 • Secure both sides using larger screws provided.
- 13 • Install left & right vertical roll-bar tubes into upper chassis (behind seats) and press down firmly. Note: To determine Left & Right, the "net tube" receptacle should be away from body with the opening to the front, the upper V shaped receptacle opening should be facing the rear.
- 14 • Insert the top of side net tube into lower roll bar receptacle.
- 15 • Secure both vertical tubes using standard screw provided.
- 16 • Secure the side bars to the vertical tubes with screw.
- 17 • Assemble rear (left & right) roll bar tubes
- 18 • Secure top with screw.
- 19 • Secure bottom with screw.
- 20 • Assemble cross-bar brackets onto rear roll-bar tubes.
- 21 • Bracket opening must be horizontal, not facing upward.
- 22 • Assemble cross bar tube into brackets.
- 23 • Insert machine screw in rear hole and nut in front hole (both sides).
- 24 • Tighten screws.
- 25 • On the roll-bar cross bar; you will see 3 recessed areas for the light brackets; NOTE: the wider recess (illus B) must face the rear. Place the cross bar onto the vertical tubes.
- 26 • Secure seat belts (and roll-bar top) to vertical roll-bar tubes with screws (Screws are in separate hardware bag).
- 27 • Assemble 3 roll-bar light brackets to roll-bar with screw holes facing rear and to the top.
- 28 • Attach roll-bar lights to rings with screws (in hardware bag).
- 29 • Locate front grill and note that it has many points of attachment (A-E).
- 30 • Begin attaching grill by inserting tabs A and B into silver hood slots until they lock.
- 31 • Insert tab D into silver hood slot until it locks.
- 32 • Pull bottom of grill down to allow 2 square holes to fit onto 2 pegs in chassis.
- 33 • Assemble front bumper onto round pegs on grill.
- 34 • Insert bottom bumper tab into slot E in lower grill.
- 35 • Install screw and tighten.
- 36 • Secure brush guard to grill using 2 of the standard screws provided.
- 37 • Apply the speedometer stickers.
- 38 • Position the speedometer in the dashboard provided hole over the radio.
- 39 • Insert tab into left hole and press right side to lock into place.
- 40 • Attach red ring to steering wheel by lining up the posts with the holes and pressing.
- 41 • Attach black center piece to steering wheel by lining up the posts with the holes and pressing.
- 42 • Remove protective plastic piece from steering column.
- 43 • Slide steering wheel down onto column. NOTE: be sure to align holes in steering wheel with holes in steering column.
- 44 • Press special screw through steering wheel and steering column and secure using matching nut.
- 45 • Insert T-handle in square slot on passenger side.
- 46 • Secure T-handle using standard screw provided.
- 47 • Snap gas cap into place on passenger's side of vehicle.
- 48 • Remove thumbscrews from seat bases.
- 49 • Place seat onto vehicle by lining up posts on seat base with holes in seat. NOTE: seat can be adjusted for the growth of the child.
- 50 • Replace thumbscrews to secure seat to vehicle.
- 51 • Rotate seat down into place.
- 52 • Secure using standard screw provided.
- 53 • Assemble windscreen. Illustration A shows it fully assembled.
- 54 • Secure meshes to tube with 3 screws.
- 55 • Place the windshield on the hood hooking the three central tabs.
- 56 • Secure windscreen to vehicle with screws.
- 57 • Install small hubcaps onto wheels.
- 58 • On rear bumper, apply reflective chrome decals. Then attach red plastic tail light lenses.
- 59 • On front, apply reflective chrome decals for headlights and fog lights. Attach clear head light lenses. For fog lights, place black plastic ring around clear circular lenses and snap into place.
- 60 • Remove 2 small screws from bottom of dashboard beneath radio.
- 61 • Remove radio by carefully releasing tabs at top of each side.
- 62 • Remove small screw on battery compartment door.
- 63 • Insert 2 AA batteries (not included) and replace battery compartment door.
- 64 • Replace radio into dashboard. NOTE: be sure to place antenna wire through opening in dashboard before inserting radio. Replace screws.

## BATTERY INSTALLATION

### WARNING:

WARNING: BATTERY CHARGING AND ANY OTHER OPERATION ON THE ELECTRICAL SYSTEM MUST BE CARRIED OUT BY ADULTS ONLY. THE BATTERY CAN ALSO BE CHARGED WITHOUT REMOVING IT FROM THE VEHICLE.

- 65 • Once battery is fully charged (light on charger is green), remove screw from passenger side seat and rotate up.
- 66 • Remove thumbscrews and lift seat up and out of vehicle.
- 67 • Remove 2 screws at front of seat base and remove seat base by lifting up and pulling out.
- 68 • Lower battery into compartment. NOTE: Be sure battery is setting all the way down correctly into compartment.
- 69 • Place battery plug through rear slot in seat base. Place vehicle wiring system plug through front slot.
- 70 • Replace seat base.

- 71 •Connect wiring system of the vehicle (plug B) to the battery (plug A).  
72 •Screw seat base. Replace seat and thumbscrews. Rotate seat down into place and secure screw.

#### VEHICLE FEATURES AND INSTRUCTIONS FOR USE

##### 73 •RADIO

- A- mp3 input jack (adaptor cord not included)
- B- Autotune
- C- Off button on left, On button on right
- D- Power indicator light
- E- Volume control
- F- Set buttons; hold down "set" button while pressing "HR" to change hour, "MN" to set minute

##### 74 •DASHBOARD

- A- Steering wheel
- B- Radio
- C- mp3 player compartment
- D- Passenger handle
- E- Accelerator pedal
- F- Gear shift lever
- G- Cupholder

- 75 •Exclusive **SmartPedal Technology™** feature allows for longer run times and more realistic driving. In "LOW" setting, when accelerator is pressed completely down, forward motion at 3.5 mph is activated. In "HIGH" setting, when pedal is pressed completely down, forward motion begins at 3.5 mph for a few seconds and then automatically accelerates to 7 mph. In "HIGH" setting, when pedal is released halfway, vehicle automatically "downshifts" to 3.5 mph. Brake activates automatically when the child takes his foot off the accelerator.

- 76 •ATTENTION: For safety, when the vehicle is first removed from the packing, it is in the LOW setting. Peg Perego suggests that the LOW setting be used until your child has become familiar with operating the vehicle.

- 77 •To adjust high speed lockout, loosen screw. Then slide safety collar down into HIGH setting and replace screw.

- 78 •**GEAR SHIFT LEVER** The vehicle has two directions. To use REVERSE (R), pullback and hold the gearshift lever. NOTE: For safety, gearshift must be held back in the reverse position.

- 79 •Exclusive Red Line Nitrile Traction™: The wheels on this vehicle feature an extra deep tread AND a special rubber traction band for incredible traction on most surfaces and a quiet ride.

- 80 •**CUP HOLDER** Place drinks for convenient storage. NOTE: Do not drink while driving.

- 81 •**CARGO BED** Space for transporting items. NOTE: Total weight capacity for vehicle is 150 lbs but do not exceed 30 lbs in the cargo bed. Children should not be allowed to ride in the cargo bed.

- 82 •**SEAT BELT** NOTE: The seatbelts on this vehicle are not real and do not provide any protection. They are for encouraging play that results in increased understanding and use of real seatbelts. To secure belt, insert tab into slot.

- 83 •To release, press button and pull tab out of slot.

- 84 •Adjust size of belt by moving plastic piece up or down.

#### BATTERY RECHARGER

- 85 •Remove screw from passenger side seat and rotate up.

- 86 •Remove thumbscrews and lift seat up and out of vehicle.

- 87 •Disconnect wiring system of the vehicle (plug B) to the battery (plug A).

- 88 •Plug the battery charger (C) into a household electrical outlet. Connect battery plug (A) to charger plug (C). NOTE: Press firmly until it snaps into place.

- 89 •After battery has finished charging (full charge takes 18-24 hours), disconnect battery charger from the electrical outlet and then disconnect the battery plug (A) from the charger plug (C).

- 90 •Reconnect electrical system plug (B) to battery plug (A). NOTE: Press firmly until it snaps into place.

#### BATTERY REPLACEMENT

- 91 •Remove screw from passenger side seat and rotate up.

- 92 •Remove thumbscrews and lift seat up and out of vehicle.

- 93 •Remove 2 screws from front of seat base. Disconnect battery.

- 94 •Lift up on seat base, remove wiring plugs and remove seat base.

- 95 •Lift drained battery out and lower fresh battery into place.

- 96 •Place battery plug through rear slot in seat base. Place vehicle wiring system plug through front slot.

- 97 •Replace seat base.

- 98 •Connect wiring system of the vehicle (plug B) to the battery (plug A).

- 99 •Screw seat base. Replace seat and thumbscrews. Rotate seat down into place and secure screw.

## RULES FOR SAFETY DRIVING

**DON'T STOP THE FUN:** purchase a spare battery to have a freshly charged back-up available.

For your child's safety: please read and follow all instructions below before operating.

### HIGH SPEED

Initially we suggest using only the LOW speed setting and the reverse gear. Before moving into HIGH speed setting be sure that the child has become familiar with operating the vehicle.

#### •LOW SPEEDsetting (beginner drivers):

With both hands on the steering wheel, press down on the accelerator pedal; the vehicle goes forward at 3.5mph.

#### •HIGH SPEEDsetting (experienced drivers):

With both hands on the steering wheel, press down on the accelerator pedal; the vehicle starts out at 3.5and then goes forward at 7 mph. Let up on the accelerator pedal halfway and the vehicle will "downshift" to 3.5 mph.

#### •REVERSE:

Place the left hand on the steering wheel. With the right hand holding the gearshift in reverse, press down on the accelerator pedal; the vehicle reverses at 3.5mph. (Reverse is spring-loaded for safety).

#### •BRAKE:

The electric braking system stops the vehicle automatically when your child lifts his foot off the pedal.

Teach your child the proper use of this vehicle for a safe and fun play time.

- Before starting be sure that the way is free from people and objects.
- Drive with both hands on the handlebar and keep your eyes on the road at all times.
- Stop in time to avoid accidents and immediately release pedal when stuck. • Use the 2nd speed only after your child has the maturity and the reflexes to operate the vehicle safely.

## **⚠ CAUTION:**

- If the vehicle is overloaded, as can happen on soft sand, mud, or very uneven ground, the overload switch will immediately disconnect the power. The power supply will be restored after a few seconds.

### **VEHICLE MAINTENANCE AND SAFETY**

This product meets and/or exceeds all ASTM (American Society for Testing and Materials) TOY SAFETY STANDARDS, including F 963, Consumer Toy Safety Specification.

This vehicle is not intended for use on streets, around traffic or parked cars.

#### **MAINTENANCE AND CARE**

- Regularly check the conditions of the vehicle, particularly the electrical system, the plug connections, the covering caps and the charger. In case of fault, do not try to use the vehicle and the charger. For repair use only original PEG PEREGO's spare parts.
- PEG PEREGO assumes no liability if the electrical system is tampered with.
- Do not leave vehicle or batteries near sources of heat such as radiators, stoves, fireplaces, etc.
- Protect vehicle from water, rain, snow, etc.
- When operating in overload conditions, such as soft deep sand, mud or rough uneven terrain, the overload circuit breaker will automatically disconnect the power. After 10 or more seconds, the circuit breaker will automatically reset, however you must eliminate overload conditions to resume normal driving.
- Periodically lubricate (with a light weight oil) moving parts, such as wheel bearings, steering linkages, where they rotate or touch one another.
- The vehicle's surfaces can be cleaned with a damp cloth. Do not use abrasive cleaners. The cleaning must be carried out by adults only.
- Never disassemble the vehicle mechanisms or motor unless authorized by PEG PEREGO.

#### **SAFETY**

### **⚠ WARNING:**

- To reduce the risk of injury, adult supervision is required. Never use in roadways, near motor vehicles, on or near steep inclines or steps, swimming pools or other bodies of water; always wear shoes, and never allow more than two riders.
- Surfaces that are appropriate for use: grass, gravel, hard surfaces and moderate slopes.
- Not suitable for children under the age of 5 years. The small pieces could be swallowed or inhaled.
- The dump bed is not designed to support a child's weight. Do not place loads over 30 lbs. in the dump bed.
- Please note that the seat belts and roll cage are designed for play use only and DO NOT provide any protection.
- Never use the vehicle on steep slopes or near steps or stairs. This vehicle is not suitable for use on public highways.
- Children should always wear shoes when riding in or driving a ride-in/ride-on vehicle.
- The use of a certified bicycle helmet is strongly recommended.
- Do not allow children to place their hands, feet or any part of their body, clothing or other articles near the moving parts while vehicle is in operation.
- Do not allow the electrical components, motors, wiring, switches of your motorized vehicle to become wet and never wash it with a hose.
- Never use gasoline or other flammable substances near the vehicle.

## PROBLEMS?

### IF THE VEHICLE DOES NOT OPERATE?

- **When operating in overload conditions, such as running the vehicle against a fixed object, through soft deep sand or mud, or over rough or uneven terrain, the overload circuit breaker will automatically disconnect the power. After 10 or more seconds, the circuit breaker will automatically reset, however you must eliminate overload conditions to resume normal driving.**
- Check that all plugs are properly connected.
- Check electrical switches. Replace if necessary.
- Check that the battery is connected to the electrical system.

### IF THERE IS NO POWER?

- Fully recharge the battery. If the problem persist, check with an Authorised PEG PEREGO Service Center.

## CUSTOMER SERVICE

For your convenience, PEG PEREGO offers after-sales service, directly or through a network of authorized service centers for repairs or replacement parts.

If you have any questions about your Peg Perego vehicle, please call our toll-free service lines at;

**U.S.A , call 1-800-728-2108**

**CANADA, call 1-800-661-5050**

Trained customer service representatives are available to take your call in English or Spanish.

## FCC STATEMENT United States Only)

This equipment has been tested and found to comply with the limits for a Class B digital device, pursuant to Part 15 of the FCC Rules. These limits are designed to provide reasonable protection against harmful interference in a residential installation. This equipment generates, uses and can radiate radio frequency energy and, if not installed and used in accordance with the instructions, may cause harmful interference to radio communications. However, there is no guarantee that interference will not occur in a particular installation. If this equipment does cause harmful interference to radio or television reception, which can be determined by turning the equipment off and on, the user is encouraged to try to correct the interference by one or more of the following measures:

- Reorient or relocate the receiving antenna.
- Increase the separation between the equipment and receiver.
- Consult the dealer or an experienced radio/TV technician for help.

**Note:** Changes or modifications not expressly approved by the manufacturer responsible for compliance could void the user's authority to operate the equipment.

In reference to the radio:



# STOP!

## Do not return your vehicle to the store!

We're a toll-free phone call away and we can help.  
If you are missing parts or need assistance, please see the contact information below.

# ¡ALTO!

## ¡No vuelva su vehículo al almacén!

Somos una llamada telefónica gratis lejos y podemos ayudar.  
Si usted es piezas que falta o necesita ayuda, vea por favor la información del contacto abajo.

# ARRÊTEZ!

## Ne renvoyez pas votre véhicule à la mémoire !

Nous sommes un appel téléphonique en service libre appel loin et nous pouvons aider.  
Si vous êtes les pièces manquantes ou avez besoin d'aide, voir s'il vous plaît l'information  
de contact ci-dessous.

**Model Number** **IGOD0514**

**PEG PEREGO U.S.A Inc.**

3625 INDEPENDENCE Dr. FORT WAYNE IN 46808  
fax 260-484-2940

**call us toll free 1-800-728-2108**

**llame USA gratis 1-800-225-1558**

**llame Mexico gratis 01-800-710-1369**

**PEG PEREGO CANADA Inc.**

585 GRANITE COURT PICKERING ONT. CANADA L1W3K1  
fax 905-839-9542

**call us toll free 1-800-661-5050**

**PEG PEREGO S.p.A.**

via DE GASPERI 50 20043 ARCORE (MI) ITALIA



[www.pegperego.com](http://www.pegperego.com)

This document was created with Win2PDF available at <http://www.win2pdf.com>.  
The unregistered version of Win2PDF is for evaluation or non-commercial use only.  
This page will not be added after purchasing Win2PDF.