

This Owner's Manual is provided and hosted by [Appliance Factory Parts](#).



ESSICK EA1201 Owner's Manual

[Shop genuine replacement parts for ESSICK EA1201](#)



[Find Your ESSICK Humidifier Parts - Select From 54 Models](#)

----- Manual continues below part list -----

Available Replacement Parts for ESSICK EA1201

1B5460070	CASTER SET OF 4
830496	Support Float
829816	Float
1B72450	Fill door.
1B72487	Fill Float
1B72444	Wick frame top.
HDC311	WICKS, 3 PACK
1B72445	Wick frame bottom.

READ AND SAVE THESE INSTRUCTIONS



**EVAPORATIVE
HUMIDIFIER**

**OWNER'S
CARE
&
USE
MANUAL**

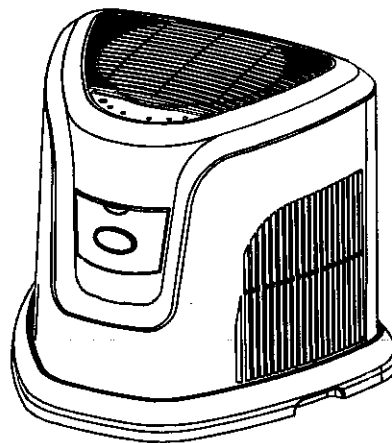

MODEL:

EA1201 Silver and Black

- Touch screen control
- Variable Speed Motor
- Automatic Humidistat
- Automatic Shutoff
- Nighttime Setting

*French and Spanish
Instructions included.*

*Se incluyen instrucciones
En Español y Francés.*

*Directives en Français et en
espagnol compris*



**SAVE THE ENVIRONMENT
RECYCLE APPROPRIATE MATERIALS**

*To order parts and accessories call
1-800-547-3888*

IMPORTANT SAFEGUARDS

General Safety Instructions

READ BEFORE USING YOUR HUMIDIFIER

DANGER: means if the safety information is not followed someone will be seriously injured or killed.

WARNING: means if the safety information is not followed someone could be seriously injured or killed.

CAUTION: means if the safety information is not followed someone may be injured.

1. To reduce the risk of fire or shock hazard, this humidifier has a polarized plug (one blade is wider than the other.) Plug humidifier directly into a 120V, A.C. electrical outlet. Do not use extension cords. If the plug does not fully fit into the outlet, reverse plug. If it still does not fit, contact a qualified electrician to install the proper outlet. Do not change the plug in any way.
2. Keep the electric cord out of traffic areas. To reduce the risk of fire hazard, never put the electric cord under rugs, near heat registers, radiators, stoves or heaters.
3. Always unplug the unit before moving, cleaning or removing the fan assembly section from the humidifier, or whenever it is not in service.
4. Keep the humidifier clean.
5. Do not put foreign objects inside the humidifier.
6. Do not allow unit to be used as a toy. Close attention is necessary when used by or near children.
7. To reduce the risk of electrical hazard or damage to humidifier, do not tilt, jolt or tip humidifier while unit is running.
8. To reduce the risk of damage to humidifier, unplug when not in use.
9. To reduce the risk of accidental electrical shock, do not touch the cord or controls with wet hands.
10. To reduce the risk of fire, do not use near an open flame such as a candle or other flame source.

WARNING: For your own safety, do not use humidifier if any parts are damaged or missing.

WARNING: To reduce risk of fire, electric shock, or injury always unplug before servicing or cleaning.

WARNING: To reduce the risk of fire or shock hazard, do not pour or spill water into control or motor area. If controls get wet, let them dry completely and have unit checked by authorized service personnel before plugging in.

INTRODUCTION

Your Essick Air evaporative humidifier adds invisible moisture to your home by moving dry air through a saturated wick. As air moves through the wick, the water evaporates into the air, leaving behind any white dust, minerals, or dissolved and suspended solids. Because the water is evaporated, there is no messy mist or spray, just clean and invisible moist air.

As the evaporative wick traps accumulated minerals from the water, its ability to absorb and evaporate water decreases. We recommend changing the wick at the beginning of every season. In hard water areas, more frequent replacement may be necessary to maintain your humidifier's efficiency.

Use only Essick Air brand replacement wicks and chemicals. To order parts, wicks and chemicals call 1-800-547-3888. The EA1201 humidifier uses 3 Wicks part number HDC311. Only the Essick Air evaporative wick guarantees the certified output of your humidifier. Use of wicks other than Essick Air brand may void your warranty as well as the certification of output and may reduce the efficiency of your humidifier.

ABOUT YOUR HUMIDIFIER

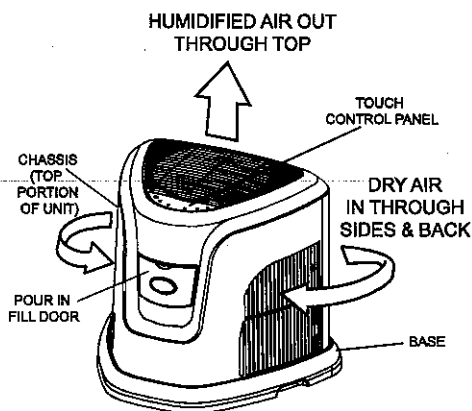

How it Works

Dry air is drawn into the unit through the sides where the air is pulled through the saturated wicks and becomes moisturized before it is fan forced out the top of the unit to the room.

FEATURES

Output per 24 hrs	12 gallons
Water capacity	3.5 gallons
Sq. ft. coverage	2500 (avg. construction)
	3000+ (tight construction)
Fan Speeds	Variable (9)
Replacement wicks	HDC311
Automatic humidistat	Yes
Auto shutoff	Yes
Control type	Digital Touchscreen
Volts	120
Hertz	60
Watts	80

NOTE: If excessive condensation forms, reduce set humidity level until condensation no longer forms

Location Tips

Place humidifier in area that needs most humidity is needed or where moist air will be circulated throughout house such as near a cold air return.

DO NOT place unit:

- directly in front of hot air duct or radiator.
- near thermostat or hot air register
- next to window
- up against heavy drapery of curtains

ASSEMBLY

UNPACKING AND SETTING UP THE UNIT

1. Open the carton and lift out the humidifier.
2. Lift the humidifier chassis (top part) off the base to locate the accessory kit inside, including:
 - ◆ Caster kit
 - ◆ Bacterial treatment sample
 - ◆ Evaporative Wicks (3)
 - ◆ Manual

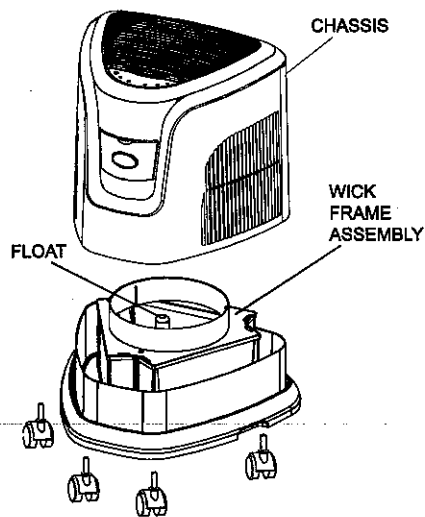

CASTERS

3. Remove wick frame and float assembly from base.
4. Turn the base upside down. Insert each caster stem into a caster hole on each corner of the humidifier bottom. The casters should fit snugly and be inserted until the stem shoulder reaches the cabinet surface. Turn the base right side up. Replace float back in its place.

EVAPORATIVE WICKS

5. Three (3) HDC311 wicks (provided) fit into the wick frame.
6. To replace wicks separate the wick frame top from the wick frame base and slide wicks into each of the three sections. Secure wick frame top to the base by positioning the slots on the top onto the tabs on the base.
7. Ensure the float is in position, place the chassis onto the base and the unit is ready for filling.

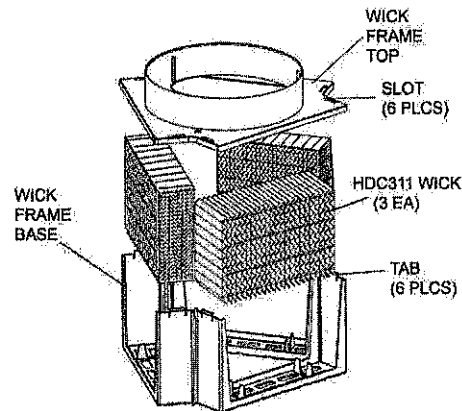

FILLING INFORMATION

8. Your humidifier is equipped with a convenient front pour-in door. Use a pitcher to fill the unit through the spout door. When the door is opened an LED light illuminates the MAX FILL line inside. The reservoir holds 3.5 gallons. Do Not Overfill.

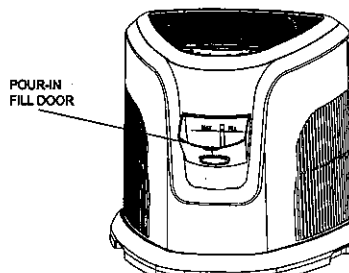

NOTE: Fill unit with cool, fresh (preferably unsoftened) water. If you only have softened water available in your home, you can use it, but mineral buildup will occur more quickly.

NOTE: On initial fill up, it will take approximately 20 minutes for the wick to become fully saturated.

CONTROLS AND OPERATION

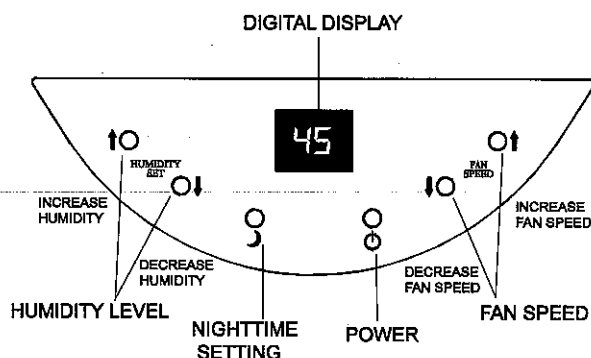

1. Plug cord into wall receptacle. Your humidifier is now ready for use. The humidifier should not be near any heat registers.

2. Place the unit at least FOUR inches away from any walls. Unrestricted airflow into the unit will result in the best efficiency and performance.

3. The digital touch screen panel allows you to control the fan speed and humidity level by simply tapping the appropriate up or down arrow switch on the front of the panel.
4. A digital display provides information on the status of the unit. Depending on which function is being accessed, it displays ambient and set humidity, fan speed and status of the unit.

FAN SPEED

5. Tap the up arrow or down arrow on the FAN SPEED section to adjust the fan. The display will show F1 through F9 proceeding from low to high speed.

NOTE: When excessive condensation exists, a lower speed setting is recommended.

HUMIDITY CONTROL

NOTE: The EA1201 has an automatic humidistat that cycles the humidifier on and off as required to maintain the selected setting.

6. At initial startup the ambient humidity of the room will be displayed.
7. Tap the up or down arrow in the HUMIDITY SET section of the panel to adjust the humidity level in 5% increments. At 65% set point, the unit will operate continuously.

OTHER INDICATIONS

8. When the unit runs out of water the control will display a flashing "F". When the unit is completely out of water, the motor will shut off.
9. This humidifier has a check filter reminder timed to appear after 720 hours of operation. When the Check Filter (CF) message is displayed, disconnect the power cord and check the condition of the filter. The CF function is reset after plugging the unit back in.

NIGHTTIME SETTING

10. As a convenience, a nighttime setting switch (Crescent moon) extinguishes all lights on the control panel but leaves all settings in their current state. Touch any of the switches to reset the panel to the normal lighting.

CARE AND MAINTENANCE

CAUTION: Disconnect power before filling, cleaning or servicing unit. Keep grille dry at all times.

Cleaning your humidifier regularly helps eliminate odors and bacterial / fungal growth. Ordinary household bleach is a good disinfectant and can be used to wipe out the humidifier base and bottle/reservoir after cleaning. We recommend cleaning your humidifier at least once every two weeks to maintain optimum environmental conditions for your home.

We also recommend using Essick Air Bacteriostat Treatment each time you refill your humidifier to eliminate bacterial growth. Add bacteriostat according to the instructions on the bottle. Please call 1-800-547-3888 to order Bacteriostat Treatment reference part number 1970.

1. Turn off unit completely and unplug from outlet.
2. Lift out the water bottles and the power pack.
3. Carry bottles and base to cleaning basin. Lift wick from the base allowing the water to drain. Rinse wick under fresh water only. Do not use soap, detergent, or any other cleaners on the wick. Leave in sink to drain.

REMOVING SCALE

4. Empty the water from the reservoir. Fill reservoir $\frac{1}{2}$ full with fresh water and add 8 oz. (1 cup) of white vinegar. Let stand 20 minutes. Then empty solution.
5. Dampen a soft cloth with white vinegar and wipe out reservoir to remove scale. Rinse the reservoir thoroughly with fresh water to remove scale and cleaning solution before disinfecting.

DISINFECTING UNIT

6. Fill reservoir $\frac{1}{2}$ full with water and add 1 teaspoon of bleach to each. Wipe cabinet and reservoir surfaces with this solution. Let solution stay for 20 minutes, then rinse with water until bleach smell is gone. Dry with clean cloth.
7. Refill unit and re-assemble per ASSEMBLY instructions.

SUMMER STORAGE

1. Clean unit as outlined in Care & Maintenance section.
2. Discard used wick and any water in the reservoir or bottles and allow to dry thoroughly before storage. Do not store with water inside reservoir or bottles.
3. Do not store unit in an attic or other high-temperature area, as damage will occur.
4. Install new filter at beginning of season.

Parts List for EA1201

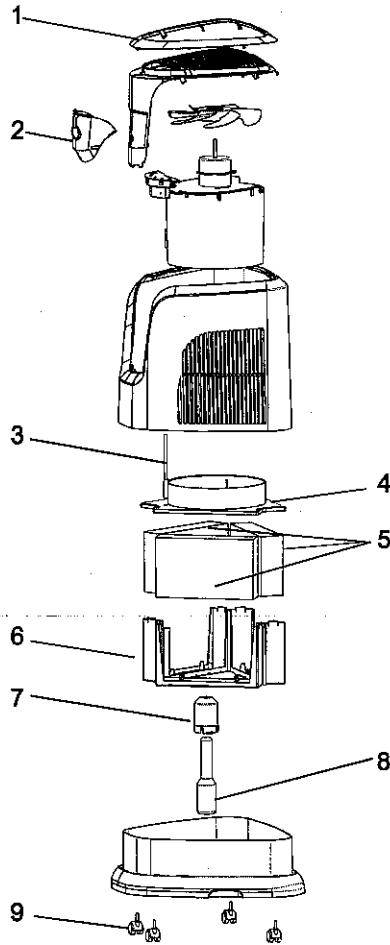

Replacement Parts Available for Purchase		
Item no.	Description	Part Number
1	Trim Ring	1B72447
2	Fill Door	1B72450
3	Fill Float	1B72487
4	Wick Frame Top	1B72444
5	Wicks (3)	HDC311
6	Wick Frame Bottom	1B72445
7	Float Retainer	S98830496C002
8	Float	F34829816
9	Casters (4)	1B5460070
10	Manual (not shown)	1B72484

**ESSICK AIR PRODUCTS
HUMIDIFIER WARRANTY
POLICY**

EFFECTIVE APRIL 1, 2013

**SALES RECEIPT REQUIRED AS PROOF OF
PURCHASE FOR ALL WARRANTY CLAIMS.**

This product is warranted against defects in workmanship and materials as listed below:

One year from the date of sale on factory installed components.

Two years from the date of sale on motor and control.

Thirty (30) days on replacement components.

This warranty does not apply to filters or wicks which are customer replaceable parts.

This warranty applies only to the original purchaser of the product when it is purchased from a reputable retailer/dealer.

This warranty does not apply to damage from accident, misuse, alterations, unauthorized repairs, unauthorized use, mishandling, unreasonable use, abuse, including failure to perform care and maintenance as listed in the owner's manual, normal wear and tear, nor where the connected voltage is more than 5% above the nameplate voltage, nor to the equipment or products being improperly installed or wired or maintained in violation of this Owner's Manual.

Alterations include the substitution of name brand components including, but not limited to wicks and bacteria treatment.

THIS PRODUCT IS NOT INTENDED FOR COMMERCIAL USE. THIS IS THE SOLE AND EXCLUSIVE WARRANTY GIVEN BY MANUFACTURER WITH RESPECT TO THE PRODUCTS AND, TO THE MAXIMUM EXTENT PERMITTED BY LAW, IS IN LIEU OF AND EXCLUDES ALL OTHER WARRANTIES AND CONDITIONS, EXPRESSED OR IMPLIED, ARISING BY OPERATION OF LAW OR OTHERWISE, INCLUDING WITHOUT LIMITATION, MERCHANTABILITY AND/OR FITNESS FOR A PARTICULAR PURPOSE.

No employee, agent, dealer or other person is authorized to give any warranties or conditions on behalf of the manufacturer. The customer shall be responsible for all costs incurred in the removal or reinstallation and shipping of the product for repairs.

Within the limitations of this warranty, purchaser with inoperative units should contact customer service @ 800-547-3888 for paperwork and instructions on the return of the unit for replacement. A copy of the sales receipt is required before authorization to return a unit for repair is approved. The manufacturer will replace the chassis, at its discretion, with return freight paid by the manufacturer and that TO THE MAXIMUM EXTENT PERMITTED BY LAW, THE MANUFACTURER IS NOT RESPONSIBLE FOR DAMAGES OF ANY KIND, INCLUDING INCIDENTAL AND CONSEQUENTIAL DAMAGE OR LOSS OF PROFITS OR REVENUES.

This warranty will be null & void if purchaser attempts to repair or replace any parts which are mechanical or electrical.

The warranty gives the customer specific legal rights, and the customer may also have other rights which vary from province to province, or state to state.