



**Outdoor Gas Barbeque/Grill  
Gril À Gaz**

**Assembly Manual and Parts List  
Manuel De Montage et Liste De Pieces**



**broil-mate™**  
**30040BMT**

**HUNTINGTON™**  
**30040HNT**

MADE IN USA  
FABRIQUÉ EN USA

Onward Manufacturing Company (LTD)  
Canada: 585 Kumpf Drive      USA: 1 Fiesta Drive  
Waterloo, ON N2V1K3      Dickson, TN 37055-7716

SP5558-37 Rev A 09/12

1-800-387-8643

**FOR OUTDOOR USE ONLY**

**UTILISER À L'EXTÉRIEUR SEULEMENT**

[www.omcbbq.com](http://www.omcbbq.com)

**1**

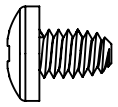
(8) 

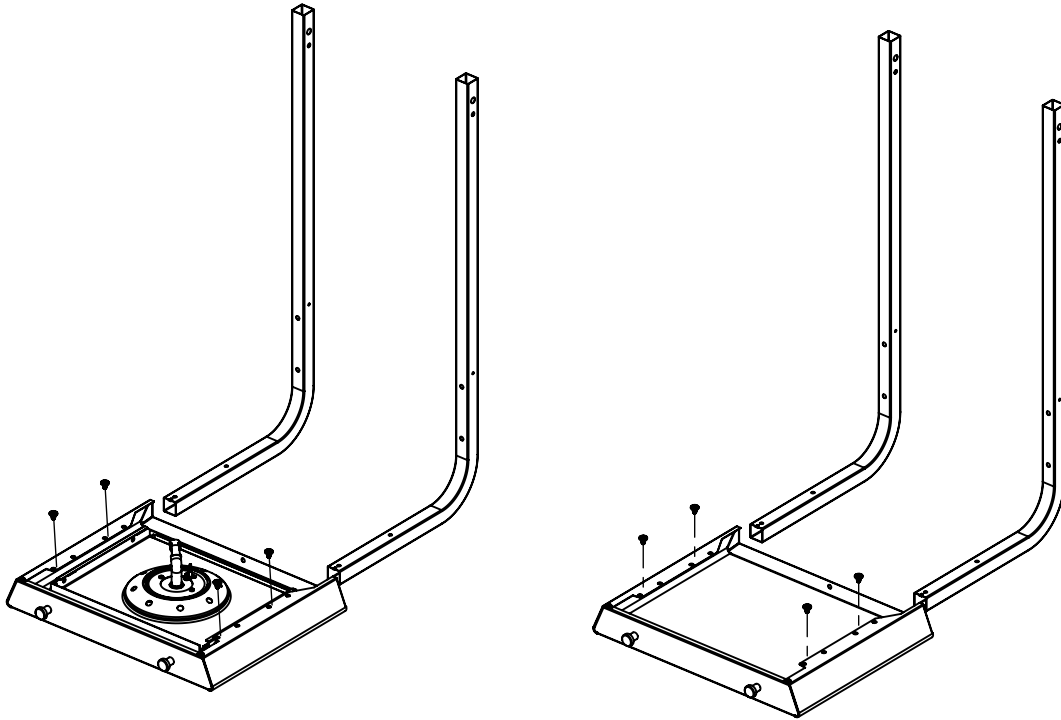

**2**

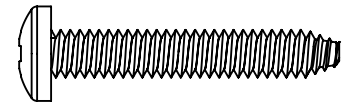
(4) 

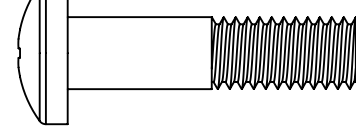
(2) 

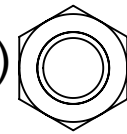
(2) 

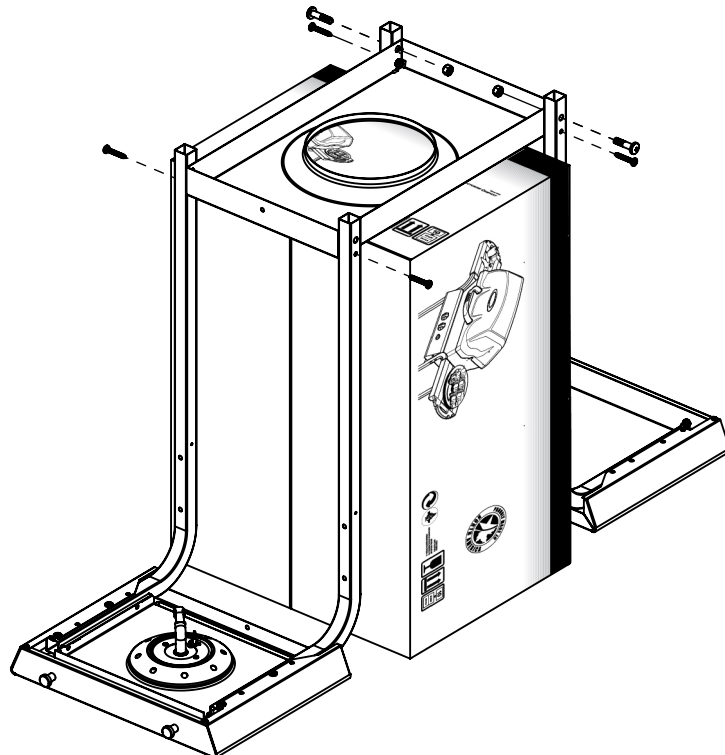

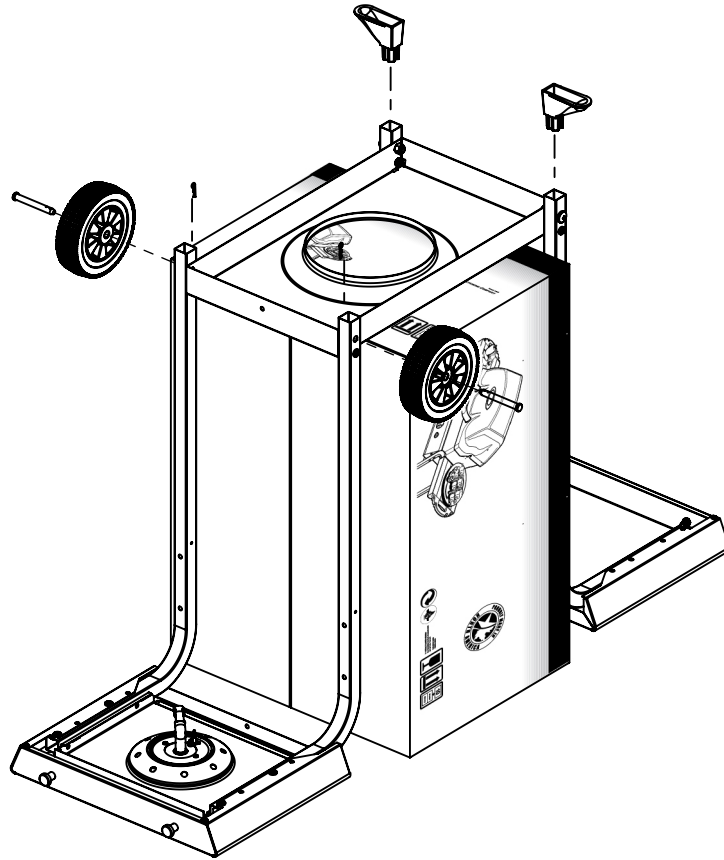
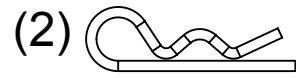
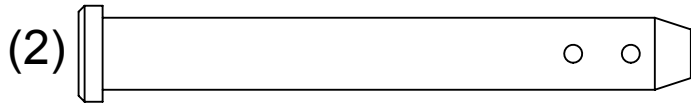

**3**

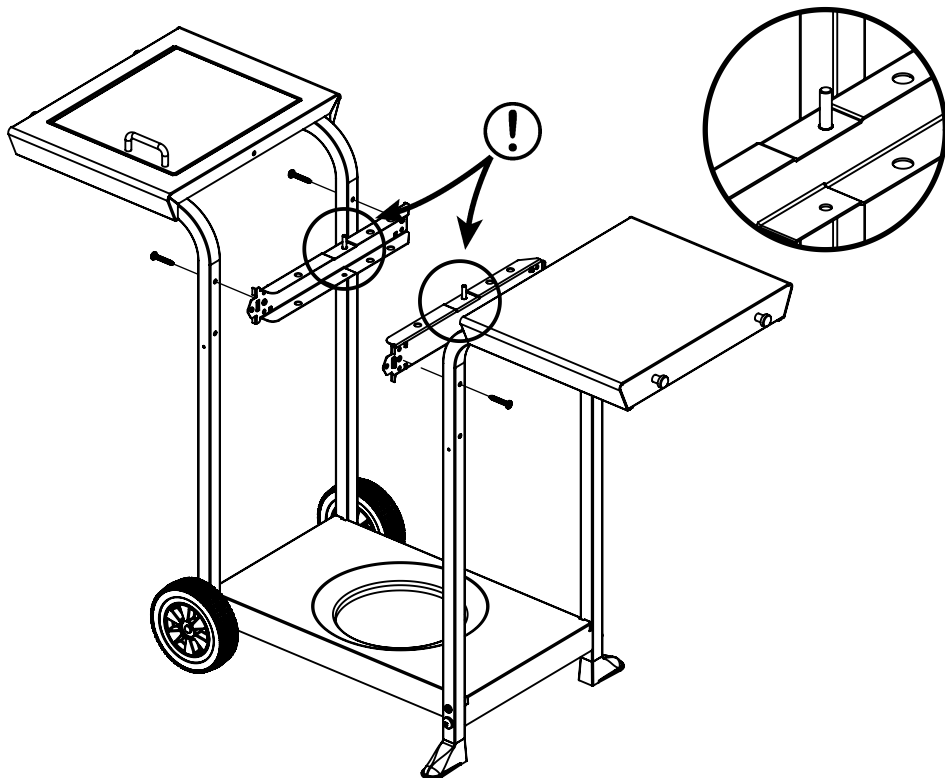
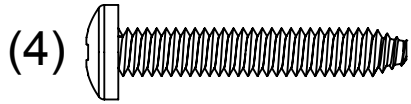

**4**

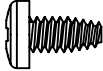

5

(2)  (2)  (2) 

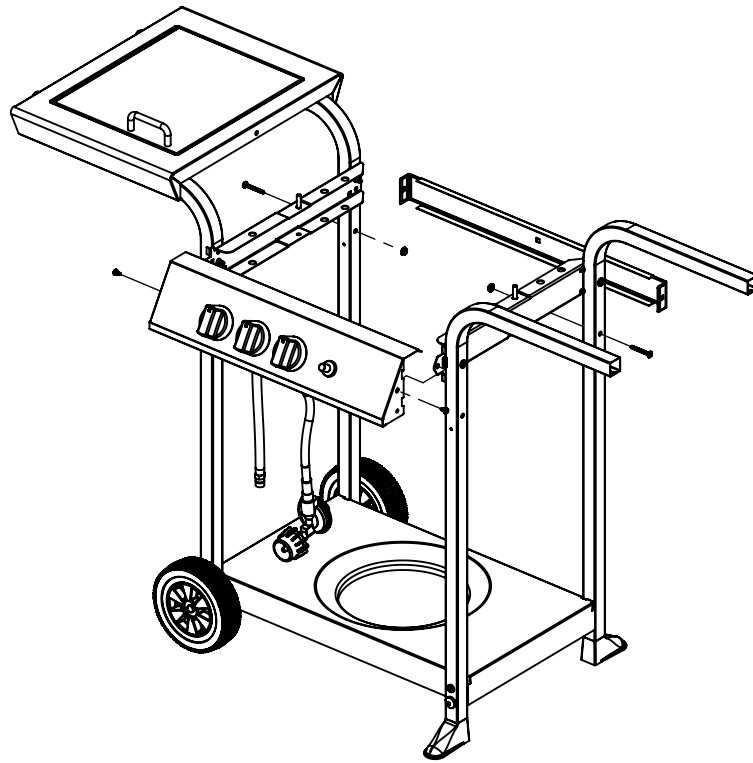

6

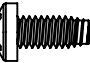
(2) 

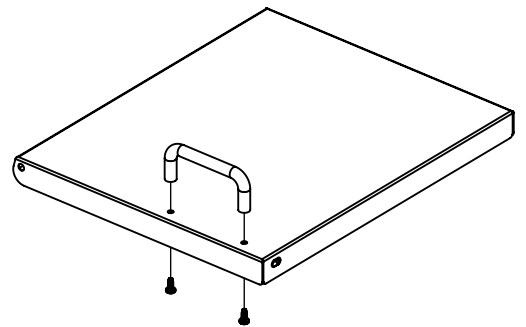
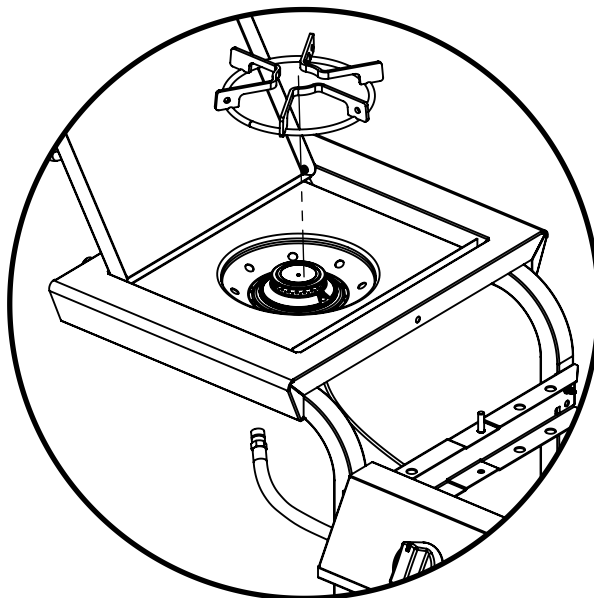
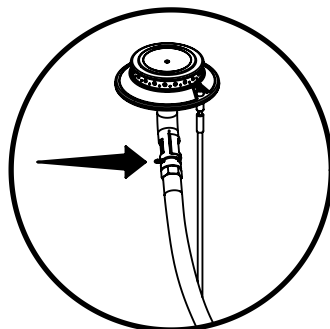
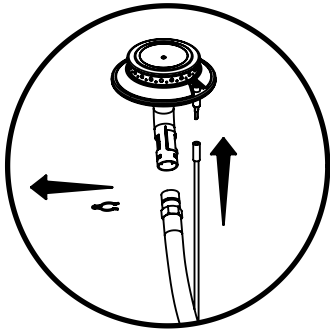

7

(2)

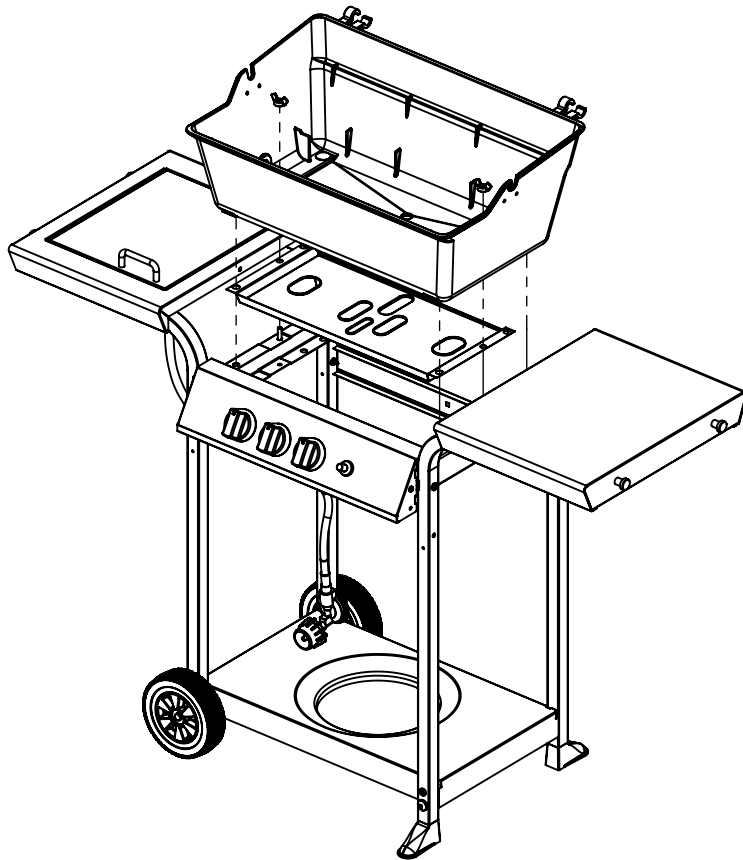
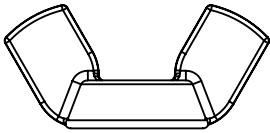

8

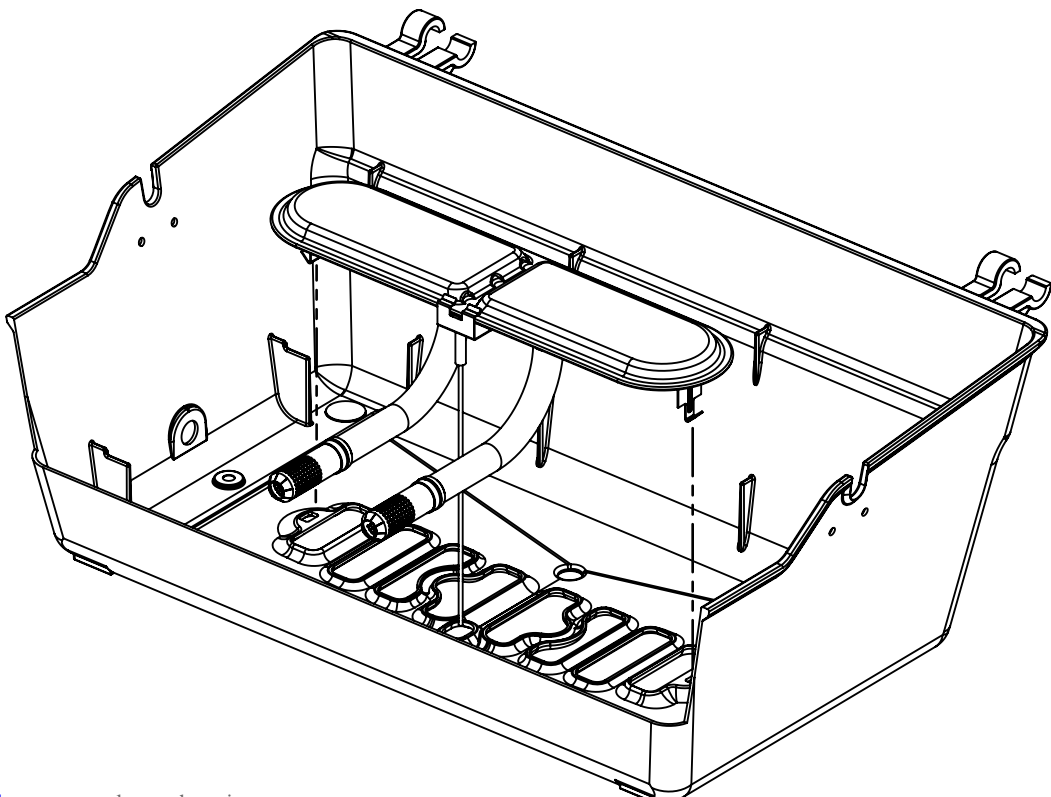

9

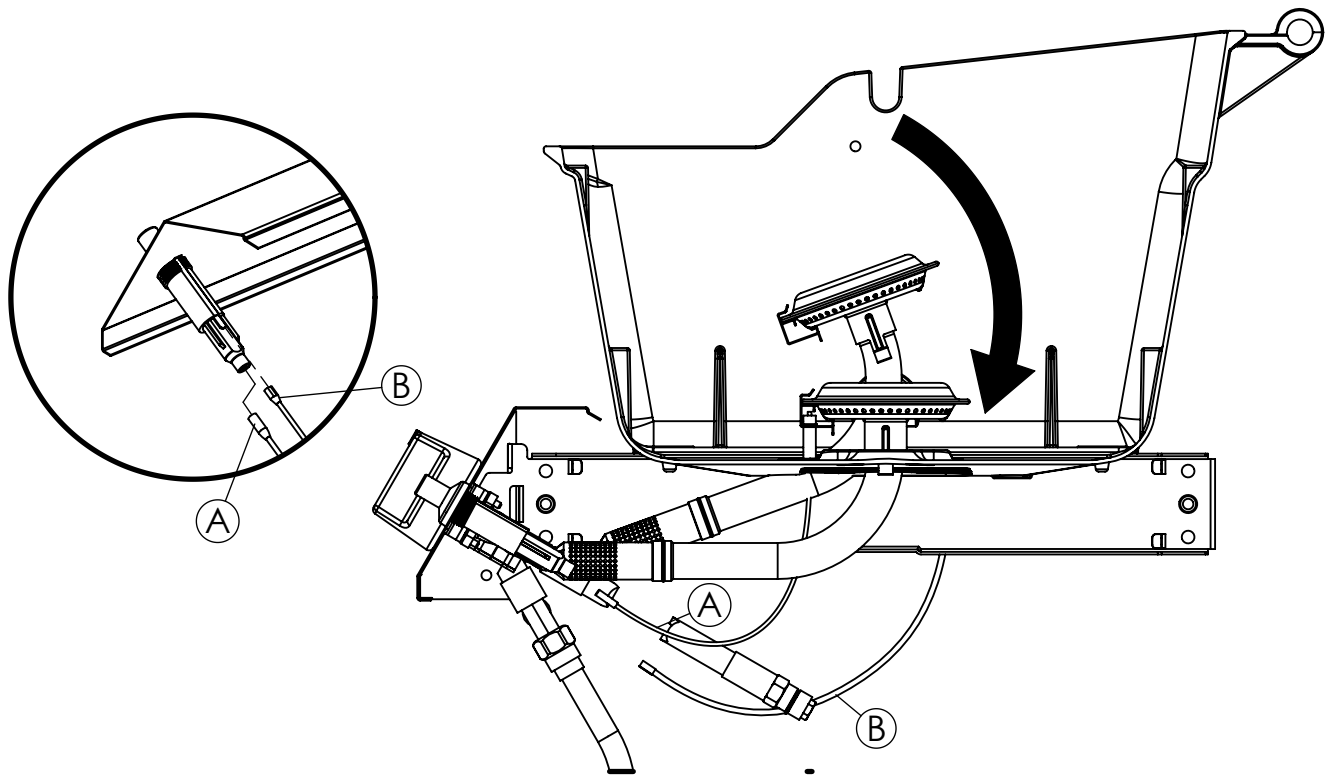

10

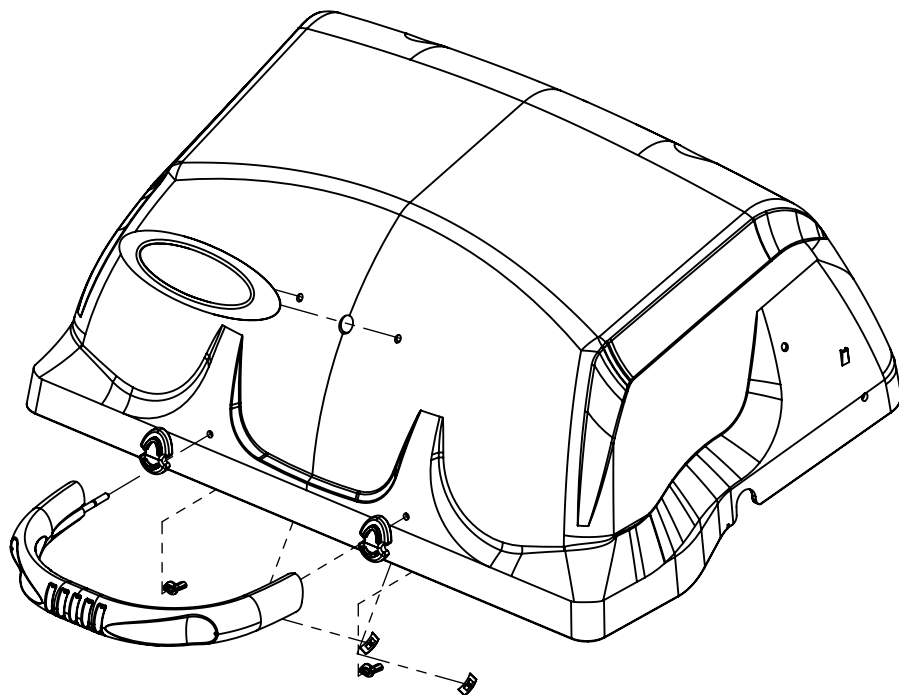
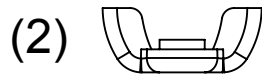

11

(1)

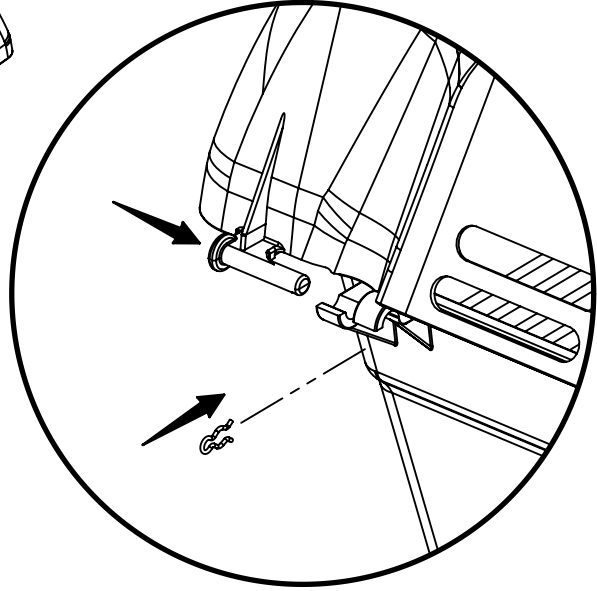
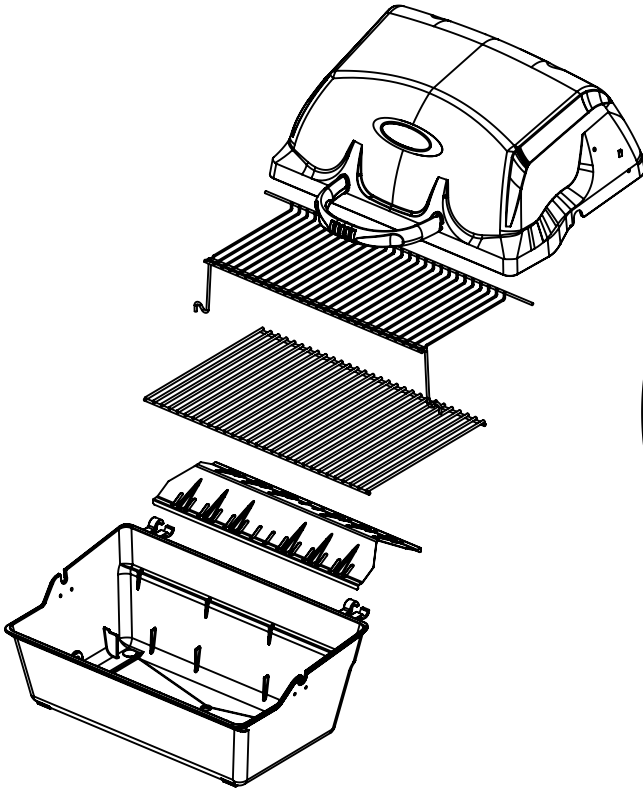
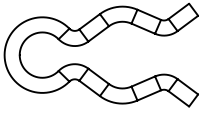

12

(1)

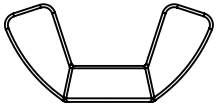

(1)

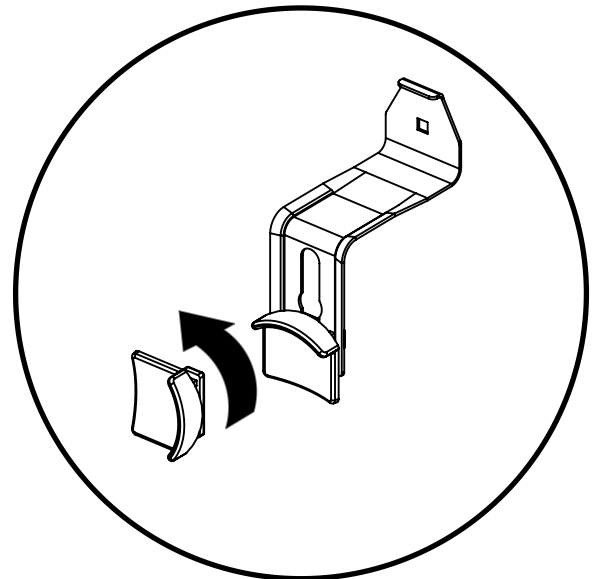
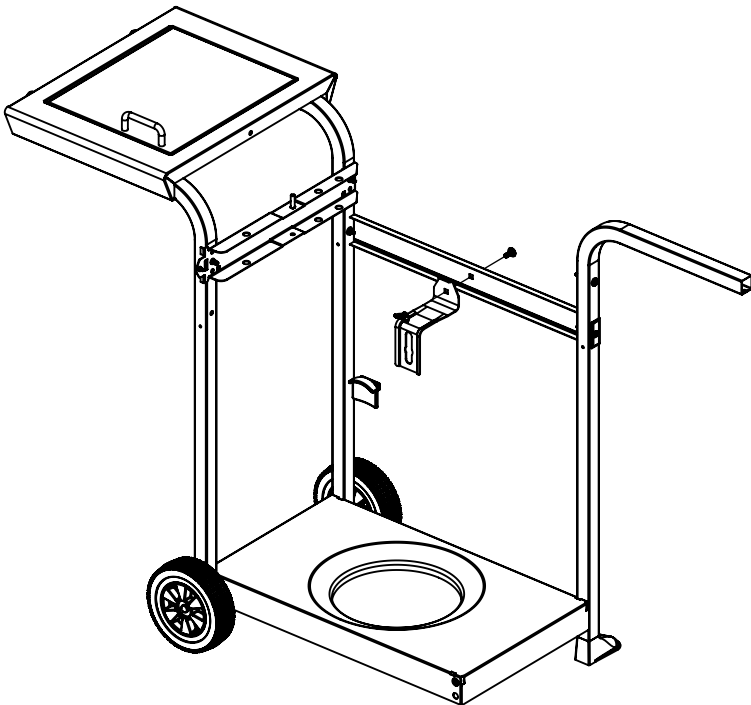
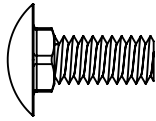

13

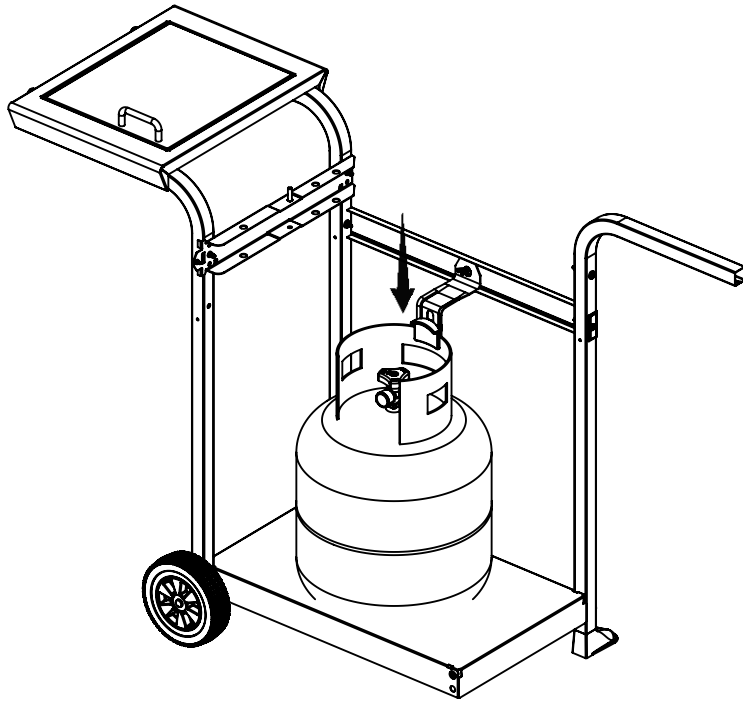

14

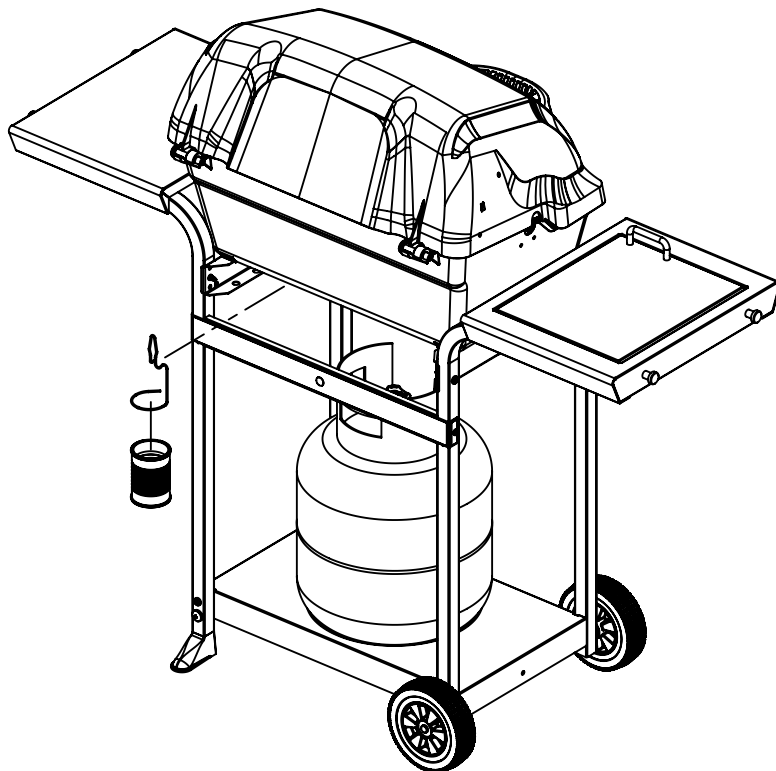

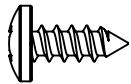

**15**

(2) 

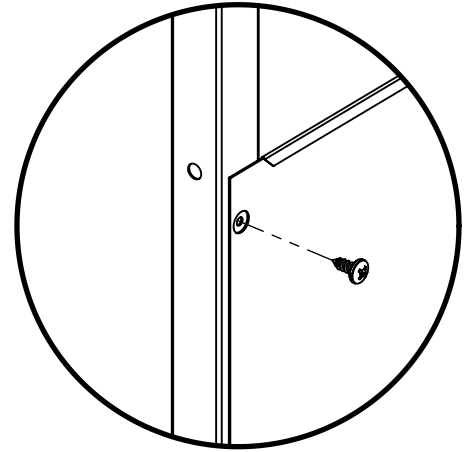
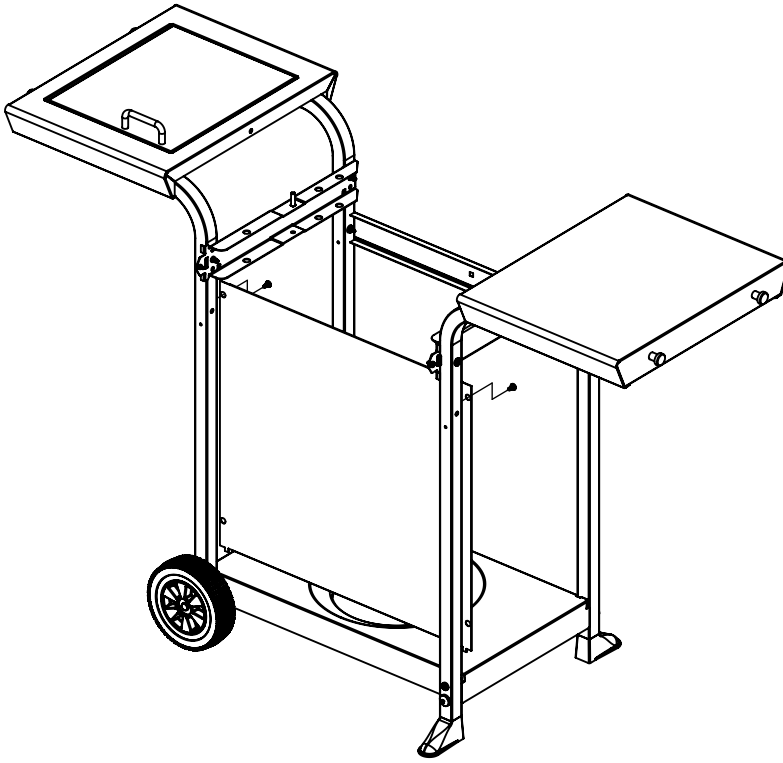

**16**

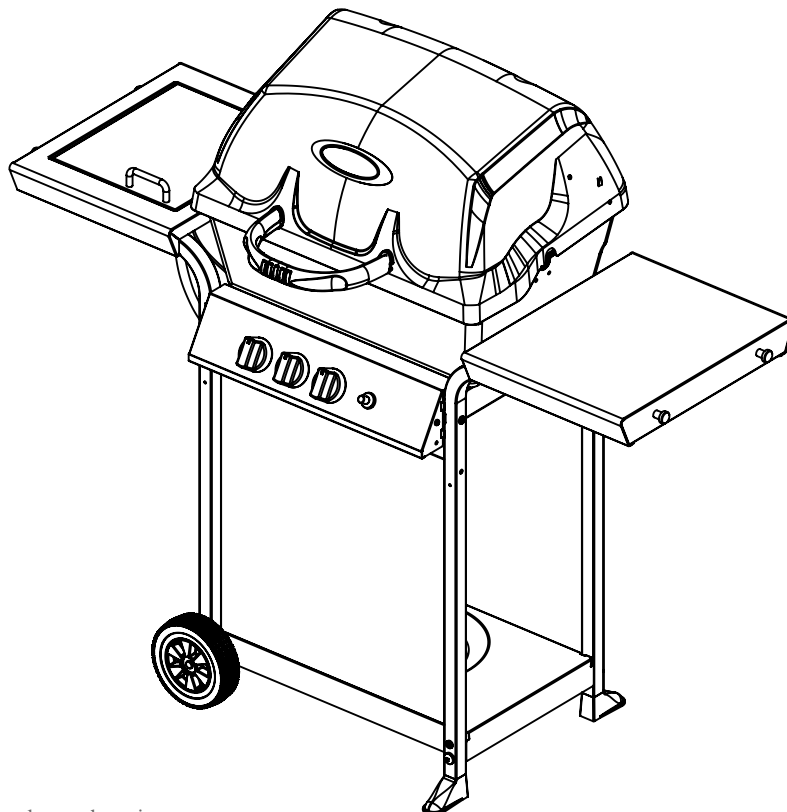

ITEM #	PART #	DESCRIPTION	DESCRIPTION	30030BMT	30030HNT
1	SM51A-1B	CASTING TOP	COUVERCLE DU GRILL	1	1
2	SM5003-2B	CASTING BOTTOM	FOND DU FOYER	1	1
3	10081-F607	NAMEPLATE	PLAQUE D'IDENTIFICATION	-	1
	10081-BM607			1	-
4	SP5022-3	GRID-WARMING RACK	GRILLE	1	1
5	SP43A-3	GRID	GRILLE	1	1
6	SP69-9	FLAV-R-WAVE	FLAV-R-WAVE	1	1
7	SM190A-12	BURNER ASM	ENSEMBLE DE BRULEUR	1	1
8	SP5016-20	ELECTRODE	ELECTRODE	1	1
9	SP5038-19A	LID HANDLE	POIGNEE	1	1
10	SP5001-40	CASTING STANDOFF	SUPPORT DE GUIDON	2	2
20	SM5032-311	CONTROL COVER	PANNEAU DE CONTROLE	1	1
21	10442-534	CONTROL ASM LP	SOUPAPE	1	1
22	10114-12	HOSE & REGULATOR LP - Q	TUYAU ET REGULATEUR PL - Q	1	1
23	SP11-7	CONTROL KNOB	BOUTON DE CONTROL	3	3
24	10342-22	IGNITOR	ALLUMEUR	1	1
25	S13467-091	SIDE BURNER HOSE	TUYAU DU BRÛLEUR LATÉRAL	1	1
30	SM5069-9	HEAT SHEILD	PROTECTION LA CHALEUR	1	1
32	SM5038-8B	BENT LEG	JAMBE COUDÉE	4	4
35	SM5397A-42B	SUPPORT CASTING LEFT	SUPPORT DU FOYER GAUCHE	1	1
36	SM5398A-42B	SUPPORT CASTING RIGHT	SUPPORT DU FOYER DROIT	1	1
39	SM5004A-6B	BRACE - UPPER REAR	SUPPORT ARRIERE	1	1
40	10711-E401R	BASE	BASE	1	1
46	SM5066-6B	BRACKET - CYLINDER LP	SUPPORT DU RESERVOIR PL	1	1
47	SP21-6	CYLINDER CLAMP	CYLINDER DE SERRAGE	1	1
50	10711-E231	SHELF - SIDE	PLANCHETTE LATÉRALE	1	1
51	10711-E241	SHELF - SIDE BURNER	PLANCHETTE - BRÛLEUR LATÉR	1	1
54	10956-E601	FRONT PANEL	PANNEAU AVANT	1	1
55	SP5018-18	SCREW #10	VIS #10	2	2
56	SP5004-22SC	WHEEL	ROUE	2	2
57	10393-E62	SIDE BURNER - BODY	BRÛLEUR LATÉRAL - PLATEAU	1	1
58	10390-E10	SIDE BURNER	BRÛLEUR LATÉRAL	1	1
59	10225-T09	SIDE BURNER - TRIVET	BRÛLEUR LATÉRAL - TRIVET	1	1
60	10393-E401	SIDE BURNER - COVER	BRÛLEUR LATÉRAL - COUVERTU	1	1
61	PB20-60	SIBE BURNER - COVER HAN	BRÛLEUR LATÉRAL - POIGNÉE	1	1
62	10342-T16	ELECTRODE WIRE	FIL ÉLECTRODE	1	1
63	Y-11230	CLIP	CLIP	1	1
77	S15111	GREASE CUP HOLDER	PORTE CONTENANT A GRAISSE	1	1
78	11494-148	LEG PLUG	PLUG JAMBE	2	2
80	SP25-16	1/4-20 WING NUT	ECROU PAPILLON 1/4-20	2	2
81	Y-11560	BOLT 1/4-20 x 1 1/2	BOULON 1/4-20 x 1 1/2	8	8
83	S21141	CARRIAGE BOLT 1/4-20 x 5/8	BOULON 1/4-20 x 5/8	1	1
88	Y-11598	WING NUT 1/4-20	ECROU PAPILLON 1/4-20	1	1
91	Y-11968	BOLT 3/8-16 x 1 3/4	BOULON 3/8-16 x 1 3/4	2	2
92	Y-12285	NUT 3/8	ECROU 3/8	2	2
93	Y-29320	BOLT 10-24 x 1 3/4	BOULON 10-24 x 1 3/4	2	2
94	32010190	BOLT 10-24 x 1/2	BOULON 10-24 x 1/2	2	2
95	Y-29304	BOLT 10-24 x 3/8	BOULON 10-24 x 3/8	2	2
96	S21061	WING NUT 10-24	ECROU PAPILLON 10-24	2	2
97	10240-13	PIN	GOUPILLE	2	2
98	S21233	COTTER PIN	GOUPILLE	2	2
99	SP5004-15	CLIP	CLIP	1	1
101	SP23-16	NUT 10-24	ECROU 10-24	2	2
102	S21125	SCREW #8 x 3/8	VIS #8 x 3/8	4	4
103	Y-12855	SCREW 1/4-20 x 3/8	VIS 1/4-20 x 3/8	8	8
104	Y-12835	SCREW #6 x 3/8	VIS #6 x 3/8	2	2
105	Y-12646	SCREW #8 x 1/2 - SHOULDEF	VIS #8 x 1/2 - EPAULE	2	2
106	Y-11987	TOOL HOOK	CROCHET OUTIL	4	4
107	23502-507	SPACER	ENTRETOISE	4	4
108	Y-11793	NUT 1/4-20	ECROU 1/4-20	4	4
109	S21136	SCREW #8-32 x 3/8	VIS #8-32 x 3/8	2	2

