

HEAT CONTROLLER, INC.

REPLACEMENT PARTS LIST

**Room Air Conditioner with R-410A:
REG-253J**

EXPLODED VIEW

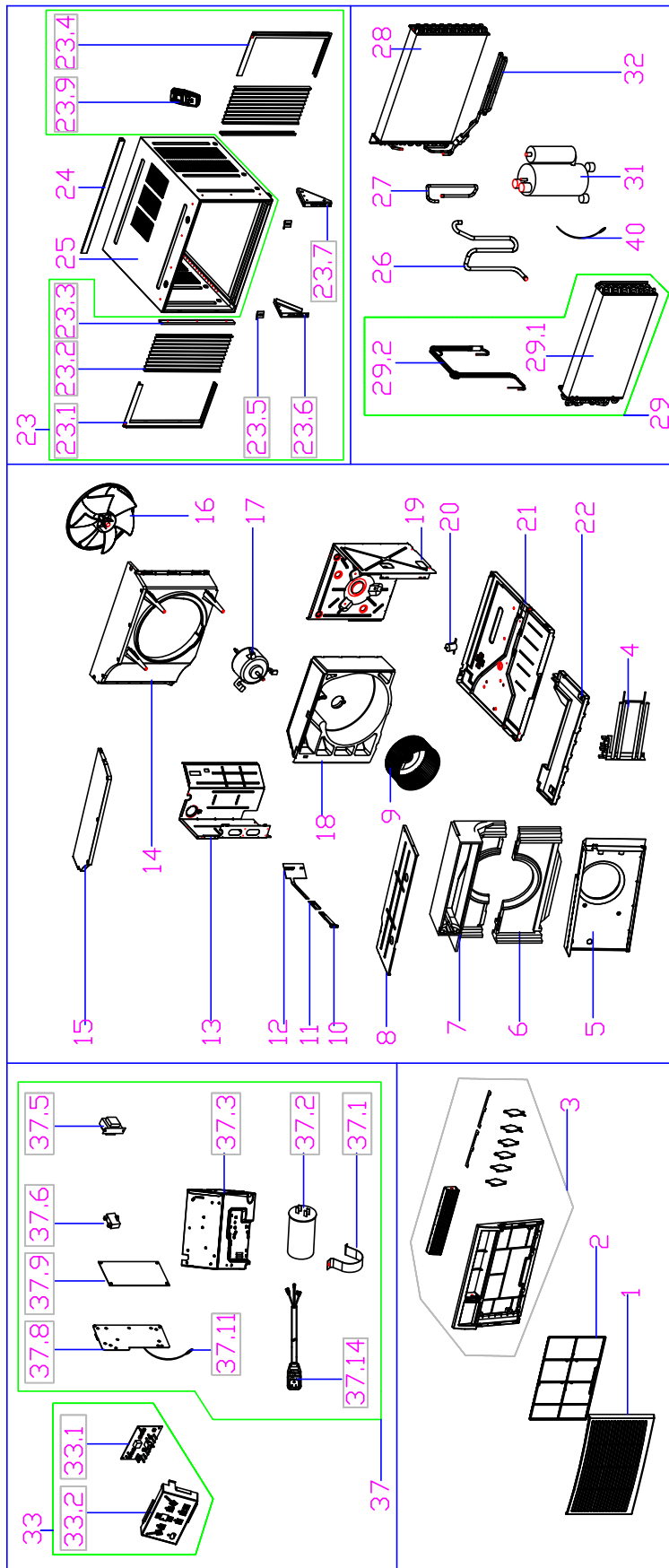

REPLACEMENT PARTS

Location	Part Name	Quantity	Part No.
1	Front panel	1	2011221A0153
2	Air filter	1	201122190038
3	Panel frame assembly	1	2011221A0177
3.1	Panel frame	1	2011221A0157
3.1.5	Connecting rod of louver	2	P0000951132
4	Electric heater	1	202403100021
5	Box for Electronic heater	1	201222190032
6	Volute shell base	1	202222190014
7	Upper volute shell	1	202222190017
8	Front cover	1	201222190101
9	Centrifugal fan	1	201100120010
10	Connecting rod of fresh air door	1	2011221A0154
11	Bracket of fresh air door	1	201122190017
12	Fresh air door	1	201122190012
13	Front left barrier	1	201222190004
14	Rear separating	1	201122190019
15	Rear cover	1	201122190007
16	Axial flow fan	1	201100320005
17	Asynchronous motor	1	202400430600
18	Rear volute shell assembly	1	202222190012
19	Front right barrier	1	201222190015
20	Drain valve	1	202301610703
21	Chassis assembly	1	201222190093
22	Condenser water tray	1	202222190000
23	Installation accessory	1	2028220A0018
23.1	Left shutter frame	1	201122190011
23.2	Shutter	2	201122190009
23.3	Connecting bar of cabinet	2	201122190008
23.4	Right shutter frame	1	201122190010
23.5	Locking bar	2	201222190008
23.6	Left supporter	1	201221890082
23.7	Right bracket	1	201221890083
23.9	Remote controller	1	2033550A3128
24	Top shutter frame	1	201222190090
25	Cabinet assembly	1	201222190104
26	Suction pipe assembly	1	201622190272
27	Discharge pipe assembly	1	201622190275
28	Condenser assembly	1	201522190030
29	Evaporator coil assembly	1	201522190048
29.1	Evaporator	1	201522190014
29.2	Capillary assembly	1	201622190259
31	Compressor	1	201400601300
32	Super-cooling pipe	1	201622190197
33	Display box assembly	1	2033221A0044
33.1	Display Board	1	201322190042
33.2	Control panel	1	2011221A0155
33.3	Display Panel artwork	1	2020221A0402
37	Electronic control box assembly	1	2033221A0039
37.1	Capacitor clip	1	201200100011
37.2	Capacitor of compressor (55/440)	1	202401000808
37.3	Electronic control box	1	201222190052
37.5	transformer	1	202300900140
37.6	Capacitor of fan motor	1	202401100967
37.8	Main control board assembly	1	2013221A0004
37.9	Bracket of main control board	1	201121890090
37.11	Indoor temperature sensor assembly	1	202301300092
37.14	Power cord	1	202402290016
Not Shown	Discharge temp. sensor	1	202301310065

Design, material, performance data and components
subject to change without notice.

HEAT CONTROLLER, INC.

1900 Wellworth Ave., Jackson, MI 49203 • Ph. 517-787-2100 • Fax 517-787-9341

THE QUALITY LEADER IN CONDITIONING AIR

www.heatcontroller.com