

This Owner's Manual is provided and hosted by [Appliance Factory Parts](#).



# Charbroil 04501128 Owner's Manual

[Shop genuine replacement parts for Charbroil  
04501128](#)



[Find Your Charbroil Grill Parts - Select From 3592 Models](#)

----- Manual continues below -----



# Caldera Outdoor Fire Bowl

Model • 04501128

Assembly Instructions



## FOR OUTDOOR USE ONLY

Tools needed for assembly: Cross head screwdriver  
Adjustable spanner  
(not supplied)

	<b>CAUTION</b>	
Read and follow all safety statements, warnings, assembly instructions and use & care directions before attempting to assemble.		

	<b>WARNING</b>	
Do not use this unit on a wood deck or on combustible surfaces such as dry grass, leaves, mulch, etc. Do not use this unit near heat sensitive or combustible structures such as vinyl or wood siding.		

# HARDWARE

Hardware is shown actual size. You may have spare hardware after assembly is complete.

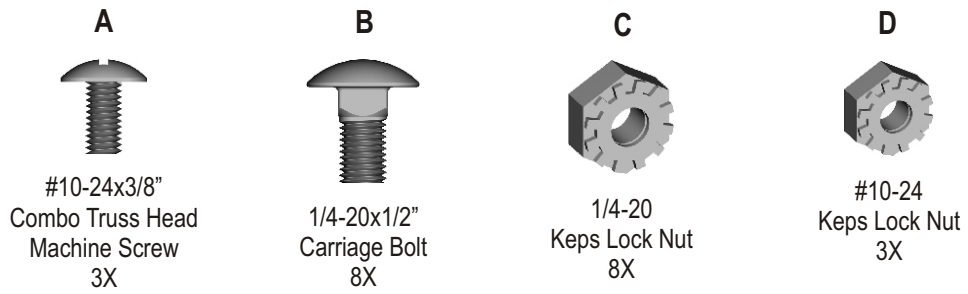

## PARTS LIST

Ref. No.	Description	Qty.
1	Leg	4
2	Bottom Ring	1
3	Top Ring	1
4	Fire Bowl	1
5	Ash Catcher	1

**1** Make sure legs (1) are on the inside of ring (2), attach legs to lower ring as shown using 4X B from the outside and 4X C on the inside. Tighten nuts after all four legs are attached.

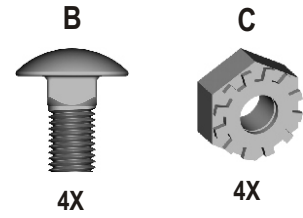

**Repeat this step for areas 2, 3 and 4.**

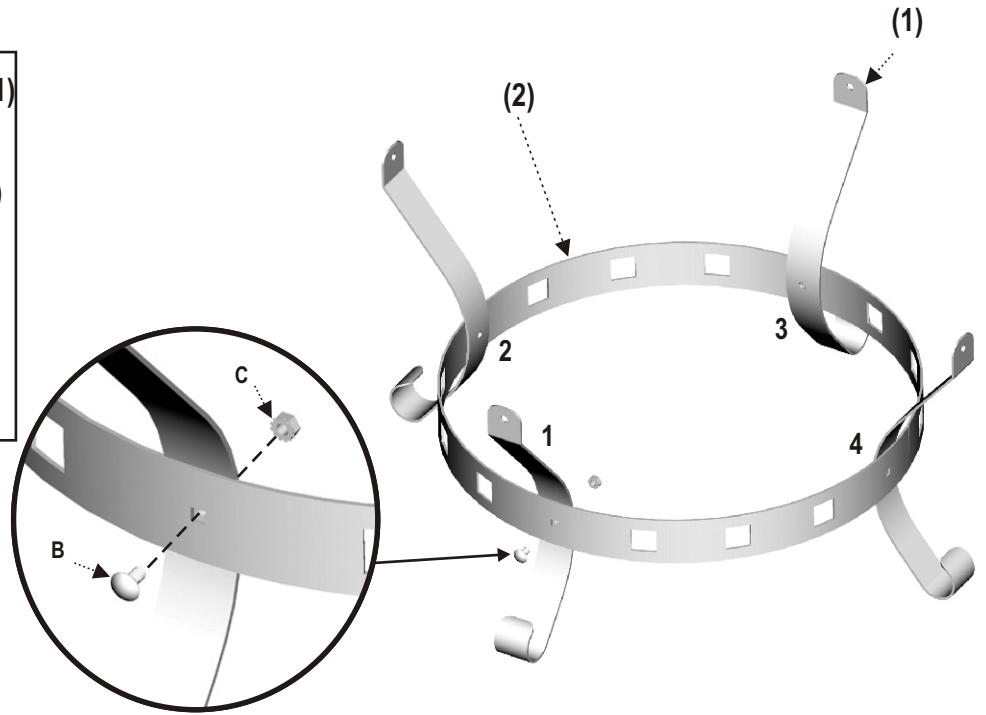
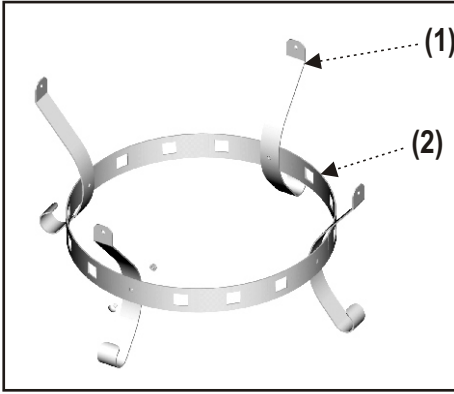

**2** Making sure the legs (1) are on the inside of ring (3), attach legs to upper ring (3) as shown using 4X B from the outside and 4X C on the inside. Tighten nuts after all four legs are attached.

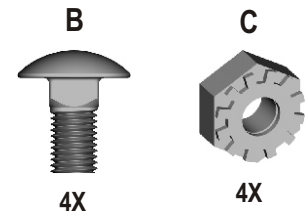

**Repeat this step for areas 2, 3 and 4.**

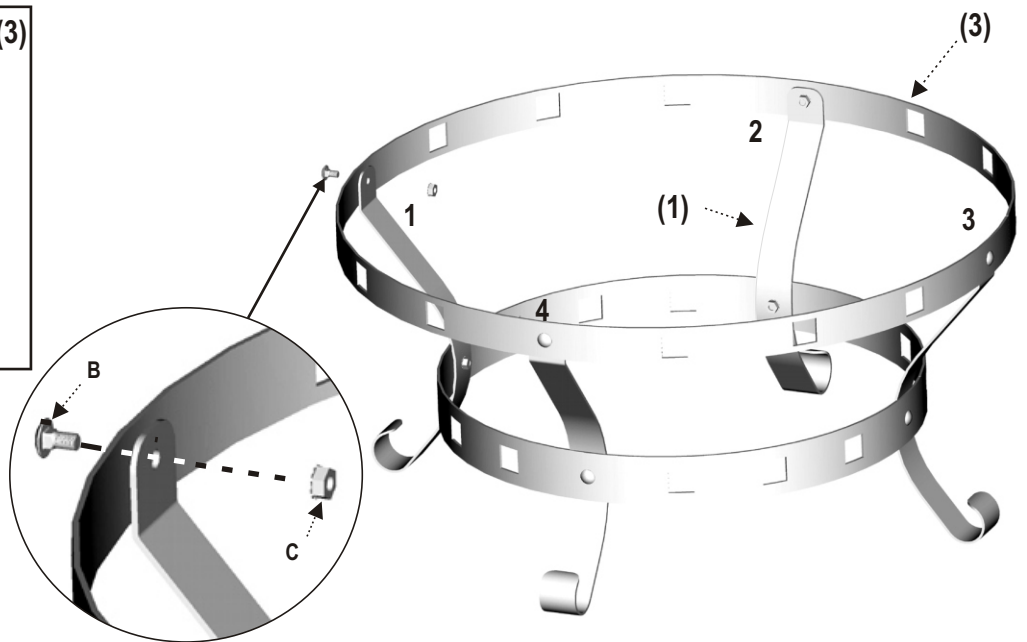
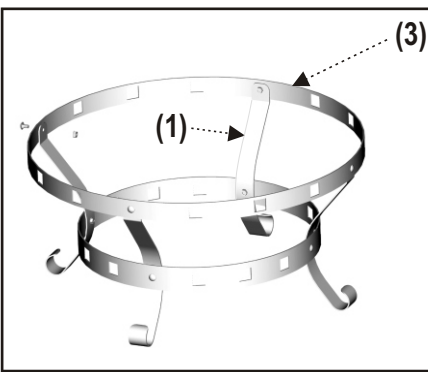

**3** Using 3X A from inside the bowl (4) and 3X D attach ash catcher bracket (5) to the bottom side of bowl. Tighten all nuts.

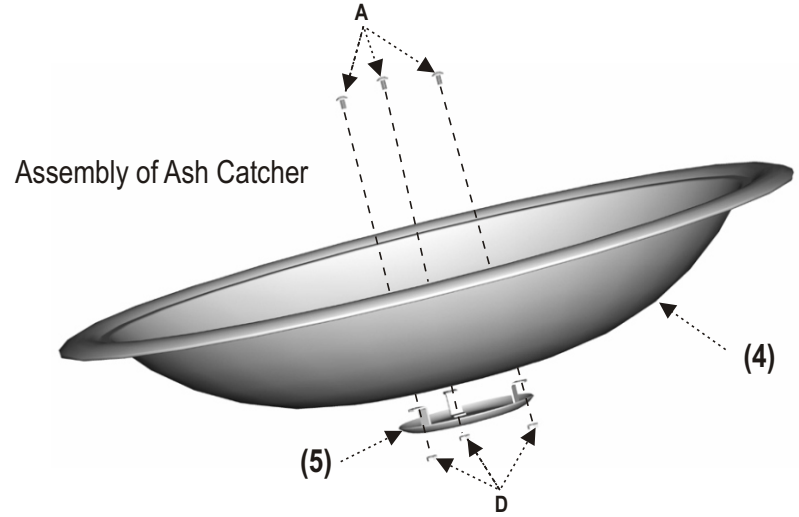
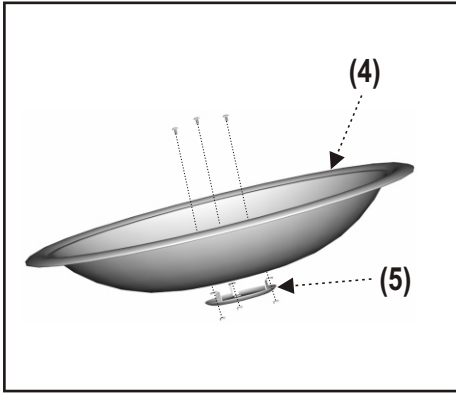
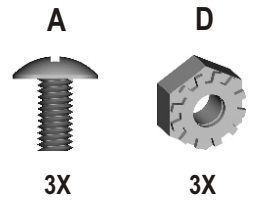

Lower bowl onto assembled base



**Completed view of Caldera Fire Bowl After Assembly**



- This product is intended for **OUTDOOR USE ONLY**.
- This product is **NOT** suitable for use on decking or other flammable surfaces such as dry grass, wood chips, leaves or decorative bark.
- Ensure when positioning the unit it is sufficiently clear of flammable items or material such as fencing, wooden and plastic structures or similar.
- Keep children and pets at a safe distance from the unit when in use.
- Never leave this product unattended when in use.
- This product will become hot when used - take care when touching.
- This product is **NOT** intended to be used to cook or heat food.
- Allow to cool before touching.
- **DO NOT** move this product when in use or while hot.
- **FIRE HAZARD** Hot embers may emit while in use.
- **DO NOT** use petrol, white spirit, lighter fluid, alcohol or other similar chemicals to light a fire.
- **DO NOT** lean or rest items on the rim of the bowl as this could make the unit unstable.

## CARE & USE

- **ONLY** use on flat level ground.
- **ONLY** use untreated wood as fuel in this product.
- Only load between 4 or 5 logs at a time. **DO NOT OVER FILL**.
- **Lighting.** **ONLY** use kindling wood, rolled newspaper or lighting blocks to light the fuel.
- If using an outdoor cover, only position once the product has completely cooled.
- Extinguish with sand or a fine water spray.
- Remove ash residue when cooled with a dustpan and brush.
- Wipe clean surfaces with a damp cloth.
- The bowl and stand will discolour after a period of use.

**If you have any queries or require advice or spare parts for this product  
please call the following HELP LINE NUMBER 01622 677244**

**GB SERVICE**

Char-Broil International L.L.C.  
Bradley House  
Bircholt Road  
Parkwood, Maidstone, Kent, ME15 9XY  
Phone 01622 6774244  
Fax 01622 688124

**For Warranty and replacement parts**  
**[support@charbroil.co.uk](mailto:support@charbroil.co.uk)**  
**[sales@charbroil.co.uk](mailto:sales@charbroil.co.uk)**