



# ELECTRICAL REPLACEMENT MANUAL

## MANUEL DE REMPLACEMENT ÉLECTRIQUE

### MANUAL DE REEMPLAZO ELÉCTRICO

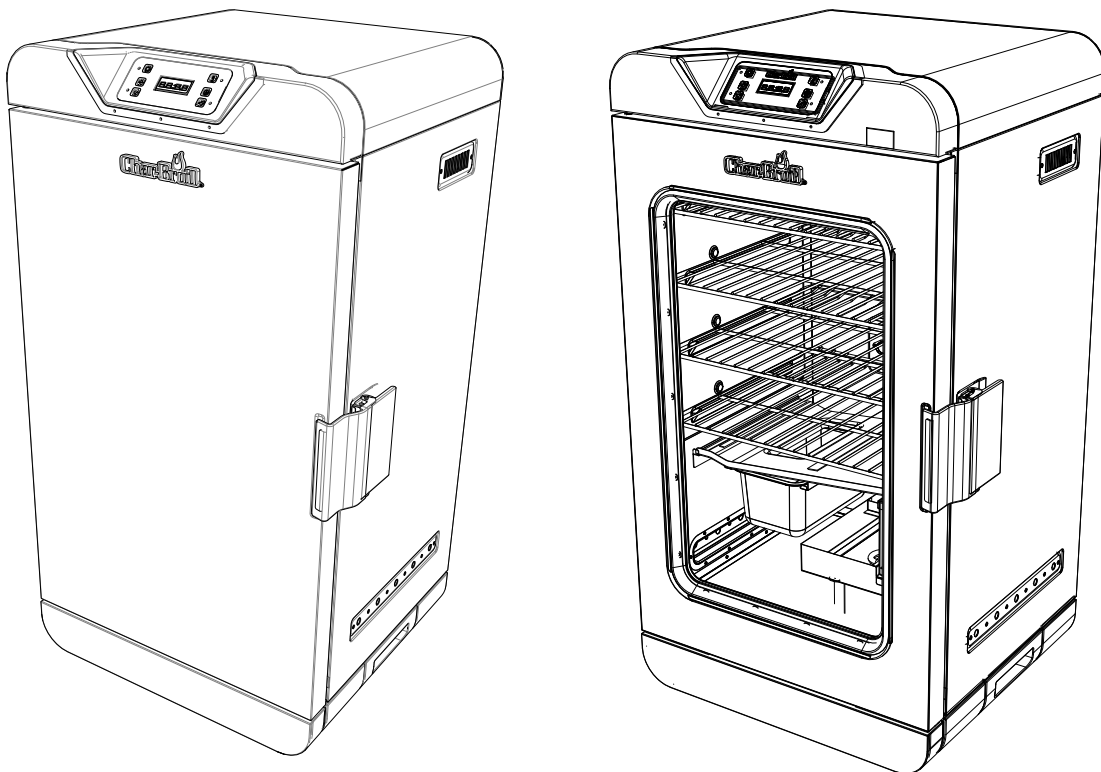
MODEL | MODÈLE | MODELO

**14202002 14202004**  
**14202005**

DIGITAL ELECTRIC VERTICAL SMOKER® 725

FUMOIR ÉLECTRIQUE NUMÉRIQUE VERTICAL® 725

AHUMADOR DIGITAL ELÉCTRICO VERTICAL® 725

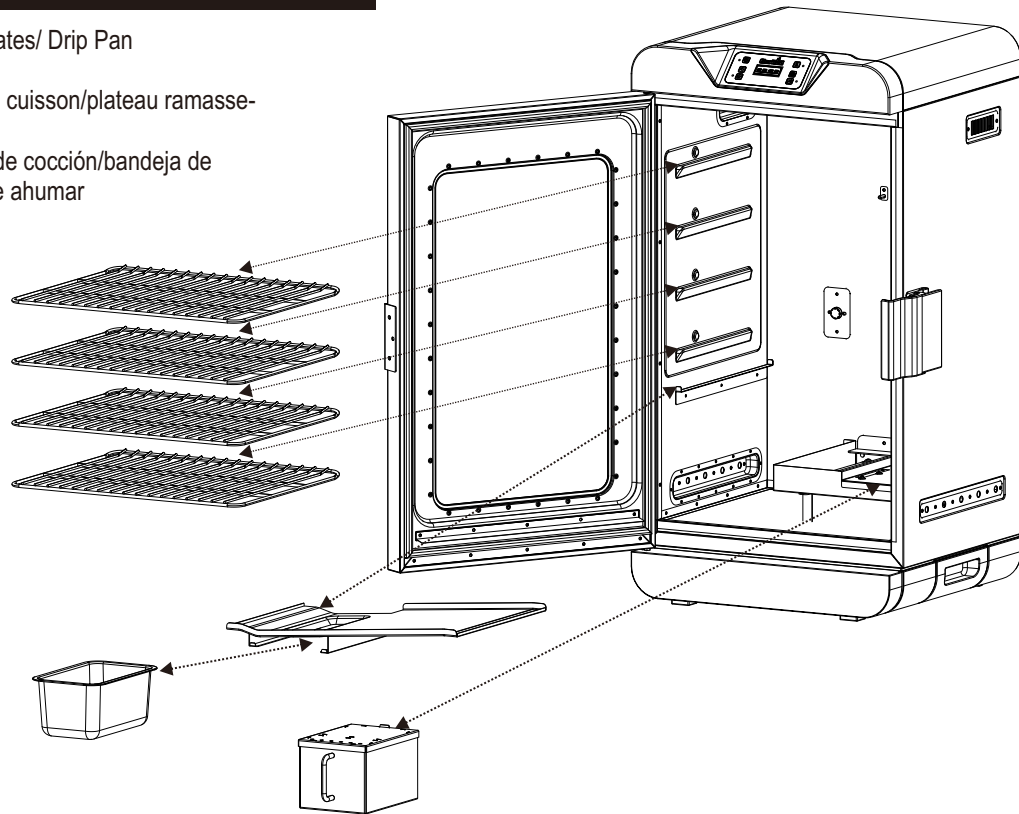


## FIGURE 1/ IMAGE 1/ FIGURA 1

Remove/ Replace Cooking Grates/ Drip Pan  
/ Water Pan/ Smoker Box

Retirer/remplacer les grilles de cuisson/plateau ramasse-  
gouttes/bac à eau/foyer

Retire/reemplaza las parrillas de cocción/bandeja de  
goteo/bandeja de agua/caja de ahumar

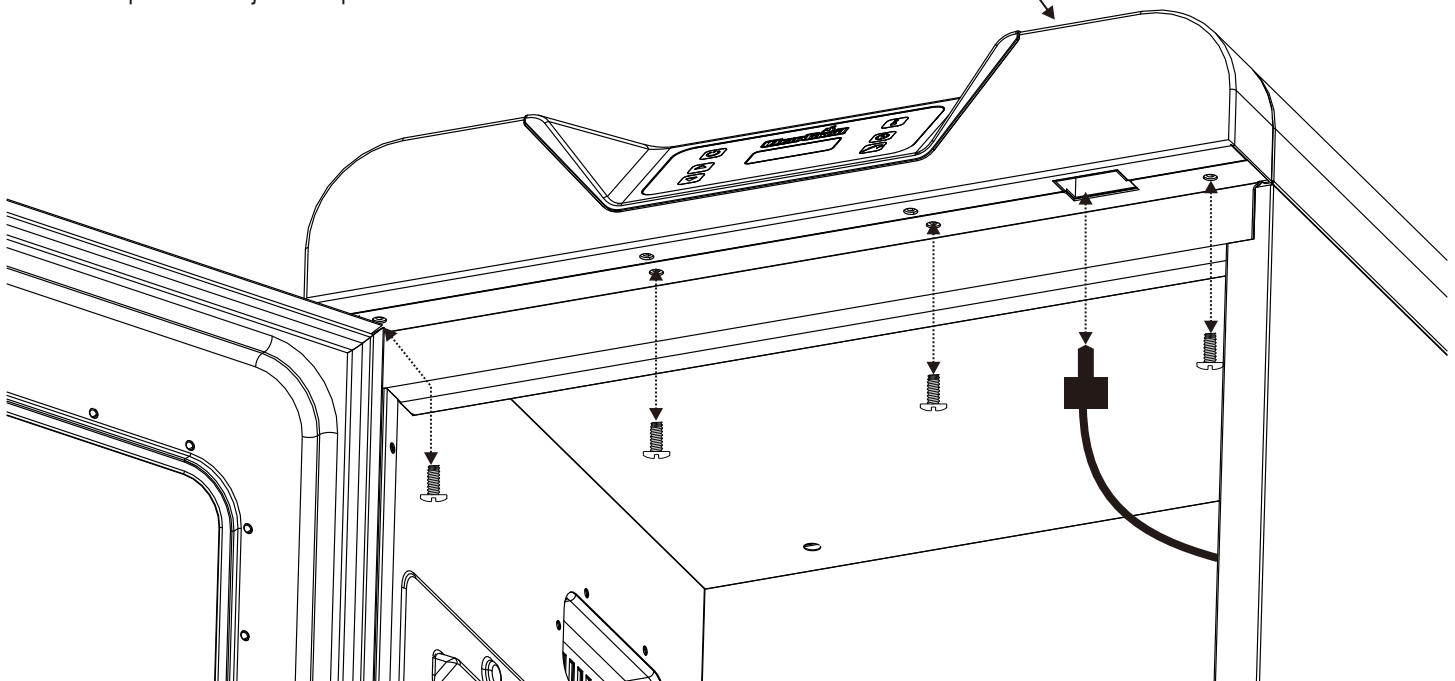


**CONTROL PANEL/ MEAT PROBE HOUSING/ DISPLAY KIT/ DISPLAY HOUSING ACCESS/ REPLACEMENT  
PANNEAU DE COMMANDE/BOÎTIER DE LA SONDÉ À VIANDE/SUPPORT D'AFFICHAGE/ACCÈS AU  
LOGEMENT DE L'AFFICHAGE/REPLACEMENT  
REEMPLAZO DEL PANEL DE CONTROL/CUBIERTA DE LA SONDÉ DE CARNE/ KIT DE PANTALLA/ACCESO A  
LA CUBIERTA DE LA PANTALLA**

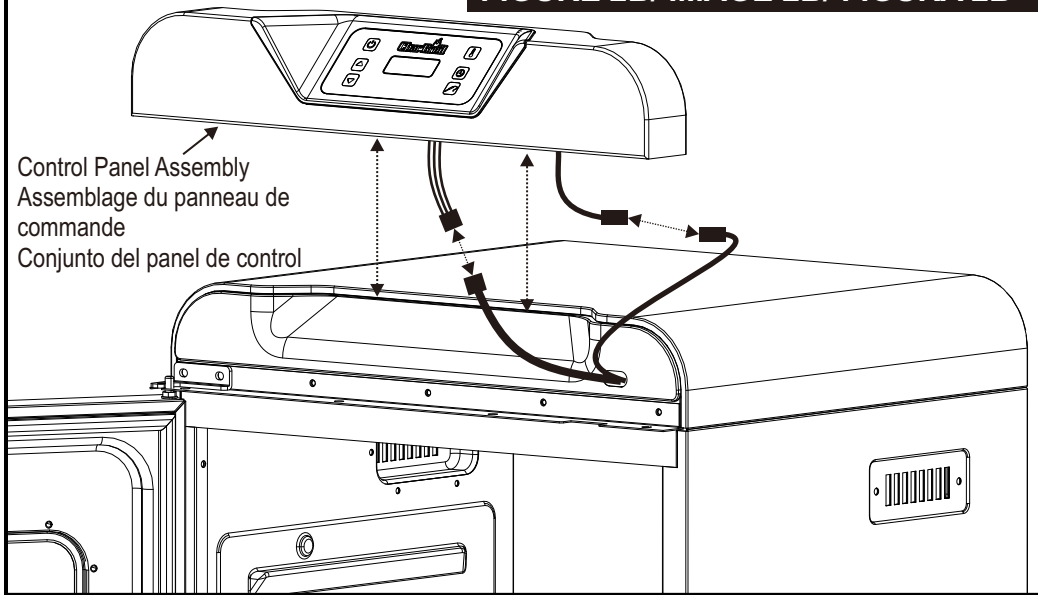
## FIGURE 2A/ IMAGE 2A/ FIGURA 2A

Remove/ Replace Control Panel Assembly  
Retirer/remplacer l'assemblage du panneau de commande  
Retirar/reemplazar el conjunto del panel de control

Control Panel Assembly  
Assemblage du panneau de commande  
Conjunto del panel de control

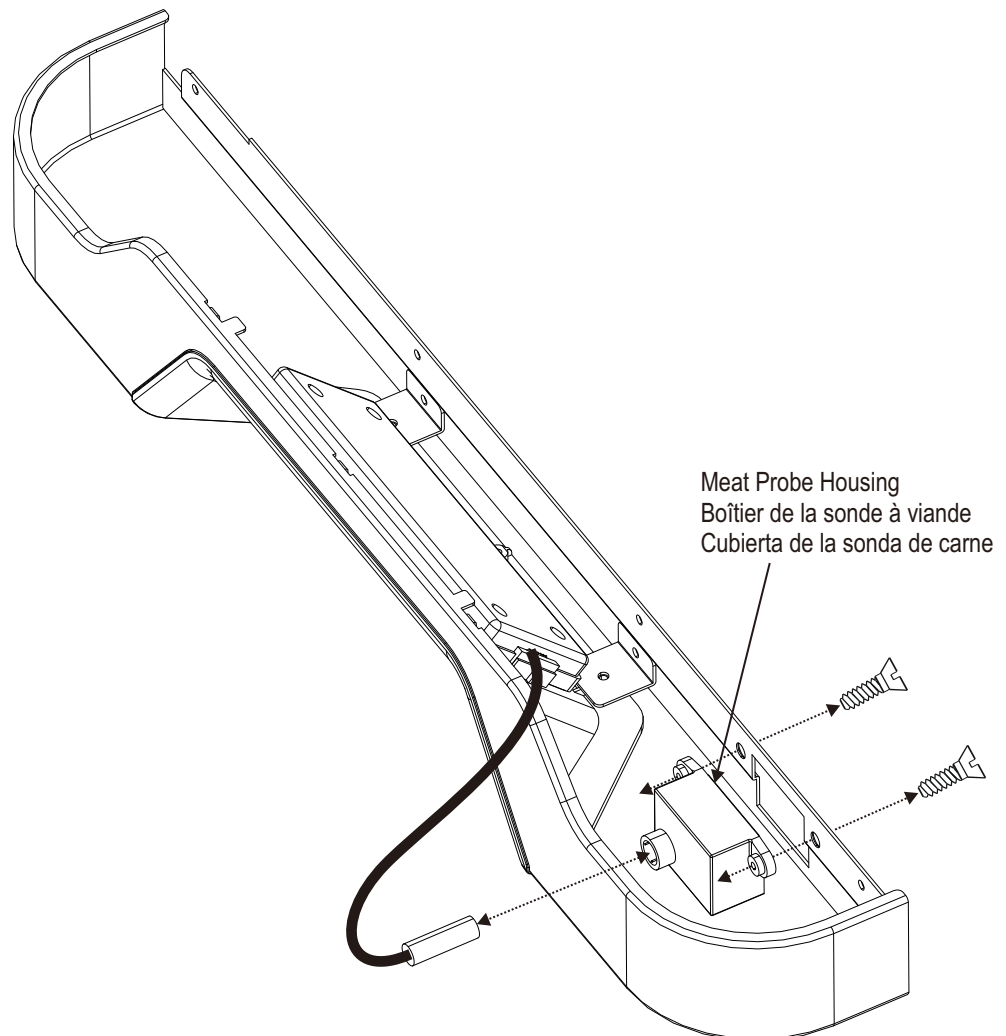


**FIGURE 2B/ IMAGE 2B/ FIGURA 2B**



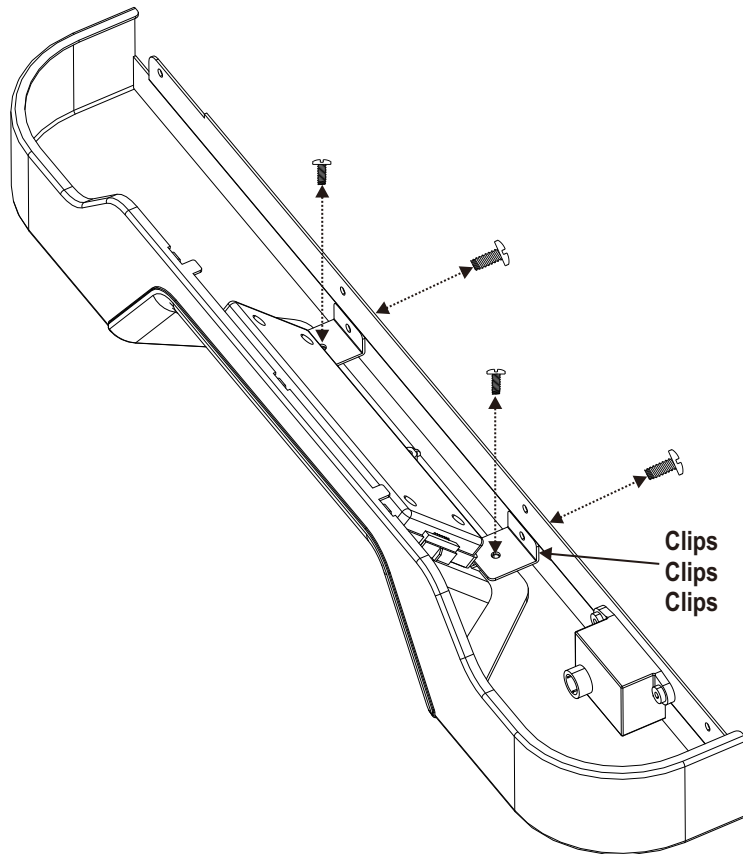
**FIGURE 2C/ IMAGE 2C/ FIGURA 2C**

Remove/ Replace Meat Probe Housing  
Retirer/remplacer le boîtier de la sonde à viande  
Retirar/reemplazar la cubierta de la sonda de carne



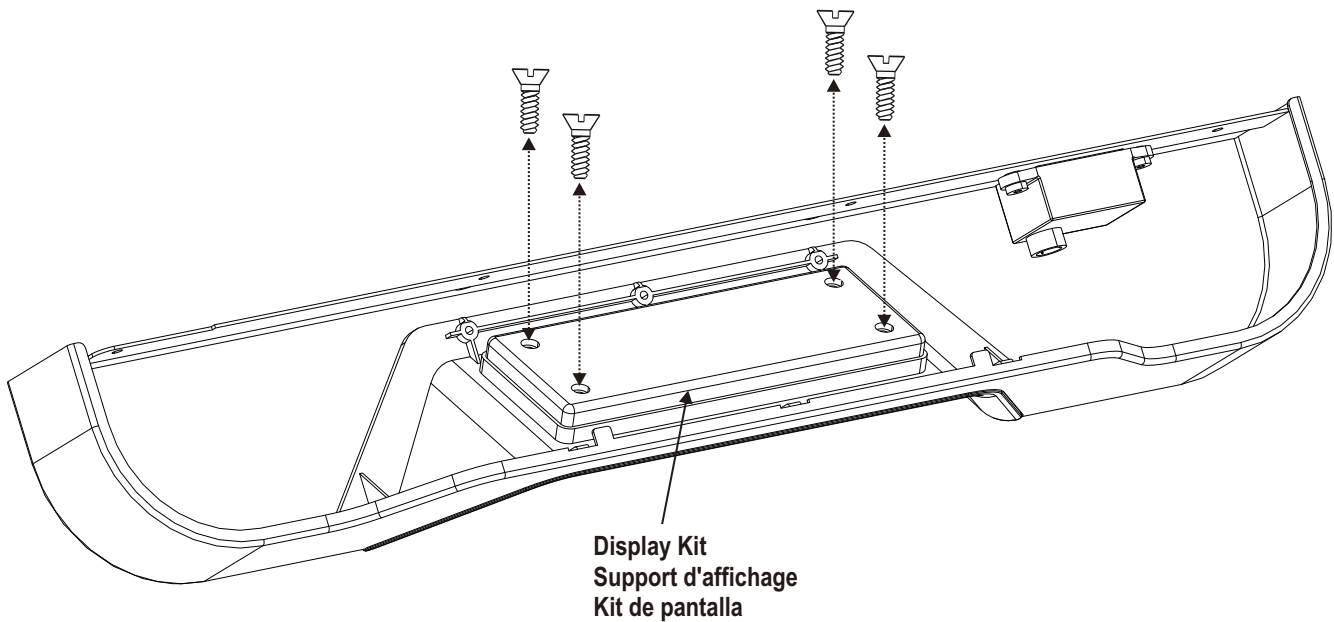
**FIGURE 2D/ IMAGE 2D/ FIGURA 2D**

Remove/ Replace Clips  
Retirer/remplacer les clips  
Retirar/reemplazar los sujetadores



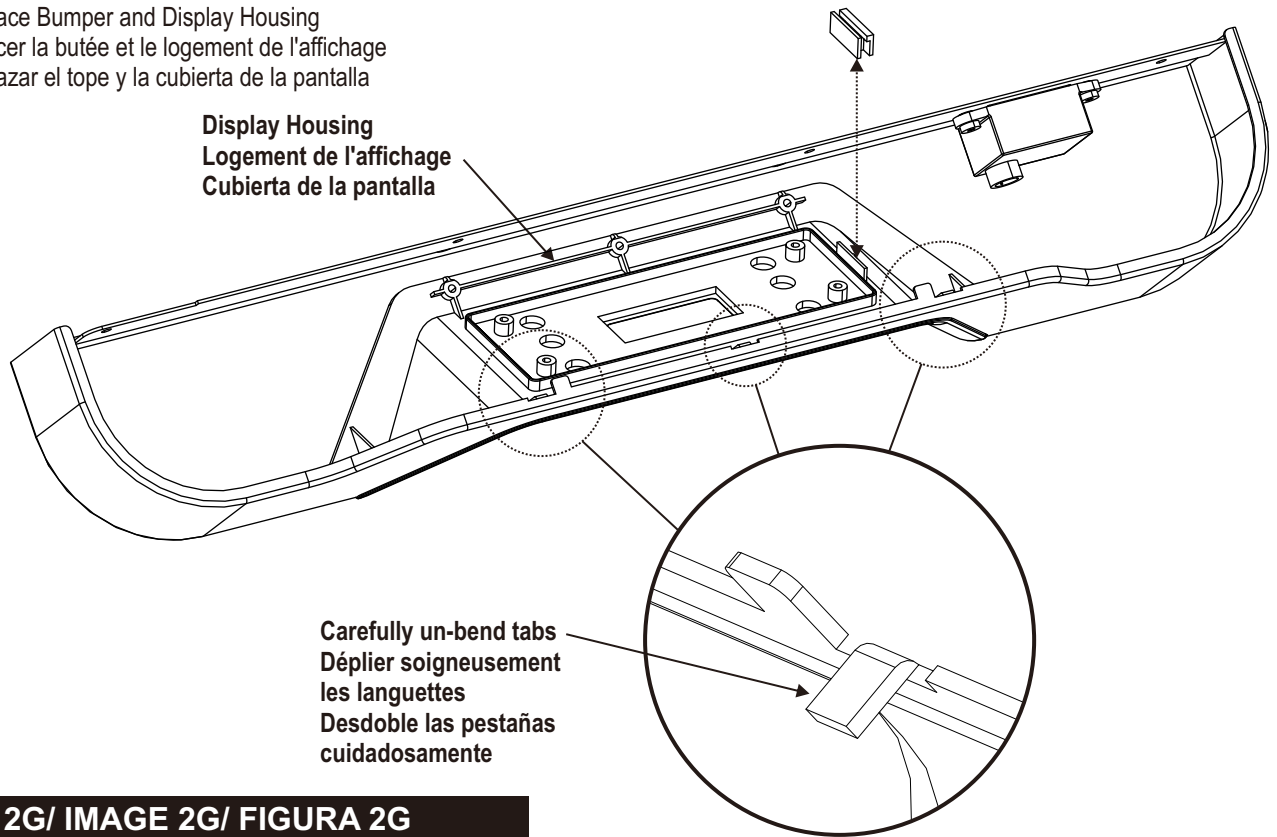
**FIGURE 2E/ IMAGE 2E/ FIGURA 2E**

Remove/ Replace Display Kit  
Retirer/remplacer le support d'affichage  
Retirar/reemplazar el kit de la pantalla



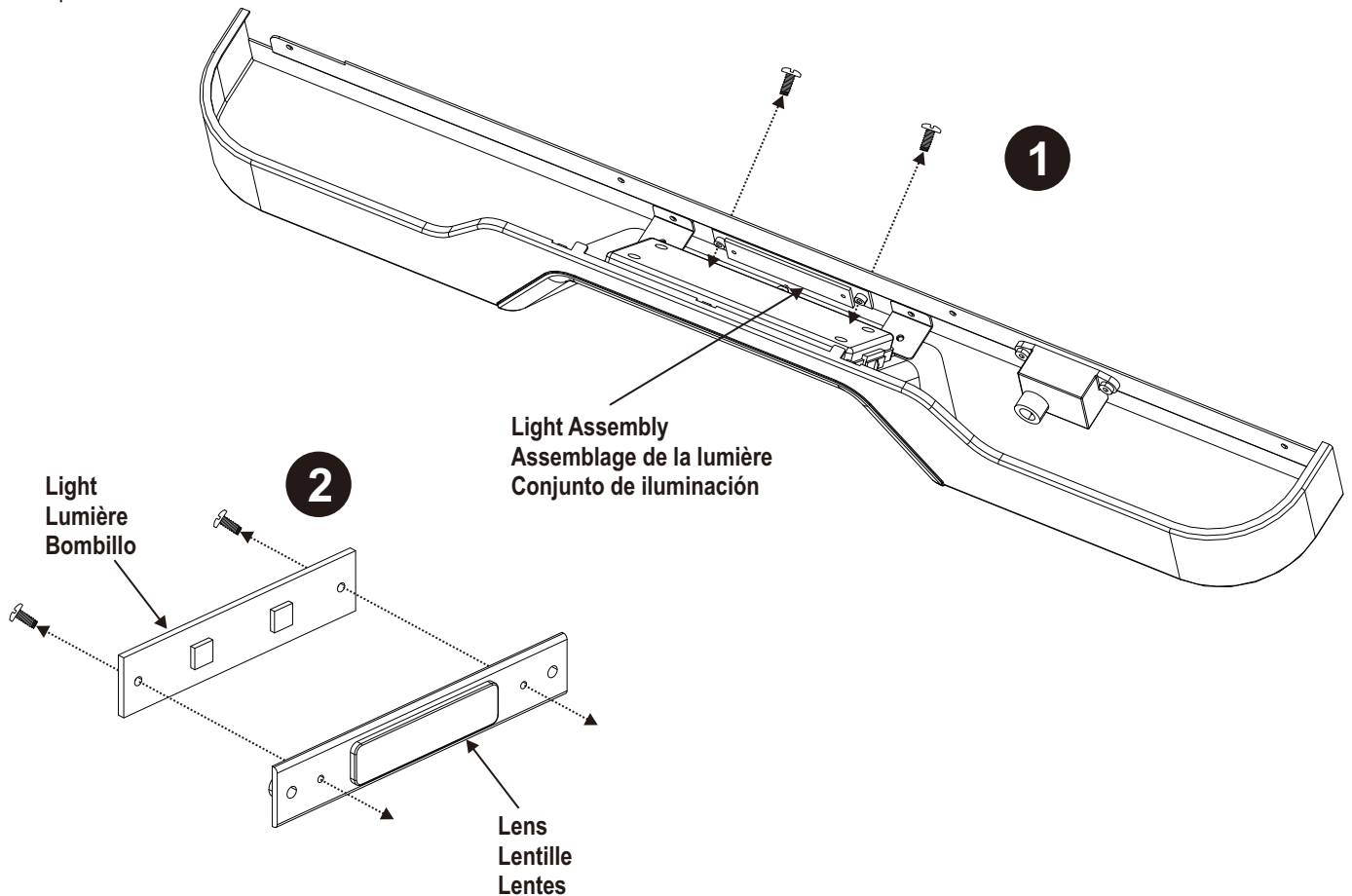
## FIGURE 2F/ IMAGE 2F/ FIGURA 2F

Remove/ Replace Bumper and Display Housing  
Retirer/remplacer la butée et le logement de l'affichage  
Retirar/reemplazar el tope y la cubierta de la pantalla



## FIGURE 2G/ IMAGE 2G/ FIGURA 2G

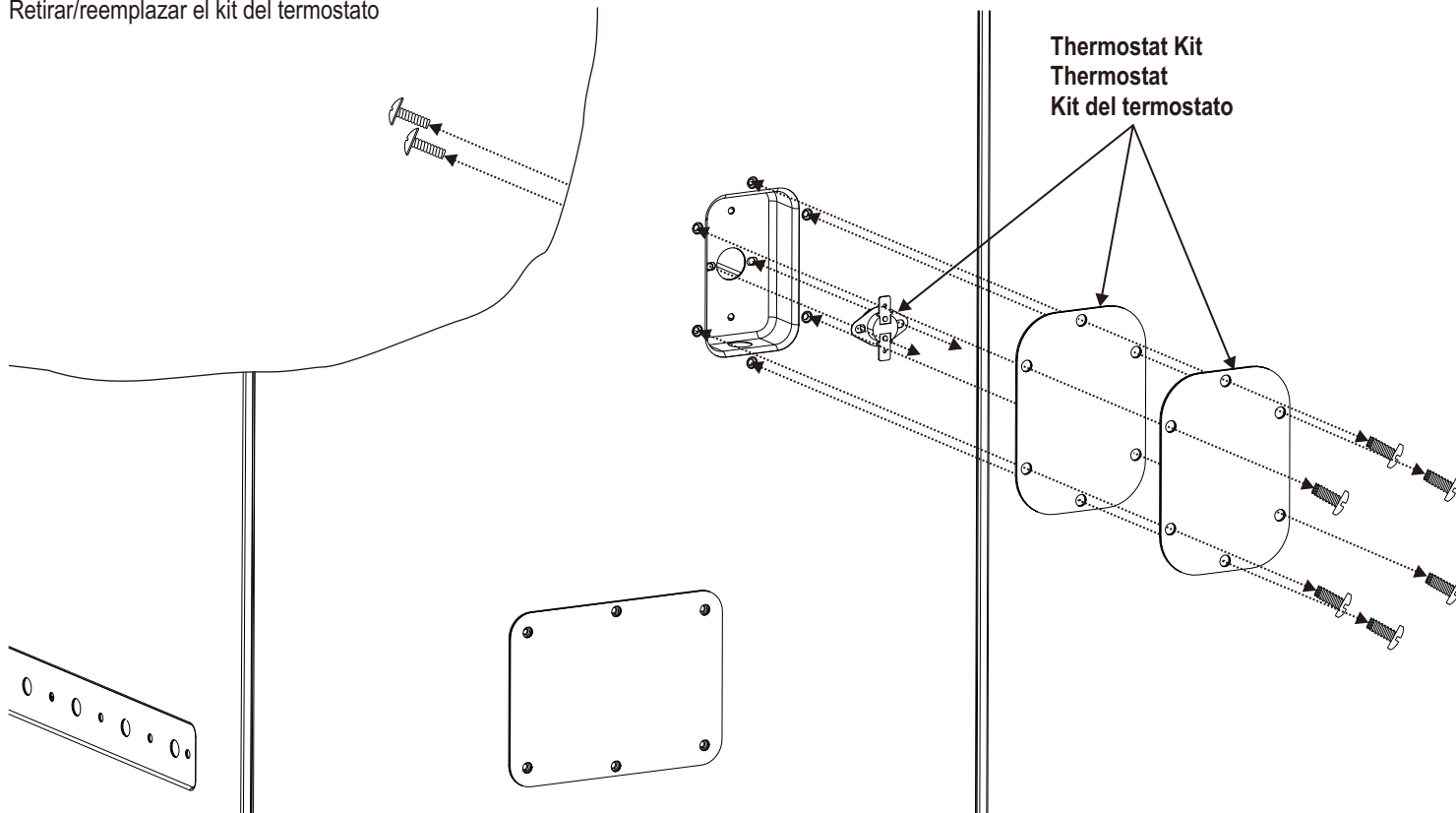
Remove/ Replace Light  
Retirer/remplacer la lumière  
Retirar/reemplazar la luz



**THERMOSTAT KIT ACCESS/ REPLACEMENT  
ACCÈS AU/REPLACEMENT DU THERMOSTAT  
ACCEDER/REEMPLAZAR KIT DEL THERMOSTATO**

**FIGURE 3/ IMAGE 3/ FIGURA 3**

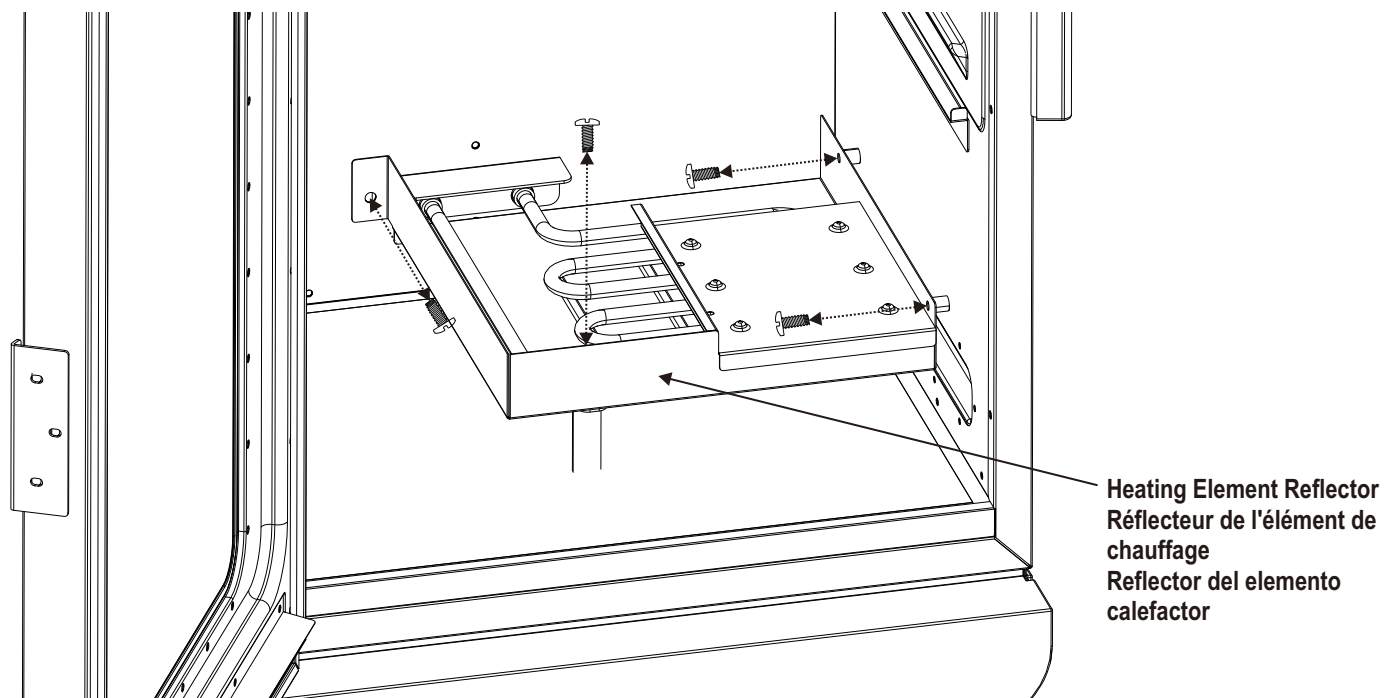
Remove/ Replace Thermostat Kit  
Retirer/remplacer le thermostat  
Retirar/reemplazar el kit del termostato



**HEATING ELEMENT ACCESS/ REPLACEMENT  
ACCÈS À/REEMPLACEMENT DE L'ÉLÉMENT DE CHAUFFAGE  
ACCEDER/REEMPLAZAR ELEMENTO CALEFACTOR**

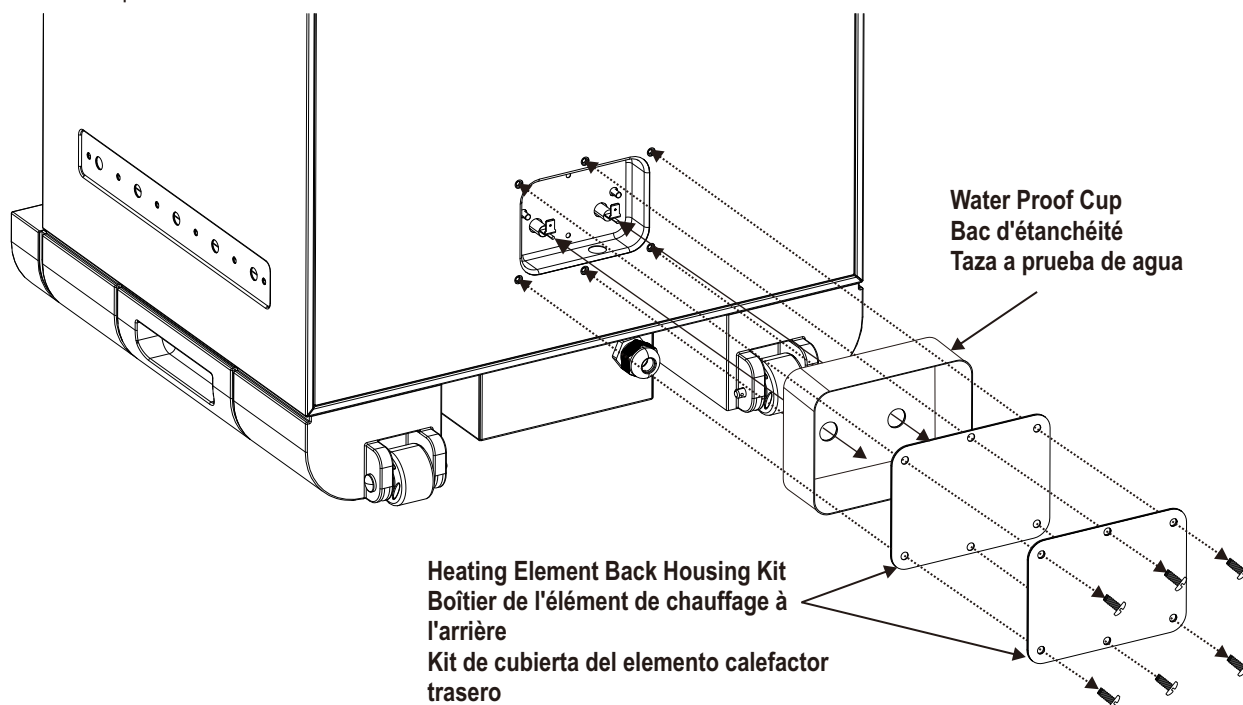
**FIGURE 4A/ IMAGE 4A/ FIGURA 4A**

Remove/ Replace Heating Element Reflector  
Retirer/remplacer le réflecteur de l'élément de chauffage  
Retirar/reemplazar reflector del elemento calefactor



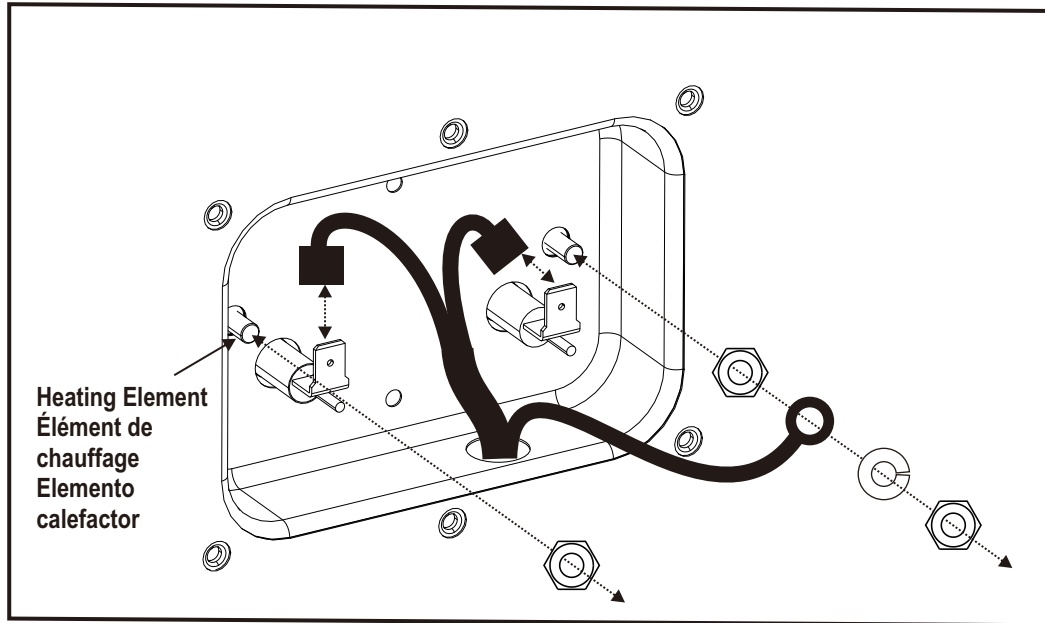
**FIGURE 4B/ IMAGE 4B/ FIGURA 4B**

Remove/ Replace Heating Element Back Housing Kit  
Retirer/remplacer le boîtier de l'élément de chauffage à l'arrière  
Retirar/reemplazar kit de cubierta del elemento calefactor trasero



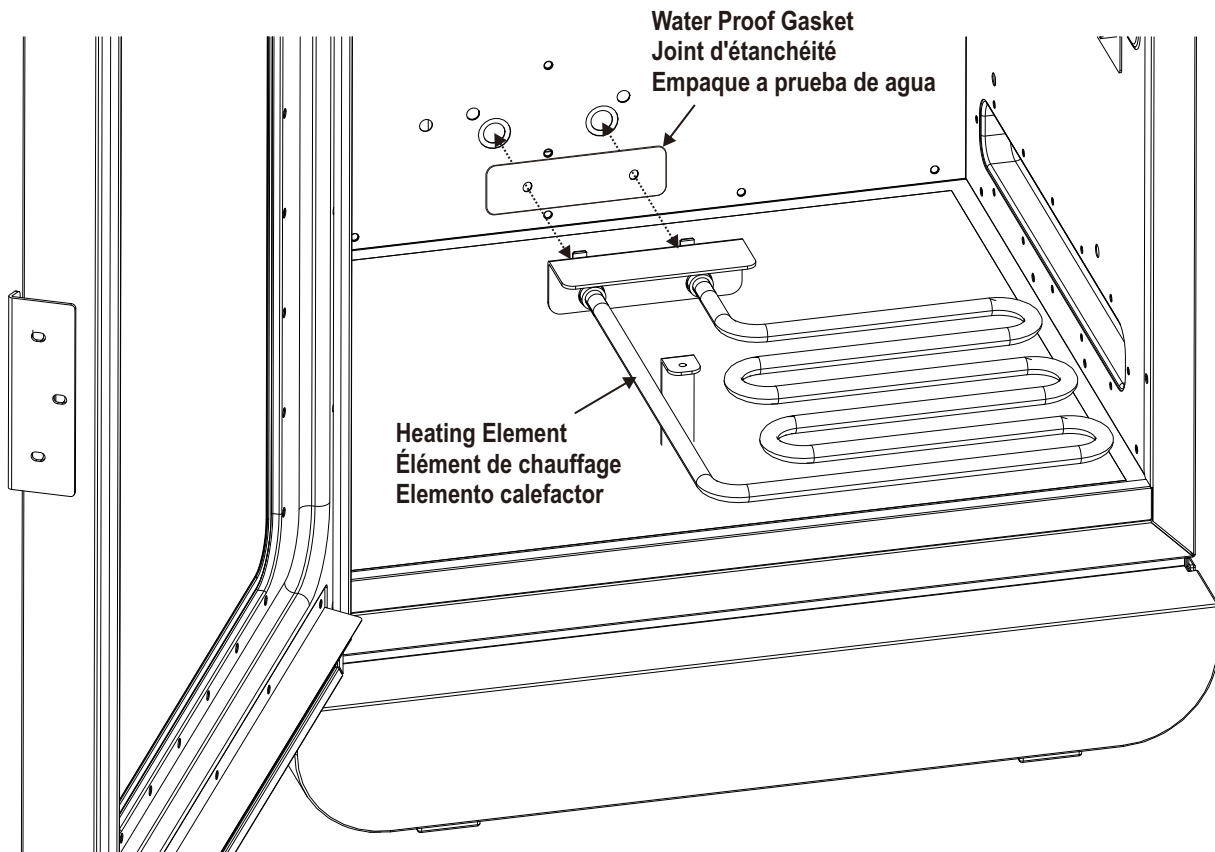
### FIGURE 4C/ IMAGE 4C/ FIGURA 4C

Remove/ Replace Heating Element  
Retirer/remplacer l'élément de chauffage  
Retirar/reemplazar elemento calefactor



### FIGURE 4D/ IMAGE 4D/ FIGURA 4D

Remove/ Replace Heating Element  
Retirer/remplacer l'élément de chauffage  
Retirar/reemplazar elemento calefactor

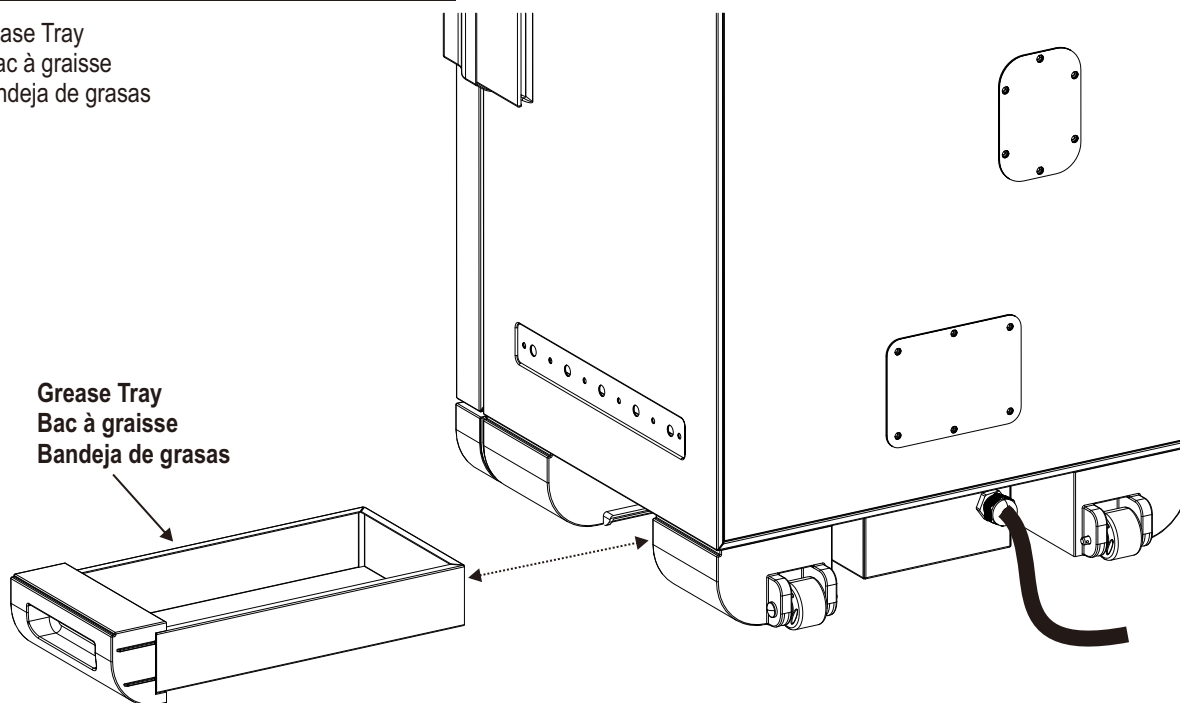




**POWER CONTROL BOARD ACCESS/ REPLACEMENT**  
**ACCÈS À/REEMPLACEMENT DE LA CARTE DE CONTRÔLE D'ALIMENTATION**  
**ACCEDER/REEMPLAZAR TARJETA DE CONTROL DE ENERGÍA**

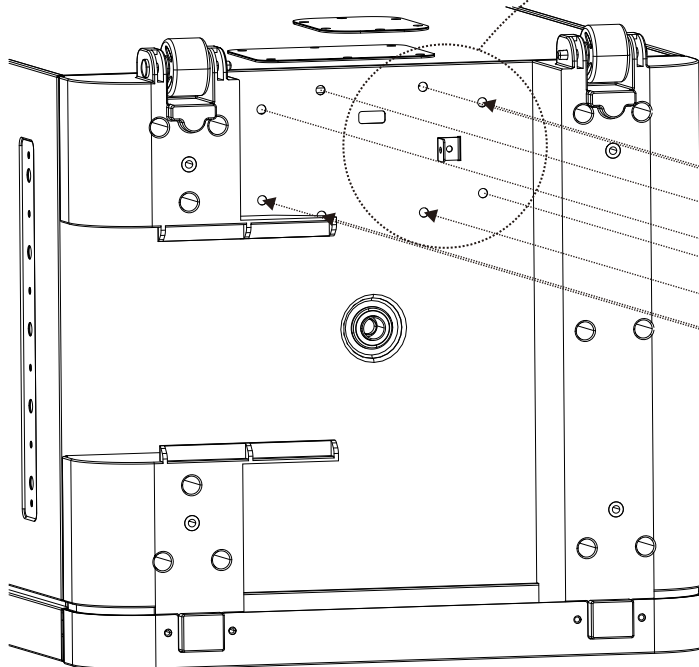
**FIGURE 5A/ IMAGE 5A/ FIGURA 5A**

Remove/ Replace Grease Tray  
 Retirer/remplacer le bac à graisse  
 Retirar/reemplazar bandeja de grasas

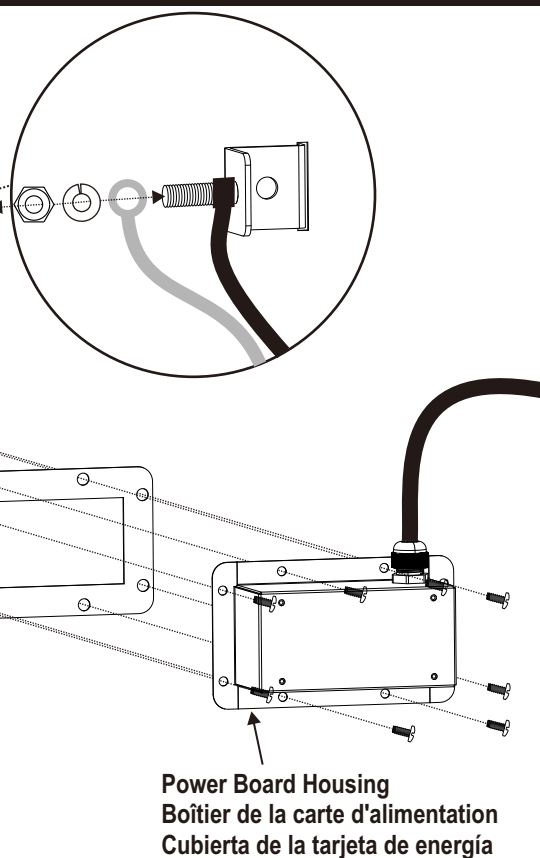


**FIGURE 5B/ IMAGE 5B/ FIGURA 5B**

Remove/ Replace Power Board Housing  
 Retirer/remplacer le boîtier de la carte d'alimentation  
 Retirar/reemplazar la cubierta de la tarjeta de energía  
 Remove/ Replace the green power wire (Figure 5C)  
 Retirer/remplacer le fil d'alimentation vert (image 5C)  
 Retirar/reemplazar el cable de energía verde (Figura 5C)



**FIGURE 5C/ IMAGE 5C/ FIGURA 5C**

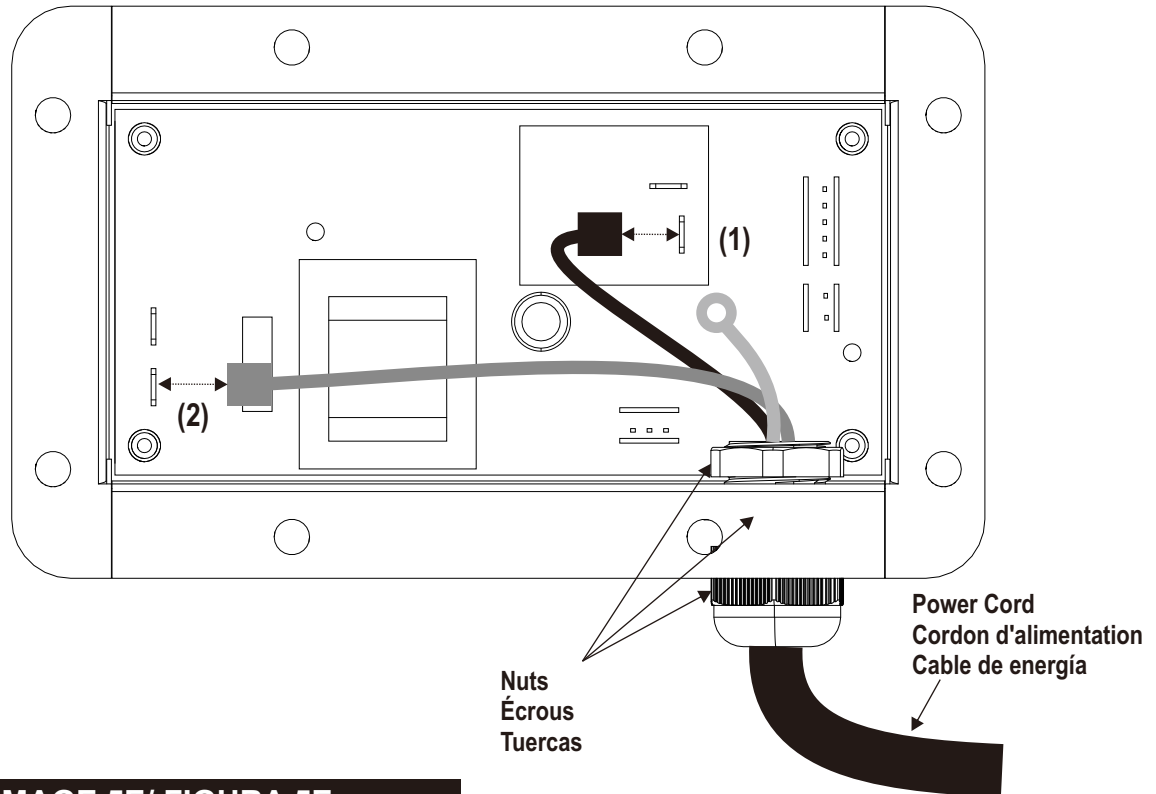


### FIGURE 5D/ IMAGE 5D/ FIGURA 5D

Remove/ Replace the black power wire from (1) .  
Remove/ Replace the white power wire from (2) .  
Remove/ Replace the nuts to replace the power cord.

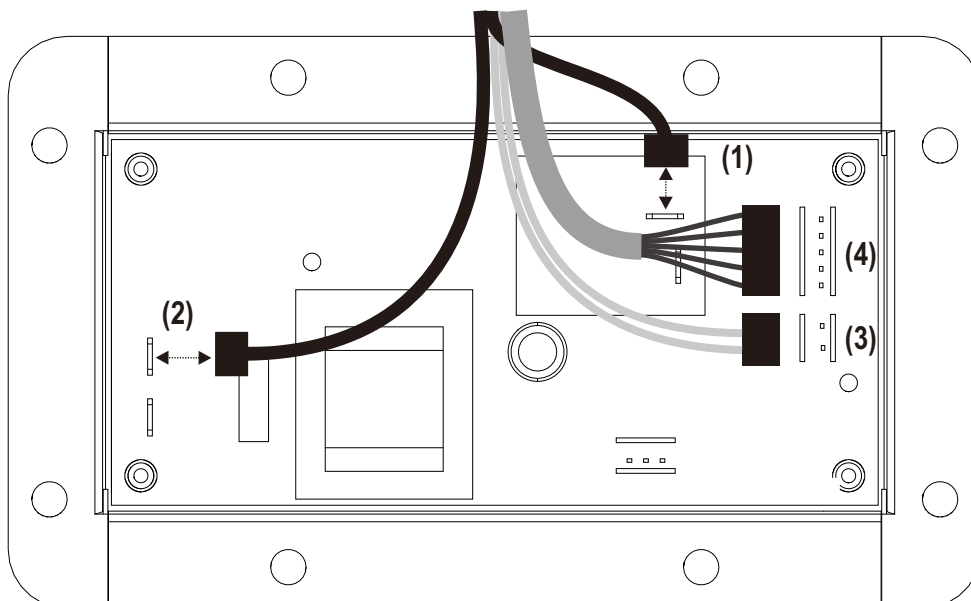
Retirer/remplacer le fil d'alimentation noir de (1).  
Retirer/remplacer le fil d'alimentation blanc de (2).  
Retirer/remplacer les écrous pour remplacer le cordon d'alimentation.

Retirar/reemplazar el cable de energía negro de (1).  
Retirar/reemplazar el cable de energía blanco de (2).  
Retirar/reemplazar las tuercas para reemplazar el cable de energía.



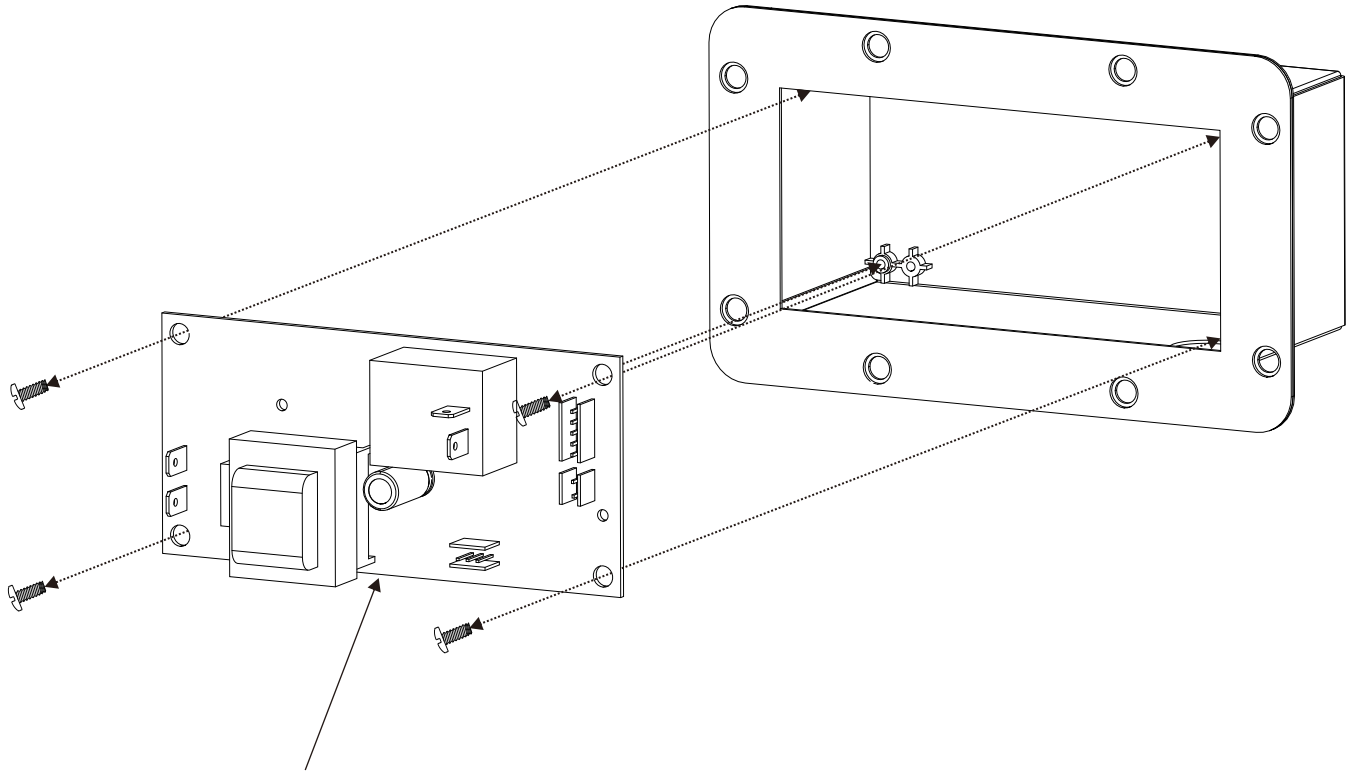
### FIGURE 5E/ IMAGE 5E/ FIGURA 5E

Remove/ Replace 2 black wires from (1) and (2). Remove/ Replace the bundles of wires from (3) and (4).  
Retirer/remplacer les 2 fils noirs de (1) et (2). Retirer/remplacer les faisceaux des fils de (3) et (4).  
Retirar/reemplazar los 2 cables negros de (1) y (2). Retirar/reemplazar el grupo de cables de (3) y (4).



**FIGURE 5F/ IMAGE 5F/ FIGURA 5F**

Remove/ Replace the Power Control Board.  
Retirer/remplacer la carte de contrôle d'alimentation.  
Retirar/reemplazar la tarjeta de control de energía.



**Power Control Board**  
**Carte de contrôle d'alimentation**  
**Tarjeta de control de energía**