

This Owner's Manual is provided and hosted by [Appliance Factory Parts](#).



Broil King 9453-58 Owner's Manual

[Shop genuine replacement parts for Broil King 9453-58](#)



[Find Your Broil King Grill Parts - Select From 1349 Models](#)

----- Manual continues below part list -----

Available Replacement Parts for Broil King 9453-58

| | |
|-----------------------------|--|
| 34120194 | CASTING BOTTOM 390 + |
| 18434 | INFINITY BURNER T501 |
| 18488 | FLAV-R-WAVE - 50,000 BTU STAINLESS |
| 10342-T301 | IGNITOR ELECTRODE ASSEMBLY 8 BURNER 1993 |
| 18013 | LARGE PROBE HEAT INDICATOR |
| S15111 | GREASE CUP HOLDER ALL P8069A + |
| 10081-BK630 | NAMEPLATE HI BROIL KING BLACK ZINC |
| 10240-15 | HINGE PIN SIDE SHELF DROP DOWN |
| S21237 | HINGE PIN SPACER |
| S21124 | SCREW PHCP #8 X 12 + |
| 10958-K531 | POST BLACK |
| Y-12220 | S/B BUSHING SB 1.375 16 HEY |
| 10184-E411 | SUPPORT CASTING R BLK |
| 10342-244 | IGNITOR ELECTRONIC + |
| 10111-K23 | HOSE 23 INCH PIGTAIL FITTING POST |
| 10184-E401 | SUPPORT CASTING L BLK |
| 10473-E392 | CASTING TOP 390 |
| 10225-E391 | GRID UPPER PORCELAIN 390 A + |
| 10156-E30 | HEAT SHIELD 2007 |
| 10711-E32 | EDGE CAP CONTROL COVER LHS |
| 10184-E62 | SHELF SUPPORT BRACKET LHS + |
| 10184-E63 | SHELF SUPPORT BRACKET RHS + |
| 10184-E691 | ALIGNMENT BRACKET BLACK |
| 10958-E400 | TOP CASTING INSERT SS |
| 11228 | CI COOKING GRIDS SET OF 2 |
| 10239-390 | PHENOLIC STANDOFF LHS + |
| 10239-391 | PHENOLIC STANDOFF RHS + |
| 10958-k561 | POST BASE BRACKET BLACK |
| 10958-K541 | POST COVER BLACK |
| 10184-K801 | POST BASE SUPPORT BLACK 2.91 |

| | |
|----------------------------|--|
| 10711-E764 | SIDE SHELF ASSY LEFT 390 |
| 10194-E33 | CONTROL COVER 2V SS |
| 10472-K431 | CONTRL KNOB RESIN LRG BLCK W/SS BA STRIP |
| 24005-12AB | LID-HANDLE BENT, |

Broil King®

REDDI-BILT BARBECUES

ASSEMBLY MANUAL & PARTS LIST

MANUEL DE MONTAGE & LISTE DE PIÈCES



Broil King
CROWN 20 POST
9453-58

RETAIN FOR FUTURE REFERENCE

VEUILLEZ CONSERVER POUR REFERENCE ULTERIEURE

ASSEMBLY VIDEO

VIDÉO MONTRANT
L'ASSEMBLAGE

VIDEO DE
ENSAMBLAGE





BROILKINGBBQ.COM

Onward
MANUFACTURING COMPANY LIMITED
SINCE 1906
585 KUMPF DRIVE
WATERLOO, ONTARIO, CANADA
N2V 1K3

info@omcbbq.com
1-800-265-2150

10084-K77 REV A 11/13

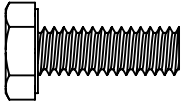
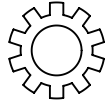
1

- (4)  (4)  (8) 

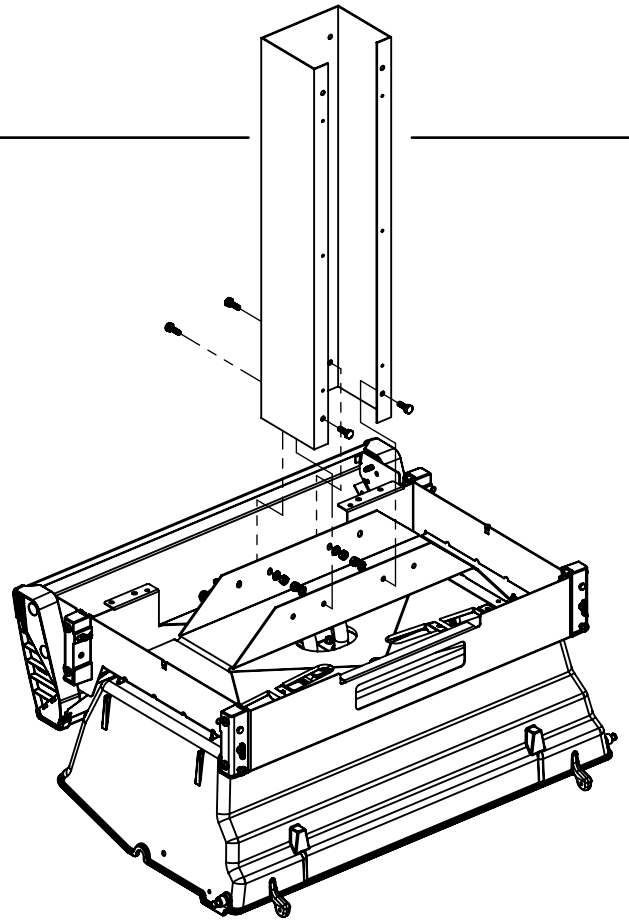
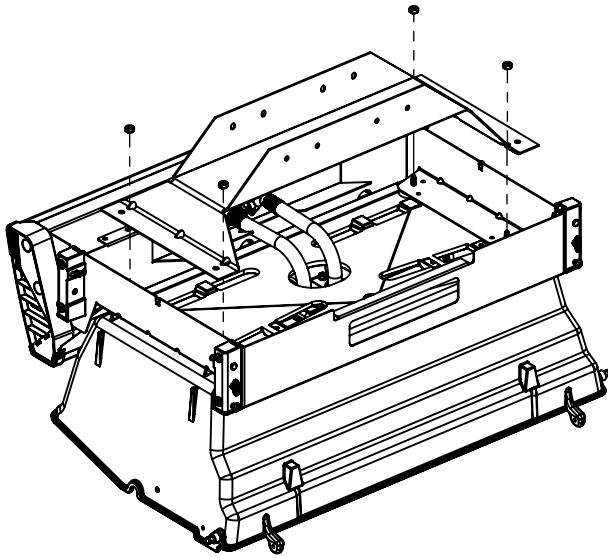

2

11240 INGROUND POST
(OPTIONAL)

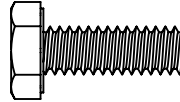
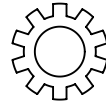
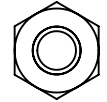
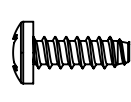
- (4)  (4)  (4)  (6) 

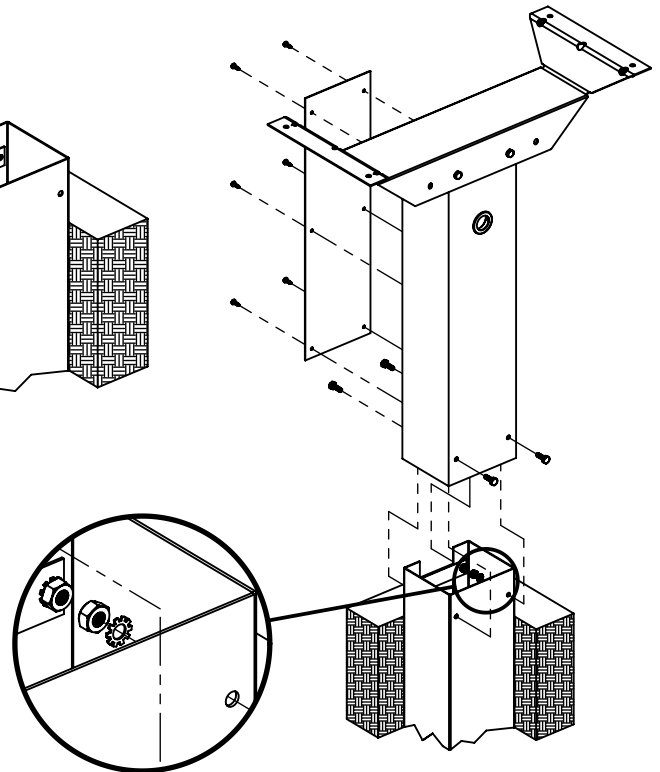
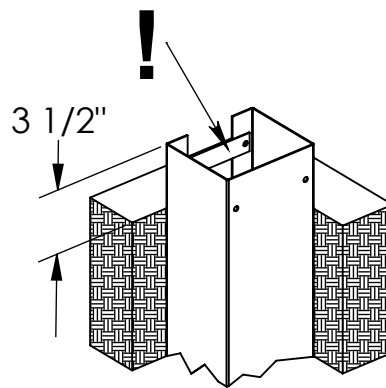
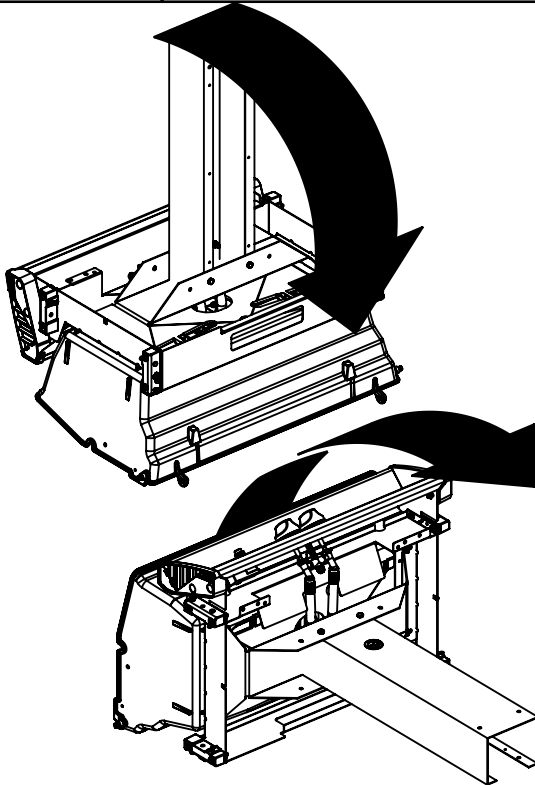

2

11300 DECK MOUNT
(OPTIONAL)

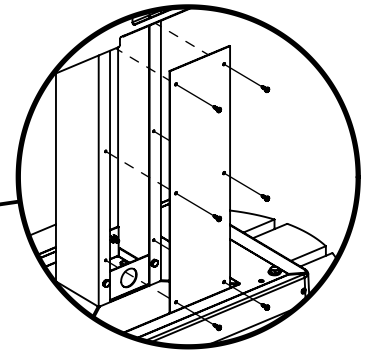
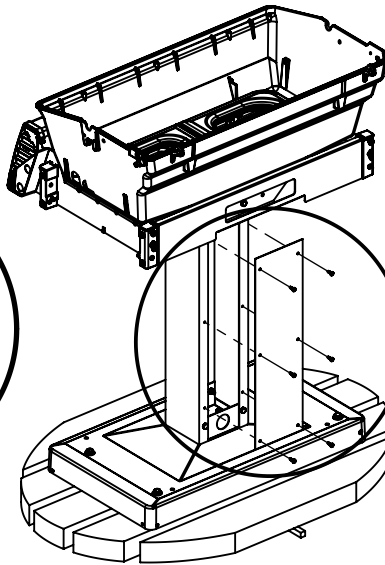
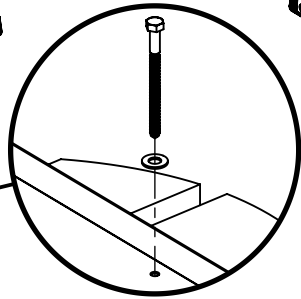
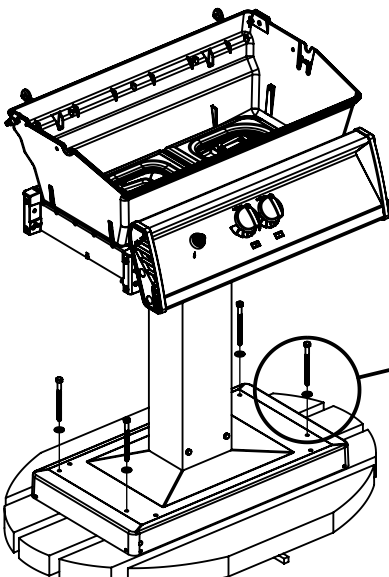
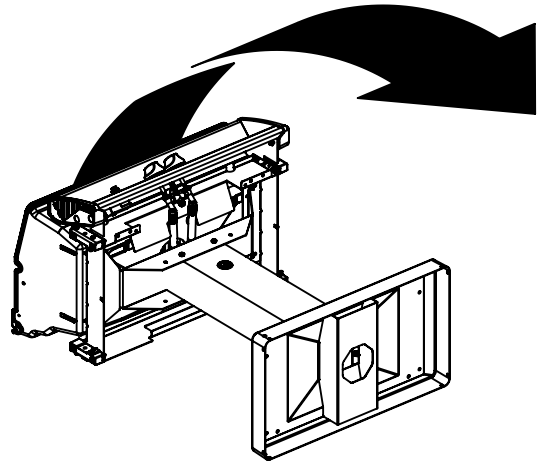
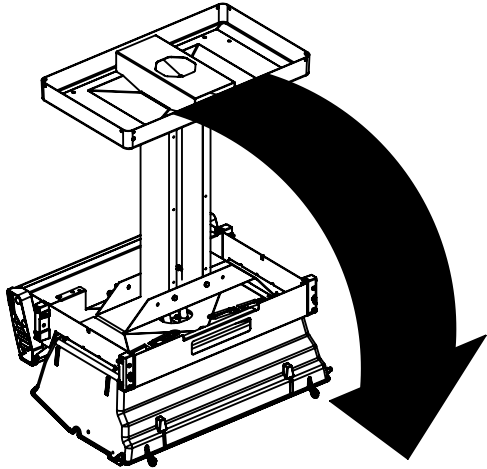
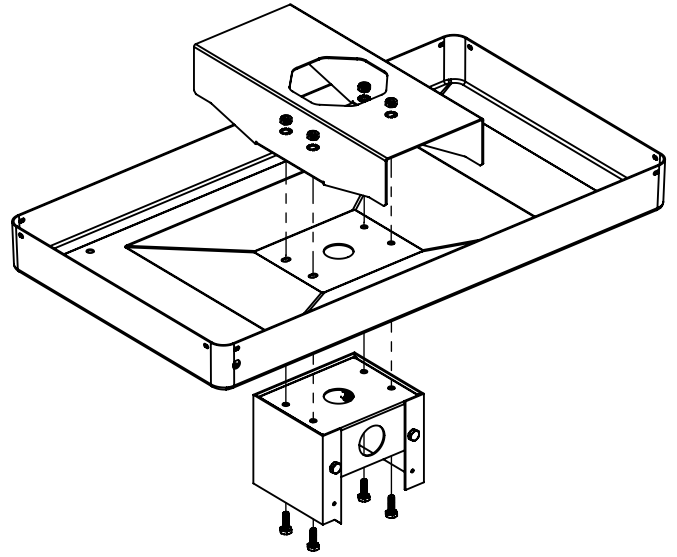
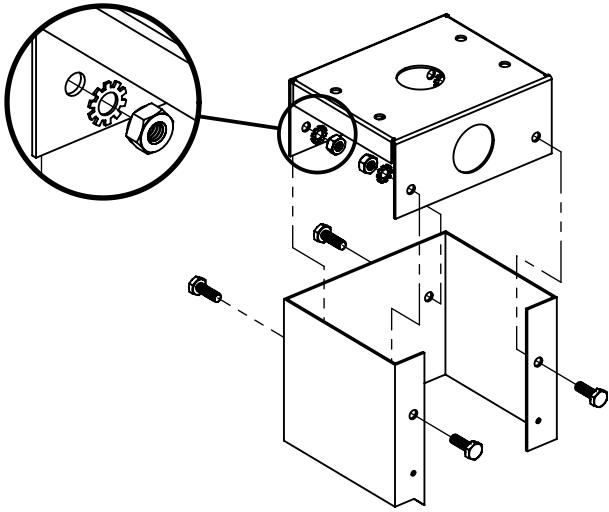
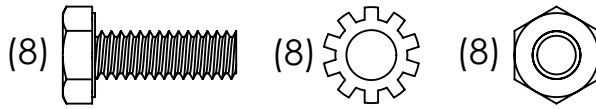

3

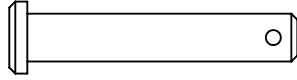
(4) 

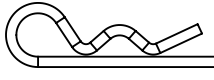
(4) 

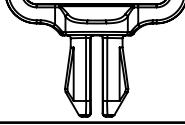
(2) 

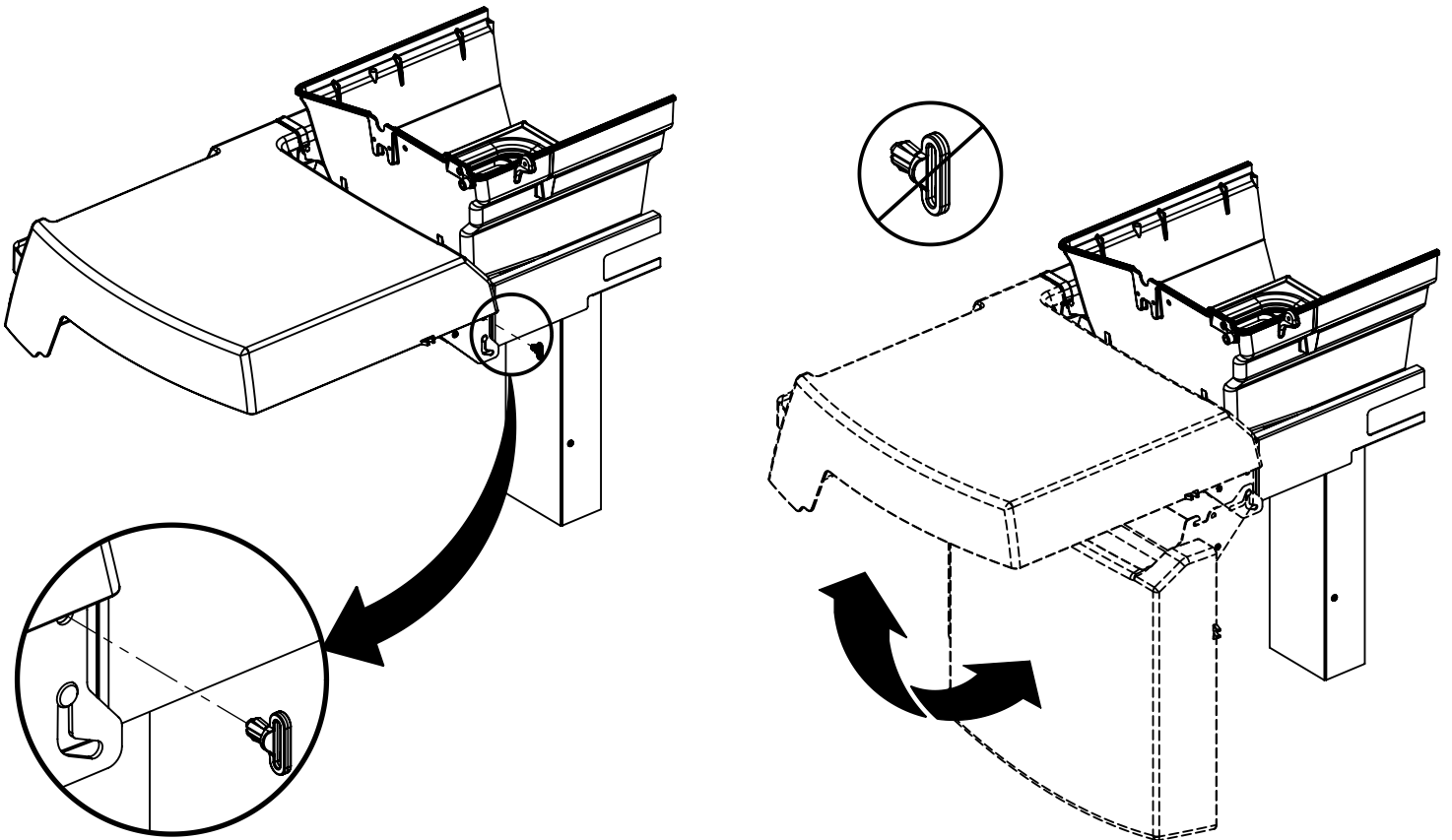
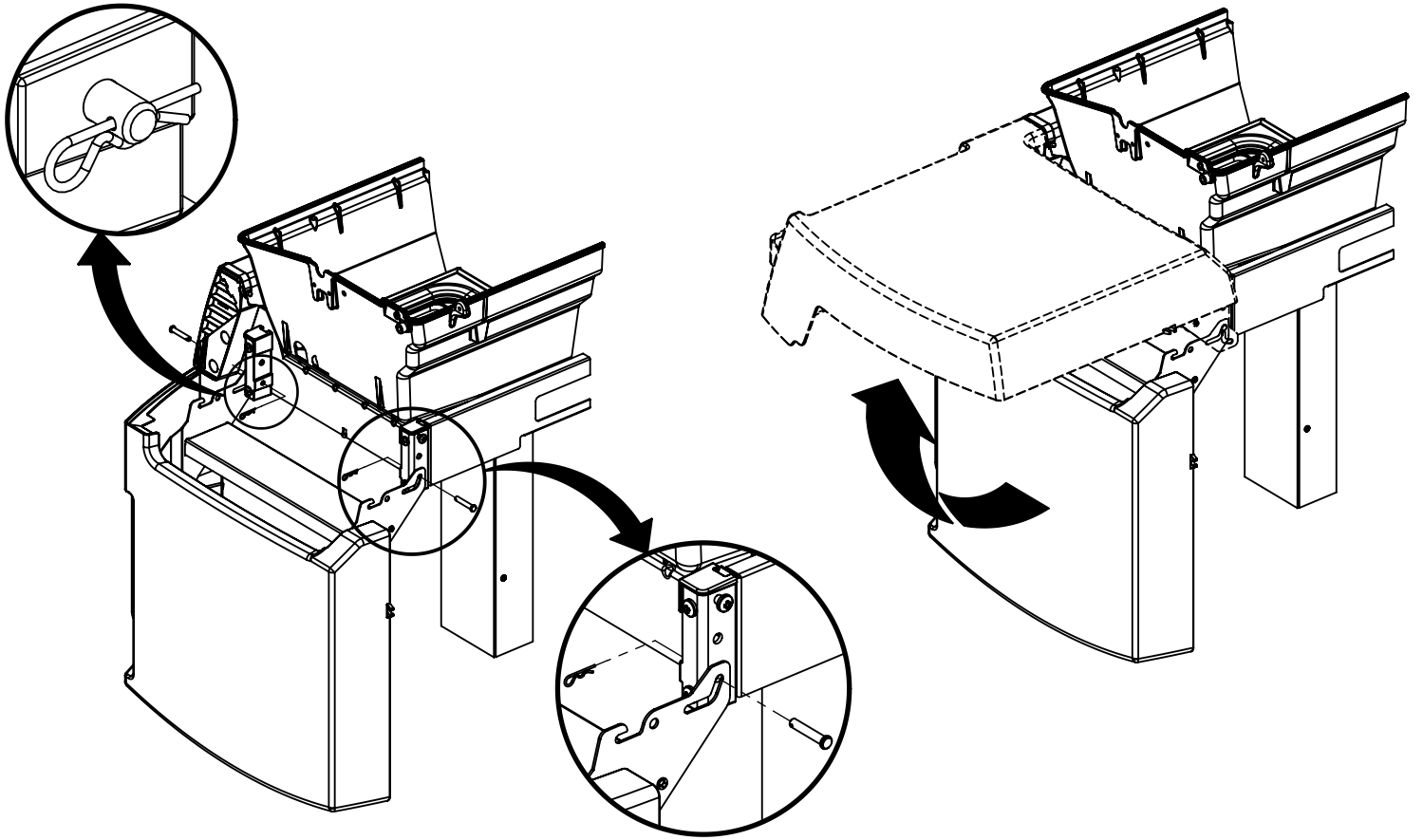

4

(2)

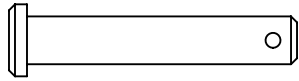

(2)

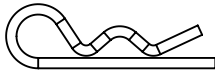

(2)

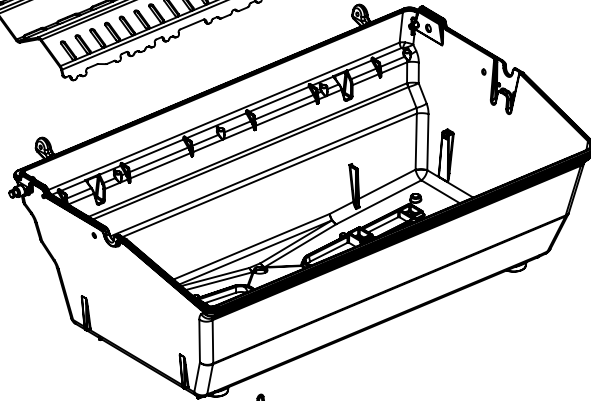
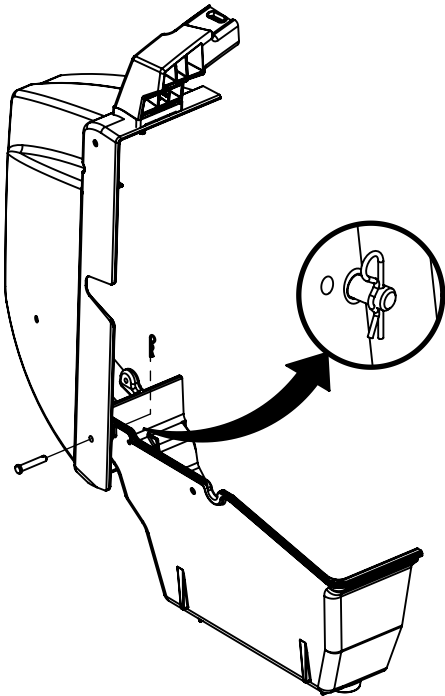
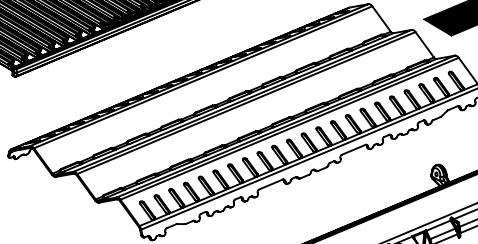
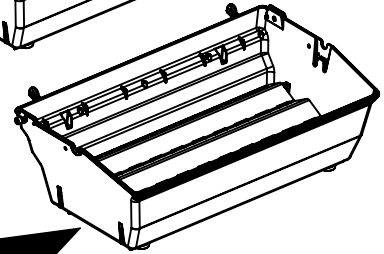
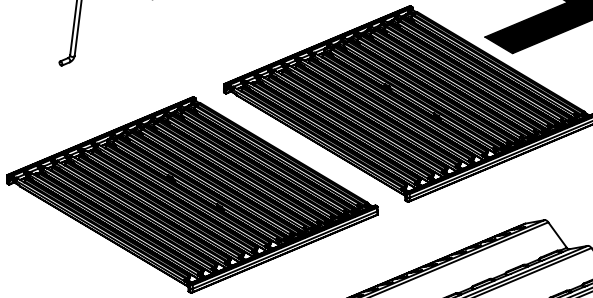
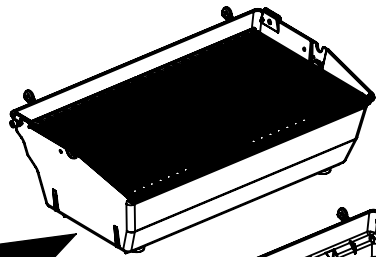
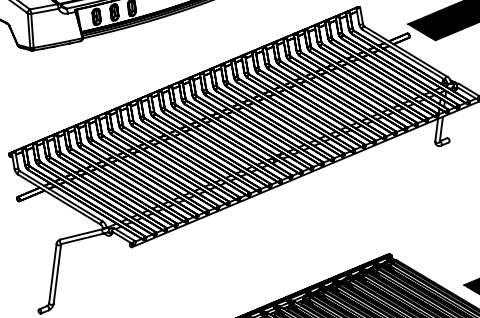
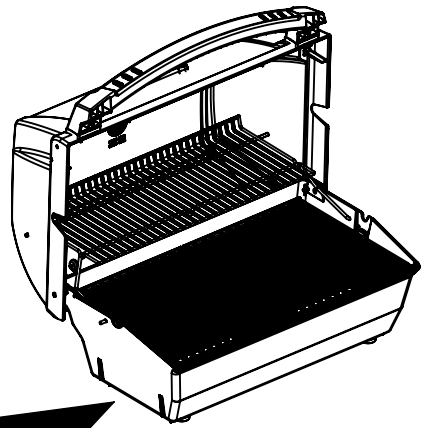
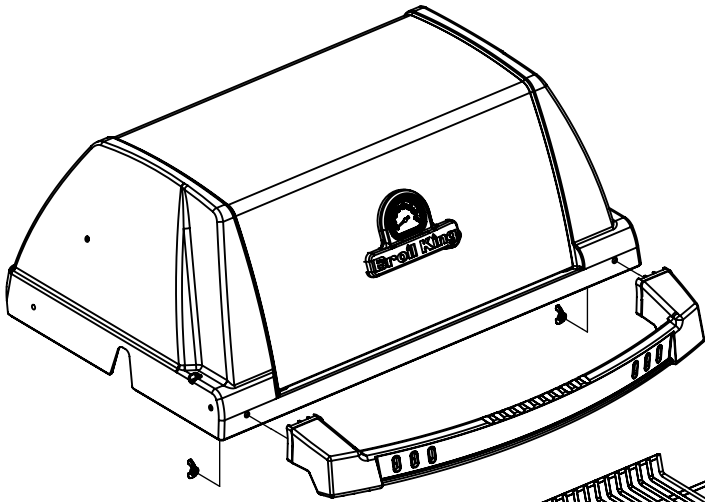

KEY ITEM # **9453-58****OPTIONAL**

| | | |
|-----|-------------|----|
| 1 | 34120194 | 1 |
| 2 | 10473-E392 | 1 |
| 3 | 10081-BK630 | 1 |
| 4 | 10958-E400 | 1 |
| 5 | 10571-6 | 1 |
| 6 | 10240-15 | 6 |
| 6A | S21237 | 2 |
| 7 | S21233 | 6 |
| 8 | 10222-T425 | 1 |
| 9 | 10225-T436 | 2 |
| 11 | 10225-E391 | 1 |
| 15 | 10390-T501 | 1 |
| 17 | 10342-244 | 1 |
| 18 | 10342-T301 | 1 |
| 21 | 10440-T51 | 1 |
| 22 | 10111-K23 | 1 |
| 23 | 10472-K431 | 2 |
| 29 | 10156-E30 | 1 |
| 30 | 10194-E33 | 1 |
| 31 | 10711-E32 | 1 |
| 32 | 10711-E31 | 1 |
| 35 | 10184-E401 | 1 |
| 36 | 10184-E411 | 1 |
| 37 | 10184-E751 | 2 |
| 37A | 10184-E63 | 2 |
| 38 | 10184-E741 | 2 |
| 38A | 10184-E62 | 2 |
| 39 | 10956-E561 | 1 |
| 41 | 10956-E571 | 1 |
| 42 | 10958-K521 | 1 |
| 46 | 10958-K531 | 1 |
| 47 | 10958-K541 | 1 |
| 48 | 10184-E691 | 2 |
| 50 | 10711-E75 | 1 |
| 50A | 10184-E733 | 2 |
| 51 | 10711-E76 | 1 |
| 74 | S21084 | 12 |
| 75 | 10338-391A | 1 |
| 75A | 10184-E706C | 1 |
| 77 | S15111 | 1 |
| 79 | Y-11561 | 8 |
| 80 | Y-11546 | 4 |
| 81 | Y-11545 | 4 |
| 82 | Y-12673 | 2 |
| 83 | S21014 | 12 |
| 84 | Y-12220 | 1 |
| 85 | Y-11211 | 12 |
| 86 | Y-11958 | 2 |
| 87 | Y-11793 | 20 |
| 89 | Y-12860 | 4 |
| 96 | S21125 | 4 |
| 98 | S21124 | 19 |
| 109 | S21136 | 1 |
| 115 | Y-29304 | 2 |

PATIO BASE ASSEMBLY 11300

| | | |
|----|------------|---|
| 40 | 10958-K811 | 1 |
| 45 | 10184-K801 | 1 |
| 48 | 10958-K561 | 1 |
| 83 | S21014 | 4 |
| 85 | Y-11211 | 4 |
| 87 | Y-11793 | 4 |
| 90 | Y-12286 | 4 |
| 92 | Y-12851 | 4 |

POST EXTENSION ASSEMBLY 11240

| | | |
|----|-----------|---|
| 43 | 10958-K55 | 1 |
| 83 | S21014 | 2 |
| 87 | Y-11793 | 2 |
| 88 | 10958-K58 | 1 |

