Comfort-Aire®

Century®

MARS®
Delivering Confidence

REPLACEMENT PARTS LIST

Single Zone Inverter Mini-Split Outdoor Condenser

A-DVH24SF-1

EXPLODED VIEW

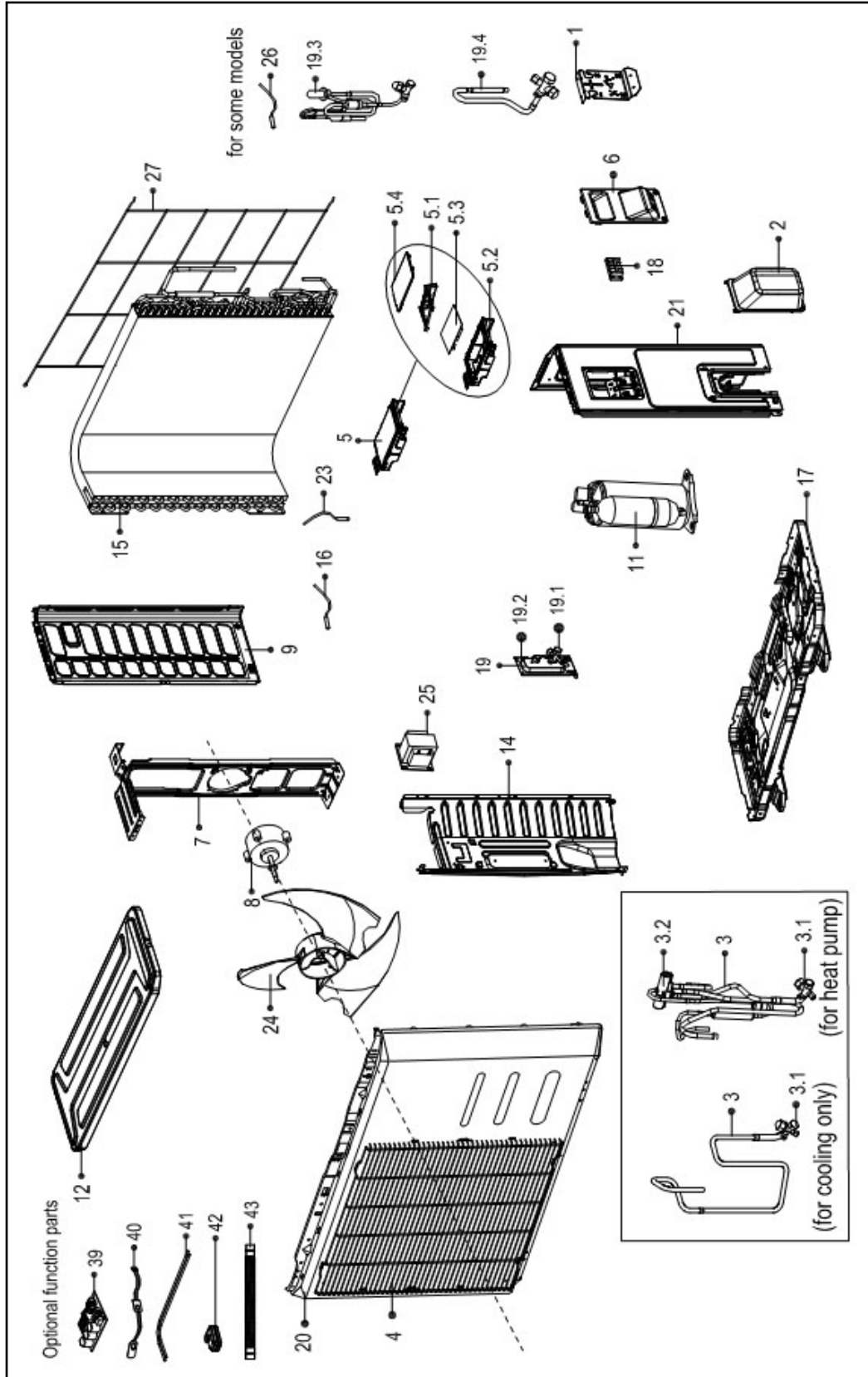

REPLACEMENT PARTS

Location	Part Name	Quantity	Part No.
1	Terminal board	1	12222000004782
2	Line set connection cover	1	12122000007150
3	4-way valve assembly	1	15422000004833
3.1	Stop valve	1	15500204000025
3.2	4-way Valve	1	15500216000026
4	Air outlet grille	1	12222000007425
5	Electronic control box assembly	1	17222000A17828
5.1	Supporting Plate	1	12122000014683
5.2	Cover of electronic control box	1	12222000004827
5.3	Outdoor main control board assembly	1	17122000A14115
5.4	Electric Installing Box Subassembly	1	12122000006856
6	Big handle	1	12222000005102
7	Supporter assembly of fan motor	1	12222000004923
8	Single-phase Asynchronous Motor	1	11002012005429
9	Left side plate assembly	1	12222000004831
11	Inverter Controlled Rotary Compressor	1	11103020000179
12	Top cover assembly	1	12222000004835
14	Partition board assembly	1	12222000004784
15	Condenser assembly	1	15822000A06769
16	Outdoor Temperature Sensor	1	11201007002020
17	Chassis assembly	1	12222000004824
18	Wire holder (terminal strip)	1	17400401000075
19	Liquid valve Assembly	1	15422000007812
19.1	Liquid valve	1	15500208000023
19.2	Installing plate for valves	1	12222000002571
20	Front panel	1	12222000006304
21	Right side plate	1	12222000004830
23	Pipe temperature sensor assembly	1	11201007000069
24	Axial fan	1	12100105000181
25	Reactor	1	17400306000058
26	Discharge temperature sensor assembly	1	11201007000005
27	Rear net	1	12222000004833
40	Crankcase electric heater	1	17402001000119
99	Connection cable assembly of compressor	1	17401203000939

Due to ongoing product improvements, specifications and dimensions are subject to change and correction without notice or incurring obligations. Determining the application and suitability for use of any product is the responsibility of the installer. Additionally, the installer is responsible for verifying dimensional data on the actual product prior to beginning any installation preparations.

Incentive and rebate programs have precise requirements as to product performance and certification. All products meet applicable regulations in effect on date of manufacture; however, certifications are not necessarily granted for the life of a product. Therefore, it is the responsibility of the applicant to determine whether a specific model qualifies for these incentive/rebate programs.

Comfort-Cire®  **Century**

1900 Wellworth Ave., Jackson, MI 49203 • Ph. 517-787-2100 • www.marsdelivers.com

