

HEAT CONTROLLER, INC.

Comfort-Care[®]

PORTABLE ROOM AIR CONDITIONER



PD-91B &
PD-121B

Replacement Parts List

PD-91B & PD-121B Exploded View

Accessories

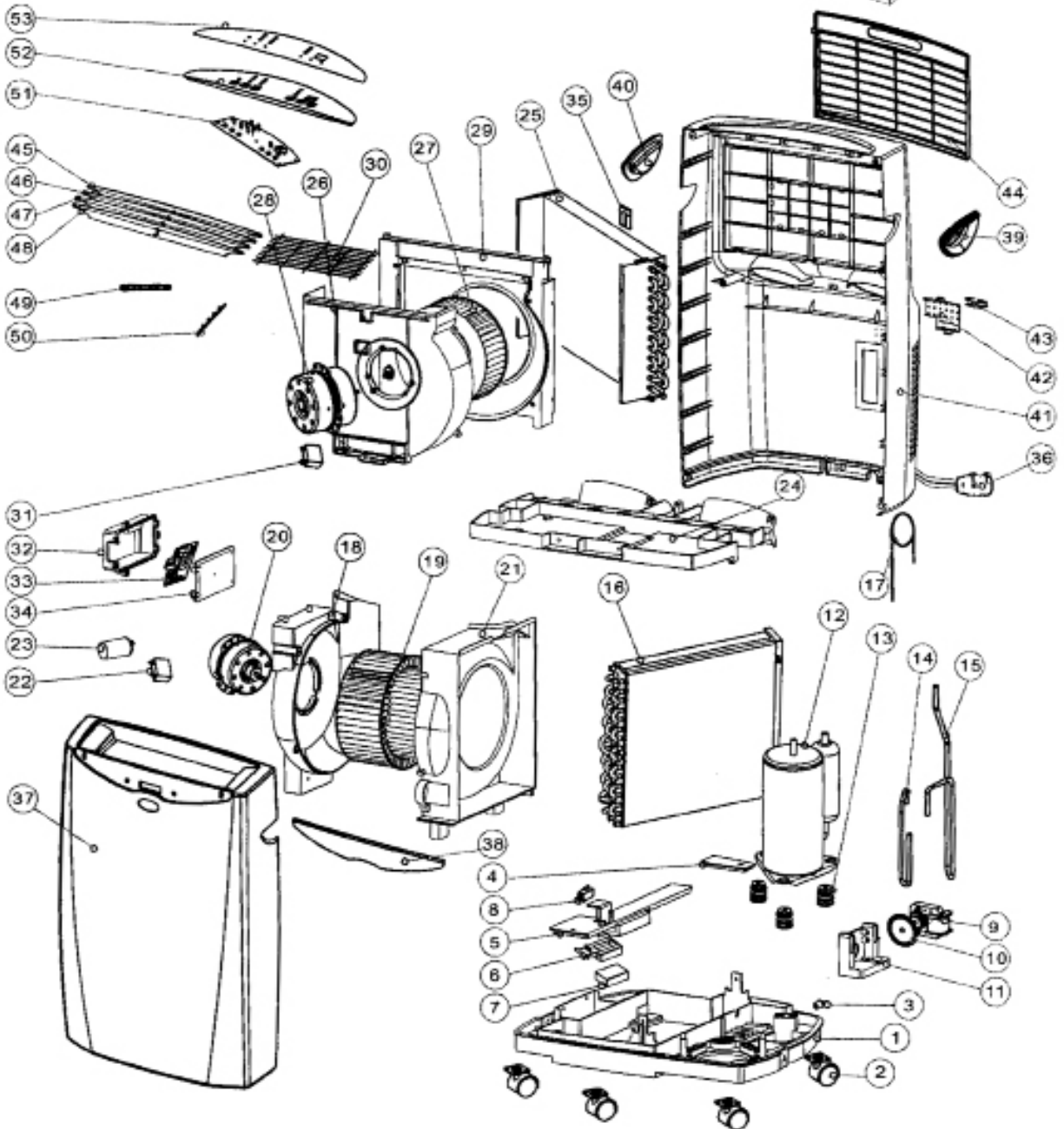
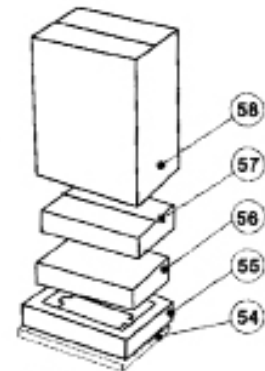
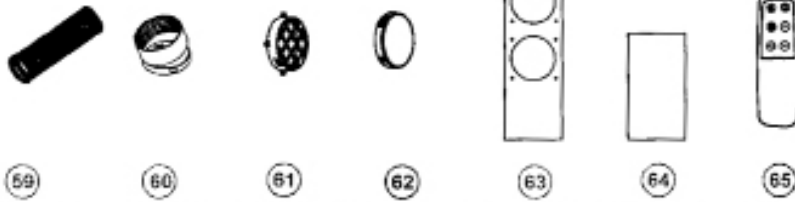

PD-91B Replacement Parts List

NO	PART NUMBER	PART NAME	Q'TY
1	A4805-210-A-11	BASE PAN	1
2	A7402-020	CASTERS	4
3	A7307-060	SOFT CAP	1
4	A5408-250-H-11	DRAIN BUCKET COVER-B	1
5	A5408-230-H-11	DRAIN BUCKET COVER-A	1
6	A5405-110-H-11	TANK LID	1
7	A5404-090	FLOAT	1
8	A2506-020	MICRO SWITCH	1
9	A3002-200	FAN MOTOR(WT-15T1-04)	1
10	A5311-030-A-11	FAN BLADE	1
11	A5812-630-X-11	FIXTURE	1
12	A3203-080	COMPRESSOR ASS'Y(41T086R2)	1
13	A5600-170	RUBBER ISOLATION GROMMETS	3
14	A6209-580	DISCHARGE PIPE	1
15	A6228-750	SUCTION PIPE	1
16	A3422-540	CONDENSER COIL ASSEMBLY	1
17	A6204-050	CAPILLARY TUBE	2
18	A5301-610-AH-22	FAN CASING	1
19	A5304-470-AH-11	BLOWER WHEEL	1
20	A3002-500	FAN MOTOR(LS-53T1-4P)	1
21	A5301-620-AH -22	FAN CASING	1
22	A2509-410	CAPACITOR (9uF/250V FOR CONDENSER FAN MOTOR(20))	1
23	A2509-840	CAPACITOR (30uF/300V FOR COMPRESSOR(12))	1
24	A5702-170-A-22	PLATE	1
25	A3419-540	EVAPORATOR COIL ASSEMBLY	1
26	A5301-590-A-22	FAN CASING	1
27	A5304-310-A-22	BLOWER WHEEL	1
28	A3002-220	FAN MOTOR(LS-23T3-6P)	1
29	A5301-730-A-22	FAN CASING	1
30	A7204-040	SCREEN	1
31	A2509-130	CAPACITOR (8uF/250V FOR EVAPORATOR FAN MOTOR(28))	1
32	A6101-510-AF-11	COVER (CONTROL BOARD)	1
33	A2516-760	CONTROL BOARD	1

PD-91B Replacement Parts List continued

NO	PART NUMBER	PART NAME	Q'TY
34	A5812-570-AF-11	FIXTURE	1
35	A5812-540-P-11	FIXTURE	1
36	A3700-930	POWER SUPPLY CORD COMPLETE	1
37	A4201-290-A-BS	FRONT PANEL	1
38	A6101-190-A-CA	COVER (REMOTE RECEIVER)	1
39	A4258-070-A-BS	HANDLE	1
40	A4258-080-A-BS	HANDLE	1
41	A4219-370-A-BS	REAR PANEL	1
42	A5820-060-A-BS	PLATE	1
43	A4251-260-A-BS	BAR	1
44	A7301-230-A-BS	AIR FILTER	1
45	A4243-410-A-BS	VANE-AIR DEFLECTOR	1
46	A4243-420-A-BS	VANE-AIR DEFLECTOR	1
47	A4243-430-A-BS	VANE-AIR DEFLECTOR	1
48	A4243-440-A-BS	VANE-AIR DEFLECTOR	1
49	A5805-190-A-BS	STRIKE	1
50	A4251-190-P-BS	BAR	1
51	A2521-690	PC BOARD	1
52	A4254-330-H-BS	CONTROL PLATE	1
53	A6931-530-C3	CONTROL PANEL	1
54	A7105-950	PAPER FRAME	1
55	A7108-420	SHOCK ABSORBER	1
56	A7108-430	SHOCK ABSORBER	1
57	A7010-730	CARTON	1
58	A7018-370	CARTON	1
59	A6200-070	HEAT EXHAUST HOSE	2
60	A5815-090-H-BS	HEAT EXHAUST HOSE CONNECTOR	4
61	A5812-210-H-BS	EXHAUST FIXTURE	2
62	A6101-230-H-B S	EXHAUST COVER	2
63	A5700-210	WINDOW PLATE	1
64	A5700-200	WINDOW PLATE	2
65	A2529-090	REMOTE CONTROL ASSEMBLY	1

PD-121B Replacement Parts List

NO	PART NUMBER	PART NAME	Q'TY
1	A4805-210-A-11	BASEPAN	1
2	A7402-020	CASTERS	4
3	A7307-060	SOFTCAP	1
4	A5408-250-H-11	DRAIN BUCKET COVER-B	1
5	A5408-230-H-11	DRAIN BUCKET COVER-A	1
6	A5405-110-H-11	TANK LID	1
7	A5404-090	FLOAT	1
8	A2506-020	MICRO SWITCH	1
9	A3002-200	FAN MOTOR (WT-15T1-04)	1
10	A5311-030-A-11	FAN BLADE	1
11	A5812-630-X-11	FIXTURE	1
12	A3203-130	COMPRESSOR ASSEMBLY (44N100-A2)	1
13	A5600-170	RUBBER ISOLATION GROMMETS	3
14	A6209-580	DISCHARGE PIPE	1
15	A6228-750	SUCTION PIPE	1
16	A3422-540	CONDENSER COIL ASSEMBLY	1
17	A6204-300	CAPILLARY TUBE	1
18	A5301-610-AH-22	FAN CASING	1
19	A5304-470-AH-11	BLOWER WHEEL	1
20	A3002-500	FAN MOTOR (LS-53T1-4P)	1
21	A5301-620-AH-22	FAN CASING	1
22	A2509-410	CAPACITOR (9uF/250V FOR FAN MOTOR (20))	1
23	A2509-940	CAPACITOR (55uF/300V FOR COMPRESSOR (12))	1
24	A5702-170-A-22	PLATE	1
25	A3419-540	EVAPORATOR COIL ASSEMBLY	1
26	A5301-590-A-22	FAN CASING	1
27	A5304-310-A-22	BLOWER WHEEL	1
28	A3002-220	FAN MOTOR (LS-23T3-6P)	1
29	A5301-730-A-22	FAN CASING	1
30	A7204-040	SCREEN	1
31	A2509-130	CAPACITOR (8uF/250V FOR FAN MOTOR (28))	1
32	A6101-510-AF-11	COVER (CONTROL BOARD)	1
33	A2516-760	CONTROL BOARD	1

PD-121B Replacement Parts List continued

NO	PART NUMBER	PART NAME	Q'TY
34	A5812-570-AF-11	FIXTURE	1
35	A5812-540-P-11	FIXTURE	1
36	A3700-940	POWER SUPPLY CORD COMPLETE	1
37	A4201-290-A-BS	FRONT PANEL	1
38	A6101-190-A-DC	COVER (REMOTE RECEIVER)	1
39	A4258-070-A-BS	HANDLE	1
40	A4258-080-A-BS	HANDLE	1
41	A4219-370-A-BS	REAR PANEL	1
42	A5820-060-A-BS	PLATE	1
43	A4251-260-A-BS	BAR	1
44	A7301-230-A-BS	AIR FILTER	1
45	A4243-410-A-BS	VANE-AIR DEFLECTOR	1
46	A4243-420-A-BS	VANE-AIR DEFLECTOR	1
47	A4243-430-A-BS	VANE-AIR DEFLECTOR	1
48	A4243-440-A-BS	VANE-AIR DEFLECTOR	1
49	A5805-190-A-BS	STRIKE	1
50	A4251-190-P-BS	BAR	1
51	A2521-690	PC BOARD	1
52	A4254-330-H-BS	CONTROL PLATE	1
53	A6931-530-C3	CONTROL PLATE	1
54	A7105-950	PAPER FRAME	1
55	A7108-420	SHOCK ABSORBER	1
56	A7108-430	SHOCK ABSORBER	1
57	A7010-730	CARTON	1
58	A7018-370	CARTON	1
59	A6200-070	HEAT EXHAUST HOSE	2
60	A5815-090-H-BS	HEAT EXHAUST HOSE CONNECTOR	4
61	A5812-210-H-BS	EXHAUST FIXTURE	2
62	A6101-230-H-BS	EXHAUST COVER	2
63	A5700-210	WINDOW PLATE	1
64	A5700-200	WINDOW PLATE	2
65	A2529-090	REMOTE CONTROL ASSEMBLY	1

Design, material, performance data and components
subject to change without notice.

HEAT CONTROLLER, INC.

1900 Wellworth Ave., Jackson, MI 49203 ♦ Ph. 517-787-2100 ♦ Fax 517-787-9341

THE QUALITY LEADER IN CONDITIONING AIR

www.heatcontroller.com