



HEAT CONTROLLER, INC.

# Replacement Parts List



**Room Air Conditioner:  
RAD-101B**

# RAD-101B Exploded View

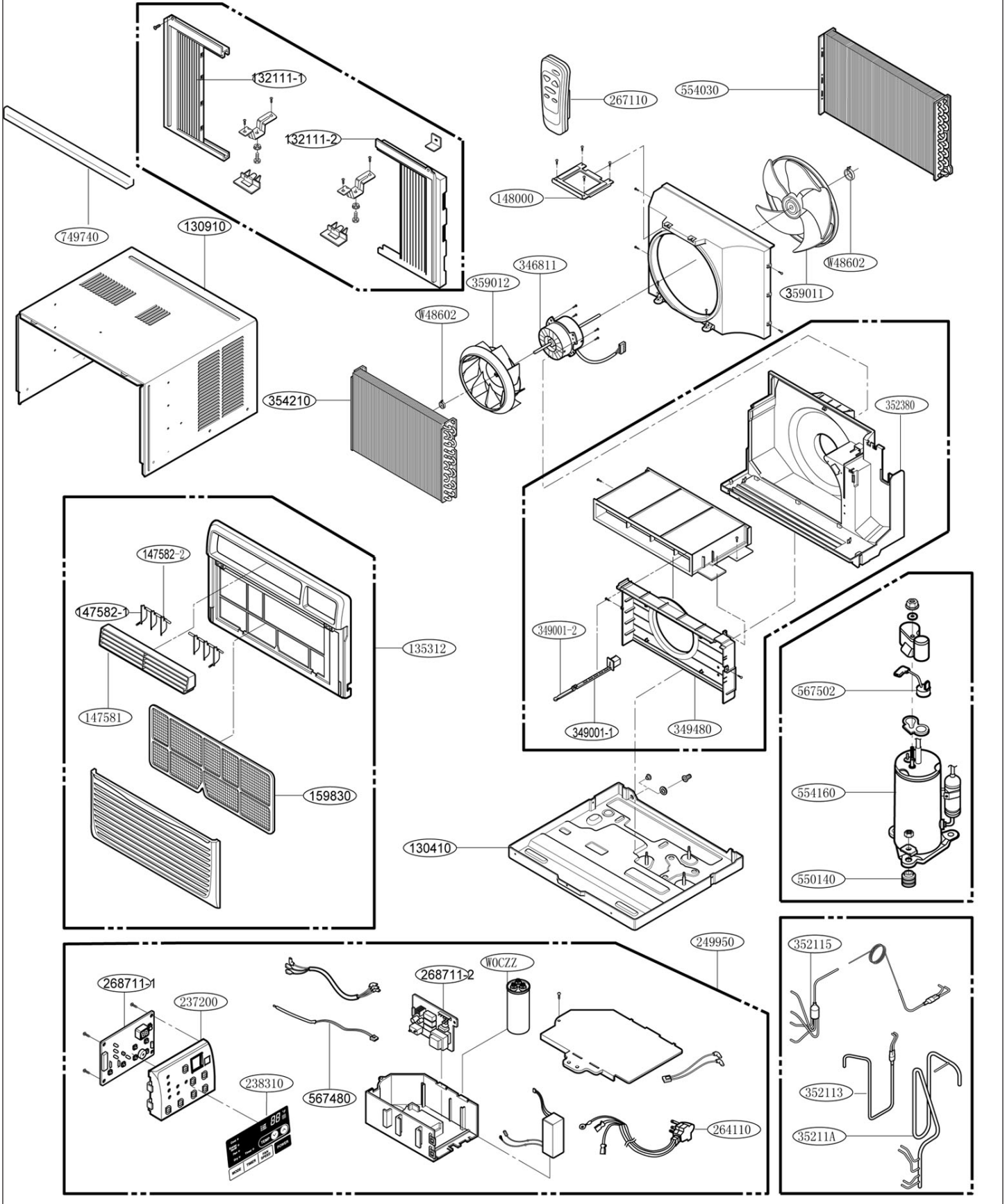

# RAD-101B Parts List

<b>PART DESCRIPTION</b>	<b>LOCATION NO.</b>	<b>PART NO.</b>
Base Assembly,Weld	130410	3041A10041K
Damper,Compressor	550140	4830AR4335A
Duct	352380	5238A10015A
Motor, AC Single	346811	4681A20140D
Fan,Turbo	359012	MDG58298301
Orifice	349480	MF58305901
Damper,Vent	349001-1	4900A20020A
Damper,Vent	349001-2	4900A20020B
Fan,Axial	359011	5900A20015A
Clamp,Spring	W48602	3H02932B
Supporter	148000	4800A30002C
Compressor Set,China	554160	TBZ34628901
Overload Protect	567502	6750U-L031A
Evaporator Assembly,First	354210	5421A10047D
Condenser Assembly,First	554030	5403A20180B
Tube Assembly,Evaporator(In)	352115	5211A25022C
Tube Assembly,Suction	35211A	5211A22029D
Tube Assembly,Discharge	352113	5211A21268A
Panel,Control	237200	3720A10111C
PCB Assembly,Main	268711-2	EBR39283902
Cover Assembly,Display	249950	ACQ31027901
PCB Assembly,Display	268711-1	6871A20418A
Power Cord Assembly	264110	6411A20056E
Escutcheon	238310	MDD61841201
Thermistor,NTC	567480	6323A20004P
Capacitor,Film,Box	W0CZZ	0CZZA20005Y
Cabinet Assembly,Single	130910	3091A10056C
Guide	749740	4974A30067C
Grille Assembly,Front	135312	3531A24016D
Filter Assembly,Air Cleaner	159830	5231A20023A
Louver,Horizontal	147581	4758A20064A
Louver,Vertical	147582-1	4758A20040C
Louver,Vertical	147582-2	4758A20040D
Remote Controller Assembly	267110	6711A20089K
Frame Assembly	132111-1	3211AR3239A
Frame Assembly	132111-2	3211AR3239B

Design, material, performance data and components  
subject to change without notice.

## HEAT CONTROLLER, INC.

1900 Wellworth Ave., Jackson, MI 49203 ♦ Ph. 517-787-2100 ♦ Fax 517-787-9341

THE QUALITY LEADER IN CONDITIONING AIR

**[www.heatcontroller.com](http://www.heatcontroller.com)**