

HEAT CONTROLLER

**REPLACEMENT
PARTS LIST**

**Room Air Conditioner with R-410A:
BGE-123J**

EXPLODED VIEW

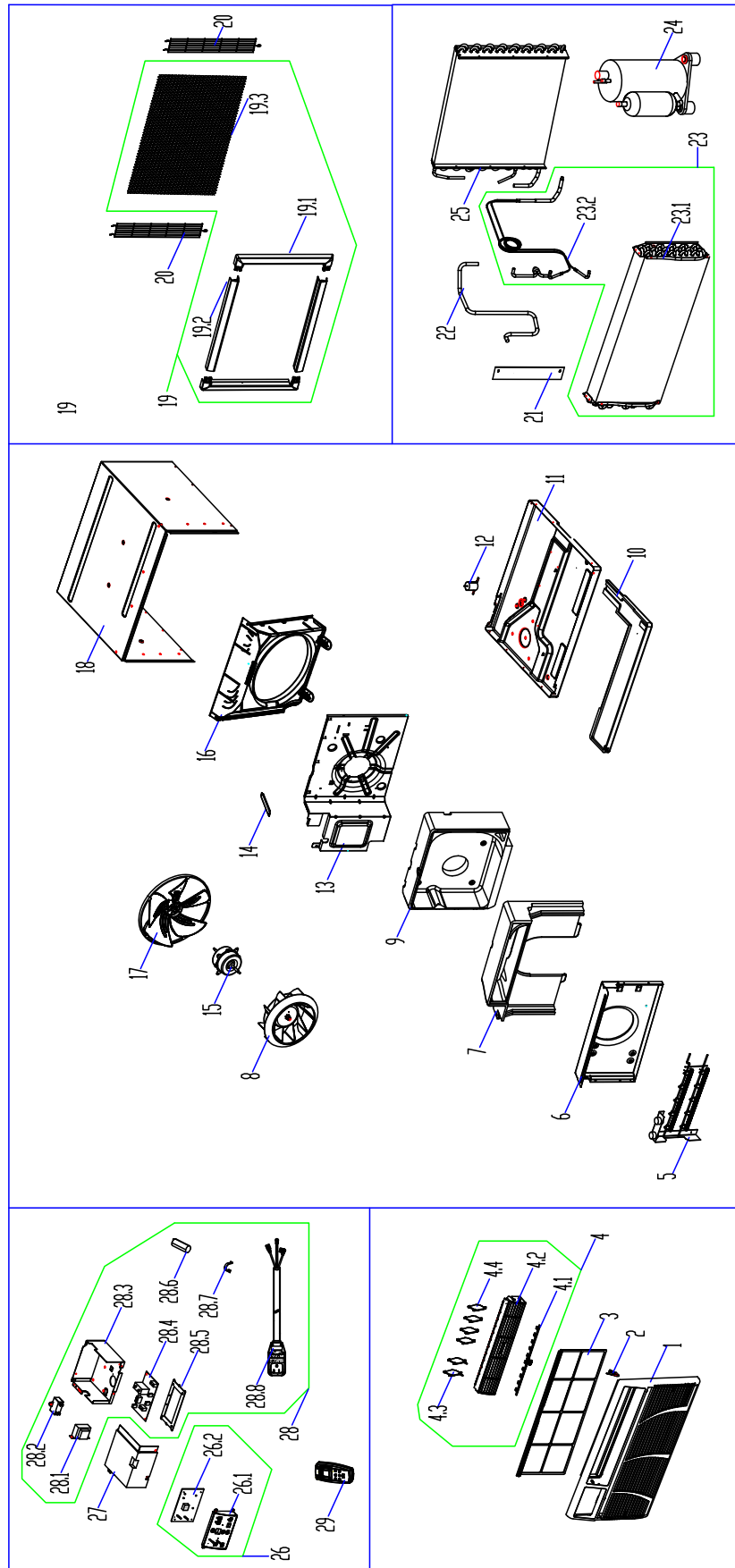

REPLACEMENT PARTS

Location	Part Name	Quantity	Part No.
1	Front panel	1	201121890037
2	Filter guide	2	201121890003
3	Air filter	1	201121890036
4	Air outlet assembly	1	201121890135
4.1	Connecting rod of louver	2	201121890035
4.2	Air outlet assembly	1	201121890136
4.3	Horizontal louver	2	201121890033
4.4	Horizontal louver	4	201121890034
5	Electric heater	1	202403100268
6	Box for Electronic heater	1	201221890060
7	Front volute shell	1	202221890012
8	Centrifugal fan	1	201100100038
9	Rear volute shell	1	202221390003
10	Condenser water tray	1	202221890010
11	Chassis assembly	1	201221890063
12	Drain valve	1	202301610702
13	Front separating board	1	201221890033
14	Linker for front separating board	1	201221890034
15	Asynchronous motor	1	202400400953
16	Rear separating	1	201121390106
17	Axial flow fan	1	201100300022
18	Cabinet	1	201221390086
19	Installation accessory	1	202821590016
19.1	Left and right shutter frame	2	201121890008
19.2	Up and down shutter frame	2	201121890007
19.3	Plastic net	1	201121890009
20	Reseau	1	201221390106
20	Reseau	1	201221890078
21	Separating board for power cord	1	201121890017
22	Discharge pipe assembly	1	201621590263
23	Evaporator coil assembly	1	201521790233
23.1	Evaporator	1	201521890049
23.2	Capillary assembly	1	201621790693
24	Compressor	1	201402000480
25	Condenser assembly	1	201521790234
26	Display box assembly	1	2033218A0115
26.1	Control panel	1	201121890030
26.2	Display board assembly	1	201321990028
	Display panel artwork	1	2020218A0762
27	Cover of electronic control box	1	201221890058
28	Electronic control box assembly	1	203321790191
28.1	Transformer	1	202300900140
28.2	Capacitor of fan motor	1	202401100407
28.3	Electronic control box	1	201221890057
28.4	Main control board assembly	1	201321790103
28.5	Bracket of main control board	1	201121890090
28.6	Capacitor of compressor	1	202401000508
28.7	Capacitor clip	1	201225590048
28.8	Power cord	1	202419990025
29	Remote controller	1	2033550A3128
not shown	Outdoor temperature sensor	1	202301300210

Due to ongoing product improvements, specifications and dimensions are subject to change and correction without notice or incurring obligations. Determining the application and suitability for use of any product is the responsibility of the installer. Additionally, the installer is responsible for verifying dimensional data on the actual product prior to beginning any installation preparations.

Incentive and rebate programs have precise requirements as to product performance and certification. All products meet applicable regulations in effect on date of manufacture; however, certifications are not necessarily granted for the life of a product. Therefore, it is the responsibility of the applicant to determine whether a specific model qualifies for these incentive/rebate programs.

HEAT CONTROLLER

1900 Wellworth Ave., Jackson MI 49203 • Ph. 517-787-2100 • www.heatcontroller.com

A  Company