

---

*Comfort-Aire*®

 **Century**®

**MARS**®  
Delivering Confidence

---

REPLACEMENT PARTS LIST

**Single Zone Ductless Mini-Split  
with Inverter Technology**

A-SVH18SA-1

# EXPLODED VIEW

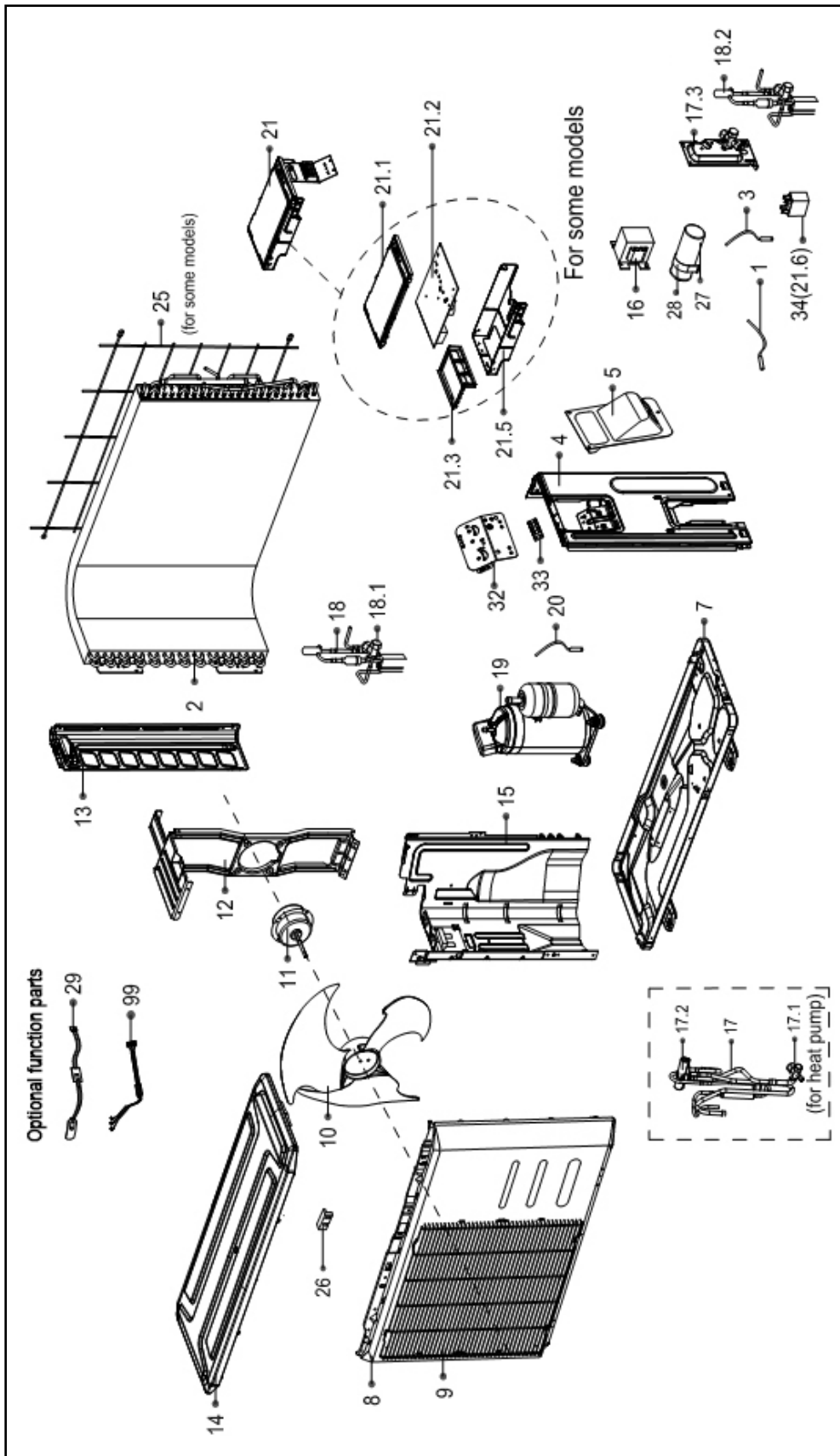

## REPLACEMENT PARTS

Location	Part Name	Quantity	Part No.
1	Room temperature sensor	1	11201007002020
2	Condenser assembly	1	15822000003520
3	Pipe temperature sensor	1	11201007000069
4	Right clapboard assembly	1	12222000005745
5	Big handle assembly	1	12222000005102
7	Chassis assembly	1	12222000004326
8	Front panel assembly	1	12222000004463
9	Air outlet grille	1	12222000007424
10	Axial flow fan	1	12100105000051
11	Single phase asynchronous motor	1	11002012008761
12	Supporter subassembly of fan motor	1	12222200002154
13	Left side plate assembly of cabinet	1	12222000008484
14	Top cover assembly	1	12222200001291
15	Partition board assembly	1	12222200001146
16	Reactor	1	17400306000053
17	4-way valve assembly	1	15422000004716
17.1	Gas valve	1	15500204000058
17.2	4-way valve	1	15500216000026
17.3	Valve plate	1	12222000002571
18	Liquid valve assembly	1	15422000004813
18.1	Liquid valve	1	15500208000028
19	DC inverter rotary compressor	1	11103020000006
20	Discharge temperature sensor	1	11201007000005
21	Electronic control box subassembly	1	17222000A17829
21.1	Electronic installing box subassembly	1	12122000006856
21.2	Outdoor main control board subassembly	1	17122000A14114
21.3	Support of electronic control box	1	12122000014683
21.5	Electronic installing box subassembly	1	12222000001325
21.6	Capacitor of fan motor	1	17400101000019
25	Rear net	1	12222000003622
29	Crankcase electric heater	1	17402001000008
32	Terminal board	1	12222000002259
33	Wire joint	1	17400401000075
99	Compressor wire subassembly	1	174012030000802

---

Due to ongoing product improvements, specifications and dimensions are subject to change and correction without notice or incurring obligations. Determining the application and suitability for use of any product is the responsibility of the installer. Additionally, the installer is responsible for verifying dimensional data on the actual product prior to beginning any installation preparations.

Incentive and rebate programs have precise requirements as to product performance and certification. All products meet applicable regulations in effect on date of manufacture; however, certifications are not necessarily granted for the life of a product. Therefore, it is the responsibility of the applicant to determine whether a specific model qualifies for these incentive/rebate programs.

*Comfort-Cire*®  **Century**

1900 Wellworth Ave., Jackson, MI 49203 • Ph. 517-787-2100 • [www.marsdelivers.com](http://www.marsdelivers.com)

