

HEAT CONTROLLER, INC.

**REPLACEMENT  
PARTS**

**RADS-151A  
Room Air Conditioner**

# Replacement Parts List

RADS-151A		
LOC. NO.	PART NO.	DESCRIPTION
130410	3041A20023T	Base Assembly,Weld
749750	5239A20002A	Guide Assembly,Air
346811	4681A23010A	AC Motor Assembly
359012	5901A20009A	Fan,Turbo
W48602	3H02932C	Clamp,Spring
149980	4998A10013A	Shroud
559011	5900AR1508B	Fan Assembly,Axial
349480	4948A30008A	Orifice
130910	3091AR6057V	Cabinet Assembly,Single
749740	2H00858D	Guide
135312	3531A10201D	Grille Assembly,Front
135314	3530A10146A	Grille,Inlet
147582-1	4758A20042A	Louver,Vertical
147582-2	4758A20042B	Louver,Vertical
147581	4758A30022A	Louver,Horizontal
159830	5231A20008A	Filter,Air
554160	2520UCBK025	Compressor Set,China
550140	4H00982C	Damper,Compressor
354210	5421A20091H	Evaporator Assembly,First
35211A	5211A20441K	Tube Assembly,Suction
5540301	5403A20062P	Condenser Assembly,First
352111	5210A30646A	Tube Assembly,Capillary
352113	5210A30176L	Tube,Discharge
249950	4995A26003B	Case Assembly,Control
567480	6323A20012C	Thermostat Assembly
W0CZZ	0CF1042856A	Capacitor,Film,Box
264110	6411A20056L	Power Cord Assembly
352115-1	5210A30819B	TUBE,EVAPORATOR
352115-2	5210A30819C	TUBE,EVAPORATOR
731273	3127AR3403U	Install Parts Assembly
148000	4800A20001A	Supporter
349600	4960AR1596A	Bracket,Motor
349001	5410A20250C	Damper
267110	6711A20093A	Remote
268711-1	6871A20604A	PCB Assembly,Display
268711-2	EBR39283901	PCB Assembly,Main
137215	3720A10112A	Panel
238310	3831A10021M	Escutchoen

# Exploded View

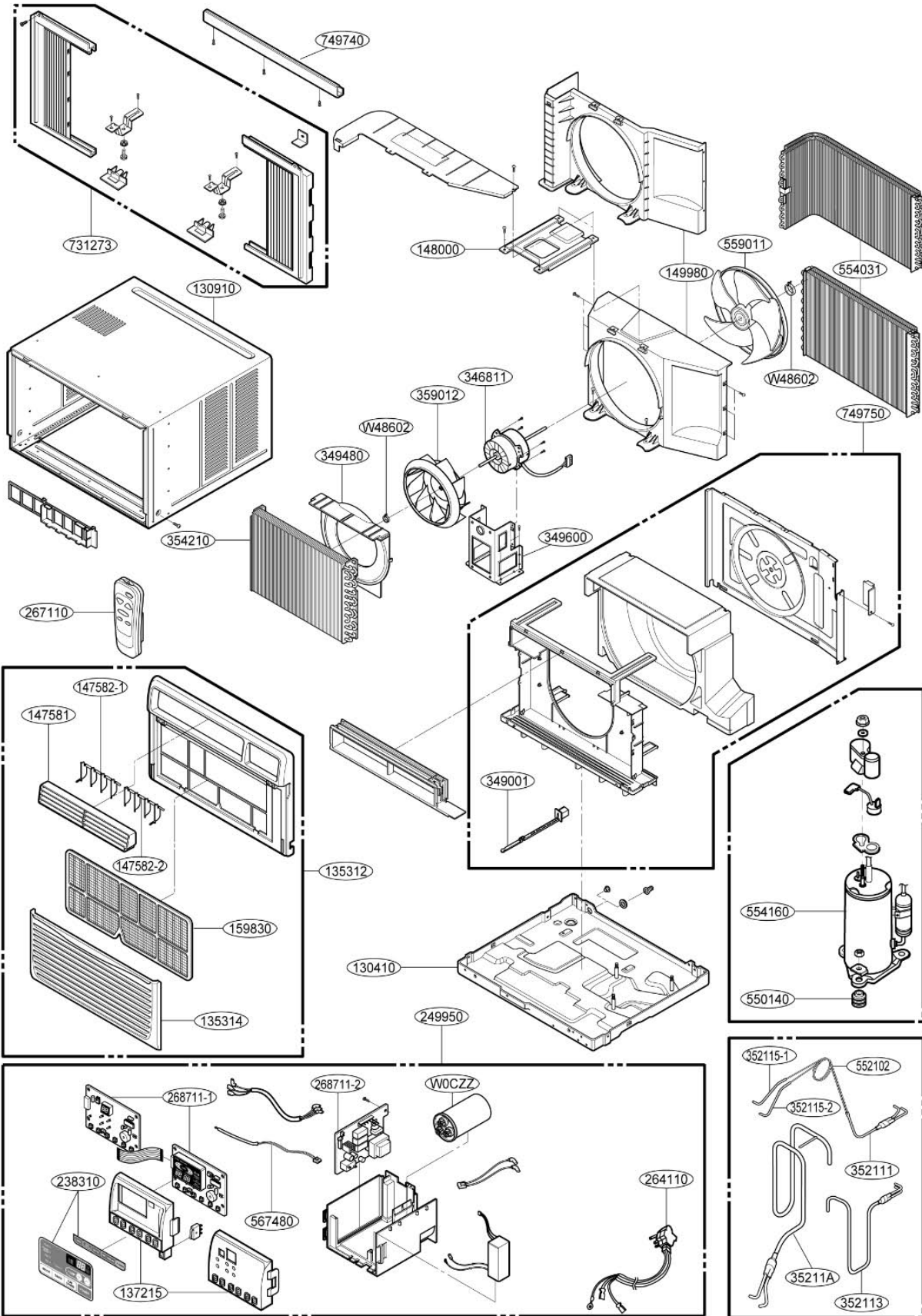

**Design, material, performance data and components  
subject to change without notice.**

## **HEAT CONTROLLER, INC.**

1900 Wellworth Ave., Jackson, Michigan 49203 • Ph. 517-787-2100 • Fax 517-787-9341

THE QUALITY LEADER IN CONDITIONING AIR

**[www.heatcontroller.com](http://www.heatcontroller.com)**