

This Owner's Manual is provided and hosted by [Appliance Factory Parts](#).

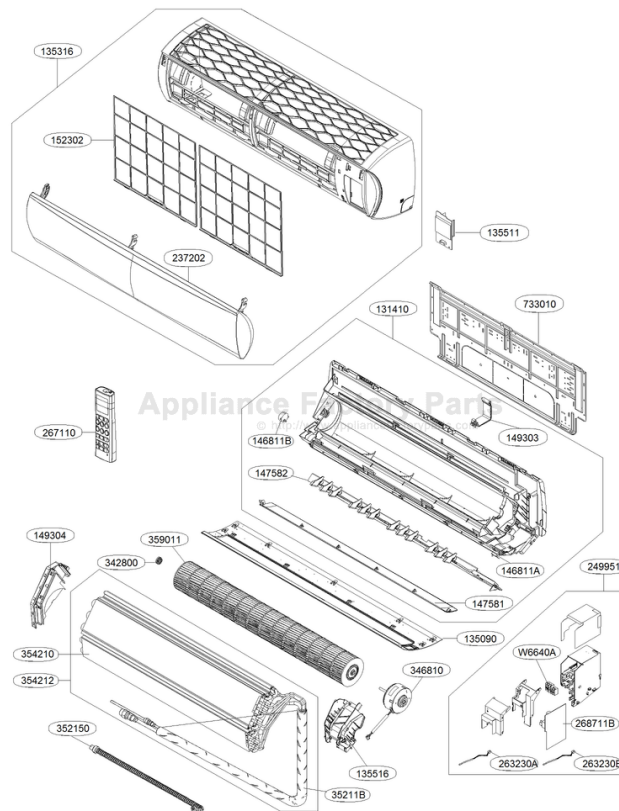

FRIEDRICH MW30Y3J Owner's Manual

[Shop genuine replacement parts for FRIEDRICH
MW30Y3J](#)



[Find Your FRIEDRICH Air Cleaner Parts - Select From 41 Models](#)

----- Manual continues below part list -----

Available Replacement Parts for FRIEDRICH MW30Y3J

P67602110	Fan Assembly Cross Flow
P67603204	Louver, Horizontal
P67603323	Motor Assembly DC Stepping
P67606700	Bearing



FRIEDRICH

1883

SPECIALTY AIR CONDITIONERS

THE EXPERTS IN ROOM AIR CONDITIONING

The Next Generation of Ductless Split Systems

THREE INDOOR UNIT TYPES.



WALL-MOUNTED

Cool only and heat pump models



Friedrich's highest energy efficiencies ever. Up to 25.0 SEER

All of the advantages of ductless systems and Friedrich quality.

ENERGY STAR® models

All Friedrich ductless models exceed the federal 13.0 SEER requirements. Of the 146 total possible single and multizone configurations, 102 models meet ENERGY STAR® published minimums with SEERS up to 25.0 and EERs up to 14.0.

Inverter variable capacity advantages

Inverter technology allows each system to adjust capacity and cooling output to provide only the amount of cooling needed at a given time. For example, an 18000 Btu system will operate even more efficiently at 15500 Btu or less if that's all that's needed, reducing energy consumption and improving comfort.

Optimized airflow

The indoor unit's 4-way air swing quickly disperses cool air to all four corners of the room to provide comfort throughout the room within a few minutes. The 'Air Burst' feature moves air at an even higher speed for rapid cooling.

Zero duct loss

The DOE reports that ducted systems lose an average of 25-40% in performance due to leaks, cracks or disconnections in ductwork. No ductwork means that ductless systems do not experience duct loss, saving energy and money.

Zone cooling flexibility

Independently condition up to (4) separate zones using only a single outdoor unit. Achieve the ultimate in comfort and energy control by cooling or heating only the zones that are in use. And, because each zone is independent of the others, comfort settings can vary.

No dirty air ducts*

Now there's no need to clean dirty air ducts that can harbor dust, germs and allergens that are eventually blown into your home or office.

DIAMONGOLD
Advanced Corrosion Protection™



Protects the outdoor coil against deterioration and extends the life of the unit especially in harsh coastal environments.

*Ductless wall-mounted and ceiling cassette models



CEILING CASSETTE
Heat pumps



CONCEALED DUCT
Heat pumps

Friedrich has up to 131 multizone configurations utilizing wall-mounted, ceiling cassette and concealed duct models.

Zone Cooling and Heating

Occupants have the ability to set the temperature of each zone to their preferred comfort level. The system will run as needed to maintain desired temperature.

Occupants may also turn off units in unoccupied rooms without affecting other zones.

That's the beauty- and efficiency of a Friedrich multizone system.

Enjoy the flexibility to mix and match wall-mounted, ceiling cassette and concealed duct systems to fit your application.



Attractive and high efficiency options for cooling and heating residential and light commercial spaces.



Wall-mounted models mount high on the wall.

The attractive, neutral finish blends well with just about any decor.



Indoor units can be used individually or as part of a multizone system to condition multiple spaces or a large area.

131

MULTIZONE COMBINATIONS

Residential Applications

- Room additions/renovations
- Homes without ductwork
- Bedrooms and family rooms
- Garage workshops
- Sunrooms
- Guest quarters
- Wine cellars

Commercial Applications

- Hotels and other lodging
- Computer rooms/server rooms
- Restaurant kitchen and prep areas
- Offices in warehouse spaces
- Storage facilities
- Buildings where security concerns prevent the use of window units
- Internal areas without exterior wall access

Zone Cooling and Heating

Occupants have the ability to set the temperature to their preferred comfort level. And, you can turn off units in unoccupied rooms.

That's the beauty– and efficiency of a Friedrich multizone system.

Enjoy the flexibility to mix and match wall-mounted, ceiling cassette and concealed duct systems to fit your application.



Features you'll find with Friedrich Ductless Systems:

System Type	Wall-mounted Single Zone	Wall-mounted Multizone	Cassette Single Zone	Cassette Multizone	Concealed Duct Single Zone	Concealed Duct Multizone
Installation	Wall	Wall	Ceiling	Ceiling	Ceiling	Ceiling
Cool only	Y	N	N	N	N	N
Heat pump	Y	Y	Y	Y	Y	Y
115 volt models	Y	N	N	N	N	N
Inverter compressor	Y	Y	Y	Y	Y	Y
SEER	Up to 25.0	Up to 21.7	Up to 19	Up to 16.5	Up to 17.6	Up to 16.5
Auto changeover	Y	N	Y	N	Y	N
Low ambient operation*	Y	Y	Y	Y	Y	Y
24- Hr. Programmable timer	Y	Y	Y	Y	N	N
Remote control	Y	Y	Y	Y	N	N
Wall controller option	Y	Y	Y	Y	Y	Y
7-Day Programmability (with wall control)	Y	Y	Y	Y	Y	Y
Auto restart when power is interrupted	Y	Y	Y	Y	Y	Y
Continuous 'Air Sweep"	Y	Y	Y	Y	N	N
Washable, antimicrobial air filters	Y	Y	Y	Y	Y	Y
Auto shut flaps when unit is off	Y	Y	Y	Y	N	N
Louver Position (Fan/Cool/Heat)	6 / 6 / 6	6 / 6 / 6	4 / 5 / 4	4 / 5 / 4	N	N

*Refer to specification tables for low ambient capabilities.

Powerful airflow for faster heating and cooling.

Optimum air flow

Air is directed downward in heating mode and angled upward during cooling mode so the room feels more comfortable, faster.

Large fans

Powerful fans move the air across the room—up to 39 feet away. That means faster cooling and heating and you feel comfortable sooner no matter where you are in the room.

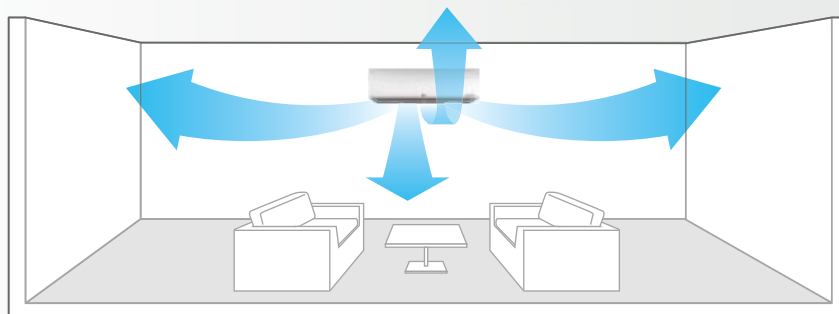
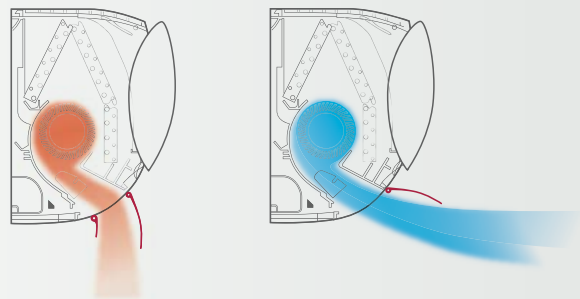

Single Zone

WALL-MOUNTED COOL ONLY

9000-24000 Btu. Cool only models with features for convenient operation, care-free comfort and years of dependability.

Features

- Inverter technology (variable speed compressor)
- High efficiency for low operating cost
- DiamonGold Advanced Corrosion Protection™
- Auto dry indoor coil
- Cooling/Fan mode
- Surge cool
- Natural air flow
- 4-Way auto swing
- Ultra quiet operation
- Sleep mode
- Dehumidifying mode
- Auto restart
- Built-in low ambient standard, down to 14°F (Cooling Mode)
- 24-hour on-off timer
- Condensate sensor connection
- Multiple ease of installation features



MW09C1J, MW12C1J



MW18C3J, MW24C3J



MR09C1J, MR12C1J



MR18C3J



MR24C3J



SPECIFICATIONS

PERFORMANCE RATINGS		Single Wall Mounted - Cool Inv			
		9k	12k	18k	24k
SYSTEM MODEL NO.		M09CJ	M12CJ	M18CJ	M24CJ
INDOOR MODEL		MW09C1J	MW12C1J	MW18C3J	MW24C3J
OUTDOOR MODEL		MR09C1J	MR12C1J	MR18C3J	MR24C3J
SPECIFICATIONS					
CAPACITY COOLING (RATED)	Btu	9,000	11,200	17,000	22,000
CAPACITY COOLING (MIN~MAX)	Btu	3,070~12,120	3,070~13,660	3,070~20,470	3,070~26,270
CAPACITY HEATING (RATED)	Btu	N/A	N/A	N/A	N/A
CAPACITY HEATING (MIN~MAX)	Btu	N/A	N/A	N/A	N/A
COOLING AMPS		6	8.4	7	8.7
HEATING AMPS		N/A	N/A	N/A	N/A
SENSIBLE HEAT RATIO		.89	.83	.79	.81
SEER		21.5	21.5	18.0	20.0
EER		13.3	12.5	12.0	10.8
HSPF		N/A	N/A	N/A	N/A
ENERGY STAR		YES	YES	YES	No
MOISTURE REMOVAL	Pts/h	2.6	3.0	5.3	6.0
AIRFLOW (QUIET, LOW, MED, HIGH)	CFM	124/212/272/335	124/212/272/335	300/399/509/622	300/424/629/742
SOUND RATING - INDOOR	dB-A	19 / 24 / 33 / 38	19 / 24 / 33 / 39	29 / 35 / 40 / 45	29 / 35 / 40 / 46
SOUND RATING - OUTDOOR	dB-A	45	45	53	54
OPERATING RANGE WIND BAFFLE	°F	14(0)~118	14(0)~118	14(0)~118	14(0)~118
OPERATING RANGE (HEATING)	°F	N/A	N/A	N/A	N/A
EST. YEARLY OPERATING COST	\$	61	81	127	183
ELECTRICAL DATA					
POWER SOURCE	V	115/60/1	115/60/1	208/230/60/1	208/230/60/1
MINIMUM AMPACITY	A	12	12	19	19
COOLING WATTS	W	677	896	1416	2037
MAX. TD FUSE/BREAKER	A	20	20	25	25
POWER AND COMMUNICATION CABLE	No. x AWG	4 x 18	4 x 18	4 x 18	4 x 18
REFRIGERATION SYSTEM					
REFRIGERANT		R410A	R410A	R410A	R410A
COMPRESSOR TYPE		Inverter	Inverter	Inverter	Inverter
CONNECTIONS		Flare	Flare	Flare	Flare
LIQUID LINE O.D.	in	1/4	1/4	1/4	3/8
SUCTION LINE O.D.	in	3/8	3/8	1/2	5/8
FACTORY PRECHARGE	ft	41	41	25	25
REFRIGERANT CHARGE	oz	36	36	48	64
MIN./MAX. LINE LENGTH	ft	7~66	7~66	10~66	10~98
MAX. HEIGHT DIFFERENCE	ft	33	33	33	49
DIMENSIONS & WEIGHT					
INDOOR UNIT					
W X H X D	in	35-1/4x 11-1/4x 8-5/16	35-1/4x 11-1/4x 8-5/16	40-5/8x 12-7/8x 9-5/8	40-5/8x 12-7/8x 9-5/8
NET WEIGHT	lbs	23	23	31	32
SHIPPING WEIGHT	lbs	27	27	35	37
OUTDOOR UNIT					
W X H X D	in	30-5/16x 21-5/16x 11-5/16	30-5/16x 21-5/16x 11-5/16	34-5/16x 25-7/8x 12-5/8	34-5/16 x 31-1/2 x 12-5/8
NET WEIGHT	lbs	75	75	108	122
SHIPPING WEIGHT	lbs	79	79	115	130
TOTAL NET WEIGHT	lbs	97	97	139	154
TOTAL SHIPPING WEIGHT	lbs	106	106	150	167

Your operating costs will depend on your utility rates and use. The estimated operating cost is based on a electricity cost of \$.115 per kWh. For more information, visit www.ftc.gov/energy.

Due to continuing research in new energy-saving technology, specifications are subject to change without notice.



Single Zone

25.0 SEER WALL-MOUNTED HEAT PUMP

12000 Btu. Our most efficient unit ever! Features for comfort and convenience year 'round. In heating mode, unit efficiently heats by using approximately 1/4 of the energy required by electric heat.

Features

- Inverter technology (variable speed compressor)
- High efficiency for low operating cost
- DiamonGold Advanced Corrosion Protection™
- Auto dry indoor coil
- Surge cool/heat
- Natural air flow
- Ultra quiet operation
- Sleep mode
- Auto restart
- Auto changeover
- BLDC Motor
- Low ambient operation down to 14°F (Cooling Mode)
- 24-hour on-off timer
- ENERGY STAR® qualified model
- Hidden display (only visible during operation)
- Multiple ease of installation features



MWH12Y3J



MRH12YCJ



SPECIFICATIONS

PERFORMANCE RATINGS		Single Wall Mounted - H/P Inv (High SEER)
		12k
SYSTEM MODEL NO.		HM12YJ
INDOOR MODEL		MWH12Y3J
OUTDOOR MODEL		MRH12Y3J
SPECIFICATIONS		
CAPACITY COOLING (RATED)	Btu	12,000
CAPACITY COOLING (MIN-MAX)	Btu	3070~14660
CAPACITY HEATING@17°F (RATED)	Btu	13,600
CAPACITY HEATING (MIN-MAX)	Btu	3070~20470
COOLING AMPS		3.8
HEATING AMPS		4.3
SENSIBLE HEAT RATIO		.84
SEER		25.0
EER		14.0
HSPF		11.0
ENERGY STAR		Yes (Most Efficient)
MOISTURE REMOVAL	Pts/h	1.7
AIRFLOW (QUIET, LOW, MED, HIGH)	CFM	177 / 283 / 417 / 494
SOUND RATING - INDOOR	dB-A	42 / 36 / 25 / 17
SOUND RATING - OUTDOOR	dB-A	51
OPERATING RANGE (COOLING)	°F	14~118
OPERATING RANGE (HEATING)	°F	14~75
EST. YEARLY OPERATING COST	\$	77
ELECTRICAL DATA		
POWER SOURCE	V	208/230/60/1
MINIMUM AMPACITY	A	10
COOLING WATTS	W	857
HEATING WATTS	W	960
MAX. TD FUSE/BREAKER	A	15
POWER AND COMMUNICATION CABLE	No. x AWG	4 x 18
REFRIGERATION SYSTEM		
REFRIGERANT		R410A
COMPRESSOR TYPE		Twin Rotary
CONNECTIONS		Flare
LIQUID LINE O.D.	in	1/4
SUCTION LINE O.D.	in	3/8
FACTORY PRECHARGE	ft	25
REFRIGERANT CHARGE	oz	44
MIN./MAX. LINE LENGTH	ft	10~49
MAX. HEIGHT DIFFERENCE	ft	23
DIMENSIONS & WEIGHT		
INDOOR UNIT		
W X H X D	in	34-7/16 x 11-5/8 x 9-1/4
NET WEIGHT	lbs	25
SHIPPING WEIGHT	lbs	29
OUTDOOR UNIT		
W X H X D	in	34-5/16 x 25-7/8 x 12-5/8
NET WEIGHT	lbs	95
SHIPPING WEIGHT	lbs	100
TOTAL NET WEIGHT	lbs	119
TOTAL SHIPPING WEIGHT	lbs	128

Your operating costs will depend on your utility rates and use. The estimated operating cost is based on a electricity cost of \$.115 per kWh. For more information, visit www.ftc.gov/energy.

Due to continuing research in new energy-saving technology, specifications are subject to change without notice.



Single Zone

WALL-MOUNTED HEAT PUMPS

9000-18000 Btu. Features for comfort and convenience year 'round. In heating mode, units efficiently heat by using approximately 1/4 of the energy required by electric heat.

Features

- Inverter technology (variable speed compressor)
- High efficiency for low operating cost
- DiamonGold Advanced Corrosion Protection™
- Auto dry indoor coil
- Cooling/Heating/Fan mode
- Surge Cool/Heat
- Natural air flow
- 4-Way auto swing
- Ultra quiet operation
- Sleep mode
- Dehumidifying mode
- Auto restart
- Auto changeover
- Built-in low ambient standard, down to 14°F (Cooling Mode)
- 24-hour on-off timer
- Condensate sensor connection
- Multiple ease of installation features



MW09Y3J, MW12Y3J



MW18Y3J



MR09Y3J, MR12Y3J



MR18Y3J

DIAMONGOLD
Advanced Corrosion Protection™

5YR.
PARTS
WARRANTY

7YR.
COMPRESSOR
WARRANTY

**PRECISION
INVERTER™**

SPECIFICATIONS

PERFORMANCE RATINGS		Single Wall Mounted - H/P Inv		
		9k	12k	18k
SYSTEM MODEL NO.		M09YJ	M12YJ	M18YJ
INDOOR MODEL		MW09Y3J	MW12Y3J	MW18Y3J
OUTDOOR MODEL		MR09Y3J	MR12Y3J	MR18Y3J
SPECIFICATIONS				
CAPACITY COOLING (RATED)	Btu	9,000	11,200	17,000
CAPACITY COOLING (MIN-MAX)	Btu	3,070~12,620	3,070~14,660	3,070~20,470
CAPACITY HEATING @17°F (RATED)	Btu	10,800	13,300	20,200
CAPACITY HEATING (MIN-MAX)	Btu	3,070~17,060	3,070~20,470	3,070~30,700
COOLING AMPS		3	4.2	7
HEATING AMPS		3.7	4.9	7.8
SENSIBLE HEAT RATIO		.88	.81	.78
SEER		21.5	21.5	18.0
EER		13.3	12.5	12.0
HSPF		11.0	11.0	9.7
ENERGY STAR		YES	YES	YES
MOISTURE REMOVAL	Pts/h	2.6	3.0	5.3
AIRFLOW (QUIET, LOW, MED, HIGH)	CFM	124/212/272/335	124/212/272/335	300/399/509/622
SOUND RATING - INDOOR	dB-A	19 / 24 / 33 / 38	19 / 24 / 33 / 39	29 / 35 / 40 / 45
SOUND RATING - OUTDOOR	dB-A	45	45	53
OPERATING RANGE (COOLING)(WIND BAFFLE)	°F	14(0)~118	14(0)~118	14(0)~118
OPERATING RANGE (HEATING)	°F	-4~75	-4~75	-4~75
EST. YEARLY OPERATING COST	\$	61	81	127
ELECTRICAL DATA				
POWER SOURCE	V	208/230/60/1	208/230/60/1	230/208/60/1
MINIMUM AMPACITY	A	10	10	19
COOLING WATTS	W	677	896	1416
MAX. TD FUSE/BREAKER	A	15	15	20
POWER AND COMMUNICATION CABLE	No. x AWG	4 x 18	4 x 18	4 x 18
REFRIGERATION SYSTEM				
REFRIGERANT		R410A	R410A	R410A
COMPRESSOR TYPE		Inverter	Inverter	Inverter
CONNECTIONS		Flare	Flare	Flare
LIQUID LINE O.D.	in	1/4	1/4	1/4
SUCTION LINE O.D.	in	3/8	3/8	1/2
FACTORY PRECHARGE	ft	41	41	25
REFRIGERANT CHARGE	oz	36	36	48
MIN./MAX. LINE LENGTH	ft	7~66	7~66	10~66
MAX. HEIGHT DIFFERENCE	ft	33	33	33
DIMENSIONS & WEIGHT				
INDOOR UNIT				
W X H X D	in	35-1/4 x11-1/4 x8-1/4	35-1/4 x11-1/4 x8-1/4	40-5/8 x 12-7/8 x 9-5/8
NET WEIGHT	lbs	23	23	31
SHIPPING WEIGHT	lbs	27	27	36
OUTDOOR UNIT				
W X H X D	in	30-5/16x21-5/16x11-5/16	30-5/16x21-5/16x11-5/16	34-5/16x25-7/8x12-5/8
NET WEIGHT	lbs	75	75	108
SHIPPING WEIGHT	lbs	79	79	115
TOTAL NET WEIGHT	lbs	98	98	139
TOTAL SHIPPING WEIGHT	lbs	107	107	150

Your operating costs will depend on your utility rates and use. The estimated operating cost is based on a electricity cost of \$.115 per kWh. For more information, visit www.ftc.gov/energy.

Due to continuing research in new energy-saving technology, specifications are subject to change without notice.



Single Zone

WALL-MOUNTED HEAT PUMPS

24000-36000 Btu. Extensive features for comfort and convenience year 'round. In heating mode, units efficiently heat by using approximately 1/4 of the energy required by electric heat.

Features

- Inverter technology (variable speed compressor)
- High efficiency for low operating cost
- DiamonGold Advanced Corrosion Protection™
- Self-cleaning indoor coil
- Cooling/Heating/Fan mode
- Surge Cool/Heat
- Natural air flow
- 4-Way auto swing
- Ultra quiet operation
- Sleep mode
- Dehumidifying mode
- Auto restart
- Auto changeover
- Built-in low ambient standard, down to 14°F (Cooling Mode)
- 24-hour on-off timer
- Condensate sensor connection
- Multiple ease of installation features (see p.10)



MW24Y3J, MW30Y3J, MW36Y3J



MR24Y3J, MR30Y3J, MR36Y3J



SPECIFICATIONS

PERFORMANCE RATINGS		Single Wall Mounted - H/P Inv		
		24k	30k	36k
SYSTEM MODEL NO.		M24YJ	M30YJ	M36YJ
INDOOR MODEL		MW24Y3J	MW30Y3J	MW36Y3J
OUTDOOR MODEL		MR24Y3J	MR30Y3J	MR36Y3J
SPECIFICATIONS				
CAPACITY COOLING (RATED)	Btu	22,000	30,000	33,000
CAPACITY COOLING (MIN~MAX)	Btu	3,070~30,030	3,070~34,000	3,070~34,000
CAPACITY HEATING @17°F (RATED)	Btu	27,600	32,000	35,200
CAPACITY HEATING (MIN~MAX)	Btu	3,070~38,898	3,070~38,900	3,070~38,900
COOLING AMPS		7.9	13.4	17.0
HEATING AMPS		10.7	13.9	16.2
SENSIBLE HEAT RATIO		.66	.61	.67
SEER		21.0	18.5	16.5
EER		12.5	10.0	8.2
HSPF		11.0	10.0	10.0
ENERGY STAR		YES	No	No
MOISTURE REMOVAL	Pts/h	6.8	10.7	10.7
AIRFLOW (QUIET, LOW, MED, HIGH)	CFM	300/389/512/600	459/530/706/848	459/530/706/848
SOUND RATING - INDOOR	dB-A	33 / 39 / 43 / 46	33 / 39 / 44 / 49	37 / 40 / 44 / 49
SOUND RATING - OUTDOOR	dB-A	54	55	55
OPERATING RANGE (COOLING)(WIND BAFFLE)	°F	14(0)~118	14(0)~118	14(0)~118
OPERATING RANGE (HEATING)	°F	-4~75	-4~75	-4~75
EST. YEARLY OPERATING COST	\$	158	270	395
POWER AND COMMUNICATION CABLE	No. x AWG	4 x 18	4 x 18	4 x 18
ELECTRICAL DATA				
POWER SOURCE	V	208/230/60/1	208/230/60/1	230/208/60/1
MINIMUM AMPACITY	A	19	19	19
COOLING WATTS	W	1760	3000	4024
MAX. TD FUSE/BREAKER	A	25	25	25
REFRIGERATION SYSTEM				
REFRIGERANT		R410A	R410A	R410A
COMPRESSOR TYPE		Inverter	Inverter	Inverter
CONNECTIONS		Flare	Flare	Flare
LIQUID LINE O.D.	in	3/8	3/8	3/8
SUCTION LINE O.D.	in	5/8	5/8	5/8
FACTORY PRECHARGE	ft	25	25	25
REFRIGERANT CHARGE	oz	78	78	78
MIN./MAX. LINE LENGTH	ft	10~164	10~164	10~164
MAX. HEIGHT DIFFERENCE	ft	98	98	98
DIMENSIONS & WEIGHT				
INDOOR UNIT				
W X H X D	in	46-7/8 x 13-5/8 x 10-3/8	46-7/8 x 13-5/8 x 10-3/8	46-7/8 x 13-5/8 x 10-3/8
NET WEIGHT	lbs	40	40	40
SHIPPING WEIGHT	lbs	46	46	46
OUTDOOR UNIT				
W X H X D	in	34-5/16 x 31-1/2 x 12-5/8	34-5/16 x 31-1/2 x 12-5/8	34-5/16 x 31-1/2 x 12-5/8
NET WEIGHT	lbs	108	108	108
SHIPPING WEIGHT	lbs	115	115	115
TOTAL NET WEIGHT	lbs	148	148	148
TOTAL SHIPPING WEIGHT	lbs	160	160	160

Your operating costs will depend on your utility rates and use. The estimated operating cost is based on a electricity cost of \$.115 per kWh. For more information, visit www.ftc.gov/energy.

Due to continuing research in new energy-saving technology, specifications are subject to change without notice.



Single Zone

CEILING CASSETTE HEAT PUMPS

24000 and 36000 Btu. Ceiling cassette models install nearly flush with a drop ceiling for a clean and efficient installation.

Features

- Inverter technology (variable speed compressor)
- Internal condensate pump included with 31-1/2" lift
- Natural air flow
- 4-Way cooling
- Surge Cool/Heat
- Cooling mode
- Dehumidifying mode
- Night Quiet Operation
- Built-in low ambient standard, down to 14°F (Cooling mode)
- Fan mode
- Independent vane control
- 5 Fan speeds
- Evaporator frost control
- 24-hour on-off timer
- Auto restart
- Auto changeover
- Temperature display on remote
- Ultra-quiet turbo fan
- DiamonGold Advanced Corrosion Protection™
- Clean, modern look
- Flexible installation
- ENERGY STAR® qualified models
- Precise air distribution

Low profile indoor unit is recessed into the ceiling for a clean look and greater clearance.

NOTE: Grilles are sold separately. See optional accessories on page 30.



MC24Y3J



MC36Y3J



MRC24Y3J



MRC36Y3J

SPECIFICATIONS

PERFORMANCE RATINGS		Single Zone Cassette H/P	
		24k	36k
SYSTEM MODEL NO.		C24YJ	C36YJ
INDOOR MODEL		MC24Y3J	MC36Y3J
OUTDOOR MODEL		MRC24Y3J	MRC36Y3J
SPECIFICATIONS			
CAPACITY COOLING (RATED)	Btu	24,000	36,000
CAPACITY COOLING (MIN-MAX)	Btu	9,700~26,700	14,000~42,000
CAPACITY HEATING @17°F (RATED)	Btu	27,000	40,000
CAPACITY HEATING (MIN-MAX)	Btu	10,900~30,000	14,500~45,000
COOLING AMPS		15.1	20.2
HEATING AMPS		15.1	20.8
SENSIBLE HEAT RATIO		.77	.76
SEER		17.0	19.0
EER		12.5	13.5
HSPF		9.7	9.5
ENERGY STAR *		Yes	Yes
MOISTURE REMOVAL	Pts/h	5.1	7.7
AIRFLOW (LOW, MED, HIGH)	CFM	459 / 530 / 600	918 / 989 / 1,060
SOUND RATING - INDOOR	dB(A)	57	65
SOUND RATING - OUTDOOR	dB(A)	62	67
OPERATING RANGE (COOLING)	°F	5~118	5~118
OPERATING RANGE (HEATING)	°F	-4~64	-4~64
EST. YEARLY OPERATING COST	\$	172	240
ELECTRICAL DATA			
POWER SOURCE	V	208/230/60/1	208/230/60/1
MINIMUM AMPACITY	A	18.1	24.5
COOLING WATTS	W	1910	2970
MAX. TD FUSE/BREAKER	A	30	40
POWER AND COMMUNICATION CABLE	No. x AWG	4 x 18	4 x 18
REFRIGERATION SYSTEM			
REFRIGERANT		R410A	R410A
COMPRESSOR TYPE		Twin Rotary	Twin Rotary
CONNECTIONS		Flare	Flare
LIQUID LINE O.D.	in	3/8	3/8
SUCTION LINE O.D.	in	5/8	5/8
FACTORY PRECHARGE	ft	25	25
REFRIGERANT CHARGE	oz	71	120
MIN./MAX. LINE LENGTH	ft	25~164	25~246
MAX. HEIGHT DIFFERENCE	ft	98	98
DIMENSIONS & WEIGHT			
INDOOR UNIT			
W X H X D	in	33-1/16 x 8-1/16 x 33-1/16	33-1/16 x 11-3/8 x 33-1/16
NET WEIGHT	lbs	45	54
SHIPPING WEIGHT	lbs	58	65
INDOOR UNIT GRILLE** W X H X D	in	37-3/8 x 15/16 x 37-3/8	37-3/8 x 15/16 x 37-3/8
INDOOR UNIT GRILLE** NET WEIGHT	lbs	11	20
OUTDOOR UNIT			
W X H X D	in	37-7/16 x 32-7/8 x 13	37-13/32 x 54-3/8 x 13
NET WEIGHT	lbs	132	203
SHIPPING WEIGHT	lbs	146	227
TOTAL NET WEIGHT	lbs	178	257
TOTAL SHIPPING WEIGHT	lbs	203	293

Your operating costs will depend on your utility rates and use. The estimated operating cost is based on a electricity cost of \$.115 per kWh. For more information, visit www.ftc.gov/energy.

Models require grille. Grille sold separately.

Due to continuing research in new energy-saving technology, specifications are subject to change without notice.



Single Zone

CONCEALED DUCT HEAT PUMPS

24000 and 36000 Btu. Indoor unit is installed in the ceiling or furr down for unobtrusive installation.

Features

- Inverter technology (variable speed compressor)
- Internal condensate pump included with 31-1/2" lift
- Cooling mode
- Dehumidifying mode
- 3 Fan speeds+
- 24-hour on-off timer
- Auto restart
- Auto changeover
- Sleep mode
- Control lock function
- External Static Pressure Range(ESP)
 - 24,000 (0.1 - 0.78) WC
 - 36,000 (0.15 - 0.6) WC



MD24Y3J, MD36Y3J



MRD24Y3J



MRD36Y3J

SPECIFICATIONS

PERFORMANCE RATINGS		Single Zone Concealed Ducted H/P	
		24k	36k
SYSTEM MODEL NO.		D24YJ	D36YJ
INDOOR MODEL		MD24Y3J	MD36Y3J
OUTDOOR MODEL		MR24UY3J	MR36U3J
SPECIFICATIONS			
CAPACITY COOLING (RATED)	Btu	24,000	36,000
CAPACITY COOLING (MIN-MAX)	Btu	9,700~26,700	16,000~41,400
CAPACITY HEATING @17°F (RATED)	Btu	27,000	40,000
CAPACITY HEATING (MIN-MAX)	Btu	10,900~30,000	17,500~48,000
COOLING AMPS		15.1	20.8
HEATING AMPS		15.1	21.4
SENSIBLE HEAT RATIO		.68	.67
SEER		17.0	17.6
EER		12.0	12.1
HSPF		10.0	9.2
ENERGY STAR		No	No
MOISTURE REMOVAL	Pts/h	7.0	10.6
AIRFLOW (LOW, MED, HIGH)	CFM	530 / 618 / 688	706 / 953 / 1,130
SOUND RATING - INDOOR	dB(A)	56	56
SOUND RATING - OUTDOOR	dB(A)	62	67
OPERATING RANGE (COOLING)	°F	5~118	5~118
OPERATING RANGE (HEATING)	°F	-4~64	-4~64
EST. YEARLY OPERATING COST	\$	180	268
ELECTRICAL DATA			
POWER SOURCE		208/230/60/1	208/230/60/1
MINIMUM AMPACITY	A	18.1	24.5
COOLING WATTS	W	2000	2910
MAX. TD FUSE/BREAKER	A	30	40
POWER AND COMMUNICATION CABLE	No. x AWG	4 x 18	4 x 18
REFRIGERATION SYSTEM			
REFRIGERANT		R410A	R410A
COMPRESSOR TYPE		Twin Rotary	Twin Rotary
CONNECTIONS		Flare	Flare
LIQUID LINE O.D.	in	3/8	3/8
SUCTION LINE O.D.	in	5/8	5/8
FACTORY PRECHARGE	ft	25	25
REFRIGERANT CHARGE	oz	71	120
MIN./MAX. LINE LENGTH	ft	25~164	25~246
MAX. HEIGHT DIFFERENCE	ft	98	98
DIMENSIONS & WEIGHT			
INDOOR UNIT			
W X H X D	in	46-9/16 x 11-3/4 x 17-3/4	48-1/2 x 15 x 23-1/4
NET WEIGHT	lbs	73	125
SHIPPING WEIGHT	lbs	95	139
OUTDOOR UNIT			
W X H X D	in	37-7/16 x 32-7/8 x 13	37-7/16 x 54-3/8 x 13
NET WEIGHT	lbs	132	203
SHIPPING WEIGHT	lbs	146	227
TOTAL NET WEIGHT	lbs	205	327
TOTAL SHIPPING WEIGHT	lbs	240	366

Your operating costs will depend on your utility rates and use. The estimated operating cost is based on a electricity cost of \$.115 per kWh. For more information, visit www.ftc.gov/energy.

Due to continuing research in new energy-saving technology, specifications are subject to change without notice.



Remote Controls

Wired and wireless controllers.

Wireless Controller



Cassette & All
Wall-mounted
Models

Wired Controllers

Wall control thermostat with infrared sensor that enables communication between the remote control and the thermostat.



Concealed Ducted
D24YJ, D36YJ
MD12Y3JM, MD18Y3JM



DWC1- Optional
All Ductless Models

PROGRAMMABLE SETTINGS

- Simple program (1 to 7 hour) ON/OFF
- Sleep program ON/OFF at set time
- ON at set time
- OFF at set time
- 7 Day schedule
- Vacation at user set time ON/OFF

Multizone

WALL-MOUNTED HEAT PUMPS

High efficiency heat pumps with features for comfort and convenience year 'round. In heating mode, units efficiently heat by using approximately 1/4 of the energy required by electric heat.

Features

- Inverter technology (variable speed compressor)
- High efficiency for low operating cost
- DiamonGold Advanced Corrosion Protection™
- Self-cleaning indoor coil
- Cooling/Heating/Fan mode
- Surge Cool/Heat
- Natural air flow
- 4-Way auto swing
- Ultra quiet operation
- Sleep mode
- Dehumidifying mode
- Auto restart
- Auto changeover
- Built-in low ambient standard, down to 14°F (Cooling Mode)
- 24-hour on-off timer
- Condensate sensor connection
- Built-in kick stand



MW09Y3J, MW12Y3J



MW18Y3J



MR24DY3JM



MR36TQY3JM



SPECIFICATIONS

PERFORMANCE RATINGS		Multi Zone Wall Mounted		
		9k	12k	18k
INDOOR MODEL		MW09Y3J	MW12Y3J	MW18Y3J
SPECIFICATIONS				
CAPACITY COOLING (RATED)	Btu	9,000	11,200	17,000
CAPACITY HEATING (RATED)	Btu	10,800	13,300	20,200
MOISTURE REMOVAL	Pts/h	2.6	3.0	5.3
AIRFLOW (QUIET, LOW, MED, HIGH)	CFM	124/212/272/335	124/212/272/335	300/399/509/622
SOUND RATING - INDOOR	dB-A	19 / 24 / 33 / 38	19 / 24 / 33 / 39	29 / 35 / 40 / 45
ELECTRICAL DATA				
POWER SOURCE	V, Ø, Hz	230/208-60-1	230/208-60-1	230/208-60-1
REFRIGERATION SYSTEM				
CONNECTIONS		Flare	Flare	Flare
LIQUID LINE O.D.	in	1/4	1/4	1/4
SUCTION LINE O.D.	in	3/8	3/8	1/2
DIMENSIONS & WEIGHT				
W X H X D	in	35-1/4 x 11-1/4 x 8-1/4	35-1/4 x 11-1/4 x 8-1/4	40-5/8 x 12-7/8 x 9-5/8
NET WEIGHT	lbs	23	23	31
SHIPPING WEIGHT	lbs	27	27	35

PERFORMANCE RATINGS		Multi Outdoor	
		24k	36k
OUTDOOR MODEL		MR24DY3JM	MR36TQY3JM
SPECIFICATIONS			
POWER SOURCE		208/230/60/1	208/230/60/1
EST. YEARLY OPERATING COST	\$	122-125	170-245
RUNNING CURRENT COOLING MIN.-RATED-MAX.	A	2.8~6.6~14.0	3.3~11.8~17.0
RUNNING CURRENT HEATING MIN.-RATED-MAX.	A	3.0~10.2~14.1	4.9~15.5~17.8
POWER INPUT COOLING MIN.-RATED-MAX.	W	390~1430~3090	770~2720~3920
POWER INPUT HEATING MIN.-RATED-MAX.	W	420~2210~3100	1120~3580~4100
POWER AND COMMUNICATION CABLE	No. x AWG	4 X 18	4 X 18
DIMENSIONS W X H X D	inch	34-1/4 x 31-7/8 x 12-5/8	35-7/16 x 45-7/8 x 14-5/8
NET WEIGHT	lbs	130	209
SHIPPING WEIGHT	lbs	139	223
REFRIGERATION SYSTEM			
REFRIGERANT		R410A	R410A
FACTORY PRECHARGE	ft	74	98
REFRIGERANT CHARGE	oz	74	124
LIQUID LINE O.D.	in	1/4	1/4
SUCTION LINE O.D.	in	3/8	3/8
MIN./MAX. LINE LENGTH (EACH)	ft	10~82	10~82
MIN./MAX. LINE LENGTH (TOTAL)	ft	75~246	75~246
MAX. HEIGHT DIFFERENCE	ft	49	49
SOUND PRESSURE LEVEL COOLING	A	51	57
SOUND PRESSURE LEVEL HEATING	A	51	57
OPERATING RANGE COOLING MIN. ~ MAX.	°F DB	14 ~ 114	14 ~ 114
OPERATING RANGE HEATING MIN. ~ MAX.	°F WB	5 ~ 64	5 ~ 64
MINIMUM AMPACITY	A	15	17
MAX. TD FUSE/BREAKER	A	25	25

Your operating costs will depend on your utility rates and use. The estimated operating cost is based on a electricity cost of \$.115 per kWh. For more information, visit www.ftc.gov/energy.

Due to continuing research in new energy-saving technology, specifications are subject to change without notice.



Multizone

CEILING CASSETTE HEAT PUMPS

Ceiling cassette models install nearly flush with a drop ceiling for a clean and efficient installation.

Features

- Inverter technology (variable speed compressor)
- Internal condensate pump included with 31-1/2" lift
- Natural air flow
- 4-Way cooling
- Surge Cool/Heat
- Cooling mode
- Dehumidifying mode
- Night Quiet Operation
- Built-in low ambient standard, down to 14°F (Cooling mode)
- Fan mode
- Independent vane control
- 5 Fan speeds
- Evaporator frost control
- 24-hour on-off timer
- Auto restart
- Auto changeover
- Temperature display on remote
- Ultra-quiet turbo fan
- DiamonGold Advanced Corrosion Protection™
- Clean, modern look
- Flexible installation
- ENERGY STAR® qualified models
- Precise air distribution

NOTE: Grilles are sold separately. See optional accessories on page 30.



MC12Y3JM, MC18Y3JM



MR24DY3JM



MR36TQY3JM

SPECIFICATIONS

PERFORMANCE RATINGS		Multi Zone Cassette	
INDOOR MODEL		MC12Y3JM	MC18Y3JM
SPECIFICATIONS			
CAPACITY COOLING (RATED)	Btu	12,000	18,000
CAPACITY HEATING (RATED)	Btu	13,800	19,000
MOISTURE REMOVAL	Pts/h	4.2	4.2
AIRFLOW (LOW, MED, HIGH)	CFM	247 / 283 /335	388 / 424 / 459
SOUND RATING - INDOOR	dB-A	32/35/38	34/37/38
ELECTRICAL DATA			
POWER SOURCE	V, Ø, Hz	208/230, 1, 60	208/230, 1, 60
POWER AND COMMUNICATION CABLE	No. x AWG	4C x 18	4C x 18
REFRIGERATION SYSTEM			
CONNECTIONS		Flare	Flare
LIQUID LINE O.D.	in	1/4	1/4
SUCTION LINE O.D.	in	3/8	1/2
DIMENSIONS & WEIGHT			
W X H X D	in	22-7/16 x 8-7/16 x 22-7/16	22-7/16 x 10-3/32 x 22-7/16
NET WEIGHT	lbs	31	33
SHIPPING WEIGHT	lbs	36	42
INDOOR UNIT GRILLE* W X H X D	in	27-9/16 x 7/8 x 27-9/16	27-9/16 x 7/8 x 27-9/16
INDOOR UNIT GRILLE* NET WEIGHT	lbs	6.6	6.6

PERFORMANCE RATINGS		Multi Outdoor	
		24k	36k
OUTDOOR MODEL		MR24DY3JM	MR36TQY3JM
SPECIFICATIONS			
POWER SOURCE		208/230/60/1	208/230/60/1
EST. YEARLY OPERATING COST	\$	122-125	170-245
RUNNING CURRENT COOLING MIN.-RATED-MAX.	A	2.8~6.6~14.0	3.3~11.8~17.0
RUNNING CURRENT HEATING MIN.-RATED-MAX.	A	3.0~10.2~14.1	4.9~15.5~17.8
POWER INPUT COOLING MIN.-RATED-MAX.	W	390~1430~3090	770~2720~3920
POWER INPUT HEATING MIN.-RATED-MAX.	W	420~2210~3100	1120~3580~4100
POWER AND COMMUNICATION CABLE	No. x AWG	4 X 18	4 X 18
DIMENSIONS W X H X D	inch	34-1/4 x 31-7/8 x 12-5/8	35-7/16 x 45-7/8 x 14-5/8
NET WEIGHT	lbs	130	209
SHIPPING WEIGHT	lbs	139	223
REFRIGERATION SYSTEM			
REFRIGERANT		R410A	R410A
FACTORY PRECHARGE	ft	74	98
REFRIGERANT CHARGE	oz	74	124
LIQUID LINE O.D.	in	1/4	1/4
SUCTION LINE O.D.	in	3/8	3/8
MIN./MAX. LINE LENGTH (EACH)	ft	10~82	10~82
MIN./MAX. LINE LENGTH (TOTAL)	ft	75~246	75~246
MAX. HEIGHT DIFFERENCE	ft	49	49
SOUND PRESSURE LEVEL COOLING	A	51	57
SOUND PRESSURE LEVEL HEATING	A	51	57
OPERATING RANGE COOLING MIN. ~ MAX.	°F DB	14 ~ 114	14 ~ 114
OPERATING RANGE HEATING MIN. ~ MAX.	°F WB	5 ~ 64	5 ~ 64
MINIMUM AMPACITY	A	15	17
MAX. TD FUSE/BREAKER	A	25	25

Models require grille. Grille sold separately.

Your operating costs will depend on your utility rates and use. The estimated operating cost is based on a electricity cost of \$.115 per kWh. For more information, visit www.ftc.gov/energy.

Due to continuing research in new energy-saving technology, specifications are subject to change without notice.



Multizone

CONCEALED DUCT HEAT PUMPS

Indoor unit is installed in the ceiling or furr down for unobtrusive installation.

Features

- Inverter technology (variable speed compressor)
- Internal condensate pump included with 31-1/2" lift
- Cooling mode
- Dehumidifying mode
- 3 Fan speeds+
- 24-hour on-off timer
- Auto restart
- Auto changeover
- Sleep mode
- Control lock function
- External Static Pressure Range(ESP)
 - 12,000 (0.0 - 0.16) WC
 - 18,000 (0.0 - 0.16) WC

Fresh air can be easily introduced to the conditioned space whenever required.



MD12Y3JM, MD18Y3JM



MR24DY3JM



MR36TQY3JM

SPECIFICATIONS

PERFORMANCE RATINGS		Multi Zone Concealed Ducted	
INDOOR MODEL		MD12Y3JM	MD18Y3JM
SPECIFICATIONS			
CAPACITY COOLING (RATED)	Btu	12,000	18,000
CAPACITY HEATING (RATED)	Btu	13,800	19,000
MOISTURE REMOVAL	Pts/h	2.5	4.2
AIRFLOW (LOW, MED, HIGH)	CFM	265 / 300 / 335	406 / 477 / 530
SOUND RATING - INDOOR	dB-A	26/31/33	29/31/34
ELECTRICAL DATA			
POWER SOURCE		208/230, 1, 60	208/230, 1, 60
POWER AND COMMUNICATION CABLE	No. x AWG	4C x 18	4C x 18
REFRIGERATION SYSTEM			
CONNECTIONS		Flare	Flare
LIQUID LINE O.D.	in	1/4	1/4
SUCTION LINE O.D.	in	3/8	1/2
DIMENSIONS & WEIGHT			
W X H X D	in	32-9/32 x 7-15/32 x 22-5/8	43-5/16 x 7-15/32 x 22-5/8
NET WEIGHT	lbs	45	58
SHIPPING WEIGHT	lbs	51	65

PERFORMANCE RATINGS		Multi Outdoor	
		24k	36k
OUTDOOR MODEL		MR24DY3JM	MR36TQY3JM
SPECIFICATIONS			
POWER SOURCE		208/230/60/1	208/230/60/1
EST. YEARLY OPERATING COST	\$	122-125	170-245
RUNNING CURRENT COOLING MIN.-RATED-MAX.	A	2.8~6.6~14.0	3.3~11.8~17.0
RUNNING CURRENT HEATING MIN.-RATED-MAX.	A	3.0~10.2~14.1	4.9~15.5~17.8
POWER INPUT COOLING MIN.-RATED-MAX.	W	390~1430~3090	770~2720~3920
POWER INPUT HEATING MIN.-RATED-MAX.	W	420~2210~3100	1120~3580~4100
POWER AND COMMUNICATION CABLE	No. x AWG	4 X 18	4 X 18
DIMENSIONS W X H X D	inch	34-1/4 x 31-7/8 x 12-5/8	35-7/16 x 45-7/8 x 14-5/8
NET WEIGHT	lbs	130	209
SHIPPING WEIGHT	lbs	139	223
REFRIGERATION SYSTEM			
REFRIGERANT		R410A	R410A
FACTORY PRECHARGE	ft	74	98
REFRIGERANT CHARGE	oz	74	124
LIQUID LINE O.D.	in	1/4	1/4
SUCTION LINE O.D.	in	3/8	3/8
MAX. LINE LENGTH	ft	246	246
MAX. HEIGHT DIFFERENCE	ft	49	49
SOUND PRESSURE LEVEL COOLING	A	51	57
SOUND PRESSURE LEVEL HEATING	A	51	57
OPERATING RANGE COOLING MIN. ~ MAX.	°F DB	14 ~ 114	14 ~ 114
OPERATINGRANGE HEATING MIN. ~ MAX.	°F WB	5 ~ 64	5 ~ 64
MINIMUM AMPACITY	A	15.4	16.8
MAX. TD FUSE/BREAKER	A	25	25

Your operating costs will depend on your utility rates and use. The estimated operating cost is based on a electricity cost of \$.115 per kWh. For more information, visit www.ftc.gov/energy.

Due to continuing research in new energy-saving technology, specifications are subject to change without notice.



Multizone

Mix and match wall-mounted, concealed duct and ceiling cassette models.



131

**MULTIZONE
COMBINATIONS**

Enjoy the flexibility to mix and match systems to fit your application.

DIAMONGOLD
Advanced Corrosion Protection™



5YR.
PARTS
WARRANTY

7YR.
COMPRESSOR
WARRANTY

**PRECISION
INVERTER™**

SPECIFICATIONS

24K		Combination of Indoor Units (kBTU/h Class)													
2 Indoor Units	Wall Mounted			Ducted		Cassette		Capacity			Efficiency				
	9K	12K	18K	12K	18K	12K	18K	Min	Nominal	Max	SEER	EER	HSPF	COP	E-STAR*
◆◆								10798	17000	19800	19.0	12.6	7.7	3.0	—
◆	◆							11100	17000	23100	19.0	12.8	7.7	3.1	—
◆		◆						11400	19200	27500	19.0	13.1	8.2	3.3	YES
◆			◆					10798	18600	23100	16.7	12.1	7.8	3.1	—
◆				◆				10798	18600	27500	16.7	12.3	8.2	3.3	YES
◆						◆		10798	18600	23100	19.0	12.8	7.7	3.1	—
◆							◆	10798	18600	27500	19.0	13.1	8.2	3.3	YES
	◆◆							11400	19200	25500	19.0	13.1	8.2	3.3	YES
	◆	◆						11400	19200	27500	19.0	13.1	8.2	3.3	YES
	◆		◆					11400	18600	25500	16.7	12.3	8.2	3.3	YES
	◆			◆				11400	18600	27500	16.7	12.3	8.2	3.3	YES
	◆					◆		11400	18600	25500	19.0	13.1	8.2	3.3	YES
	◆						◆	11400	18600	27500	19.0	13.1	8.2	3.3	YES
		◆	◆					11400	18600	25500	16.7	12.3	8.2	3.3	YES
		◆				◆		11400	18600	27500	19.0	13.1	8.2	3.3	YES
			◆◆					12300	18600	25500	14.4	11.5	8.1	3.3	—
						◆◆		12300	18600	25500	19.0	13.1	8.2	3.3	YES
3 Indoor Units	◆◆◆							11700	19200	28800	21.7	13.4	9.4	3.5	YES
	◆◆	◆						11700	19200	28800	21.7	13.4	9.4	3.5	YES
	◆◆			◆				11700	18600	28800	19.5	12.6	9.0	3.5	YES
	◆◆					◆		11700	18600	28800	21.7	13.4	9.4	3.5	YES
	◆	◆◆						11700	19200	28800	21.7	13.4	9.4	3.5	YES
	◆			◆◆				11700	18600	28800	19.0	12.6	9.0	3.5	YES
	◆					◆◆		11700	18600	28800	21.7	13.4	9.4	3.5	YES
	◆	◆		◆				11700	18600	28800	19.0	12.6	9.0	3.5	YES
	◆	◆					◆	11700	18600	28800	21.7	13.4	9.4	3.5	YES
36K		Combination of Indoor Units (kBTU/h Class)													
2 Indoor Units	Wall Mounted			Ducted		Cassette		Capacity			Efficiency				
	9K	12K	18K	12K	18K	12K	18K	Min	Nominal	Max	SEER	EER	HSPF	COP	E-STAR*
◆◆								10798	18000	19800	13.5	9.5	9.3	2.9	—
◆	◆							12597	21000	23100	14.1	10.0	8.9	2.8	—
◆		◆						16197	27000	29700	15.8	11.2	10.0	3.1	—
◆			◆					10798	34000	36300	13.8	9.7	8.9	2.8	—
◆				◆				10798	34000	36300	15.4	10.9	9.5	3.1	—
◆						◆		10798	34000	36300	14.1	10.0	8.9	2.8	—
◆							◆	10798	34000	36300	15.8	11.2	10.0	3.1	—
	◆◆							14397	24000	26400	14.7	10.3	10.0	3.1	—
	◆	◆						17996	30000	33000	16.4	11.5	10.0	3.1	—
	◆		◆					17996	34000	36300	14.3	10.1	9.5	3.1	—
	◆			◆				17996	34000	36300	16.0	11.3	9.5	3.1	—
	◆					◆		17996	34000	36300	14.7	10.3	10	3.1	—
	◆						◆	17996	34000	36300	16.4	11.5	10	3.1	—
		◆◆						19796	33000	36300	17.1	11.5	10.1	3.2	—
		◆	◆					19796	34000	36300	16.0	11.3	9.5	3.1	—
		◆		◆				19796	34000	36300	15.8	11.2	9.6	3.1	—

*Systems meet ENERGY STAR® published minimums.

SPECIFICATIONS

36K		Combination of Indoor Units (kBTU/h Class)														
		Wall Mounted			Ducted		Cassette		Capacity			Efficiency				
		9K	12K	18K	12K	18K	12K	18K	Min	Nominal	Max	SEER	EER	HSPF	COP	E-STAR*
			◆			◆		19796	34000	36300	16.4	11.5	10.0	3.1	—	
			◆				◆	19796	34000	36300	17.1	11.5	10.1	3.2	—	
				◆◆				14397	24000	26400	13.9	9.9	9.0	3.0	—	
				◆	◆			17996	30000	33000	15.5	11.1	9.0	3.0	—	
				◆		◆		14397	24000	26400	14.3	10.1	9.5	3.1	—	
				◆			◆	17996	30000	33000	16.0	11.3	9.5	3.1	—	
					◆◆			19796	33000	36300	15.4	11.0	9.0	3.0	—	
					◆	◆		19796	33000	36300	16.0	11.3	9.5	3.1	—	
					◆		◆	19796	33000	36300	15.8	11.2	9.6	3.1	—	
						◆◆		14397	24000	26400	14.7	10.3	10.0	3.1	—	
						◆	◆	17996	17996	17996	16.4	11.5	10.0	3.1	—	
							◆◆	19796	33000	36300	17.1	11.5	10.1	3.2	—	
◆◆◆								16197	27000	29700	15.8	11.2	10.0	3.1	—	
◆◆	◆							17996	30000	33000	16.4	11.5	10.0	3.1	—	
◆◆		◆						20396	34000	37400	17.5	12.5	10.5	3.4	YES	
◆◆			◆					10798	34000	37400	16.0	11.3	9.5	3.1	—	
◆◆				◆				10798	34000	37400	17.0	12.3	10.0	3.3	YES	
◆◆						◆		10798	34000	37400	16.4	11.5	10.0	3.1	—	
◆◆							◆	10798	34000	37400	17.5	12.5	10.5	3.4	YES	
◆	◆◆							20396	34000	37400	17.1	12.0	10.4	3.3	YES	
◆	◆	◆						20396	34000	37400	17.5	12.5	10.4	3.4	YES	
◆	◆		◆					10798	34000	37400	16.7	11.8	9.8	3.2	—	
◆	◆			◆				10798	34000	37400	17.0	12.3	10.0	3.3	YES	
◆	◆					◆		10798	34000	37400	17.1	12.0	10.4	3.3	YES	
◆	◆						◆	10798	34000	37400	17.5	12.5	10.5	3.4	YES	
◆		◆◆						20396	34000	37400	17.5	12.5	10.5	3.4	YES	
◆		◆	◆					10798	34000	37400	17.0	12.3	10.0	3.3	YES	
◆		◆		◆				10798	34000	37400	17.0	12.3	10.0	3.3	YES	
◆		◆				◆		10798	34000	37400	17.5	12.5	10.5	3.4	YES	
◆		◆					◆	10798	34000	37400	17.5	12.5	10.5	3.4	YES	
◆			◆◆					10798	34000	37400	16.7	11.8	9.8	3.3	—	
◆			◆	◆				10798	34000	37400	17.0	12.3	10.0	3.3	YES	
◆				◆◆				10798	34000	37400	17.0	12.3	10.0	3.3	YES	
◆				◆	◆			10798	34000	37400	17.0	12.3	10.0	3.3	YES	
◆						◆◆		10798	34000	37400	17.1	12.0	10.4	3.3	YES	
◆						◆	◆	10798	34000	37400	17.5	12.5	10.5	3.4	YES	
◆							◆◆	10798	34000	37400	17.5	12.5	10.5	3.4	YES	
	◆◆◆							20396	34000	37400	17.5	12.5	10.5	3.4	YES	
	◆◆	◆						20396	34000	37400	17.5	12.5	10.5	3.4	YES	
	◆◆		◆					20396	34000	37400	17.0	12.3	10	3.3	YES	
	◆◆			◆				20396	34000	37400	17.0	12.3	10	3.3	YES	
	◆◆					◆		20396	34000	37400	17.5	12.5	10.5	3.4	YES	
	◆◆						◆	20396	34000	37400	17.5	12.5	10.5	3.4	YES	
	◆	◆◆						20396	34000	37400	17.5	12.5	10.5	3.4	YES	
	◆	◆	◆					20396	34000	37400	17.0	12.3	10.0	3.3	YES	
	◆	◆		◆				20396	34000	37400	17.0	12.3	10.0	3.3	YES	

3
Indoor Units

*Systems meet ENERGY STAR® published minimums.

SPECIFICATIONS

36K		Combination of Indoor Units (kBTU/h Class)														
3 Indoor Units	Wall Mounted			Ducted		Cassette		Capacity			Efficiency					
	9K	12K	18K	12K	18K	12K	18K	Min	Nominal	Max	SEER	EER	HSPF	COP	E-STAR*	
		◆	◆			◆		20396	34000	37400	17.5	12.5	10.5	3.4	YES	
		◆	◆				◆	20396	34000	37400	17.5	12.5	10.5	3.4	YES	
		◆		◆	◆			20396	34000	37400	17.0	12.3	10	3.3	YES	
		◆		◆		◆		20396	34000	37400	17.0	12.3	10	3.3	YES	
		◆				◆	◆	20396	34000	37400	17.5	12.5	10.5	3.4	YES	
		◆					◆◆	20396	34000	37400	17.5	12.5	10.5	3.4	YES	
			◆◆	◆				20396	34000	37400	17.0	12.3	10	3.3	YES	
			◆◆			◆		20396	34000	37400	17.5	12.5	10.5	3.4	YES	
			◆	◆		◆		20396	34000	37400	17.0	12.3	10	3.3	YES	
			◆	◆			◆	20396	34000	37400	17.0	12.3	10	3.3	YES	
			◆		◆	◆		20396	34000	37400	17.0	12.3	10	3.3	YES	
				◆◆◆				20396	34000	37400	16.5	12	9.5	3.2	YES	
				◆◆	◆			20396	34000	37400	16.5	12	9.5	3.2	YES	
				◆◆		◆		20396	34000	37400	17.0	12.3	10	3.3	YES	
				◆◆			◆	20396	34000	37400	17.0	12.3	10	3.3	YES	
				◆	◆◆			20396	34000	37400	16.5	12	9.5	3.2	YES	
				◆			◆◆	20396	34000	37400	17.0	12.3	10	3.3	YES	
					◆◆	◆		20396	34000	37400	17.0	12.3	10	3.3	YES	
					◆	◆◆		20396	34000	37400	17.0	12.3	10	3.3	YES	
						◆◆◆		20396	34000	37400	17.5	12.5	10.4	3.4	YES	
						◆◆	◆	20396	34000	37400	17.5	12.5	10.4	3.4	YES	
						◆	◆◆	20396	34000	37400	17.5	12.5	10.4	3.4	YES	
4 Indoor Units	◆◆◆◆							20396	34000	37400	17.5	12.5	10.4	3.4	YES	
	◆◆◆	◆						20396	34000	37400	17.5	12.5	10.4	3.4	YES	
	◆◆◆		◆					20396	34000	37400	17.5	12.5	10.4	3.4	YES	
	◆◆◆			◆				10798	34000	37400	17.0	12.3	10	3.3	YES	
	◆◆◆				◆			10798	34000	37400	17.0	12.3	10	3.3	YES	
	◆◆◆					◆		10798	34000	37400	17.5	12.5	10.4	3.4	YES	
	◆◆◆						◆	10798	34000	37400	17.5	12.5	10.4	3.4	YES	
	◆◆	◆◆							20396	34000	37400	17.5	12.5	10.4	3.4	YES
	◆◆			◆◆					10798	34000	37400	17.0	12.3	10	3.3	YES
	◆◆						◆◆		10798	34000	37400	17.5	12.5	10.4	3.4	YES
	◆◆	◆		◆					10798	34000	37400	17.0	12.3	10	3.3	YES
	◆◆	◆					◆		10798	34000	37400	17.5	12.5	10.4	3.4	YES
	◆	◆◆◆							20396	34000	37400	17.5	12.5	10.4	3.4	YES
	◆			◆◆◆					10798	34000	37400	17.0	12.3	10	3.3	YES
	◆						◆◆◆		10798	34000	37400	17.5	12.5	10.4	3.4	YES
		◆◆◆◆							20396	34000	37400	16.5	12.0	9.5	3.2	YES
		◆◆		◆◆					20396	34000	37400	17.0	12.3	10	3.3	YES
		◆◆					◆◆		20396	34000	37400	17.5	12.5	10.4	3.4	YES
				◆◆◆◆					20396	34000	37400	17.0	12.3	10	3.3	YES
				◆◆			◆◆		20396	34000	37400	17.0	12.3	10	3.3	YES
						◆◆◆◆		20396	34000	37400	17.5	12.5	10.4	3.4	YES	

*Systems meet ENERGY STAR® published minimums.

OPTIONAL ACCESSORIES

Refrigeration Line Sets

USED WITH	Length Ft.	Liquid	Suction	Kit#
9000 and 12000 Btu indoor units	15'	1/4"	3/8"	T32150
	35'	1/4"	3/8"	T32350
18000 BTU indoor units	15'	1/4"	1/2"	T42150
	35'	1/4"	1/2"	T42350
24000, 30000 and 36000 Btu indoor units	15'	3/8"	5/8"	T53150
	35'	3/8"	5/8"	T53350

Low Ambient Wind Baffle Kit

Wind baffle allows operation down to 0 degrees Fahrenheit (Available for Wall-Mounted Single Zone)

WIND BAFFLE	USED WITH
DLAWB1	9000 - 12000 Btu wall-mounted single zone models
DLAWB2	18000 - 36000 Btu wall-mounted single zone models



Thermostat

DWC1-Wired Wall Thermostat (Available for all models)



Ceiling Cassette Grilles

Required decorative grille for ceiling cassette models

DECORATIVE GRILLE	USED WITH
DCG1218	MC24Y3J- 24000 Btu model
DCG2436	MC36Y3J- 36000 Btu model



Friedrich's Ductless Split systems are compatible with aftermarket drain pumps and condensate sensors.

For more information visit the following sites:

Condensate Pumps

Rectorseal/Aspen Pumps: <http://airtec.rectorseal.com/pumpselector>.

Condensate Sensors

Rectorseal, Safe-T-Switch® SS610E: www.rectorseal.com

Aqua guard, AG-9300-U: www.rctus.com/product

Adapter

Adapter part number 67270018 is available through Friedrich parts distributors.

All R410A models have 1/2"-20 UNF (5/16" SAE) X 1/4" SAE thread per inch charging and vacuuming ports.

An adapter must be used for 1/4" gauges.

Packaged Terminal Air Conditioners



FRIEDRICH PTACs ARE
RELIABLE AND ENERGY
EFFICIENT FOR A LOWER COST
OF OWNERSHIP.

You have to consider the big picture when buying PTACs, and that means your TOTAL COST of ownership. Friedrich delivers value to your bottom line with great pricing, long-term reliability and high energy efficiency.

And Friedrich is backed by an industry-leading 2-year parts and labor warranty; 5-yr. limited warranty.

QUIET, YET POWERFUL AIR FLOW.

And outstanding efficiency.

Designed for quiet operation with maximum comfort and dependable performance.



Friedrich Engineered for quiet performance.

Improved air distribution for better comfort

Tangential blower wheel has nearly 5x the surface area of a typical fan used on other PTACS. The result is more uniform airflow over a wider path for faster, more even air distribution throughout the room and improved sound levels.

Air is blown over the entire length of the tangential wheel into the room in a uniform laminar airflow.

Ultra quiet, two motor design

With separate indoor and outdoor motors, the indoor motor can run at slower speeds which reduces sound levels indoors.

Friedrich has a one-tier model line up, so you'll find more premium features offered as standard on each and every Friedrich PTAC.



PTAC *Electric Heat*

COOLING
7700-15000 Btu
Up to 12.2 EER

ELECTRIC HEAT
6800-17000 Btu

PTAC *Heat Pump*

COOLING
7700-14500 Btu
Up to 12.2 EER

HEATING
6300-13300 Btu
Up to 3.4 COP



RELIABLE PERFORMANCE

It begins with durable materials and the highest quality components.

Modular design for easy access to key components

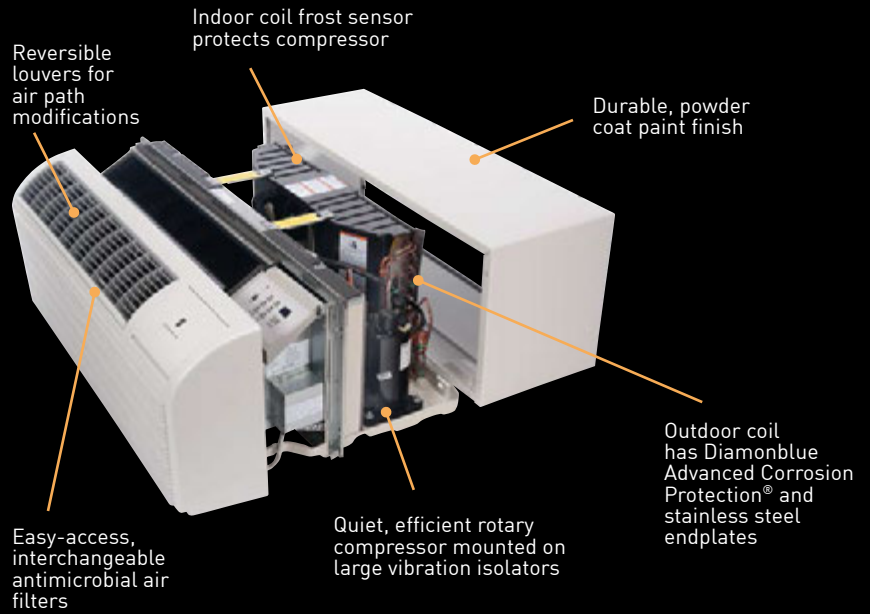

PDXWS WALL SLEEVE
DIMENSIONS:
16" H x 42" W x 13 3/4" D
FRONT COVER DIMENSIONS:
16" H x 42" W x 7 3/4" D
CUT OUT DIMENSIONS:
16 1/4" x 42 1/4"

Reliability backed by a 2-yr. parts and labor warranty, and 5-yr. limited warranty

2 YR.
WARRANTY
PARTS AND LABOR

5 YR.
LIMITED WARRANTY

See warranty documentation for full details.

RECEPTACLES AND FUSE TYPES						
Voltage	230V			265V		
	15	20	30	15	20	30
Heater Size	0, 2.0 kW	3.0 kW	5.0 kW	2.0 kW	3.0 kW	5.0 kW
Receptacles						
NEMA# Receptacle	6-15R	6-20R	6-30R	7-15R	7-20R	7-30R
NEMA# Plug	6-15P	6-20P	6-30P	7-15P	7-20P	7-30P



The tangential blower wheel has 5x the surface area of blowers used by other PTACs. It creates a wide path air flow that reaches the furthest corner of the guest room.

DIAMONBLUE
Advanced Corrosion Protection®



Protects the outdoor coil against deterioration and extends the life of the unit especially in harsh coastal environments.

IMPORTANT NOTE: Sleeves are sold and shipped separately to accommodate new construction and replacement requirements. Fits other PTAC sleeves without the added expense of a baffle kit.

MORE STANDARD FEATURES

Durable construction

- Steel base pan and sleeve that are powder-coat painted to resist rust and corrosion
- Outdoor coil end plates are stainless steel to resist rust and corrosion (other PTACs use lower grade steel)
- Every PTAC unit is run-tested at the factory to reduce problems in the field
- 14 numeric service error codes stored in memory facilitate rapid unit diagnostics
- Easy access, long-life filters simplify maintenance that extends the life of the product
- Room freeze protection- initiates heat if temperature falls to 40°F in an unoccupied room
- Random compressor restart protects electrical systems from overload when power is restored
- Tamper-resistant grille and durable front panel with break-proof control door design
- Indoor coil frost sensor protects the compressor to lengthen the life of the unit
- 2 year full warranty on parts and labor; 5 year limited warranty
- Backed by a nationwide service network, and U.S.-based Friedrich expert technical team

Energy efficient and energy smart PTACS

- Super efficient refrigeration design with EERs up to 12.2; COPs up to 3.4
- All units are available in energy efficient heat pump models
- Electronic defrost control ensures more run time in efficient heat pump mode
- Ability to adjust low/high temperature range limits for reduced energy usage
- Thicker steel inner-wall and foam construction decreases thermal transfer and energy loss
- Condensate removal system uses slinger ring technology to cool the coil and increase efficiency
- Desk control ready allowing hotel owners to control units from a central location

Comfort & Dehumidification

- Removes up to 3.2 pts./hr. of moisture in cool mode to improve comfort and reduce the chance of mold and mildew growth
- Intuitive unit controls are easy to operate and operate either set point or room temperature
- Owner-configurable 'Constant Fan' mode
- 'Instant Heat' heat pump mode quickly heats a room to the desired temperature for increased comfort
- 'Even-heat Monitoring' checks room temperature and automatically adds heat boost if necessary
- The digital control panel will automatically run the fan to briefly sample the room temperature every nine minutes to ensure desired conditions are maintained

Maintenance & Installation Features

- Universal heaters with heat capacities determined by the power cords; achieve up to 48 PTAC SKUs with 16 units by changing the power cord size
- Remote thermostat pop-out wiring module allows easier wiring and unit changeout without rewiring thermostat
- May be installed flush with the floor
- Reversible indoor air louvers
- Condensate disposal system
- Improved weather barrier
- Emergency heat override ensures heat mode operation even in the unlikely event of compressor failure
- Modular product design ensures easy access to key components for cleaning and repairs- including washable, lift-out air filters
- Depth of front is 7 3/4 inches which preserves indoor floor space

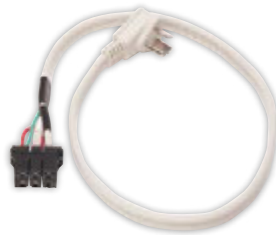

Energy management thermostats available (wired & wireless)

- Integrated occupancy sensor
- Auto changeover
- 5 distinct energy presets
- Unique energy savings features
- Comprehensive remote management capability*



Health & IAQ

- Fresh air damper to bring in fresh outside air when desired
- Two, easy-access washable, antimicrobial air filters
- Up to 3.2 pts./hr. dehumidification

Sound Reduction Technology

- Two permanently lubricated fan motors for added durability and reduced sound levels indoors
- Quiet, efficient rotary compressor mounted with vibration isolators to keep the compressor running smoothly and quietly
- High-density insulation blocks outdoor noise

Durability

- Faultless sure-hold front cover system securely attaches the front each time
- Random compressor restart protects electrical systems from overload when power is restored
- Quiet, efficient rotary compressor mounted with vibration isolators to keep the compressor running smoothly and quietly
- Steel base pan and sleeve
- Stainless steel outdoor end plates
- Room freeze protection

* Energy management capability requires purchase of additional hardware and service fee

OPTIONAL ACCESSORIES

WALL SLEEVE PDXWSA

Galvanized steel is prepared in a state-of-the-art, multistep process for stronger paint adhesion, then powder coated with a polyester finish and cured in an oven for exceptional durability. The wall sleeve is insulated for thermal efficiency and noise reduction.
16" H x 42" W x 13 3/4" D

SLEEVE EXTENSION RETROFIT KIT PXSE

2 1/4" sleeve extension attached to the room side of the sleeve to allow for the installation of a PD-series Friedrich PTAC in a 11 1/2" deep T-series sleeve.

DEEP WALL SLEEVES PDXWSEXT18

For walls up to 17 1/2" deep.

PDXWSEXT24

For walls up to 23 1/2" deep.

PDXWSEXT (Custom depth wall sleeve)

One-piece extended wall sleeve for walls from 13 1/4" to 25 1/2" deep are available by special order.

DIGITAL REMOTE THERMOSTAT RT6

Single stage cool, single stage heat for PDE models or single stage cool, dual stage heat for PDH model thermostat features high/low fan speed switch. Thermostat is hard wired and can be battery powered or unit powered. Features backlit display and multiple configuration modes.

WRT1

Wireless, single stage, wall-mounted digital thermostat with two fan speeds. Features backlit display and multiple configuration modes.

ENERGY MANAGEMENT THERMOSTATS

EMRT1

Wired thermostat with occupancy sensor.

EMWRT1

Wireless thermostat with occupancy sensor.

EMOCT

Online connection kit.

EMRAF

Remote access fee.

REMOTE THERMOSTAT ESCUTCHEON KIT PDXRTA

Kit contains escutcheons that can be placed over the factory control buttons when a remote wall mounted thermostat is used. The escutcheon directs the user to the wall thermostat for operation and retains the LED window to display error codes and diagnostic information. 10 pack.

CONDUIT KIT /JUNCTION BOX PXCJA

Hard wire conduit kit with junction box for 208/230V and 265V units (subbase not required). Kit includes a means of quick disconnect for easy removal of the chassis.



Deep wall sleeve extension PDXWSEXT18 shown with weather panel in place



RT6



WRT1



EMRT1, EMWRT1



OPTIONAL ACCESSORIES

STANDARD GRILLE

PXGA

Standard, stamped, anodized aluminum to resist chalking and oxidation.



ARCHITECTURAL GRILLES

Architectural grilles that consist of heavy gauge 6063-T5 aluminum alloy

PXAA Clear extruded aluminum.

PXBG Beige acrylic enamel.

PXSC Available in custom colors.



PXAA

DECORATIVE SUBBASE (black)

PXSBA

Provides unit support for walls less than six inches thick. Includes leveling legs, side filler panels and mounting brackets for electrical accessories. Accepts circuit breaker, power disconnect switch and conduit kit.



ELECTRICAL SUBBASE

Provides unit support for walls less than six inches thick. Includes leveling legs, side filler panels, mounting brackets, a plug-in receptacle and field-wiring access. The subbase also includes electrical knockouts for a power disconnect switch or circuit breaker.

PXSB23020	Electrical Subbase - 230V 15 & 20A
PXSB23030	Electrical Subbase - 230V 30A
PXSB26515	Electrical Subbase - 265V 15A
PXSB26520	Electrical Subbase - 265V 20A
PXSB26530	Electrical Subbase - 265V 30A

POWER CORDS

		Length
PXPC23000	LCDI 230V 15A Cord - 00 kW (for use PDE models only)	6 ft.
PXPC23015	LCDI 230V 15A Cord - 2.0 kW	6 ft.
PXPC23020	LCDI 230V 20A Cord - 3.0 kW	6 ft.
PXPC23030	LCDI 230V 30A Cord - 5.0 kW	6 ft.
PXPC26515	Non-LCDI 265V 15A Cord - 2.0 kW	18 inches
PXPC26520	Non-LCDI 265V 20A Cord - 3.0 kW	18 inches
PXPC26530	Non-LCDI 265V 30A Cord - 5.0 kW	18 inches



PXFTA

Antimicrobial air filters. 10 pack.



CONDENSATE DRAIN KIT

PXDR10

Attaches to the bottom of the wall sleeve for internal draining of condensate or to the rear wall sleeve flange for external draining. Recommended for all units to remove excess condensate. 10 pack.



LATERAL DUCT ADAPTER

PDXDAA

Attaches to the Friedrich PTAC/PTHP unit to direct up to 35% of the total airflow to a second room. The unit-mounted duct plenum features a front-mounted aluminum grille that has two positions to provide the most optimal air direction. The air may be directed to either the left or the right of the unit through the supplied 3.5 H" x 7 W" x 47" L plenum. Plenum may be cut to length by the installer. Kit includes duct plenum, front grille, 47" duct extension, duct discharge grille, duct end cap and all necessary mounting hardware.

LATERAL DUCT EXTENSION

PDXDEA

Additional 3.5 H" x 7" W x 47" L plenum for use with the LATERAL DUCT ADAPTER. A maximum of 3 duct extensions total may be used. Note: Ducted airflow is reduced as duct length is increased.



PDXDAA and PDXDEA ship together

SPECIFICATIONS

PDE Series

Model		PDE07K	PDE07R	PDE09K	PDE09R	PDE12K	PDE12R	PDE15K	PDE15R
PERFORMANCE DATA:									
Cooling Btu		7700/7600	7700	9000/8800	9000	12000/11800	12000	15000/14600	15000
Cooling Watts		640/620	640	800/770	800	1120/1120	1120	1530/1510	1530
Energy Efficiency Ratio	EER	12.0/12.2	12.0	11.3/11.4	11.3	10.7/10.5	10.7	9.8/9.7	9.8
Moisture Removal	Pts./Hr.	1.7	1.7	2.2	2.2	2.7	2.7	3.2	3.2
Sensible Heat Ratio		0.84	0.84	0.81	0.81	0.67	0.67	0.65	0.65
ELECTRICAL DATA:									
Voltage (1 PHASE, 60 Hz)		230/208	265	230/208	265	230/208	265	230/208	265
Current	Amps	2.8/3.0	2.4	3.7/3.9	3.7	5.1/5.3	4.8	6.7/7.5	5.9
Power Factor		0.97	0.99	0.99	0.99	0.99	0.99	0.99	0.99
Compressor LRA		19.0	12.0	17.0	18.0	27.0	23.0	32.6	27.8
Compressor RLA		2.8	2.4	3.7	2.9	5.0	4.3	6.6	5.6
Outdoor Fan Motor	HP	0.024	0.024	0.029	0.029	0.031	0.031	0.031	0.031
AIRFLOW DATA:									
Indoor CFM, HIGH		345/315	345	360/345	360	360/350	360	385/375	385
Indoor CFM, MED		320/290	320	330/305	330	330/310	330	360/330	360
Indoor CFM, LOW		295/265	295	300/270	300	310/280	310	320/290	320
Vent CFM		75	75	75	75	75	75	75	75
PHYSICAL DATA:									
Sleeve Dimensions H x W x D	In.	16"x42"x13 3/4"	16"x42"x13 3/4"	16"x42"x13 3/4"	16"x42"x13 3/4"	16"x42"x13 3/4"	16"x42"x13 3/4"	16"x42"x13 3/4"	16"x42"x13 3/4"
Dimensions with front H x W x D	In.	16"x42"x21 1/2"	16"x42"x21 1/2"	16"x42"x21 1/2"	16"x42"x21 1/2"	16"x42"x21 1/2"	16"x42"x21 1/2"	16"x42"x21 1/2"	16"x42"x21 1/2"
Cut Out Dimensions H x W	In.	16 1/4"x42 1/4"	16 1/4"x42 1/4"	16 1/4"x42 1/4"	16 1/4"x42 1/4"	16 1/4"x42 1/4"	16 1/4"x42 1/4"	16 1/4"x42 1/4"	16 1/4"x42 1/4"
Net Weight	Lbs.	106	106	111	111	116	116	119	119
Shipping Weight	Lbs.	126	126	131	131	136	136	139	139
R-410A Charge	Oz.	23.63	24.69	33.51	33.51	35.27	35.98	38.10	40.21
Dimensions with Packaging	In.	19.75"x23"x43.5" (all models)							

PDH Series

Model		PDH07K	PDH07R	PDH09K	PDH09R	PDH12K	PDH12R	PDH15K	PDH15R
PERFORMANCE DATA:									
Cooling	Btu	7700/7600	7700	9000/8800	9000	12000/11800	12000	14500/14200	14500
Cooling Watts		640/620	640	800/770	800	1120/1120	1120	1480/1460	1480
Energy Efficiency Ratio	EER	12.0/12.2	12	11.3/11.4	11.3	10.7/10.5	10.7	9.8/9.7	9.8
Reverse Heating	Btu	6300/6100	6300	8100/7900	8100	10700/10500	10700	13300/13000	13300
Heating Watts		540/530	540	720/770	720	1010/990	1010	1300/1270	1300
COP		3.4/3.4	3.4	3.3/3.3	3.3	3.1/3.1	3.1	3.0/3.0	3.0
Moisture Removal	Pts./Hr.	1.7	1.7	2.2	2.2	2.7	2.7	3.2	3.2
Sensible Heat Ratio		0.84	0.84	0.81	0.81	0.67	0.67	0.65	0.65
ELECTRICAL DATA:									
Voltage (1 PHASE, 60 Hz)		230/208	265	230/208	265	230/208	265	230/208	265
Current	Amps	2.8/3.0	2.4	3.7/3.9	3.7	5.1/5.3	4.8	6.7/7.5	5.7
Reverse Heat	Amps	2.4/2.5	2.1	3.4/3.8	3.4	4.5/4.7	4.5	5.8/6.2	5.0
Power Factor		0.97	0.99	0.99	0.99	0.99	0.99	0.98	0.98
Compressor LRA		19.0	12.0	18.5	19.0	27.0	23.0	36.0	26.0
Compressor RLA		2.8	2.4	3.6	3.2	5.0	4.3	6.5	5.3
Outdoor Fan Motor	HP	0.024	0.024	0.029	0.029	0.031	0.031	0.031	0.031
AIRFLOW DATA:									
Indoor CFM, HIGH		345/315	345	360/345	360	360/350	360	420/390	385
Indoor CFM, MED		320/290	320	330/305	330	330/310	330	410/380	360
Indoor CFM, LOW		295/265	295	300/270	300	310/280	310	380/350	320
Vent CFM		75	75	75	75	75	75	75	75
PHYSICAL DATA:									
Sleeve Dimensions H x W x D	In.	16"x42"x13 3/4"	16"x42"x13 3/4"	16"x42"x13 3/4"	16"x42"x13 3/4"	16"x42"x13 3/4"	16"x42"x13 3/4"	16"x42"x13 3/4"	16"x42"x13 3/4"
Dimensions with front H x W x D	In.	16"x42"x21 1/2"	16"x42"x21 1/2"	16"x42"x21 1/2"	16"x42"x21 1/2"	16"x42"x21 1/2"	16"x42"x21 1/2"	16"x42"x21 1/2"	16"x42"x21 1/2"
Cut Out Dimensions H x W	In.	16 1/4"x42 1/4"	16 1/4"x42 1/4"	16 1/4"x42 1/4"	16 1/4"x42 1/4"	16 1/4"x42 1/4"	16 1/4"x42 1/4"	16 1/4"x42 1/4"	16 1/4"x42 1/4"
Net Weight	Lbs.	108	108	113	113	118	118	121	121
Shipping Weight	Lbs.	128	128	133	133	138	138	141	141
R-410A Charge	Oz.	23.63	24.69	33.51	35.27	35.27	35.98	39.86	36.33
Dimensions with Packaging	In.	19.75"x23"x43.5" (all models)							

Operating range 0°-115°F.

Due to continuing research in new energy-saving technology, specifications are subject to change without notice.

Five-year warranty limited to installations in the United States, Puerto Rico, Mexico and Canada only.

See warranty documentation for full details.



Single Package Vertical Air Conditioners



TOTALLY CONCEALED INSTALLATION

Friedrich Vert-I-Pak® air conditioners provide a more homelike appearance and a unique 'floating chassis' design for quiet operation.





BETTER AESTHETICS OUTDOORS

Packaged unit eliminates the clutter of outdoor condensing units and the sleek architectural grille is available in custom colors to match the building's exterior.



A quiet and energy efficient option for extended stay properties, suites, assisted living, student housing, and commercial spaces.

Vert-I-Pak® is a superior product

What you'll find on Friedrich Vert-I-Pak®	What you'll find on many competitor's products
<ol style="list-style-type: none">1. Chassis installs into a wall plenum and is held firmly in place by a sealing gasket, reducing noise from vibration transfer.2. ½ inch foil-backed insulation added on the inside of the chassis to reduce sound transmission into the guest room.3. Extra thick, vibration-absorbing rubber grommets mounted on durable base that is engineered for structural and acoustic integrity.4. Dynamically balanced blower with large, vibration-absorbing motor mounts for smooth and quiet operation.5. Patented telescoping plenums (accessory) easily adapt to more installations.6. 5 year limited warranty includes labor.	<ol style="list-style-type: none">1. Chassis is screwed into the wall plenum. Metal-on-metal contact transfers vibration, increasing operating noise under typical conditions. Noise is transferred through the walls and into the room.2. No insulation on the unit to reduce noise transmission into the guest room.3. Hard plastic feet on the unit base which are less durable and transfer harsh vibration noise.4. Different plenums needed based on varying wall depths.5. No labor warranty.

FRIEDRICH ENGINEERED FOR QUIETER PERFORMANCE

With the aesthetics of a central air system and the simplicity of a PTAC.

Friedrich's unique 'Free Floating' chassis design

The chassis slides into the wall plenum and a gasket firmly seals the chassis to the patented telescoping plenum. This eliminates vibration noises that are transmitted into the room in competitor's metal-on-metal fixed installations.

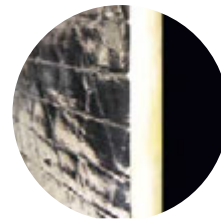

Foil-backed insulation blanket inside the cabinet reduces sound transmitted into the guest room

Reliable and durable

- PSC permanently lubricated motor for low maintenance and maximum efficiency
- Engineered drain pan won't rust, eliminating the risk of unsightly rust stains from condensation on the building exterior
- Standard safety power disconnect
- Electronic control panel on unit for easy diagnostics and servicing
- 100% run tested prior to shipment- Every unit is tested in every operating mode before it ships for optimal performance and reliability

DIAMONBLUE
Advanced Corrosion Protection.



Protects the outdoor coil against deterioration and extends the life of the unit especially in harsh coastal environments.

Easy installation

- Can be installed from any interior side (front, right or left)
- Compact and lightweight, weighs as little as 125 lbs.
- Easy installation; does not require an HVAC technician
- Ductable to multiple rooms
- All units are ready to install with only electrical hook up needed to be up and running
- Central desk control ready
- 24-volt remote wireless or wired thermostat ready
- 10" crimped and beaded duct-collar ready to attach flex duct
- Prewired, charged and piped
- Patented telescoping wall plenums adjust to fit varying exterior wall thicknesses
- All units are shipped (on pallet) with return air filter
- Rear or side wall sleeves
- Condensate removal system uses slinger ring technology to cool the coil and increase efficiency

- Primary condensate removal system provided thru 3/4" pipe fittings for more placement options
- Secondary overflow from primary drain*

Energy management thermostats available (wired & wireless)

- Integrated occupancy sensor
- Auto changeover
- 5 distinct energy presets
- Unique energy savings features
- Comprehensive remote management capability**



* 24000 Btu model uses secondary gravity-fed drain

** Energy management capability requires purchase of additional hardware and service fee

A better heating and cooling option inside and out

- Eliminates the clutter of outdoor condensing units and the need for vandalism barriers.
- Completely self-contained
- No refrigerant lines running from floor to floor
- Fast, easy replacement keeps spaces livable

Improved guest comfort

- Individually controlled
- Heat and cool
- Duct air specifically where it's needed, not just on the outside wall
- 2-speed fan with constant fan option

A better choice than whole building solutions

ADVANTAGES INCLUDE:

- Lower installed cost
- Independent metering (no need to prorate for multitenant applications)
- Individual temperature set point (one unit can heat and others can cool)
- Less risk, with a whole building system spaces may become uninhabitable until the system is repaired or replaced
- Vert-I-Paks can be easily accessed for maintenance or replacement



Installs in a small mechanical closet and can be ducted to multiple rooms.

Vert-I-Pak®

COOLING
9400-17000 Btu

Up to 10.5 EER

ELECTRIC HEAT
AND HEAT PUMPS

3.0 COP

HEAT PUMPS

Vert-I-Pak®

COOLING
23000 Btu

9.5 EER

ELECTRIC HEAT
AND HEAT PUMP

3.0 COP

HEAT PUMP

Typical Vert-I-Pak® installation

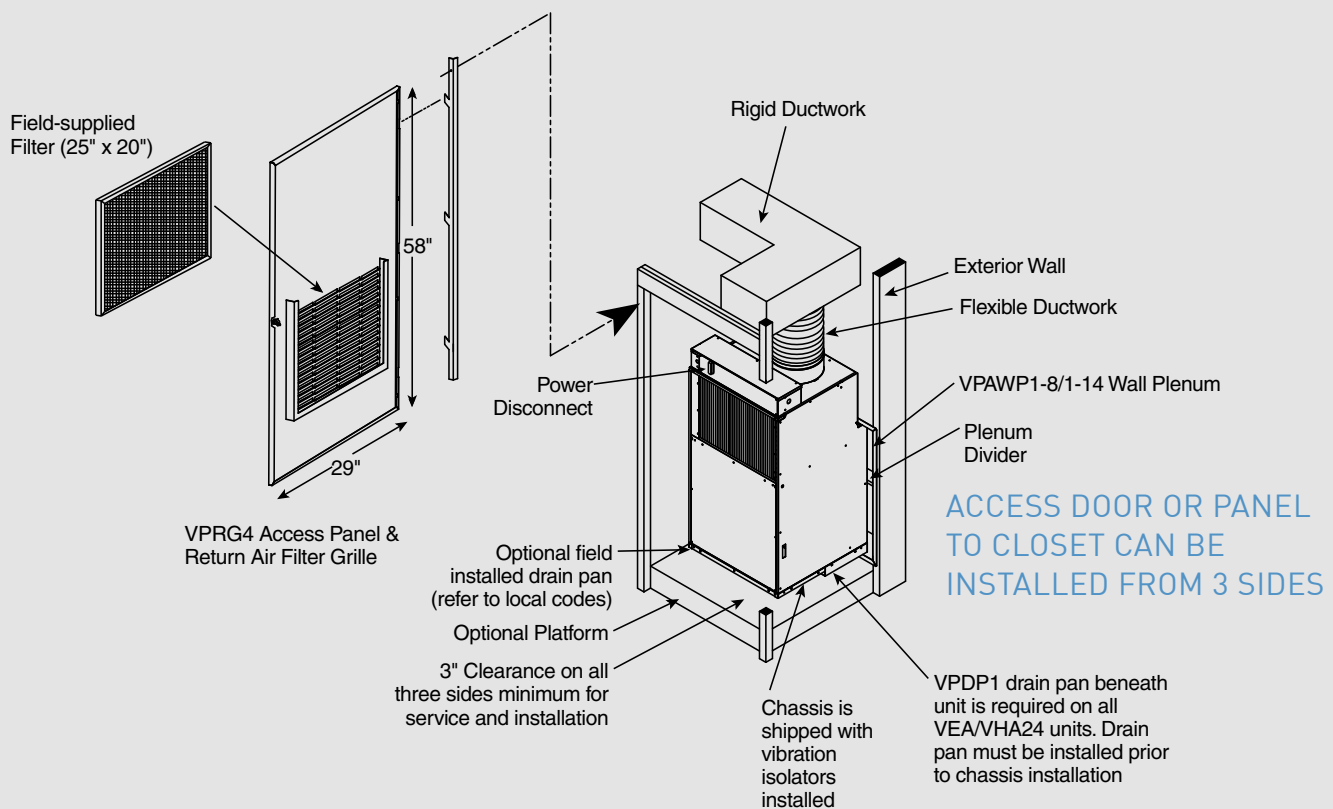

OPTIONAL ACCESSORIES

ARCHITECTURAL LOUVER

VPAL2 and VPSC2

Extruded aluminum grille that attaches to the outdoor section of the wall plenum. Takes in fresh air and returns condensed air. VPSC2 can be ordered in custom colors.

DIMENSIONS: 25 9/16" W x 31 1/16" H

WALL PLENUM

VPAWP1-8, VPAWP1-14

Two-part sleeve that telescopes in and out. Sits inside the exterior wall penetration.

VPAWP1-8 telescopes from 5 1/2"-8"

VPAWP1-14 telescopes from 8"-14"

DIMENSIONS: 24 1/8" W x 30 3/8" H

CUTOUT DIMENSIONS: 24 5/8" W x 30 7/8" H

RETURN AIR GRILLE/ ACCESS PANEL

VPRG4

Hinged panel allows access to unit and return air filter. A field-supplied filter (25" x 20") should be mounted on the inside grille. Panel can be mounted with return air openings high or low on the door for optimum sound attenuation.

DIMENSIONS: 29" W x 58" H

CUTOUT DIMENSIONS: 27" W x 55 3/4" H

FIRST COMPANY SLEEVE ADAPTER

VPASA1

Single piece, welded adapter allows retrofit into existing First Company SPXR-series single package vertical unit wall sleeve and louver. Easy connection to Friedrich chassis.

SINGLE STAGE THERMOSTATS

RT6

Single stage, wall-mounted digital thermostat with two fan speeds and backlight for control of Friedrich VERT-I-PAK.

WRT1

Wireless, single stage, wall-mounted digital thermostat with two fan speeds and backlight for control of Friedrich VERT-I-PAK.

ENERGY MANAGEMENT THERMOSTATS

EMRT1

Wired thermostat with occupancy sensor.

EMWRT1

Wireless thermostat with occupancy sensor.

EMOCT

Online connection kit.

EMRAF

Remote access fee.

DRAIN PAN

VPDP1

For VEA/VHA24 models. May be installed prior to chassis for easy installation/removal.



RT6

WRT1



EMRT1, EMWRT1

FriedrichLink



SPECIFICATIONS

Model	VEA09K	VEA12K	VEA18K	VEA24K	VHA09K	VHA09R	VHA12K	VHA12R	VHA18K	VHA24K										
COOLING DATA																				
COOLING Btu	9000/8600	11500/11200	17000/16500	23000/22700	9000/8600	8900	11500/11200	12000	17000/16800	23000/22800										
POWER (W)	857/819	1174/1143	1889/1833	2421/2389	857/819	908	1186/1155	1224	1868/1846	2527/2505										
EER	10.5/10.5	9.8/9.8	9.0/9.0	9.5/9.5	10.5/10.5	9.8	9.7/9.7	9.8	9.1/9.1	9.1/9.1										
SENSIBLE HEAT RATIO	0.74	0.74	0.70	0.70	0.74	0.74	0.74	0.72	0.70	0.70										
HEATER SIZE	2.5/3.4/5.0	2.5/3.4/5.0	2.5/3.4/5.0	2.5/3.4/5.0/7.5/10.0	2.5/3.4/5.0	2.5/3.4/5.0	2.5/3.4/5.0	2.5/3.4/5.0	2.5/3.4/5.0	2.5/3.4/5.0/7.5/10.0										
HEAT PUMP DATA																				
HEATING Btu	—	—	—	—	8200/8000	8700	10800/10600	11500	16000/15000	20000/20000										
COP @ 47F	—	—	—	—	3.0/3.0	3.0	3.0/3.0	3.0	3.0/3.0	3.0/3.0										
HEATING POWER (W)	—	—	—	—	801/782	850	1055/1035	1123	1560/1540	1953/1953										
HEATING CURRENT (A)	—	—	—	—	3.6/3.9	3.4	4.5/4.7	4.4	7.5/8.2	8.5/9.4										
ELECTRICAL DATA																				
VOLTAGE (1 PHASE, 60 Hz)	230/208	230/208	230/208	230/208	230/208	265	230/208	265	230/208	230/208										
VOLT RANGE	253-197	253-197	253-197	253-197	253-197	253-198	253-197	253-198	253-197	253-197										
COOLING CURRENT (A)	4.0/4.3	5.2/5.4	8.1/8.6	10.0/10.4	4.0/4.3	3.6	5.3/5.5	5.0	8.2/8.6	10.6/10.9										
AMPS L.R	21.0	29.5	42.0	46	21.0	16.5	29.5	23.5	42.0	46.0										
AMPS F.L.	3.5	4.5	7.8	9.5	3.5	3.1	5.0	4.3	7.8	9.5										
INDOOR MOTOR (HP)	1/4	1/4	1/4	1/4	1/4	1/4	1/4	1/4	1/4	1/4										
INDOOR MOTOR (A)	1.2	1.2	1.2	1.94	1.2	1.08	1.2	1.08	1.2	1.94										
OUTDOOR MOTOR (HP)	—	—	—	1/4	—	—	—	—	—	1/4										
OUTDOOR MOTOR (A)	—	—	—	0.85	—	—	—	—	—	0.85										
PHYSICAL																				
DIMENSIONS (W x D x H)	23"x23"x32"	23"x23"x32"	23"x23"x32"	23"x23"x47"	23"x23"x32"	23x23x32	23"x23"x32"	23x23x32	23"x23"x32"	23"x23"x47"										
NET WEIGHT (LBS)	114	124	144	167	114	114	125	124	144	167										
SHIPPING WEIGHT (LBS)	125	135	155	220	125	125	135	135	155	220										
TEST SETTING	Low	Low	High	Low	Low	Low	Low	Low	High	Low										
R410A CHARGE (OZ)	41.5	32	48.1	65	38	39	39	37	48	65										
AIRFLOW DATA																				
INDOOR CFM*	Low	High	Low	High	Low	High	Low	High	Low	High	Low	High	Low	High	Low	High	Low	High	Low	High
.10" ESP.10" ESP	405	450	420	450	400	480	610	700	420	450	420	450	420	450	420	450	400	480	610	700
.15" ESP.10" ESP	375	420	405	425	375	465	585	670	405	425	405	425	405	425	405	425	375	465	585	670
.20" ESP.10" ESP	345	385	385	400	350	450	560	640	385	400	385	400	385	400	385	400	350	450	560	640
.25" ESP.10" ESP	325	365	355	375	330	390	535	610	355	375	355	375	355	375	355	375	330	390	535	610
.30" ESP.10" ESP	305	340	320	350	310	330	510	580	320	350	320	350	320	350	320	350	310	330	510	580
VENT CFM	60	60	60	60	60	60	60	60	60	60	60	60	60	60	60	60	60	60	60	60

NOTES:

Cooling Standards: 95°F DB/75°F WB outdoor, 80°F DB/67°F WB indoor

Heating Standards: 47°F DB/43°F WB outdoor, 70°F DB/60°F WB indoor

Normal Value Wet Coil @ .1" ESP.

Rated CFM at Low Speed: VEA09/VHA09....325 VHA12/VEA12....390 VEA18/VHA18....400 VEA24/

VHA24....610

Due to continuing research in new energy-saving technology, specifications are subject to change without notice.





FRIEDRICH

1 8 8 3