

This Owner's Manual is provided and hosted by [Appliance Factory Parts](http://www.appliancefactoryparts.com).

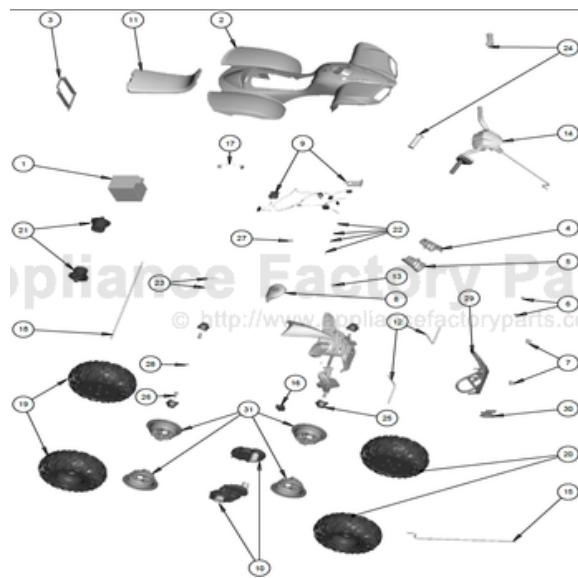

FISHER PRICE X3416 Owner's Manual

[Shop genuine replacement parts for FISHER PRICE
X3416](#)



[Find Your FISHER PRICE Ride On Parts - Select From 999 Models](#)

----- Manual continues below -----

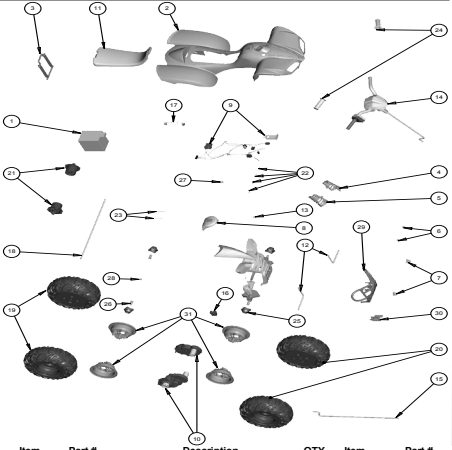

X3416 Kawasaki KFX PW Advanced	
Age Range:	3 years and up
Weight Limit:	130 lbs
Surfaces:	Ultimate Terrain
Speed:	2.5 Mph Forward/Reverse 5.0 Mph Forward
Colors:	Black with Red seat
Intro:	2011
Suggested Retail:	\$238.15
Box Dimensions:	19.63"x25.13"x40.75"
Warranty:	One Year Vehicle Six Months Battery



Item	Part #	Description	QTY	Item	Part #	Description	QTY
1	00801-1869	12 Volt Battery (1)	1	29	W4715-6259	Brush Guard for KFX	1
2	N/A	Body	1	30	J8472-2859	Steering Column Plate	1
3	B9272-2419	Battery Retainer for Kawasaki KFX	1	31	W4715-6459	Wheel Cover	4
4	W5540-2419	Left Spring Cover	1				
5	W5540-2429	Right Spring Cover	1				
6	J8472-2639	Upper Bushing Kawasaki KFX	2				
7	J8472-2649	Lower Bushing Kawasaki KFX	2				
8	00801-1773	Control Switch FR - w/white buttons	1				
9	P5066-9799	Harness Assembly for Barbie KFX	1				
10	00968-2921	# 7R Motor Gearbox Assembly	2				
11	W5540-9169	Seat for KFX	1				
12	P5066-4519	Front Axle (threaded) for Barbie KFX	2				
13	00801-1939	Cap Nut .437 - Black	2				
14	W5540-9729	Handlebar Assembly for KFX	1				
15	P5066-4439	Steering Column	1				
16	P2723-3549	Turbo Switch for Kawasaki KFX	1				
17	P5066-9659	Turbo Wiring Harness for KFX	1				
18	P5066-4509	Rear Axle (threaded) for Barbie KFX	1				
19	B9272-2269	Rear Wheel for Kawasaki KFX (black)	2				
20	B9272-2339	Front Wheel for Kawasaki KFX (black)	2				
21	74460-2249	Wheel Driver 10 RIB	2				
22	N/A	***See Hardware bag					
23	N/A	***See Hardware bag					
24	W5540-2439	Hand Grip for KFX	2				
25	W4715-6959	Hubcap	4				
26	73610-2689	Bushing .437 Long Black	2				
27	00801-1621	Cap (retainer .437) - Black	1				
28	00905-0116	3/8" -16 Lock Nut	4				

Bold and underlined parts are to be purchased and installed by Service Centers only. These items may not be sold directly to consumers by Service Centers or Fisher-Price.