

This Owner's Manual is provided and hosted by [Appliance Factory Parts](#).

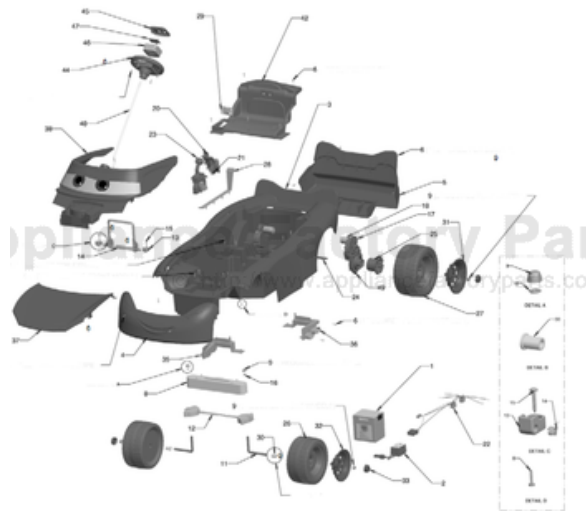

# FISHER PRICE W5542 Owner's Manual

[Shop genuine replacement parts for FISHER PRICE  
W5542](#)



[Find Your FISHER PRICE Ride On Parts - Select From 999 Models](#)

----- Manual continues below -----

**W5542**

**LIGHTING MCQUEEN Super 6  
6 VOLT ADVANCED SERIES**

Age Range:	3-7 Years
Weight Limit:	65 lbs.
Surfaces:	Hard and Grass
Speed:	3.5 MPH Forward/Reverse
Colors:	Red Body, Black Wheels
Intr:	2011
Suggested Retail:	\$249.99
Box Dimensions:	26x17x51
Warranty:	One Year Vehicle Six Months Battery

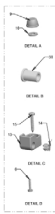
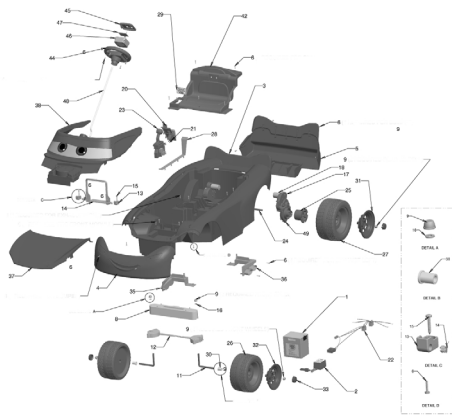

Item	Part Number	Description	QTY	Item	Part Number	Description	QTY
1	00801-0712	56V BATTERY	1	42	N/A	SEAT	1
2	00801-1779	56V CHARGER FUSED	1	44	3800-1003	STEERING WHEEL	1
3	N/A	BODY	1	45	H8256-2379	STEERING WHEEL COVER	1
4	3800-8089	FRONT BUMPER	1	46	W2604-9759	SOUNDBOX ASSEMBLY	1
5	N/A	REAR BUMPER	1	47	N/A	ASSY. BATTERY DOOR	1
6	0912-8001	# 8 X 3/4 PH PLAS SCREW	28	48	H8256-4239	STEERING COLUMN	1
8	N/A	MODULE, FRONT	1	<b>49</b>	<b>00968-2924</b>	<b>GEARBOX ASSEMBLY</b>	<b>2</b>
9	0801-0226	.437 RETAINER - PALNUT	6	50	3900-1002	REAR SPOILER	1
11	H8256-4509	FRONT AXLE	2	<b>PARTS NOT SHOWN</b>			
12	H8256-9419	ASSY STEERING LINKAGE	1	<u>Part Number</u>	<u>Description</u>	<u>QTY</u>	
13	N/A	RETAINER PIVOT	2	W2604-0301	MAIN DECAL	1	
14	3800-7809	BATTERY RETAINER	1	W2604-0920A	OWNERS MANUAL	1	
15	N/A	#12 X 1.25 SCREW	2	W2604-9259	PARTS BAG	1	
16	00801-1337	1/4" FLAT WASHER	2	W2604-9289	HARDWARE BAG	1	
<b>17</b>	<b>00968-2821</b>	<b>GEARBOX ASSY</b>	<b>2</b>	78640-2629	CAP NUT TOOL	1	
<b>18</b>	<b>00968-2710</b>	<b>MOTOR PINION ASSY</b>	<b>2</b>	0801-0196	7/16 WASHER	2	
20	H8256-9389	ASSEMBLY FOOTBOARD	1	00905-01145	3/8" - 16 HEX NUT	2	
<b>21</b>	<b>00801-2039</b>	<b>FTSWITCH-PLUNGER TYPE</b>	<b>1</b>	00801-1421	.354 RETAINER-PALNUT	3	
<b>22</b>	<b>N9733-9799</b>	<b>MAIN WIRING HARNESS</b>	<b>1</b>	<b>00801-1775</b>	<b>SWITCH CONTROL-SHIFTER</b>	<b>1</b>	
23	N9733-9239	SHIFTER	1				
24	H8256-4519	REAR AXLE	1				
25	74460-2249	DRIVER	2				
26	H8256-2459	FRONT WHEEL	2				
27	H8256-2469	REAR WHEEL	2				
28	N/A	WIRE COVER	1				
29	*On Seat	PW EMBLEM	1				
30	73610-2689	BUSHING .437 LONG	1				
31	W2604-2289	REAR WHEEL COVER	2				
32	W2604-2579	FRONT WHEEL COVER	2				
33	H8256-2589	HUBCAP CENTER	4				
35	H8256-2169	EXHAUST PIPE, RIGHT	1				
36	H8256-2069	EXHAUST PIPE, LEFT	1				
37	3900-1039	HOOD W/LABEL	1				
38	W2604-9409	CAB	1				

Revised 10/30/2013 14:40

**Bold and Underlined parts are to be purchased and installed by Service Centers only. These may not be sold directly to consumers by Service Centers or Fisher-Price.**