

This Owner's Manual is provided and hosted by [Appliance Factory Parts](#).

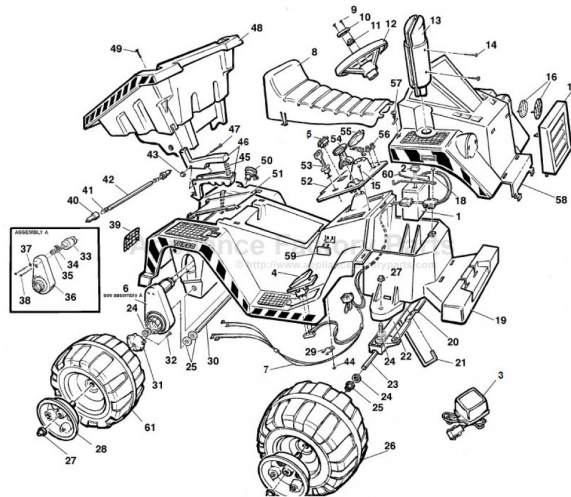

# FISHER PRICE 78656-9993 Owner's Manual

[Shop genuine replacement parts for FISHER PRICE  
78656-9993](#)



[Find Your FISHER PRICE Ride On Parts - Select From 999 Models](#)

----- Manual continues below -----

Age Range: 2-6 Yrs.  
 Weight Limit: 65 Lbs.  
 Surfaces: Hard & Grass  
 Speed: 3.5 MPH Forward  
 2.5 PH Reverse  
 Colors: Yellow Body  
 Black Trim  
 Intro: 3-14-97  
 Suggested Retail: \$149.99  
 Box Dimensions: 44" x 21" x 26.5"  
 In-Box Weight: 46.5 Lbs.  
 Warranty: 90 Days Vehicle  
 6 Months Battery

# 78656-9993 Caterpillar Dump Truck

Preschool Series  
Super 6 Volt

This product is affected by the PW recall announced Oct 1998. Please confirm that the product is modified or remediated in accordance with policy.

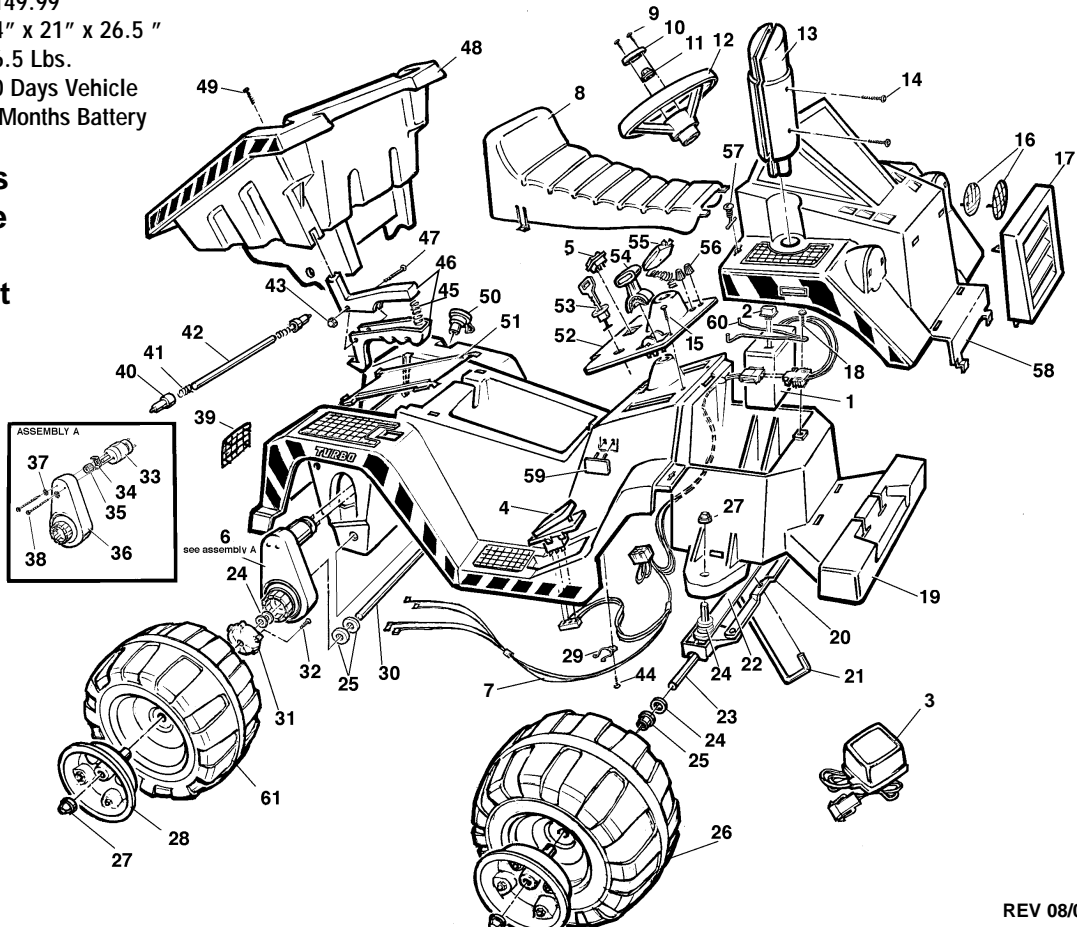

REV 08/04/04

Item No.	Description	Part No.	Qty.	Item No.	Description	Part No.	Qty.	Item No.	Description	Part No.	Qty.
1	Battery, 6 Volt	00801-0712	1	29	Harness Retainer	74550-2299	1		(when depleted, use new 78570-2439)		
2	Thermal Fuse	0801-0610	1	30	Rear Axle N/A	74550-4509	1	58	Front Clip N/A	78656-2319	1
3	Charger, S6 Volt	00801-0974	1	31	Driver N/A	74550-2239	2	59	Power Wheels Emblem Set	74540-9069	1
4	Footboard Assembly	74550-9159	1	32	#10 x 1/2" Screw	0801-0255	2	60	Battery Retainer	74550-4129	1
5	Control Switch	00801-0885	1	<b>33</b>	<b>Motor w/Pinion</b>	<b>74550-9539</b>	2	61	Rear Wheel	74550-2469	2
6	<b>Motor/Gearbox Assembly</b>	<b>74550-9509</b>	2	<b>34</b>	<b>(Comes w/#33)</b>			<b>PARTS NOT SHOWN</b>			
7	<b>Wiring Harness Assembly</b>			<b>35</b>	<b>(Comes w/#33)</b>				Main Label Sheet	78656-0310	1
	<b>(Include: #5)</b>	<b>74550-9809</b>	1	<b>36</b>	<b>Gearbox</b>	<b>74550-9279</b>	2		Small Label Sheet (Bezels)	78656-0320	1
8	Seat	74550-2309	1	<b>37</b>	<b>Star Washer N/A</b>	<b>0801-0330</b>	4		(located in Lit Bag)		
9	#8 x 1" Screw	0801-0224	2	<b>38</b>	<b>Motor Bolt</b>	<b>0801-0269</b>	4		Literature Bag N/A	78656-9019	1
10	Steering Wheel Button	74550-2729	1	39	Taillight Guard Set N/A	74550-2219	1		Owner's Manual N/A	78656-0920	1
11	.354 Cap Nut	0801-0215	1	40	Hinge Pin Endcap	74550-2189	2		Large Parts Bag N/A	78656-9249	1
12	Steering Wheel	74440-2379	1	41	Hinge Spring	74550-4419	2		Small Parts Bag N/A	78656-9259A	1
13	Exhaust Stack N/A	74550-2559	1	42	Dump Pivot Pin	74550-4139	1		Hardware Bag	78656-9259B	1
14	#6 x 1-1/2" Screw	0801-0221	2	43	Acorn Nut N/A	0801-0218	1				
15	#8 x 3/4" Screw	0801-0223	4	44	#8 x 1/2" Screw	0801-0202	1				
16	Headlight Guard N/A	78656-2339	2	45	Latch Spring	74550-4429	1				
17	Grill	74550-2829	1	46	Dump Bed Handle N/A	78656-205A	1				
18	Truss Hd #8 x 7/8" Screw	0801-0228	2	47	#10 x 1-1/4" Shoulder Bolt	0801-0304	1				
19	Main Body N/A	74550-2109	1	48	Dump Bed N/A	74550-2389	1				
20	Steering Linkage N/A	78610-4229	1	49	#10 x 1" Screw	0801-0220	1				
21	Steering Column	74550-4239	1	50	Gas Cap N/A	74550-2249	1				
22	Cross Bar N/A	78610-4579	1	51	Motor Cover N/A	74550-2489	1				
23	Front Axle N/A	74550-4519	2	52	Dash	74550-2699	1				
24	7/16" Washer	0801-0196	8	53	Key/Housing Assembly	74550-2439	1				
25	7/16" Round Bushing	74550-2689	6	54	Shift Lever	74550-2229	1				
26	Front Wheel N/A	74550-2459	2	55	Microphone	74550-9479	1				
27	.437 Cap Nut	0801-0226	6	56	Radio Knobs	74550-2719	2				
28	Hubcap N/A	74550-2579	4	57	Lock Fastener	78570-2239	2				

**Bold and Underlined parts are to be purchased and installed by Service Centers only. These items may not be sold directly to consumers by Service Centers or Fisher-Price.**

