

This Owner's Manual is provided and hosted by [Appliance Factory Parts](#).

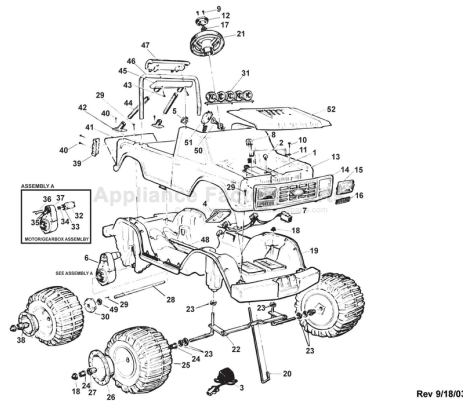

FISHER PRICE 76174-85150 Owner's Manual

[Shop genuine replacement parts for FISHER PRICE
76174-85150](#)



[Find Your FISHER PRICE Ride On Parts - Select From 999 Models](#)

----- Manual continues below -----

This product is affected by the PW recall announced Oct 1998. Please confirm that the product is modified or remediated in accordance with policy.

76174-9993 / 85150

Monster 4X4™

Age Range: 3-6 Yrs.
 Weight Limit: 65 Lbs.
 Surfaces: Hard, Grass & Carpet
 Intro: 1991
 Warranty: 90 Days Vehicle
 6 Months Battery

TRU Exclusive

Service Bulletin 138

Intermediate Series
 Type H 6 Volt

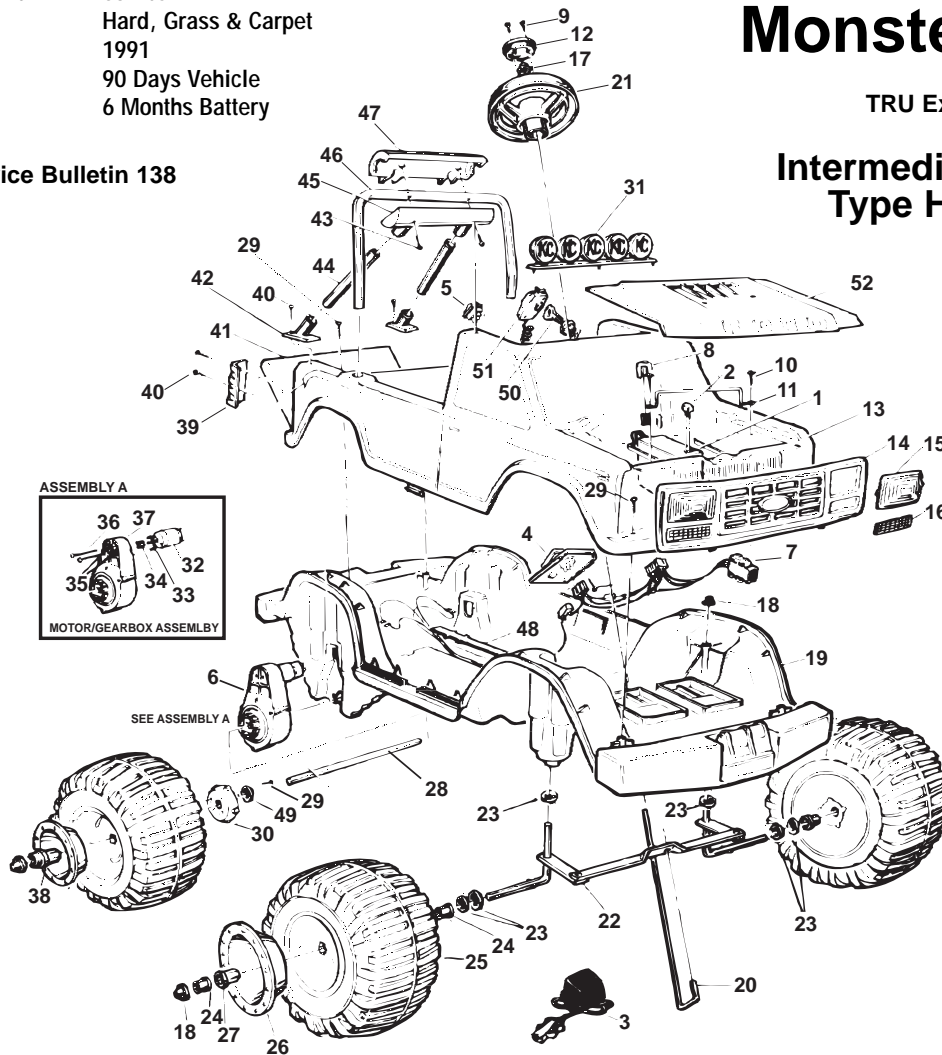

Rev 9/18/03

Item No.	Description	Part No.	Qty.	Item No.	Description	Part No.	Qty.	Item No.	Description	Part No.	Qty.
1	** Battery	00801-0712	1	23	7/16" Washer	0801-0196	4	44	Roll-Bar Support N/A	78670-4239	2
3	** Charger, Super 6 TM	00801-0974	1	24	Round Bushing	74550-2689	2	45	Roll-Bar Covr (Lower) N/A	78670-2189	1
4	Footboard Assembly	76817-9159	1	25	Wheel N/A	76188-2459	4	46	Roll-Bar N/A	78670-4219	1
5	** Switch (Fwd./Rev.)	80014-0073	1	26	Hubcap	74590-2579	4	47	Roll-Bar Covr (Upper) N/A	78670-2179	1
6	Motor/Gearbox Assy.	76804-9519	2	27	Hex Bushing	73233-2559	4	48	Wiring Harness Cover N/A	78471-2459	1
7	** Wiring Harn/Footbd Assy. N/A	80064-0110	1	28	Rear Axle N/A	80046-0013	1	49	Wheel Spacer N/A	80052-0003	2
8	Battery U-Clip N/A	74570-2669	1	29	#10 x 1/2" Phillips Screw	0801-0255	2	50	Key/Housing Assembly	73233-2439	1
9	#8 x 7/8" Phil Plascrew N/A	80006-0008	2	30	Wheel Driver	73233-2239	2	51	Microphone (Black)	73233-9479	1
10	#8 x 7/8" Trusshead Screw	0801-0228	6	31	KC Light Group N/A	78640-9239	1	52	Hood N/A	80031-0008	1
11	Battery Retainer N/A	76181-4419	1	32	Motor w/ Pinion	74580-9539	2	PARTS NOT SHOWN			
12	Steering Wheel Cap	74550-2729	1	33	D Lock Washer	0801-0329	2		Switch Hole Cover N/A	80001-0092	1
13	Body (Upper) N/A	80005-0038	1	34	Motor Drive Gear	74550-2269	2		Twist Lock Clip N/A	78670-0100	1
14	Grill N/A	80065-0007	1	35	Star Washer N/A	0801-0330	4		Screw For Hood N/A	0801-0219	1
15	Headlight Lens N/A	80030-0007	2	36	Motor Bolts	0801-0269	4		Literature Bag N/A	80044-0148	1
16	Parking Lens N/A	78640-2759	2	37	3A Gearbox w/Insert	74580-9269	2		Decal Sheet N/A	80017-0031	1
17	.354 Cap Nut (Black)	0801-0604	1	38	Hex Bushing w/Ext. N/A	80009-0001	2		Antenna N/A	80002-0002	1
18	.437 Cap Nut (Black)	0801-0225	6	39	Taillight N/A	78640-2279	2		Use & Care N/A	76174-CCCC	1
19	Body (Lower) N/A	80005-0026	1	40	#8 x 1/2" Plascrew	0801-0202	6				
20	Steering Column N/A	78471-4239	1	41	Tailgate	80057-0003	1				
21	Steering Wheel	74440-2379	1	42	Roll-Bar Bracket Set N/A	78670-2199	1				
22	Steering Linkage N/A	78670-4259	1	43	#8 x 1-1/2" Screw	0801-0308	2				

**Service Bulletin 138

Bold and Underlined parts are to be purchased and installed by Service Centers only. These items may not be sold directly to consumers by Service Centers or Fisher-Price.

