

Age Range: 1-3 Yrs.  
 Weight Limit: 40 Lbs.  
 Surfaces: Hard, Grass & Carpet  
 Colors: White Body  
 Pink Tires  
 Purple seat and Handlebars  
 Intro: 1994  
 Warranty: 90 Days Vehicle  
 6 Months Battery

# 76104-9993 / 836804AH

## BALLET BARBIE®

### Toddler Series Type H Mini 6 Volt

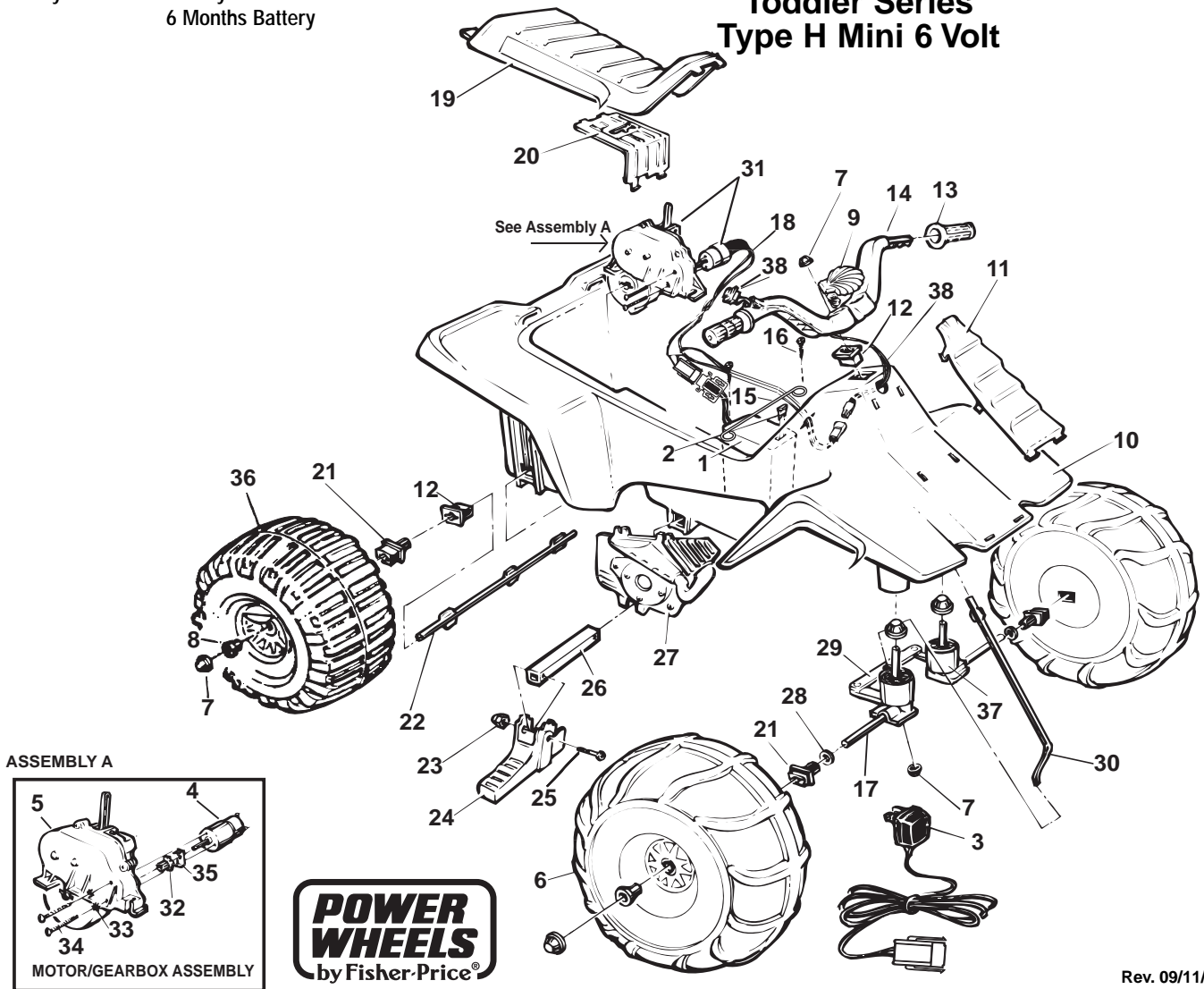

Rev. 09/11/03

Item No.	Description	Part No.	Qty.	Item No.	Description	Part No.	Qty.	Item No.	Description	Part No.	Qty.
1	Battery 6 Volt	0801-0336	1	19	Seat - Lavender N/A	73680-2819	1	36	Rear Wheel	76980-2469	2
2	25 Amp Fuse	0801-0151	1	20	Motor Cover	73560-9489	1	37	Front Post Bushing N/A	73680-2539	2
3	Charger (4 Amp Hr)	00801-0976	1	21	Bushing w/Long Extension	78560-2659	4	38	Switch Assm.	78560-2799	2
<b>4</b>	<b>Motor (NLA)</b>	<b>73560-0640</b>	1	22	Rear Axle	74504-4539	1	<b>PARTS NOT SHOWN</b>			
<b>5</b>	<b>#5 Gearbox w/out Motor</b>	<b>72629-9259</b>	1	23	Acorn Nut N/A	0801-0218	2	Tassels	73680-2129	2	
6	Front Wheel N/A	73670-2469	1	24	Footpeg - Lavender N/A	73680-2159	2	Decal Sheet N/A	80017-0270	1	
7	.354 Cap Nut	0801-0548	8	25	1-1/4" Shoulder Bolt	0801-0304	2	Literature Bag N/A	80034-0576	1	
8	Wheel Bushing	78560-2679	4	26	Footpeg Support	76940-2179	1	Mylar Decal Sheet N/A	80017-0271	1	
9	Microphone N/A	74780-9479	1	27	False Motor Set N/A	73670-2119	1	Lace Scrunchie Set N/A	80001-0397	1	
10	Body N/A	77440-2109	1	28	Washer	0801-0253	2	Battery Foam Pocket	73560-0401	1	
11	Grill - Lavender N/A	73680-2809	1	29	Steering Linkage	74504-4219	1				
12	Bushing w/o Extension	74504-2549	2	30	Steering Column	76940-4239	1				
13	Handgrips N/A	73670-2129	2	31	#5 Motor Gearbox Assy. (incl. 4, 5, 32, 33, 34 & 35)	74504-9519	1				
14	Handlebar/Switch Assy N/A	80029-0047	1	<b>32</b>	<b>Motor Drive Gear N/A</b>	<b>74504-2259</b>	1				
15	Battery Retainer	74504-4429	1	<b>33</b>	<b>Star Washer N/A</b>	<b>0801-0330</b>	2				
16	#8 x 7/8" Trusshead Screw	0801-0228	2	<b>34</b>	<b>Motor Bolt</b>	<b>0801-0269</b>	2				
17	Front Axle	74504-4509	2	35	D Lock Washer	0801-0329	1				
<b>18</b>	<b>Wiring Harness</b>	<b>73560-9799</b>	1								

**Bold and Underlined parts are to be purchased and installed by Service Centers only. These items may not be sold directly to consumers by Service Centers or Fisher-Price.**