

This Owner's Manual is provided and hosted by [Appliance Factory Parts](#).

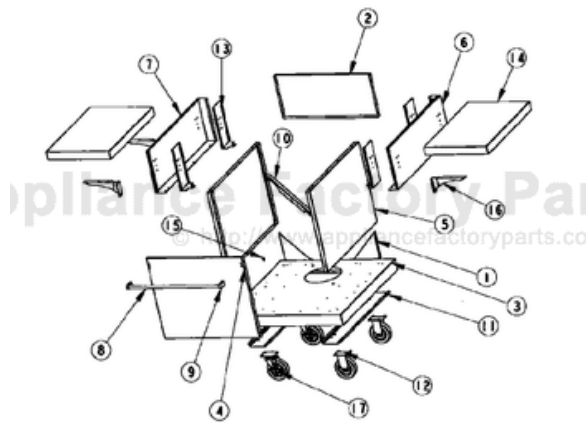

VIKING BQC300T Owner's Manual

[Shop genuine replacement parts for VIKING BQC300T](#)



[Find Your VIKING Grill Parts - Select From 210 Models](#)

----- Manual continues below -----

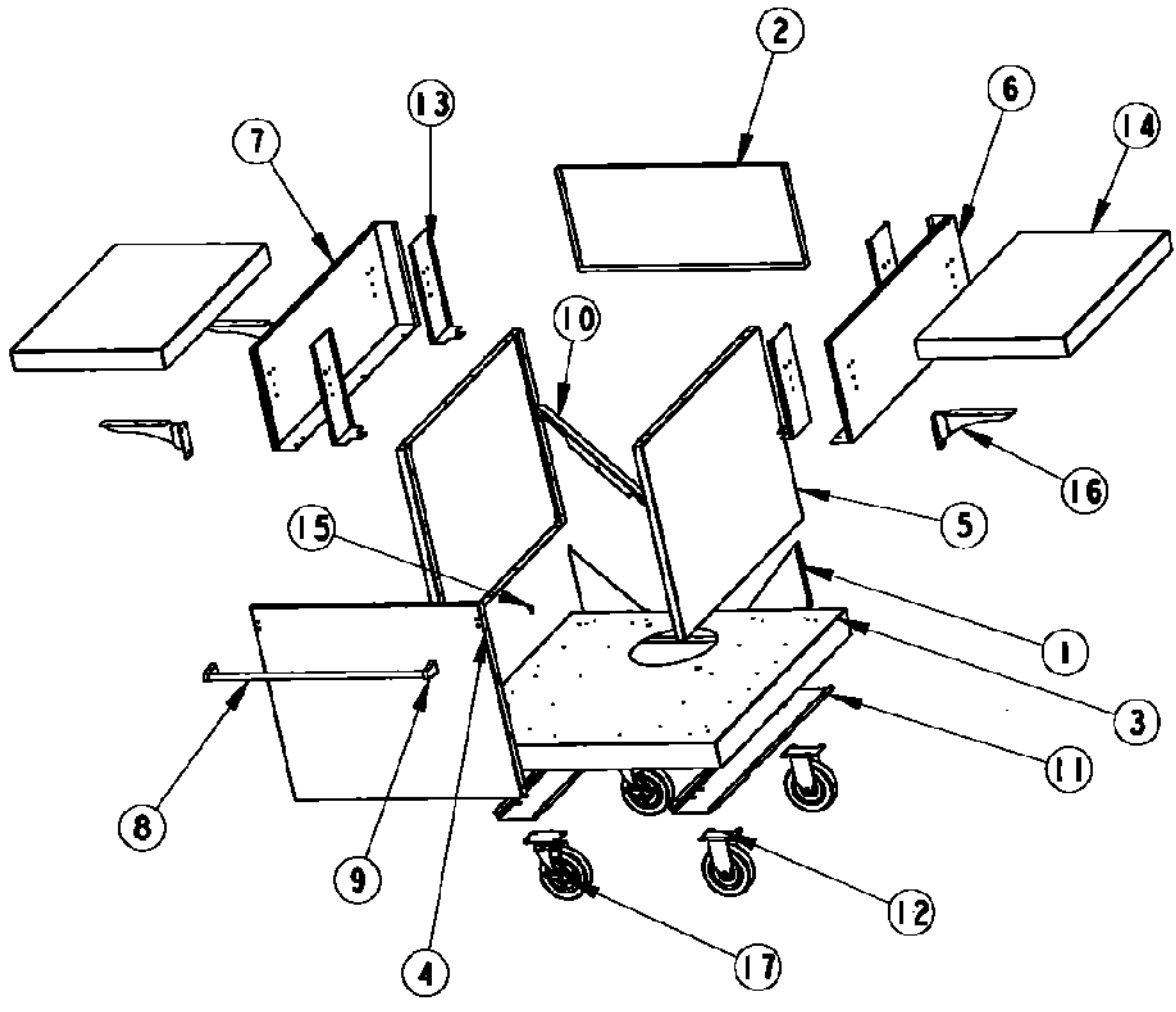

Ref #	Part Number	Qty.	Description
1	B2007209		CART BRACE
2	B2005345		30 CART BACK
3	B3003290		CART BTM BBQ GRILL 30
4	B2006375		30 GRILL CART FRONT
5	B2005342		30 CART SIDE RH
6	B2005343		30 CART TOP SIDE
	B2007242		30 UPPER CART SIDE-RH (BQC300T1)
7	B2005344		30 UPPER CART SIDE LH
	B2007243		30 UPPER CART SIDE LH (BQC300T1)
8	PE030099		CART TOWEL RACKXSSX
	PE030099PVD		CART TOWEL RACK - BRASS
9	PE030054		END CAP - SS
	PE030055		END CAP - BR
10	B2003973		CROSS BRACE (CARTS)
11	B2003364		CASTER BRACE (BBQ)
12	PC030021		CASTER, FIXED
13	B2006320		SIDE SHELF HINGE REINFORCEMENT
14	B3005378		SIDE SHELF PH II BQC530TSS
15	PD020055		NO.10 X 1/2 PAN PHIL. TEK. SS
16	PC020031		FOLD DOWN SHELF BRACKET
17	PC030020		CASTER, SWIVEL
NI	B2004202		L.P. TANK STRAP (VGBQ)
NI	PD020070		1/4 X 20 X 1 SHOULDER THUMB SCREW
NI	PD030050		10-24 CAGE NUT SS
NI	PD020118		ALLEN SCREW