

This Owner's Manual is provided and hosted by [Appliance Factory Parts](#).



Charbroil 463341918 Owner's Manual

[Shop genuine replacement parts for Charbroil
463341918](#)



[Find Your Charbroil Grill Parts - Select From 3621 Models](#)

----- Manual continues below part list -----

Available Replacement Parts for Charbroil 463341918

G430-0033-W1	Grease Cup Aluminized. Measures approxim
G508-0039-W1	Match Holder And Chain.
g409-0030-w1	Button For Electronic Module. Measures a
G437-0037-W1	Wheel. Fits multiple Char-Broil and Kenm
G409-0021-W1	Electronic Ignition Module. 2 port
G430-5303-W1	Electrode Wire For Sideburner. Measures
G305-0043-W2	Clip For Grease Cupplated.
G405-0019-W1	Sideburner Valve Clip.
G501-0066-W1	Rubber Bumper Lid.
G430-0053-W1	Sideburner Grate. Black porcelain grate.
G308-0025-W1	Heat Shield For Electronic Ignition Modu
G501-0039-W1	Grommet.
G560-5001-W1	Rubber Bumper Round.
G432-0078-W1	Flame Carry Over Tube. Stainless steel c
G213-0022-W1	Magnet. Set of 2 magnets.
G451-0025-W1	Warming Rack. Black porcelan wire with c
G651-0038-W1	Drip Pan For Sideburner. Measures approx
G211-0047-W1	Logo Plate For Lid. Measures approximate
G466-2200-W1	Control Knob. Hardware included.. Please
G515-0039-W2	Electrode For Sideburner. Fits multiple
G312-B202-W1	Bezel Temperature Gauge.
G421-0006-W1	Temperature Gauge.
G421-0100-W1	Top Lid.
G421-0200-W1	Charcoal Tray.
G421-0500-W1	Burner.
G421-9100-W1	Sideburner Shelf.
G421-1202-W1	Sideburner Lid.
G421-2001-W1	Heat Shield For Handle.
G421-2400-W1	Upper Cart Frame B.
G451-0030-W4	Handle.

G460-2900-W2	Heat Shield For Tank Firebox.
G466-0047-W2	Burner Brace.
G527-0002-W8	Rubber Bumper With Hole For Top Lid.
G421-7000-W1	Heat Shield For Firebox
G421-0003-W2	Axle
G421-0008-W1	Cooking Grate
G421-4700-W1	Sideburner
G356-0027-W2	Bezel For Knob
G553-0002-W1A	Heat Tent

ASSEMBLY/ ARMADO

1

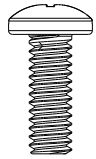

Ⓐ x10

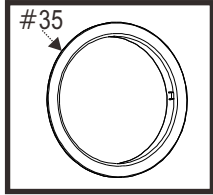

#35

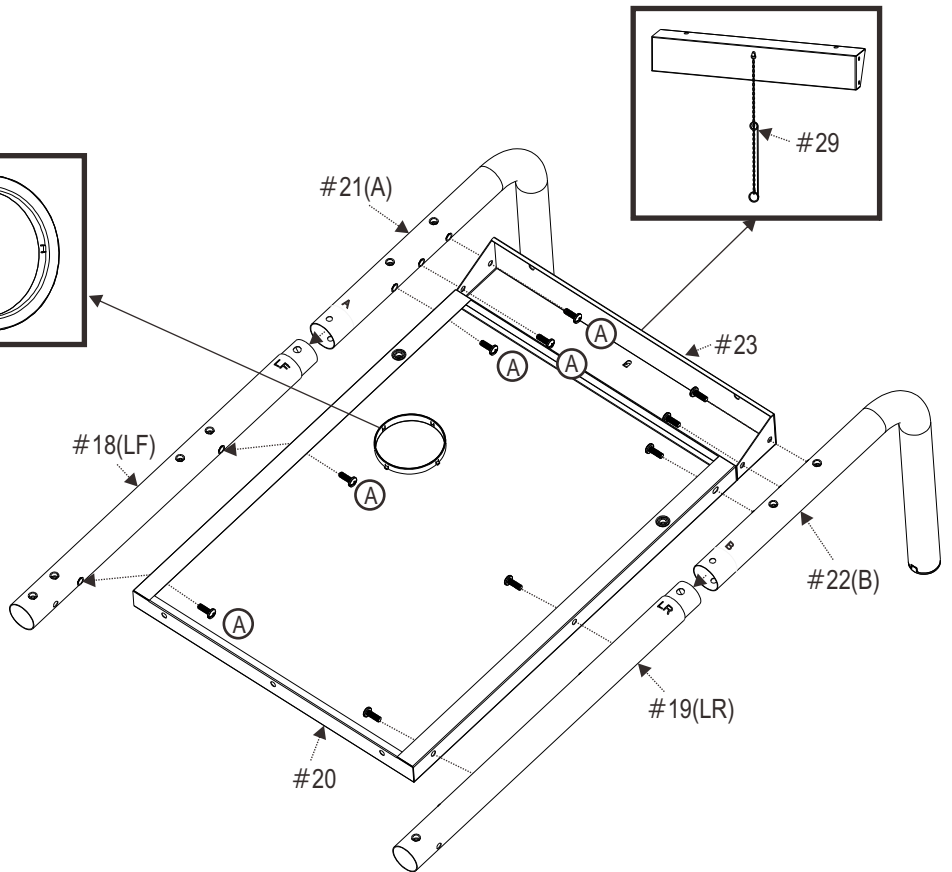

2

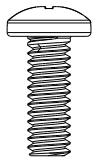

Ⓐ x10

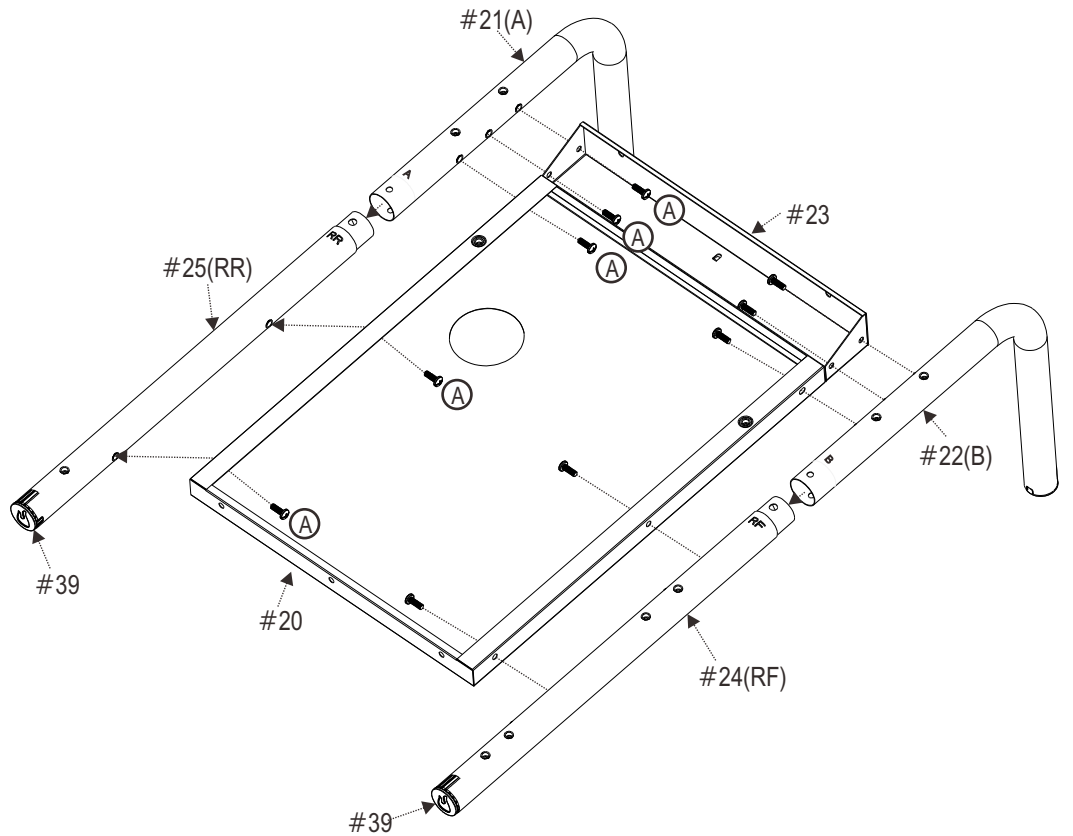

3

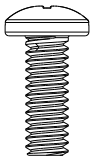

A x8



C x4

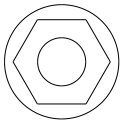

B x4

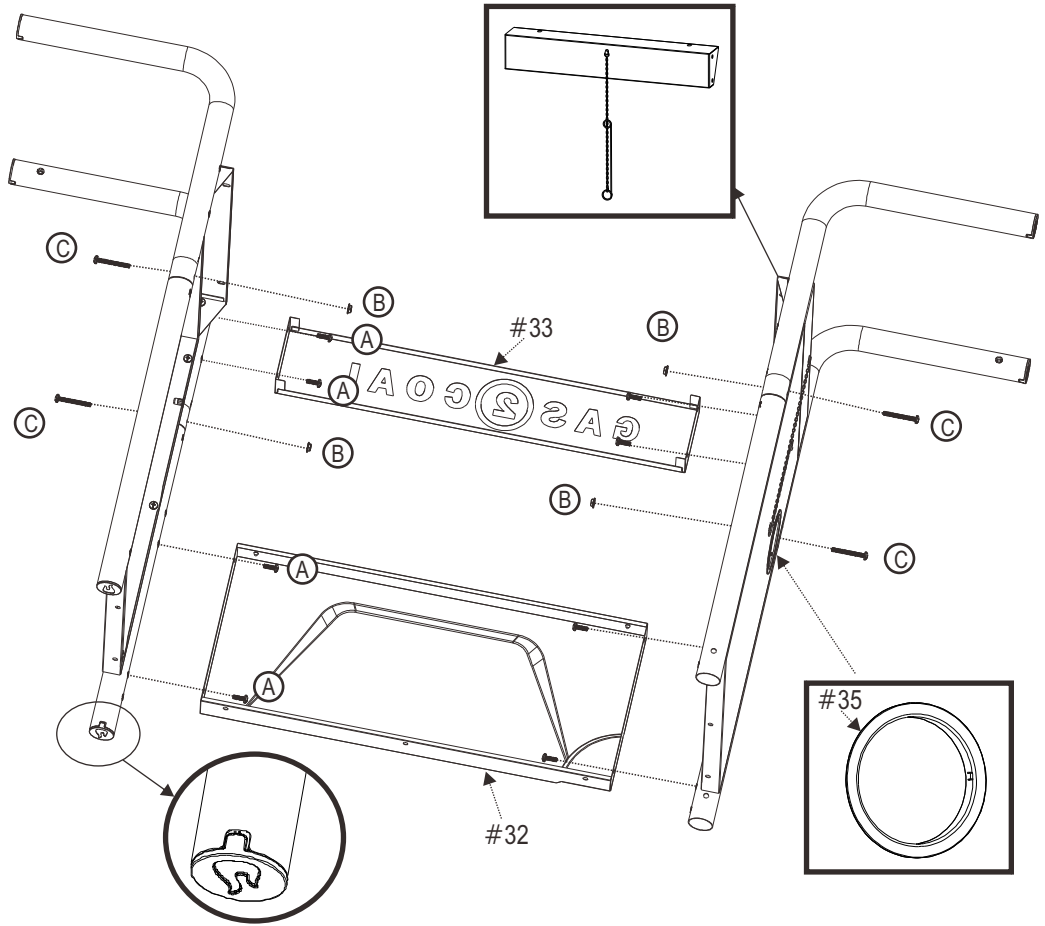

4

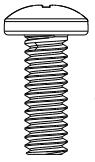

A x4

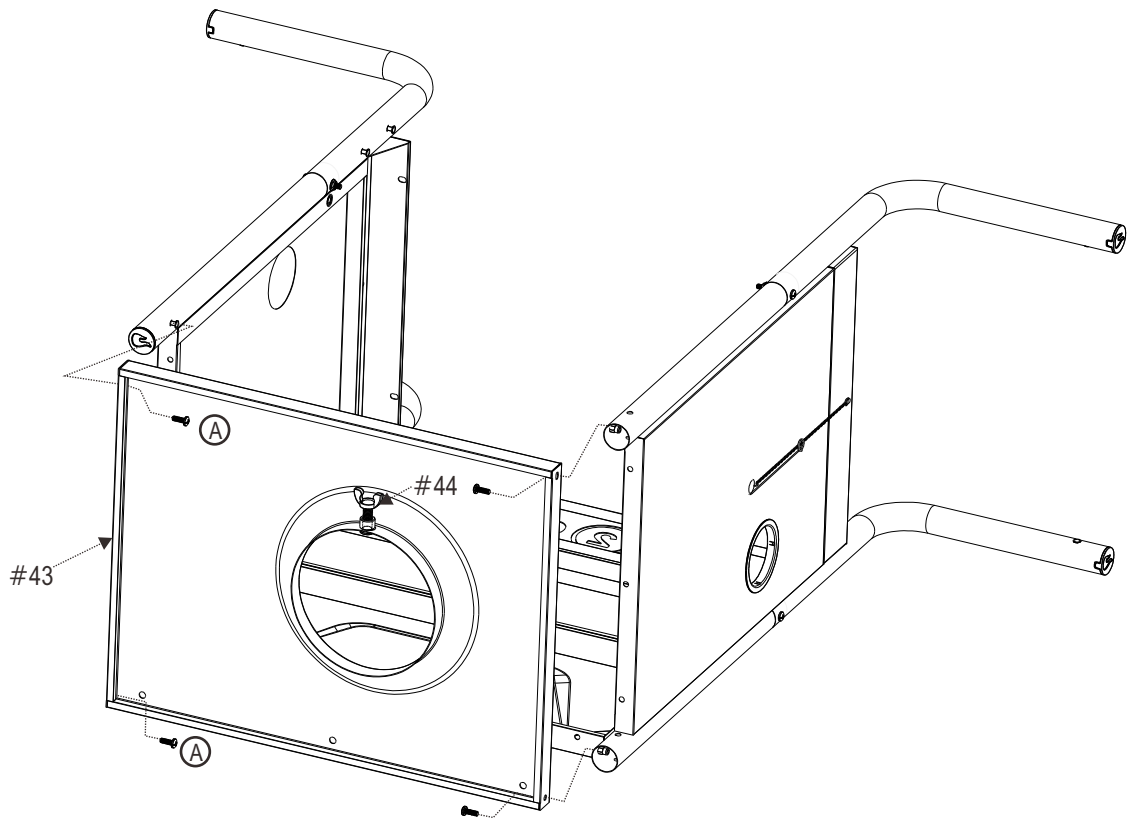

5

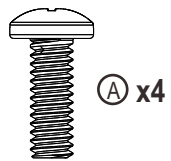
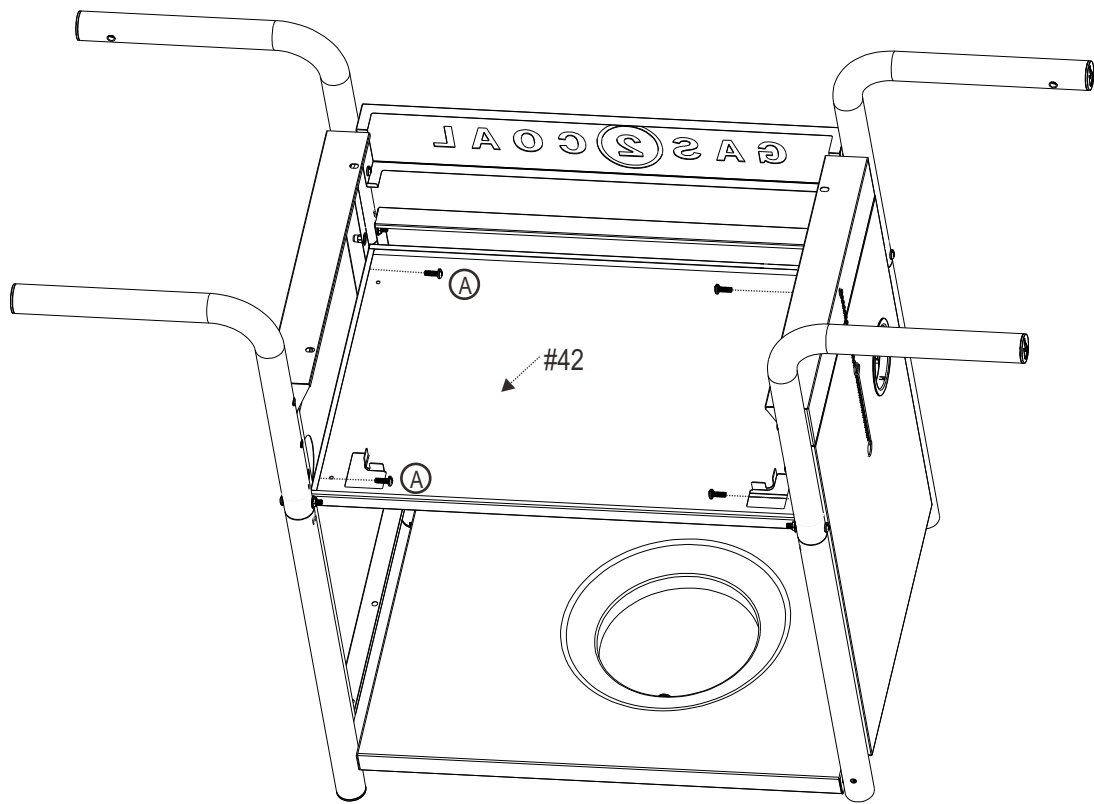

A x4

6

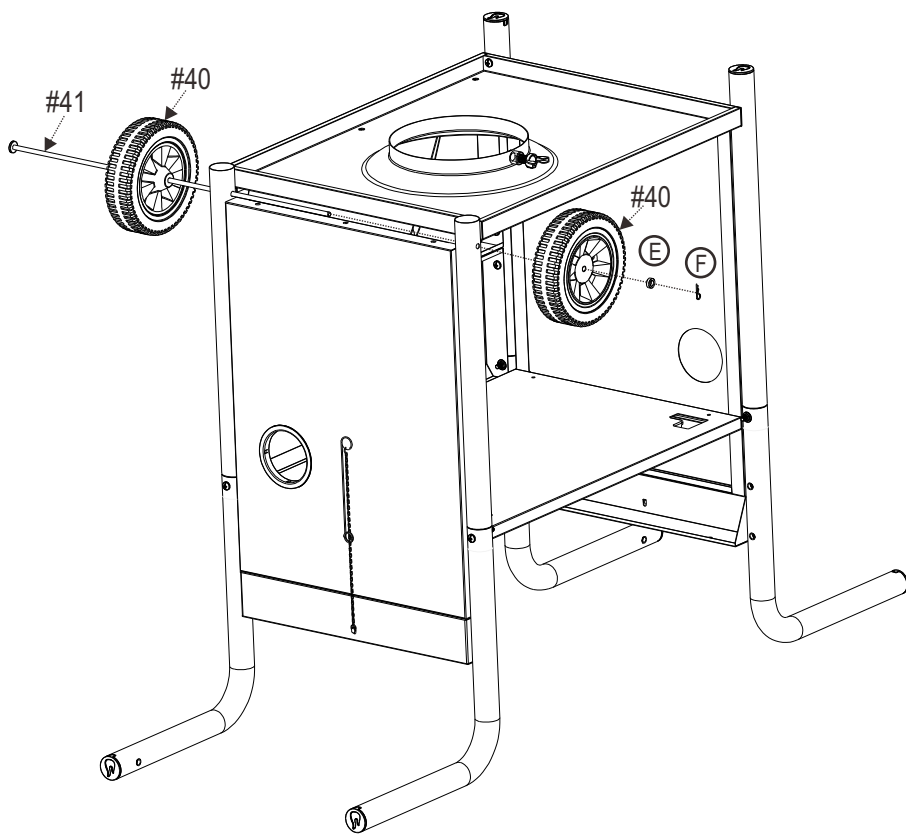

F x1



E x1

7

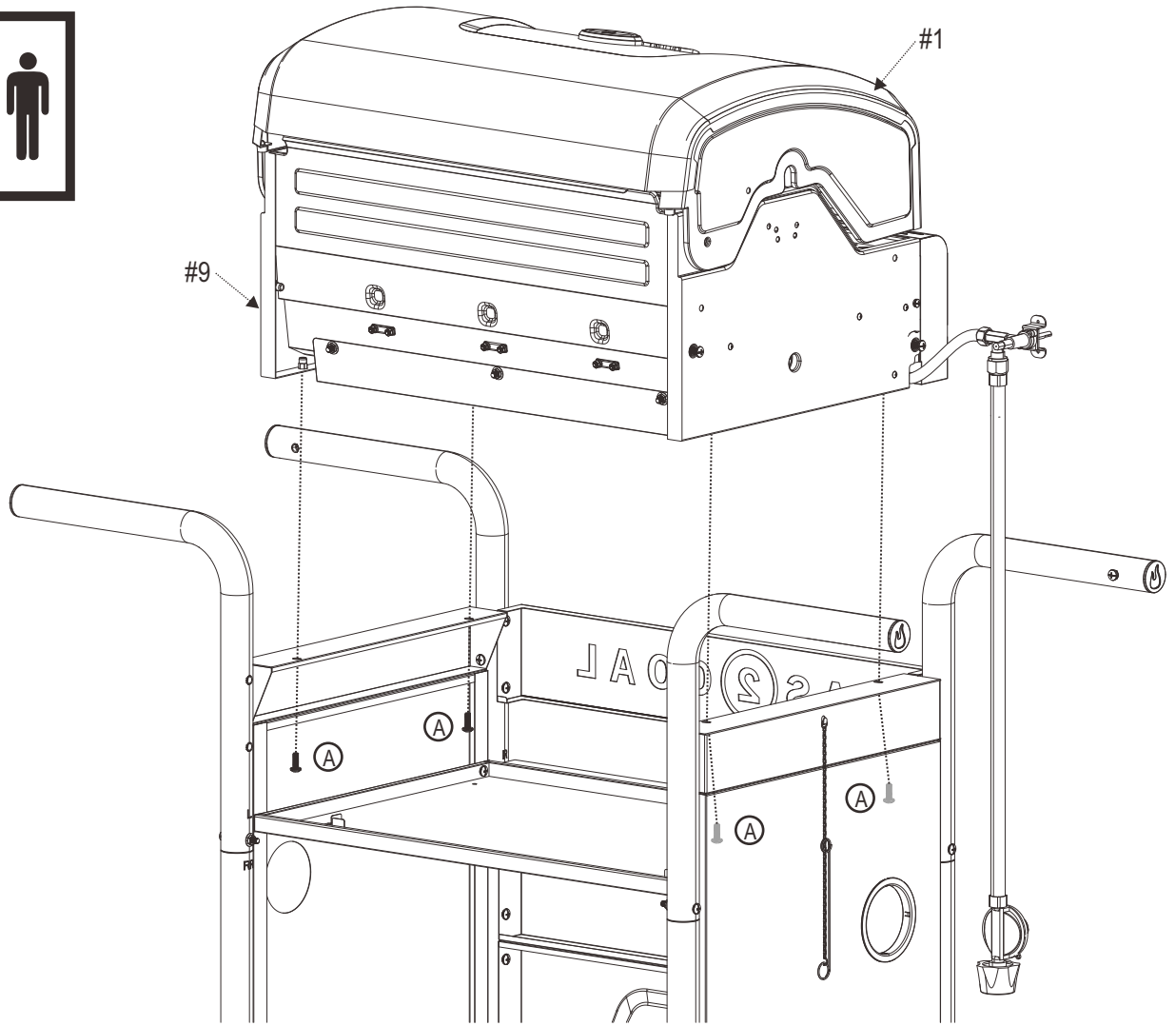
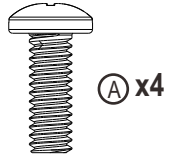
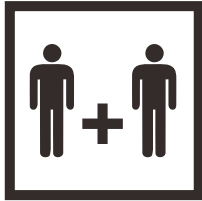

8

1ST

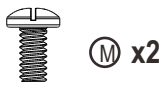
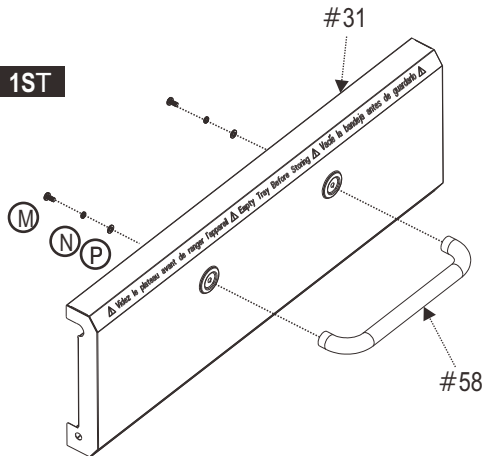

2ND

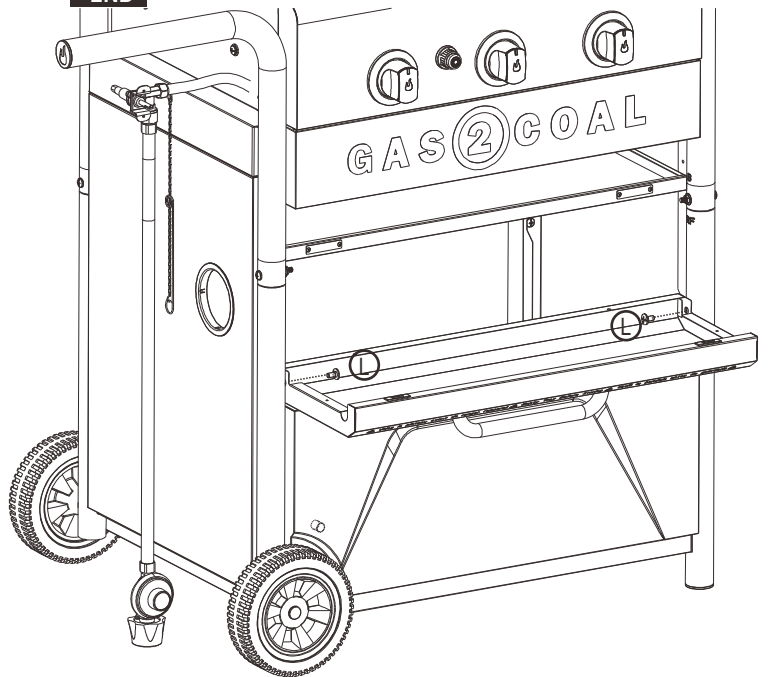

9

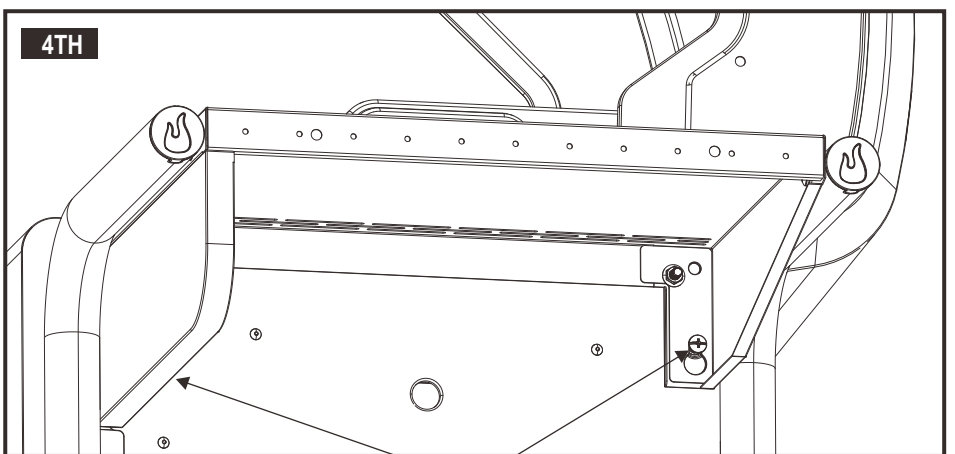
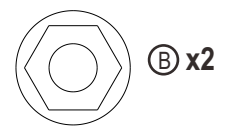
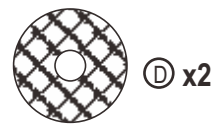
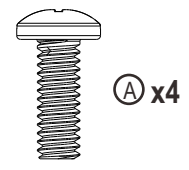
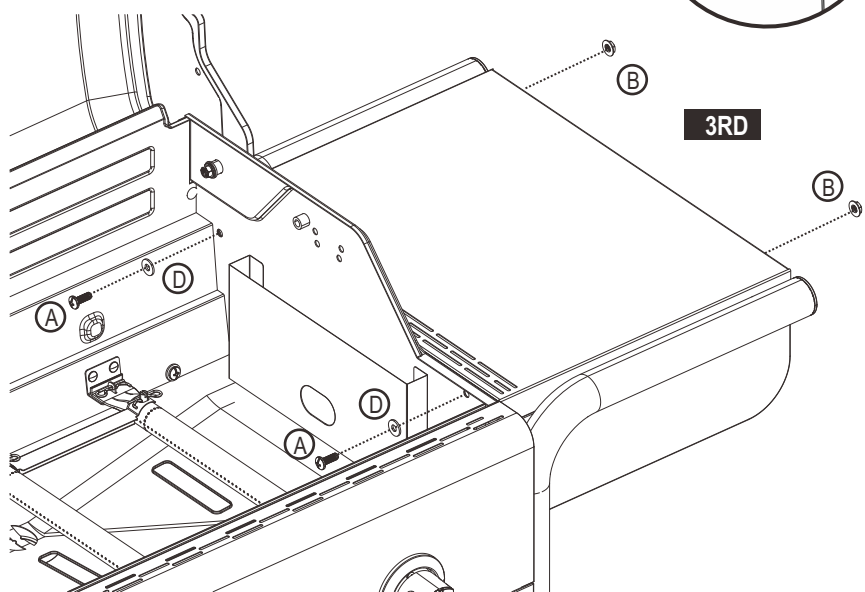
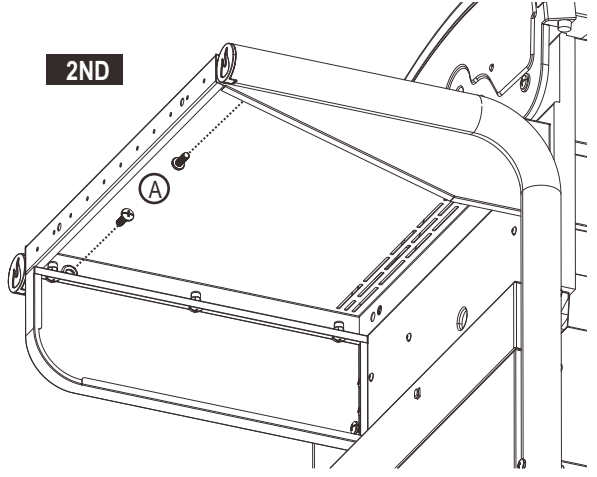
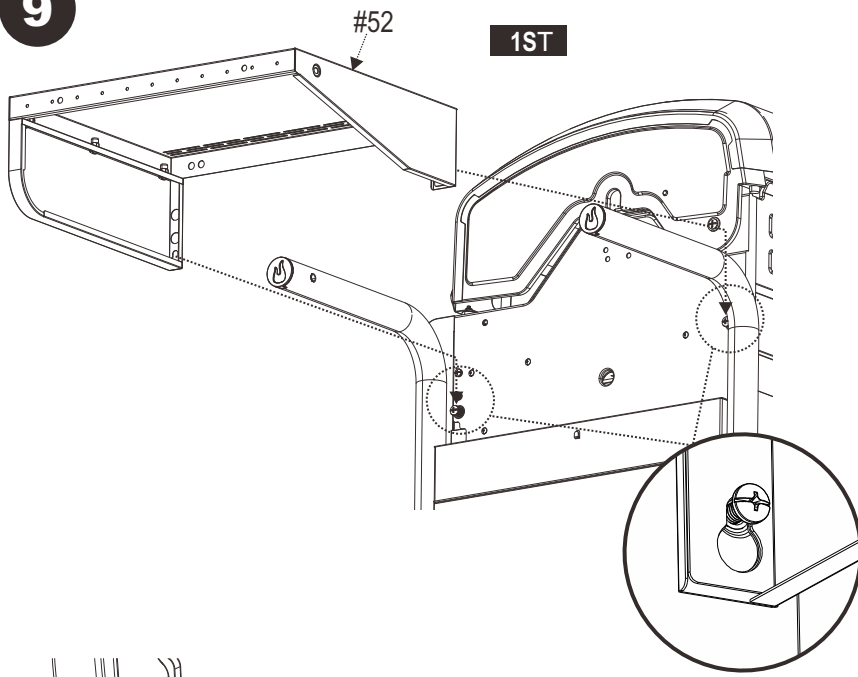

Tighten the screws
Apriete los tornillos

10

1ST

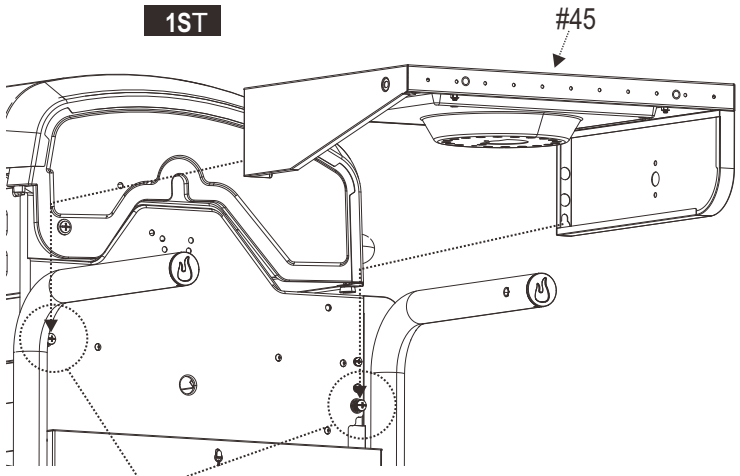

2ND

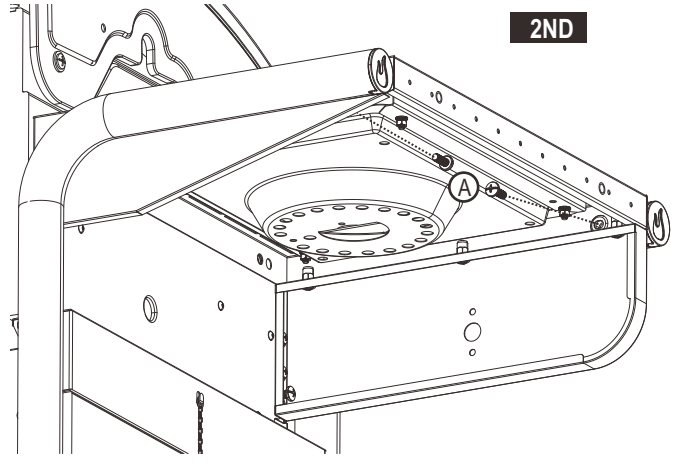

3RD

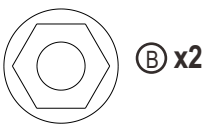
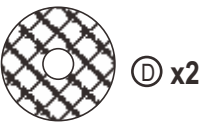
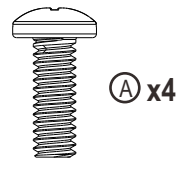
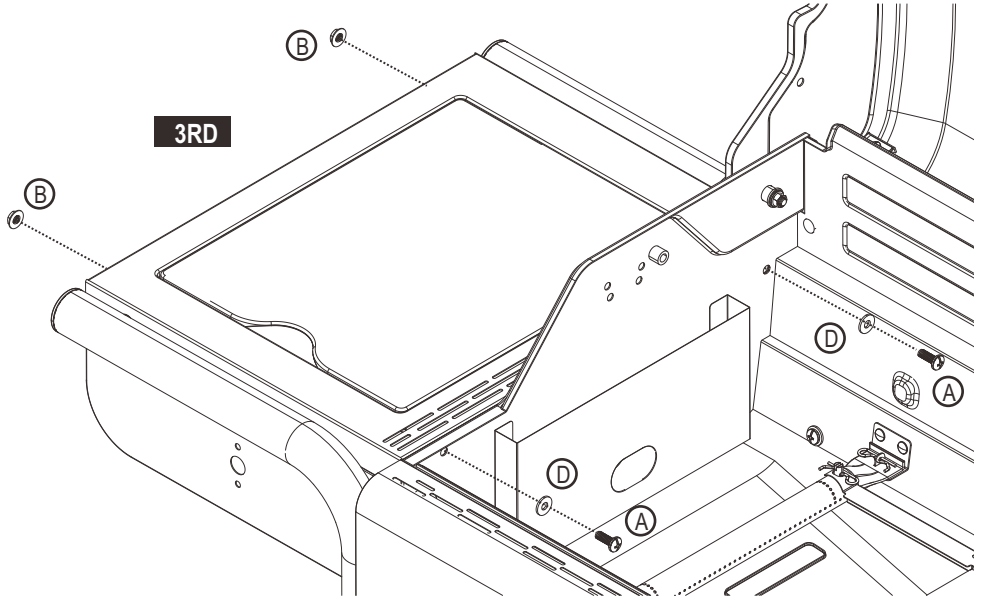

4TH

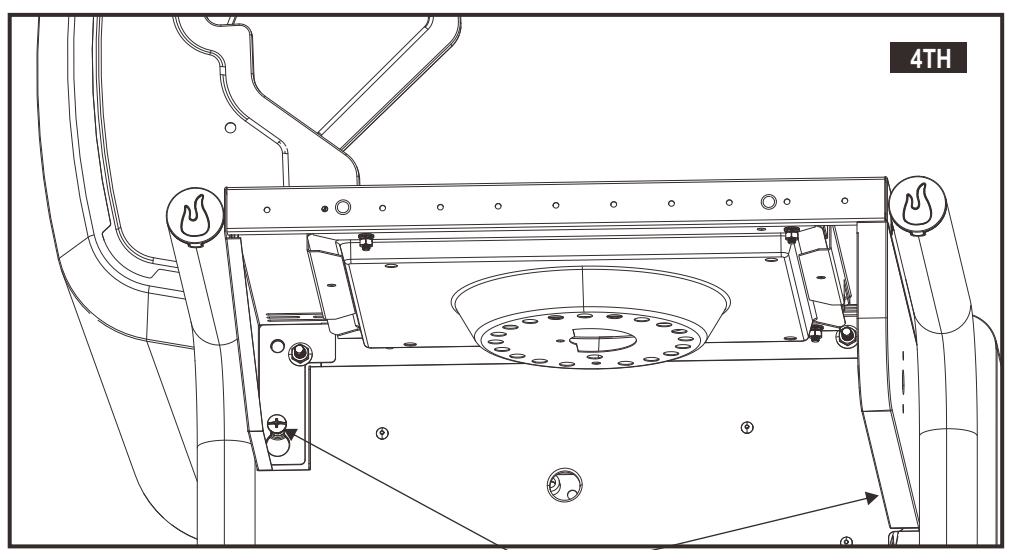

**Tighten the screws
Apriete los tornillos**

11

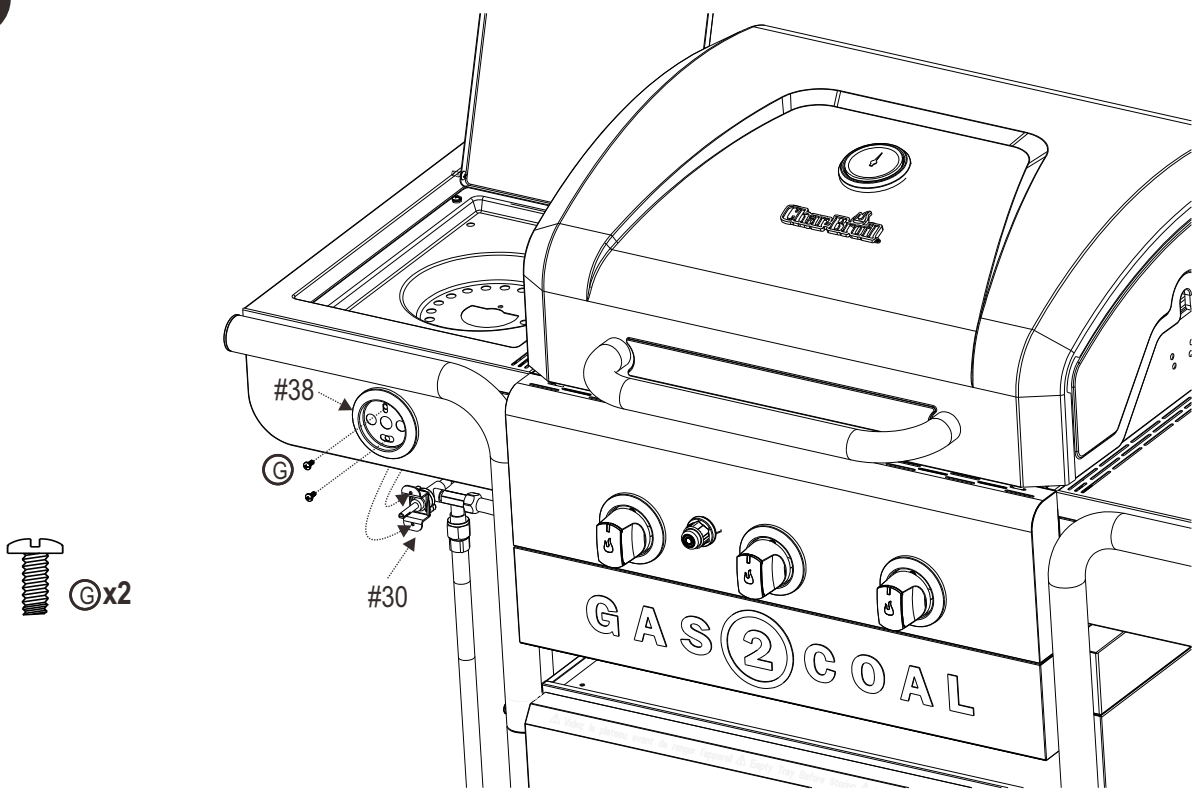

12

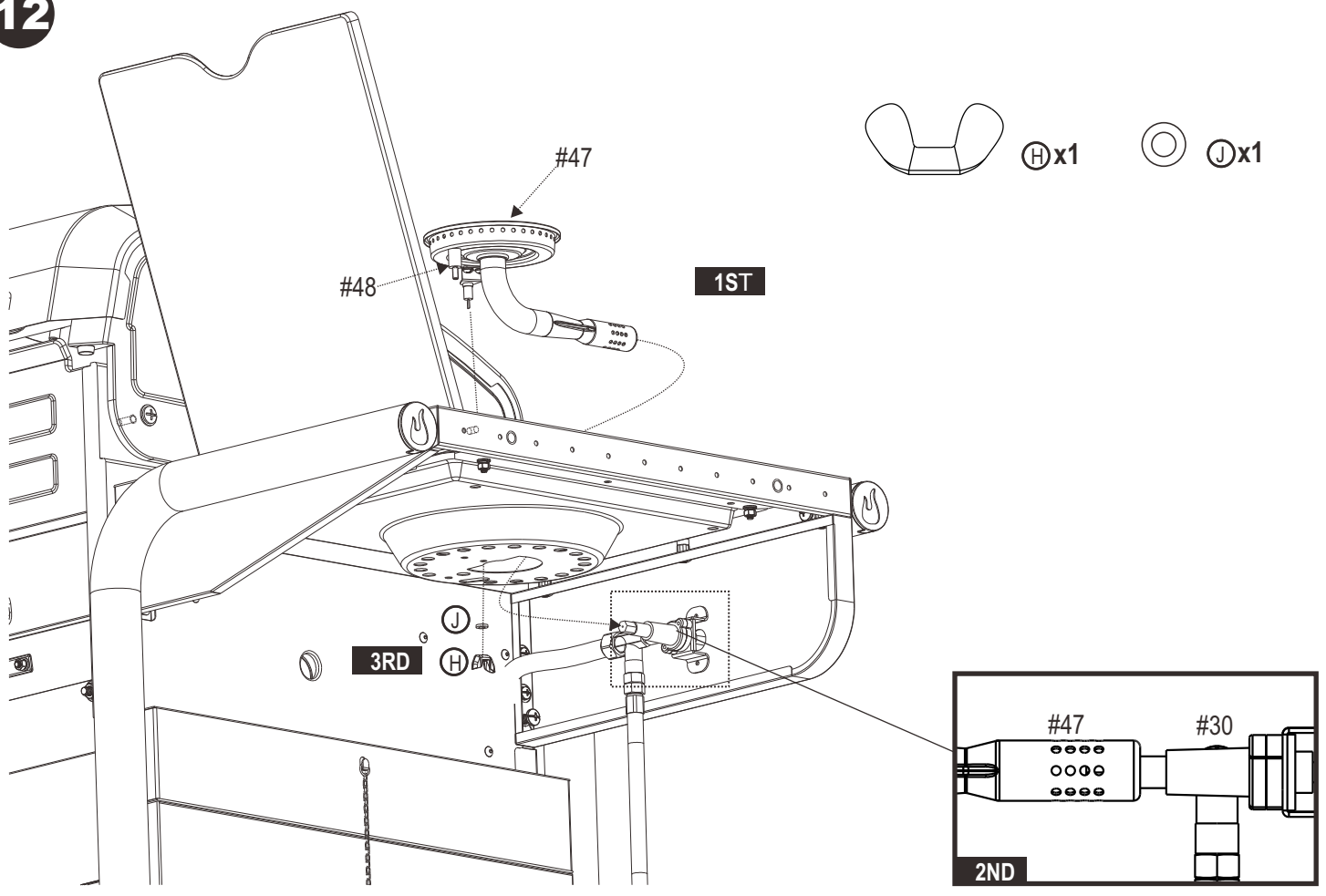

13

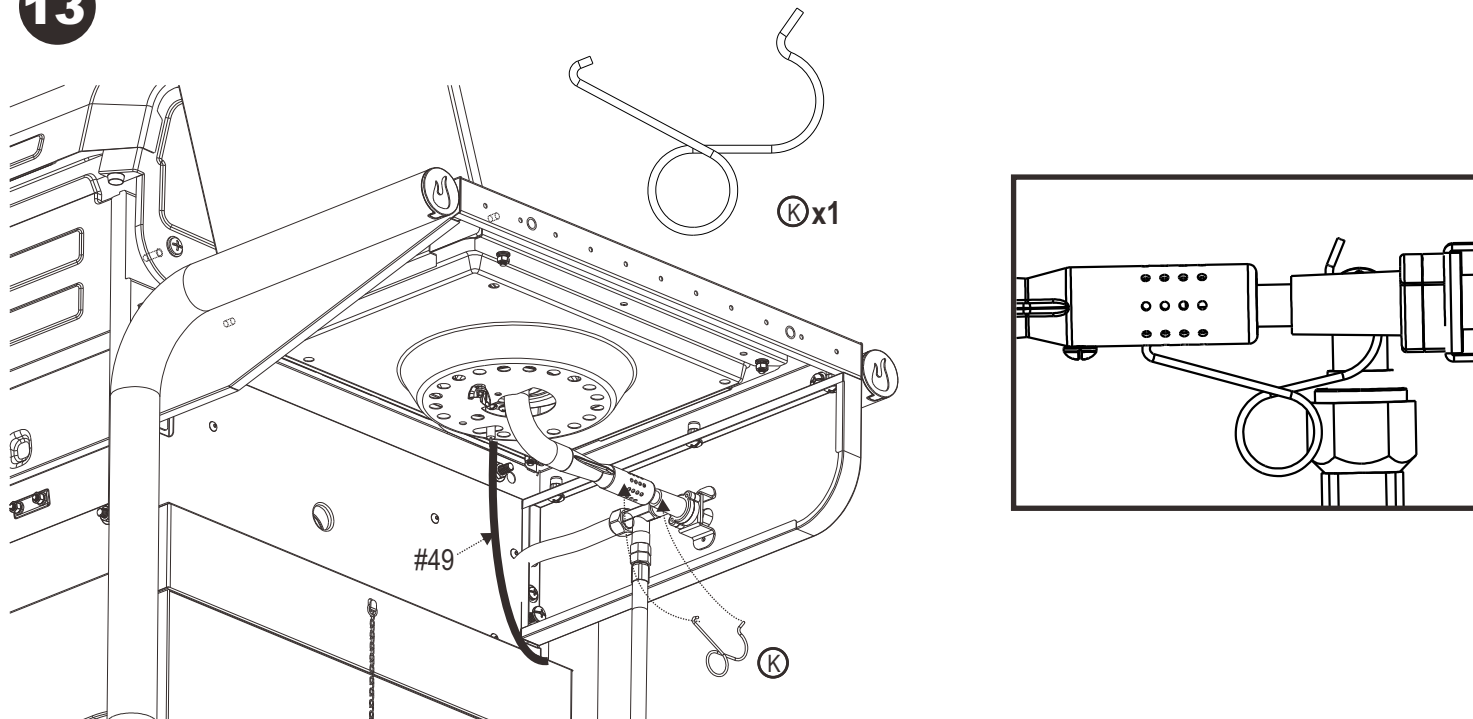

14

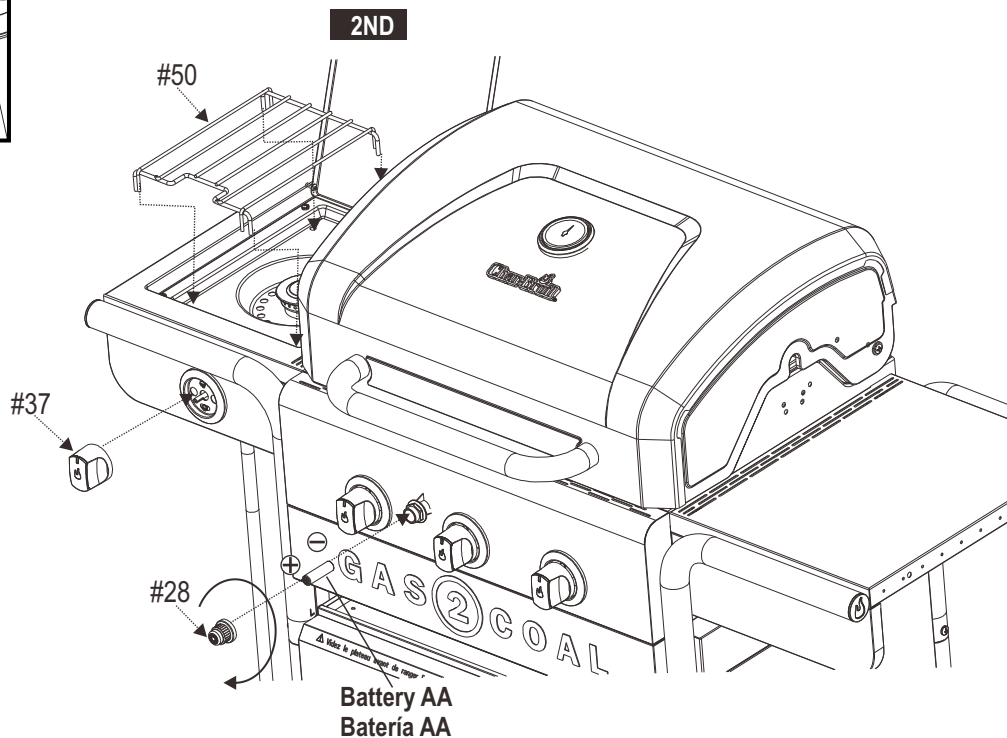
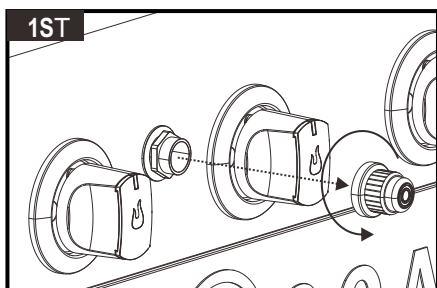

Battery AA
Bateria AA

Battery AA
Bateria AA

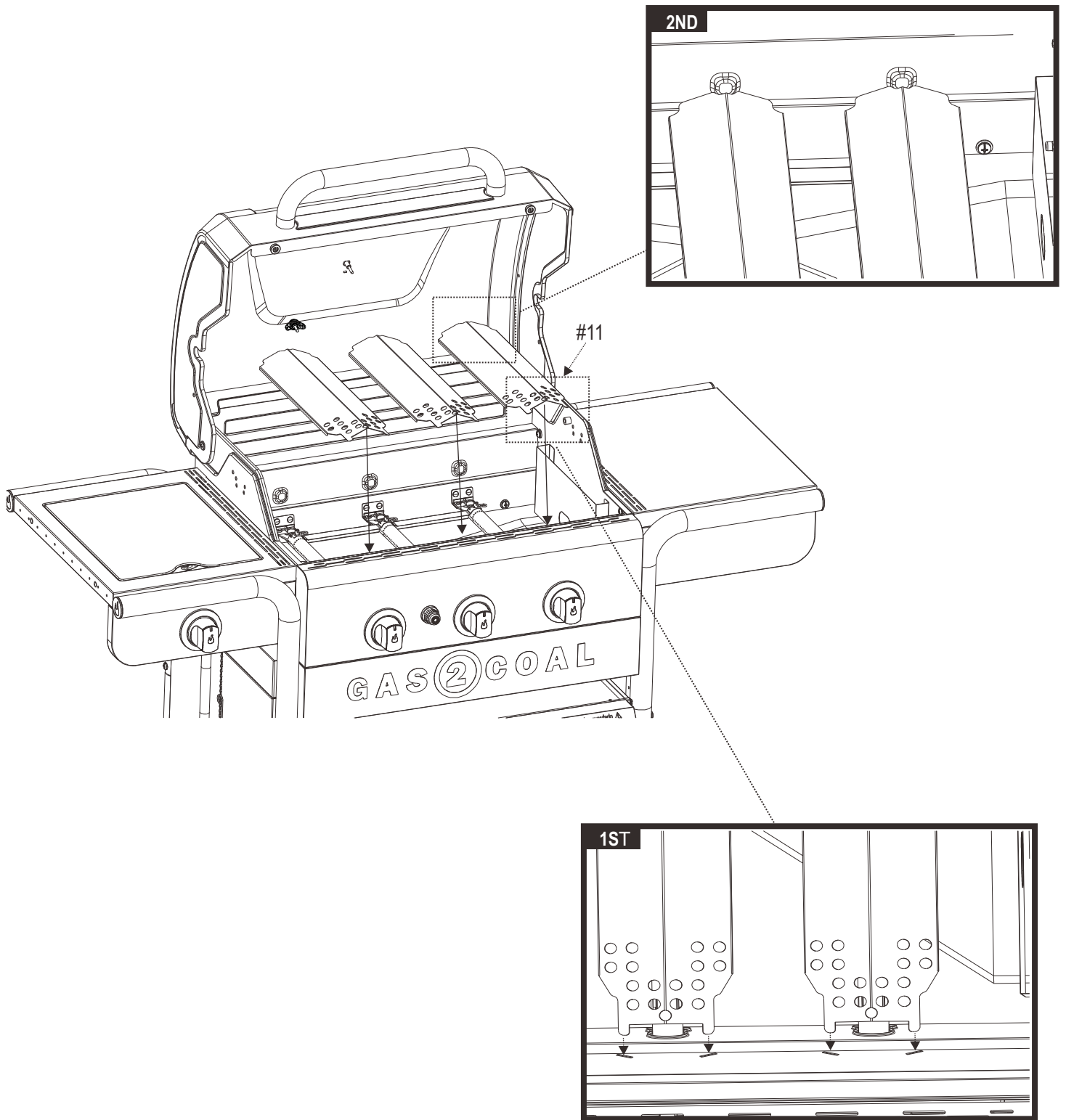

16

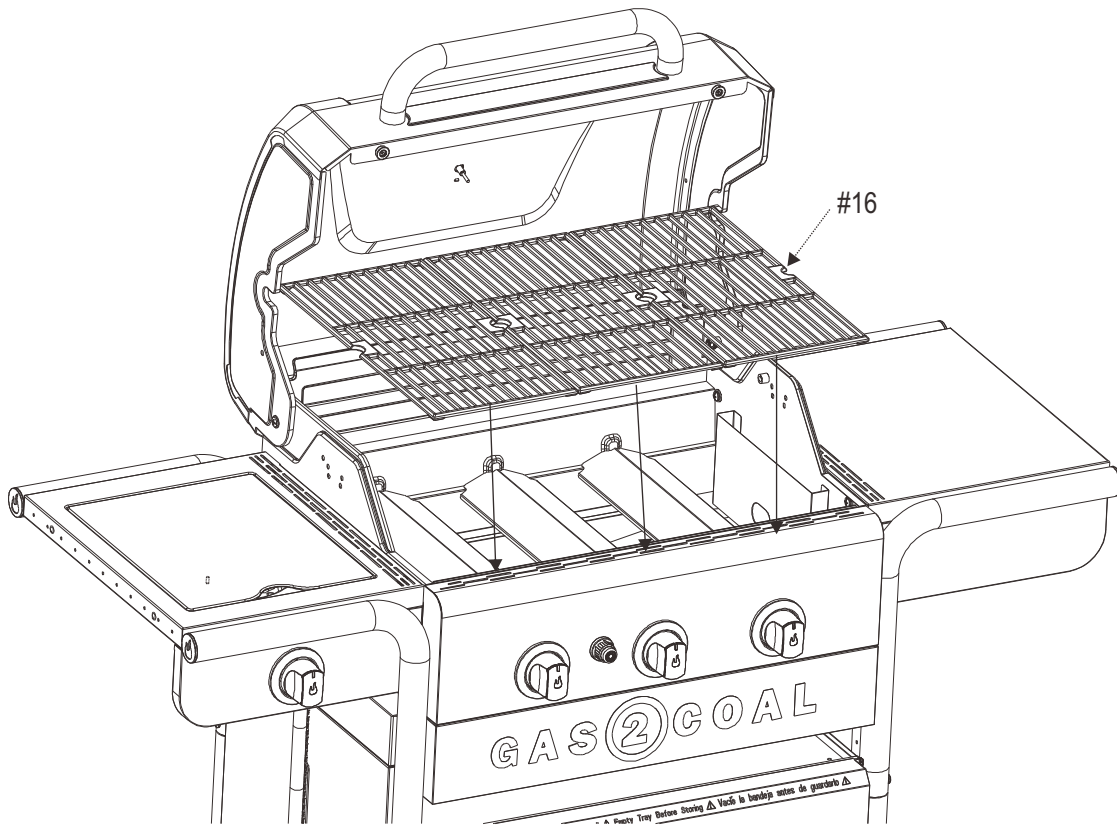

17

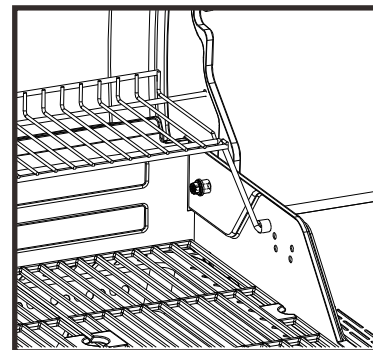
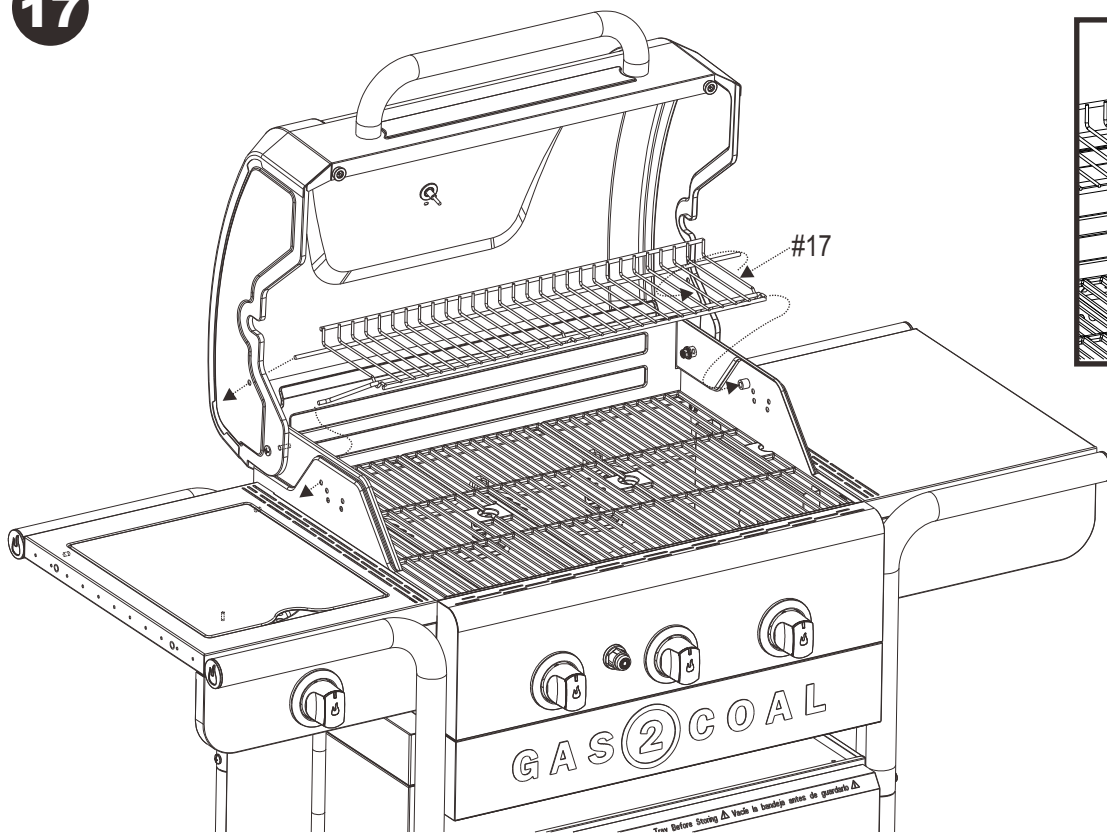

18

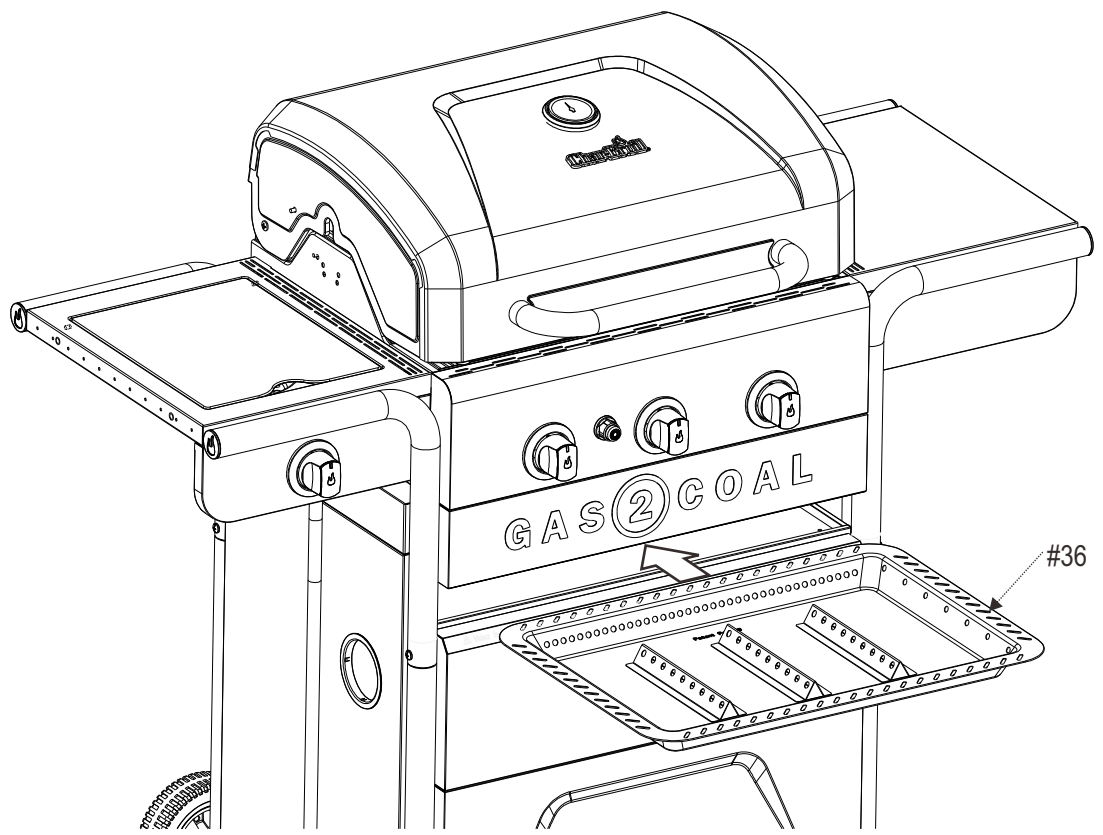

19

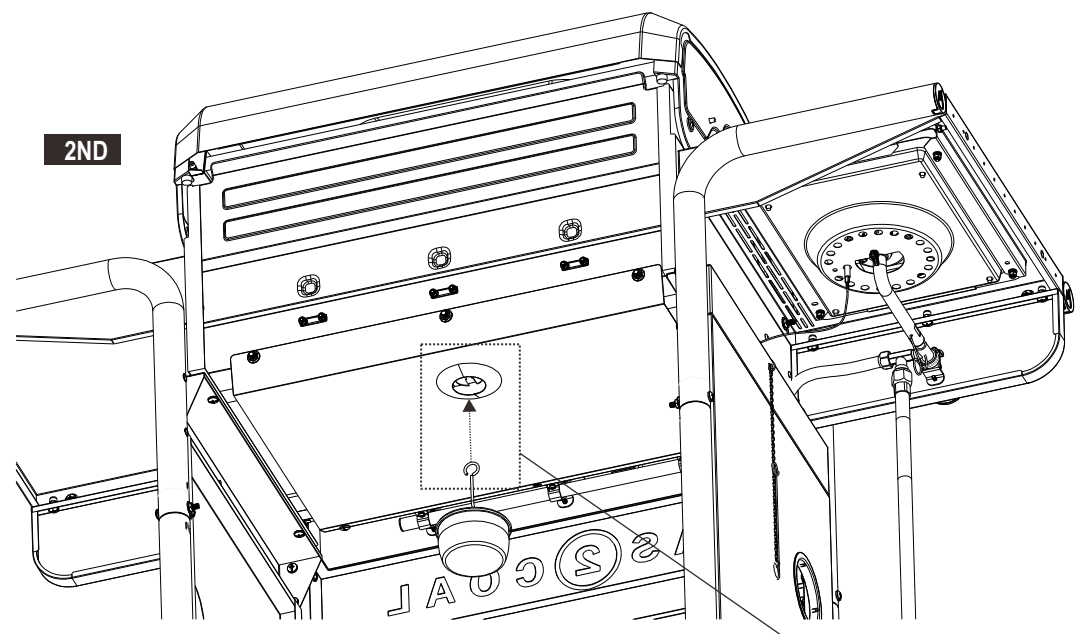
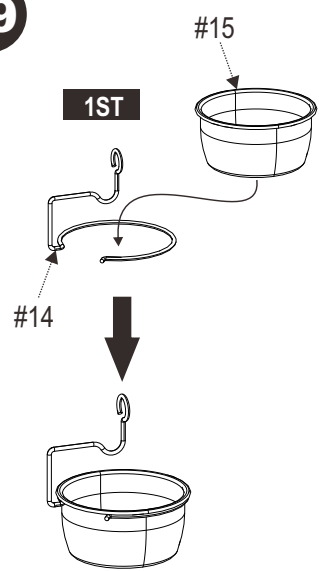

CAUTION

Failure to install grease cup clip and cup will cause hot grease to drip from bottom of grill with risk of fire or property damage.

ADVERTENCIA

Si no instala un recipiente para la grasa, goteará grasa caliente desde el fondo de la parrilla, lo que puede ocasionar el riesgo de incendio o de daños a la propiedad.

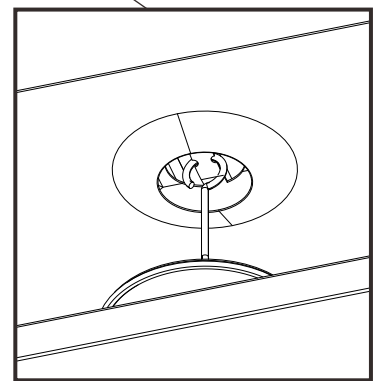

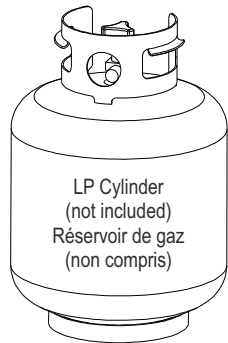

1ST

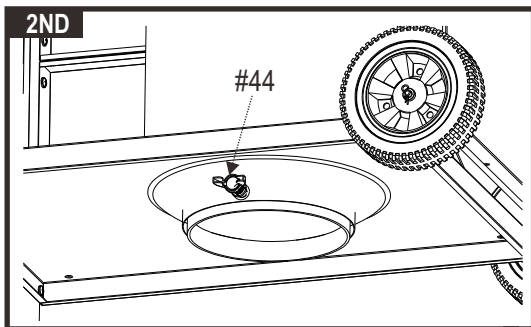
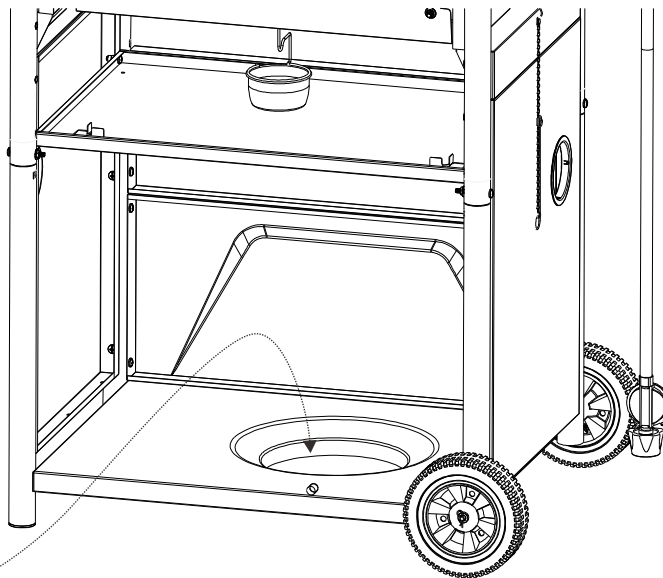

3RD

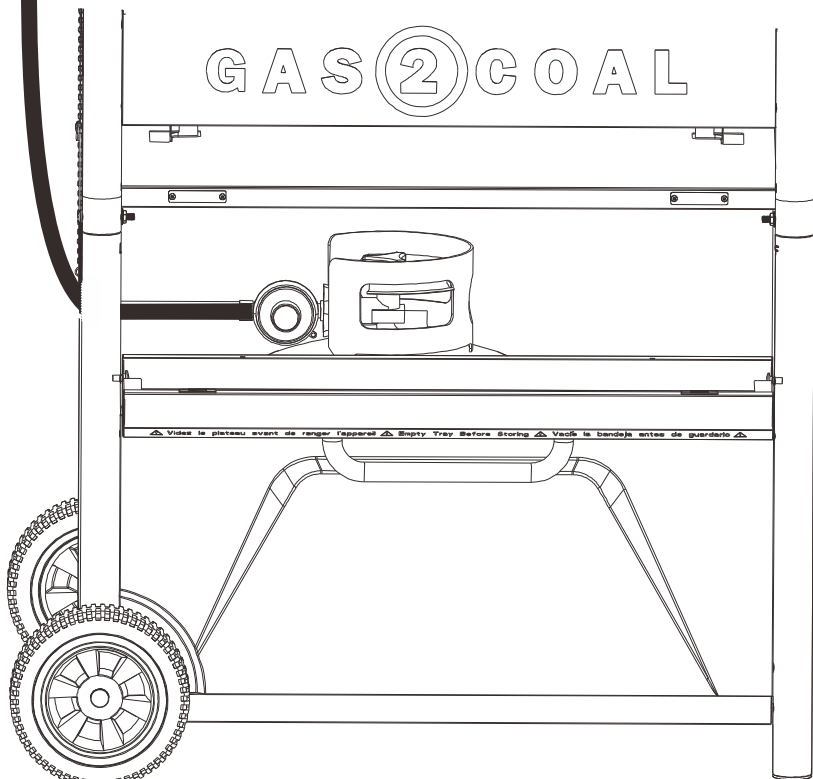

CAUTION

Cylinder valve must face to left of cart once tank is attached. Failure to install cylinder correctly may allow gas hose to be damaged in operation, resulting in the risk of fire.

ADVERTENCIA

Una vez que el tanque haya quedado instalado, la válvula del tanque debe quedar orientada hacia la parte izquierda del carrito. Si no se instala correctamente el tanque, se puede dañar la manguera de gas durante el suministro, lo que puede ocasionar el riesgo de incendio.

CONVERSION/ CONVERSIÓN

1

GAS TO CHARCOAL CONVERSION MUST BE DONE WITH A COLD GRILL.
LA CONVERSIÓN DE GAS A CARBÓN DEBE REALIZARSE CON LA PARRILLA EN FRÍO.

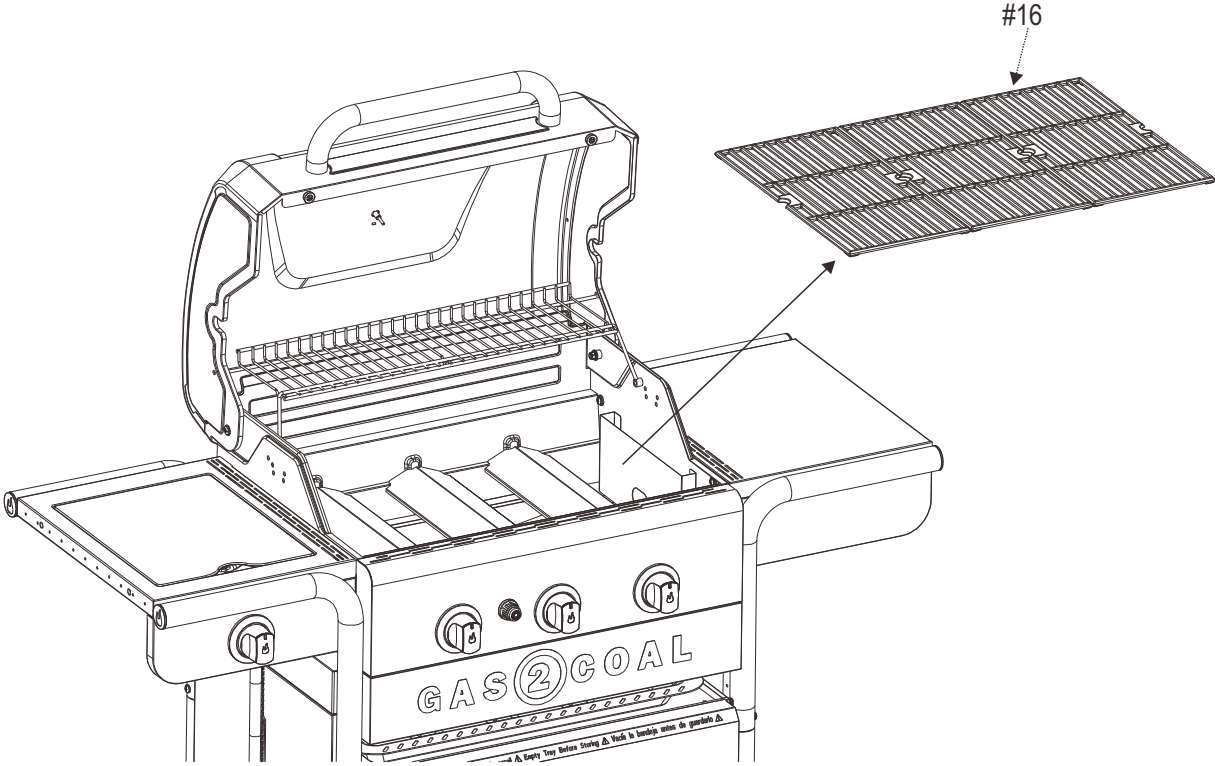

2

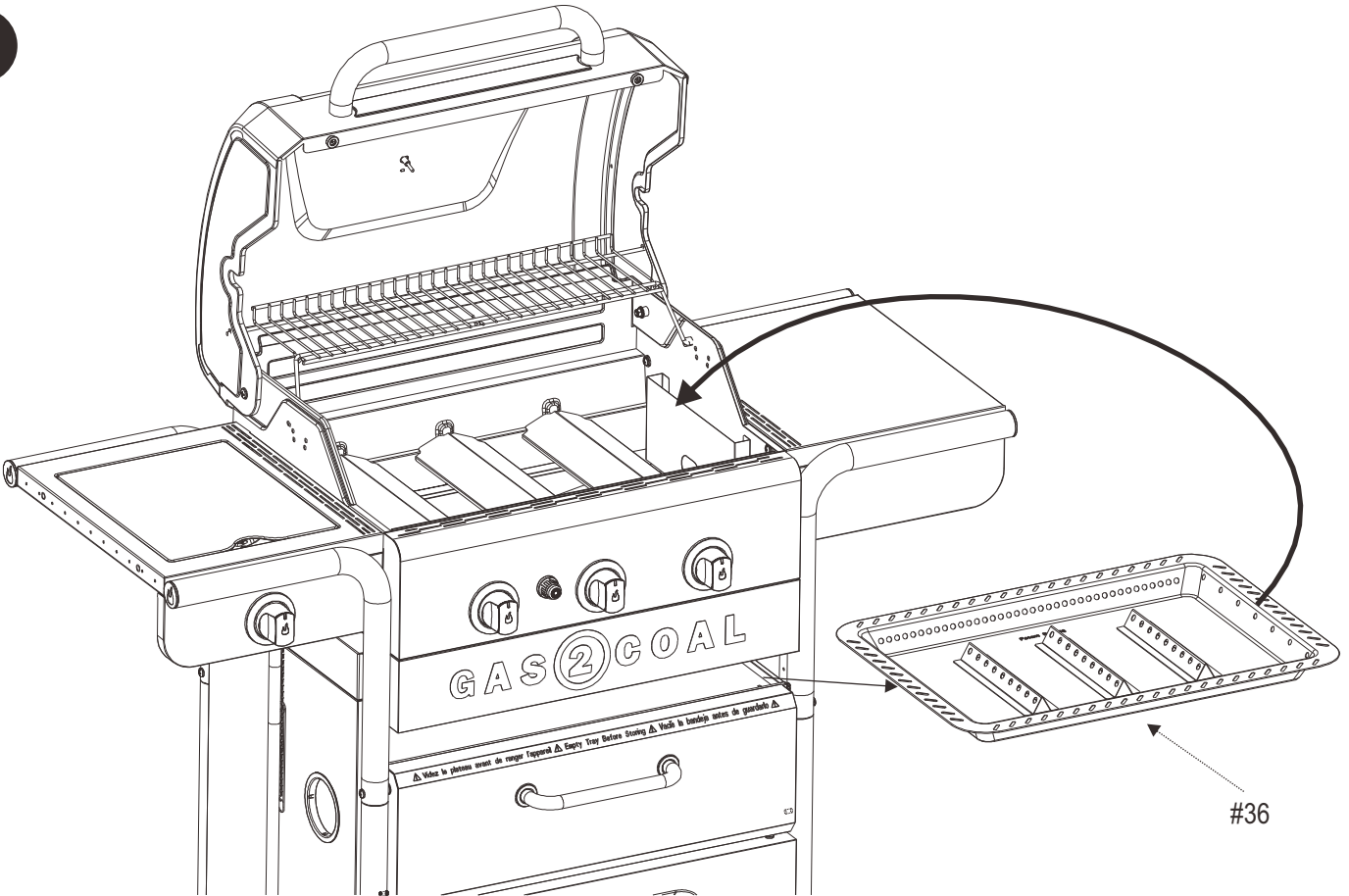

3

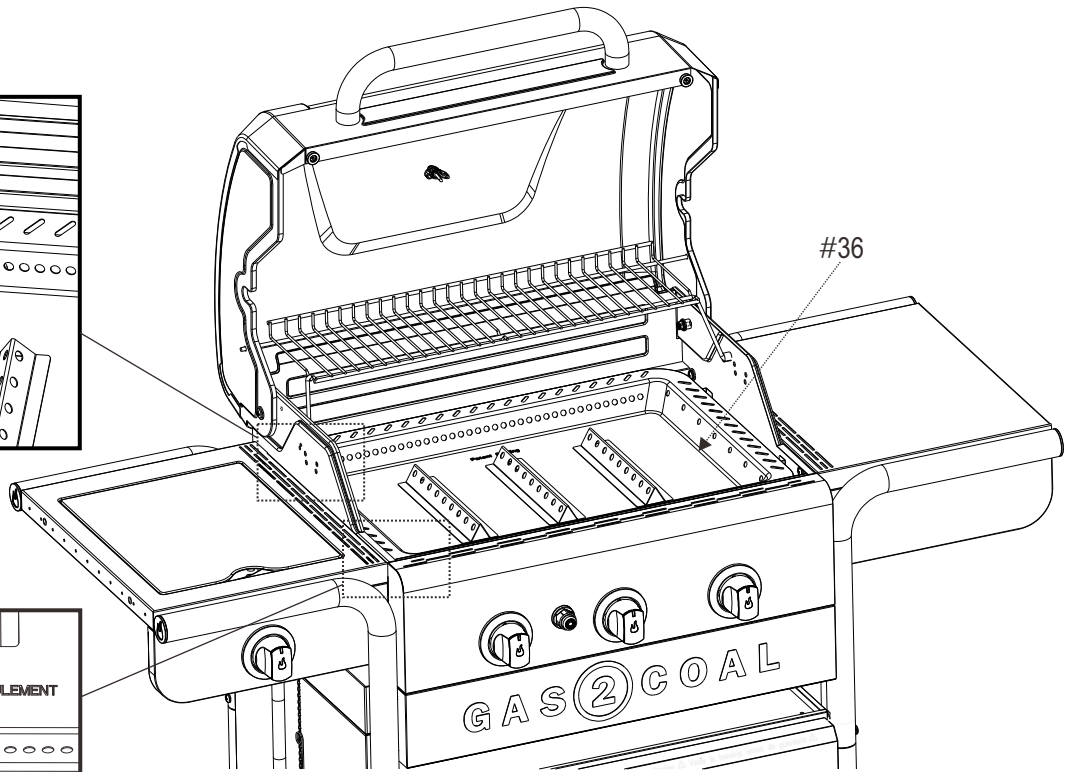
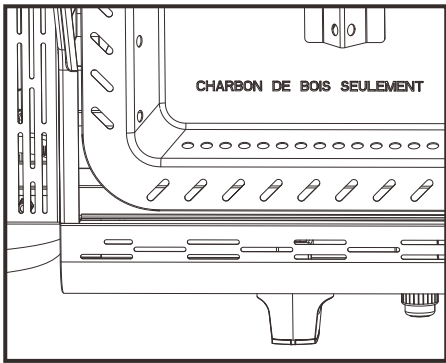
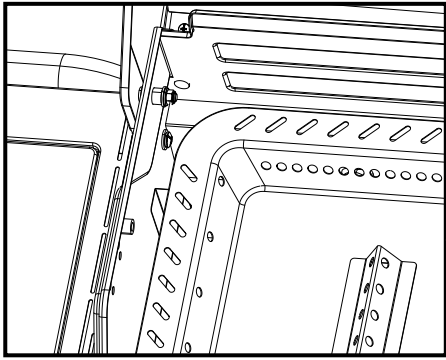

#36

GAS 2 COAL

4

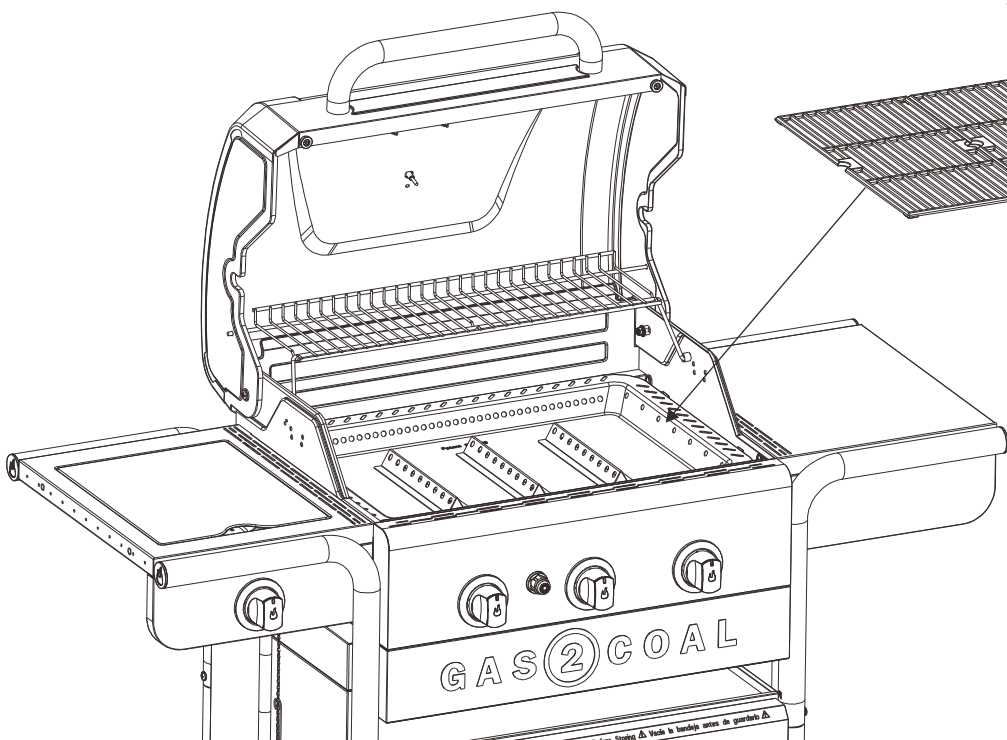

#16

GAS 2 COAL

5

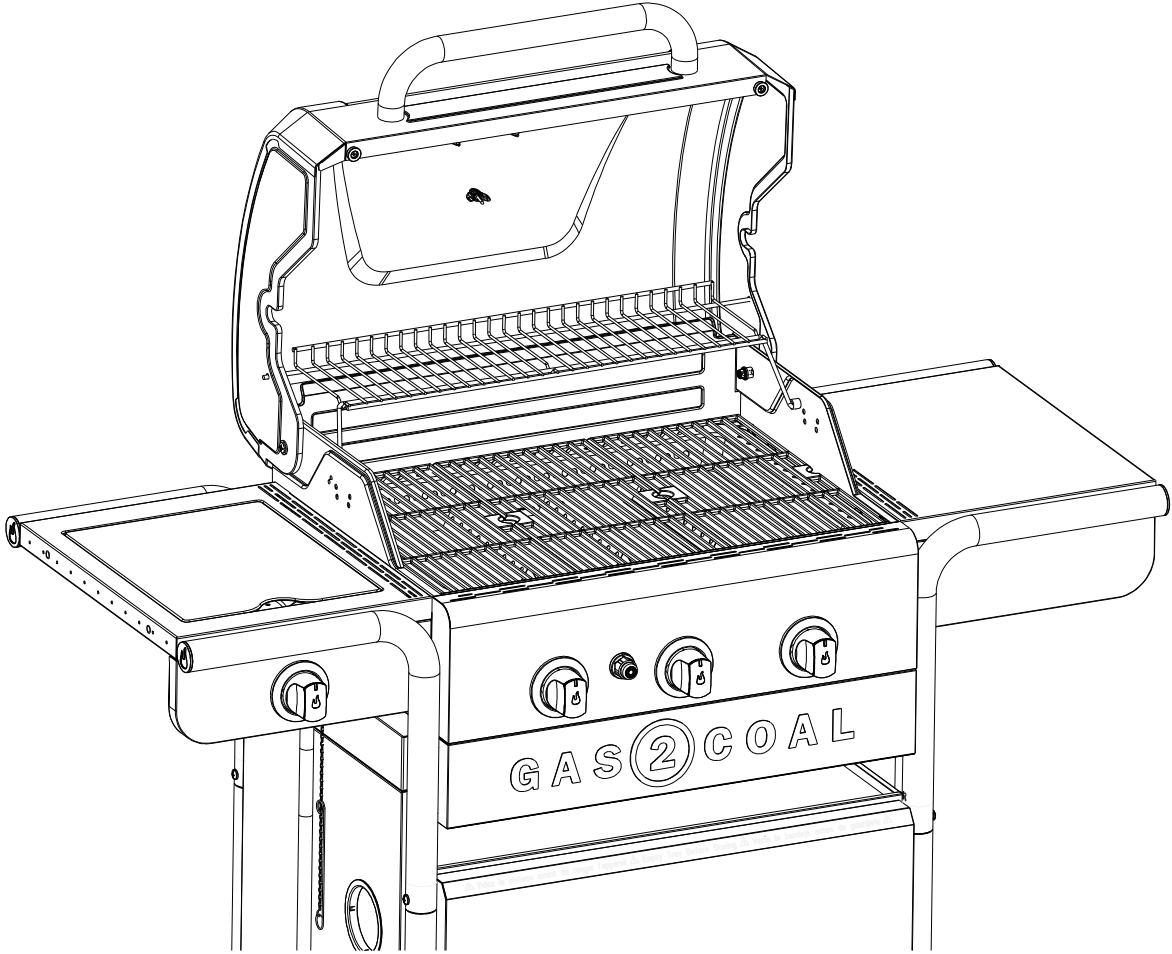



Char-Broil®

©2017 Char-Broil, LLC. Columbus, GA, 31904. Printed in China. Impreso en China.

©2017 Assembly instructions. ©2017 Instrucciones de ensamblado.

The product associated with this guide was manufactured in China.

El producto asociado con esta guía ha sido fabricado en China.