

Package Contents

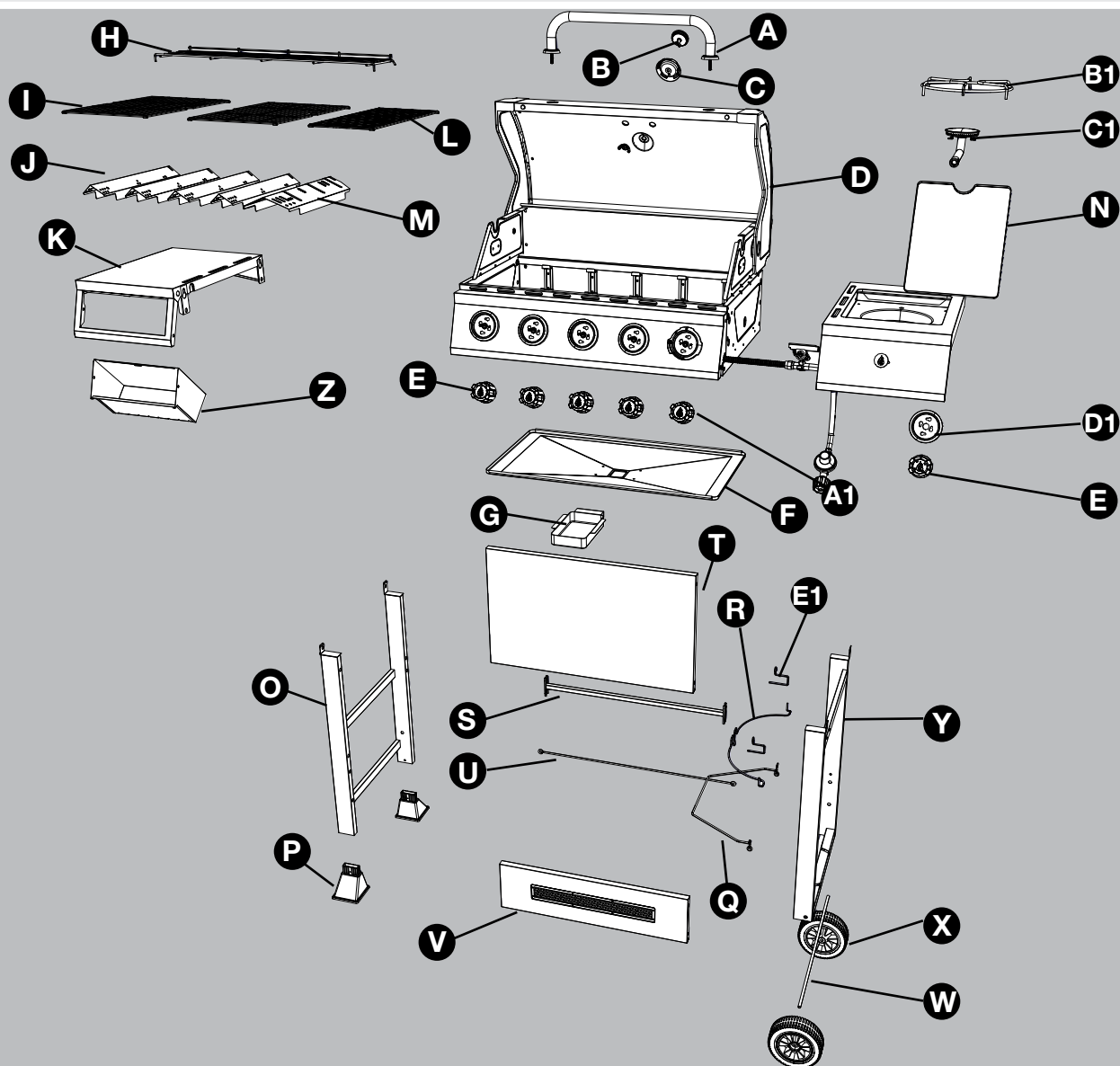

PART	DESCRIPTION	QTY.
A	Hood Handle	1
B	Temperature Gauge	1
C	Temperature Gauge Bezel	1
D	Grill Body Assembly	1
E	Control Knob	5
F	Grease Pan	1
G	Grease Cup	1
H	Warming Rack	1
I	Cooking Grate For Main Burner	2
J	Heat Tent For Main Burner	4
K	Left Side Table	1
L	Cooking Grate For Sear Burner	1
M	Heat Tent For Sear Burner	1
N	Right Side Burner Body	1
O	Left Leg Assembly	1

PART	DESCRIPTION	QTY.
P	Leg End Cap	2
Q	Side Exclusion Bar	1
R	Tank Brace	1
S	Cart Rear Support	1
T	Cart Front Panel - Upper	1
U	Cylinder Exclusion	1
V	Cart Front Panel - Lower	1
W	Axle	1
X	Wheel	2
Y	Right Leg Assembly	1
Z	Condiment Tray	1
A1	Control Knob for Sear Burner	1
B1	Side Burner Grate	1
C1	Side Burner	1
D1	Side Burner Control Knob Bezel	1
E1	Tank Retention Fixed Wire	2

Hardware Contents

AA

2X



BB

2X

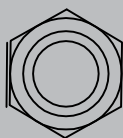

M10 Nut

CC

2X



M10
Wrench

DD

32X

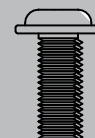

M6x16
Screw

EE

2X

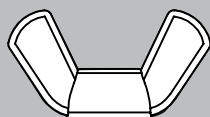

M6 Wing
Nut

FF

2X



M6 Spring
Washer

GG

2X

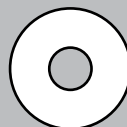

M6 Plain
Washer

HH

4X



M4x10
Screw

Preparation

Before beginning assembly of product, make sure all parts are present. Compare parts with package contents list on previous page and hardware contents above. If any part is missing or damaged, do not attempt to assemble the product. Contact customer service for replacement parts.

Estimated Assembly Time: 50 minutes with 2 people.

CAUTION

THIS UNIT IS HEAVY. Two people required for safe assembly.

Two people required for safe assembly. Some parts may contain sharp edges. Wear protective gloves if necessary. Read and follow all safety statements, warnings, assembly instructions and use and care instructions before attempting to assemble and use.

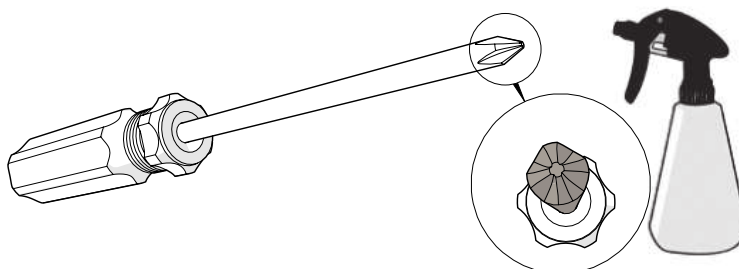

Tools Required for Assembly and Leak Testing (not included): Phillips screwdriver, Spray bottle

Assembly Instructions

1 Assembly – Left Leg

AA

2X

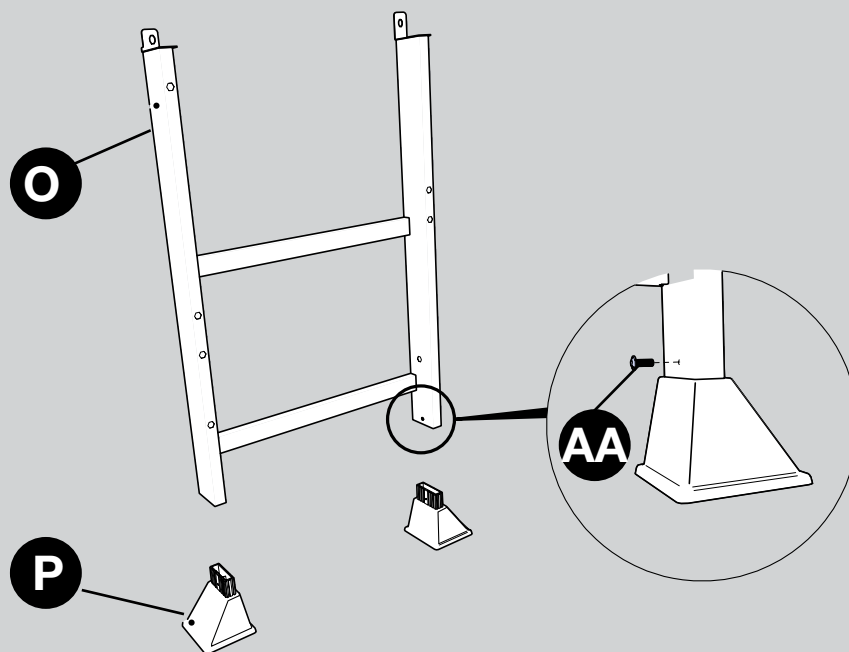

2 Assembly – Right Leg

BB

2X

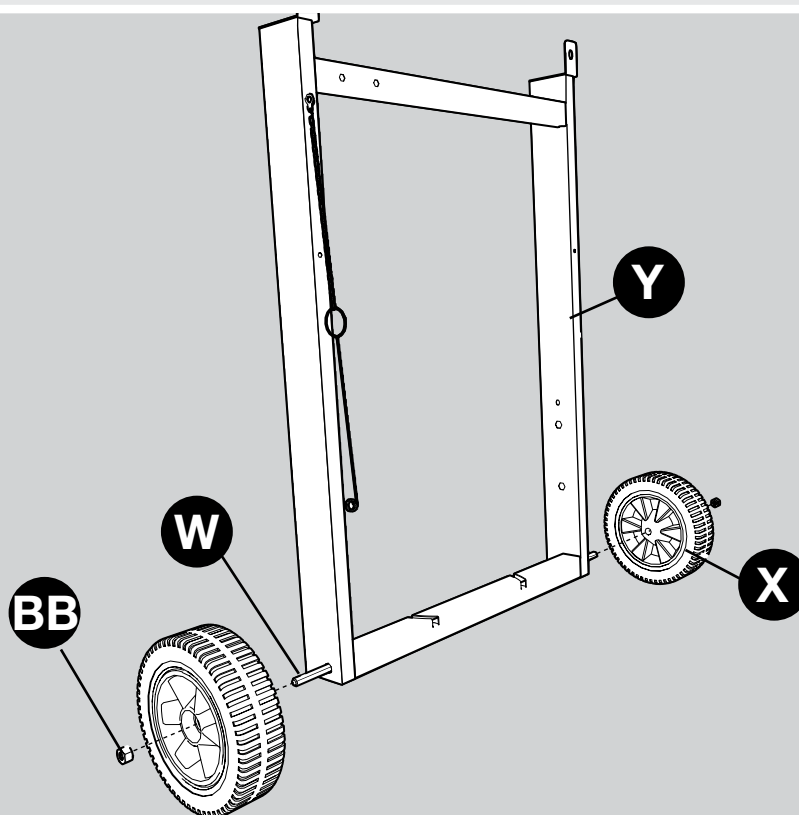

3

Assembly – Cart Front Panels

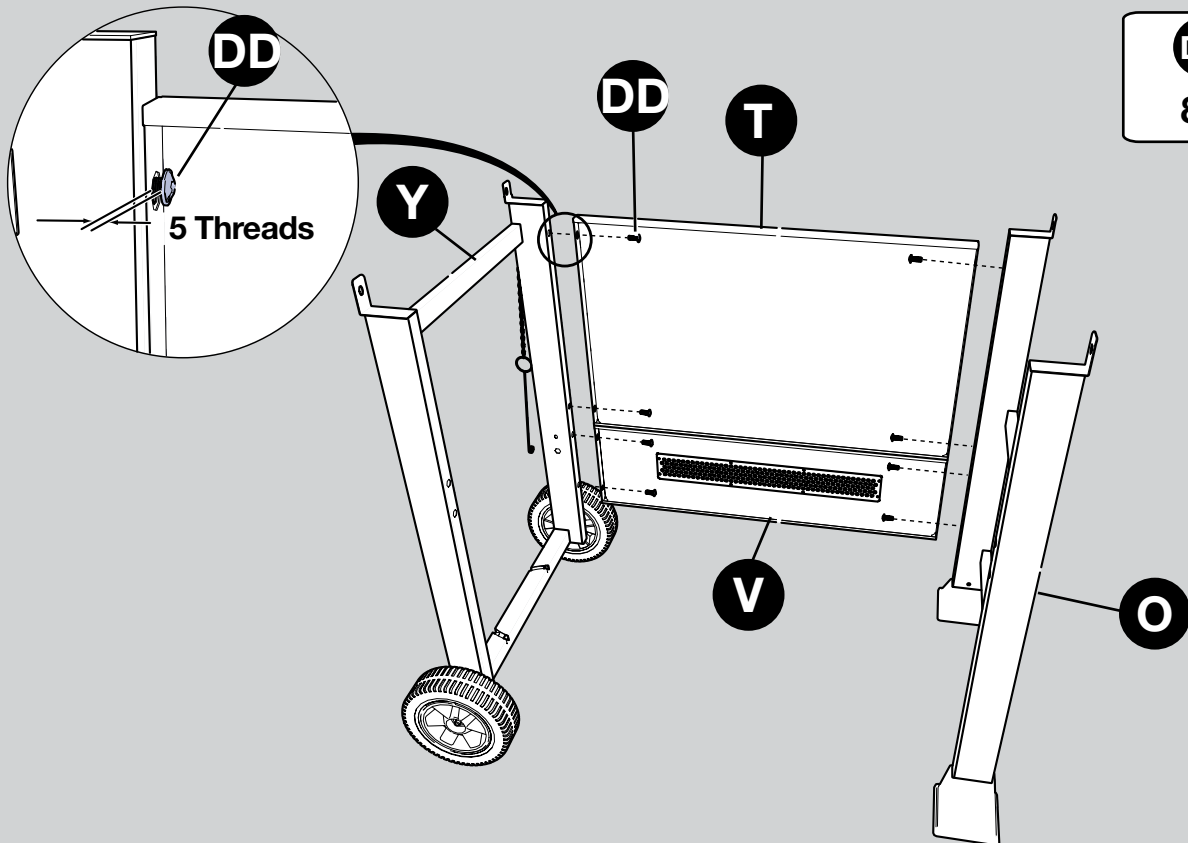

4

Assembly – Back Exclusion Bar and Cart Rear Support

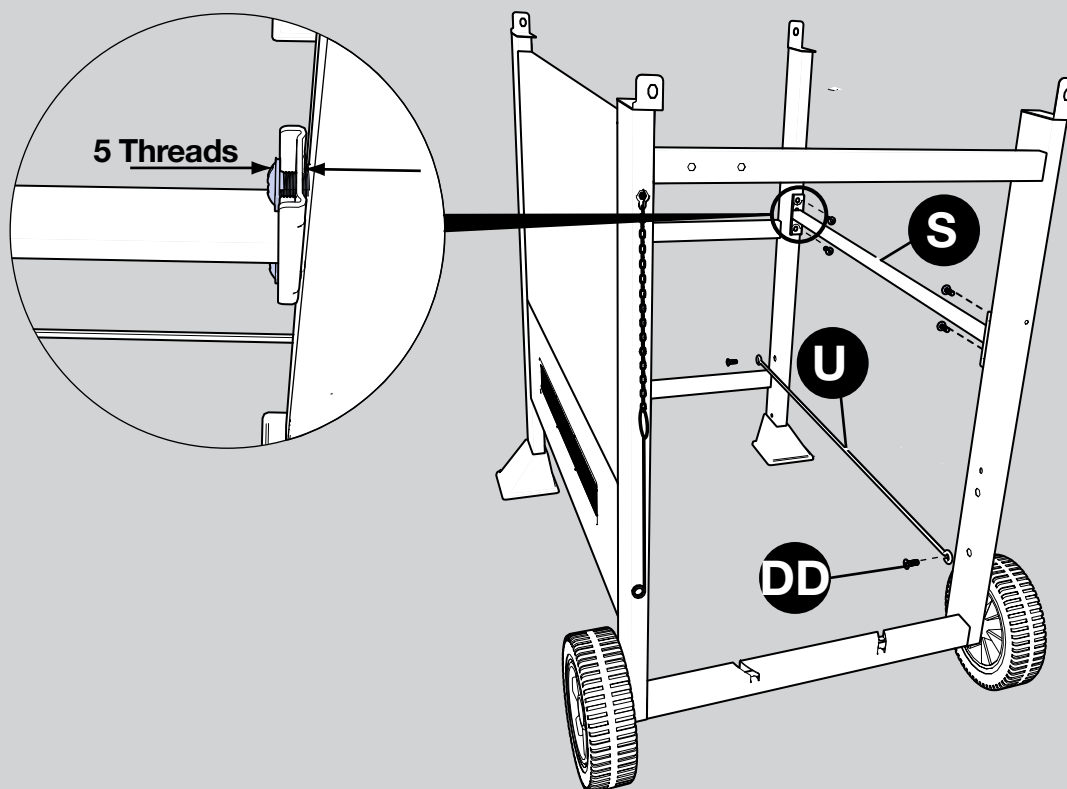

5

Assembly – Tank Brace and Side Exclusion Bar

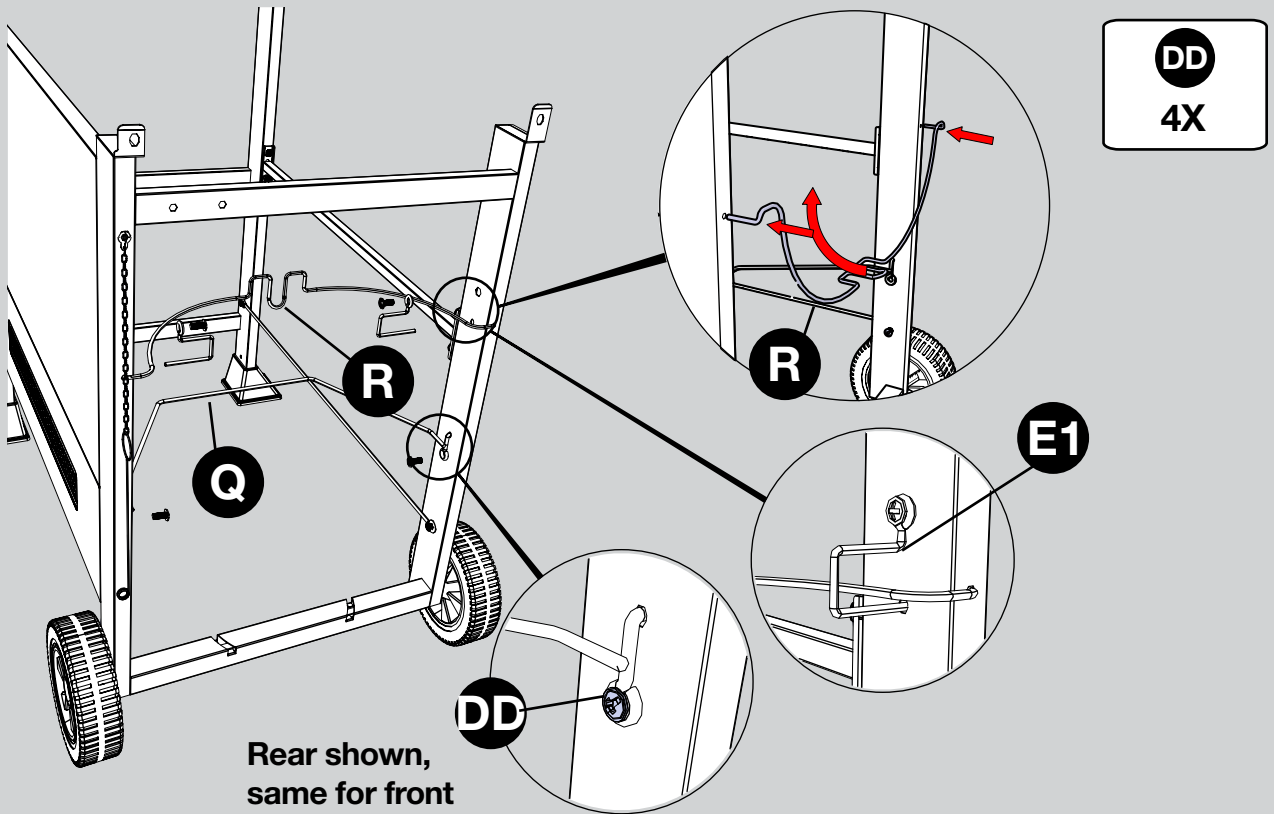

6

Assembly – Handle, Knobs, and Temperature Gauge

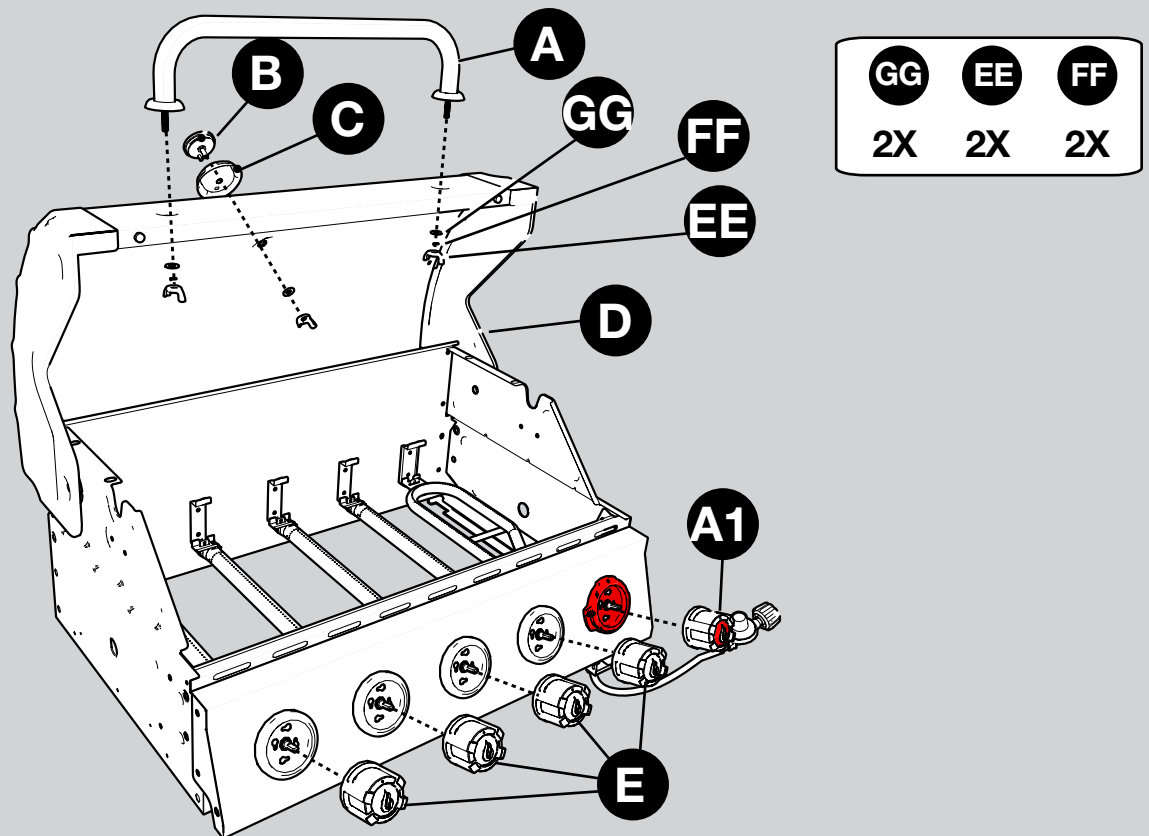



CAUTION:
2 people required
for safe assembly.

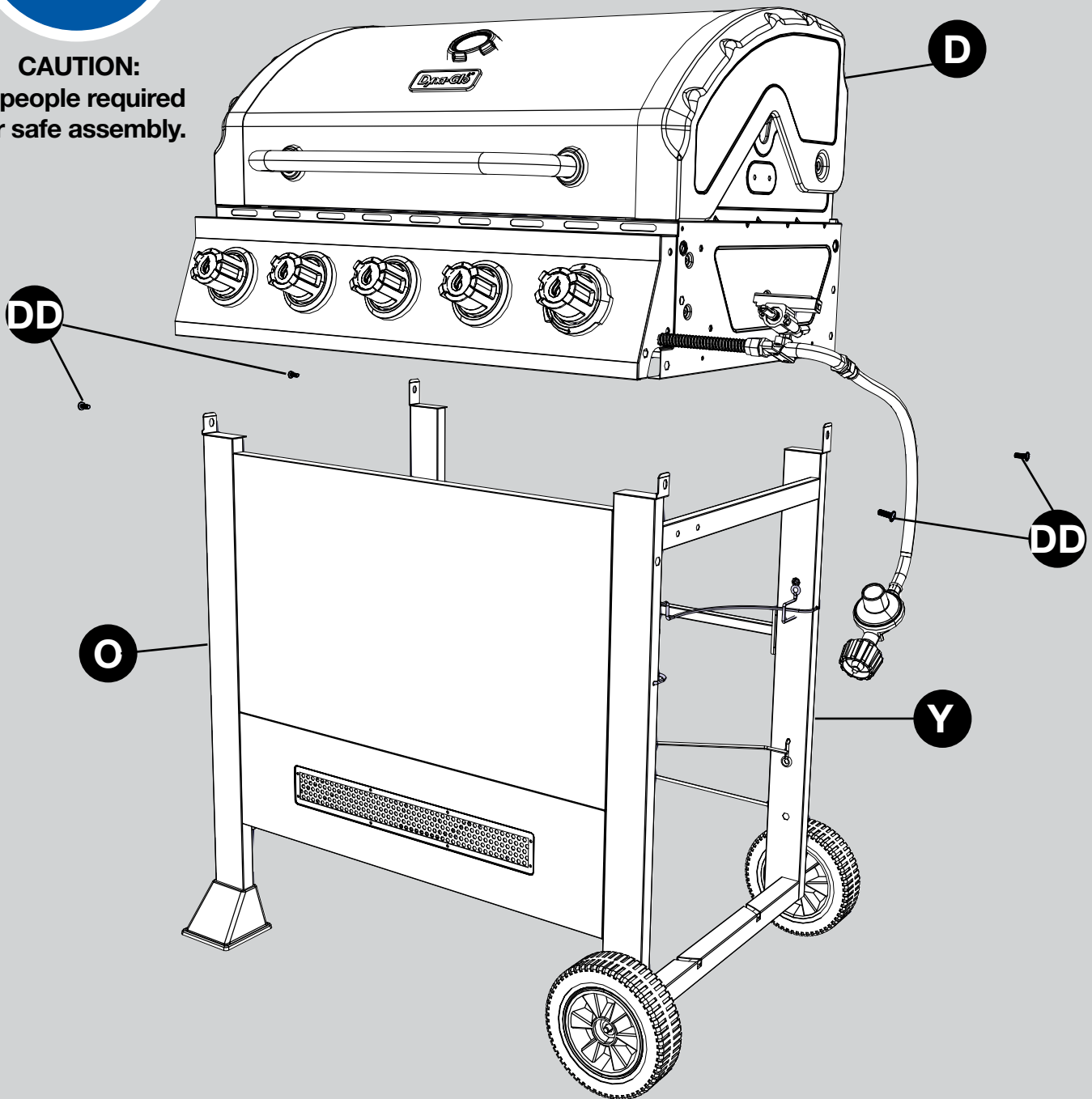
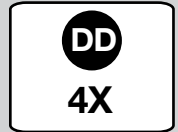

NOTE: Fully tighten all nuts from front panel and back brace screws at this time.

A

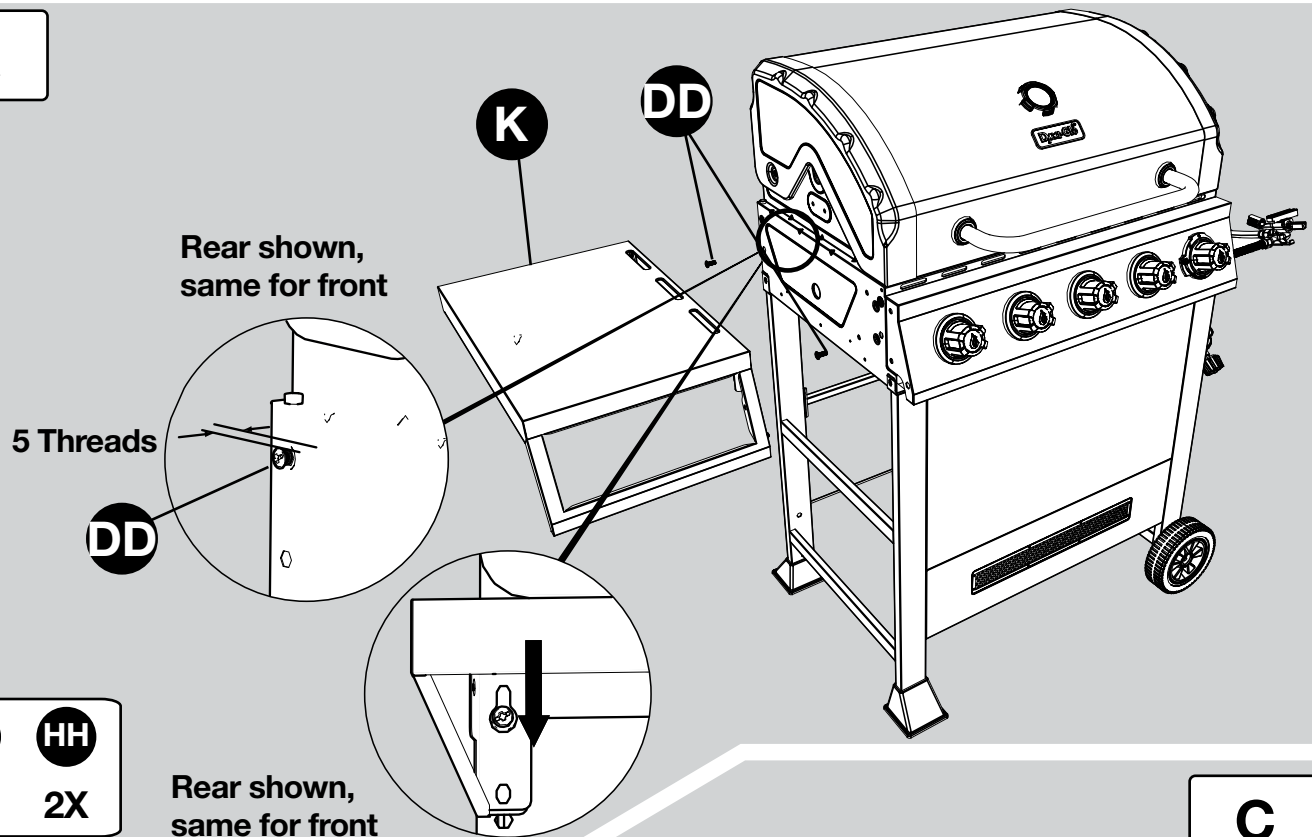

B

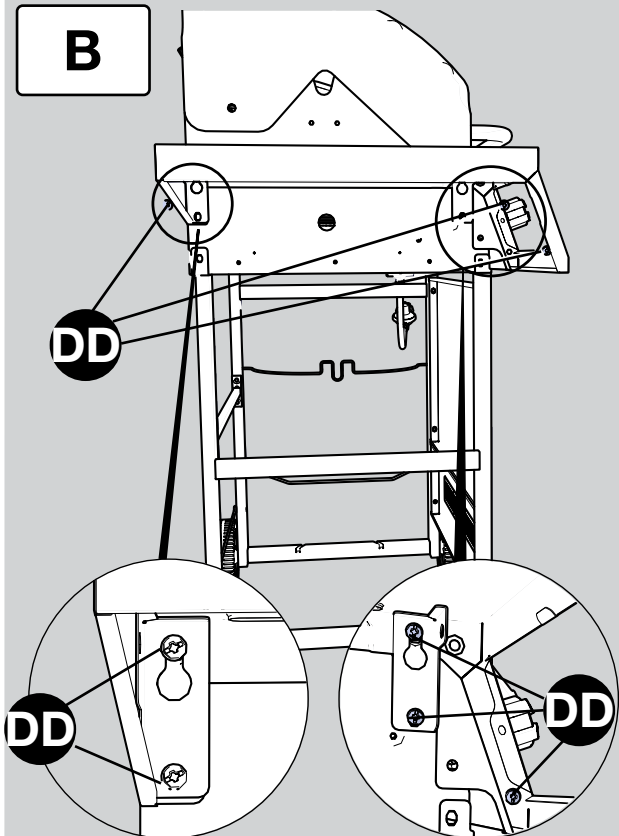

C

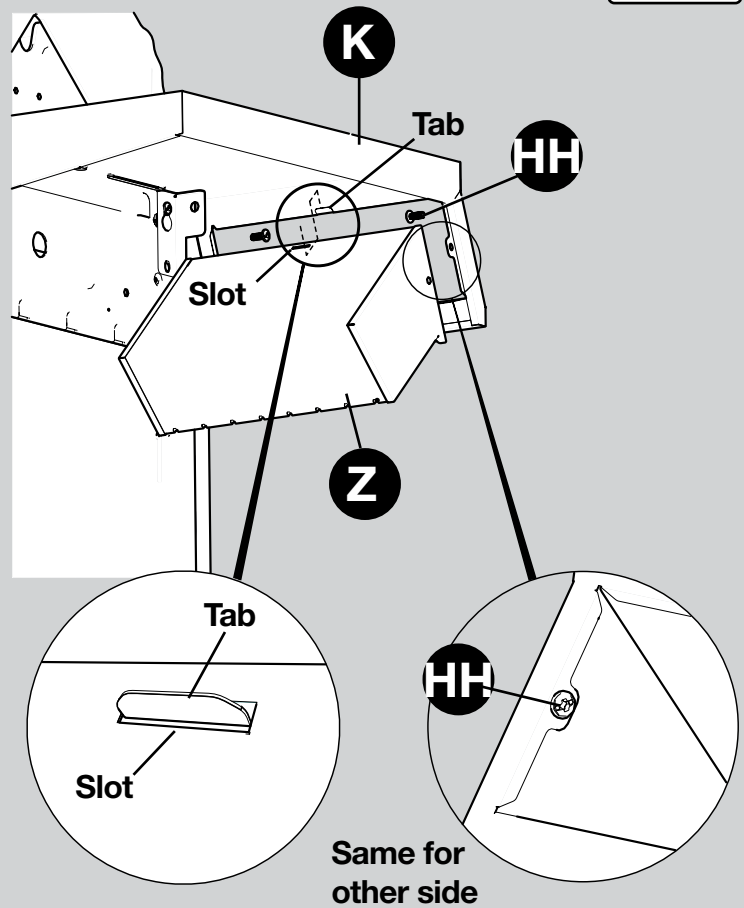

A

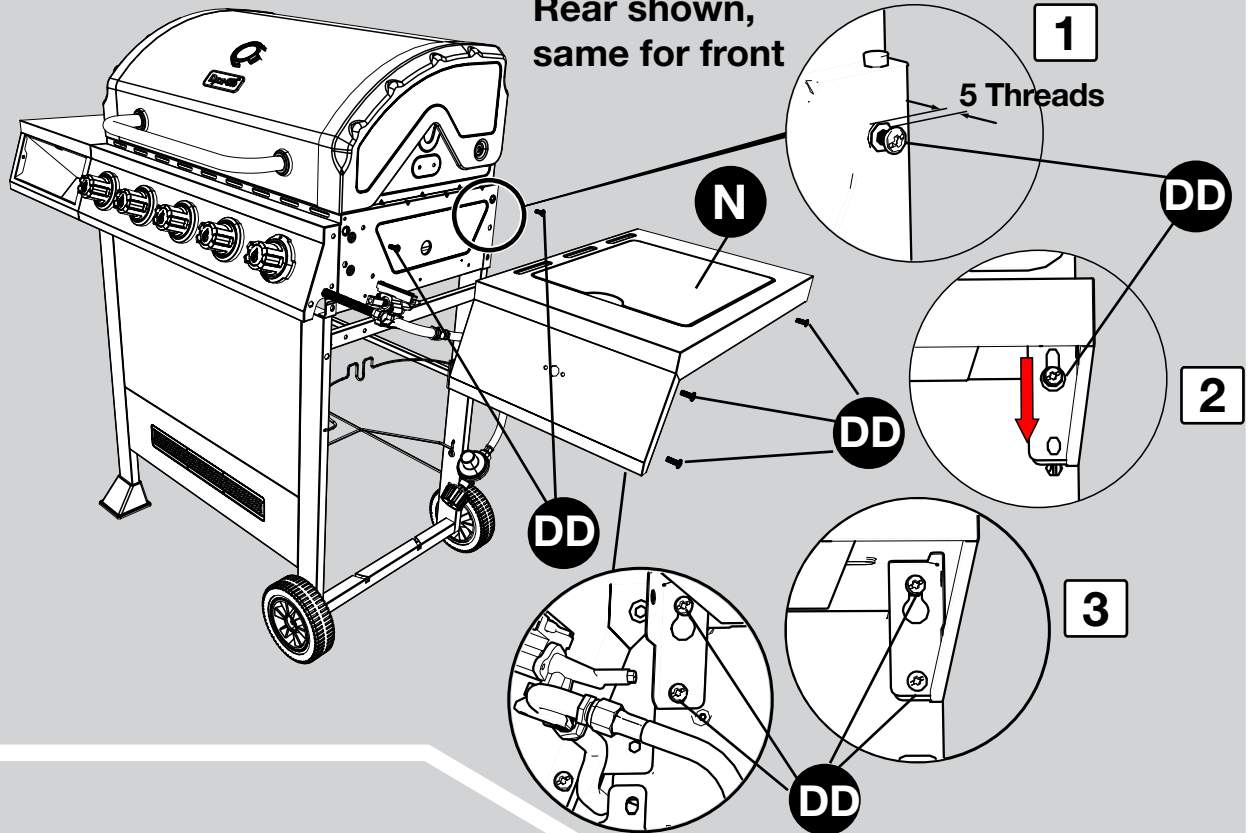

B

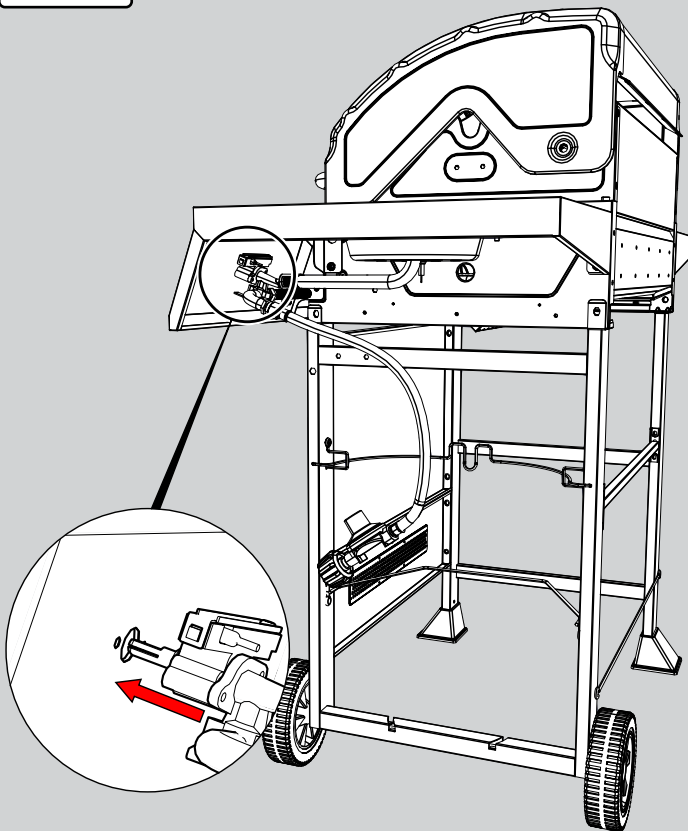

C

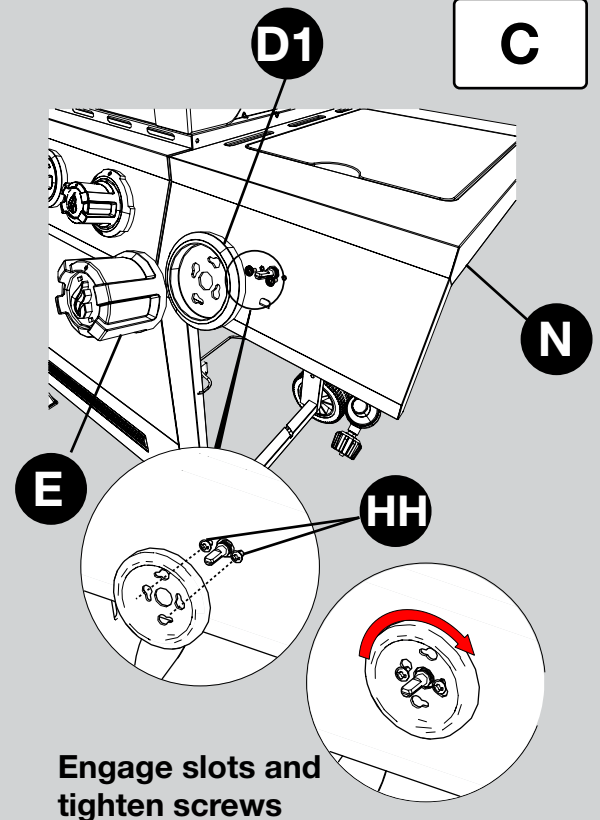

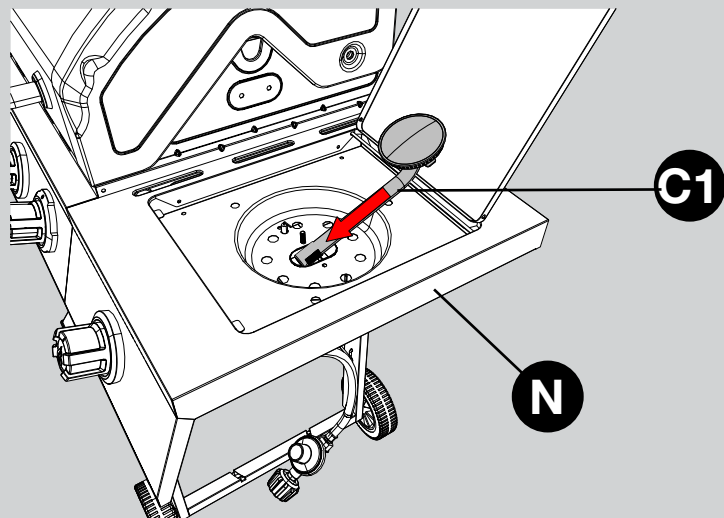
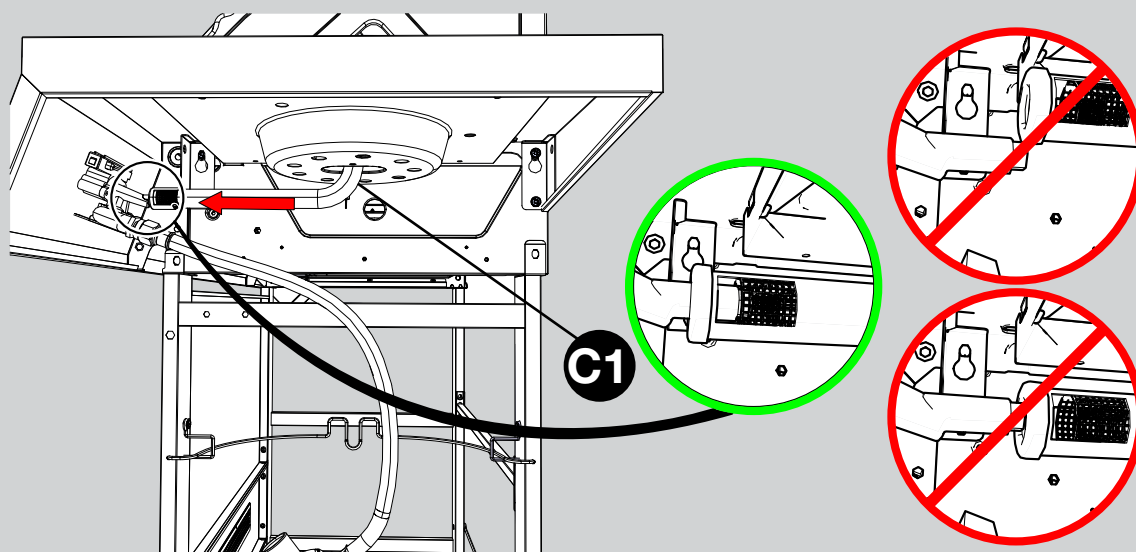
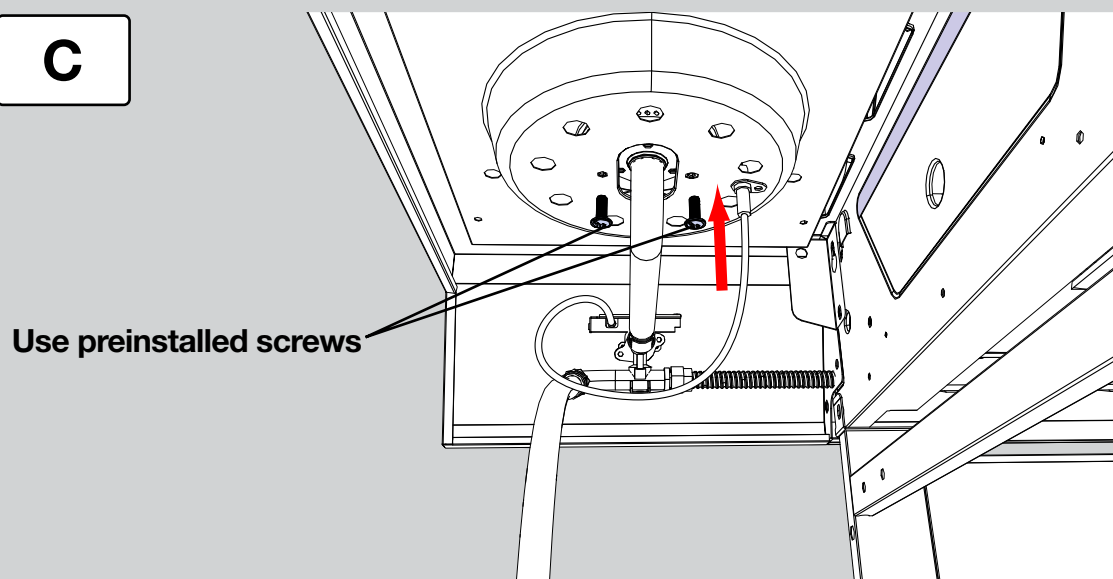
A**B****C**

11

Assembly – Heat Tents

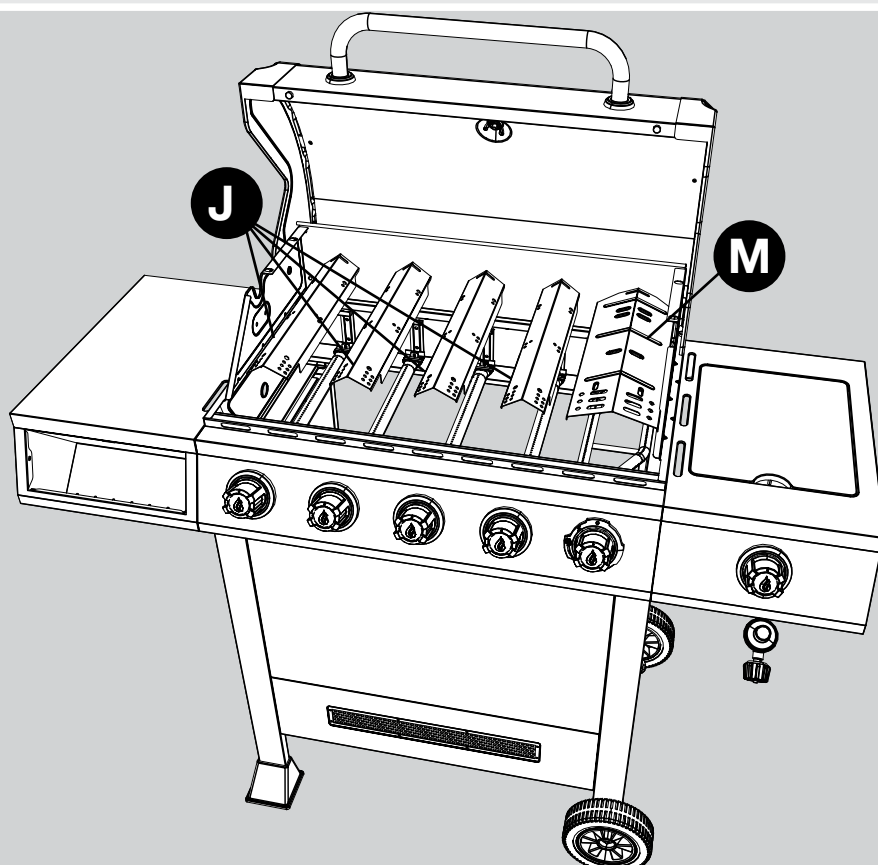
**12**

Assembly – Rack and Cooking Grates

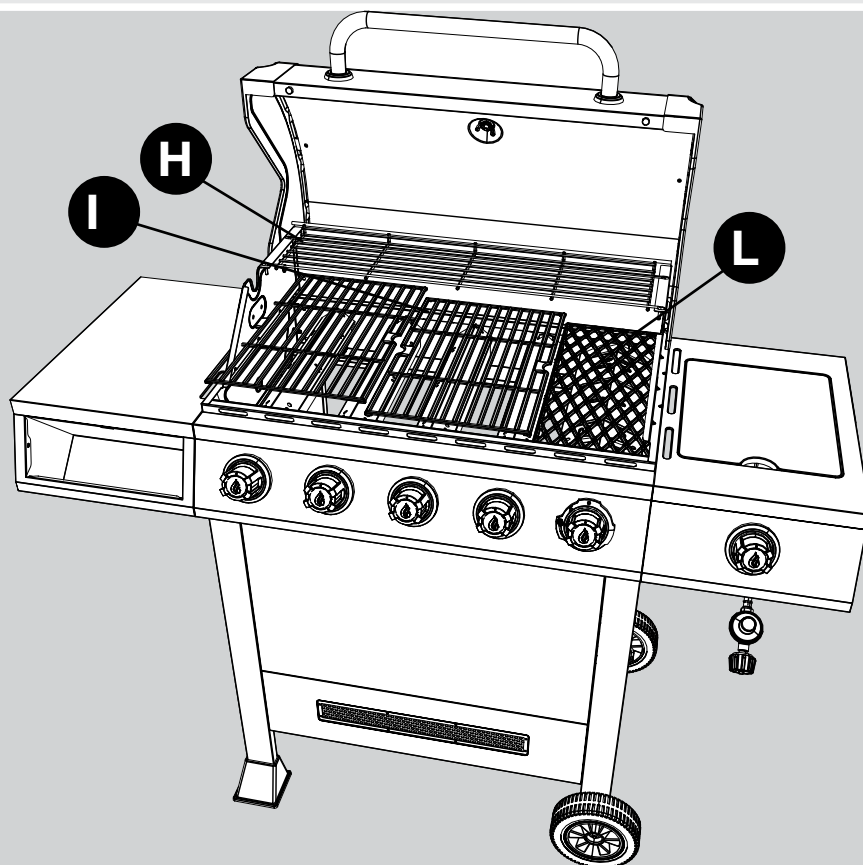

13 Assembly – Side Burner Grate

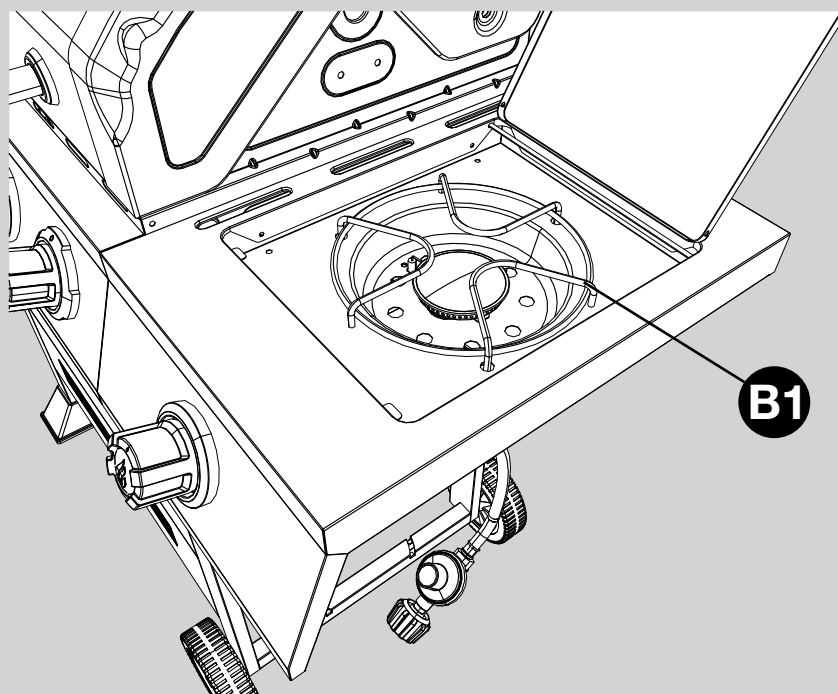

14 Assembly – Grease Pan and Grease Cup

