

This Owner's Manual is provided and hosted by [Appliance Factory Parts](#).



Landmann 12736 Owner's Manual

[Shop genuine replacement parts for Landmann 12736](#)



[Find Your Landmann Grill Parts - Select From 200 Models](#)

----- Manual continues below -----



"Gas barbecue kitchen"

Assembly and operating manual



Please read before starting!

Failure to observe these instructions can affect or damage the device and other objects and lead to personal injury.

We therefore recommend that you read the relevant chapter of these instructions prior to assembly and before each use. Follow the steps in the order they are specified and please observe the safety warnings.

These instructions form part of the product. They should therefore always be stored with the product and passed on to each subsequent user.

12736

Table of contents

Technical specifications	3
Delivery specifications.....	4
Exploded View.....	5
Controls.....	6
Utilisation	7
Warranty and disclaimer	7
Safety instructions	8
Definition of terms used	8
Danger "Hot surfaces and parts"	9
Danger "Gas is highly flammable"	10
Danger "Gas displaces oxygen"	11
Assembly	12
Assembly procedure.....	13
Connecting and disconnecting the gas cylinder	21
Connecting the Gas Cylinder	21
Operation	23
Starting up the burner.....	23
Starting up the sideburner	24
Switching off the barbecue.....	24
Cleaning.....	25
Grill	25
Gas system	25
Maintenance	26
Environmental information and disposal measures	26
Troubleshooting	27
Instructions for using liquid gas cylinders	28
Declaration of conformity	29

Technical specifications

Approvals

ITS	Test number C€ - 0359, Pin/no. 359CL1126
-----	--

Barbecue

Appliance category	I ₃ + according to DIN EN 498
Total weight	approx. 29 kg
Dimensions (L x H x W)	approx. 1260 x 1055 x 530 mm
Grilling surface (L x W)	2 x approx. 400 x 275 mm

Gas system

Heat output	3x 3,2 kW + 1x 3,2 kW (total heat Input 12,8kW)
Mass flow rate	3x 228,5 g/h + 1x 228,5 g/h = 914 g/h
Gas type	Liquid gas (propane/butane)
Gas cylinder	Standard gas cylinder with a fill weight of 7 or 11 kg
Gas pressure	28-30 mbar at butane, 37 mbar at propane
Gas hose	C€-approved hose (max 1.5 m)
Ignition	Piezo ignition
Flame regulator	infinitely adjustable 0 - max.
Nozzle diameter	0,85 mm, side burner 0,85 mm

Delivery specifications

Pos.*	Qty.	Description	Pos.*	Qty.	Description
1	1	Grill unit (pre-assembled)	16	1	Door bracket
2	1	Side shelf	17	1	Knob
3	2	Car bracket	18	1	Knob base
4	1	Trolley back-side panel	19	1	Side burner shelf
5	1	Cart bottom panel	20	1	Igniter wire
5a	1	Magnet	21	1	Side burner
6	2	Trolley side panel	22	1	Side burner rack
7	1	Right back leg	23	2	Cooking grid
8	1	Right front leg	24	3	Flame tamer
9	1	Right door	25	1	Grease tray
10	2	Door handle	27	2	Wheel cap
11	1	Left Door	A	44	Bolt M6x10
12	2	Wheel	C	6	Bolt M4x10
13	2	Wheel axle	D	2	Bolt M3x10
14	1	Left front leg	E	2	Nut M3
15	1	Left back leg	B	2	Clip

Exploded View

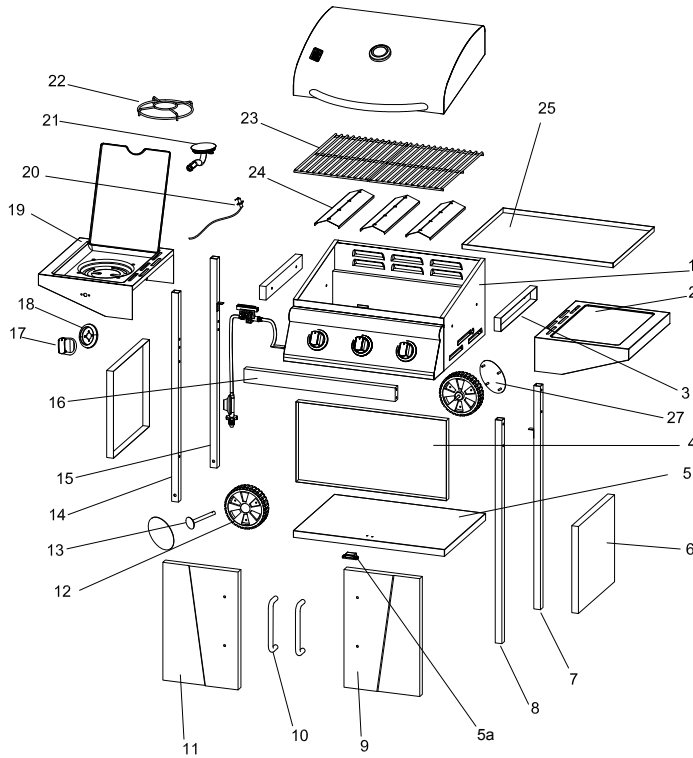

12736

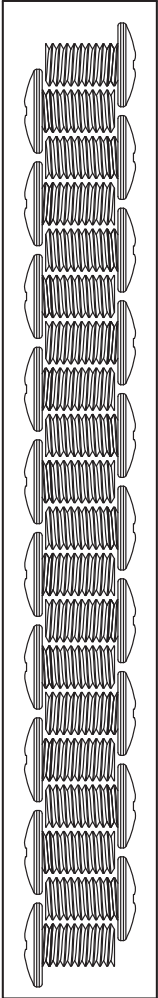
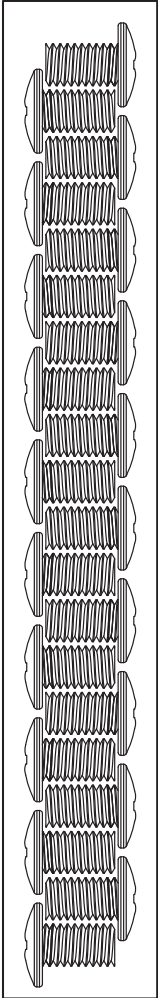

A M6x10 44pcs

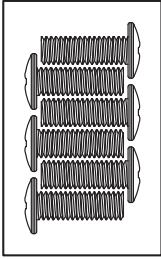
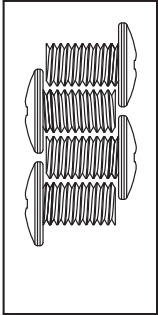

C M4x10 6pcs

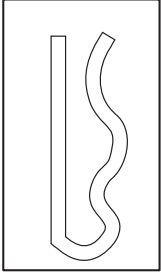

B Clip 2pcs

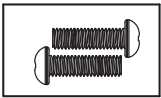

D M3x10 2pcs

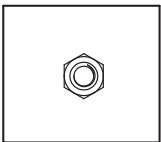

E M3 Nut 2pcs

Controls

Pos.	Designation		Function
B	Flame regulator	middle	Fill burner with gas to ignite (keep depressed and turn to „large flame“ setting). After igniting set the heat output for the centre burner (turn).
		left	Fill burner with gas to ignite (keep depressed and turn to „large flame“ setting). After ignition adjust the heat input for the left burner (turn).
		right	Ignite the right burner (keep depressed briefly and turn to "large flame" setting). After ignition adjust the heat supply for the right burner (turn).
1	Pressure reducer		Reduce gas pressure.
2	Gas cylinder for bottle valve		Fuel container
3	Rubber hose		Directs gas to burner
4	Proper hose clip		Fuel container
5	Regulator handle		Cut-off safety device with 2 settings: „-“ setting: Gas off / shut off gas cylinder „flame“: Gas is on.

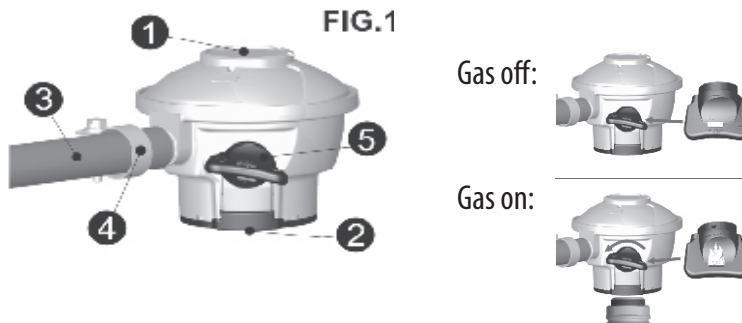

Utilisation

Intended use

This is a gas barbecue intended for outdoor use only. It is designed to be used exclusively in accordance with these instructions for preparing food that is suitable for barbecuing and these instructions must be observed at all times.

Only for private use!

Improper use

Any other application or applications extending beyond the stated purpose are not authorised. This applies to the following types of misuse in particular:

- **Do not operate the barbecue with coal or fuel other than liquid gas (propane/butane).**
- **Do not operate the barbecue as a stove with pots and pans.**
- **Do not operate the barbecue as a heater.**

Do not use the barbecue to heat materials and substances other than food that is suitable for barbecuing.

Warranty and disclaimer

The barbecue has been manufactured according to the general engineering rules - valid at the time manufacturing was started - and the requirements of the CE - sign. It is certified and approved by ITS (test number CE-0359). The barbecue left the factory in perfect condition regarding its function and safety.

This barbecue is covered by our warranty for a period of two years from the date of purchase. This warranty covers manufacturing defects and faulty parts as well as the replacement of these parts. The cost of freight, assembly, replacement of worn parts, and other such costs are not covered by this warranty.

The warranty shall expire and any responsibility shall pass over to the executor:



- if the barbecue is not used properly.
- if the barbecue is used despite visible damage or if it is not completely assembled.
- if any technical alterations have been made to the barbecue.
- if accessories are used that are not expressly authorised for this barbecue (if in doubt please contact our customer service department).
- if original spare parts from LANDMANN GmbH & Co. Handels-KG are not used.

Safety instructions

Definition of terms used

The following pictograms and signal words are used in these instructions to point out hazards and important information.

Safety instructions

Pictogram and signal word	Note on ...
 Danger	... a possible danger that can result in severe personal injury or damage to property if the stated measures are not observed.
 Caution	... a possible danger that can result in damage to property if the specified measures are not observed.

Operating notes

Pictogram	Note on ...
	... a useful function or tip.



Danger "Hot surfaces and parts"

During operation some accessible parts of the barbecue can become very hot, particularly those that are close to the fire bowl.

Possible consequences:

- Severe burns from touching parts near the fire bowl.
- Fire or smouldering fire if flammable materials or substances are near the barbecue.

Safety measures prior to using the barbecue:

- When setting up the barbecue, make sure that
 - there are not, and will not be, any flammable materials or substances nearby. Minimum distance to flammable materials or substances: 2 m above and 1 m to the side. Distance to highly flammable materials or substances, e.g. walls: min. 0.25 m.
 - the barbecue is positioned firmly on a sufficiently large surface area. It must not be moved during operation.

Safety measures while barbecuing:

- Wear protective barbecue gloves.
- Never leave the barbecue unattended. Take particular care to ensure that children and pets are kept away from the barbecue.



Danger "Gas is highly flammable"

Liquid gas is highly flammable and explosive.

Possible consequences:

- Serious personal injury or damage to property if escaping gas ignites in an environment in which it is not controlled.

Safety measures:

- Only use the barbecue outdoors and ensure that the area is well-ventilated.
- Protect the gas cylinder and the gas hose from direct sunlight and other sources of heat above 50 K. Take particular care to ensure that the gas hose does not touch any part of the hot barbecue.
- **Do not place the gas cylinder on the lower shelf, as it is too near the burner.**
- Do not lean over the barbecue when igniting the gas flame.
- Close the valve on the gas cylinder immediately after each use (turn the valve clockwise).
- Never leave the barbecue unattended. If the flame extinguishes, relight immediately or cut off the supply from the gas cylinder.
- When connecting the gas cylinder make sure that there are no sources of ignition within a 5 m radius.

Take special care not to light any naked flames, do not smoke or switch on electric appliances (devices, lights, door bells), etc. (sparkover possible).

- Before each use, make sure that all gas connections are sealed and intact.

If necessary, replace the hose in order to comply with the corresponding national requirements.

The barbecue must not be used if the connections for the gas supply are porous or faulty. This also applies, for example, to hoses or fittings blocked by insects, as this can produce a dangerous flashback.

- Ensure the position of the connection flexible tube is not subject to twisting.
- Do not move the appliance during use.
- Turn off the gas supply at the container after use
- Any modification of the appliance may be dangerous



Danger "Gas displaces oxygen"

Liquid gas is heavier than oxygen. Therefore it settles on the ground and displaces the oxygen at that level.

Possible consequences:

- Suffocation resulting from a lack of oxygen if the gas concentration is allowed to rise sufficiently.

Safety measures:

- Only use the barbecue outdoors in a well ventilated area and above ground (i.e. not in areas that are below ground level).
- Close the valve on the gas cylinder after each use.
- Never leave the barbecue unattended. If the flame extinguishes, relight immediately or cut off the supply from the gas cylinder.
- Before each use, make sure that all gas connections are sealed and intact.

If necessary, replace the hose in order to comply with the corresponding national requirements.

The barbecue must not be used if the connections for the gas supply are porous or faulty.

- If the barbecue is not being used for a prolonged period, cut off the supply from the gas cylinder and store properly:
 - Fit the gas cylinder valve with a cap nut and safety cap.
 - Do not store the gas cylinder in rooms below ground level, in or near stairways, hallways or passages and thoroughfares between buildings.
 - Always store gas cylinders upright, even if they are empty.
- The parts sealed by the manufacturer or his agent must not be altered by the user

Assembly

Before starting

Here are a few tips to help you assemble your barbecue quickly and successfully:

- Check that no parts are missing by placing all of the individual parts on an empty surface (we reserve the right to make minor technical alterations, such as the content of the small parts bag).

If, despite careful factory checks, a component is missing, please contact our customer service department (see the last page). We will immediately attend to your request.

- Sort out the small parts, as some of the screws and bolts, for example, are very similar and can be easily confused.
- For assembly you will need a medium size screwdriver and a suitable spanner (flat spanner or box spanner).

You will need a flat spanner (AF17) to connect the gas cylinder.

Only use tools that are intact and suitable for the job at hand. Worn or unsuitable tools will not allow you to tighten the bolts sufficiently, but will damage them to the extent that they can no longer be turned.

- Always fit all connecting elements (screws, bolts, nuts, etc.) as shown in the following illustrations. If you misplace a connecting element, replace this with an appropriate part. Only by doing this can you ensure that the construction is strong and safe.
- It is essential that you follow the instructions in the order they are specified!
- *Read the text for each step before carrying it out, as useful information is sometimes only provided at the end of the section.*

Assembly procedure

Assembly step 1

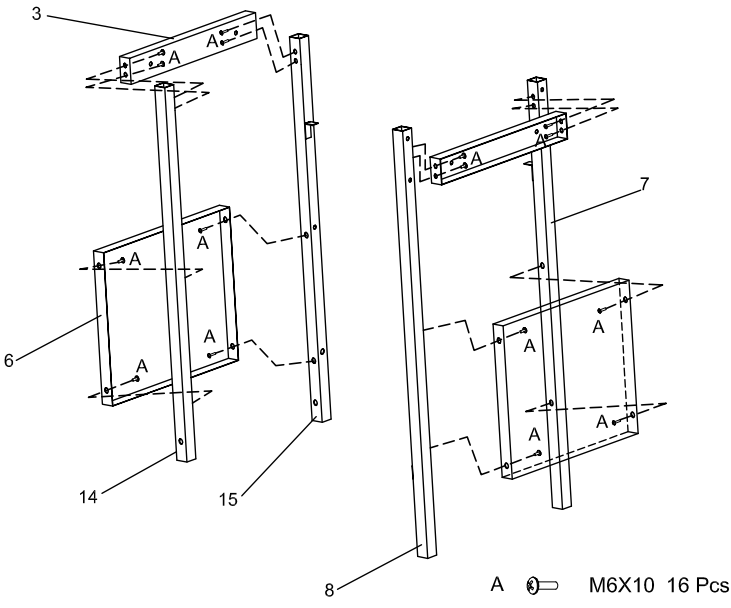

Assembly step 2

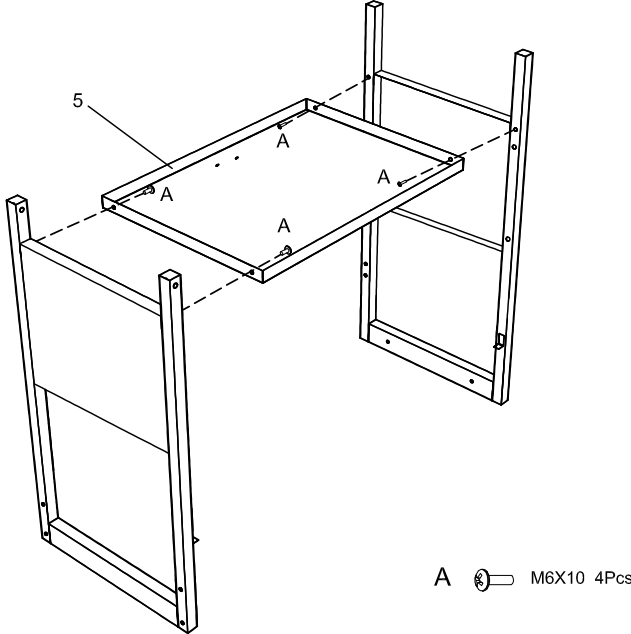

Assembly step 3

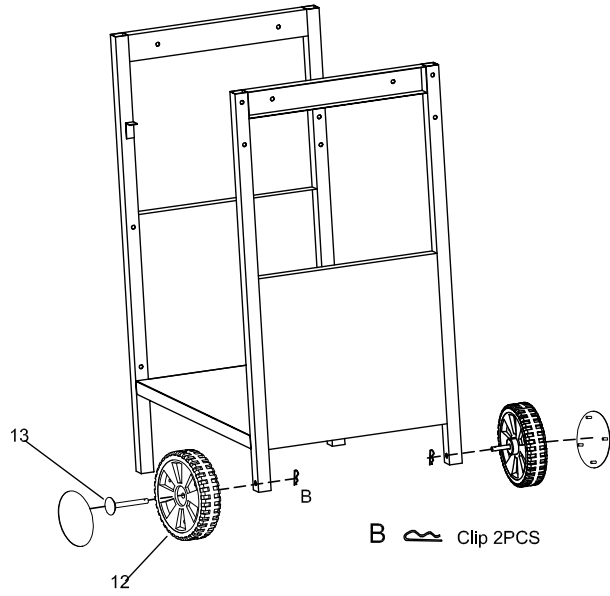

Assembly step 4

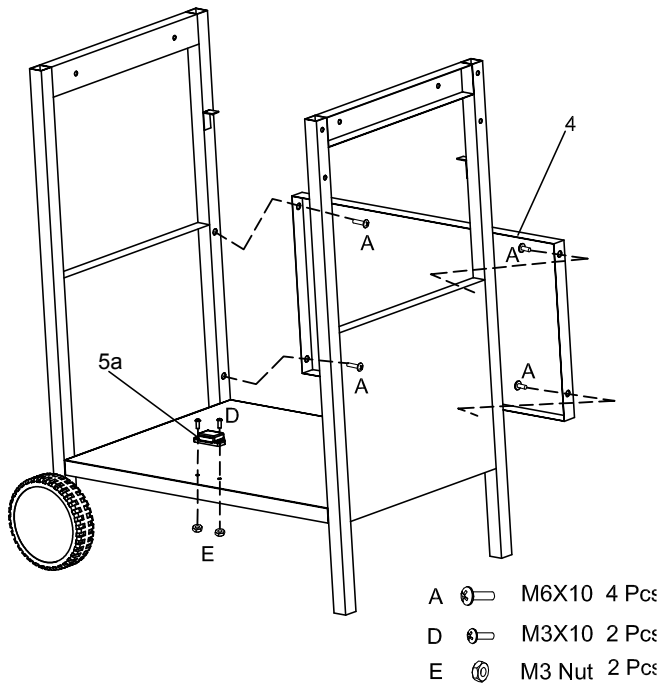

Assembly step 5

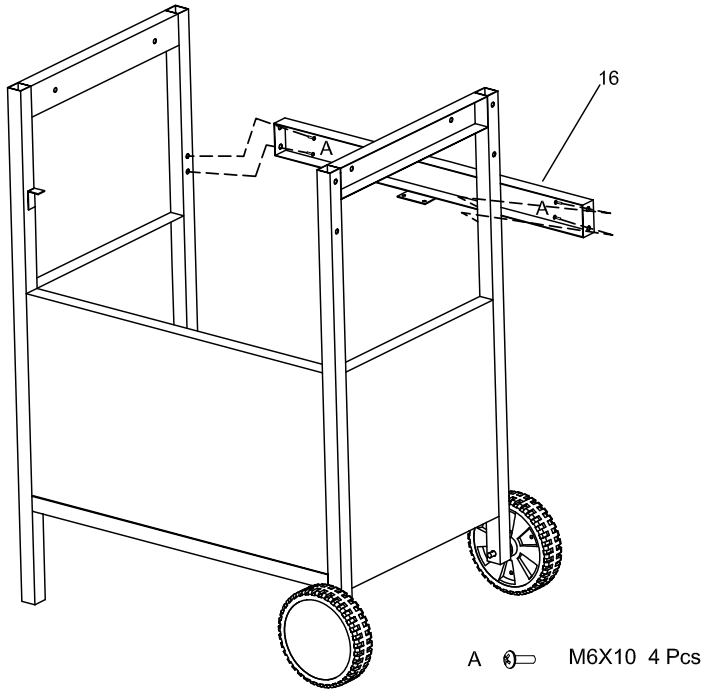

Assembly step 6

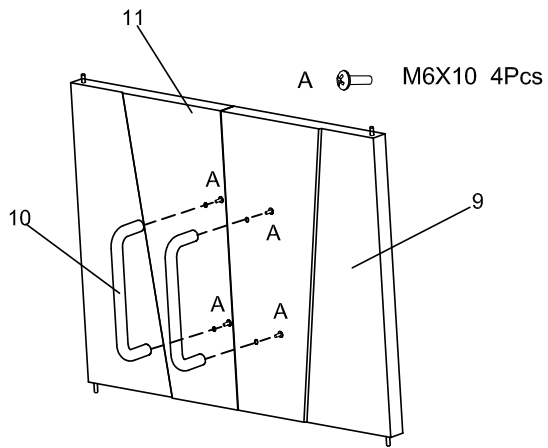

Assembly step 7

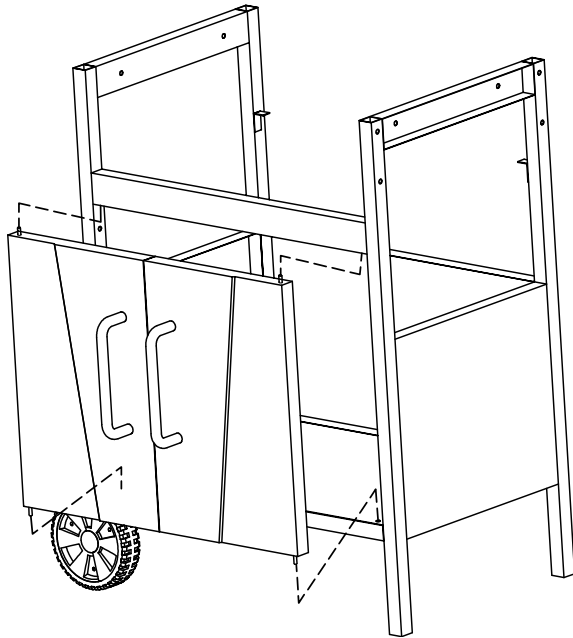

Assembly step 8

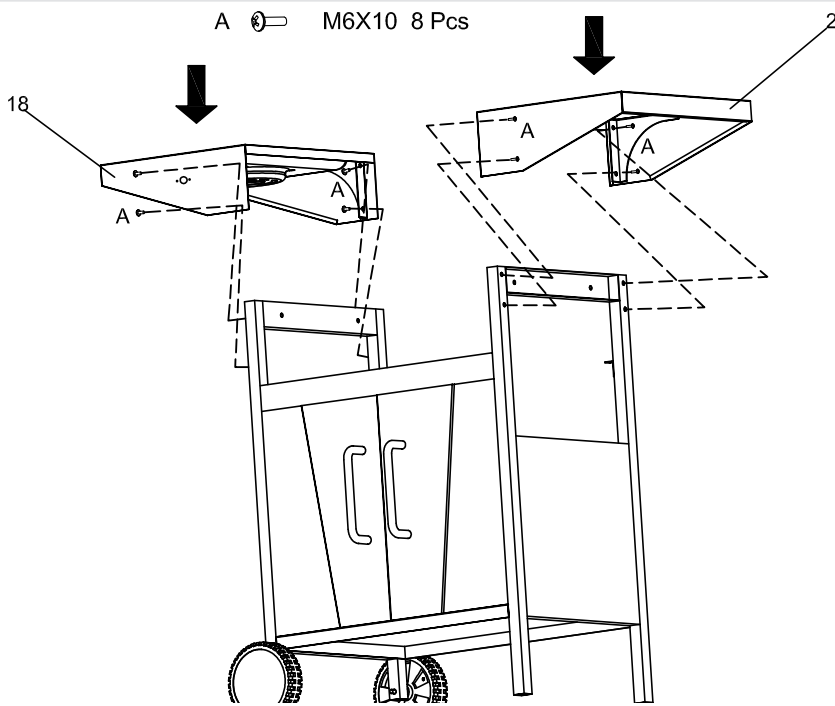

Assembly step 9

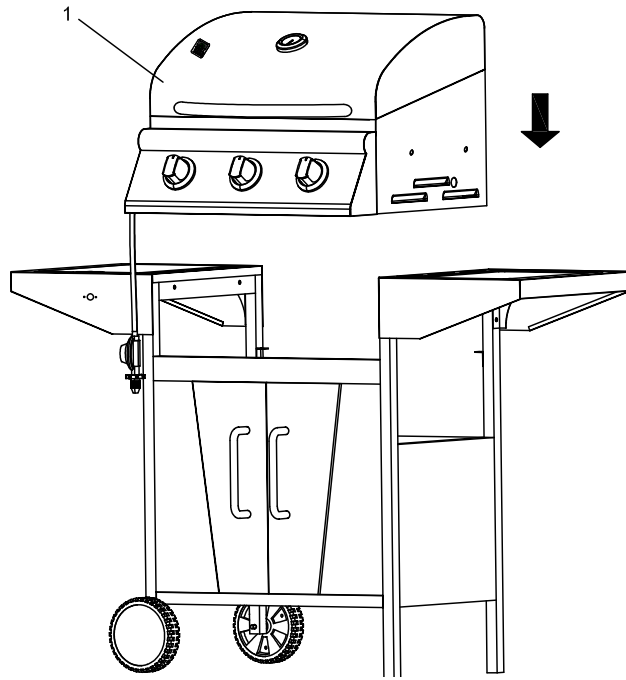

Assembly step 10

A  M6X10 4 Pcs

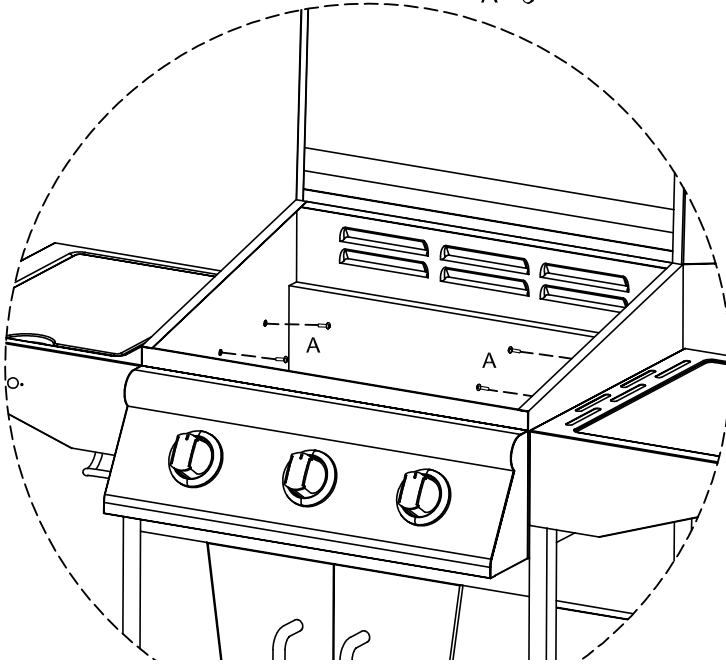

Assembly step 11

C  M4X10 2 Pcs

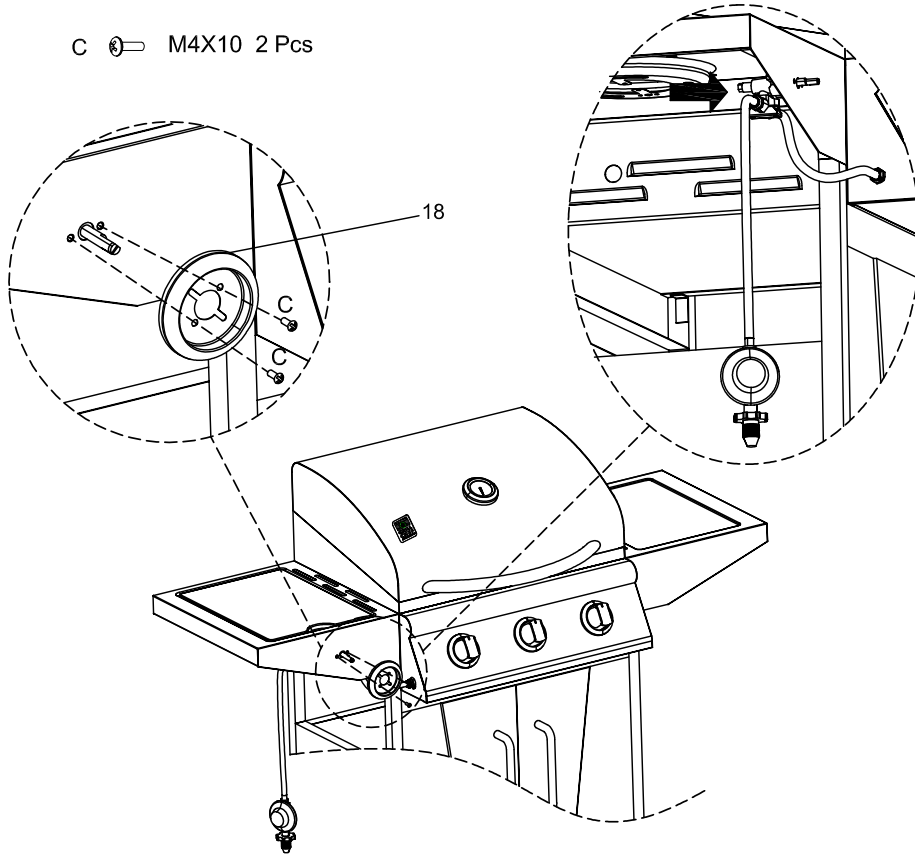

Assembly step 12

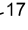
17 

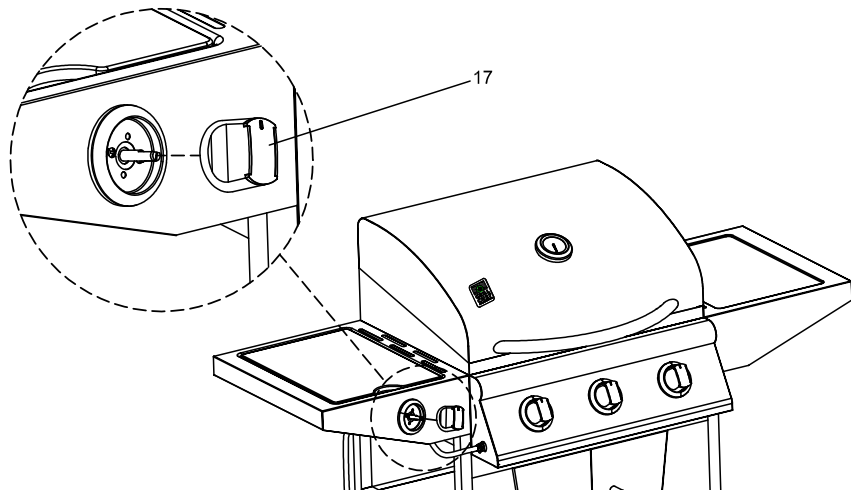

Assembly step 13

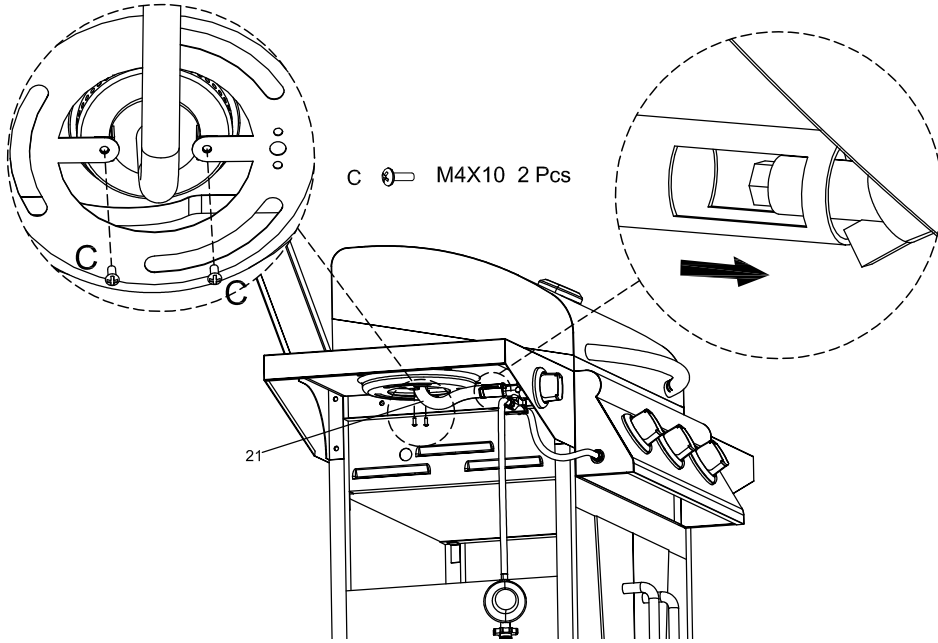

Assembly step 14

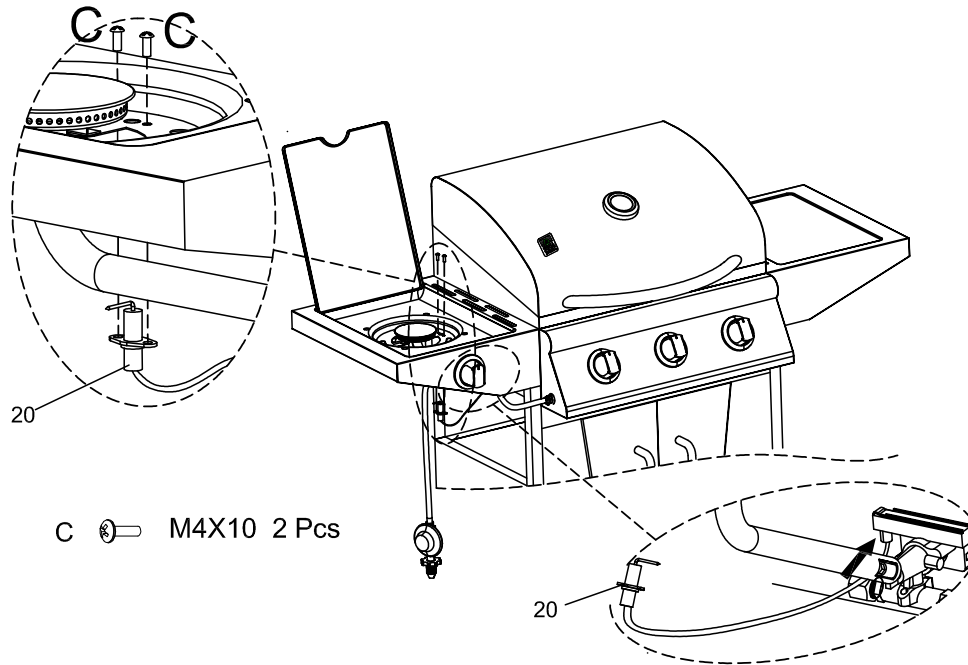

Assembly step 15

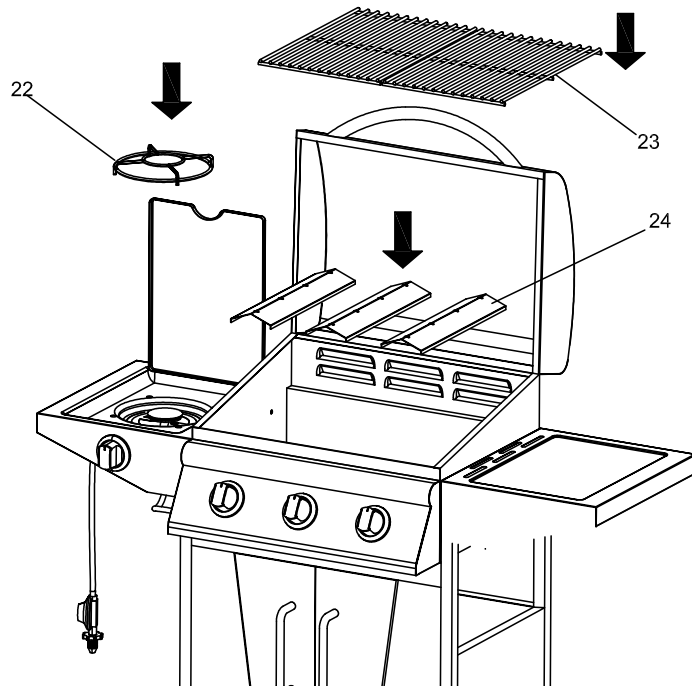

Assembly step 16

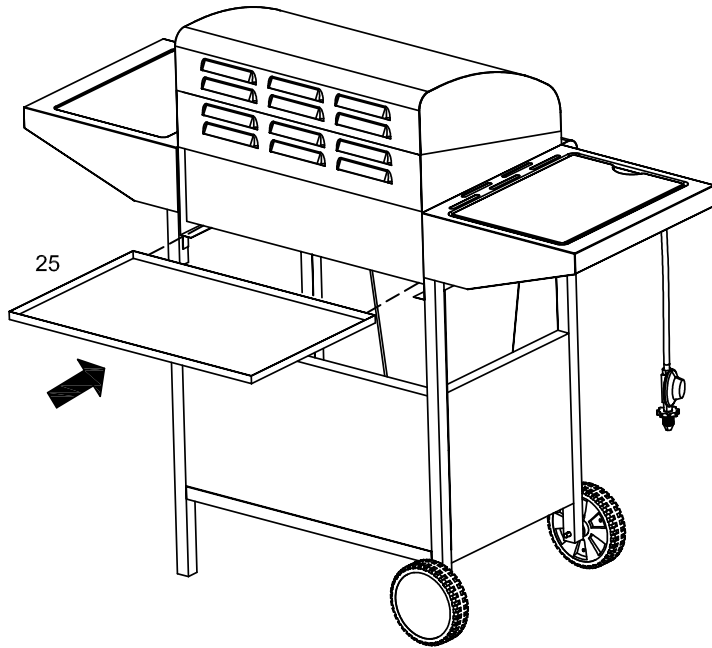

Connecting and disconnecting the gas cylinder

Parts and tools needed

- 17 mm spanner (open-ended spanner SW 17)
- Gas cylinder
A common camping gas cylinder with a fill weight of 3, 5 or 11 kg (e.g. grey camping propane gas cylinder). These are available at DIY shops or liquid gas suppliers.
- Pressure regulator
Preset and CE-approved pressure regulator, max. 1.5 kg/h, operating pressure 28-30 mbar at butane, 37 mbar at propane, suitable for the gas cylinder used. This type of pressure reducer is also available from your local dealer.
- Leak detector
You can locate any leaks in the gas system using a leak detector. This can be purchased at DIY shops or liquid gas suppliers. Please follow the operating instructions of the leak detector.

The following part is included in delivery. It corresponds to the standards applicable in the country to which it has been supplied by LANDMANN.

- Gas hose
CE-approved hose of sufficient length; not exceeding 1.5m, allowing installation without any kinks.

Connecting the Gas Cylinder



Danger "Ignition of escaping gas"

Liquid gas is highly flammable and explosive.

Possible consequences:

- Serious personal injury or damage to property if escaping gas ignites in an environment in which it is not controlled.

Safety precautions:

- When connecting the gas cylinder ensure that there are no sources of ignition within a 5 m radius.
- Take special care not to light any naked flames, do not smoke or switch on electric appliances (devices, lights, door bells), etc. (sparkover possible).
- If necessary, replace the hose in order to comply with the corresponding national requirements.

1. Select a suitable place to set up the cooker. Make sure that ...
 - no flammable materials or substances are in close proximity to the cooker. Minimum distance to flammable materials or substances: 2m above and 1m to the side; distance to flame resistant materials or substances - min 0.25 m.
 - the cooker is positioned firmly on a flat, sufficiently large surface area. It must not be moved during operation.

I. Operating instructions

The Quick-On+ is a low pressure gas regulator in conformity with the EN 12864 European standard.

- Make sure that the inlet and the outlet of the regulator are correct and suitable for the cylinder valve and the application.
- This regulator cannot be used on caravans and motor homes.
- In case the regulator is used outdoors, make sure that it is protected from atmospheric agents.
- The gas cylinder must always be in vertical position and it can never be removed while operating.
- In case of anomalies, close the gas supply and contact the gas dealer.
- Do not use any flames to detect gas leakage; soap solution is suggested.
- Quick-On+ versions featuring a release valve (the marking "PRV" is visible on the label(1)) are generally not type-approved for use in closed premises (see local laws on the subject).



2. Fitting the rubber hose (fig.1)

Connect the end of the hose (3) to the regulator outlet, if necessary with the aid of soapy water. Fasten the hose using clamps (4). Do not over-tighten to prevent damaging the hose (in some countries, the hose clamps and the hose are of standards dimensions).

3. Assembling on the gas cylinder

Make sure that:

- All taps of the gas consuming appliance are closed.
- The connecting pipe is correctly fitted to the consuming appliance.
- The handle is in 'closed' position (the regulator is OFF when a green rectangle is visible on the handle. See fig. 2)

CAUTION: with no flames on, remove seal cap from the automatic valve, place the Quick-On+ onto the valve and push down firmly and vertically. You should be able to hear a click sound, which means the regulator is securely fitted to the gas bottle.

NOTE: The Quick-On+ is designed so as to be fitted to the valve, if only its handle is in "OFF" position.

CAUTION: Never try to assemble nor to disassemble the regulator, if the handle is not in OFF position.

4. Operation

OPEN (ON): After fitting the regulator correctly onto the valve, gas flow can be opened by turning the knob an anticlockwise half turn till the stop and to find the opposite horizontal ON position. In ON position a red flame and the marking "ON" is visible. Please, see fig. 4.

In this position the valve is open and the gas can flow.

CLOSED (OFF): The gas flow can be stopped by turning the knob a clockwise half turn until the stop and to reach the opposite horizontal OFF position. In OFF position the valve is closed. No gas is flowing.

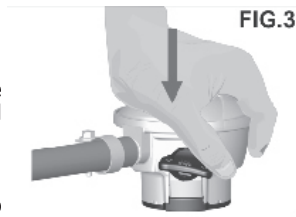

Caution: If you are unable to turn the regulator to "ON" position, your Quick On+ is not correctly connected to the valve. Do not force the handle, but restart following operations described at above-mentioned point 3.

5. Replacement of a cylinder

Make sure that:

- All taps on the gas consuming appliance are in OFF position.
- The Quick-On + handle (5) is in OFF position (it closes by turning it a clockwise half turn until the stop: red flame on the handle is not visible (OFF)).

Then disassemble the Quick-On + by pressing horizontally on the handle (5) and pulling upwards at the same time (fig. 5).

IMPORTANT: Do not remove gas cylinder during this operation.

NOTE - IMPORTANT SECURITY FEATURE: It is not possible to press the handle, if the knob is not in complete horizontal position and the marking "OFF" is not visible.

Please contact your gas supplier in case of any problems.



6. Excess flow valve (EFV)

The Quick-On + can be equipped with a safety device "excess flow valve" designed to stop gas escaping in case of accidental detachment or breakage of the rubber hose used to supply gas to the user appliance. The marking "excess flow" on the label (1) shows the presence of this device on the Quick-On +.

The flow limiting device should operate as follows:

1. In the event of the hose moving from its correct position:

- Close the Quick-On + knob,
- Fit the hose correctly back on the regulator hose connection.
- Open the Quick-On + knob,
- Wait at least 20 seconds before opening the regulator again.

2. In case of the flow of gas being higher than the capacity of the regulator, contact your gas supplier.

To ensure correct operation of the flow limiting device during gas supply, the appliances hose length should be 1.5m at maximum.

In normal conditions of use, in order to ensure the correct operation of the of the installation, it is recommended that this regulator is changed within 10 years of the date of manufacture

IMPORTANT: Never leave the regulator connected to the cylinder valve when the rubber hose is not correctly fitted in its housing as the flow limiting device has not been designed to guarantee the gas supply shut off function.

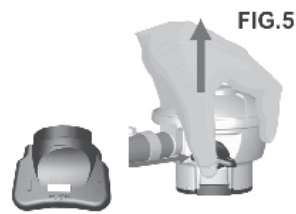

Cleaning

Grill

To ensure your barbecue serves you well for many years to come, it should be cleaned after each use with washing-up liquid, a brush and a cloth - ensure that all parts have cooled down first. This is much easier than cleaning it at a later stage when the dirt has dried.



Caution "Spark plug on burner can be bent"

The spark plug on the burner can be bent or may snap off during cleaning.

Possible consequences:

- Burner no longer lights.

Safety measures:

- Take special care when cleaning the area around the burner.

Gas system

If necessary, the gas outlet nozzle on the adjusting element (underneath the front panel) can be cleaned with a needle. All other parts through which gas is passed may only be cleaned by an expert.

Never dismantle the adjusting element!

Maintenance

The barbecue is maintenance free. Nevertheless, you should check it at regular intervals. The intervals depend on how often the barbecue is used and the environmental conditions to which it is exposed.

Barbecue

- Check to ensure that all parts of the barbecue are present and assembled (visual check).
- Check to ensure that all connections are present and are securely fastened. Tighten if necessary.

Gas system

The gas system needs to be checked every time a gas cylinder is connected (see chapter "Connecting and disconnecting the gas cylinder").

If necessary, replace the hose in order to comply with the corresponding national requirements.

Environmental information and disposal measures

Residual substances



DANGER: Risk of fire when disposing of the hot residual substance

Only dispose of the residual substances when they have fully cooled down and only then in the designated metal containers. Observe the local regulations.

Barbecue

Pay attention to cleanliness when handling the barbecue.

To dispose of the barbecue properly, disassemble it into its individual parts. Recycle the metal and plastic components. Observe the local regulations.

Troubleshooting

If there is a fault despite due care, this chapter may help you to resolve the malfunction.

Malfunction	Cause	Remedy
There is a smell of gas	Leak in the gas system	<ol style="list-style-type: none"> 1. Close the cylinder valve immediately (turn G1 clockwise) 2. Prevent any flame or spark formation (do not switch on any electrical appliances) 3. Tighten all connections of the gas system 4. Check all components of the gas system for external damage; replace defective parts with original spare parts 5. Check for leaks using a leak detector
Burner does not light	Gas cylinder is empty	Replace the gas cylinder
	Cylinder valve is closed	Turn the cylinder valve (G1) anti-clockwise
	Nozzles of the adjusting element (underneath the front panel) are not inserted into the burner hoses	Conduct a visual check, if necessary align the nozzles and connection hoses
	Distance between the spark plug and gas outlets on the burner is incorrect	Visual inspection; correct if necessary
	Nozzle on adjusting element (underneath front panel) is blocked.	Remove the front panel and clean the nozzle of the adjusting element using a pin
	Other gas system blocked	The gas system should be cleaned by a specialist
Temperature on grill too low	Pre-heating time too short	Close lid and set flame regulator to max. setting
	Gas outlets on the burner are blocked	Remove blockages from burner
Popping or bubbling noise	Flashback caused by blockages in the burner.	<ol style="list-style-type: none"> 1. Close the cylinder valve immediately (turn G1 clockwise) 2. Wait 3 minutes and then switch the barbecue back on 3. If the malfunction reoccurs, disassemble and clean the burner

Instructions for using liquid gas cylinders

Operating instructions for liquid gas cylinder systems

(other than propellant gas cylinders and propellant gas cylinder systems)

1. Properties of liquid gas

Liquid gas (propane, butane and mixtures thereof) is a **highly flammable**, colourless gas with a perceptible odour. It is heavier than oxygen and is flammable with low mixtures of ambient air. **Caution:** uncontrolled gas can **deflagrate** or **explode**.

Liquid gas is pressurised in the cylinder. Protect it from temperatures above 40°C! At higher temperatures, especially when exposed to fire, there is a risk of an uncontrolled **gas leak** and even to the cylinder **bursting**.

2. Conduct in the event of malfunctions and leaks:

in the case of fire:

(e.g. smell of gas, noise of escaping gas):		(in buildings/vehicles) additionally:	Notify the fire department ☎ 112!
Close the cylinder valve immediately (clockwise)! Extinguish any naked flames! Contact a specialist!	Do not smoke! Do not actuate any electrical switches! Do not use the telephone!	Open windows and doors! Transfer any leaking cylinders outside immediately! Evacuate the building/vehicle!	Point out the presence of liquid gas cylinders! If possible, remove cylinders from any area that is susceptible to fire or cool with water if necessary.

3. Operation of liquid gas cylinder systems

Liquid gas cylinder systems should only be installed, commissioned, modified and checked by specialised companies.

Liquid gas cylinder systems should only be installed in the **commercial** sector by trained personnel and checked by an appropriately qualified person or, when dealing with certain cylinder systems, by a person assigned by the contractor (accident prevention regulations (BGV D 34).

The cylinder must be set in an upright position. Cylinders positioned on their side pose a threat of deflagration.

The operating instructions provided by the manufacturer of the liquid gas appliance are to be observed carefully by the user for operation and, if necessary, for troubleshooting measures. Prior to the initial operation, or after making a modification, the operator of a liquid gas cylinder system must be assured of its orderly condition through examination and certification by a specialised company (commercial systems are to be addressed by a specialised person responsible for the respective commercial sector). The certificates from the examinations are to be kept by the operator.

If the system is not going to be used for a prolonged period the valves are to be closed; when doing this start from the device shut-off valve towards the cylinder valve. When starting up the system again the valves are to be opened; when doing this start from the cylinder valve towards the device shut-off valve.

Naked flames and smoking are prohibited in areas where **large cylinders** are stored and in close proximity to **large cylinder systems**. The ventilation openings of the installation area and/or the cylinder cabinet must be kept free.

Warning signs must be applied.

The operator is **prohibited** from siphoning liquid gas!

4. Changing the cylinder

When changing the cylinder only loosen the regulator connection after the cylinder valve has been fully closed (clockwise). The pressure regulator must be connected and well sealed. Pay attention to the existing sealing ring (see diagram) **Note left-hand thread!** Every time the cylinder is changed the seal of the regulator connection must be tested using foaming agents (e.g. soapy water).

For multi-cylinder systems: Close the shut-off valve of the container connecting line; set switch to full cylinders.

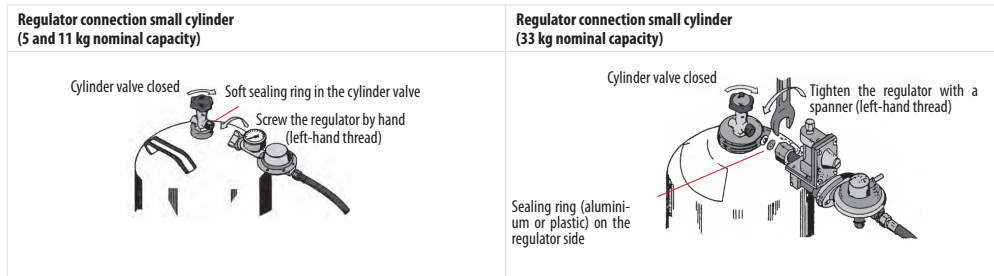

5. Safety monitoring of liquid gas cylinder systems

Liquid gas cylinder systems are to be examined on a recurring basis. The examinations are to be initiated by the operator:

Fixed systems in buildings with cylinders up to 11 kg nominal capacity: every 5 years by a specialised company

Fixed systems in buildings with cylinders between 22 and 33 kg nominal capacity: every 10 years by a specialised company

In accordance with accident prevention regulations BGV D 34 for commercial areas (depending on the type of system): every 4 years / every 2 years / annually

Systems in vehicles in the private and commercial sector: every 2 years

Systems on boats in the private sector: every 2 years

Components of the system that are subject to wear (e.g. regulators, hoses, etc.) are to be replaced where applicable.

6. Transport and storage

To avoid damaging the valve and to prevent gas leaks full and empty liquid gas cylinders should only be transported and stored with a closed and protected valve (wear nut and cap). When transporting in vehicles it must be ensured that there is adequate ventilation in the storage area. The cylinders must be secured from shifting during transport.

The cylinders, even if they are empty, should only be stored upright in well-ventilated areas; they should not be stored below ground level (e.g. basements, shafts, etc.), in stairwells, corridors, passageways, near emergency exits, escape routes and passages between buildings or in their immediate vicinity. No more than two small cylinders should be stored in a home - and only then in separate rooms (not bedrooms).

Any use of energy involves a risk of danger.
Therefore please observe these user/operating instructions!

Declaration of conformity

- DE EG Konformitätserklärung
- GB EG Declaration of Conformity
- FR Déclaration de Conformité CE
- NL EC Conformiteitsverklaring
- ES Declaración CE de Conformidad
- PT Declaração de conformidade CE
- S EC Konformitetsförklaring
- FIN EC Yhdenmukaisuusilmoitus
- N EC Konfirmatsetserklæring
- RU EC Заявление о конформности
- HR Izjava o Konformnosti CE

- RO Declarație de conformitate CE
- TR AT Uygunluk Deklarasyonu
- GR EC Δήλωση περί της ανταπόκρισης
- I Dichiarazione di conformità CE
- DK EC Overensstemmelseserklæring
- CZ EU prohlášení o konformitě
- H EU Konformkijelentés
- SL EU Izjava o skladnosti
- PL Oświadczenie o zgodności z normami Europejskiej Wspólnoty
- SK Vyhásenie EU o konformite



Der Unterzeichnende erklärt im Namen der Firma die Übereinstimmung des Produktes.

The undersigned declares in the name of the company that the product is in compliance with the following guidelines and standards.

La soussigné déclare au nom de l'entreprise la conformité du produit avec les directives et normes suivantes.

De ondertekenaar verklaart in naam van de firma dat het product overeenstemt met de volgende richtlijnen en normen.

El abajo firmante declara, en el nombre de la empresa, la conformidad del producto con las directrices y normas siguientes.

O signatário declara em nome da firma a conformidade do produto com as seguintes directivas e normas.

Undertecknad förklarar i firmans namn att produkten överensstämmer med följande direktiv och standarder.

Allekirjoittanut ilmoittaa liikkeen nimissä, että tuote vastaa seuraavia direktiivejä ja standardeja.

Undertegnede erklærer på vegne av firmaet at produktet samsvarer med følgende direktiver og normer.

Подписавшийся подтверждает от имени фирмы что настоящее изделие соответствует требованиям следующих нормативных документов.

Ovim izjavljujemo da u daljnjem tekstu opisani proizvod na osnovu njegovog koncipiranja i načina gradnje, kao i od Landmann-Peiga u prodaju puštena izvedba odgovara poznatim, osnovnim sigurnosnim i zdravstvenim zahtjevima EG smjernica.

Subsemnatul declară în numele firmei că produsul corespunde următoarelor directive și standarde.

Imzalayan kişi, firma adına ürünün aşağıda anılan yönetmeliklere ve normlara uygun olduğunu beyan eder.

Εν ονόματι της εταιρείας δηλώνει ο υπογεγραμμένος την συμφωνία του προϊόντος προς τους ακόλουθους κανονισμούς και τα ακόλουθα πρότυπα.

Il sottoscritto dichiara a nome della ditta la conformità del prodotto con le direttive e le norme seguenti.

På firmaets vegne erklærer undertegnede, at produktet imødekommer kravene i følgende direktiver og normer.

Ni e podepsaný jménem firmy proha uje, e výrobek odpovídá následujícím směrnici a normám.

Az aláíró kijelenti, a cég nevében a termék megegyezését a következő irányvonalakkal és normákkal.

Podpisani izjavljam v imenu podjetja, da je proizvod v skladnosti s slede čimi smernicami in standardi.

Niżej podpisany oświadcza w imieniu firmy, że produkt jest zgodny z następującymi wytycznymi i normami.

Podpisujući zázavne prehlasuje v mene firme, že tento výrobek je v súlade s nasledovnými smernicami a normami.

- | | |
|--|---|
| <input type="checkbox"/> 98/37/EG | <input type="checkbox"/> 89/686/EWG |
| <input type="checkbox"/> 73/23/EWG | <input type="checkbox"/> 87/404/EWG |
| <input type="checkbox"/> 97/23/EG | <input type="checkbox"/> R&TTED 1999/5/EG |
| <input type="checkbox"/> 89/336/EWG | <input type="checkbox"/> 2000/14/EG: LWM.....dB(A); LWA.....dB(A) |
| <input checked="" type="checkbox"/> 90/396/EWG | <input type="checkbox"/> 90/396/EWG |

DIN EN 498 (Oktober 2009)

Osterholz-Scharmbeck, den 18.10.2010

Jens Keil



LANDMANN® Ltd.
Unit 6 Blackstone Road,
Stukeley Meadows Industrial Estate,
Huntingdon, Cambs, PE29 6EF,
United Kingdom

Hotline
Monday to Thursday 9am to 5pm,
Friday, 9am to 4pm.

+44 0871-231-1990