

This Owner's Manual is provided and hosted by [Appliance Factory Parts](http://www.appliancefactoryparts.com).



COMFORT-AIRE PS-121D Owner's Manual

[Shop genuine replacement parts for COMFORT-AIRE
PS-121D](#)



[Find Your COMFORT-AIRE Air Conditioner Parts - Select From 599 Models](#)

----- Manual continues below -----

Comfort-Aire®

PARTS LIST

Portable Air Conditioner

PS-121D



517.787.2100 • www.marsdelivers.com

EXPLODED VIEW

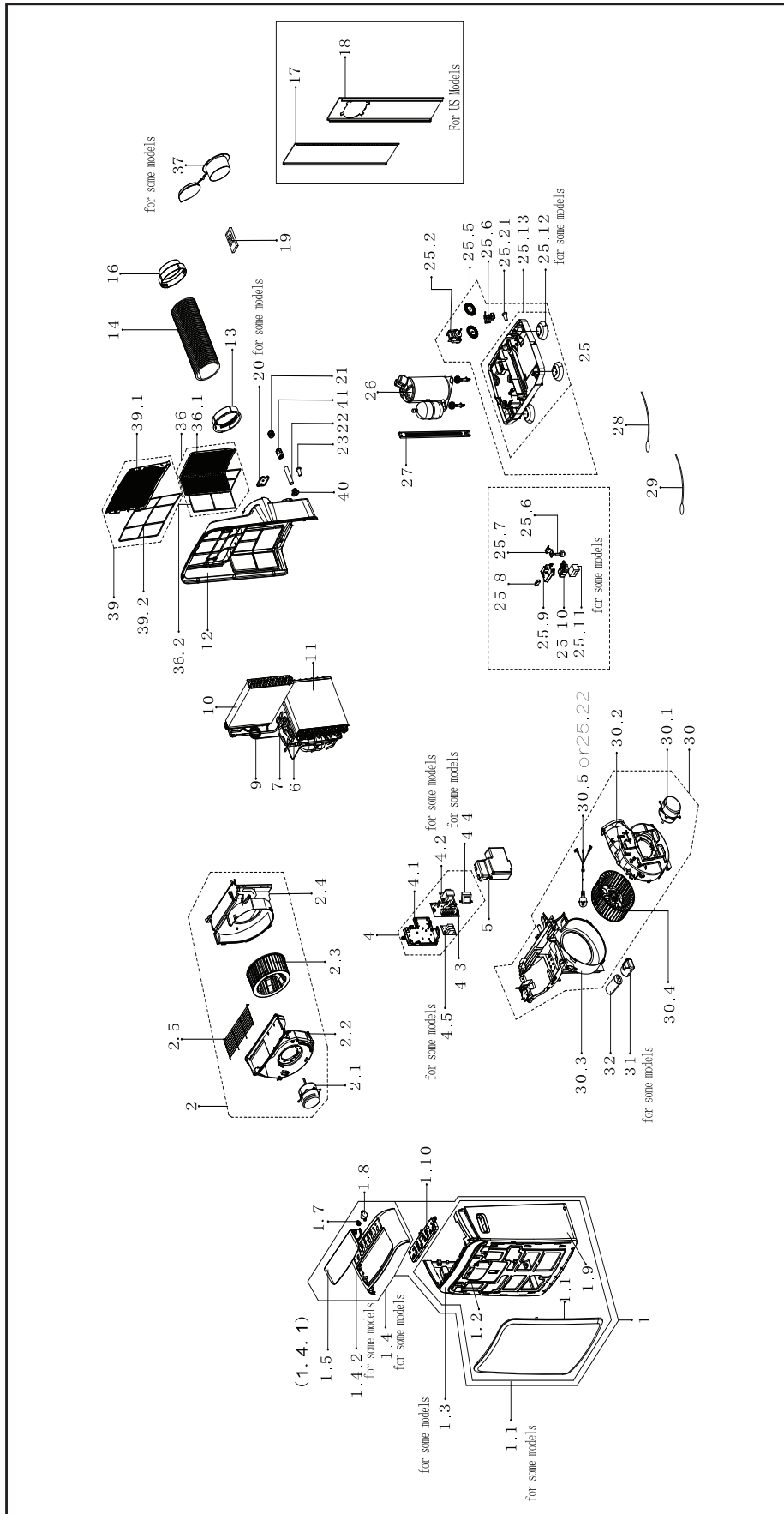

REPLACEMENT PARTS

Location	Part Name	Quantity	Part No.
1	Front panel assembly	1	12120600A24699
1.1	Front panel	1.0	12120600001065
1.2	Signal receiving board subassembly	1.0	17120600000020
1.3	Adorn board	1.0	12120600000751
1.4	Upper panel subassembly	1.0	12120600004384
1.4.1	Horizontal louver	1.0	12120600000007
1.4.2	Upper panel	1.0	12120600001244
1.7	Gear wheel	1.0	12120600000004
1.8	Stepper motor	1.0	11002010000176
1.9	Middle Panel	1.0	12120600000749
1.10	Display board subassembly	1.0	17220600A05512
2	Cover of Air exhaust volute shell assembly	1	12120600005526
2.1	Single phase asynchronous motor	1.0	11002012030246
2.2	Air outlet volute shell	1.0	12120600000896
2.3	Centrifugal Fan	1.0	12100103000044
2.4	air volute subassembly	1.0	12120600004446
2.5	Outdoor air inlet grille	1.0	12220600001002
4	Electronic control box subassembly	1	17220600001822
4.1	Electronic control box subassembly	1.0	12120600005863
4.3	Main control board subassembly	1.0	17120600002210
4.4	Linear Transformer	1.0	11203103000067
4.5	Capacitor auxiliary board subassembly	1.0	17122000040152
5	E-Box Cover	1	12120600004045
6	Suction pipe assembly	1	15120600002719
7	Discharge pipe assembly	1	15120600002717
9	Capillary assembly	1	15120600002617
10	Evaporator assembly	1	15820600001017
11	Condenser assembly	1	15820600000877
12	Rear panel	1	12120600004727
13	Connector, air exhaust duct	1	12120600003049
14	Exhaust hose subassembly	1	12120600A12675
16	Connector, air exhaust duct	1	12120600A12674
17	Window sealing board	1	12120600004203
18	Window sealing board	1	12120600004204
19	Remote controller	1	17317000A52927
21	Drain connection	1	12120600001492
22	Drain pipe	1	12100509000040
23	Drain stopper	1	12600801000048
25	Chassis assembly	1	12120600005524
25.2	Shaded-pole motor	1.0	11002017000545
25.5	Water wheel	1.0	12120600004464
25.5	Water wheel	1.0	12120600000251
25.6	Water Level Switch	1.0	17400511000164

REPLACEMENT PARTS (CONTINUED)

Location	Part Name	Quantity	Part No.
25.13	Chassis subassembly	1.0	12120600004163
25.13.1	Universal wheel	4.0	12620600000019
25.21	Drain stopper	1.0	12600801000048
25.22	Power cord subassembly of LCDI	1.0	17401202006809
26	Fixed speed rotary compressor	1	11103010015853
27	Supporting bar	1	12220600000075
28	Pipe Temperature Sensor	1	11201007003439
29	Room temperature sensor	1	11201007003423
30	Middle partition board assembly	1	12120600004449
30.1	Single phase asynchronous motor	1.0	11002012026562
30.2	Cover of Air exhaust volute shell(outdoor)	1.0	12120600000886
30.3	Partition board subassembly	1.0	12120600004443
30.4	centrifuge fan	1.0	12100103000069
31	rubber heat	1	12600801000643
32	Capacitor of compressor	1	17400103000090
36	Outside inlet air frame unit assembly	1	12120600000560
36.1	Outside inlet air frame unit	1.0	12120600000573
36.2	inside filte	1.0	12120600000661
39	Inside inlet air frame unit assembly	1	12120600000598
39.1	Indoor air inlet grille	1.0	12120600000647
39.2	inside filte	1.0	12100204000251
40	Drain connection	1	12120600001495
41	Cover of Drain connector(outdoor)	1	12120600001499

Due to ongoing product improvements, specifications and dimensions are subject to change and correction without notice or incurring obligations. Determining the application and suitability for use of any product is the responsibility of the installer. Additionally, the installer is responsible for verifying dimensional data on the actual product prior to beginning any installation preparations.

Incentive and rebate programs have precise requirements as to product performance and certification. All products meet applicable regulations in effect on date of manufacture; however, certifications are not necessarily granted for the life of a product. Therefore, it is the responsibility of the applicant to determine whether a specific model qualifies for these incentive/rebate programs.

1900 Wellworth Ave., Jackson, MI 49203 • Ph. 517-787-2100 • www.marsdelivers.com