

This Owner's Manual is provided and hosted by [Appliance Factory Parts](#).



# Saber R33CC0317 Owner's Manual

[Shop genuine replacement parts for Saber R33CC0317](#)



[Find Your Saber Grill Parts - Select From 18 Models](#)

----- Manual continues below -----

# SABER®

## ASSEMBLY INSTRUCTIONS INSTRUCCIONES DE MONTAJE INSTRUCTIONS DE MONTAGE

Estimated Assembly Time: 45 minutes  
Tiempo estimado de ensamblaje: 45 minutos  
Estimation de l'Assemblée Durée: 45 minutes

Tools suggested •  
Herramientas sugerida •  
Outils suggérée •

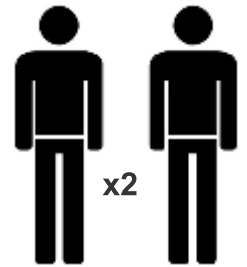
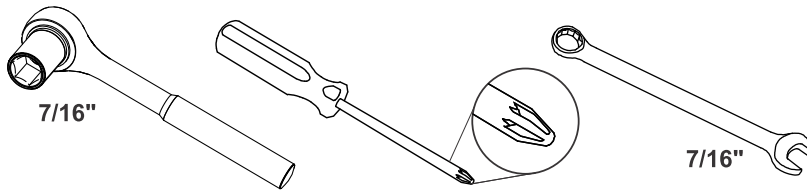

**NOTE:** Assemble your grill on a clean, level surface.  
**NOTA:** Monte la parrilla sobre una superficie limpia y nivelada.  
**REMARQUE:** Montez votre grill sur une surface propre et plane.

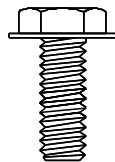

1/4-20x5/8" Hex Bolt - 48  
1/4-20x5/8" Perno Hexagonal - 48  
1/4-20x5/8" Boulon Hexagonal - 48

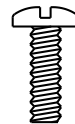

#8-32x3/8" Screw - 11  
#8-32x3/8" Tornillo - 11  
#8-32x3/8" Vis - 11

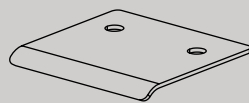

Door Closer Bracket - 1  
Abrazadera de puerta - 1  
Support de porte - 1

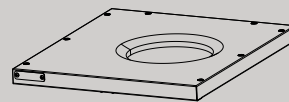

Bottom Shelf - 1  
Repisa inferior - 1  
Tablette du bas - 1

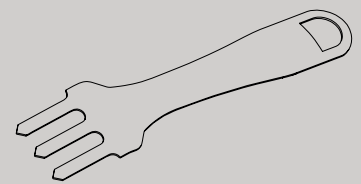

Grate Cleaning Tool - 1  
Rallar herramienta de limpieza - 1  
Râper outil de nettoyage - 1



Door Handle - 1  
Tirador - 1  
Poignée de porte - 1

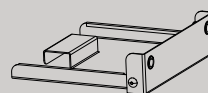

Tank Retainer Bracket - 1  
Soporte de retención del tanque - 1  
Support de retenue de réservoir - 1

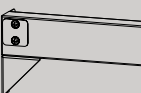

Front Door Bracket - 1  
Abrazadera de puerta - 1  
Attache de porte - 1

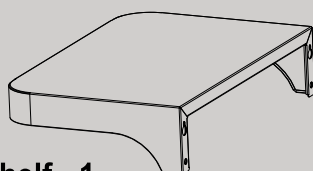

Side Shelf - 1

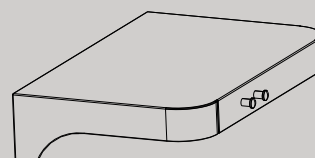

Side Shelf - 1



Casters - 4

**5**

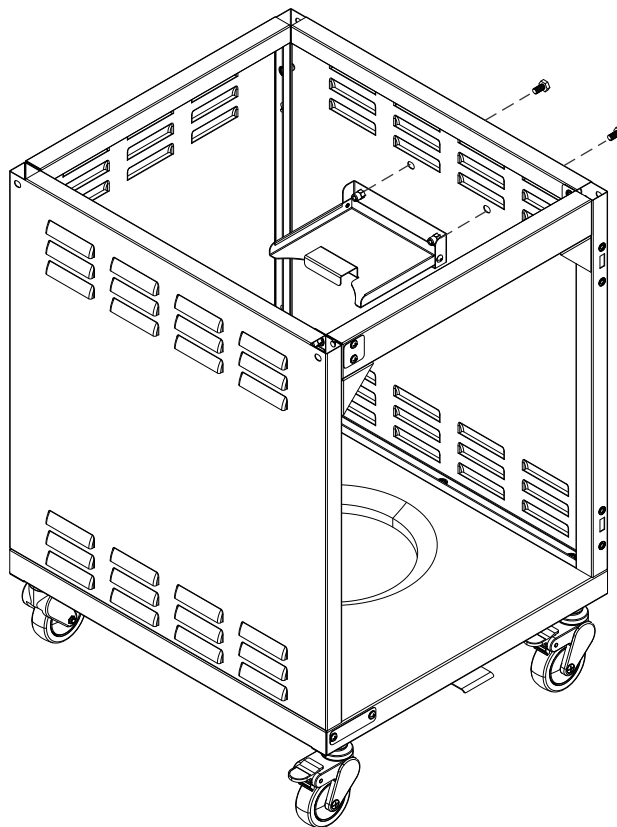
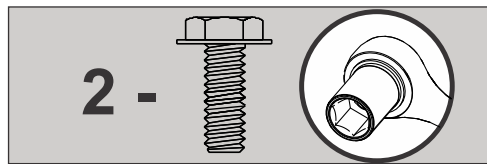

**7**

