

This Owner's Manual is provided and hosted by [Appliance Factory Parts](#).



ASKO T793FI Owner's Manual

[Shop genuine replacement parts for ASKO T793FI](#)



[Find Your ASKO Dryer Parts - Select From 74 Models](#)

----- Manual continues below -----

Operating Instructions

Tumble dryer

Dear ASKO customer,

Thank you for choosing this quality product from Scandinavia, which was made in Sweden.

We want you to feel assured that the inside of your new machine is just as good as the outside and that the ethics and standards that went into the production of this machine are just as high as the quality and performance that you will receive from it. We hope that this product will give you many years of pleasure.

To ensure that you get the most from your new machine, we recommend that you read the operating instructions before using the machine. The operating instructions also contain information on how to avoid damaging the environment.

Asko T793C

Contents

Before using your machine for the first time	4	Settings	17
Do not tumble-dry	4	You can carry out the following settings	17
Safety instructions	5	How to choose the settings:	17
General	5	Clock	17
Installation	5	Audible Volume	17
Safety	5	Language	18
Interrupting a program	5	Child safe start	18
Transport/Winter storage	5	Care and cleaning	19
Packing material	5	Cleaning the lint filter	19
Recycling	6	Emptying the condensed water container	19
Child safety	7	Cleaning the outside of the machine	19
General	7	Cleaning the condenser	20
Activating the Child-safe start	7	Troubleshooting	21
To deactivate the Child-safe start temporarily:	7	The machine will not start	21
Description of the tumble dryer	8	Overheating cut-out	21
Front panel	9	Drying takes too long	21
Advice and tips before you tumble-dry	10	The washing does not dry, or is too dry	21
Have the clothes been spun?	10	Error messages	21
Laundry labels	10	Technical information	22
And do not tumble-dry...	10	Technical data	22
Tumble drying	11	Standard tests	22
Sort your fabrics	11	Service	23
Turn on the main power switch.	11	Before contacting the service division	23
Open the door, load the items and then close the door	11	Installation	24
Select the program	11	Positioning the tumble dryer	24
Press the Start button	12	Adjusting the feet	25
Drying program finished	14	Condensed water	26
Once drying has finished	14	Electrical installation	26
Selecting Options	15	Door hanging	27
Temperature	15	Follow these instructions:	28
Cooling	15		
Anti-crease function	15		
Delayed Start	15		
Setting the time for the Timed dry and Air fluff programs	16		

Contents

Quick guide	32
Fabrics	32
Turn on the main power switch	32
Load the laundry	32
Select a program and any options	32
Press the button	32
Drying program finished	32
Once tumble-drying has finished	32

Before using your machine for the first time

Do not tumble-dry

Certain materials are sensitive to tumble-drying. Always check and follow the instructions on each item's laundry label. You can find more information in the chapter "Advice and tips before you tumble-dry".

Note!

When starting the tumble dryer for the first time or after a long period without use, you may notice a slight thumping noise. This noise is completely normal and will disappear after a few loads.

See the Quick guide on the last page.

Safety instructions

General

- Read the operating instructions and keep them in a safe place!
- Electrical installation, if required, should be carried out by a qualified electrician.
- The machine should only be used for tumble-drying as described in these instructions.
- Repairs and maintenance must be carried out by a qualified professional.
- Damaged mains cables must only be replaced by a qualified electrician.
- Sufficient ventilation is required to prevent smoke from open fires or fumes from equipment burning other fuels being sucked into the room.
- Do not dry dirty laundry in the tumble dryer.
- Items that are stained with e.g. cooking oil, acetone, alcohol, petrol, kerosene, stain remover, turpentine, wax and wax remover should be washed in hot water with extra detergent before they go in the tumbler dryer.
- Items such as foam rubber (latex foam), shower caps, waterproof textiles, rubber-coated items and clothes or latex foam-filled cushions may not be dried in the tumbler dryer.
- Fabric softener or similar products should be used as per the recommendations of the detergent manufacturer.
- The last phase of the drying cycle is carried out without any heat (cool down cycle).

Caution!



Never stop a tumble dryer before the program is completed unless you immediately remove all the laundry and spread it out so that the heat can disperse.

Installation

See the “Installation” chapter.

Safety

- The machine must not be used for drying items that have been dry-cleaned at home or fabrics that may contain residues of flammable liquids.
- The tumble dryer is protected by an overheating cut-out. This shuts off the machine if the temperature gets too high.
- The appliance is not intended for use by young children or infirm persons without supervision.
- The machine automatically cuts off if the condenser water tank is full or outlet hose is blocked.

Caution!



When the tumble dryer is operating, the back of the tumble dryer will get very hot. Leave the machine to cool completely before touching the back.

Interrupting a program

You can stop a drying program by:

- Open the door. The drum will then stop automatically.
- Press the main power switch.
- You can also stop a program by pressing the Start/Stop button for three seconds.
- When you want to resume tumble-drying, simply close the door and press the Start/Stop button.

Transport/Winter storage

If you need to move your machine or store it over the winter in unheated premises, make sure that you drain the condensed water container beforehand.

Packing material

Sort waste materials in accordance with local guidelines.

Safety instructions

Recycling

This machine is manufactured and labelled for recycling. To prevent injuries, the machine must be made unusable before disposing of it. Contact your local authority for information about where and how your machine can be recycled correctly.

- Items that have been spotted or soaked with vegetable or cooking oil constitute a fire hazard and should not be placed in a tumble dryer. Oil-affected items can ignite spontaneously, especially when exposed to heat sources such as in a tumble dryer. The items become warm, causing an oxidation reaction in the oil. Oxidation creates heat. If the heat cannot escape, the items can become hot enough to catch fire. Piling, stacking or storing oil-affected items can prevent heat from escaping and so create a fire hazard. If it is unavoidable that fabrics that contain vegetable or cooking oil or have been contaminated by hair care products be placed in a tumble dryer they should first be washed in hot water with extra detergent - this will reduce, but not eliminate, the hazard. The 'cool down' cycle of tumble dryers should be used to reduce the temperature of the items. They should not be removed from the tumble dryer or piled or stacked while hot.
- Items that have been previously cleaned in, washed in, soaked in or spotted with petrol/gasoline, dry-cleaning solvents or other flammable or explosive substances should not be placed in a tumble dryer. Highly flammable substances commonly used in domestic environments include acetone, denatured alcohol, petrol/gasoline, kerosene, spot removers (some brands), turpentine, waxes and wax removers.

- Items containing foam rubber (also known as latex foam) or similarly textured rubberlike materials should not be dried in a tumble dryer on a heat setting. Foam rubber materials can, when heated, produce fire by spontaneous combustion.
- Fabric softeners or similar products should not be used in a tumble dryer to eliminate the effects of static electricity unless this practice is specifically recommended by the manufacturer of the fabric softener or product.
- Undergarments that contain metal reinforcements should not be placed in a tumble dryer. Damage to the tumble dryer can result if metal reinforcements come loose during drying. When available a drying rack could be used for such items.
- Plastic articles such as shower caps or babies' waterproof napkin covers should not be placed in a tumble dryer. Rubber-backed articles, clothes fitted with foam rubber pads, pillows, galoshes and rubber-coated tennis shoes should not be placed in a tumble dryer.

Vented dryers

- There has to be adequate ventilation to avoid the back flow of gases into the room from appliances burning other fuels, including open fires, when operating the tumble dryer
- The exhaust air must not be discharged into a flue which is used for exhausting fumes from appliances burning gas or other fuels

Caution!

Air from the tumble dryer must not be fed through ducts used for equipment that burns gas or other fuels.

Child safety

General

Do not allow children to play with the tumble dryer.

The tumble dryer does not start automatically when the door closes (e.g. if a child closes the door from inside). In order to prevent children from starting a program or changing one that has already started, you can activate a Child-safe start.

Activating the Child-safe start

You can activate a Child-safe start to prevent children from starting the machine.

1. Press the program selector until the Child-safe start is highlighted.
2. Turn the program selector until On or Off is displayed.
3. Press the program selector to activate

To deactivate the Child-safe start temporarily:

By pressing the program selector and the Stop button at the same time for three seconds, you can temporarily disable the safety catch for three minutes.

Description of the tumble dryer

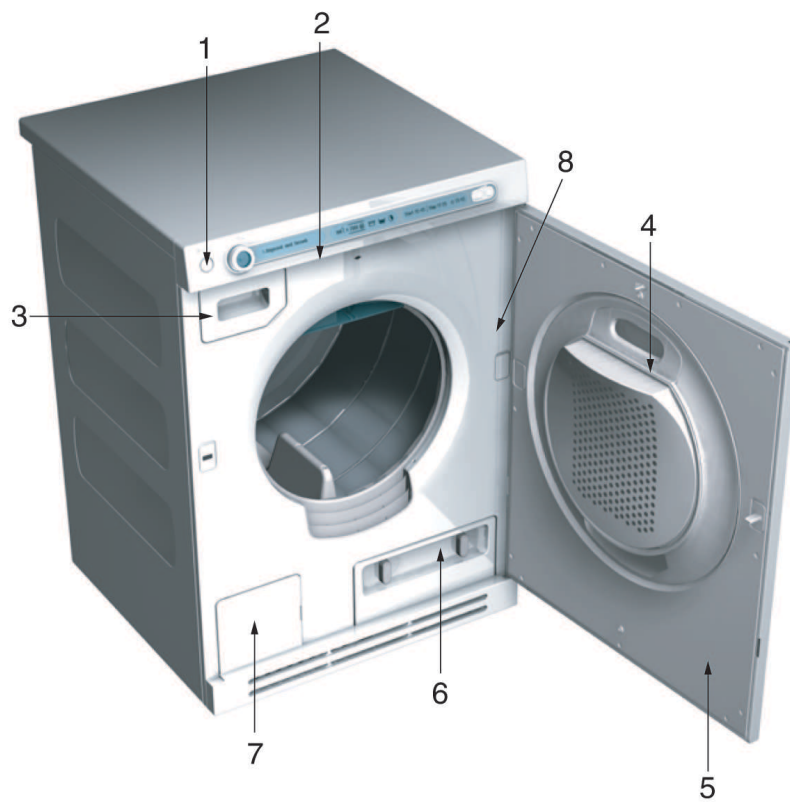

- | | | | |
|----|---------------------------|----|--------------------|
| 1. | Main power switch | 6. | Condenser |
| 2. | Panel | 7. | Fan (behind hatch) |
| 3. | Condensed water container | 8. | Serial Number |
| 4. | Lint filter holder | 9. | Lint filter |
| 5. | Outer door | | |

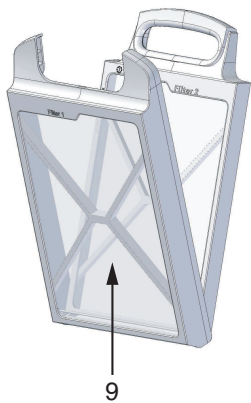

Front panel

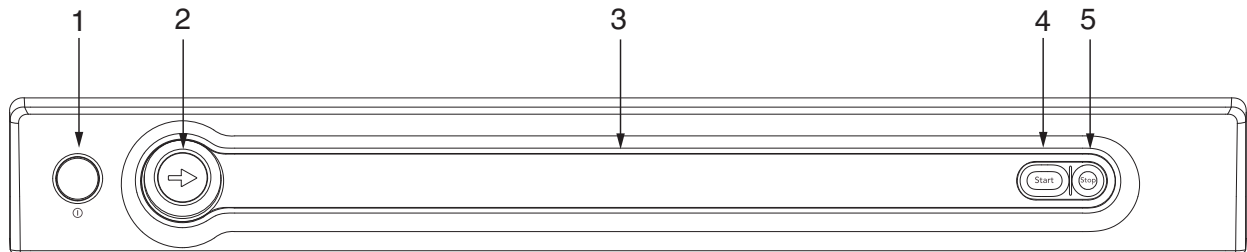

- | | | | |
|---|-------------------|---|-------|
| 1 | Main power switch | 4 | Start |
| 2 | Program selector | 5 | Stop |
| 3 | Display window | | |

Advice and tips before you tumble-dry

Here are some tips that may help you before you begin tumble-drying.

Have the clothes been spun?

Items to be tumble-dried should be spun at 1000 rpm or faster. Higher spin speeds save both energy and drying time.

Laundry labels

Materials that can be tumble-dried

 This symbol means that the material is suitable for tumble-drying. Fabrics best suited to tumble-drying are cotton fabrics, terry cloth and synthetic fibres. Garments will be softer and lighter when tumbled than when hung out to dry.

Note!

The tumble dryer does not cause any significant wear to fabrics. The lint that is trapped in the lint filter consists of dust and fibre residues that form when the items are used.

Materials that must not be tumble-dried

 This symbol means that the material is not suitable for tumble-drying. Certain materials may melt or become a fire hazard if exposed to heat, and others can lose their shape or shrink.

And do not tumble-dry...

- materials labelled "Do not dry near heat".
- garments that have been dry-cleaned at home.
- plastic foam.
- fibreglass material.
- wool because of the risk of felting.

Note!

If the door is opened during the program, the program will be interrupted and will return to the start. The clothes may be too damp or too dry as a result.

Tumble drying

Below are step-by-step instructions to help you achieve the best possible tumble-drying results.

1 Sort your fabrics

You will achieve the most uniform drying results if the items are made of the same type of material. Do up zips and buttons, fasten belts, sort the items and adjust the load and temperature.

2 Turn on the main power switch.

3 Open the door, load the items and then close the door

4 Select the program

Select a program by turning the program selector. The name of the selected program is highlighted and the finish time of the program also appears on the display. Start the program by pressing the Start button, or press the button in the centre of the program selector to go on and select Options. Guidelines as to what specific programs can be used for.

Auto extra dry

This program is for items that are particularly difficult to dry, e.g. jeans with very thick seams.

Note!

Knitted fabrics in particular are prone to shrinkage. Use the Auto dry, Auto normal dry or Auto Iron dry programs for these items. Stretch clothes back into shape immediately after drying.

Auto dry and Auto normal dry

These programs shut off the heat once the load is dry but before it is "bone-dry". The Auto dry program shuts off the heat slightly later than Auto normal dry. Use trial and error to find out what works best. Use these programs when you want items to be completely dry.

Auto Iron dry

This program shuts off the heat once the load is just damp enough for ironing or pressing.

Timed dry

The program length you choose depends on what you intend to do with the items after drying them. Use trial and error to find out what works best. When you use Timed dry to tumble-dry a load of mixed fabrics, some of the garments may remain damp. Tumble-dry any damp garments for a further 30 minutes or so using the Timed dry program.

Note!

When using the Timed dry program, garments can become "over-dry" if you have selected too long a drying time. This can cause the items to shrink or crease and become rough. Synthetic materials can also become charged with static electricity.

Setting the time for the Revitalise or Timed dry program

For the Revitalise program and the Timed dry program, you set the number of minutes incrementally. The selected time is shown on the display. You can try out different drying times.

Revitalise program

Use the Revitalise program when you just want to refresh, air or soften up items.

Tumble drying

Menu overview



Temperature normal



Energy Save



Quick cooling



Normal cooling

Note!

The illustration shows an example of a program.

5 Press the Start button

Remaining drying time

An estimate of the remaining drying time will be shown on the display within 2 minutes of the drying program starting. For example, 1:35 means that it will take approximately 1 hour and 35 minutes for the load to dry. If the Anti-crease option has been selected, the drum will rotate every minute for 2 hours after cooling.

Stopping or changing a program

Press and hold the Start/Stop button for three seconds.

Note!

The program will not be affected if you change the program selector after the program has started.

Loading or removing washing

If you want to load or remove washing once you have started the machine, open the door and the program will stop. Load more washing or take out the items you want, close the door and press the Start button. A new estimate of the remaining program time will be displayed after about 2 minutes.

Tumble drying

Program chart

For the consumption values given below, the requirements are as follows:

Temperature of intake air:	20 °C
Moisture content of intake air:	65 %
Drying temperature:	Normal or low
Heater output:	1950W

Before tumble-drying, cotton fabrics should be spun at 800 and 1600 rpm (long spin).

Before tumble-drying, other fabrics (crease-resistant and acrylic) should be spun at 800 rpm (short spin).

Program	Material	Temperature	Max. load (kg)	Energy consumption (approx. kWh)		Program time (approx. min)	
				800 rpm	1600 rpm	800 rpm	1600 rpm
Auto extra dry	Cotton, linen	Normal	7	5,4	4,3	162	129
Auto dry	Cotton, linen	Normal	7	4,6	3,6	139	109
Auto dry	Crease-resistant, polyester/cotton	Normal	3,5	2,1	-	64	-
Auto normal dry	Cotton, linen	Normal	7	4,3	3,3	130	100
Auto normal dry	Crease-resistant, polyester/cotton	Normal	3,5	1,9	-	59	-
Auto normal dry	Acrylic, rayon, acetate	Low	3,5	2,0	-	90	-
Auto Iron dry	Cotton, linen	Normal	7	3,5	2,6	104	78

Tumble drying

6 Drying program finished

The text "END" appears in the display when the program has finished. If the Anti crease option has been selected, the drum will rotate every minute for 2 hours after cooling.

Important!

- Clean the lint filter after each load.
- Empty the condensed water container after each load.

Caution!



If the lint filter becomes clogged, the machine's automatic overheating cut-out may be triggered. In order to be able to restart the machine, you must clean the filter and allow the machine to cool down for around 30 minutes.

Cleaning the lint filter

1. Grasp the filter handle and pull it towards you.

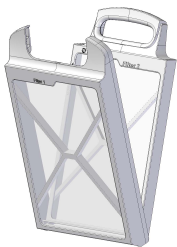

2. Pull the filter out of its holder.
3. Open the filter and remove the lint by hand.
4. Fold the filter up and re-insert it into its holder. The filter may need to be cleaned if it has limescale deposits. See the "Care and cleaning" chapter.

Emptying the condensed water container

The condensed water container must be drained after each load. Remove the condensed water container, empty out the water and replace the container. If the condensed water container becomes too full, the program is interrupted and "Over Flow fault" appears on the display. Empty the container and press the Start button to restart the program. See also the "Troubleshooting" chapter.

Note!

Do not remove the condensed water container while the machine is running.

Tip!

As the condensed water is decalcified, it can be used in steam irons. Pour it through a coffee filter.

Automatic emptying

If you want the water to empty automatically, see the "Installation" chapter.

7 Once drying has finished

Turn off the main power switch. Remove the clothes and close the door to prevent small children from climbing into the machine.

Selecting Options

By selecting options, you can tailor drying programs to suit your own laundry requirements. The machine remembers the option you have chosen and uses it the next time you select the program in question. You can, of course, change this if you want.

Temperature

1. Choose the temperature by pressing the program selector until Temperature is highlighted.
2. Turn the program selector clockwise for Normal Temperature or anticlockwise for Low Temperature.
3. Press the Start button to start the program or press the program selector to choose more options.

Cooling

If you choose Normal Cooling, the machine cools the load in 15 minutes. If you choose Quick cool-down, the load cools in 3 minutes. Cooling cannot be selected for the Revitalise program.

1. Choose Cool-down by pressing the program selector until Cool-down is highlighted.
2. Turn the program selector clockwise until Short Cooling is displayed or anticlockwise until Normal Cooling appears.
3. Press the Start button to start the program or press the program selector to choose more options.

Anti-crease function

This is a useful feature if you cannot take the washing out as soon as the tumble dryer has finished. The function prevents the clothes from remaining in the same position and becoming creased. The drum will rotate for three seconds per minute for two hours once the drying program has finished

1. Choose Anti crease by pressing the program selector until Anti crease is highlighted.
2. Turn the program selector clockwise to select On or anticlockwise to select Off.
3. Press the Start button to start the program or press the program selector to choose more options.

Delayed Start

Choose the number of hours that you want to delay the start by.

1. This option cannot be used in the Air fluff or Timed dry program.
2. Select Delayed Start by pressing the program selector until Delayed Start is displayed.
3. Turn the program selector to the number of hours that you want to delay the start by.
4. Press the Start button to start the program or press the program selector to choose more options.

Note!

Remember to press the Start. button.

Selecting Options

Setting the time for the Timed dry and Air fluff programs

You can set the time so that it appears on the display as Start, Done or as the number of minutes. This will depend on how you have chosen to display times.

1. Press the program selector until the Time setting is highlighted.
2. Turn the program selector to select the time at 15 minute intervals.
3. Press the Start button to start the program or press the program selector to choose more options.

Settings

You can carry out the following settings

- Clock
- Audible Volume
- Language
- Child safe start
- Back

How to choose the settings:

1. Press the program selector until the program selection menu on the left is highlighted.
2. Turn the program selector until Settings is highlighted.
3. Press the program selector.

Clock

Set to 12/24 hour or to display the remaining program time.

1. Press the program selector until Clock appears in the middle of the display.
2. Press the program selector again to access the options menu on the right of the display.
3. Turn the program selector and you can now choose the 12h or 24h time format or display the remaining program time.
4. Press the program selector to save your setting.
5. When you have selected 12 or 24 hour, you will automatically gain access to the Clock-setting menu.

Setting the clock

6. Turn the program selector until the right hour figure is shown.
7. Press the program selector to save your setting.
8. Turn the program selector until the right minute figure is shown.
9. Press the program selector to save your setting.
10. If you do not want to select any more settings, turn the program selector anticlockwise to the program you want.

Audible Volume

You can choose to have the machine notify you when a program is finished or when a fault has occurred.

1. Select Audible Volume by turning the program selector until Audible Volume is highlighted.
2. Press the program selector again to access the options menu on the right of the display.
3. By turning the program selector you can select the setting for the Audible Volume: Off, Low, Normal, High.
4. Press the program selector to save your setting.

Settings

Language

You can choose the language that you prefer.

1. Select Language by turning the program selector until Language is highlighted.
2. Press the program selector again to access the options menu on the right of the display.
3. Turn the program selector to choose from: AU english, US english, svenska, dansk, norsk, suomea, Francais, Deutsch, Italiano, espanol, Русский, nederlands.
4. Press the program selector to save your setting.

Child safe start

You can activate a Child-safe start to prevent children from starting the machine. By pressing the program selector and the Stop button at the same time for three seconds, you can temporarily disable the safety catch for three minutes.

1. Choose the Child-safe start by turning the program selector until Child-safe start is highlighted.
2. Press the program selector again to access the options menu on the right of the display.
3. Turn the program selector clockwise to choose "On" or anticlockwise to choose "Off".
4. Press the program selector to activate

Care and cleaning

Cleaning the lint filter

The lint filter must be cleaned after each load. If you have very hard water, this can cause limescale deposits in the lint filter. Check for any limescale deposits when cleaning the lint filter and, if necessary, wash the filter by hand.

1. Grasp the filter handle and pull it towards you.
2. Pull the filter out of its holder.

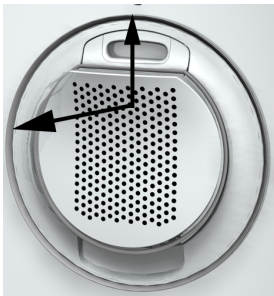

3. Open the filter and remove the lint from all sides of it by hand. Use a soft, dry cloth to remove any deposits.

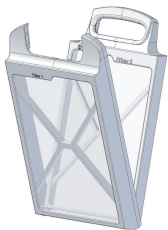

4. Replace the filter in its holder.

Note!

If you have hard water, the filter should be washed with water to get rid of any limescale deposits. Dry the filter carefully with a towel. If you cannot remove the limescale, you can buy a new filter from the retailer where you bought the tumble dryer.

Emptying the condensed water container

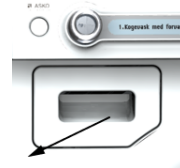

The condensed water container must be drained after each load. Remove the condensed water container, empty out the water and replace the container. If the condensed water container becomes too full, the program is interrupted and "Over Flow fault" appears on the display. Empty the container and press the Start button to restart the program. See also the "Troubleshooting" chapter.

Note!

Do not remove the condensed water container while the machine is running.

Cleaning the outside of the machine

Clean the outside of the machine and the program panel with a mild cleaner. Do not use solvents, as these can damage the machine. Do not hose down or spray the machine with water.

Note!

Do not allow dust to accumulate around the machine. Keep the area around the tumble dryer clean and cool; dust, heat and moisture prolong drying times.

Care and cleaning

Cleaning the condenser

The condenser should be cleaned at least three times a year. If you have pets, the condenser must be cleaned more frequently.

1. Turn off the main power switch.
2. Remove the lower plinth.

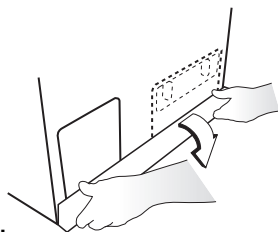

3. Open the condenser panel by turning the two knobs anticlockwise.

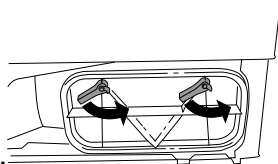

4. Remove the condenser and rinse the lamellas clean using a hand-held shower, for example. Do not touch the lamella springs, as you may damage the condenser. Do not use pointed metal objects during cleaning.

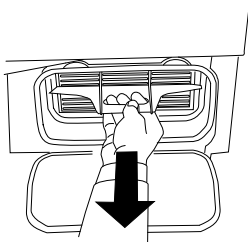

Note!

Do not put the condenser in a dishwasher.

5. Replace the condenser. When refitting the condenser, check that it is replaced correctly. The top of the condenser is labelled "upp", "up" and "oben".

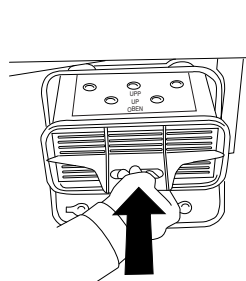

6. Before you replace the plinth, clean the filter from the plinth's air gaps with a soft cloth.
7. Replace the plinth.

Troubleshooting

The machine will not start

Check

- that the door is properly closed.
- that the main power switch is on.
- that the Delayed Start option has not been selected. If so, the time remaining until the start will be shown in full hours in the display (e.g. 5, 4, 3h). To cancel Delayed Start, press the Start/Stop button for 3 seconds.
- that the machine is not programmed to start at a specific time (e.g. 13.30)
- that the plug is connected.
- that the fuses (circuit breakers) in your house are intact. Swap two circuit breakers over to make sure. You cannot always tell from the outside if a circuit breaker is broken.
- that the overheating cut-out has not been triggered (see below).

Overheating cut-out

The overheating cut-out shuts off the tumble dryer if the temperature is too high, e.g. because dust is clogging the lint filter.

- Clean the filter.
- Check also that the condensed water container is not full and, if necessary, clean the condenser. See the "Care and cleaning" chapter.
- The overheating cut-out will reset automatically once the machine has cooled down.

Drying takes too long

- Empty the condensed water container and check that neither the lint filter nor the condenser is clogged. See the chapter "Care and cleaning".
- Prolonged drying times may also be due to the tumble dryer being located in a room that is too small and the air in the room (cooling air) being too hot.
- Make sure that the tumble dryer has access to more cold air, e.g. by opening doors and/or windows.

The washing does not dry, or is too dry

- The door has been opened while the program is running, which disrupts the moisture monitoring function.

Error messages

- If "Over Flow" is shown in the display, the condensed water container is full. Empty the container and restart the program.
- If "Max program time" appears on the display, the maximum program time has been reached. See the "Troubleshooting" chapter.
- If "Clean lint filter" appears on the display, clean the lint filter.

Technical information

Technical data

Height:	850 mm
Width:	595 mm
Depth:	585 mm
Weight:	47 kg
Cylinder volume:	111 l
Max. drying capacity:	7 kg
Speed:	52 rpm
Rated power:	See type plate.
Drum material:	Stainless steel
Outer casing material:	Powder-coated and hot-galvanized sheet steel or stainless steel.
Setup	Stacking or freestanding
Drain:	2,0 m rubber hose

Standard tests

Australia:	
Drying performance:	AS/NZS 2442.1:1996.???,7 kg cotton, temperature Normal.
Energy declaration:	AS/NZS 2442.1:1996.???, 7 kg cotton, temperature Normal. The machine has been tested for single-phase 10/16A.
Test method for noise measurement:	IEC 60 704-2-6.

Service

Before contacting the service division

Before contacting the service division, you should find out whether you can resolve the fault yourself. See the "Troubleshooting" and "Care and cleaning" chapters.

If you still need to contact the service division, make sure that you know the model designation, type designation and serial number.

The model designation can be found in the stamped hole on the first page of the operating instructions and on the machine's panel. The type designation and serial number can be found on the type plate.

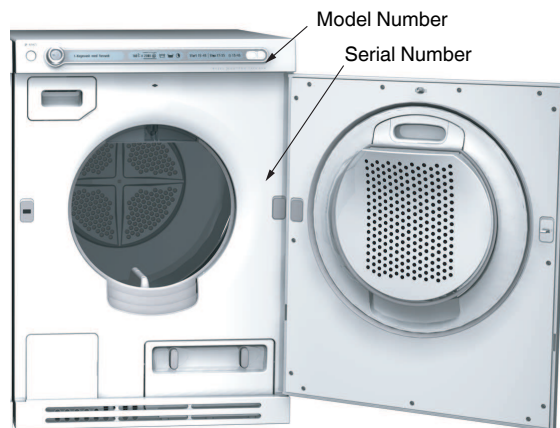
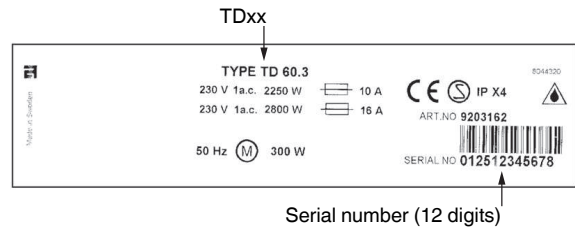

Installation

Positioning the tumble dryer

The tumble dryer can be free-standing or in a stack. Remember that the tumble dryer produces heat and should therefore not be located in a room that is too small. If the room is very small, drying will take longer due to the limited quantity of air.

Caution!



The machine must not be installed behind a lockable door, a sliding door or a door with hinges on the opposite side to those of the tumble dryer.

Caution!



The ventilation in the tumble dryer's plinth must not be blocked by a carpet or rug.

Tip!

To improve ventilation, leave the door to the room where the tumble dryer is located open.

Caution!



Any electrical installation must be carried out by qualified professionals.

A. Free-standing

The tumble dryer can be positioned beside the washing machine.

B. Stack

The tumble dryer can be placed on top of a Asko washing machine. In this case you use the stacking attachments (foot cups and anti-tilt devices) that come with the machine: You will find 2 foot cups in a bag in the drum and 2 anti-tilt devices are attached to the bottom left corner at the back of the machine.

Extending plates can be ordered from your local retailer.

How to assemble the stack:

1. Undo the anti-tilt device.

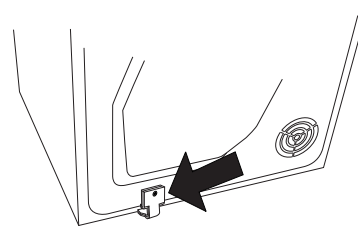

2. Undo the two screws indicated on the back of the washing machine.

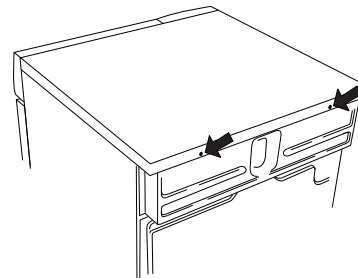

3. Secure the anti-tilt device using the screws as shown in the picture.

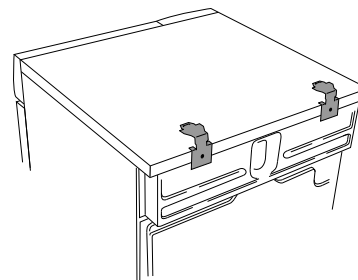

Installation

4. Attach the plastic cups for fixing the tumble dryer's front feet to the washing machine's top cover. This is essential, as only when the tumble dryer's feet are resting in the plastic cups can you be sure that the dryer is correctly positioned on the washing machine.

Break off tag A on the cup fitted on the right-hand side and tag B on the cup fitted on the left-hand side. Then remove the paper from the self-adhesive surface under the plastic cups.

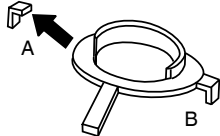

5. Fit the plastic cups so that the "tags" marked with arrows are against the front edge or side edge of the cover and press them firmly onto the cover. Then break off the remaining tags.

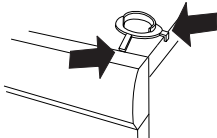

6. Push out the knock-out hole on the back of the dryer (you must not remove it, just open it) using a hammer and screwdriver.

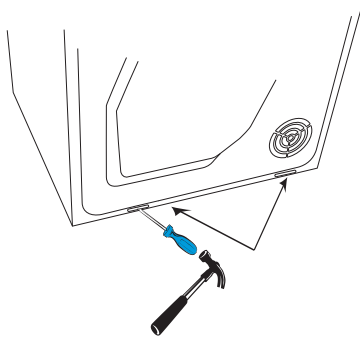

7. Push the tumble dryer in under the metal brackets, keeping the front edge raised by 1 - 2 cm.

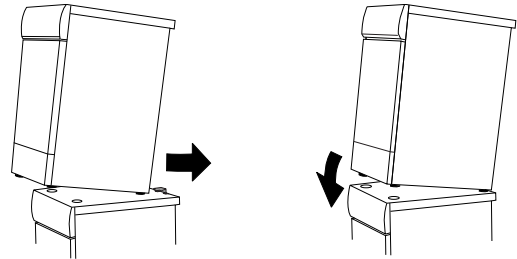

8. Lower the tumble dryer's front feet into the plastic cups and adjust the dryer to ensure that it is balanced.

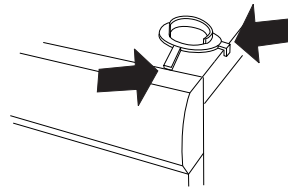

Adjusting the feet

Screw the feet in or out so that the tumble dryer is steady and balanced on the floor or on the washing machine. Then tighten the lock nuts.

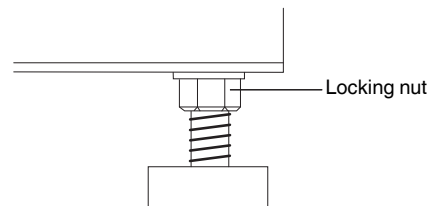

Installation

Condensed water

The machine is supplied as shown in Option 1 (inset). This means that the condensed water is pumped into the condensed water container. This must then be removed and emptied by hand.

Option 2 allows you to remove the small short hose from the nipple. Attach the rubber hose supplied to the same nipple. The water can then be pumped out into a sink or a floor drain (2a).

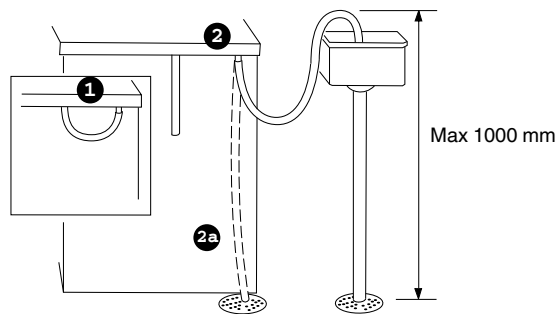

Electrical installation

The machine must only be connected to an earthed wall socket.

Connection on delivery

The machine is supplied as 1-fas, 230V, with a heat output of 1950W and a 10A fuse. Any earth fault fuses must be type A.

Switch-over

It is possible to switch over from 10A (heat output 1950W) to 16A (heat output 2500W).

1. Shut off the power
2. Press and hold the Start button, and switch on the power
3. Press the button in the centre of the program selector 5 times in 10 seconds. Turn the program selector clockwise, so that "Heater 2 off" appears in the display.
4. Press the button in the centre of the program selector once to save the setting. The machine returns to the program menu.

If you want to reset the machine to a 10A connection:

1. Repeat steps 1-4.
2. During step 3 turn the program selector until "Heater 2 off" appears on the display.
3. Press the Start button to store the setting.

The machine now has 10A connection.

Door hanging



- | | | |
|----|---|-------------------------------|
| 1. | Hinge pins (top and 4. bottom) | Locking hook |
| 2. | Cover washer | 5. Hinges (left + right side) |
| 3. | Plastic plugs (on the 6. upper and lower edges) | Plinth |

Door hanging

You can choose whether the door is hung on the right or the left.

Follow these instructions:

1. Remove the plinth.
2. Unscrew the 2 screws on the hinges.



3. Lift the door up and remove it. Support the door at the same time.
4. Remove both door pins (top and bottom). Fit them on the opposite side of the door. Refit the hinges.

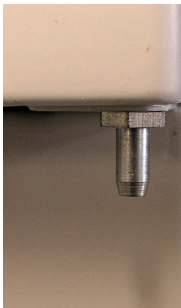

5. Undo and remove the lock hook (lift up and pull out) and the cover washer from the door and the machine. Put the hook and the washer on the other side.



6. Move the plastic plugs on the upper and lower edges of the door. Use a flat-bladed screwdriver to remove the plugs.



7. Refit the door by loosening the hinge screws slightly, affixing the door and closing it. Retighten the hinges. Replace the plinth.

Your notes

Your notes

Your notes

Quick guide

1 Fabrics

- Dry fabrics of the same type together to ensure that they dry as evenly as possible.



2 Turn on the main power switch

3 Load the laundry

- Close the door.

4 Select a program and any options

- Turn the program selector to the required program.
- Select any options and settings.

5 Press the Start button

6 Drying program finished

- The text "DONE" appears on the display when the program has finished. If the Anti crease option has been selected, the drum will rotate every minute for 2 hours after cooling.
- Clean the lint filter after each load.

7 Once tumble-drying has finished

- Turn off the mains power switch and close the door.

Program	Material	Temperature	Max. load (kg)	Energy consumption (approx. kWh)		Program time (approx. min)	
				800 rpm	1600 rpm	800 rpm	1600 rpm
Auto extra dry	Cotton, linen	Normal	7	5,4	4,3	162	129
Auto dry	Cotton, linen	Normal	7	4,6	3,6	139	109
Auto dry	Crease-resistant, polyester/cotton	Normal	3,5	2,1	-	64	-
Auto normal dry	Cotton, linen	Normal	7	4,3	3,3	130	100
Auto normal dry	Crease-resistant, polyester/cotton	Normal	3,5	1,9	-	59	-
Auto normal dry	Acrylic, rayon, acetate	Low	3,5	2,0	-	90	-
Auto Iron dry	Cotton, linen	Normal	7	3,5	2,6	104	78