

This Owner's Manual is provided and hosted by [Appliance Factory Parts](http://www.ApplianceFactoryParts.com).

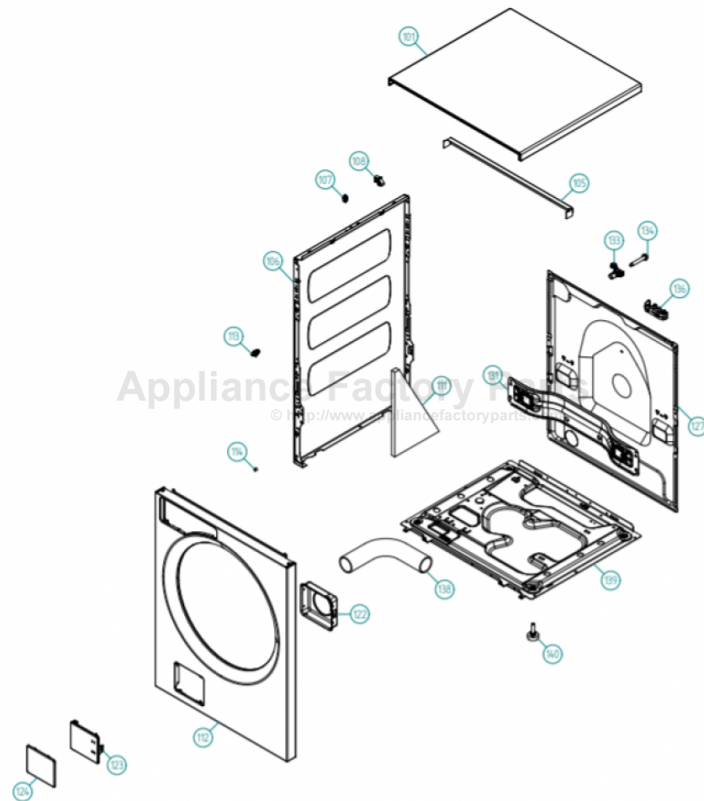

ASKO WMC63VACS Owner's Manual

[Shop genuine replacement parts for ASKO
WMC63VACS](#)



[Find Your ASKO Washer Parts - Select From 53 Models](#)

----- Manual continues below -----

Operating Instructions

Cleaning Machine

Save these instructions for future reference

Dear Customer,

Thank you for choosing this quality product from ASKO.

We hope it will meet your expectations and fulfill your needs for many years to come. Scandinavian design combines clean lines, everyday functionality, and high quality. These are key characteristics of all our products and the reason they are greatly appreciated throughout the world.

ASKO WMC63 VACS

 **ASKO**

Contents

Before using your machine for the first time	3	Installation instructions	16
Transport protection	3	Leveling the machine	16
Packing material	3	Water supply connection	16
Door	3	Drain outlet connection	16
Important safety instructions	4	Electrical Connections	17
Grounding instructions	4	Grounding instructions	17
Transport/Winter storage	5	Service and guarantee	18
Disposal	5	Warranty	18
Front panel	6	How to contact the ASKO Appliances Inc.	18
Operating instructions	7		
Sort your garments.	7		
Turn on the main power switch.	7		
Open the Door and load the garments	7		
Select the program	7		
Close the door and press the Start/Stop button	8		
Once the program has finished	8		
Settings	9		
You can change the following settings:	9		
Automatic Door Opening	9		
Select language	9		
Temperature	9		
Care and maintenance instructions	10		
Cleaning the outside of the machine	10		
Cleaning the inside of the machine to avoid unpleasant smells	10		
Rinse holes under the paddle	11		
Troubleshooting	12		
The door will not open	12		
The machine will not start	12		
Error messages	13		
Technical information	14		
Technical data	14		
Transport protection	15		

Before using your machine for the first time

Transport protection

Remove any transport protection devices before installing the machine. See the “Transport Protection Devices” chapter.

Packing material

Please sort waste materials in accordance with local guidelines.

Door

- The door cannot be opened until the machine is connected to the electricity supply.
- To open the door manually, see the section entitled “The door will not open” in the “Troubleshooting” chapter.
- It is not possible to start the machine with the door open.
- To open the door while a program is running, see the "Operating instructions" section under the heading "Close the door and press the Start/Stop button".

NOTE!

Each machine is tested before leaving the factory. A small amount of water may remain in the drain pump, though this does not affect quality or damage the machine.

Important safety instructions



Save these instructions for future reference

WARNING - To reduce the risk of fire, electric shock, or injury to persons when using your appliance, follow basic precautions, including the following:

- Read all instructions before using the appliance.
- Do not run appliance while you are out of the home.
- Do not clean or dry articles that have been previously cleaned in, washed in, soaked in, or spotted with gasoline, cooking oils, or other flammable or explosive substances because they give off vapors that could ignite or explode.
- Before the appliance is removed from service or discarded, remove the door to the cleaning compartment.
- Do not reach into the appliance if the drum is moving.
- Do not install or store this appliance where it will be exposed to the weather.
- Do not tamper with controls.
- Do not repair or replace any part of the appliance or attempt any servicing unless specifically recommended in the user-repair instructions or in published user-repair instructions that you understand and have the skills to carry out.
- Do not add gasoline, dry-cleaning solvents, or other flammable or explosive substances to the clean water. These substances give off vapors that could ignite or explode.
- Under certain conditions, hydrogen gas may be produced in a hot water system that has not been used for 2 weeks or more. **HYDROGEN GAS IS EXPLOSIVE.** If the hot water system has not been used for such a period, before using a cleaning machine or combination cleaner-dryer, turn on all water faucets and let the water flow from each for several minutes. This will release any accumulated hydrogen gas. As the gas is flammable, do not smoke or use an open flame during this time.

WARNING!



This appliance must be properly grounded.

This manual does not cover every possible condition and situation that may occur. Use common sense and caution when installing, operating, and maintaining any appliance.

Grounding instructions

A) Grounding instructions for a grounded, cord-connected appliance:

In the event of malfunction or breakdown, grounding will reduce the risk of electric shock by providing a path of least resistance for electric current. This appliance is equipped with a cord having an equipment-grounding conductor and a grounding plug. The plug must be plugged into an appropriate outlet that is properly installed and grounded in accordance with all local codes and ordinances.

WARNING!



Improper connection of the equipment-grounding conductor can result in a risk of electric shock. Check with a qualified electrician or service representative or personnel if you are in doubt as to whether the appliance is properly grounded.

Do not modify the plug provided with the appliance. If it will not fit the outlet, have a proper outlet installed by a qualified electrician.

Important safety instructions



B) Grounding instructions for a permanently connected appliance:

This appliance must be connected to a grounded metal, permanent wiring system, or an equipment-grounding conductor must be run with the circuit conductors and connected to the equipment-grounding terminal or lead on the appliance.

NOTE!

This manual does not cover every possible condition and situation that may occur. Use common sense and caution when installing, operating, and maintaining any appliance.

Transport/Winter storage

If the machine is to be transported or stored in unheated premises where the temperature can fall below freezing, do as follows:

- Empty the filter and drain pump (see the "Care and Cleaning" chapter).
- Shut off the water to the machine, loosen the supply hose to the intake valve, and let the water run out from the valve and hose.
- After emptying the pump, a small amount of water may remain in the machine. This does not affect quality or damage the machine.

Disposal

When the machine has reached the end of its service life and is to be disposed of, it should immediately be made unusable by removing the door to the cleaning compartment. Contact your local authorities for information about where your machine should be disposed of and recycled in the proper way. The machine is manufactured and labeled for recycling.

Front panel

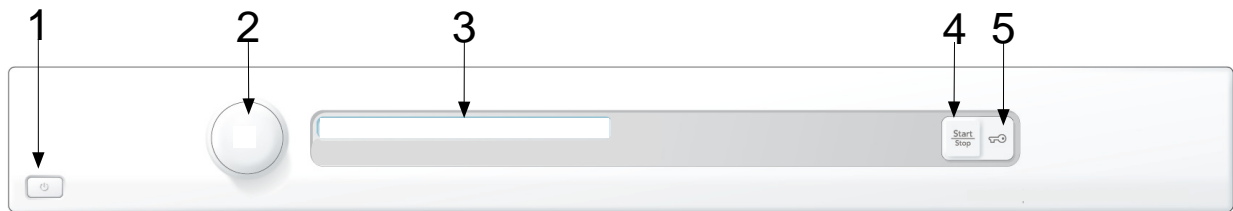

- 1 Main power switch
- 2 Program selector
- 3 Display window

- 4 Start/Stop
- 5 Door opening

Operating instructions

WARNING - To reduce the risk of fire, electric shock, or injury to persons, read the IMPORTANT SAFETY INSTRUCTIONS before operating this appliance.

1 Sort your garments.

Empty pockets. Coins, nails, and the like can cause damage to the machine and fabrics.

2 Turn on the main power switch.

3 Open the Door and load the garments

If the door is closed, press the Door Opening button (key symbol). The door will open after a few seconds. Load the garment.

4 Select the program

1. Very sensitive (high extraction)

Program for:

- Wool
- Sensitive garments

2. Silk (low extraction)

Program for:

- Silk
- Garments with beads and or sequins
- Ties
- Garments sensitive to high or medium extractions

3. All in one light (medium extraction)

Program for:

- Blended fabrics

4. All in one heavy (high extraction)

Program for:

- Blended fabrics
- Cottons and Cotton Blends

5. Rinse cold (low extraction)

Program for:

- All fabrics

6. Extraction low

Program for:

- Fabrics sensitive to medium and high extraction like, Silk and delicate fabrics

7. Extraction medium

Program for:

- All fabrics sensitive to high extraction, like light linen, cotton and micro fiber

8. Extraction high

Program for:

- Wool, heavy cotton, heavy linen
- Cotton and linen blends

9. Sanitation

Maintenance program

Operating instructions

5 Close the door and press the Start/Stop button

Time remaining

The time remaining is shown in hours and minutes. During the actual program, the time counts down in minutes. Once a program is selected, the estimated program time is displayed. This may differ from time to time depending on the temperature of the water entering the machine and the size of the load. If the program time is longer than the previous cleaning using the same program, "1" will be displayed until the program finishes. This is normal!

Stopping or changing a program

You can also stop a program by pressing the Start/Stop button for three seconds. "Stop" appears on the display. To restart the machine, select a new program, add any extra detergent needed, and press the Start/Stop button.

6 Once the program has finished

Once a program has finished, "End" appears on the display.

The door opens automatically once the program has finished. If you want to deactivate Automatic Door Opening, see the "Selecting settings" section.

- Remove the garment.
- Turn off the main power switch and you will save energy.

If you have small children or pets at home, close the door once you have removed the laundry.

Backlighting

Two minutes after the program finishes the display backlighting enters energy saving mode.

Settings

You can change the following settings:

- Automatic Door Opening
- Language
- Temperature °C/°F

Do as follows to open the settings menu:

1. Turn off the machine using the main power switch.
2. Press and hold Start/Stop and the Door Open button and switch on the machine with the main power switch. Then press the Door Open button 5 times within 10 seconds.
3. Select a setting by turning the program selector.
4. Press the program selector, make a selection, and store as described below.
5. Press Start/Stop to return to the program menu.

Automatic Door Opening

If you do not want the door to open automatically when the program is finished, you can deactivate this function.

1. Turn the program selector and choose "Automatic Door Opening On" or "Automatic Door Opening Off".
2. Press the Door Open button once to store the setting.

Select language

1. Turn the program selector to choose from: US English, English, Svenska, Dansk, Norsk, Suomi, Francais, Deutsch, Italiano, Espanol, Русский or Nederlands.
2. Press the Door Open button once to store the setting.

Temperature

1. Turn the program selector to choose between: °C and °F.
2. Press the Door Open button once to store the setting.

Care and maintenance instructions

Cleaning the outside of the machine

Clean the outside of the machine and the program panel with a mild cleaner. Do not use any solvents, as these can damage the machine.

NOTE!

Do not hose down or spray the machine with water.

Cleaning the inside of the machine to avoid unpleasant smells

To avoid unpleasant smells, we recommend running the Sanitation program once a month.

Care and maintenance instructions

Rinse holes under the paddle

If you think that objects such as nails or paper clips may have fallen into the drum, check the container under the agitator. Such objects can rust and cause spots on clothing. Nails and other sharp objects can cause holes in fabrics.

Do as follows:

1. Insert a screwdriver or similar tool into the hole on the paddle as illustrated and carefully push to the left.

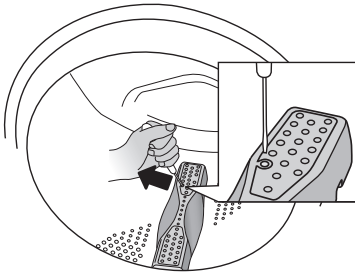

2. Use your other hand to grasp the paddle and pull it toward you.

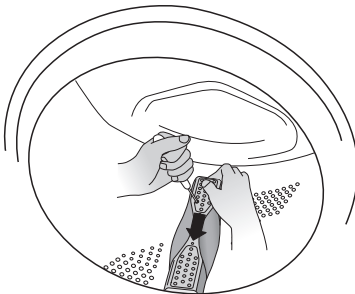

3. Lift the paddle.
4. Remove any objects.
5. Place the paddle in the mounting hole with the F-mark toward you. Ensure that all the paddle fasteners are in their holes in the drum. Push it in until it catches.

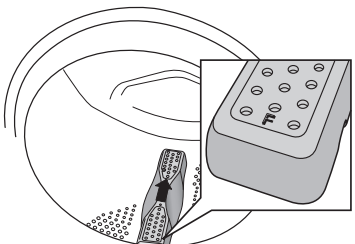

Troubleshooting

The door will not open

1. Check that the main power switch is on.
2. Is there power? Check your fuses (circuit breakers). The door cannot be opened with the door opening button (with the key symbol) if the power is off.

If nothing else works, the door can be opened as follows:

- This must only be done in an emergency if the machine's glass door does not open automatically when the program has finished.
- The water must first be drained from the machine. If the Drain program cannot be run, the machine must be drained manually. This is described under the heading "Checking the Filter and Drain pump" in the "Care and Cleaning" chapter.
- Make sure that the main power switch is off and that the plug has been removed from the wall socket.
- You will find the emergency opener for the glass door in the double sealed bag.
- Open the glass door by putting the opener in the slot to the right of the lock on the door. Push the opener up or down and the door will open. Illustration 3.

Illustration 3.

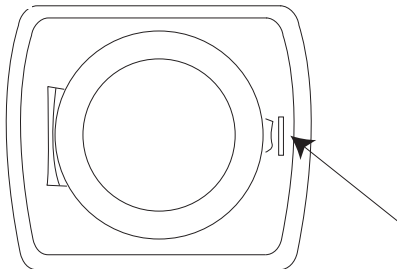

If the machine's glass door does not open the next time a cleaning program finishes, call the Customer Care Center at the number at the bottom of this page.

The machine will not start

1. Is the door properly closed? Push it firmly.
2. Is there power? Check the house fuses.

Troubleshooting

Error messages

The display indicates whether an error has occurred during the program. After taking the measures described below, turn off the machine to exit error message mode.

The error messages that may be shown are:

The door is not closed

If the display shows Close the door, you tried to start a program with the door open. Close the door and the program will start.

Over filling

If the display indicates Over filling:

1. Shut off the water tap.
2. Contact the Customer Care Center at the number listed at the bottom of this page!

Drainage error

If the display indicates a Drainage error, check:

- that no objects are stuck in the drainage hose outlet.
- that the drain pump is not blocked by foreign objects. Clean the pump (see the "Care and cleaning" chapter).
- that there are no kinks in the drainage hose.

After taking corrective action, run the Drain program or press the door opening button (key symbol) to empty the machine. If this does not resolve the problem, call the Customer Care Center.

Water intake error

If the display indicates a Water inlet fault, check:

Fault with water supply. Check:

- that the tap on the water pipe is open.
 - that the filter in the machine's water intake is not blocked.
1. Shut off the water tap.
 2. Unscrew the hose.
 3. Clean the filter in the intake valve on the machine.
 4. Screw the hose back on.
 5. Turn on the tap.
 6. Run the program again to check whether the error has been fixed.
 7. If the problem persists, contact the Customer Care Center at the number listed at the bottom of this page!

Door opening error

If the display indicates a Door opening error. Contact the Customer Care Center at the number listed at the bottom of this page!

Motor fault

If the display indicates a Motor fault. Contact the Customer Care Center at the number listed at the bottom of this page!

Technical information

Technical data

Height:	33 1/2" (850mm)
Width:	23 1/2" (597mm)
Depth:	23,0" (585mm)
Weight:	161lb (73kg)
Cylinder volume:	15,9gal (60l)
Spin speed (rpm)	1300
Rated power:	See serial number tag and rating plate.
Heater output:	See serial number tag and rating plate.
Water pressure:	14-145 psi
Drum and liquid compartment material:	Stainless steel
Outer casing material:	Powder-coated and hot-galvanized sheet steel or stainless steel.
Water connection:	59" (1.5m) pex pipe
Drain:	67" (1.7m) polypropylene hose

Transport protection

Before the machine is used, the three transport screws should be removed as shown below.

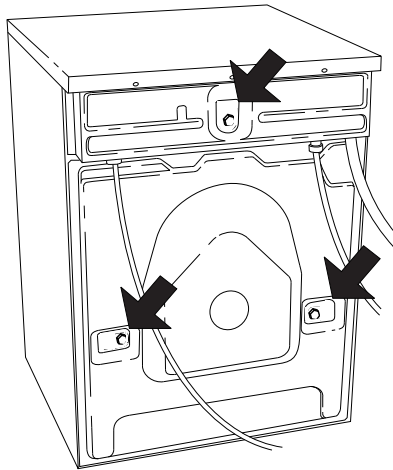

1. Loosen and remove the bolts.

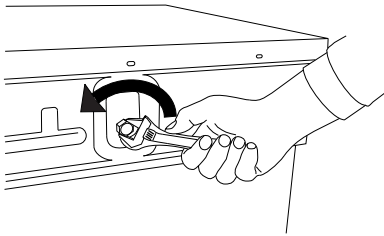

2. The enclosed plastic bag contains three plastic plugs to fit in the empty screw holes.

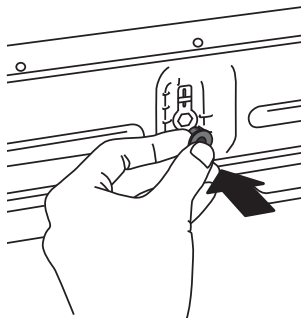

NOTE!

If the machine is to be moved and transported, the transport screws must be refitted to prevent damage to the machine through shaking. If the transport screws or plastic plugs have been lost, you can order new ones from your retailer.

Article number	Designation
----------------	-------------

80 882 77	Screw
-----------	-------

80 884 67	Plastic plug
-----------	--------------

Order three of each item!

Installation instructions

Read these instructions carefully and completely before you install the machine. The installation should be carried out by a qualified person who is familiar with all local codes and ordinances for electrical and plumbing connections.

Cosmetic damage must be reported to your dealer within five days from the date of purchase. After unpacking the machine, thoroughly check the unit for cosmetic damage.

Leveling the machine

It is important that the machine is level to prevent excessive vibrations during spin cycles. Each foot of the machine is adjustable, so you can level the machine on any surface. Once it is level, securely tighten the lock nuts on the feet to prevent excessive vibration during spin cycles.

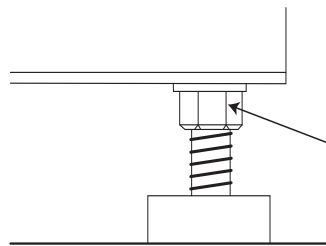

Be sure to tighten the lock nuts securely when you level the machine.

Water supply connection

Since ASKO Cleaning machines have a built-in heating element, you only need a cold water inlet. The connection should be made by someone who is sufficiently skilled. Use the hose supplied with the machine. (The inlet hose is marked for correct connection.) The water pressure must be in the range 15–146 PSI. A tap should be fitted on the water supply pipe. If a new supply pipe has been installed for the machine, it should be flushed thoroughly to remove any foreign particles that might clog the filter in the water inlet.

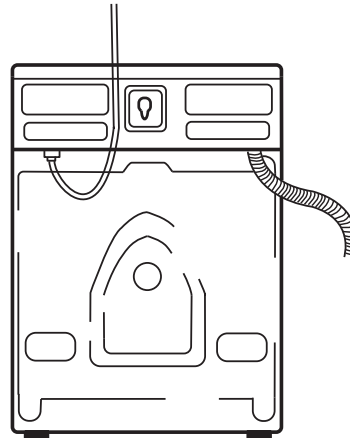

Drain outlet connection

The machine is supplied with the outlet hose already attached. The hose should be installed at a height of 24" to 36" (610 mm to 914 mm) above the bottom of the unit. (The lower height is preferable.) Make sure the hose is not kinked.

NOTE!

If the hose is extended, the internal diameter of the coupling must not be less than ½".

WARNING!



Do not extend the drain hose higher than 36" (914 mm) from the bottom of the unit.

Installation instructions

Electrical Connections

The machine is delivered ready-fitted with a plug.

As supplied: 208-240V, 60Hz, 3000W heating element, 1-Phase 15A fuse required.

WARNING!



Connection to a permanently wired supply point must be made only by a qualified electrician

Grounding instructions

This machine must be grounded. In the event of malfunction or breakdown, grounding will reduce the risk of electric shock by providing a path of least resistance for electric current. This machine is equipped with a cord having an equipment-grounding conductor and a grounding plug. The plug must be plugged into an appropriate outlet that is properly installed and grounded in accordance with all local codes and ordinances.

WARNING!



Improper connection of the equipment-grounding conductor can result in a risk of electric shock.

Check with a qualified electrician or serviceman if you are in doubt as to whether the appliance is properly grounded.

Do not modify the plug provided with the appliance. If it will not fit the outlet, have a proper outlet installed by a qualified electrician.

Service and guarantee

Warranty

For residential installations only	ASKO Appliances Inc. will pay for:
One-year Full Warranty From date of purchase.	ASKO replacement parts and/or repair labor to correct defect in materials or workmanship. Service must be provided by an authorized ASKO service agent.

ASKO Appliances Inc. will not pay for:

Service calls to:

1. Repair damage due to shipment, delivery, installation, misuse or abuse.
 2. Clean or service air device in drain line.
- Damage resulting from accident, fire, floods, acts of God, alteration, misuse, abuse, improper installation, or installation not in accordance with local electrical or plumbing codes.
 - Pickup and delivery. ASKO cleaning machines are designed to be repaired at place of business.

In no event shall ASKO Appliances Inc. be responsible for any incidental or consequential damages.

Some states will not allow the exclusion or limitation of incidental or consequential damages, so this exclusion or limitation may not apply to you. This warranty gives you specific legal rights and you may also have other rights which vary from state to state.

How to contact the ASKO Appliances Inc.

Write to us at:

ASKO Appliances Inc.
P.O. Box 940609
Plano, TX 75094-0609
www.askousa.com

Or contact our

Customer Care Center at
1-800-898-1879
www.askousa.com