

This Owner's Manual is provided and hosted by Appliance Factory Parts.

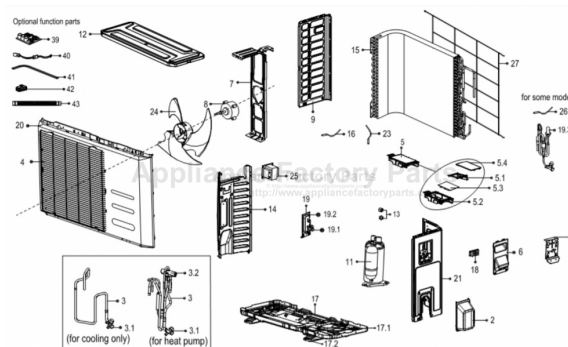

COMFORT-AIRE A-VMH18SU-1 Owner's Manual

[Shop genuine replacement parts for COMFORT-AIRE
A-VMH18SU-1](#)



[Find Your COMFORT-AIRE HVAC Parts - Select From 1486 Models](#)

----- Manual continues below -----

Comfort-Caire®

Century®

REPLACEMENT PARTS LIST

**Inverter Single Zone
Outdoor Ductless Mini-Split**

A-VMH18SU-1

EXPLODED VIEW

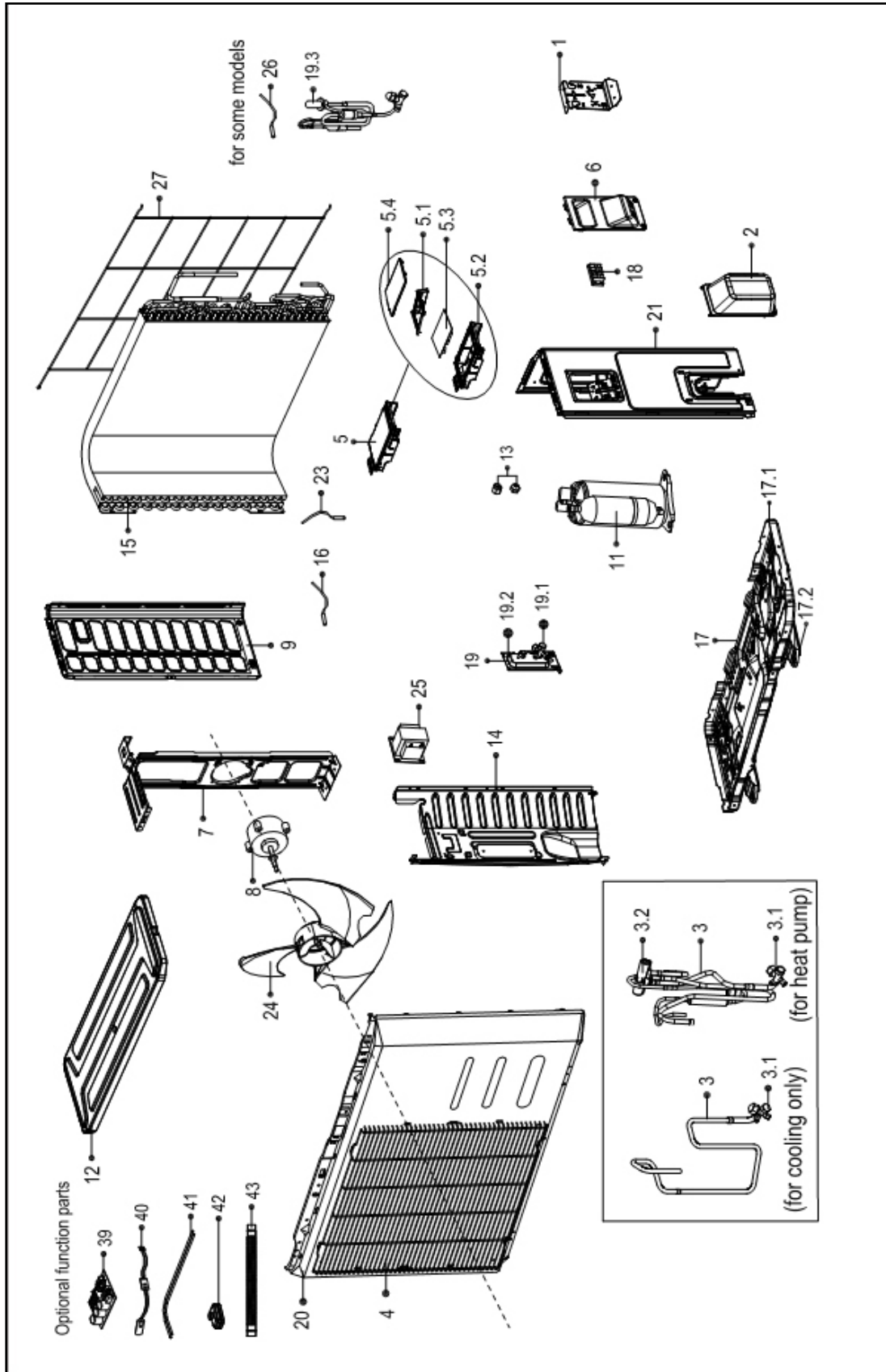

REPLACEMENT PARTS

Location	Part Name	Quantity	Part No.
1	Terminal board	1	12222000004782
2	Line set connection cover	1	12122000007150
3	4-way valve assembly	1	15422000004795
3.1	Gas valve	1	15500204000046
3.2	4-way valve	1	15500216000026
4	Air outlet grille	1	12222000007046
5	Electronic control box assembly	1	17222000009213
5.1	Support of electronic control box	1	12122000014683
5.2	Cover of electronic control box	1	12222000004827
5.3	Outdoor main control board assembly	1	17122000018581
5.4	Cover of electronic control box	1	12122000006856
6	Big handle	1	12222000005102
7	Supporter assembly of fan motor	1	12222000004884
8	Fan motor	1	11002015000397
9	Left side plate assembly	1	12222000004831
11	Compressor	1	11103020000179
12	Top cover assembly	1	12222000004835
13	Copper nut	1	15500406000012
13	Copper nut	1	15500406000016
14	Partition board assembly	1	12222000004784
15	Condenser assembly	1	15822000004516
16	Ambient temperature sensor assembly	1	11201007000039
17	Chassis assembly	1	12222000004824
18	Wire joint	1	17400401000075
19	Liquid valve assembly	1	15422000004796
19.1	Liquid valve	1	15500208000028
19.2	Valve plate	1	12222000002571
19.3	Electronic expansion valve	1	15500213000178
20	Front panel	1	12222000006304
21	Right side plate	1	12222000004830
23	Pipe temperature sensor assembly	1	11201007000069
24	Axial flow fan	1	12100105000181
25	Reactor	1	17400306000058
26	Discharge temperature sensor assembly	1	11201007000005
27	Rear net	1	12222000004833
40	Crankcase electric heater	1	17402001000119
41	Electric heater of chassis	1	17402002000043
43	Drain pipe	1	12100509000059

Due to ongoing product improvements, specifications and dimensions are subject to change and correction without notice or incurring obligations. Determining the application and suitability for use of any product is the responsibility of the installer. Additionally, the installer is responsible for verifying dimensional data on the actual product prior to beginning any installation preparations.

Incentive and rebate programs have precise requirements as to product performance and certification. All products meet applicable regulations in effect on date of manufacture; however, certifications are not necessarily granted for the life of a product. Therefore, it is the responsibility of the applicant to determine whether a specific model qualifies for these incentive/rebate programs.

Comfort-Cire®  **Century**®

1900 Wellworth Ave., Jackson, MI 49203 • Ph. 517-787-2100 • www.marsdelivers.com

Delivering Confidence