



# FARBERWARE®

## SINGLE SERVE BREWER

Model Number: 201762

UPC: 655772-01762-8

### Customer Assistance

1-855-451-2897 (US)



Please consider the option to recycle the packaging material.



## IMPORTANT SAFEGUARDS

When using electrical appliances, basic safety precautions should always be followed, including the following:

- **Read all instructions before use.**
- Do not touch hot surfaces. Use handles or knobs.
- **WARNING** - to protect against electric shock, fire and personal injury:
  - do not immerse cord, plug or appliance in water or other liquids;
  - do not immerse the cord, plug, appliance or any electrical components in water or any other liquids;
  - always switch off and unplug the appliance before cleaning.
- Close supervision is necessary when any appliance is used by or near children.
- Unplug from wall outlet when not in use and before cleaning. Allow to cool before putting on or taking off parts, and before cleaning the appliance.
- Do not operate any appliance with a damaged cord or plug, or after the appliance malfunctions or has been damaged in any manner. Call our toll-free customer assistance number for information on examination, repair, or adjustment.
- The use of accessory attachments not recommended by the appliance manufacturer may result in fire, electric shock or injuries to persons.
- Do not use outdoors or in a damp area.
- Do not place the appliance close to the edge of the countertop.
- Do not let power cord hang over edge of table or counter, or touch hot surfaces.
- Do not place on or near a hot gas or electric burner or in a heated oven.
- To turn off and disconnect, press the **ON/OFF** button, then remove plug from wall outlet.
- Do not use appliance for other than intended use.
- A fire may occur if the appliance is covered or touches flammable material, including curtains, draperies, walls, and the like, when in operation. Do not store any item on top of the appliance when in operation.
- Do not clean with metal scouring pads. Pieces can break off the pad and touch electrical parts involving a risk of electric shock.
- Never leave the appliance unattended during operation.
- Extreme caution must be used when moving an appliance containing liquids.

## SAVE THESE INSTRUCTIONS!



## IMPORTANT SAFEGUARDS

- Do not open the lid release lever, the lid or remove the capsule holder during or immediately after use. Always exercise caution when opening the lid or removing the capsule holder after use. Hot steam might be trapped beneath. Scalding may occur if the lid is opened during the brewing cycle.
- Do not use the appliance with an empty or under filled water reservoir. Ensure there is always a sufficient amount of water in the water reservoir.
- Keep the area above the appliance clear during use, as hot steam will escape the appliance.
- Do not use the appliance without a suitable cup/mug placed under the nozzle.
- Do not use the appliance without the capsule holder.
- Always use fresh and cold water for brewing.
- Do not use hot water, milk or other liquids for brewing.
- Use extreme caution when removing the capsule holder and disposing of used capsules.
- **CAUTION!** Possibility of injury! The underside of the lid and capsule holder contain sharp needles. Use caution when handling and during cleaning. Do not touch the needles.
- **CAUTION!** Do not open the lid release lever and the lid during brewing.
- **WARNING** - TO REDUCE THE RISK OF FIRE OR ELECTRICAL SHOCK, DO NOT REMOVE THE BOTTOM COVER ON THE APPLIANCE. NO USER SERVICEABLE PARTS INSIDE. REPAIR SHOULD BE DONE BY AUTHORIZED SERVICE PERSONNEL ONLY.

## SAVE THESE INSTRUCTIONS!



## ADDITIONAL SAFEGUARDS

This appliance is for **HOUSEHOLD USE ONLY**.

### **WARNING:**

- **DO NOT OPERATE THIS APPLIANCE, IF THE POWER CORD SHOWS DAMAGE OR IF APPLIANCE WORKS INTERMITTENTLY OR STOPS WORKING ENTIRELY.**
- A short power-supply cord is provided to reduce the risk resulting from becoming entangled in or tripping over a longer cord.
- Longer extension cords are available and may be used if care is exercised in their use.
- If an extension cord is used:
  - The marked electrical rating of the extension cord should be at least as great as the electrical rating of the appliance.
  - The longer cord should be arranged so that it does not drape over the countertop or table top where it can be pulled on by children or tripped over unintentionally.

### **Polarized plug**

- This appliance has a polarized plug (one blade is wider than the other). To reduce the risk of electric shock, this plug is intended to fit into a polarized outlet only one way. If the plug does not fit fully in the outlet, reverse the plug. If it still does not fit, contact a qualified electrician. Do not attempt to modify the plug in any way.
- Do not let children handle or put the electrical cord into their mouths.

## SAVE THESE INSTRUCTIONS!



# PARTS

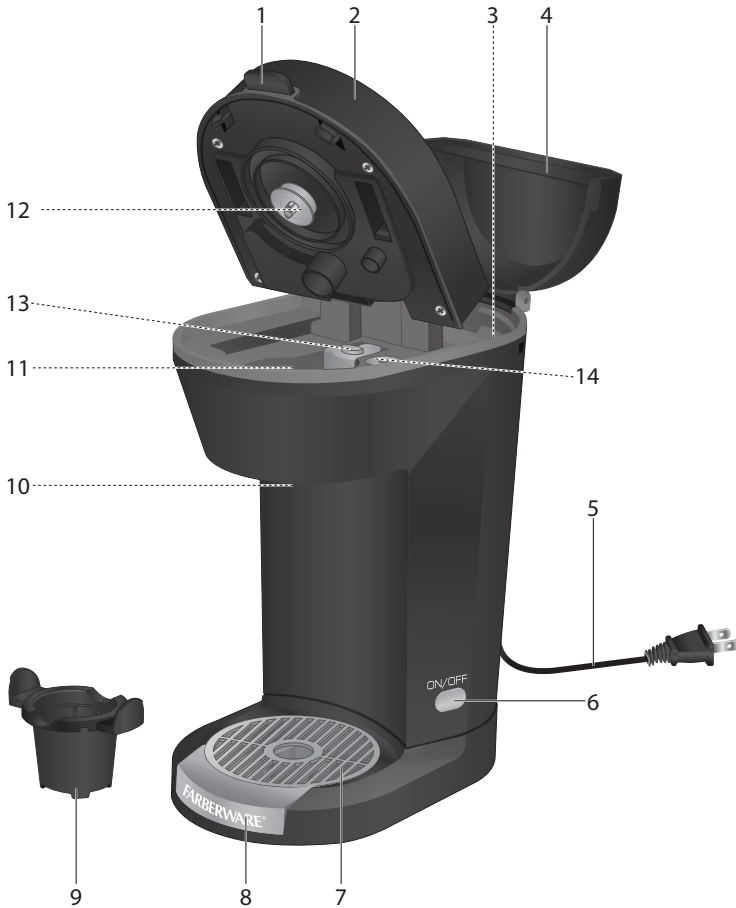

- |                               |                   |
|-------------------------------|-------------------|
| 1. Lid release lever          | 8. Drip tray      |
| 2. Lid with needle            | 9. Capsule holder |
| 3. Water reservoir            | 10. Nozzle        |
| 4. Water reservoir lid        | 11. Insert holder |
| 5. Power cord with plug       | 12. Seal 1        |
| 6. Power <b>ON/OFF</b> switch | 13. Seal 2        |
| 7. Cup holder                 | 14. Seal 3        |



# ILLUSTRATIONS

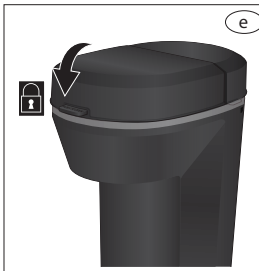
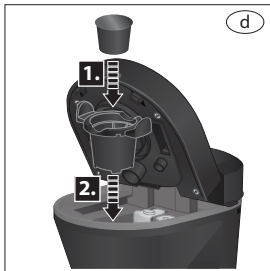
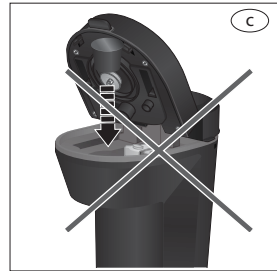
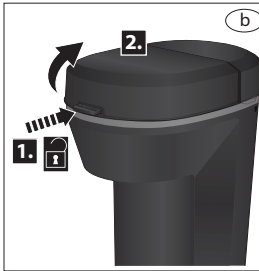
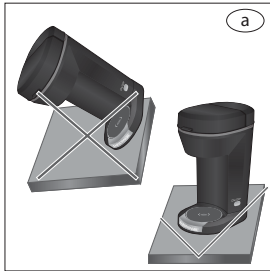



## ILLUSTRATIONS



## OPERATION

### Before first use

- Remove all packaging materials, labels and/or stickers from your appliance.
- Check package to verify all contents are included and undamaged. Do not operate the appliance if the contents are incomplete or appear damaged. Return it immediately to Walmart.

### Danger of suffocation!

- Packaging materials are not toys. Always keep plastic bags, foils and foam parts away from babies and children. Packaging material could block airways and prevent breathing.

### NOTE:

- Always use the appliance with a suitable cup/mug and fully assembled.
- The appliance may produce an odor and emit smoke when switched on for the first time, as residues from the production process are eliminated. This is normal and does not indicate a defect or hazard.



# OPERATION

- When using the appliance for the first time, it is recommended to operate it for at least 1 full cycle without a capsule (→ Operation).
- Let the appliance cool completely.
- Clean the appliance (→ Cleaning and Maintenance).

## Using the appliance

This appliance can be used for brewing coffee using K-cup capsules. Use only fresh and cold water and do not use any other liquids.

### NOTE:

- The appliance has a rated power of 600W. Before plugging it into the wall outlet, ensure that the electrical circuit is not overloaded with other appliances. This appliance should always be operated on a separate 120V ~ 60Hz wall outlet.
- Make sure the appliance is assembled before connecting it to a wall outlet.
- Place the appliance on a clean, flat and heat resistant surface (ill. **a**).
- Press the lid release lever **(1)** to unlock the lid **(2)** (ill. **b**).

### WARNING:

- Do not touch the needle on the underside of the lid **(2)** or inside the capsule holder **(9)**, they are sharp.
- Only use suitable capsules. Do not place capsules directly into the insert holder **(11)** (ill. **c**). Do not place other than the recommended capsules into the capsule holder **(9)**.
- Some capsules may not work with this appliance. If the capsule does not properly fit into the capsule holder **(9)**, or leaks during the brewing cycle, do not use that type of capsule again.
- Do not use ground coffee without a capsule in this appliance.
- Do not remove the seal 1 **(12)** & seal 2 **(13)** & seal 3 **(14)**.
- Insert a capsule in the capsule holder **(9)**. Insert the capsule holder **(9)** in the insert holder **(11)** (ill. **d**).
- Close the lid **(2)** and ensure it locks properly (ill. **e**).
- Place the drip tray **(8)** with cup holder **(7)** into the appliance (ill. **f**). Ensure they sit securely in place.
- Fill the water reservoir **(3)** with fresh cold water by opening the water reservoir lid **(4)** and pouring reservoir the water slowly into the funnel (ill. **g**).
- Fill the Water Tank to the desired level from 6 oz to 10 oz according to the markings located on the Water Reservoir.





# OPERATION

## WARNING:

- Do not over or under fill the water reservoir **(3)**. Make sure there is always sufficient water inside and that it does not exceed the MAX line.
- Securely place a cup/mug in the center of the cup holder **(10)** (ill. **(h)**).
- Insert the plug **(5)** into a wall outlet (ill. **(i)**).

## Brewing

- Push the **ON/OFF** button **(6)** to start the brewing process (ill. **(j)**).

## TIP:

- To stop the brewing cycle at any time, press the illuminated button.

## WARNING:

- Do not open the lid **(2)** or touch the appliance housing (ill. **(l)**) during use (ill. **(k)**).
- Never use the appliance with the water reservoir lid **(4)** open (ill. **(m)**) or without the capsule holder **(9)** in the insert holder **(11)** (ill. **(n)**).
- When the brew cycle is complete, the illuminated button will switch off and the Coffee Brewer will shut off.
- Disconnect the plug **(5)** from the wall outlet (ill. **(p)**).
- Remove the cup/mug from the cup holder **(7)**.
- Allow the appliance to cool down before removing the capsule holder **(9)** from the insert holder **(11)**. Always remove any used capsules after use. Remove with caution as recently used capsules can be hot.

## WARNING:

- The capsule holder is hot after using the appliance. Allow to cool before removing.
- Hot steam might be trapped under the lid **(2)**.

## NOTE:

- If you want to brew another cup/mug of coffee, allow the appliance to cool for at least 2 minutes, before starting a new brewing cycle. Always ensure the water level is suitable for your next brew. Refill the water reservoir **(3)**. Always place a new capsule in the capsule holder **(9)**. Do not reuse the same capsule. Insert capsule holder **(9)** in the insert holder **(11)** and close the lid **(2)** afterwards. Repeat previous steps (↳ Brewing).



## HINTS AND TIPS

- It is recommended to avoid placing the appliance under cabinets, as rising steam can cause damage to wooden furniture.
- Empty the drip tray after each use to prevent it from overflowing.
- Use a suitable thermal cup/mug to keep your coffee hot for longer.

## CLEANING AND MAINTENANCE

Proper maintenance will ensure many years of service from your appliance. Clean the appliance after every use. The appliance contains no user serviceable parts and requires little maintenance. Leave any servicing or repairs to qualified personnel.

### WARNING:

- Always ensure the appliance is switched off. Disconnect the plug (5) from the wall outlet before cleaning. Allow all parts of the appliance to cool down completely.
- The underside of the lid (2) and capsule holder (9) contain sharp needles. Use caution when handling and during cleaning. Do not touch the needles.

### NOTE:

- Do not immerse the power cord with plug (5), or appliance into water or any other liquids. Do not use abrasive cleaners, steel wool or scouring pads (ill. ④). Dry all parts thoroughly after cleaning, before using or storing the appliance. Ensure that no water enters the appliance housing.
- Remove the drip tray (8) with cup holder (7) and capsule holder (9) from the appliance. These parts can be washed in hot soapy water.
- Clean the surface of the appliance with a damp cloth or sponge and a mild detergent.
- Clean the appliance housing, lid (2) and insert holder (11) with a damp sponge or cloth.
- Clean all accessories after each use.

### NOTE:

- Always clean all parts that have come into contact with food in soapy water immediately after use and before storage
- Dry all parts and surfaces thoroughly before use.

## Storage

- Before storage, always make sure the appliance is completely cool, clean and dry.
- It is recommended to store the appliance in a dry place.
- Never wrap the power cord (5) around the appliance.
- Store the appliance on a stable shelf or in a cupboard. To avoid accidents, ensure that both the appliance and its power cord are beyond reach of children or pets.



# DESCALING

To keep your appliance operating effectively, periodically descale your appliance to remove any build-up of lime scale. We recommend removing lime scale deposits as follows:

- Please use a household descaler. Fill the water reservoir **(3)** with fresh water and descaler. For details refer to the instructions of descaler.
- Ensure the capsule holder **(9)** is placed in the insert holder **(11)** without capsule and the lid **(2)** is properly locked.
- Place a large mug onto the cup holder **(7)**.
- Insert the plug **(5)** into a wall outlet.
- Press the **ON/OFF** button **(6)** to start the brewing process.

## NOTE:

- Do not interrupt the process during the descaling cycle.
- Discard the solution in the mug and start another brewing process should there still be solution in the water reservoir **(3)**.
- Rinse the appliance by brewing fresh water at least 3 times afterwards without capsule holder **(9)**. Discard of the water afterwards.
- Disconnect the plug **(5)** from the wall outlet.

## NOTE:

- Alternatively, you can use white vinegar instead of household descaler. The ratio of water and white vinegar is 2:1.



# TROUBLESHOOTING

Problem	Cause	Solution
The appliance is not working	Appliance not plugged in Wall outlet not energized Appliance not switched on Malfunctioning appliance	Insert the plug into the wall outlet Check fuses and circuit breaker Switch the appliance on Unplug the appliance from the wall outlet and contact qualified personnel to check and repair the appliance
No water comes out from the nozzle	Nozzle blocked Capsule not suitable Empty water reservoir Upper/bottom of the capsule not pierced by the needle Excessive lime scale buildup	Check the nozzle for blockages Clean and descale the appliance (→ Descaling) Replace with a suitable capsule Refill the water reservoir with fresh water after a while Switch the appliance off and carefully replace the capsule
Brewing process does not start	Water reservoir is empty Start after a while	Refill the water reservoir with fresh water Thermostat has not reset
Brewing process stops before completion	Lid opened during brewing process Not enough water	Close the lid and restart Refill the water reservoir with fresh water and restart operation
Coffee flavor is too weak	Capsule used more than once Too much water used	Discard of the old capsule and use a new one Reduce the amount of water used on the next brew
Appliance is leaking during brewing cycle	Damaged capsule holder Capsule not suitable Upper/bottom of the capsule not pierced by the needle	Replace with suitable capsule holder Replace with a suitable capsule Switch the appliance off and carefully replace the capsule
Product working intermittently	This is normal Brew cycle is not complete until light turns off	No



# TROUBLESHOOTING

If additional assistance is needed, please contact our Customer Assistance at 1-855-451-2897 (US).

# TECHNICAL DATA

Rated voltage:	120V ~ 60Hz	Rated power input:	600W
Rated current:	5A	Capacity	10oz



# CUSTOMER ASSISTANCE

If you have a claim under this warranty, please call our Customer Assistance Number. For faster service, please have the model number and product name ready for the operator to assist you. This number can be found on the bottom of your appliance and on the front page of this manual.

Model Number: \_\_\_\_\_ Product Name: \_\_\_\_\_

Customer Assistance Number 1-855-451-2897

Keep these numbers for future reference!

## Two-year limited warranty

### What does your warranty cover?

- Any defect in material or workmanship.

### For how long after the original purchase?

- Two years.

### What will we do?

- Provide you with a new one.
- For those items still under warranty but no longer available, WAL-MART reserves the right to replace with a similar FARBERWARE branded product of equal or greater value.

### How do you make a warranty claim?

- Save your receipt.
- Properly pack your unit. We recommend using the original carton and packing materials.
- Return the product to your nearest Walmart store or call Customer Assistance at 1-855-451-2897.

### What does your warranty not cover?

- Parts subject to wear, including, without limitation, glass parts, glass containers, cutter/strainer, blades, seals, gaskets, clutches, motor brushes, and/or agitators, etc.
- Commercial use or any other use not found in printed directions.
- Damage from misuse, abuse, or neglect, including failure to clean product regularly in accordance with manufacturer's instructions.

## How does state law relate to this warranty?

- This warranty gives you specific legal rights, and you may also have other rights which vary from state to state or province to province.
- This warranty is in lieu of any other warranty or condition, whether express or implied, written or oral, including, without limitation, any statutory warranty or condition of merchantability or fitness for a particular purpose.
- WAL-MART, FARBERWARE and the product manufacturer expressly disclaim all responsibility for special, incidental, and consequential damages or losses caused by use of this appliance. Any liability is expressly limited to an amount equal to the purchase price paid whether a claim, however instituted, is based on contract, indemnity, warranty, tort (including negligence), strict liability, or otherwise. Some states or provinces do not allow this exclusion or limitation of incidental or consequential losses, so the foregoing disclaimer may not apply to you.

## What if you encounter a problem with this product while using it outside the country of purchase?

- The warranty is valid only in the country of purchase and if you follow the warranty claim procedure as noted.

**FARBERWARE®**

© 2018 Farberware Licensing Company, LLC. All Rights Reserved. Copyrights and Trademarks of Farberware Licensing Company, LLC, including FARBERWARE®, are used under license from Farberware Licensing Company, LLC.