



FARBERWARE®

Stainless Steel Cordless Electric Kettle

Model Number: 550243

UPC: 4897074550243

Customer Assistance

1-855-451-2897 (US)



Please consider the option to recycle the packaging material.



IMPORTANT SAFEGUARDS

When using electrical appliances, basic safety precautions should always be followed, including the following:

- **Read all instructions before use.**
- Do not touch hot surfaces. Use handles or knobs.
- **WARNING** - to protect against electric shock, fire and personal injury:
 - do not immerse cord, plug or appliance in water or other liquids;
 - do not immerse the appliance or any electrical components in water or any other liquids;
 - always switch off and unplug the appliance before cleaning.
- Close supervision is necessary when any appliance is used by or near children.
- Unplug from wall outlet when not in use and before cleaning. Allow to cool before putting on or taking off parts, and before cleaning the appliance.
- Do not operate any appliance with a damaged cord or plug, or after the appliance malfunctions or has been damaged in any manner. Call our toll-free customer assistance number for information on examination, repair, or adjustment.
- The use of accessory attachments not recommended by the appliance manufacturer may result in fire, electric shock or injuries to persons.
- Do not use outdoors or in a damp area.
- Do not let power cord hang over edge of table or counter, or touch hot surfaces.
- Do not place on or near a hot gas or electric burner or in a heated oven.
- Extreme caution must be used when moving an appliance containing hot water.
- To switch off the appliance, place the on/off switch in the off position, then remove plug from wall outlet.
- Never pull on the power cord to disconnect the appliance from the wall outlet; instead, grasp the plug and pull on the plug.
- Let the appliance cool completely before putting away or storing.
- Do not use appliance for other than intended use.
- Do not clean with metal scouring pads. Pieces can break off the pad and touch electrical parts involving a risk of electric shock.
- Scalding may occur if the water filter is removed / the lid is opened during the boiling cycles.
- Do not immerse in water.
- This appliance can be used to boil fresh, cool water only. Do not add ingredients or attempt to boil other liquids.

ADDITIONAL SAFEGUARDS

This appliance is for **HOUSEHOLD USE ONLY**.

WARNING:

- **DO NOT OPERATE THIS APPLIANCE, IF THE POWER CORD SHOWS DAMAGE OR IF APPLIANCE WORKS INTERMITTENTLY OR STOPS WORKING ENTIRELY.**
- A short power-supply cord is provided to reduce the risk resulting from it being grabbed by children, becoming entangled in, or tripping over a longer cord.
- Longer extension cords are available and may be used if care is exercised in their use.
- If an extension cord is used:
 - The marked electrical rating of the extension cord should be at least as great as the electrical rating of the appliance.
 - If the appliance is of the grounded type, the extension cord should be a grounding 3-wire cord; and



- The longer cord should be arranged so that it does not drape over the countertop or table top where it can be pulled on by children or tripped over unintentionally.

GROUNDING INSTRUCTIONS

- This appliance must be grounded while in use. Do not remove or ignore the grounding pin during use.

WARNING:

- To ensure continued protection against risk of electric shock, connect to properly grounded outlets only.

SAVE THESE INSTRUCTIONS!

PARTS

1. Lid
2. Lid release button
3. Handle
4. On/off switch with power indicator
5. Base unit
6. Power cord outlet
7. Power cord with plug
8. Cord storage
9. Electrical contact
10. Kettle
11. Heating element
12. Water level marking
13. Spout
14. Water filter

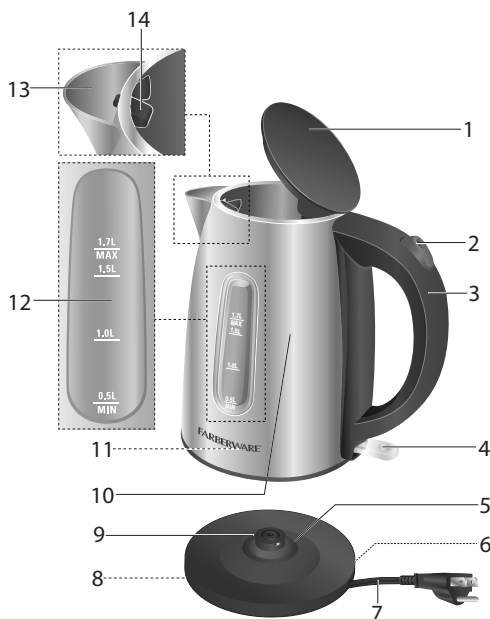

ILLUSTRATIONS

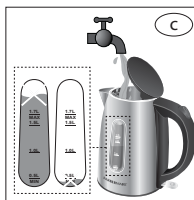
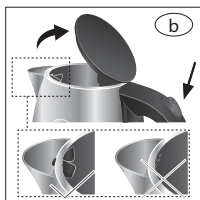
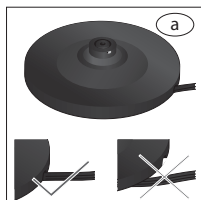



OPERATION

Before first use

- Remove all packaging materials and / or other transportation means.
- Check package to verify it is complete and undamaged. Do not operate the appliance if the contents are not complete or appear damaged. Return it immediately to Walmart.

Danger of suffocation!

- Packaging materials are not toys. Always keep plastic bags, foils and foam parts away from babies and children. Packaging material could block airways and prevent breathing.

NOTE:

- Always use the appliance with the lid (1) closed, unless filling with water.
- The appliance may produce an odor and / or emit smoke when switched on for the first time, as residues from the production process are eliminated. This is normal and does not indicate a defect or hazard. Ensure ample ventilation.
- It is recommended to boil ("Using the appliance) and discard fresh water at least twice before boiling water for consumption, as the water kettle may contain manufacturing residue. Allow the appliance to cool down between each boiling cycle.
- Let the appliance cool completely.
- Clean the appliance (→ Cleaning and Maintenance).

Using the appliance

This appliance can be used to boil fresh, cool water only. Do not add ingredients or attempt to boil other liquids.

**NOTE:**

- The appliance has a rated power of 1500W. Before plugging it into the wall outlet, ensure that the electrical circuit is not overloaded with other appliances. This appliance should always be operated on a separate 120V ~ 60Hz wall outlet.
- Make sure the appliance is switched off before connecting it to a wall outlet.
- Place the power cord (7) in the power cord outlet (6) of the base unit (5) (ill. (a)).
- Place the base unit (5) on a clean, flat and heat-resistant surface.
- Open the lid (1) by pushing the lid release button (2) (ill. (b)). Ensure the water filter (14) is correctly fitted inside the kettle (10).
- Fill the kettle (10) with fresh water. Do not fill the kettle above the **1.7L/MAX** marking or below the **0.5L/MIN** marking (ill. (c)).
- Close the lid (1). Ensure it locks in place.
- Lift the on/off switch (4) to ensure it is in the off position and place the kettle (10) fully on the base unit (5) (ill. (d)).
- Insert the plug (7) into a wall outlet (ill. (e)).

NOTE:

- Ensure a minimum distance around the appliance of at least 6-8 inches to other objects, cupboards and walls. When using the appliance on wooden furniture, use a heat resistant mat to protect the wood from damages.

WARNING:

- Never use the appliance with the lid (1) open (ill. (f)). Never use the appliance without the water filter (14) (ill. (g)).
- Do not touch the appliance during or immediately after use (ill. (h)). Only handle the appliance by its handle (3).
- Never let the power cord (7) come in contact with the appliance during use (ill. (i)).
- Do not operate the appliance when empty (ill. (j)).
- Never leave the appliance unattended during operation.
- Only use the base unit (5) provided with the kettle (10) when initially purchased. Never use a different base unit with this kettle (10).
- Push down the on/off switch (4) to the on position to switch on the appliance. The power indicator (4) will turn on (ill. (k)).

Danger of burns!

- Always pay special attention when handling the appliance. Never touch the kettle (10) and heating element (11) when the appliance is plugged in and switched on, or immediately after use.
- Escaping steam can burn.

NOTE:

- If the kettle (10) is removed from the base unit (5) while the appliance is switched on, the appliance switches off, the on/off switch (4) jumps to the off position and the power indicator (4) turns off.
- Once the water has reached boiling point, the appliance switches off automatically, the on/off switch (4) jumps to the off position and the power indicator (4) will turn off.

NOTE:

- The appliance can also be switched off manually at any time, by lifting the on/off switch (4) to the off position. The power indicator (4) will turn off.
- Lift the kettle (10) from the base unit (5) and pour the boiled water out via the spout (13).

WARNING:

- Carefully pour the boiling water with the lid closed. Do not open the lid (1) after the boiling cycle, as hot steam can escape and cause burns (ill. (l)).

**NOTE:**

- Allow the appliance to cool down before using it again. Do not add cold water immediately to the kettle (10).
- Disconnect the plug (7) from the wall outlet (ill. (m)) once the appliance is no longer in use.

Boil-dry function

This appliance is equipped with boil-dry function, which automatically switches the appliance off in case it was switched on without any water in the kettle. If this occurs, unplug the appliance and allow it to cool down completely before using it again.

WARNING:

- The heating element (11) will be very hot! Do not touch the kettle (10) or add water until the appliance cooled down completely.

HINTS AND TIPS

- It is recommended to only boil the required amount of water, as this will reduce boiling times.
- It is recommended to descale the kettle (10) and water filter (14) regularly to reduce the lime scale build-up and ensure continued performance. A build-up of mineral deposits can cause the appliance to switch off before the boiling point has been reached or prolong the boiling cycle.
- It is not recommended to place the appliance under wall units, as rising steam can cause damage to wooden cabinetwork.

CLEANING AND MAINTENANCE

Proper maintenance will ensure many years of service from your appliance. Clean the appliance after every use. The appliance contains no user serviceable parts and requires little maintenance. Leave any servicing or repairs to qualified personnel.

WARNING:

- Always place the on/off switch (4) in the off position and disconnect the plug (7) from the wall outlet before cleaning. Allow all parts of the appliance to cool down completely.

NOTE:

- Do not immerse the power cord with base unit (5), plug (7) or kettle (10) into water or any other liquids (ill. (n)). Do not use abrasive cleaners, steel wool or scouring pads. Dry all parts thoroughly after cleaning, before using or storing the appliance. Ensure that no water enters the handle (3), on/off switch (4) and base unit (5).
 - The lid (1) is not removable. Do not attempt to remove it.
-
- Remove the water filter (14) by pushing down on its tab and then towards the inside of the kettle (10) (ill. (o)).
 - Wipe the water filter (14) with a slightly damp, soft cloth and some white vinegar if needed. Rinse with fresh water afterwards. The water filter is also dishwasher safe.
 - Place the water filter (14) back inside the kettle (10) by putting it on the inside opening and pushing it back in place. Ensure the water filter tab locks in place.
 - Wipe the base unit (5) and kettle (10) with a slightly damp, soft cloth and some mild detergent if needed.



NOTE:

- Dry all parts and surfaces thoroughly before use. Make sure that all parts and surfaces are completely dry before connecting the appliance to a wall outlet.

Descaling

Periodically descale your appliance to ensure it keeps operating effectively and remove any lime scale build-up. We recommend removing lime scale deposits as follows:

- Open the lid (1) by pushing the lid release button (2). Ensure the water filter (14) is correctly placed inside the kettle (10).
- Fill the kettle (10) with water and a household descaler up to the **0.5L/MIN** marking on the water level marking (12). The ratio of water and descaler is **4:1**. For details refer to the descaler instructions.
- Close the lid (1). Ensure it locks in place.
- Lift the on/off switch (4) to ensure it is in the off position and place the kettle (10) fully on the base unit (5).
- Insert the plug (7) into a wall outlet.
- Push down the on/off switch (4) to the on position to start the boiling cycle. The power indicator (4) will turn on.
- Once the boiling cycle has finished, the appliance and the power indicator (4) will automatically switch off.
- Let the solution cool for 15 minutes before repeating the above steps twice using the same solution.
- Rinse the appliance using fresh water at least 3 times afterwards. Discard the water afterwards.
- Disconnect the plug (7) from the wall outlet.
- Alternatively, you can follow below steps:
- Open the lid (1) by pushing the lid release button (2). Ensure the water filter (14) is correctly placed inside the kettle (10).
- Fill the kettle (10) with **0.5L/MIN** of white vinegar and top off with water to the **1.7L/MAX** marking. Do not overfill.
- Close the lid (1). Ensure it locks in place.
- Allow to stand for 1 hour and then empty the kettle (10). Do not boil. Any remaining stains can be removed using a damp cloth.
- Fill the kettle (10) with fresh, clean water.
- Lift the on/off switch (4) to ensure it is in the off position and place the kettle (10) fully on the base unit (5).
- Insert the plug (7) into a wall outlet.
- Push down the on/off switch (4) to the on position to start the boiling cycle. The power indicator (4) will turn on.
- Once the boiling cycle has finished, the appliance and the power indicator (4) will automatically switch off.
- Discard the water and repeat at least twice. Discard of the water afterwards.
- Disconnect the plug (7) from the wall outlet.

Storage

- Before storage, always make sure the appliance is completely cool, clean and dry.
- The power cord (7) can be stored on the cord storage (8) underneath the base unit (5) (ill. (P)).
- It is recommended to store the appliance in a dry place.
- Store the appliance on a stable shelf or in a cupboard. To avoid accidents, ensure that both the appliance and its power cord are beyond reach of children or pets.



TROUBLESHOOTING

Problem	Cause	Solution
The appliance is not working	Appliance not plugged in Wall outlet not energized Boil-dry function activated Damaged electrical contacts on the kettle / base unit	Insert the plug into the wall outlet Check fuses and circuit breaker Disconnect the appliance from the wall outlet and allow it to cool down Disconnect the appliance from the wall outlet and contact qualified personnel to check and repair the appliance
The appliance is working but the power indicator does not light up	Damaged power indicator	Disconnect the appliance from the wall outlet and contact qualified personnel to check and repair the appliance
The power indicator lights up but the appliance does not heat up	Malfunctioning appliance	Disconnect the appliance from the wall outlet and contact qualified personnel to check and repair the appliance
The appliance heats up but the on/off switch is in the off position	Malfunctioning on/off switch	Disconnect the appliance from the wall outlet and contact qualified personnel to check and repair the appliance
The lid cannot be opened	Damaged lid / hinging system Expanded lid	Empty remaining water and contact qualified personnel to check and repair the appliance Let the appliance cool down before attempting to open it again
The appliance produces an odor	Residues from the production process are eliminated during first use Malfunctioning appliance	Boil and discard fresh water at least twice before boiling water for consumption. Allow the appliance to cool down between each boiling cycle Disconnect the appliance from the wall outlet and contact qualified personnel to check and repair the appliance

If additional assistance is needed, please contact our Customer Assistance at 1-855-451-2897 (US).

TECHNICAL DATA

Rated voltage: 120V ~ 60Hz

Rated power input: 1500W

Rated current: 12.5A

Capacity: Min. 0.5L (17oz)
Max. 1.7L (57oz)



CUSTOMER ASSISTANCE

If you have a claim under this warranty, please call our Customer Assistance Number. For faster service, please have the model number and product name ready for the operator to assist you. This number can be found on the bottom of your appliance and on the front page of this manual.

Model Number: _____ Product Name: _____

Customer Assistance Number 1-855-451-2897 (US)

Keep these numbers for future reference!

Two-year limited warranty

What does your warranty cover?

- Any defect in material or workmanship.

For how long after the original purchase?

- Two years.

What will we do?

- Provide you with a new one.
- For those items still under warranty but no longer available, WAL-MART reserves the right to replace with a similar FARBERWARE branded product of equal or greater value.

How do you make a warranty claim?

- Save your receipt.
- Properly pack your unit. We recommend using the original carton and packing materials.
- Return the product to your nearest Walmart store or call Customer Assistance at 1-855-451-2897 (US).

What does your warranty not cover?

- Parts subject to wear, including, without limitation, glass parts, glass containers, cutter/strainer, blades, seals, gaskets, clutches, motor brushes, and/or agitators, etc.
- Commercial use or any other use not found in printed directions.
- Damage from misuse, abuse, or neglect, including failure to clean product regularly in accordance with manufacturer's instructions.

How does state law relate to this warranty?

- This warranty gives you specific legal rights, and you may also have other rights which vary from state to state or province to province.
- This warranty is in lieu of any other warranty or condition, whether express or implied, written or oral, including, without limitation, any statutory warranty or condition of merchantability or fitness for a particular purpose.
- WAL-MART, FARBERWARE and the product manufacturer expressly disclaim all responsibility for special, incidental, and consequential damages or losses caused by use of this appliance. Any liability is expressly limited to an amount equal to the purchase price paid whether a claim, however instituted, is based on contract, indemnity, warranty, tort (including negligence), strict liability, or otherwise. Some states or provinces do not allow this exclusion or limitation of incidental or consequential losses, so the foregoing disclaimer may not apply to you.

What if you encounter a problem with this product while using it outside the country of purchase?

- The warranty is valid only in the country of purchase and if you follow the warranty claim procedure as noted.

FARBERWARE[®]

© 2018 Farberware Licensing Company, LLC. All Rights Reserved. Copyrights and Trademarks of Farberware Licensing Company, LLC, including FARBERWARE[®], are used under license from Farberware Licensing Company, LLC.

