

This Owner's Manual is provided and hosted by [Appliance Factory Parts](#).



# Shark S3325 Owner's Manual

[Shop genuine replacement parts for Shark S3325](#)



[Find Your Shark Vacuum Cleaner Parts - Select From 35 Models](#)

----- Manual continues below -----

# **Shark**<sup>TM</sup>

**Ultra Steam Blaster Hard Surface Cleaner**  
**Limpiadora a Vapor Ultra para Superficies Duras**  
**Outil De Nettoyage À Vapeur Ultra Puissante Pour**  
**Surfaces Dures**

**OWNER'S MANUAL**  
**MANUAL DEL USUARIO**  
**GUIDE D'UTILISATION**

**Models / Modelos / Modèles: S3325-S3325R-S3325W**  
**120V., 60Hz., 1500 Watts**



**EURO-PRO Operating LLC**  
U.S.: 94 Main Mill Street, Door 16  
Plattsburgh, NY 12901  
Canada: 4400 Bois-Franc  
St-Laurent, QC H4S 1A7  
Tel. : 1 (800) 798-7398  
[www.sharkcompany.com](http://www.sharkcompany.com)

**EURO-PRO** 

## IMPORTANT SAFETY INSTRUCTIONS

When using your **Canister Steam Cleaner**, basic safety precautions should always be observed, including the following:

1. Read all instructions before using your Canister Steam Cleaner.
  2. Use the system only for its intended use.
  3. To protect against a risk of electric shock, do not immerse any part of the system in water or other liquids.
  4. This unit should always be turned "OFF" before plugging into or unplugging from electrical outlet. Never yank cord to disconnect from outlet; instead, grasp plug and pull to disconnect.
  5. **Do not** allow cord to touch hot surfaces. Let the system cool completely before putting away or before opening the water tank (removing the safety cap). Wrap power cord loosely around your system when storing.
  6. Always disconnect system from electrical outlet when filling or emptying water tank and when not in use. Always turn the safety cap slowly when opening the water tank. This will allow any remaining steam to escape gradually.
  7. **Do not** operate the system with a damaged cord or plug, or if the appliance or any other part of the system has been dropped or damaged. To avoid the risk of electric shock, do not disassemble or attempt to repair the Canister Steam Cleaner. Return the system to **EURO-PRO Operating LLC** (see warranty) for examination and repair. Incorrect re-assembly or repair can cause a risk of electrical shock or injury to persons when the steam cleaner is used.
  8. Close supervision is necessary for any appliance being used by or near children. **Do not** leave the system unattended while connected.
  9. Burns can occur from touching hot parts, hot water or steam. **Do not** turn upside down as there may be hot water in the unit. **Never** direct steam at any person. The steam is very hot and can cause burns.
  10. **Do not** operate in the presence of explosive and/or flammable fumes.
  11. This appliance is intended only for household use. Follow all user instructions in this manual.
  12. **Never** use any chemicals or substance other than tap water or distilled water in the machine. Use of chemicals may damage the machine. **Use of chemicals will automatically void your warranty.**
- To reduce the risk of fire, electric shock, or injury:**
- **Do not** leave the Canister Steam Cleaner plugged in when unattended. Unplug the electrical cord when not in use and before servicing or refilling water tank.
  - **Do not** allow unit to be used by children as a toy. Close attention is necessary when used near children, pets or plants.
  - Use only as described in this manual. Use only manufacturer's recommended accessories.
  - When using the steam cleaner, please note that the force and the heat of the steam may damage certain surfaces or textiles. Always test on a small, concealed area of the material that you are steam cleaning, i.e. painted wood or leather can be bleached with hot steam; glossy plastic can be dulled, fabrics such as acrylic, velvet and linen can react sensitively to the temperature of the steam.
  - **Do not** hold the steam jet concentrated for too long on a single spot.
  - **Do not** pull cord, use cord as a handle, close a door on cord, or pull cord around sharp edges or corners. Keep cord away from heated surfaces.
  - **Do not** use extension cords or outlets with inadequate current carrying capacity.
  - **Do not** unplug by pulling on cord. To unplug, grasp the plug, not the cord.
  - **Do not** handle plug or steam cleaner with wet hands or operate without shoes.
  - **Do not** put any objects into openings. **Do not** use with any opening blocked.
  - Store your appliance indoors in a cool, dry area.
  - Keep your work area well lit.
  - **When in use, never turn the appliance over or on its side. Never direct steam towards people, animals or plants.**
  - **Do not** immerse the steam cleaner into water or other liquids. Always unplug the power cord from the electrical socket when filling the steam cleaner.
  - **DONOT add cleaning solutions, scented perfumes, oils or any other chemicals to the water used in this appliance as this may damage the unit or make it unsafe for use.** Use regular tap water or distilled/purified water if the tap water in your area is very hard.

**SAVE THESE INSTRUCTIONS**  
For Household Use Only

## ADDITIONAL IMPORTANT SAFEGUARDS

1. To avoid circuit overload, **do not** operate another appliance on the same socket (circuit) as the steam cleaner.
2. If an extension cord is absolutely necessary, use a 14 gage cord rated at a minimum of 15 amperes. Cords rated for less amperage may overheat. Care should be taken to arrange cord so that it cannot be pulled or tripped over.
3. **Do not** leave unattended when the system is connected to a power supply/electrical outlet.

**⚠ WARNING:** This appliance is equipped with a grounded, type 3-wire cord (3-prong plug). This plug will only fit into an electrical outlet made for a 3-prong plug. This is a safety feature. If the plug should fail to fit the outlet, contact an electrician to replace the outlet. **Do not** attempt to defeat the safety purpose of the grounding pin, part of the 3-prong plug.

**⚠ CAUTION:** Always drain condensed water from hose before use or if unit has been left idle for a period of time. To drain hose, direct nozzle into an appropriate container or sink and depress hand grip steam switch. Once hose has been drained, normal use may be resumed. **Never** direct nozzle towards people, animals or plants.

**⚠ WARNING:** Your Steam Cleaner is designed to clean hard surfaces and upholstery that will withstand high heat. **Do not** use on soft plastics and cold glass. On surfaces that have been treated with wax or some no wax floors, the sheen may be removed by the heat and steam action. **Do not** use on unsealed wood. This could cause the wood grain to rise. It is therefore recommended to test an isolated area of the surface to be cleaned before proceeding.

**IMPORTANT: DO NOT** add cleaning solutions, scented perfumes, oils or any other chemicals to the water used in this appliance. **Use regular water or distilled/purified water if the tap water in your area is very hard.**



**WARNING: Danger of Scalding.** Please use caution when using the steam cleaner. The steam emitted is very hot.

**SAVE THESE INSTRUCTIONS**  
FOR HOUSEHOLD USE ONLY

## GETTING TO KNOW YOUR CANISTER STEAM CLEANER

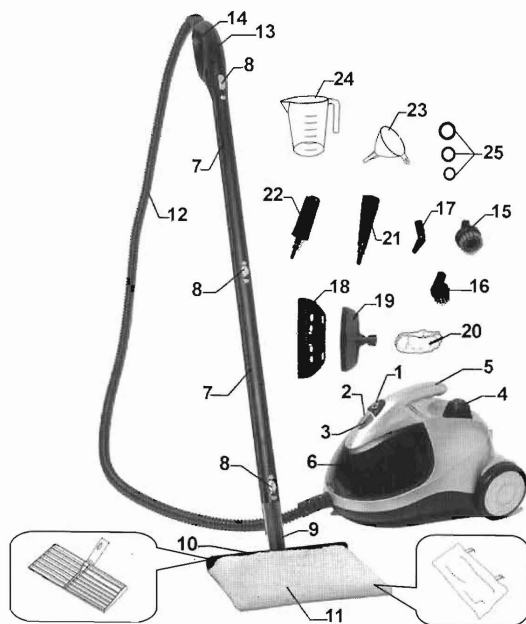

- |                                      |                               |                              |
|--------------------------------------|-------------------------------|------------------------------|
| 1. On/Off Switch                     | 10. Steam Pocket Frame        | 19. Steam Diffuser           |
| 2. Steam Ready Light (Yellow)        | 11. Steam Pocket Towel        | 20. Steam Diffuser Bonnet    |
| 3. Heating Light (Red)               | 12. Flexible Hose             | 21. Concentrator Nozzle      |
| 4. Safety Filler Cap                 | 13. Hose Hand Grip            | 22. Accessory Adapter        |
| 5. Carrying Handle                   | 14. Steam On/Off Switch       | 23. Funnel                   |
| 6. Transparent Accessory Compartment | 15. Large Brass Bristle Brush | 24. Filling Flask            |
| 7. Extension Tubes (x2)              | 16. Small Nylon Bristle Brush | 25. Replacement O-Rings (x3) |
| 8. Latch Release Button              | 17. Angle Concentrator        |                              |
| 9. Steam Pocket Angle Adapter        | 18. Window Squeegee           |                              |

### Technical Specifications

Voltage: 120V., 60Hz.  
 Power: 1500 Watts  
 Water Capacity: 47 U.S. Fl. Oz. (1400 ml)  
 Steam Generator: Stainless Steel

**IMPORTANT:** Before assembling the steam cleaner for the first time, make sure to remove any protective film from the accessory and hose ends.

## FEATURES

Your **Canister Steam Cleaner** utilizes pressurized steam to remove tough grease, dirt and grime. Steam is nature's purest and most powerful cleaner for safely cleaning all hard surfaces in your home without harsh chemicals, thus being perfectly ecological. The appliance has various attachments so that it can be used for many purposes such as:

1. Clean upholstery, sealed grout, bathroom/kitchen tile, stovetops.
2. Easy to clean difficult to reach areas with the angle adapter or concentrator such as faucets, etc.
3. Ideal for windows, mirrors, glass doors, etc.
4. Clean fabrics, window coverings, pillows, bedding etc.
5. Clean hard surface areas such as counters, sinks, shower door tracks, etc.

**WARNING:** When using your canister steam cleaner, the force and the heat of the steam may damage certain surfaces or textiles. Your **Canister Steam Cleaner** is designed to clean hard surfaces and upholstery that will withstand high heat. **Do not** use on soft plastics, unsealed wood and cold glass. On surfaces that have been treated with wax or some no wax floors, the sheen may be removed by the heat and steam action. **Do not use on unsealed wood.** This could cause the wood grain to rise. Fabrics such as acrylic, velvet and linen can react sensitively to the temperature of the steam. It is therefore recommended to test an isolated area of the surface to be cleaned before proceeding.

**CAUTION:** Do not plug in the machine during filling. Use a grounded receptacle. Use only a heavy duty extension cord rated for 15 amps – **Do not use an ordinary extension cord.**

**IMPORTANT:** **DO NOT** add cleaning solutions, scented perfumes, oils or any other chemicals to the water used in this appliance. **Use regular water or distilled/purified water if the tap water in your area is very hard.**

### Your Canister Steam Cleaner has the following features:

- **On/Off Button:** To turn the unit "On" or "Off", depress the ON/OFF button. When turned "On", the boiler will start to produce steam.
- **Heating Light (red):** This light will illuminate only when the unit is turned "On". As soon as the steam is ready, it will turn "Off".
- **Steam Ready Light (yellow):** This light will illuminate when the steam is ready to use.
- **On/Off Steam Switch:** Press the steam switch on the hose hand grip to the "On" position to start the flow of steam.
- **Safety Cap:** Always press the safety cap down and turn counter clockwise to open or clockwise to close and tighten.

## OPERATING INSTRUCTIONS

### Filling your Canister Steam Cleaner with Water

**IMPORTANT:** Always insure that the unit is **UNPLUGGED** from the wall receptacle and all switches are in the "Off" position prior to initial filling or re-filling the water tank. **Never attempt to fill this unit under a water tap, always use the filling flask and funnel provided.** Failure to follow these steps will cause the water tank to overflow and may pose an electrical safety hazard.

**RECOMMENDATION:** The use of distilled/demineralized water is recommended, particularly in areas with hard water in order to prevent the build-up of lime scale.

- Step 1:** Press the safety cap down and turn counter clockwise until removed.
- Step 2:** Assure that the steam cleaner is empty so that the addition of the prescribed amount of water will not result in overfilling.
- Step 3:** Add 47 fl. oz (1400 ml) of water using the filling flask and funnel provided. (Fig. 1) **Do not overfill.** Replace safety cap by turning clockwise - press down firmly to tighten. Heating time is **approximately 8-10 minutes.** Filling the boiler with hot water will shorten heat up time.
- Step 4:** Connect the desired accessory onto the steam hose.
- Step 5:** Plug the unit into a standard 120 volt wall receptacle. Press the On/Off switch. The Heating light (Red) will light up.
- Step 6:** Allow **approximately 8-10** minutes for water vapor to reach its working temperature. When the unit is ready for use the steam ready light will light up.
- Step 7:** Upon initial use, some water will come out from the hose nozzle. This is residual water that is left over in the hose from the last use and is normal.

**CAUTION:** Always point the nozzle outlet in a safe direction. Never point in the direction of yourself, other people or pets.



Fig. 1

**NOTE:** When the steam cleaner has run out of water, steam output will cease.

### Refilling Unit With Water

**WARNING:** Always allow the unit to cool for 15 minutes before re-filling. When re-filling the steam cleaner while it is still hot, the first drops of water might bubble up. Use caution when opening the safety cap as cap may become hot during use and escaping steam can cause scalding.

- Step 1:** Press the On/Off button on the unit to the "Off" position.
- Step 2:** Press the On/Off steam switch to the "On" position and wait until no more steam comes out of the hose.
- Step 3:** Remove the plug from the electrical outlet and allow the unit to cool for **approximately 15 minutes** before refilling with water.
- Step 4:** After completing the cool down period of step 3 (above), carefully press down on the safety cap and turn counter clockwise to loosen.

5

## OPERATING INSTRUCTIONS

**Step 5:** Slowly pour water using the filling flask and funnel provided into the boiler. **DO NOT fill under a faucet. Always use the filling flask and funnel that are provided. DO NOT OVERFILL. Never put more than 47 ounces (1400 ml) of water in the unit at one time.**

**Step 6:** Screw safety cap back on to the unit by turning clockwise and press down to tighten securely. Plug appliance back into wall outlet. Steam will start to be produced as before.

### Using Your Steam Cleaner with Steam Pocket

**Step 1:** Connect one of the extension tubes to the hand grip on the flexible steam hose. To attach the extension tubes one onto the other or onto the hand grip, press the locking button ensuring that it fits into the hole. (Fig. 2) To disconnect, repeat the operation by pressing the locking button and pulling the two sections apart.

Fig. 2

**NOTE:** Fit the steam pocket frame with the angle adapter onto the extension tube.

**Step 2:** If the angle adapter is not attached to the steam pocket frame, attach as follows: Hold the steam pocket frame in one hand and the angle adapter in the other. Insert the angle adapter stem into the opening of the steam pocket frame as shown in Fig. 3. Note that the flat on the nozzle must face toward the side of the frame with the brass pin. Once inserted, rotate it 90°.

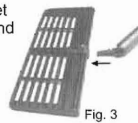

Fig. 3

### Attaching the Steam Pocket Towel to the Frame

**WARNING:** Always insure the unit is **UNPLUGGED** from the wall receptacle prior to attaching or removing accessories.

1. Slide the steam pocket towel over the steam pocket frame. (Fig. 4)

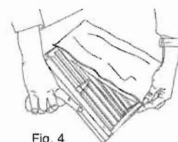

Fig. 4

2. Bring the towel all the way to the top of the steam pocket frame. (Fig. 5)

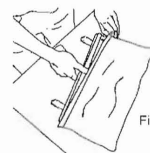

Fig. 5

3. Bring the velcro strips that are on the back side of the steam pocket towel over the steam pocket frame and attach to the inside of the front side of the steam pocket towel. (Fig. 6)

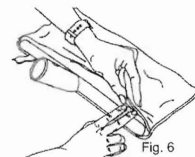

Fig. 6

6

## OPERATING INSTRUCTIONS

### Care & Maintenance of the Steam Pocket Towel

Due to the unique cleaning ability of this cloth, proper care of your micro fiber towel is required to ensure long life and continued cleaning ability.

- The first thing you should do when you get a new micro fiber towel is to wash and dry it. During the manufacturing process the fabric has a tendency to become flat as it picks up contaminants from the air and machinery. There will also be a number of loose threads that, while they cause no harm, can be annoying the first time you use the towel.
- To clean the towel, simply wash it in your washing machine using the warm water setting.
- Always wash your towels separately from other fabrics. They have a tendency to pick up lint and other particles from other fabrics and the next time you use your towel, this lint will transfer to the surface being cleaned.
- **ONLY USE LIQUID DETERGENTS!** Never use dry detergents as many times the granules do not fully dissolve and become trapped in the towel. This can scratch the surface that you are cleaning.
- **NEVER USE BLEACH OR FABRIC SOFTENERS!** Bleach will damage the micro fiber fabric and fabric softeners deposit a coating on the micro fiber fabric what **will not** allow the cloth to clean efficiently.
- Air dry the towel. **Do not** put in a clothes dryer as high heat will cause the towel to shrink and the micro fibers to break down.
- If you wash your towel on a regular basis and don't let them get too dirty, they will last much longer. As with any fabric, dirt particles, grease and other contaminants can cause the fibers to break down, therefore regular cleaning will help preserve your micro fiber towels.
- As you use the micro fiber towel, you will notice that sometimes a thread will loosen or pull out. This is normal and you should **NEVER PULL AT THE LOOSE THREAD!** Pulling the thread can cause the weave to come undone. Instead, simply trim the thread with a pair of sharp scissors.

### Attaching the Accessory Adapter

To attach the accessory adapter to the connection nozzle on the hose hand grip, push it in as far as it will go until you hear it click in place. To remove the accessory adapter, press on the locking button and pull to release it. (Fig. 7)

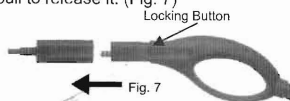

Fig. 7

### Attaching the Concentrator Nozzle

To attach the concentrator nozzle to the accessory adapter, push it in as you rotate the nozzle clockwise (when viewed with the concentrator nozzle close to you and the handle further away) to lock in place. (Fig. 8)

The accessories (brushes, steam diffuser with or without window squeegee) can now be attached onto the concentrator nozzle or it can be used alone. (Fig. 9, Fig. 10)



Fig. 8



Fig. 9

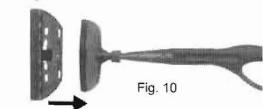

Fig. 10

**CAUTION:** Allow the unit to cool down 5 minutes before attaching or removing any accessory. Be aware of your hand placement and take care not to actuate the steam discharge switch while attaching or removing accessories.

### Using the Nylon Detail Brush

The nylon detail brush attaches to the accessory adapter and is best for cleaning the grout between tiles, ceramic or marble surfaces. Clean porcelain sinks, tubs, small spots, blinds, small appliances.

7

## OPERATING INSTRUCTIONS

### Using the Brass Detail Brush

The large brass brush attaches to the accessory adaptor and is best for cleaning ovens, stainless steel sinks and hard metal surfaces such as cast iron BBQ's.

### Using the Angle Concentrator

The angle concentrator attaches to the accessory adaptor and is best for cleaning in tight areas such as around bathroom fixtures, door tracks or under toilet bowl rims.

### Using the Steam Diffuser

Attach the steam diffuser to the accessory adaptor. You can use this attachment with or without the window squeegee (Fig. 11, Fig. 12). Use the steam diffuser with the bonnet for cleaning upholstery. Use fast, light strokes, avoid getting the fabric wet. Be patient with stubborn spots; work on a spot gently for no more than a minute at a time, then wait five minutes for the area to dry and repeat. Use circular movements or back-and-forth and side-to-side movements to get all sides of surface fibers. Finish with a brushing in one direction that will give the fabric a uniform appearance.



Fig. 11

### Using the Window Squeegee

To attach the window squeegee to the steam diffuser, place the two hinges at the back of the window squeegee (see illustration) into the two open tabs that are at the back of the steam diffuser. Swing the window squeegee up against the bottom of the steam diffuser until the locking tab engages. (Fig. 12)

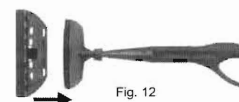

Fig. 12

**CAUTION:** When cleaning windows, always avoid any sudden changes in temperature to prevent glass breakage or cracks.

To use the window squeegee, work with the vapor jet down using the top to bottom movements. To do this without leaving streaks, use lateral movements from the top to the bottom of the surface.

The window squeegee is also perfect for cleaning mirrors, ceramic tiles and shower doors.

**CAUTION:** Always determine the color-fastness of any fabric - especially with reds or blues - by taking a clean, moist, warm towel and gently rubbing a small area as far down on the back or other out of the way place on the furniture as possible. If color comes off on the towel, you may need to have the piece dry cleaned.

8

## OPERATING INSTRUCTIONS

### Care & Maintenance

**CAUTION:** This appliance must be unplugged from the electrical outlet and allowed to cool down before performing any cleaning or maintenance tasks on the unit.

A periodic rinse of your steam cleaner will free it from deposits. This is recommended every 10-15 tankfills to free up any scale deposits. Fill the boiler with water and shake vigorously. Tilt the cleaner upside down to empty the boiler of water and any scale deposits.

If you consistently use demineralized or distilled water, cleaning the tank is unnecessary.

### Descaling your steam cleaner

If the tap water in your area contains a high level of calcium deposits and you have been using tap water to do your steam cleaning, you should descale your unit after 10-15 tankfills.

**Step 1:** Unplug the steam cleaner from the power source before you descale the boiler. Allow to cool.

**Step 2:** Fill the boiler with 1 part vinegar and 5 parts water and leave overnight or for a period of approximately 8 hours. Do not screw the safety/filler cap onto the steam cleaner while you are descaling the boiler.

**Do not use the steam cleaner while descaling solution is inside the boiler.**

**Step 3:** After the period of soaking, turn the steam cleaner upside down to empty solution from the boiler. Due to the fact that a small amount of solution will be left in the boiler, it is necessary to rinse the boiler out with clean water 2 or 3 times. Your steam cleaner is now ready for use.

### Tips On How To Use Your System

#### Water:

- Use tap water for all your cleaning needs.
- However, if you live in an area with hard water, use de-mineralized / distilled water when steaming light colored fabrics to eliminate the possibility of hard water stains.

**IMPORTANT: DO NOT** add cleaning solutions, scented perfumes, oils or any other chemicals to the water used in this appliance.

**\* Use tap water or distilled/purified water if the tap water in your area is very hard.**

**WARNING:** The steam pocket can become hot enough to burn. Make sure that you let the steam pocket cool off for 5 minutes before touching it.

#### Efficient Work

- For vertical surfaces, wipe with a towel from the top down, in this way the dirty water will not soil surfaces already cleaned.
- Avoid changing brushes back and forth while cleaning.
- Start with the smallest brush to clean tight spots and corners first.
- Use a towel to wipe dirt as soon as possible, otherwise it will dry and re-adhere to the surface.

## TIPS ON HOW TO USE YOUR SYSTEM

### Wood, Vinyl and Marble Floors

Use the Steam Pocket™ to clean wood, vinyl and marble floors. Move the Steam Pocket™ across the floor as if you are mopping. When one side of the towel is soiled, turn the Steam Pocket™ frame and use the other side. One of the great advantages of using our Steam Pocket™ is that your floor will dry faster than if you used a mop or other floor cleaning device. It is normal that some moisture may be left behind depending on how quickly you move the Steam Pocket™ across the floor and the relative heat and humidity of the room. Be sure to move quickly and steadily over wood, linoleum and vinyl flooring to avoid damaging the surface and removing wax.

**To Clean Waxed Floors:** Use the Steam Pocket™ with quick strokes. This will cause the dirt to be removed but not the wax.

**Vinyl Floors:** Do not allow heat to build up in any kind of vinyl since it can soften it enough to affect its texture. Work fast on vinyl.

**Tile Floors:** Use the concentrator with the bristle brush. Have the Steam Pocket™ ready as well. Clean the grout between the tiles with the bristle brush. Remove the concentrator and bristle brush and attach the hose and Steam Pocket™. Move the Steam Pocket™ across the floor to clean the tile and remove excess moisture and residue.

### Spot Cleaning (Carpets)

Use the concentrator with or without the bristle brush. Move slowly over the soiled area, allowing the steam to penetrate. Agitate with bristle brush or clean towel. Dab the spot with the towel (**do not rub**). Repeat as necessary to remove stain. Vacuum only after the carpet has completely dried. Always test color fastness of carpet in an inconspicuous area before cleaning. If your steam cleaner fails to remove stubborn stains a commercially available carpet shampoo may be required.

### Upholstery

Use the steam pocket or the steam diffuser with the bonnet attached directly to the hand grip. Use fast, light strokes, avoid getting the fabric wet. Be patient with stubborn spots; work on a spot gently for no more than a minute at a time, then wait five minutes for the area to dry and repeat. Use circular movements or back-and-forth and side-to-side movements to get all sides of surface fibers then blot with a towel. Finish with a brushing in one direction that will give the fabric a uniform appearance.

**CAUTION:** Always determine the color-fastness of any fabric-especially with reds or blues - by taking a clean, moist, warm towel and gently rubbing a small area as far down on the back or other out of the way place on the furniture as possible. If color comes off on the towel, you may need to have the piece dry cleaned.

### Window, Glass Surfaces and Mirrors

Use the window squeegee. Work with the vapor jet on using the top to bottom movements. Use the window squeegee with the vapor off to clear the water from the glass. To do this without leaving streaks, use lateral movements from the top to the bottom of the surface.

**CAUTION:** When cleaning windows, always avoid any sudden changes in temperature to prevent glass breakage or cracks.

**IMPORTANT: DO NOT** add cleaning solutions, scented perfumes, oils or any other chemicals to the water used in this appliance as this may damage the unit or make it unsafe for use.

## TIPS ON HOW TO USE YOUR SYSTEM

### Fiberglass or Stainless Steel Surfaces

Use the bristle brush. Slowly move the brush over the surface to be cleaned. The vapor will emulsify the dirt and grease on the surface. Follow behind with a terry cloth towel over the brush to remove excess moisture and residue.

**Tip:** An old idea for polishing stainless steel is to wipe it down with seltzer soda water after it is cleaned.

### Bathroom Areas

To clean the bathtub or shower area, use the bristle brush for grout, shower door tracks, hard to get areas and heavily soiled areas. The window squeegee will be the most efficient way to clean the rest of the area. Allow plenty of time for the heat to penetrate the surface. This is especially helpful in the shower area if there is tile or grout. Wipe with towel. Removal of soap scum on tile, grout, and shower doors is also easier with the steam cleaner.

To clean sanitary fixtures, use the concentrator with or without bristle brush. Use a terry cloth towel or paper towel to wipe up excess moisture and residue. To clean the sink and faucets, use bristle brush then finish by wiping with a towel.

### Soap Scum

Soap scum dissolves almost immediately under a combination of heat and moisture. Rinse the surface with a small amount of water afterwards or go back over it once more with a clean terry cloth towel.

**Note:** Soap scum sometimes will develop a hard surface from waterborne minerals. If this is the case, use the bristle brush to break up this surface - or spray or wipe first with lemon, vinegar or seltzer soda water to soften the minerals. Moving too slowly can dry out the soap scum and cause it to granulate on the surface. The surface will have a gritty feel. If this happens, apply vapor to the surface with the bristle brush again and re-clean.

### Garden Furniture

Use any of the brushes depending on the surface area. Work quickly when cleaning resin outdoor furniture. Finish by wiping with a towel.

### Blinds

Use the nylon bristle brush to clean blinds. Move the brush over the surface, allowing enough time for the vapor to penetrate. Work quickly on PVC blinds. Test for color fastness on fabric blinds before using. Finish by wiping with a towel.

### Artificial Plants

Use the concentrator without a brush attached to blow off the dust and dirt.

### Clothing

A vapor cleaning system is excellent for removing wrinkles from fabrics. Simply "vaporize" the surface from a distance (12"-18"). The dry vapor removes wrinkles without leaving the fabric wet like ordinary fabric steamers do. Stretch the fabric to smooth out the wrinkles.

### Nicotine and Tar

Nicotine and tar dissolves at high temperatures and becomes a light yellow oil that has the consistency of sewing machine oil. When the nicotine/tar film is touched by steam pocket, it immediately dissolves and flows into the steam pocket towel. You can remove it from flat surfaces as fast as you can move the steam pocket over the surface.

### Removing Wax, Tar, Etc.

Many stains are only stuck on the surface of materials and can be easily and quickly removed by "blowing" excess material away from the surface from the side. This is accomplished by using the concentrator. Hold the terry cloth towel to the side to catch the loose residue as it is blown by the concentrator.

**Note:** Always vacuum any loose residue off the surface before you apply vapor to it.

## TIPS ON HOW TO USE YOUR SYSTEM

### ALWAYS FINISH CLEANING BY WIPING DOWN THE CLEANED SURFACE WITH A TOWEL.

### Refrigerator

Use the concentrator to blow away dirt in the ice machine and on door seals. The vapor will not dry out or crack the seals as chemicals often do. Can openers and other kitchen equipment can be easily cleaned with the bristle brush to get into all the nooks and crannies. Mold stains around door gaskets can be removed with the bristle brush. To clean **microwaves** or **other small appliances** use the nylon bristle brush for small areas.

**Note:** When cleaning small electrical appliances always unplug them from outlet before cleaning. **Do not direct steam into any openings of the appliances.**

To clean **counter tops**, use the soap brush. For heavily soiled areas, use the soap brush with the soap solution first in order to loosen the debris, then use the scrubbing pads. Always rinse with the steam cleaner and then wipe dry with a terry cloth towel to finish.

### Hints

The steam cleaner has many uses that have not been mentioned. This was meant only to give you a general idea of what can be achieved with the unit. However, the ways in which to use the attachments and brushes are in most cases universal. It is **most** helpful to always have a terry cloth towel or paper towel ready to use for removal of moisture and residue. 100% white cotton towels work best.

You can clean the brushes with your steam cleaner. When cleaning the bristle brushes, use a pair of pliers to hold and blow dirt as above or place in the basket of your dishwasher.

**Note:** Wipe with a towel immediately before the cleaned area dries. When cleaning the oven, use the bristle brush to clean around the elements and drip trays. Use the bristle brush for cracks, crevices, and hard to reach areas.

## ORDERING SUPPLIES

If you need to order supplies such as steam pocket towels, please call the customer service number at **1 (800) 798-7398** or visit our website at **[www.sharkcompany.com](http://www.sharkcompany.com)**.