

1

**NOTE:** To prevent scratching, lay grill on packing material to assemble.



This label contains the model and serial number for your grill. You should write this information on page 2 of the LP Gas Call, Use and Care in the "Warranty Information" box.

2

**1st: Unfold legs. Do not stand cart up until front panel is attached. The front panel stabilizes the cart.**

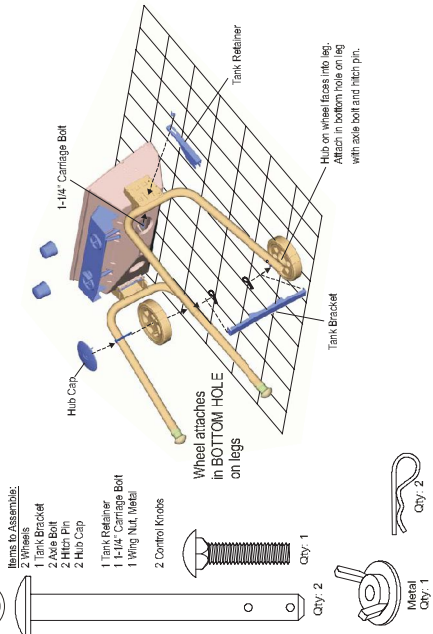

3

**Lower Panel inserts into Upper Panel**

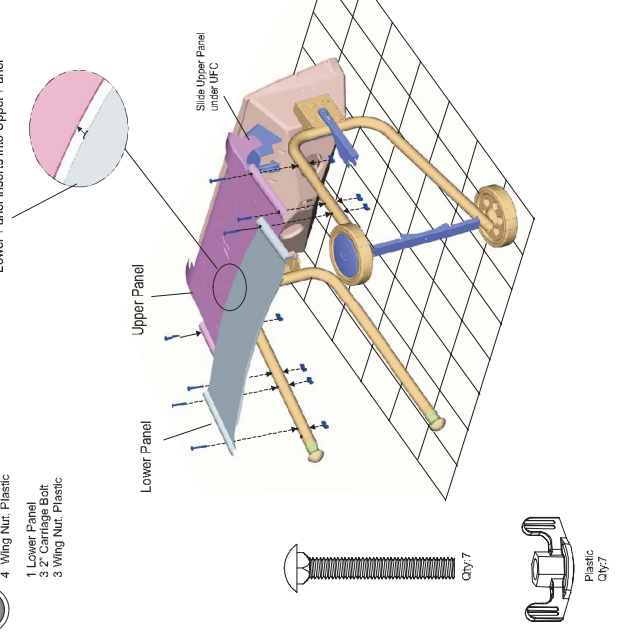

4

**Stand Cart Upright**

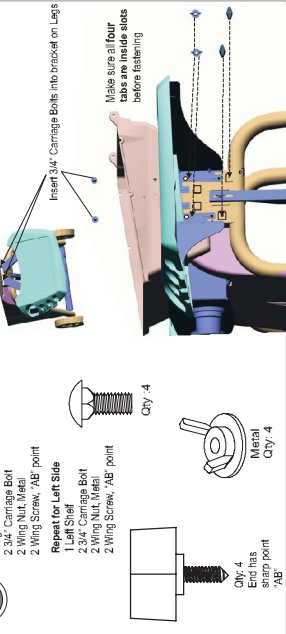

5

**1st Remove styrofoam pad**

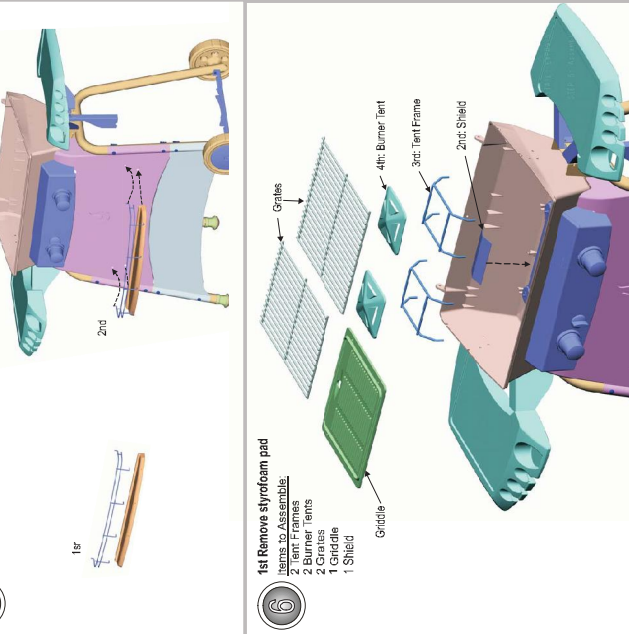

7

**Items to Assemble:**  
1 Grill Lid  
2 Hinge Pin  
2 Hitch Pin

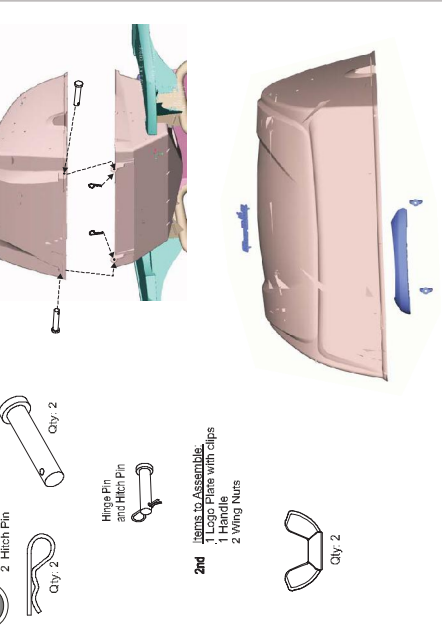

8

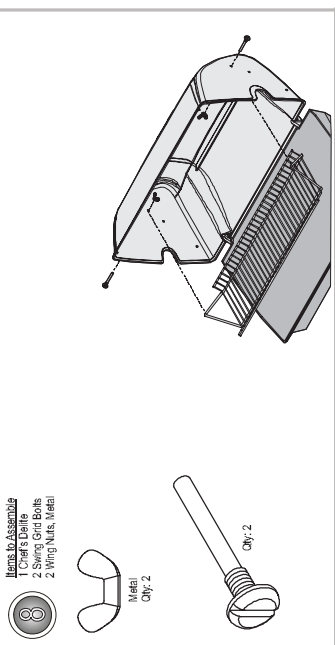

9

**Remove coupling from chain**

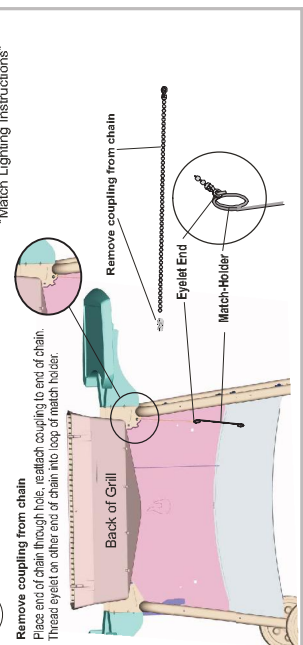

10

**Items to Assemble:**  
1 Grease Clip

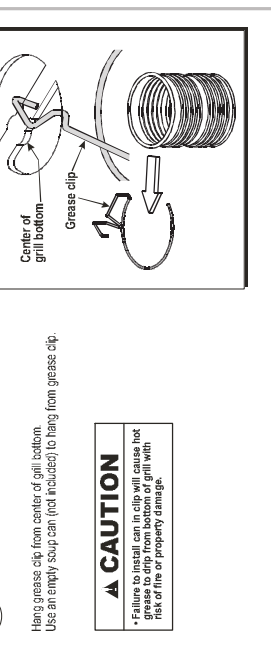

11

**Items to Assemble:**  
1 LP Tank

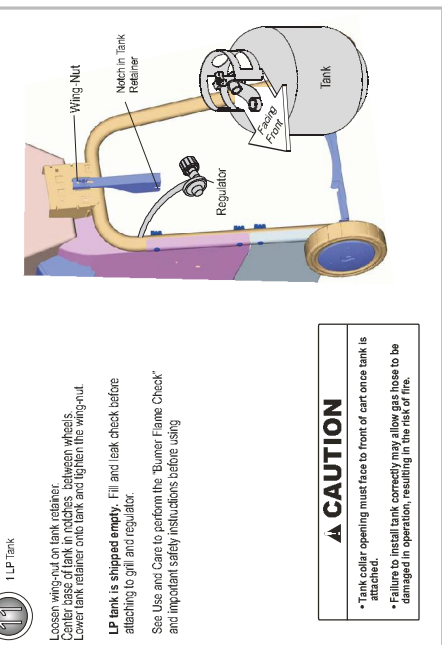

**CAUTION**  
• Failure to install can in clip will cause hot grease to drip from bottom of grill with risk of fire or property damage.

**CAUTION**  
• Tank collar opening must face to front of cart once tank is attached.  
• Failure to install tank correctly may allow gas hose to be damaged in operation, resulting in the risk of fire.