

1

NOTE: To prevent scratching, lay grill on packing material to assemble.



Remove end of rating label on back of upper panel and apply to your warranty card in box. If label is missing, contact us for further assistance on your warranty card.

NEVER store a propane grill in an enclosed space, such as a garage, porch, or tent. If you must store a propane grill in an enclosed space, use proper ventilation. Do not use a propane grill in an enclosed space. Do not use a propane grill in a tent. Do not use a propane grill in a garage. Do not use a propane grill in a porch. Do not use a propane grill in an enclosed space.

This label contains the model and serial number for your grill. You should write this information on page 2 of the LP Gas Grill Use and Care in the "Warranty Information" box.

2

1st: Unfold legs. Do not stand cart up until front panel is attached. The front panel stabilizes the cart.

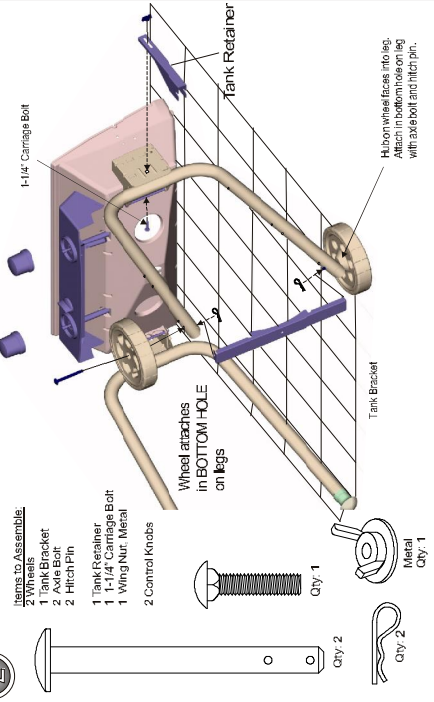

- Items to Assemble:**
- 2 Wheels
 - 1 Tank Bracket
 - 2 Axle Bolt
 - 2 Hitch Pin
 - 1 Tank Retainer
 - 1 1-1/4\"/>
 - 1 Wing Nut, Metal
 - 2 Control Knobs

Qty: 2

Qty: 1

Qty: 1

Qty: 1

Qty: 2

Qty: 2

Qty: 1

Qty: 1

Qty: 1

Qty: 1

Qty: 1

Qty: 1

Qty: 1

Qty: 1

Qty: 1

Qty: 1

Qty: 1

Qty: 1

Qty: 1

Qty: 1

Qty: 1

Qty: 1

3

Upper Panel

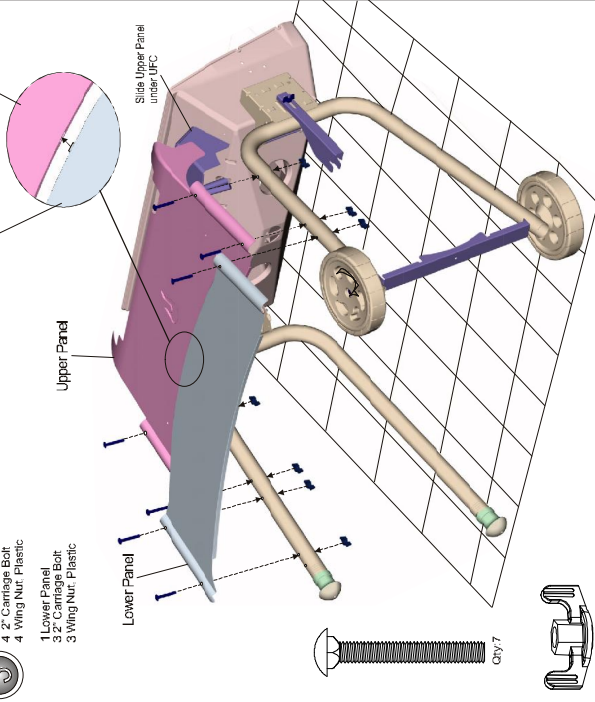

- Items to Assemble:**
- 1 Upper Panel
 - 4 2\"/>
 - 4 Wing Nut, Plastic
 - 1 Lower Panel
 - 3 2\"/>
 - 3 Wing Nut, Plastic

Qty: 7

Qty: 7

Qty: 7

Qty: 7

Qty: 7

Qty: 7

Qty: 7

Qty: 7

Qty: 7

Qty: 7

Qty: 7

Qty: 7

Qty: 7

Qty: 7

Qty: 7

Qty: 7

Qty: 7

Qty: 7

Qty: 7

Qty: 7

Qty: 7

Qty: 7

Qty: 7

Qty: 7

Qty: 7

Qty: 7

Qty: 7

Qty: 7

Qty: 7

Qty: 7

Qty: 7

Qty: 7

Qty: 7

Qty: 7

Qty: 7

Qty: 7

Qty: 7

Qty: 7

Qty: 7

Qty: 7

Qty: 7

4

Stand Cart Upright

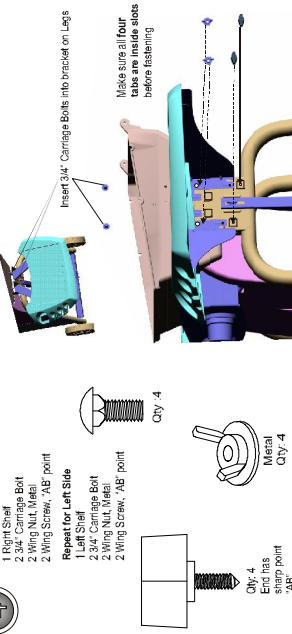

- Items to Assemble:**
- 1 Right Side Bolt
 - 2 Wing Nut, Metal
 - 2 Wing Screw, "AB" point
 - 1 Left Side Bolt
 - 2 3/4\"/>
 - 2 Wing Nut, Metal
 - 2 Wing Screw, "AB" point

Qty: 4

Qty: 4

Qty: 4

Qty: 4

Qty: 4

Qty: 4

Qty: 4

Qty: 4

Qty: 4

Qty: 4

Qty: 4

Qty: 4

Qty: 4

Qty: 4

Qty: 4

Qty: 4

Qty: 4

Qty: 4

Qty: 4

Qty: 4

Qty: 4

Qty: 4

Qty: 4

Qty: 4

Qty: 4

Qty: 4

Qty: 4

Qty: 4

Qty: 4

Qty: 4

Qty: 4

Qty: 4

Qty: 4

Qty: 4

Qty: 4

Qty: 4

Qty: 4

Qty: 4

Qty: 4

Qty: 4

Qty: 4

Qty: 4

Qty: 4

Qty: 4

Qty: 4

Qty: 4

Qty: 4

Qty: 4

Qty: 4

Qty: 4

Qty: 4

Qty: 4

Qty: 4

Qty: 4

Qty: 4

Qty: 4

Qty: 4

Qty: 4

Qty: 4

Qty: 4

Qty: 4

Qty: 4

Qty: 4

Qty: 4

Qty: 4

Qty: 4

Qty: 4

Qty: 4

Qty: 4

Qty: 4

Qty: 4

Qty: 4

Qty: 4

Qty: 4

Qty: 4

Qty: 4

Qty: 4

Qty: 4

Qty: 4

Qty: 4

Qty: 4

Qty: 4

Qty: 4

Qty: 4

Qty: 4

Qty: 4

Qty: 4

Qty: 4

Qty: 4

8

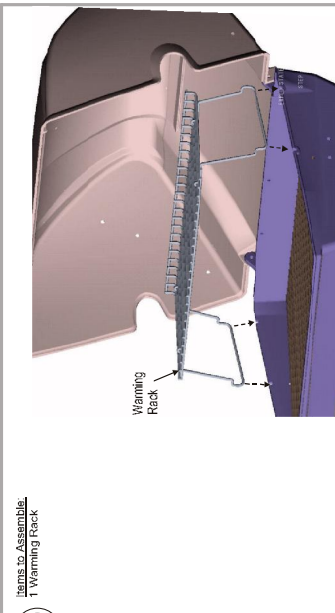

Items to Assemble:

- 1 Warming Rack

9

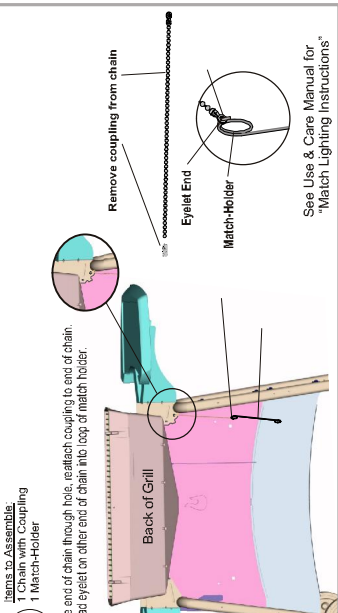

Items to Assemble:

- 1 Chain with Coupling
- 1 Match-Holder

Place end of chain through hole, reattach coupling to end of chain. Thread eyelet on other end of chain into loop of match holder.

See Use & Care Manual for "Match Lighting Instructions"

10

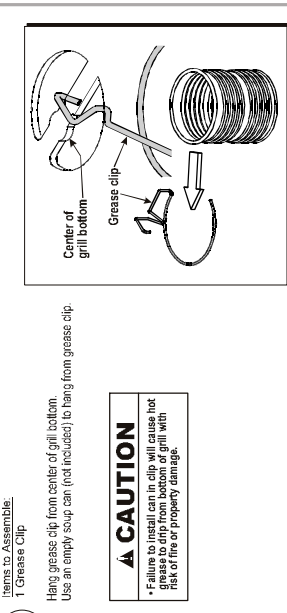

Items to Assemble:

- 1 Grease Clip

Hang grease clip from center of grill bottom. Use an empty soup can (not included) to hang from grease clip.

CAUTION

- Failure to install can in clip will cause hot grease to drip from bottom of grill with risk of fire or property damage.

11

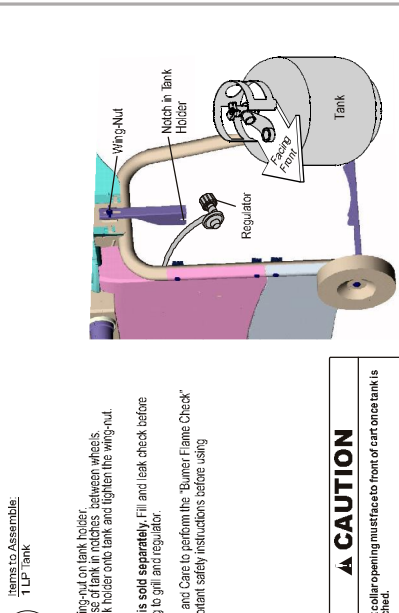

Items to Assemble:

- 1 LP Tank

Loosen wing-nut on tank holder. Slide wing-nut between wheels. Lower tank holder onto tank and tighten the wing-nut.

LP tank is sold separately. Fill and leak check before attaching to grill and regulator.

See Use and Care to perform the "Burner Flame Check" and important safety instructions before using.

CAUTION

- Tank collar opening must face to front of cart once tank is attached.
- Failure to install tank correctly may allow gas to escape to be damaged in operation, resulting in the risk of fire.