

1 Parts to assemble:
2 Leg Assembly
1 Front Panel
2 Side Support Braces
4 Carriage Bolt, 2"
4 Plastic Tee Knob

A. Lay leg assemblies on their sides.
B. Place front panel on legs.
C. Braces attach to inside of legs.
D. Secure with carriage bolts and tee knobs.

NOTE: To prevent scratching, lay grill on packing material to assemble.

2 Parts to assemble:
1 Back Support Brace
4 Carriage Bolt, 2"
4 Plastic Tee Knob

A. Turn assembly upside-down.
B. Secure back brace and side braces to legs with carriage bolts and tee knobs.

3 Parts to assemble:
1 Tank Support Bracket
2 Wheel
2 Side Bolt
2 Hitch Pin
2 Leg Extender

A. Insert side bolts through wheels, left legs and bracket. Bracket fits inside legs.
B. Secure with hitch pins in ends of side bolts.
C. Push leg extenders into right legs.

13 Parts to assemble:
1 Grease Clip

A. Insert grease clip beneath grill bottom.
B. Hang an empty soap can (not included) from grease clip.

CAUTION
Failure to install soap can clip will cause hot grease to drip from bottom of grill with risk of fire or property damage.

4 Parts to assemble:
1 Grill Bottom Assembly
4 Carriage Bolt, 1/2"
4 Metal Wing Nut

A. Stand cart upright.
B. Make sure igniter wires are connected to igniter.
C. Place grill bottom onto supports. Control panel overlaps front panel.
D. Secure with carriage bolts and wing nuts.

5 Parts to assemble:
1 Vaporizer Bar
1 Cooking Grate

A. Place vaporizer bar onto the two inner support ridges at each end of grill bottom. Bar should rest between the outer support ridges. See inset below.
B. Place cooking grate onto grill bottom.

NOTE: Ceramic briquets are not required.

6 Parts to assemble:
1 Side Shelf
4 Crown Fasteners
2 End Caps

A. Place shelf onto right legs (curved edge inward).
B. Secure with carriage bolts and crown fasteners.
C. Push end caps into left legs.

7 Parts to assemble:
1 Sideburner Body
1 Control Panel
1 Carriage Bolt, 2"
1 Metal Wing Nut

A. Place sideburner body onto legs. Insert crown screw through leg and into body.
B. Insert tab on front of sideburner frame into body, then align the rear frame hole, rear leg hole, and middle rear leg hole. Secure with carriage bolt and metal wing nut.

8 Parts to assemble:
1 Sideburner
1 Sideburner Grate
1 Sideburner Knob
1 Metal Wing Nut

A. Insert sideburner tube into frame, placing threaded stud on bottom of burner into small hole in frame. Attach from beneath with metal wing nut. Do not fully tighten.
B. Insert sideburner valve (attached to valve cap) into burner tube, then snap cap into sideburner body. Make proper engagement in inset below.
C. Press sideburner knob onto valve stem.
D. After ensuring proper valve/valve engagement, fully tighten burner wing nut.
E. Place sideburner grate onto body.
F. Locate the long sideburner igniter wire (attached to igniter behind control panel). Route wire over side support brace and attach to electrode on bottom of sideburner.

IMPORTANT: Proper valve-to-valve engagement.

9 Parts to assemble:
1 Grill Lid
1 Handle Assembly
2 Metal Wing Nut
2 Hitch Pin
2 Hitch Pin
1 Logo Plate

A. Attach lid to grill bottom with hinges and hitch pins.
B. Attach handle assembly to lid with two metal wing nuts.
C. Snap logo plate into grill lid.

10 Parts to assemble:
1 Warning Rack

A. Slide rear pivot wire of warning rack into holes in grill lid.
B. Insert leg wires into top hole of brace-hole pattern in side of grill bottom.

NOTE: Wires at rear of warning rack should point upward.

11 Parts to assemble:
1 Tank Retainer Wire
1 Carriage Bolt, 1/2"
1 Plastic Tee Knob

A. Attach retainer wire to side brace with carriage bolt and tee knob. Leave loose.

12 Parts to assemble:
1 LP Gas Tank (Not included)

LP tank is sold separately. Fill and leak check before attaching to grill and regulator.

A. Center LP tank on support bracket with collar opening to front.
B. Slide retainer over tank collar and tighten tee knob.

CAUTION
Tank collar opening must face to front of grill once tank is attached.

Failure to install tank correctly may allow gas flow to be damaged in operation, resulting in the risk of fire.

See Use & Care manual to perform the "Burner Flame Check" and for important safety instructions before using.

Parts List - Model 462636203

Key Qty.	Description	Part #	Key Qty.	Description	Part #
A	1 Handle Assembly	4000229	W	1 Sideburner Knob	4154471
B	1 Vaporizer Bar	4151038	X	1 Logo Plate	4157144
C	1 Cooking Grate	4152738	Y	1 Sideburner	5088018
D	1 Warning Rack	4152866	Z	1 Grease Clip	5156807
E	1 Side Shelf	4154279		1 Hardware Bag, Cart	4254046
F	1 Sideburner Grate	4156376		1 Hardware Bag, Shelf	4254005
G	2 Wheel	4154568		1 Hardware Bag, Sideburner	4254051
H	1 Back Support Brace	4302051		Replacement Ignition Module Bag	4306710
I	1 Sideburner Frame	4301705			
J	1 Tank Support Bracket	4302080			
K	1 Front Panel	4302118			
L	2 Side Support Braces	4302373			
M	2 Leg Assembly	4302376			
N	1 Sideburner Body	4326126			
O	4 #10x1/2", T-20, Self-Tap Screw	4280043			
P	2 Valve Clip	4156172			
Q	1 Burner/Collector Assembly	4305081			
R	1 Control Panel Assembly	4301014			
S	2 Control Knob	4154470			
T	1 Grill Bottom	4380422			
U	1 Grill Lid	4381018			
V	1 Tank Retainer Wire	4151018			

Optional Assembly Hardware
We realize some customers prefer to use tools. Optional hex nuts have been provided for you to use.

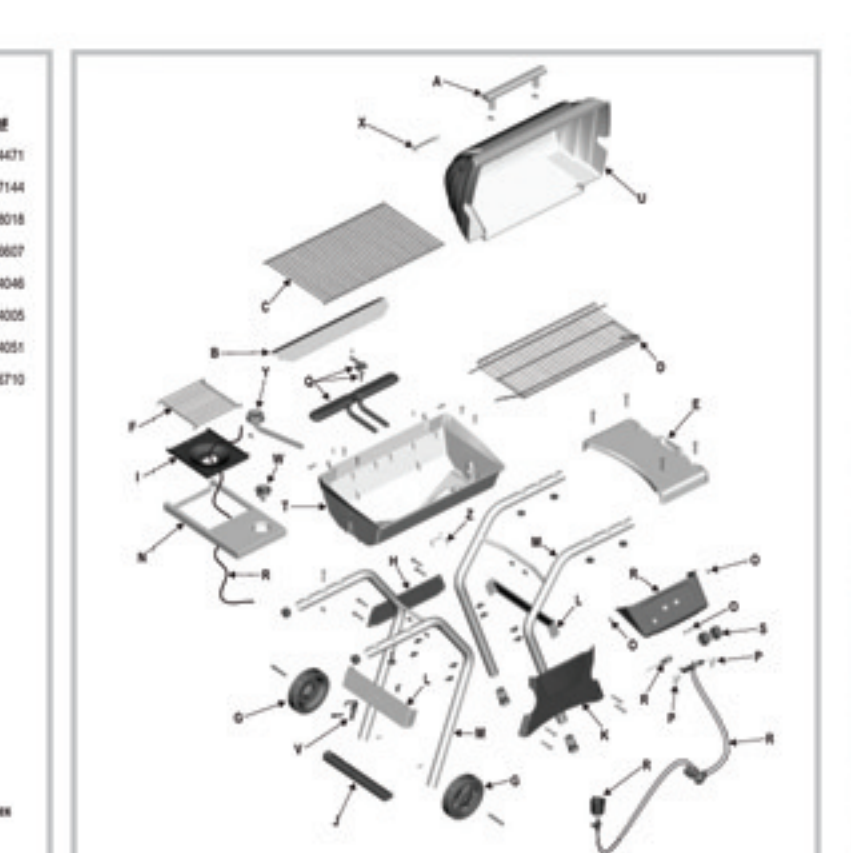

QUICKSET™
462636203
ASSEMBLY MANUAL

THERMOS®
GRILLS FOR GREAT LIVING

THIS GRILL IS FOR OUTDOOR USE ONLY

CAUTION: Read and follow all safety statements, assembly instructions, and use and care directions before attempting to assemble and cook.

INSTALLER/ASSEMBLER: Leave these instructions with consumer.

CONSUMER: Keep this manual for future reference.

WARNING
Failure to follow all manufacturer's instructions could result in serious personal injury and/or property damage.

CAUTION
Some parts may contain sharp edges - especially as noted in the manual. Wear protective gloves if necessary.

If you have any questions or need assistance during assembly, please call 1-800-241-7548.

THERMOS
COLUMBUS, GA

462636203 (1-416101) (11-23-02)