

**Parts List - Model #628120**

| Part No. | Description          | Part No. | Description          | Part No. | Description |
|----------|----------------------|----------|----------------------|----------|-------------|
| A        | Body Case            | 1        | Back Leg, Left/Right | 40211    |             |
| B        | Control Panel        | 1        | Back Leg, Cast       | 40210    |             |
| C        | Shroud/Flare         | 1        |                      |          |             |
| D        | Top Support Bar      | 1        | Back Leg, L-Bracket  | 40209    |             |
| E        | Base Case            | 40204    |                      |          |             |
| F        | Base Assembly        | 40205    |                      |          |             |
| G        | Interior Support     | 40206    |                      |          |             |
| H        | Back Plate           | 40207    |                      |          |             |
| I        | Wheel                | 40203    |                      |          |             |
| J        | LP Gas Valve         | 40212    |                      |          |             |
| K        | Flare                | 40202    |                      |          |             |
| L        | Back Support Bracket | 40207    |                      |          |             |
| M        | Control Knob         | 40201    |                      |          |             |
| N        | Flare                | 40202    |                      |          |             |
| O        | Control Panel        | 40201    |                      |          |             |
| P        | LP Gas Valve         | 40212    |                      |          |             |
| Q        | Control Knob         | 40201    |                      |          |             |
| R        | Flare                | 40202    |                      |          |             |
| S        | Control Panel        | 40201    |                      |          |             |
| T        | Control Knob         | 40201    |                      |          |             |
| U        | Igniter Knob         | 40201    |                      |          |             |

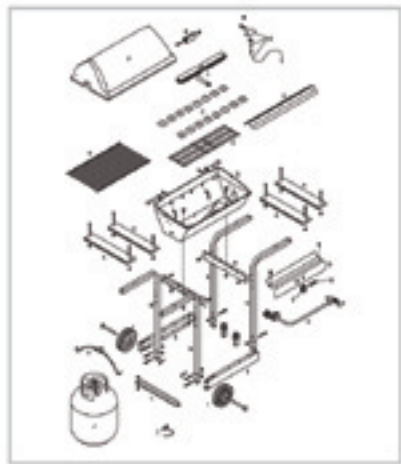

**TRADITIONAL 402120 ASSEMBLY MANUAL**

**THIS GRILL IS FOR OUTDOOR USE ONLY**

**CAUTION:** Read and follow all safety warnings, assembly instructions, and use and care instructions before attempting to assemble and use.

**INSTALLATION:** Read the instructions in the Use and Care Manual before using the grill.

**WARNING:** Do not use the grill until you have read and understood the instructions in the Use and Care Manual. Failure to do so may result in property damage, personal injury or death.

**CAUTION:** Do not touch the grill or the burner assembly until it has cooled down.

**CAUTION:** Do not use the grill until you have read and understood the instructions in the Use and Care Manual. Failure to do so may result in property damage, personal injury or death.

**FlavorMaster**