

1 Remove one of the attached handles on your grill. Use the parts list to identify and apply to your assembly unit to locate the correct handle. Always use the handles on your assembly unit.

⚠ DANGER This grill is designed for use only on a flat, level surface. Do not use on uneven ground. Do not use on a deck, porch, or other combustible surface. Do not use near flammable liquids, gases, or vapors. Do not use near children or pets. Do not use in the rain. Do not use in the wind. Do not use in the snow. Do not use in the ice. Do not use in the rain. Do not use in the snow. Do not use in the ice.

This label contains the model and serial number for your grill. You should also write this information on page 2 of your Use and Care Manual in the "Warranty Information" box.

2 Attach the front legs to the grill frame. Use the provided screws and washers to secure the legs. Do not over-tighten the screws.

3 Attach the rear legs to the grill frame. Use the provided screws and washers to secure the legs. Do not over-tighten the screws.

4 Attach the front casters to the grill frame. Use the provided screws and washers to secure the casters. Do not over-tighten the screws.

5 Attach the side rails to the grill frame. Use the provided screws and washers to secure the rails. Do not over-tighten the screws.

6 Attach the side rails to the grill frame. Use the provided screws and washers to secure the rails. Do not over-tighten the screws.

7 Attach the side rails to the grill frame. Use the provided screws and washers to secure the rails. Do not over-tighten the screws.

⚠ CAUTION Do not use the grill until the propane gas burner is properly installed and the grill is properly vented.

8 Attach the side rails to the grill frame. Use the provided screws and washers to secure the rails. Do not over-tighten the screws.

9 Attach the side rails to the grill frame. Use the provided screws and washers to secure the rails. Do not over-tighten the screws.

10 Attach the side rails to the grill frame. Use the provided screws and washers to secure the rails. Do not over-tighten the screws.

11 Attach the side rails to the grill frame. Use the provided screws and washers to secure the rails. Do not over-tighten the screws.

12 Attach the side rails to the grill frame. Use the provided screws and washers to secure the rails. Do not over-tighten the screws.

13 Attach the side rails to the grill frame. Use the provided screws and washers to secure the rails. Do not over-tighten the screws.

14 Attach the side rails to the grill frame. Use the provided screws and washers to secure the rails. Do not over-tighten the screws.

15 Attach the side rails to the grill frame. Use the provided screws and washers to secure the rails. Do not over-tighten the screws.

⚠ CAUTION Do not use the grill until the propane gas burner is properly installed and the grill is properly vented.

16 Attach the side rails to the grill frame. Use the provided screws and washers to secure the rails. Do not over-tighten the screws.

17 Before Use, Please Read! Read the Use and Care Manual for important safety instructions before using the grill.

Do not use the grill until the propane gas burner is properly installed and the grill is properly vented.

Parts List - Model 4626217

Qty	Part No.	Description	Qty	Part No.	Description
4	4626217-01	Steel Box	1	4626217-02	Propane Gas Regulator
8	4626217-03	Propane Gas Burner	1	4626217-04	Igniter
1	4626217-05	Control Panel	1	4626217-06	Knob
8	4626217-07	Knob	1	4626217-08	Knob
8	4626217-09	Knob	1	4626217-10	Knob
8	4626217-11	Knob	1	4626217-12	Knob
8	4626217-13	Knob	1	4626217-14	Knob
8	4626217-15	Knob	1	4626217-16	Knob
8	4626217-17	Knob	1	4626217-18	Knob
8	4626217-19	Knob	1	4626217-20	Knob
8	4626217-21	Knob	1	4626217-22	Knob
8	4626217-23	Knob	1	4626217-24	Knob
8	4626217-25	Knob	1	4626217-26	Knob
8	4626217-27	Knob	1	4626217-28	Knob
8	4626217-29	Knob	1	4626217-30	Knob
8	4626217-31	Knob	1	4626217-32	Knob
8	4626217-33	Knob	1	4626217-34	Knob
8	4626217-35	Knob	1	4626217-36	Knob
8	4626217-37	Knob	1	4626217-38	Knob
8	4626217-39	Knob	1	4626217-40	Knob
8	4626217-41	Knob	1	4626217-42	Knob
8	4626217-43	Knob	1	4626217-44	Knob
8	4626217-45	Knob	1	4626217-46	Knob
8	4626217-47	Knob	1	4626217-48	Knob
8	4626217-49	Knob	1	4626217-50	Knob
8	4626217-51	Knob	1	4626217-52	Knob
8	4626217-53	Knob	1	4626217-54	Knob
8	4626217-55	Knob	1	4626217-56	Knob
8	4626217-57	Knob	1	4626217-58	Knob
8	4626217-59	Knob	1	4626217-60	Knob
8	4626217-61	Knob	1	4626217-62	Knob
8	4626217-63	Knob	1	4626217-64	Knob
8	4626217-65	Knob	1	4626217-66	Knob
8	4626217-67	Knob	1	4626217-68	Knob
8	4626217-69	Knob	1	4626217-70	Knob
8	4626217-71	Knob	1	4626217-72	Knob
8	4626217-73	Knob	1	4626217-74	Knob
8	4626217-75	Knob	1	4626217-76	Knob
8	4626217-77	Knob	1	4626217-78	Knob
8	4626217-79	Knob	1	4626217-80	Knob
8	4626217-81	Knob	1	4626217-82	Knob
8	4626217-83	Knob	1	4626217-84	Knob
8	4626217-85	Knob	1	4626217-86	Knob
8	4626217-87	Knob	1	4626217-88	Knob
8	4626217-89	Knob	1	4626217-90	Knob
8	4626217-91	Knob	1	4626217-92	Knob
8	4626217-93	Knob	1	4626217-94	Knob
8	4626217-95	Knob	1	4626217-96	Knob
8	4626217-97	Knob	1	4626217-98	Knob
8	4626217-99	Knob	1	4626217-100	Knob

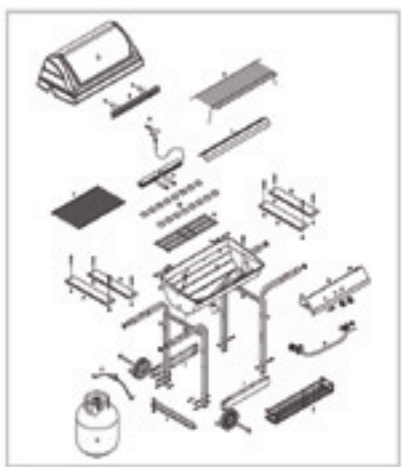

TRADITIONAL 4626217 ASSEMBLY MANUAL

NOTHING SHOULD COME BETWEEN A MAN AND HIS FLAME.

⚠ WARNING This grill is designed for use only on a flat, level surface. Do not use on uneven ground. Do not use on a deck, porch, or other combustible surface. Do not use near flammable liquids, gases, or vapors. Do not use near children or pets. Do not use in the rain. Do not use in the wind. Do not use in the snow. Do not use in the ice.

⚠ CAUTION Do not use the grill until the propane gas burner is properly installed and the grill is properly vented.

Char-Broil