

**NOTHING  
SHOULD COME BETWEEN  
A MAN  
AND HIS FLAME.**

**PRECISION FLAME®**

**4638278  
ASSEMBLY MANUAL**



**THIS GRILL IS FOR  
OUTDOOR USE ONLY**

**CAUTION:** Read and follow all safety statements, assembly instructions, and use and care directions before attempting to assemble and cook.

**INSTALLER/ASSEMBLER:** Leave these instructions with consumer.

**CONSUMER:** Keep this manual for future reference.

**▲ WARNING**

Failure to follow all manufacturer's instructions could result in serious personal injury and/or property damage.

**▲ CAUTION**

Some parts may contain sharp edges – especially as noted in the manual! Wear protective gloves if necessary.

If you have any questions or need assistance during assembly, please call **1-800-241-7548**.

Visit us on the web at:  
[www.charbroil.com](http://www.charbroil.com)

**Char-Broil**



## Parts List - Model 4638278

<u>Key</u>	<u>Qty.</u>	<u>Description</u>	<u>Part #</u>	<u>Key</u>	<u>Qty.</u>	<u>Description</u>	<u>Part #</u>
A	1	Handle . . . . .	4059000	AA	1	Grill Lid . . . . .	4580000
B	1	Cooking Grate, Small . . . . .	4152054	BB	1	Grill Bottom . . . . .	4581737
C	1	Cooking Grate, Large . . . . .	4152055	CC	1	9 Volt Battery . . . . .	4068018
D	1	Swing-Grid . . . . .	4152058	DD	2	Towel Bar . . . . .	4156084
E	1	Console . . . . .	4152405	EE	1	Stainless Series Logo Plate . . . . .	4157094
F	2	Front Panel . . . . .	4502938	FF	1	Char-Broil Logo Plate . . . . .	4157148
G	1	Spark Module/Bracket . . . . .	4507039	GG	1	Burner Support Bracket . . . . .	4501321
H	---	Briquets (1 bag) . . . . .	4158125	HH	4	Control Knob . . . . .	4154431
I	1	Sideburner Grate . . . . .	4156376	II	1	Grease Clip . . . . .	5156607
J	1	Valve Bracket . . . . .	4501004	JJ	1	Ignition Bag . . . . .	4506708
K	1	Sideburner Frame . . . . .	4501394		1	Hardware Bag - Lid/Handle . . . . .	4253274
L	1	Briquet Plate . . . . .	4501749		1	Hardware Bag - Cart . . . . .	4253750
M	1	Drip VapoRISER Bar . . . . .	4501751		1	Hardware Bag - Elec. Ignition . . . . .	4253753
N	1	HeatWave Burner . . . . .	4509037		1	Hardware Bag - Shelves . . . . .	4253754
O	1	Valve/Hose/Regulator . . . . .	4524074				
P	1	Tube Burner . . . . .	5068008				
Q	1	Sideburner . . . . .	5068012				
R	1	Tank Wire . . . . .	4154195				
S	2	Caster/Socket Set . . . . .	4154422				
T	1	LP Gas Tank . . . . .	4158015				
U	1	Tank Support Bracket . . . . .	4502733				
V	2	Rail . . . . .	4502776				
W	2	Leg Assembly . . . . .	4502875				
X	1	Brace . . . . .	5502006				
Y	1	Sideburner Shelf . . . . .	4526087				
Z	1	Control Panel Shelf . . . . .	4526088				

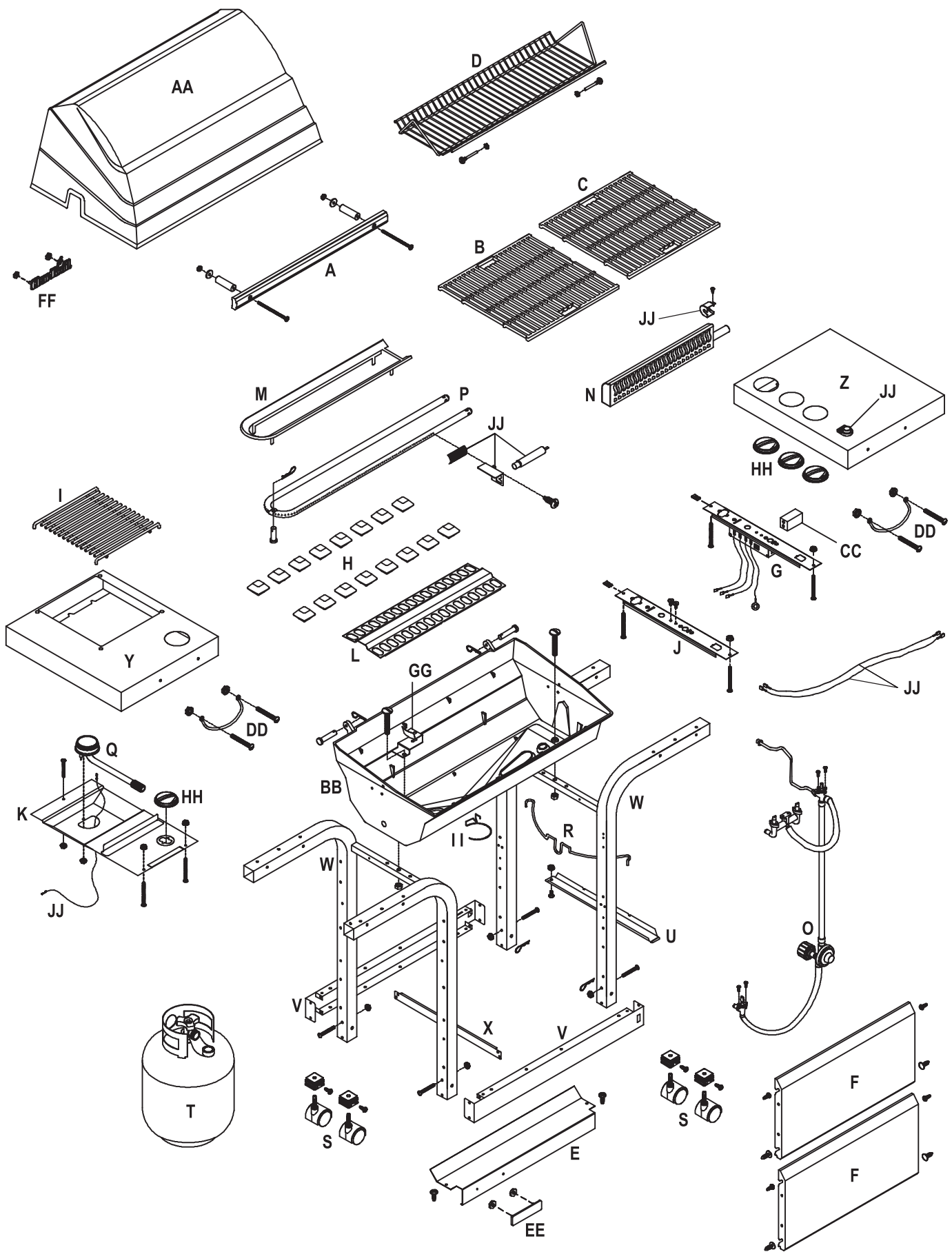

Qty. 2

Diagram C shows an angle flanged tank support being inserted into a slot on the rail. The support is shown below the rail, with an arrow pointing upwards into the slot. The rail is labeled 'Labels'.

Angle flanged end of tank support bracket into slot on rail.

**NOTE:** One bolt and nut only through rail and brace.  
(Top hole in rail.)

A diagram of a vertical spring. It consists of a coiled spring with a mass on top. The mass is represented by a horizontal bar with a small vertical line in the center, indicating a point of attachment or a specific feature of the mass.

Qty. 3



Qty. 1

**NOTE:** One bolt and nut only through rail and brace. (Top hole in rail.)

### Rail with labels

Slot on  
rail is to  
right side

Remove end of rating label located on your grill's rail (see parts list to identify) and apply to your warranty card in box #5. If label cannot be removed, write the numbers on your warranty card.

**This label contains the model and serial number for your grill. You should also**

write this information on page 2 of your Use and Care Manual in the "Warranty Information" box.

**End of tank support bracket is inside rail.**

# 3



Qty. 4

▲ Align holes in  
caster socket  
with holes on  
rail/leg

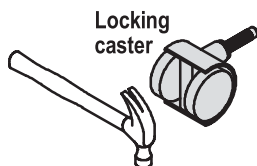
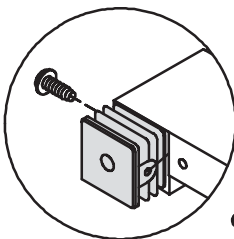

Locking  
caster

**TIP:** Use the flat side of a  
hammer head to gently tap  
caster into caster socket.



# 4

**Fully tighten after  
console is attached.**

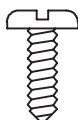

Qty. 4

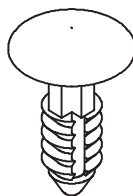

Qty. 4

Repeat for top panel

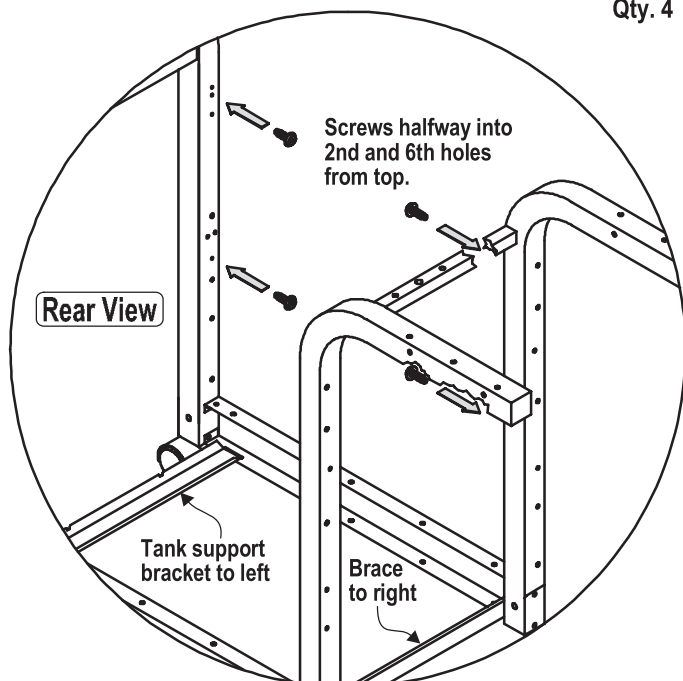

Rear View

Screws halfway into  
2nd and 6th holes  
from top.

Tank support  
bracket to left

Brace  
to right

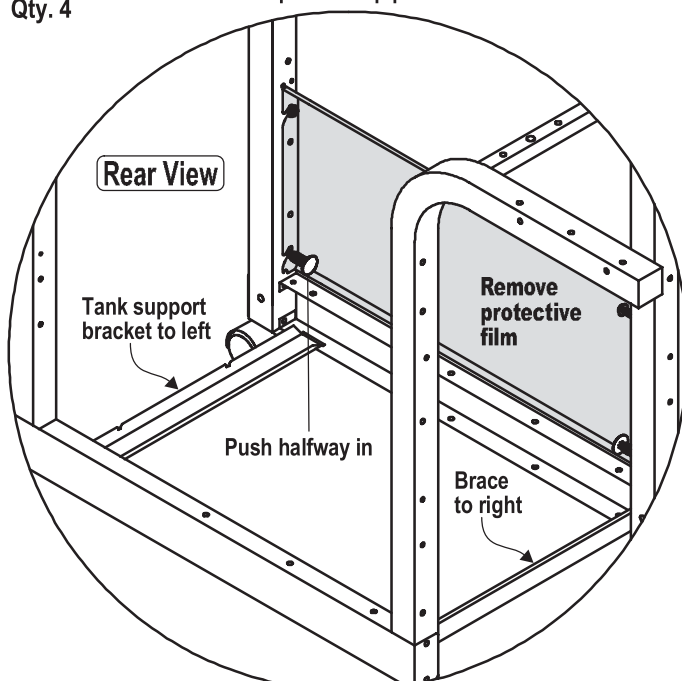

Rear View

Tank support  
bracket to left

Push halfway in

Brace  
to right

Remove  
protective  
film



# 5



Qty. 2

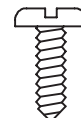

Qty. 2

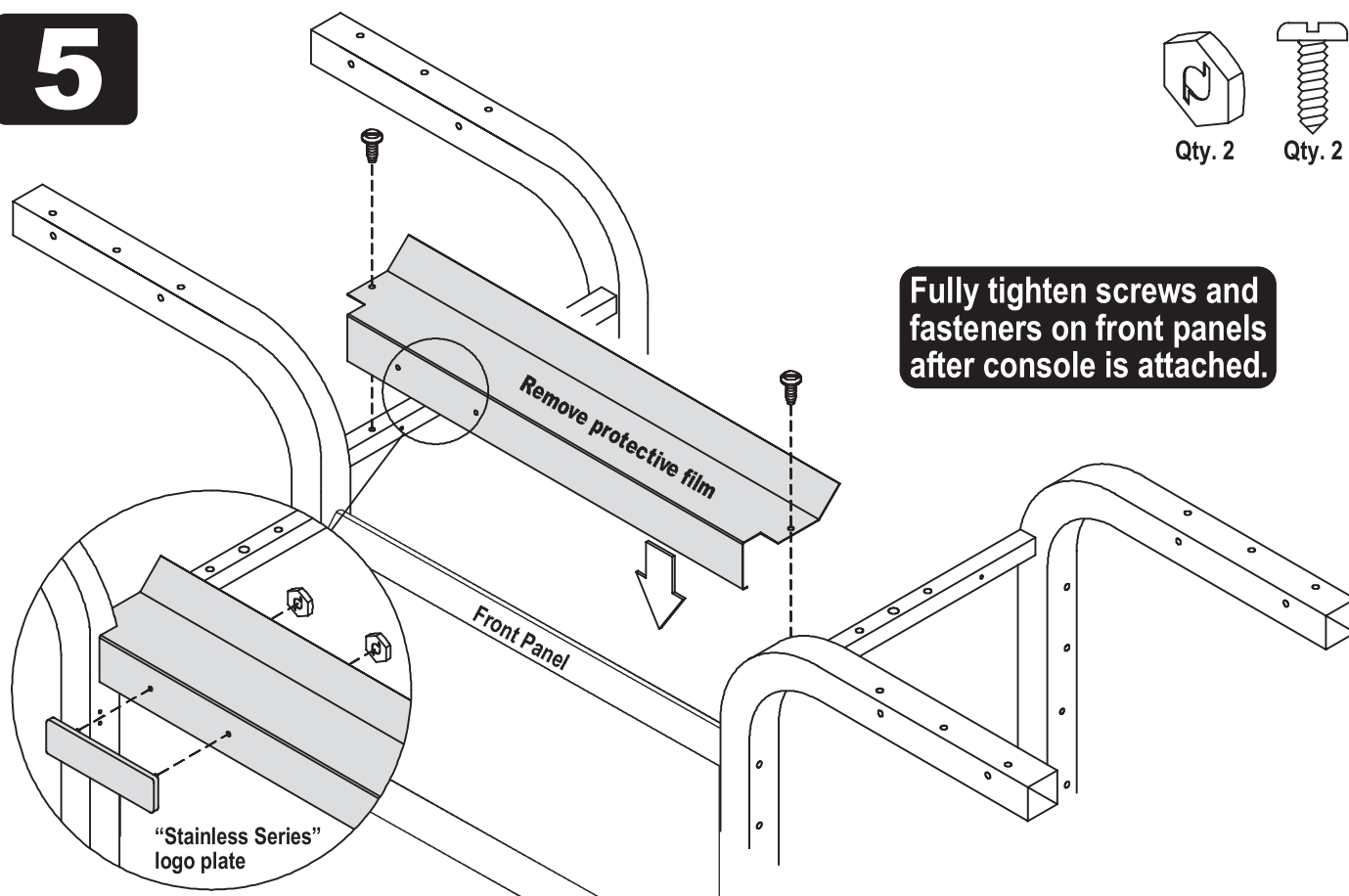

# 6



Qty. 2

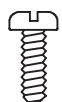

Qty. 2



Qty. 1

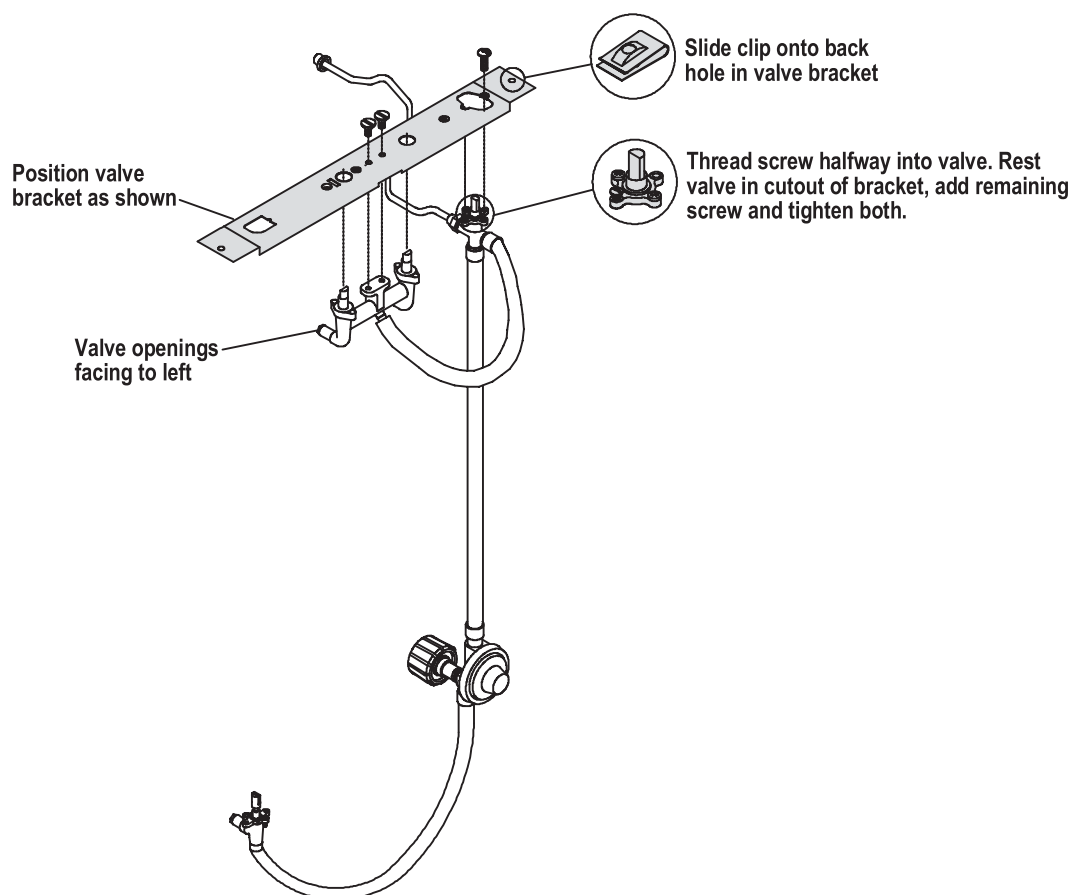

# 7



Qty. 2  
(Black)

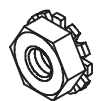

Qty. 1

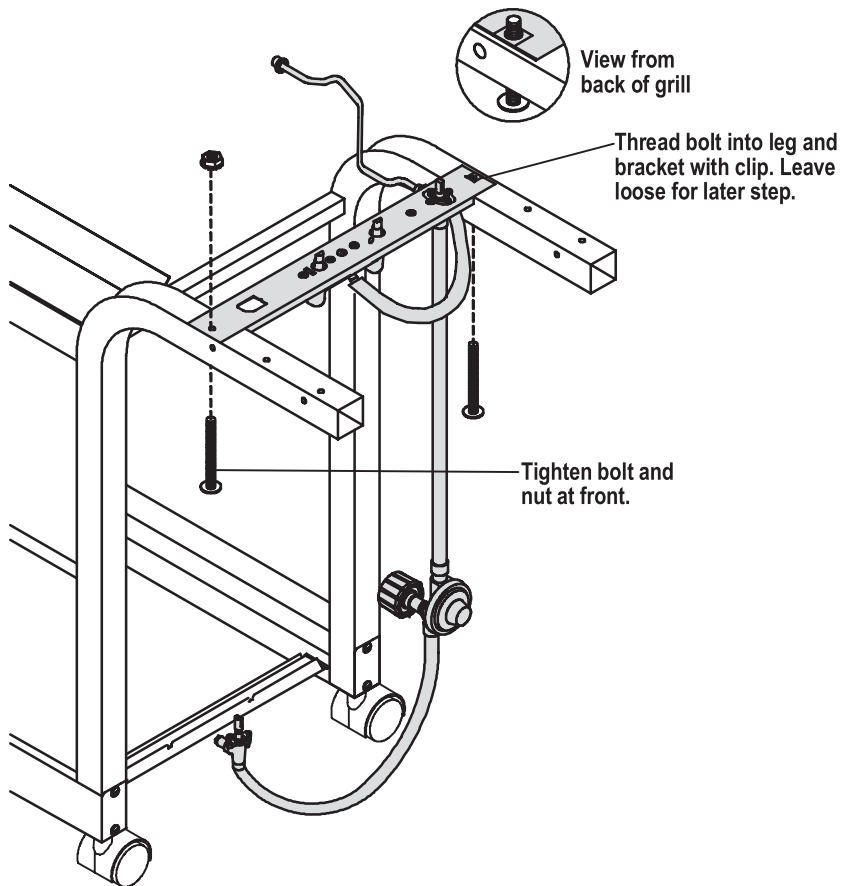

# 8

Hold grill bottom up to insert gas tube.

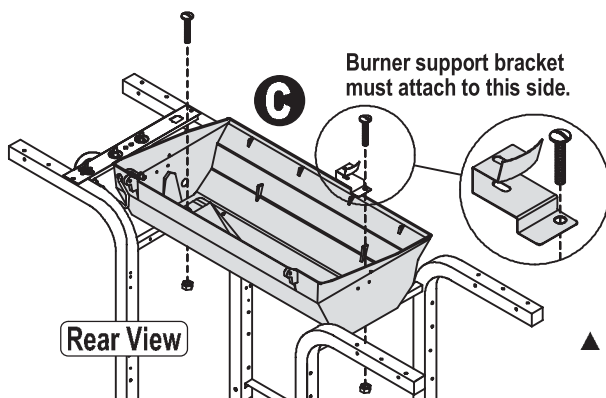
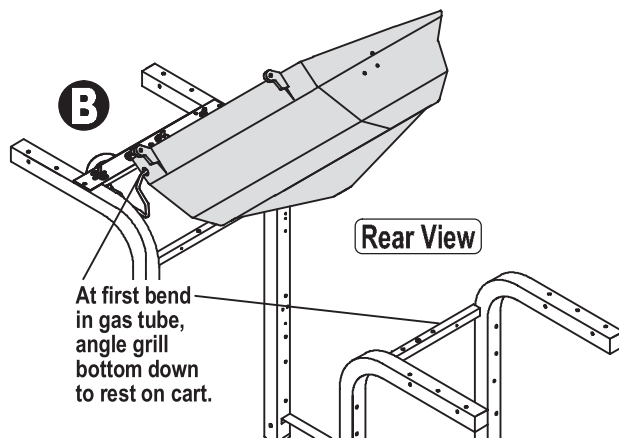
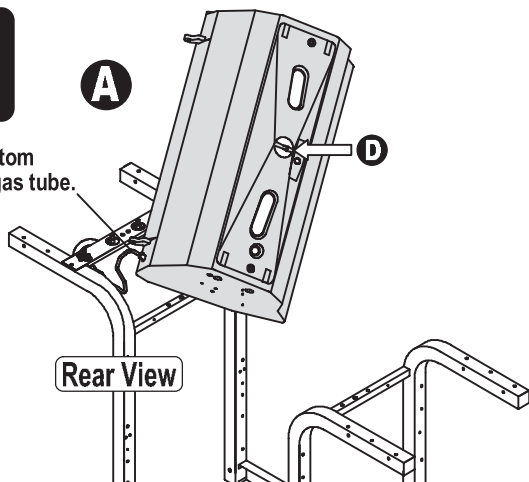

## CAUTION

Failure to install can in clip will cause hot grease to drip from bottom of grill with risk of fire or property damage.

**D** See arrow at **A** above.

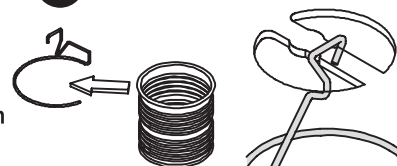

# 9

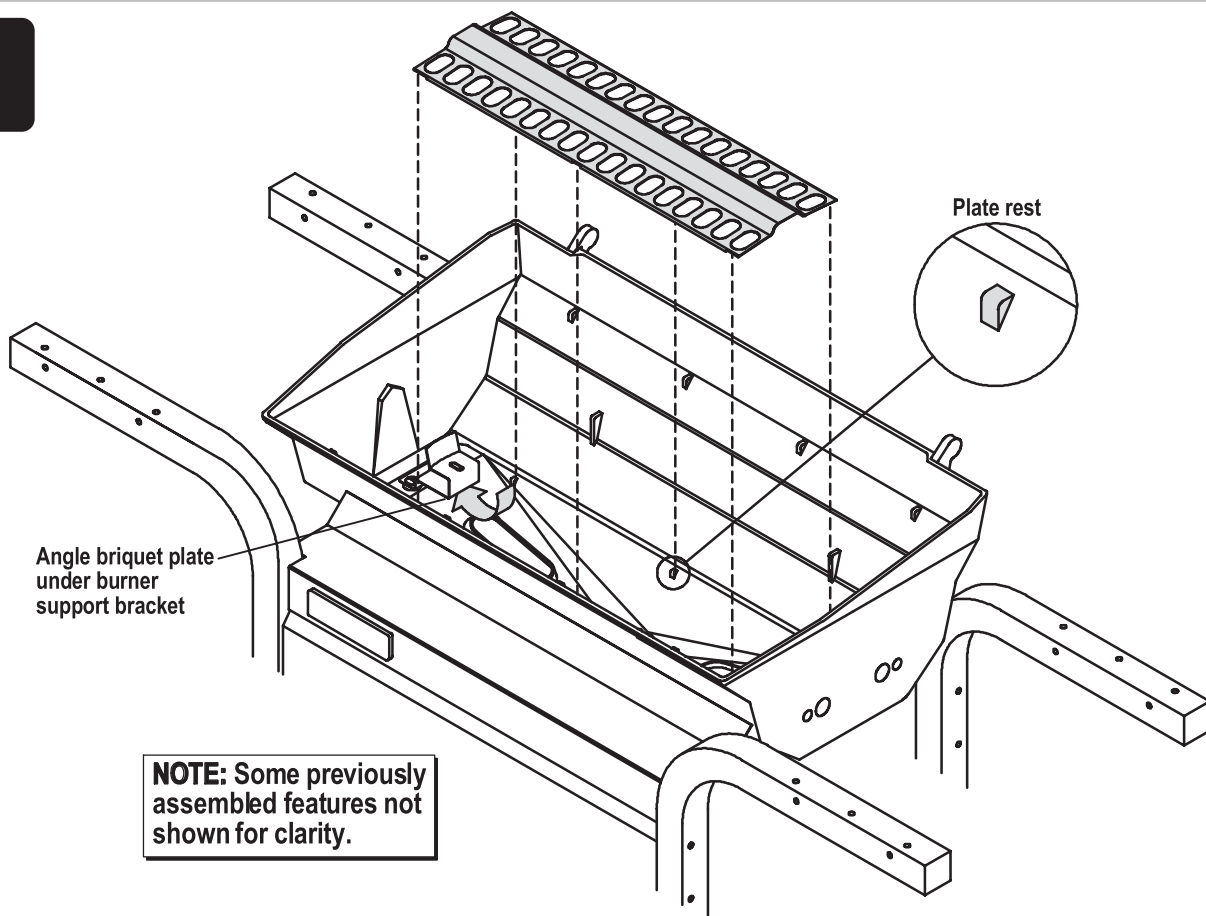

# 10



Tighten to snug fit.  
Overtightening may  
strip hole on burner.

With burner holes facing  
upward, use first hole  
in burner.

Center line  
of tube

Correct

Incorrect

Push electrode to right,  
snapping into slot.

Correctly attached ignitor  
shield/electrode assembly



# 11

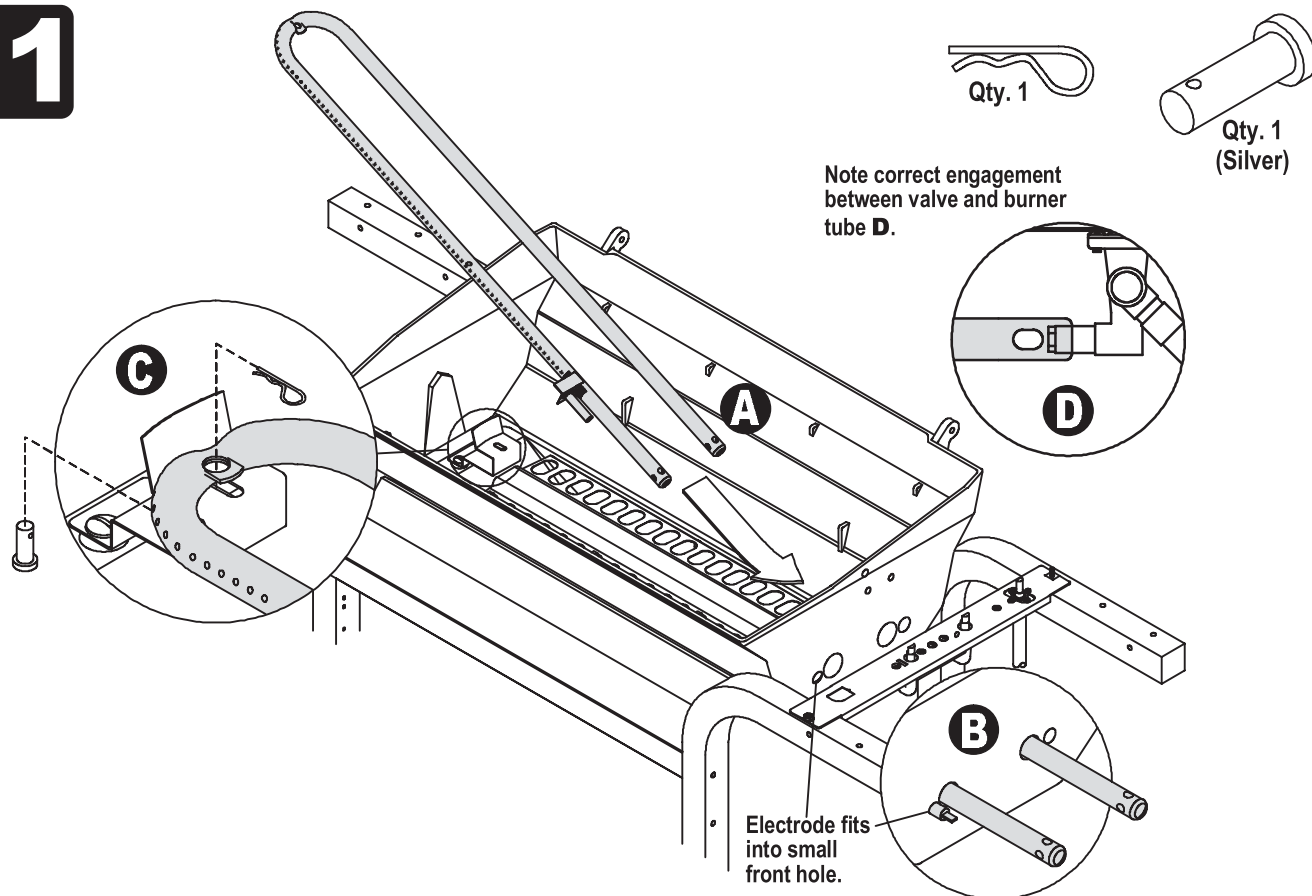

# 12

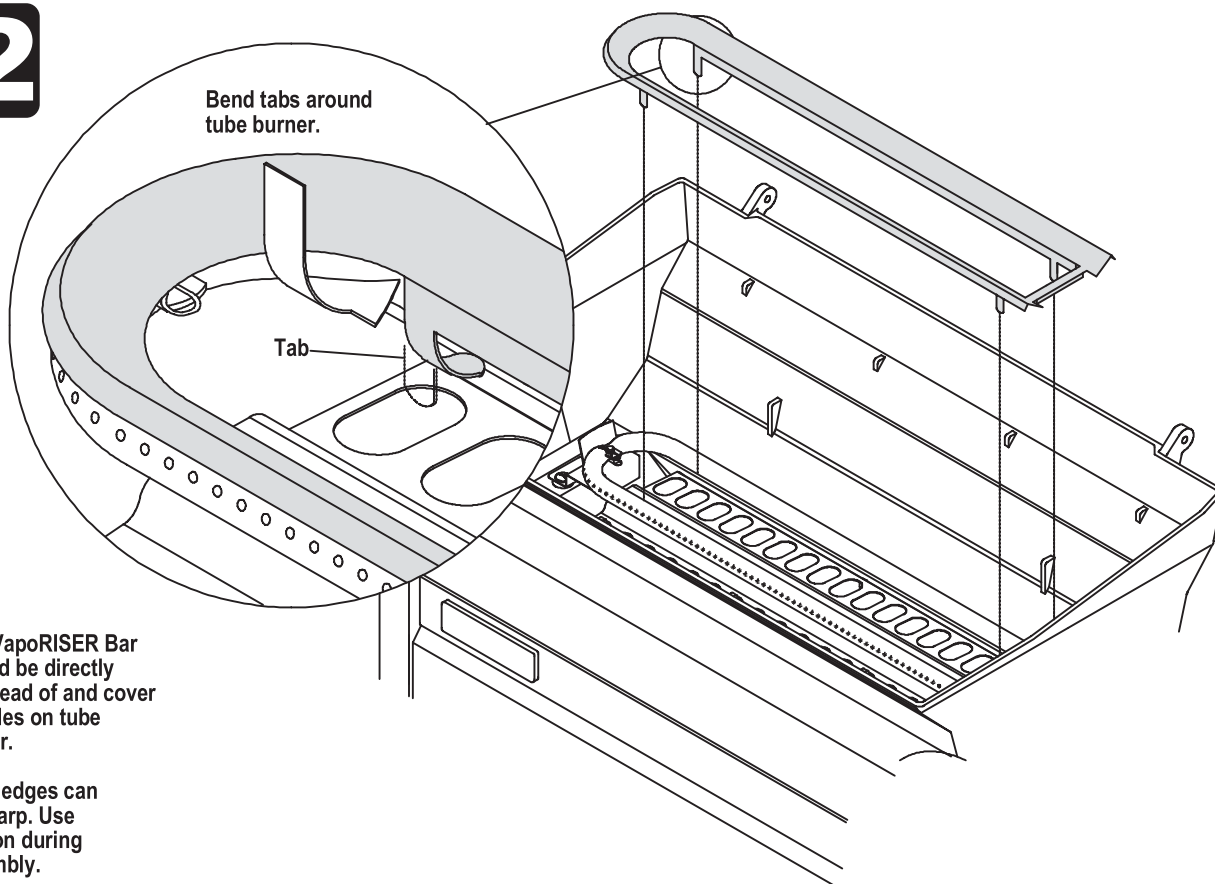

# 13

Inside grill, hold ignitor shield/electrode while pushing ignitor wire onto electrode from outside grill.



Qty. 1  
(Black)



Qty. 1



Qty. 1

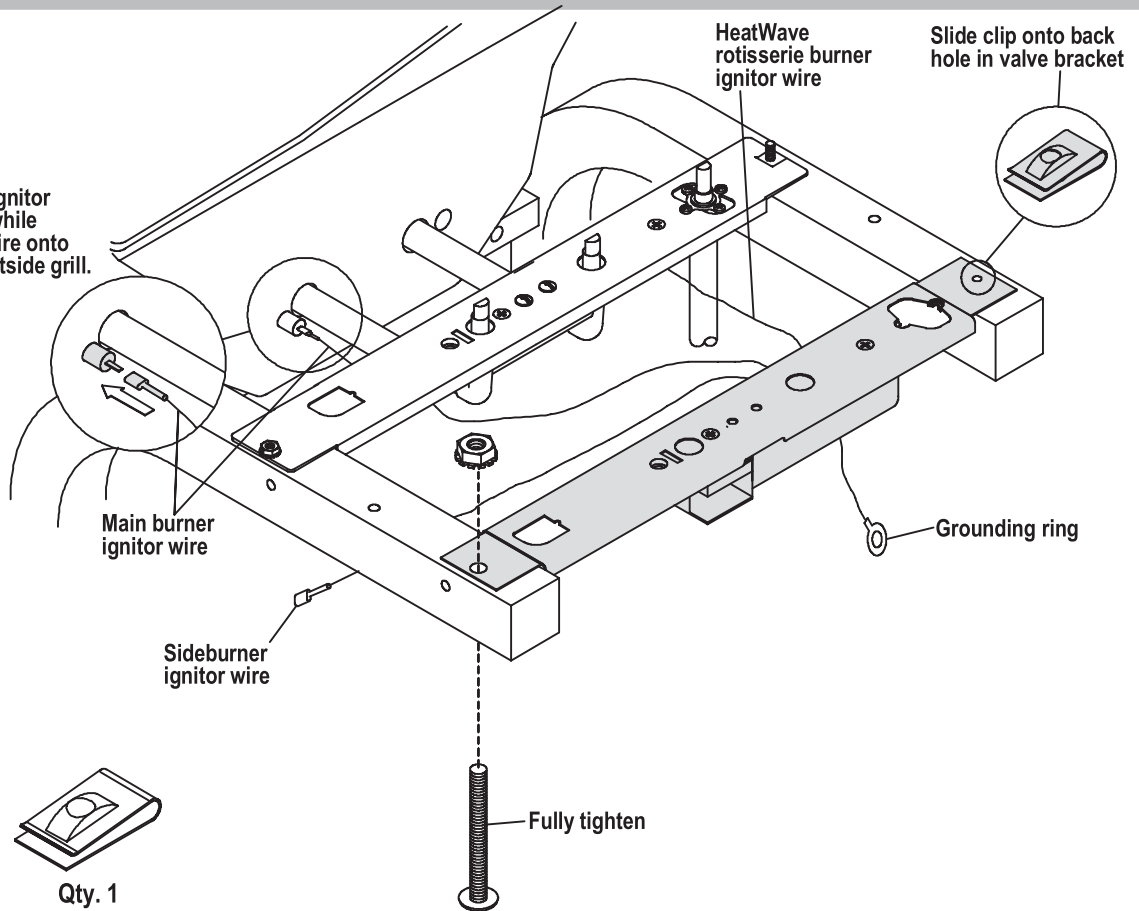

# 14

▲ See Use & Care Manual for valve check.

Press control knobs onto valve stems.

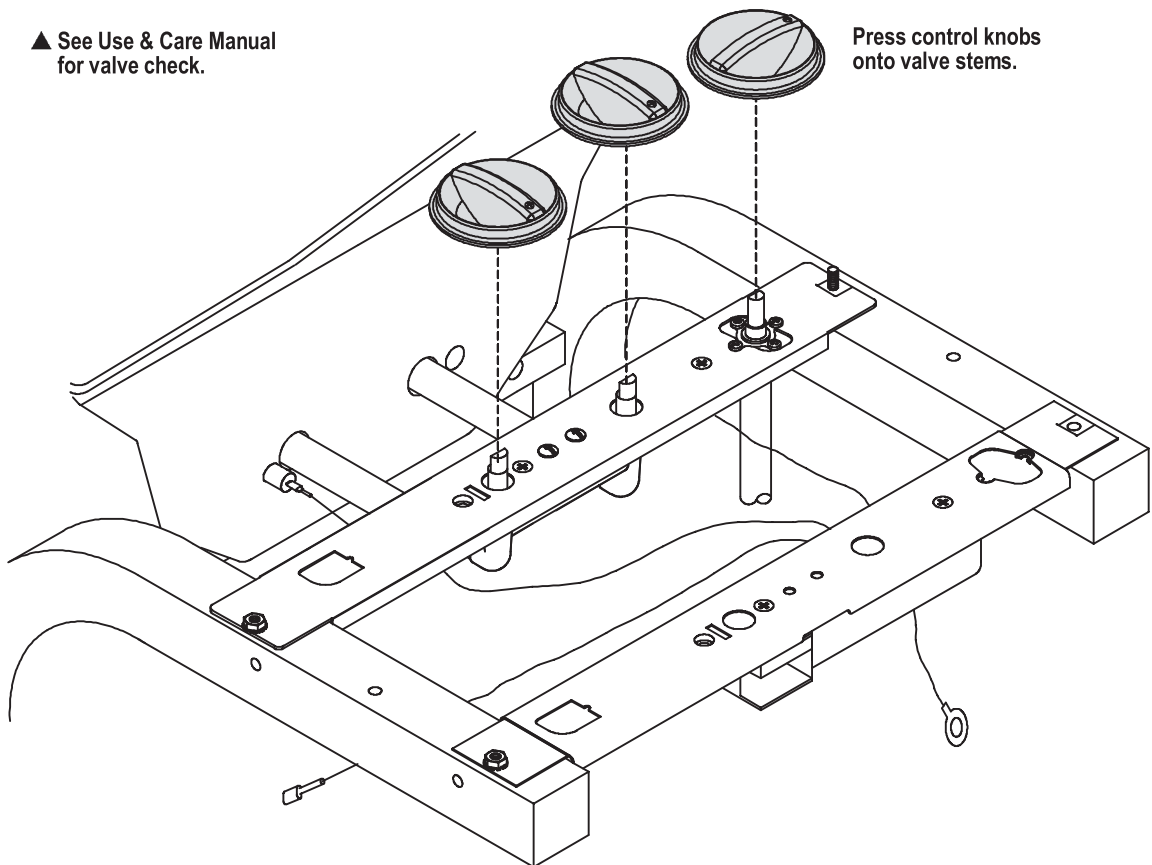

# 15

**NOTE:** Some previously assembled features not shown for clarity.

Electrode may have to be adjusted toward second burner hole.

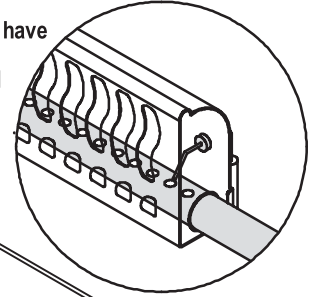

- ❶ Electrode must remain on outside of grill bottom.
- ❷ Angle HeatWave burner tube over gas tube.
- ❸ Using hammer, LIGHTLY tap clamps over grill bottom. Note correct engagement of burner tube over gas tube **A**.

## VERY IMPORTANT:

Do NOT hit ceramic electrode while tapping clamp onto grill bottom. A cracked electrode will not operate!

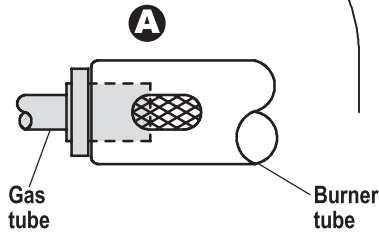
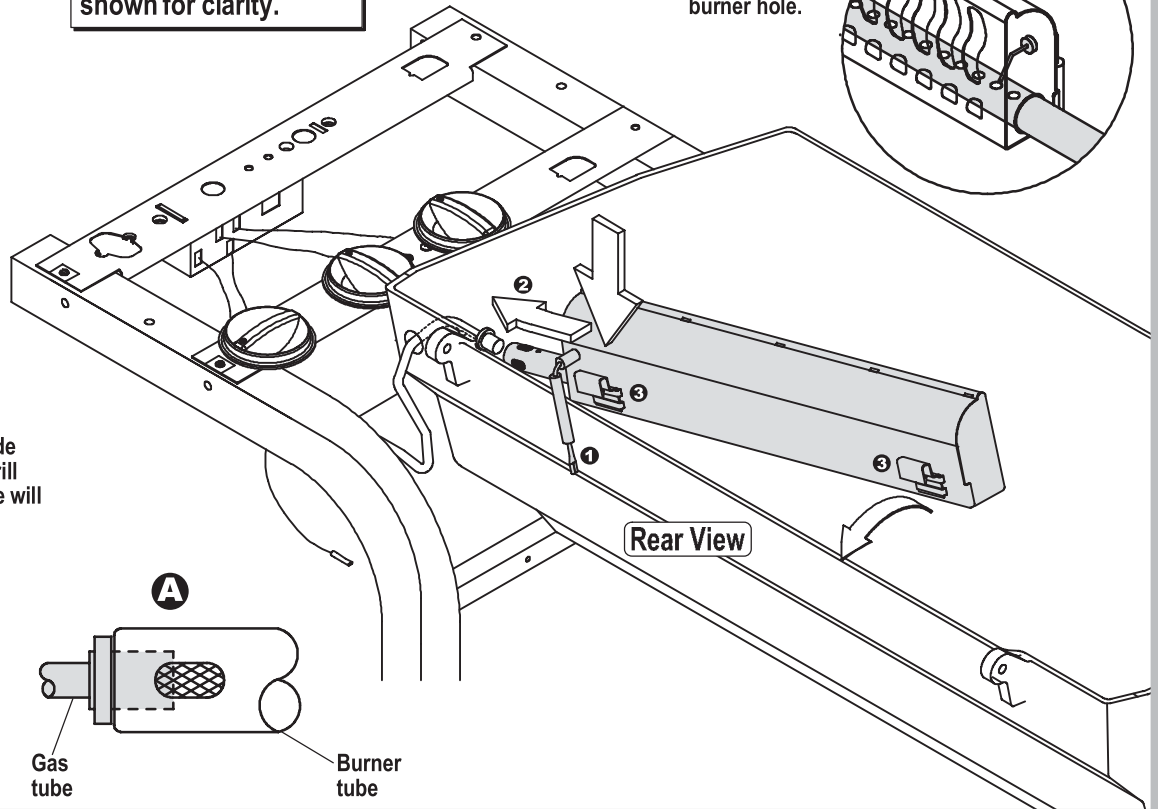

# 16

Qty. 1  
(Silver)

- ▲ HeatWave shield holds gas tube and burner tube together and shields from grease accumulation **A**.
- ▲ Once connected, be sure HeatWave ignitor wire is not touching grill bottom.

**IMPORTANT:**  
Be sure to check screw length.

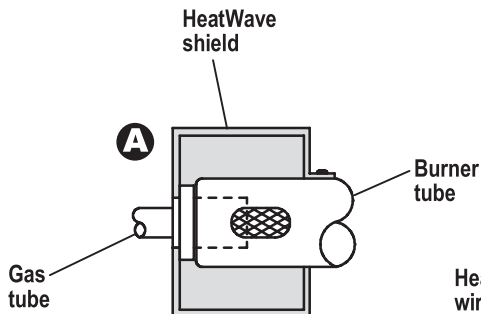
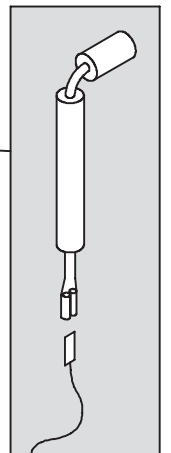
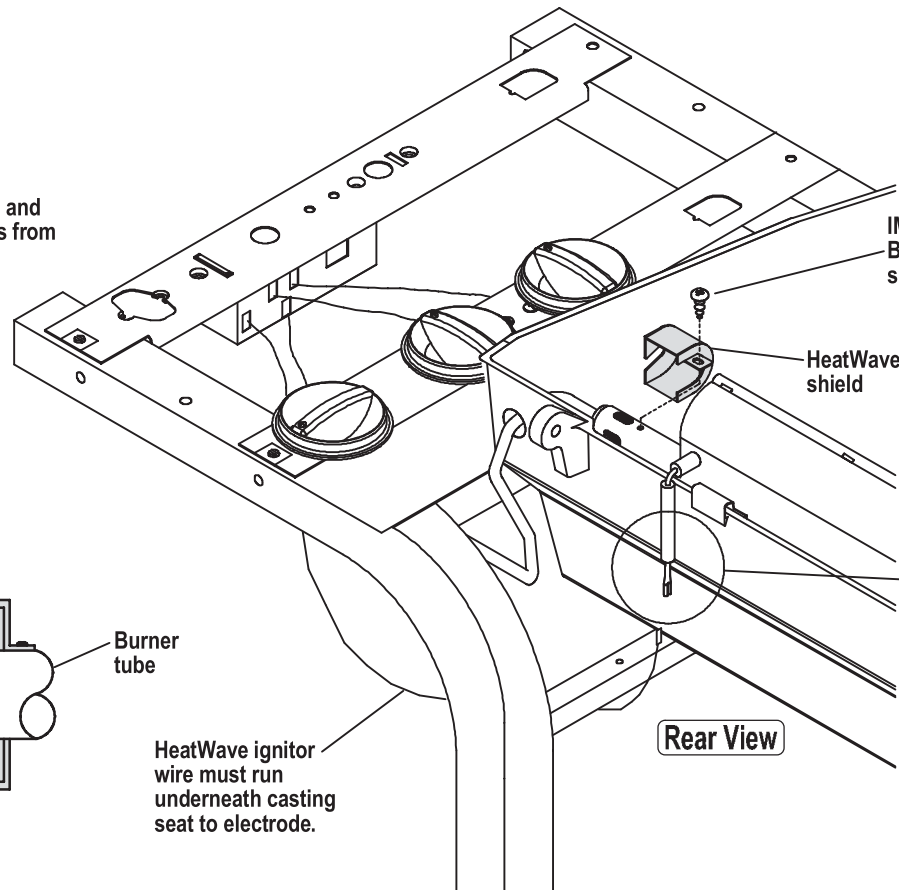

HeatWave ignitor wire must run underneath casting seat to electrode.

# 17

**Be sure** control knobs are fully pressed onto valve stems to avoid interference with shelf. Knobs should turn smoothly and spring back to original position when released. Slight upward adjustment of shelf may be necessary before tightening nuts and bolts.



Qty. 3  
(Black)



Qty. 2

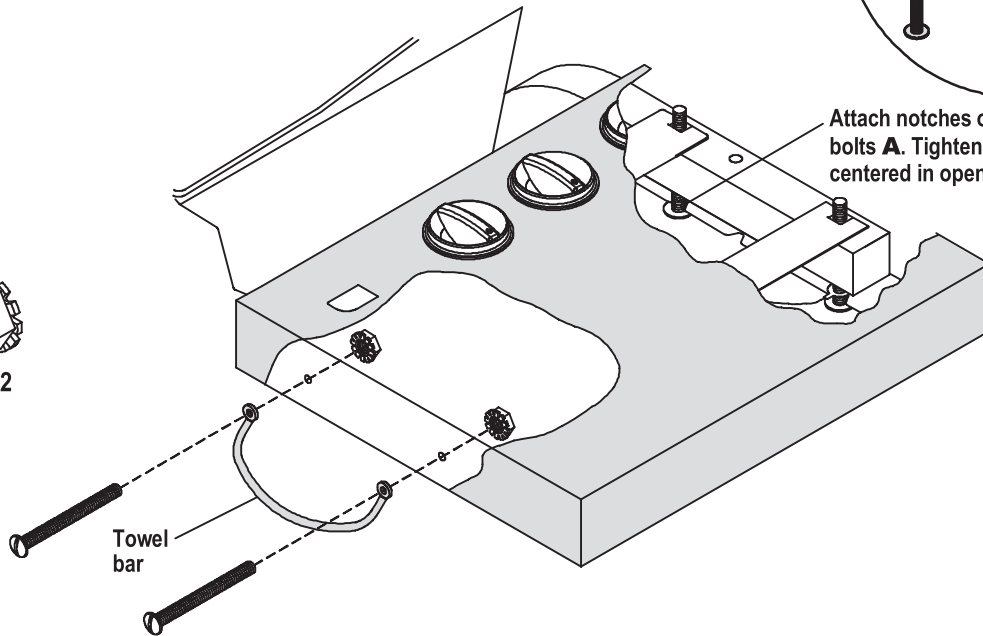

Towel  
bar

Grounding ring

Screw bolt halfway into leg and bracket with clip.

Attach notches on shelf onto heads of bolts **A**. Tighten after knobs have been centered in openings.

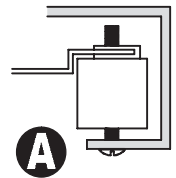

# 18

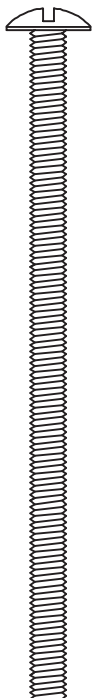

Qty. 2



Qty. 2

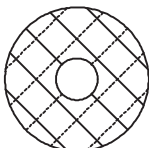

Qty. 2



Qty. 2

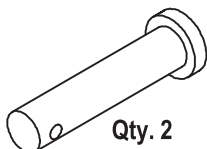

Qty. 2

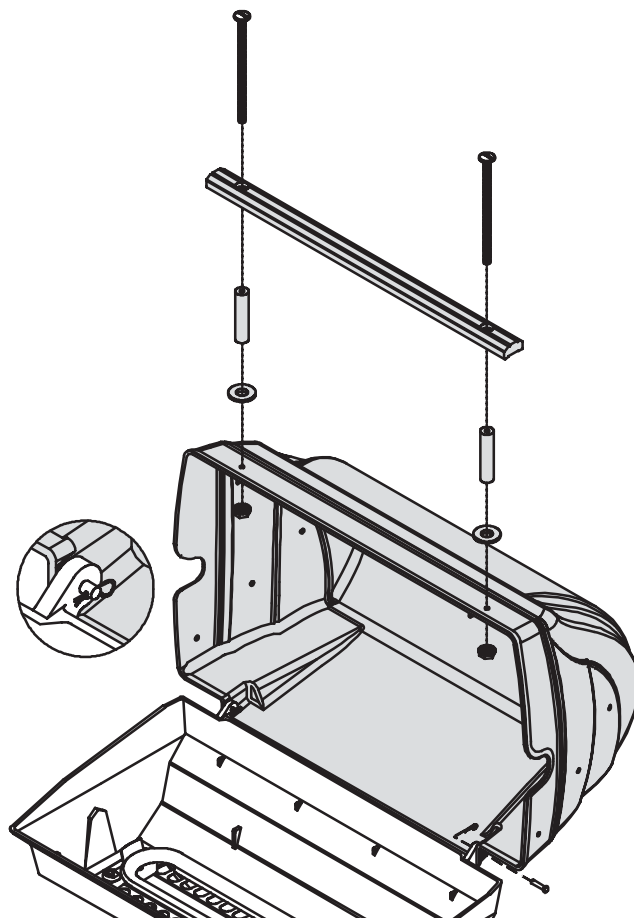

Grill lid style may vary.

# 19



Qty. 2

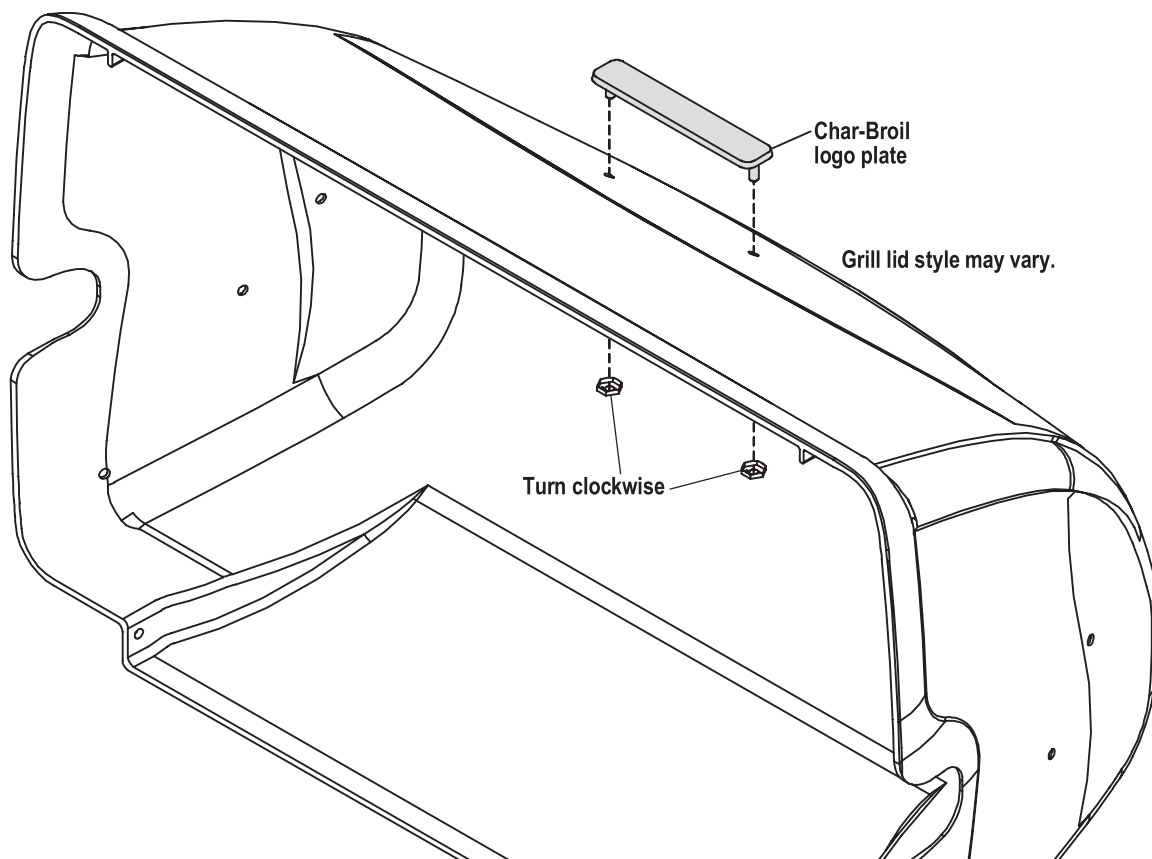

# 20



Qty. 2

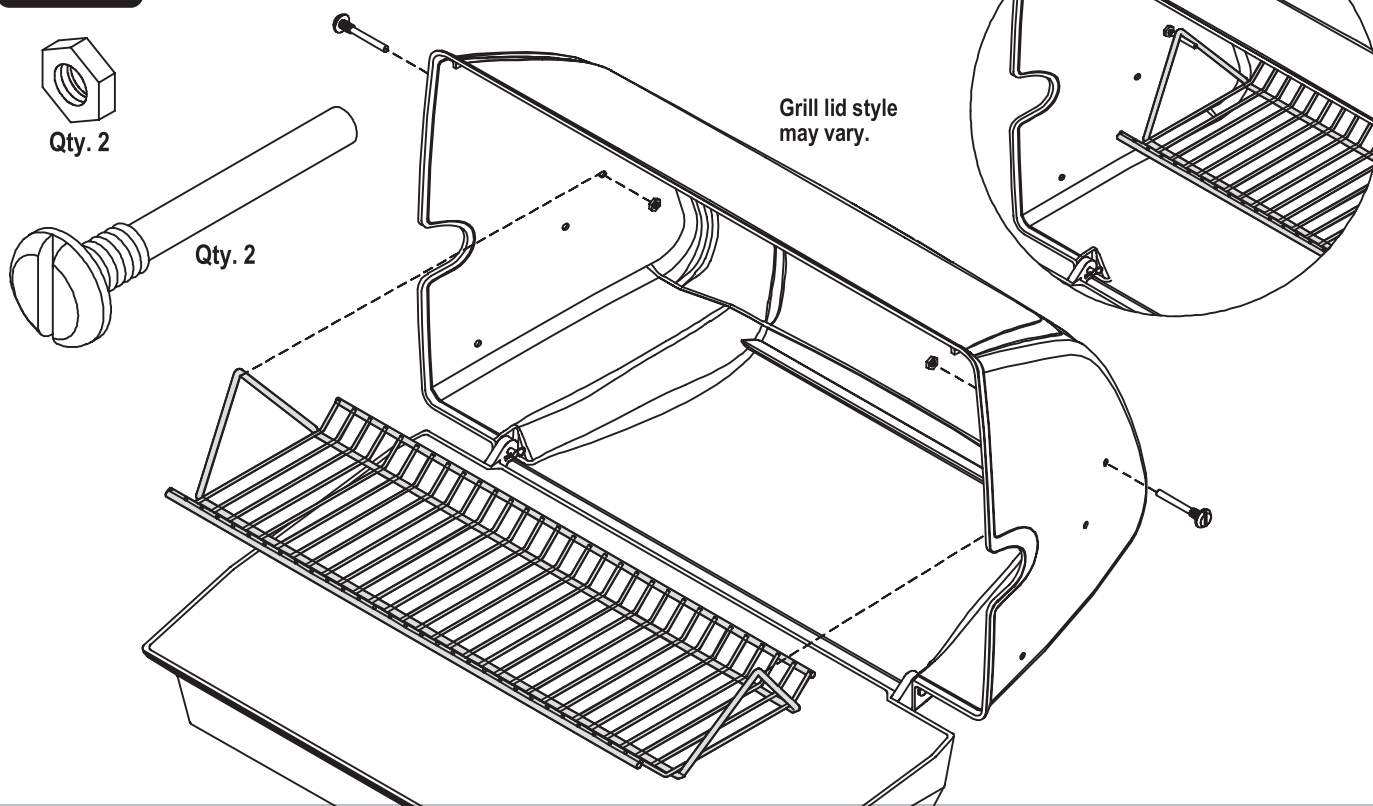



# 21



Qty. 2  
(Black)



Qty. 3



Qty. 2

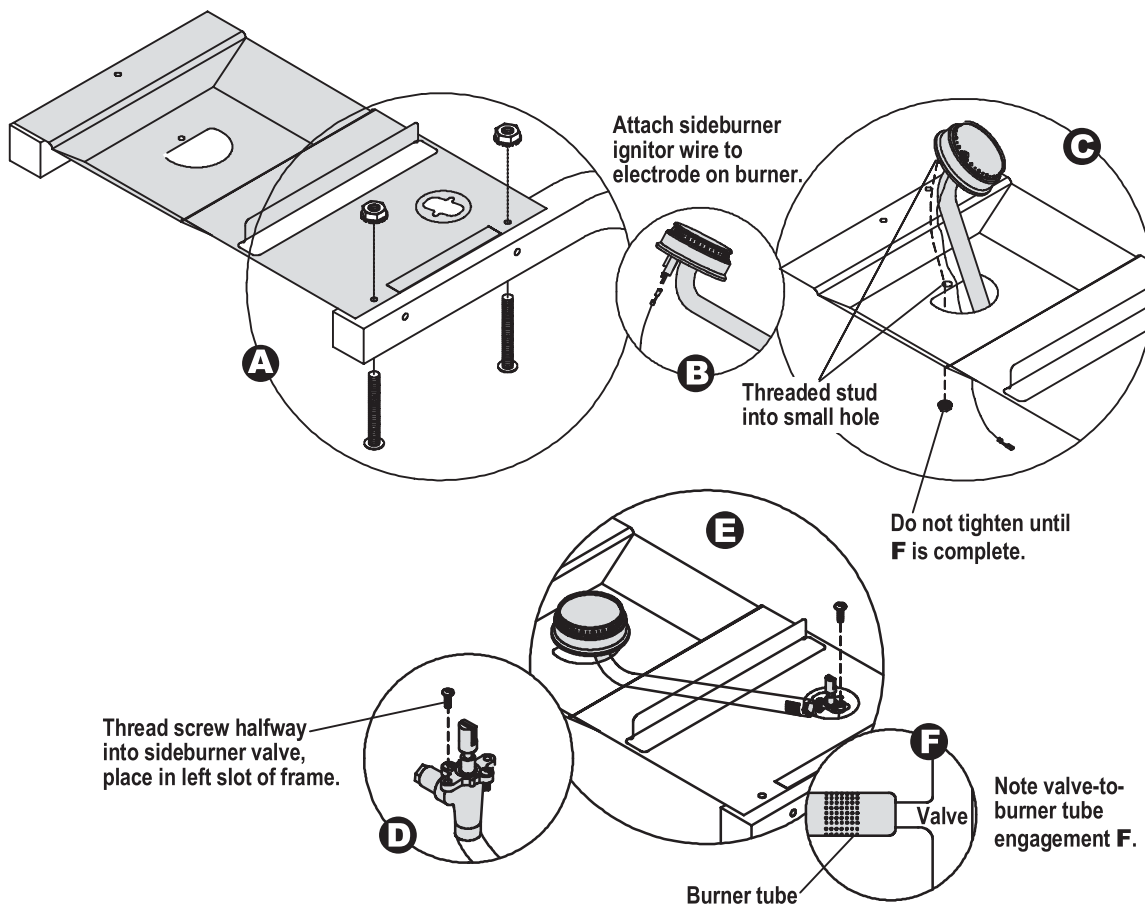

# 22

Attach center notch in sideburner shelf onto bolt and tighten.



Qty. 1  
(Black)



Qty. 1

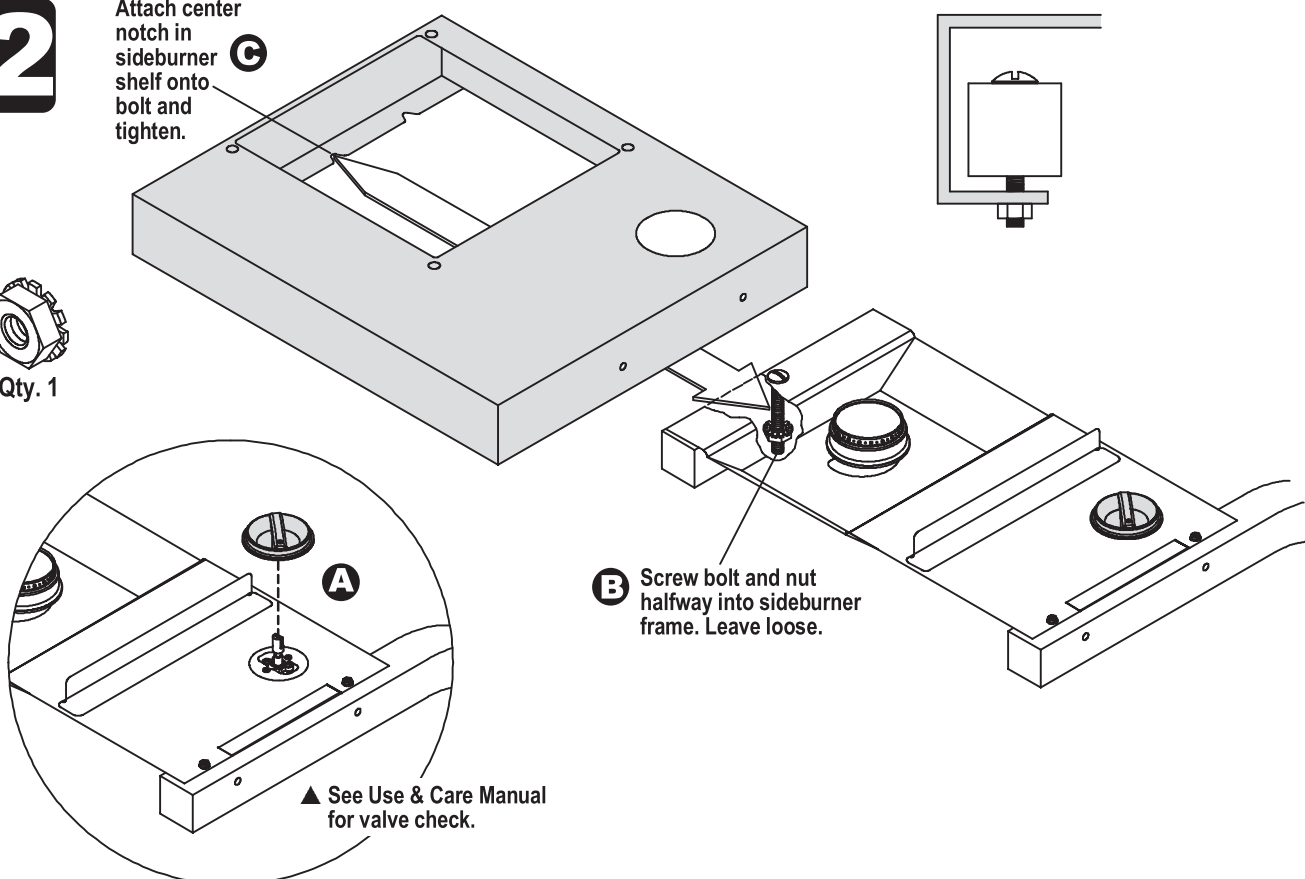

# 23

▲ Be sure sideburner knob is fully pressed onto valve to avoid interference with shelf. Knob should turn smoothly and spring back to original position when released. Slight upward adjustment of shelf may be necessary before fully tightening bolt and nut.

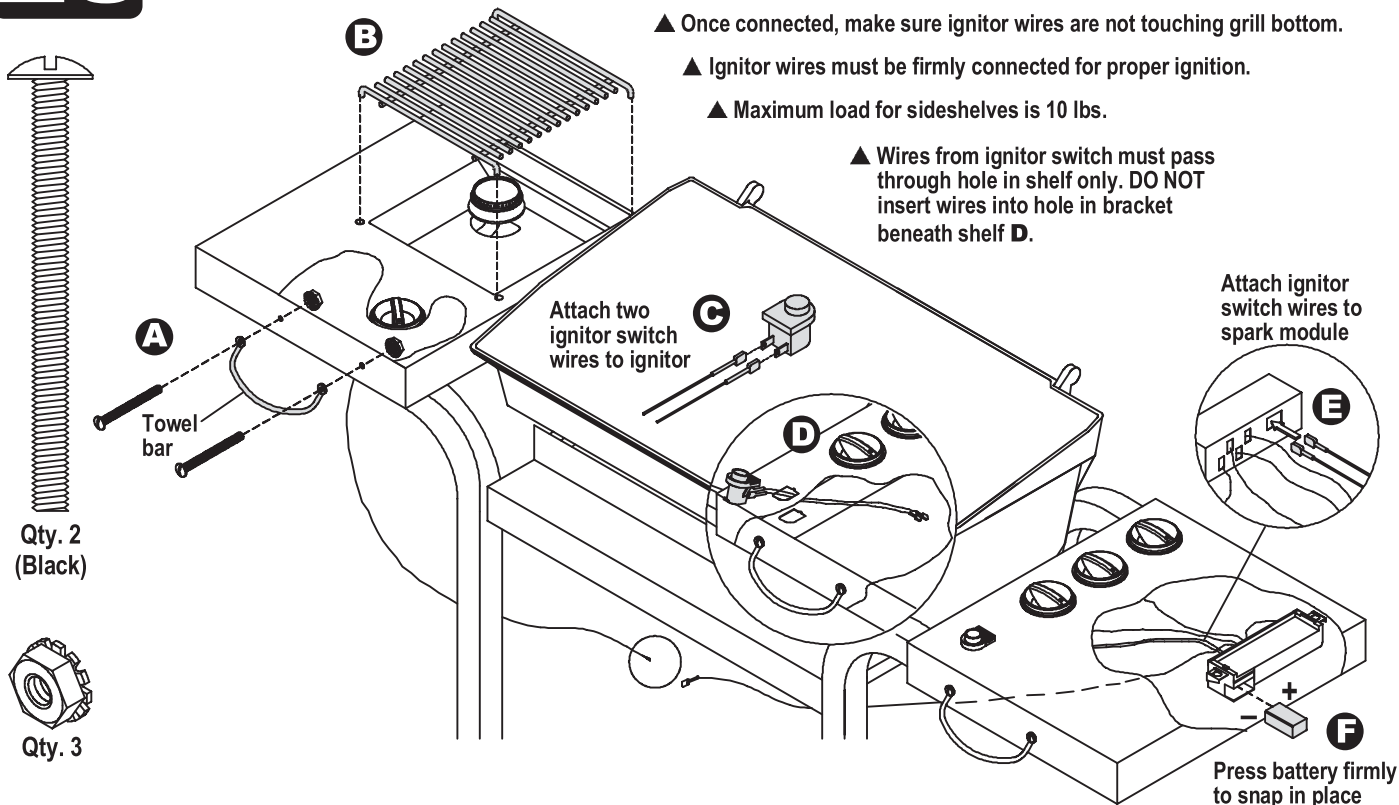

# 24

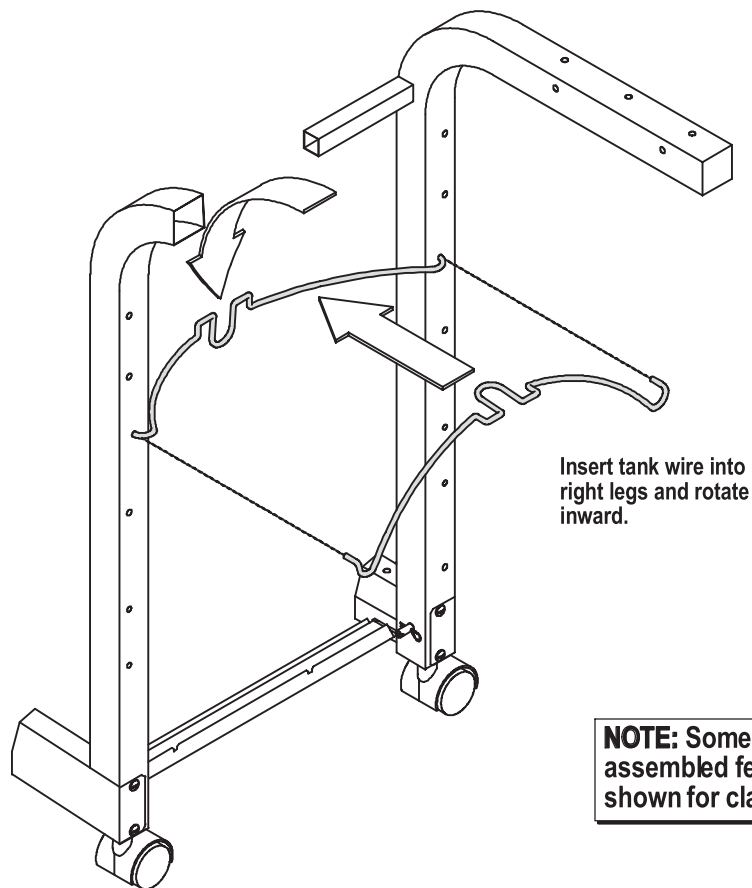

**NOTE:** Some previously assembled features not shown for clarity.

# 25



- Tank collar opening must face to front of cart once tank is attached.
- Failure to install tank correctly may allow gas hose to be damaged in operation.

▲ LP GAS TANK IS SHIPPED EMPTY. Fill and leak-check your tank before attaching it to the grill and regulator. See Use & Care Manual.

▲ Curved portion of tank wire should be inside of tank collar.

**NOTE:** Some previously assembled features not shown for clarity.

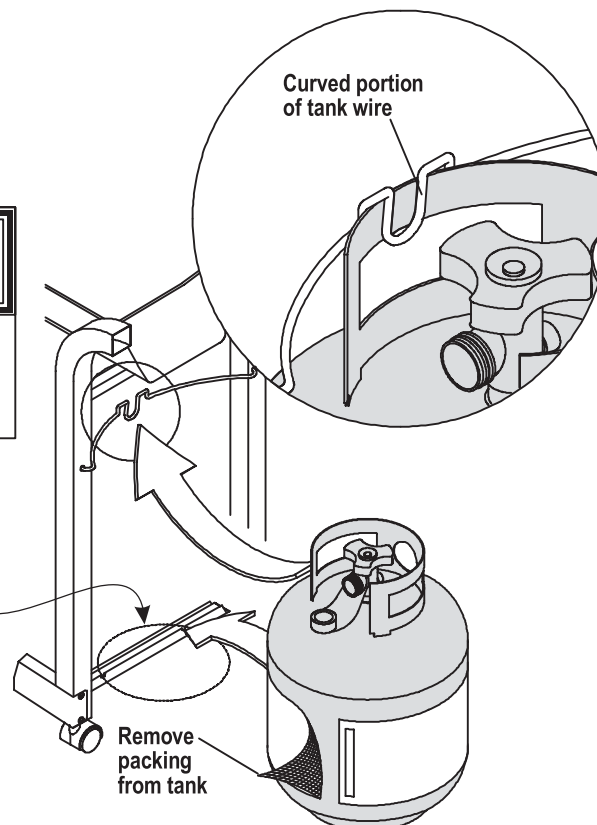

**See Use & Care Manual for important safety instructions before using.**

# 26

▲ Place 16 briquets. Do not layer or stack . . . just enough to cover briquet grate surface.

▲ Briquets should surround and can touch burner. Do not place briquets in center of burner.

▲ Do not let briquets cover burner holes.

