

This Owner's Manual is provided and hosted by [Appliance Factory Parts](http://ApplianceFactoryParts.com).

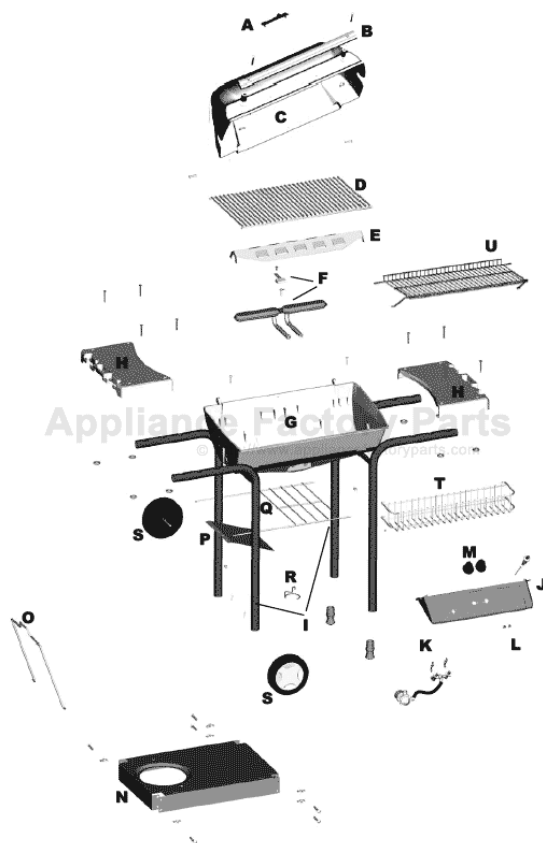

# Charbroil 466734803 Owner's Manual

[Shop genuine replacement parts for Charbroil  
466734803](#)



[Find Your Charbroil Grill Parts - Select From 3592 Models](#)

----- Manual continues below -----

**1**

Items to Assemble:  
6 Carriage Bolts  
6 Wing Nuts

**Place Bottom Shelf and Legs as shown.**

**After assembling tighten all Wing Nuts.**

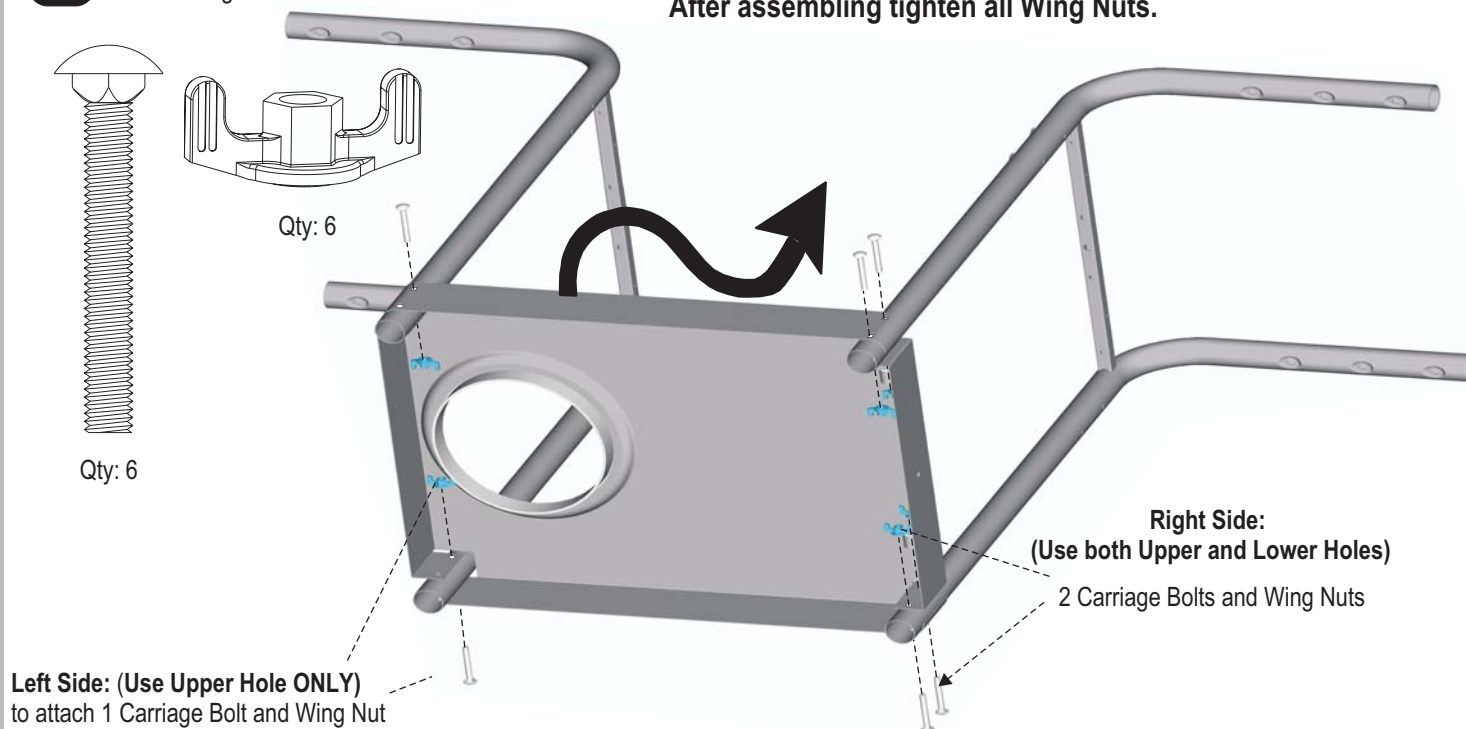

**4**

Items to Assemble:  
2 Shelves  
8 Crown Nuts  
8 Carriage Bolts

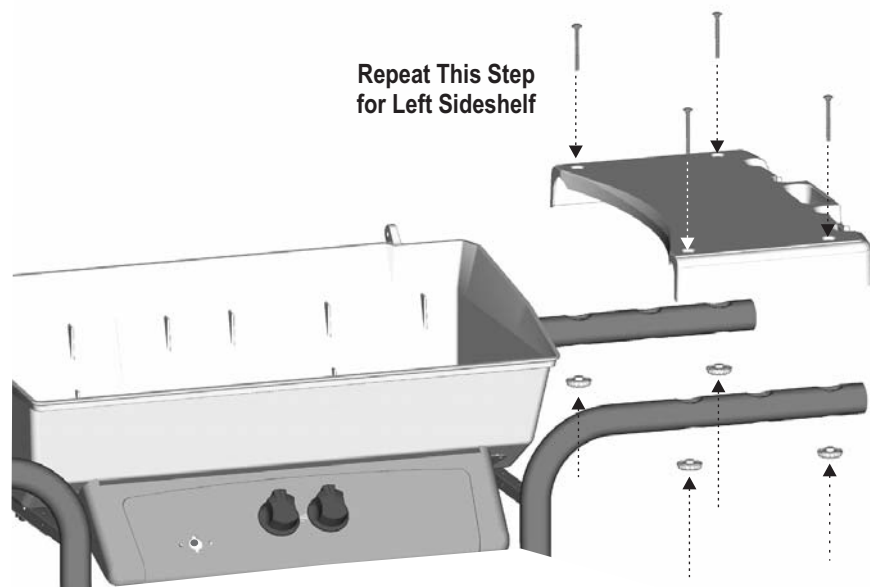
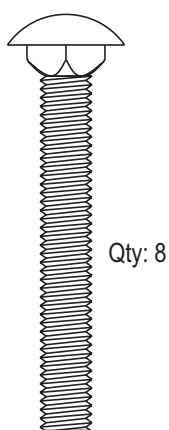
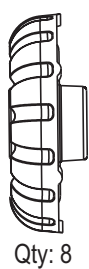

**7**

Item to Assemble:  
2 Wing Nuts  
1 Logo Plate  
1 Handle  
2 Screws  
2 Washers  
2 Spacers

