

This Owner's Manual is provided and hosted by [Appliance Factory Parts](#).



Charbroil 463453305 Owner's Manual

**[Shop genuine replacement parts for Charbroil
463453305](#)**



[Find Your Charbroil Grill Parts - Select From 3592 Models](#)

----- Manual continues below -----

14 **Items to Assemble**
 1 Fascia
 1 Base
 1 Screw, 1/2"
 1 Screw, 3/8"

A Slide fascia around manifold and insert edge/valve into slot. Fascia tabs must insert into 2 slots in front of slot, then slide towards leg. Fasten fascia into second hole through control panel and leg.
 B Place bezel onto valve and attach with 3/8" screw.

1/2" Qty: 1
 3/8" Qty: 1

15 Follow these instructions to install Logo Plate, Bezel and Temperature Gauge into Grill Lid (if necessary)

Items to Assemble
 1 Logo Plate
 1 Bezel
 1 Temperature Gauge

A Insert logo plate into grill lid.
 B Center bezel over large hole on grill lid.
 C Insert temperature gauge into hole on bezel and grill lid. Gently press temperature gauge down to engage. Note: Do not over-tighten the locking device on the temperature gauge. Note: This may damage the locking device on the temperature gauge.

Back Side of Temperature Gauge showing locking device.

16 **Items to Assemble**
 1 Top Cover, Left
 2 Wing Nuts
 1 Top Cover, Right

A Place handles onto the lid. See inset showing correct position of stud in vertical position.
 B Place top covers into each side.
 C Attach wing nut to stud.

Qty: 2

17 **Items to Assemble**
 1 Top Casting
 2 Shoulder Bolts
 4 Control Knobs
 1 AAA Battery
 1 Button

A Place shoulder lid to install shoulder bolt into top casting.
 B Insert 1 size of battery into ignitor module. Note correct position to load ignitor button. Push on button once to engage seal.

Qty: 2

18 **Items to Assemble**
 3 Vaporizer Tents
 2 Grease
 1 Warming Rack

A Note correct position of vaporizer tents directly over burners.
 B Place warming rack in slots on bottom casting.
 C Place warming rack in slots on bottom casting.

Warming rack slots

19 **Items to Assemble:**
 1 (optional) LP Tank

LP tank is sold separately. Use only with an overfill protection device (OPD) pin and tank check before attaching to grill and regulator.
 Place LP tank into hole in bottom shelf. Tighten thumbscrew to hold LP tank securely in place.

Back of cart

CAUTION

* Tank collar opening must face to front of cart once tank is attached.
 * Failure to install tank correctly may allow gas to leak to the damaged in operation, resulting in a risk of fire.

See the Use & Care manual to correctly install the LP Tank. Leak Test and do the Burner Flame Check.

20 **Items to Assemble**
 1 Grease Pan

A Slide grease tray into brackets on bottom casting.
 B Slide grease pan into brackets on grease tray.

CAUTION

Failure to install the grease tray will cause hot grease to drip from bottom of grill with risk of fire or property damage.

You may have to adjust the grill after completing assembly of your grill. This is normal as in some cases we have included extra hardware to ensure you have enough.

Parts List - Model 463453305

Key Qty.	Description	Part #
A	1 Bottom Shelf	7000451
B	4 Rails	7001653
C	1 Top Casting	7000455
D	1 Bottom Casting	7000457
E	3 Burners	7000039
F	1 Carry-Over Tube	7000279
G	1 Handle	7000198
H	1 Condiment Basket	7000348
I	2 Wheels	7000262
J	1 Axle Rod	7000265
K	3 Vaporizer Tents	7000381
L	1 Grease Tray Assembly	7000043
M	1 Grease Pan Assembly	7000046
N	1 Fascia, Right	7000458
O	1 Fascia, Left	7000473
P	2 Leg Extenders	7000230
Q	4 Control Knobs	7000309
R	4 Bezels	7000912
S	1 Ignitor	7000047
T	1 Ignition Module	7000160
U	1 1" Ignitor Wire	7000893
V	1 Stieburner Ignitor Wire	7000894
W	1 Stieburner Body	7000462
X	1 Stieburner Lid Assy.	7000463
Y	1 Stieburner Handle	7000059
Z	1 Stieburner Grid	7000304

Key Qty.	Description	Part #
AA	1 Stieburner Burner	7000037
BB	3 "S" Hooks	7000346
CC	1 Grid	7000034
DD	1 Shelf	7000454
EE	1 Front Panel	7000465
FF	3 Warming Rack	7000181
GG	1 Cook Grid	7000025
HH	2 Cook Grids	7000026
II	1 Valve/ Hose Regulator Assy	7000067
JJ	1 Control Panel	7000833
KK	1 Logo Plate	4157147
LL	1 Leg Assembly, Long	7000469
MM	1 Leg Assembly, Short	7000498
NN	1 Hose Heat Shield	7000398
OO	2 Pin Nuts	7000132
PP	3 "U" Nuts	7000185
QQ	2 Casting Bumpers	7000184
RR	1 Top Cover, Left	7000116
SS	1 Top Cover, Right	7000117
TT	1 Temperature Gauge	7000361
UU	1 Temperature Gauge Bezel	4157169
VV	1 Ignition Button w/Battery	7000162
WW	1 Stieburner Frame Insert	7000306
XX	1 Hardware Bag	7000972

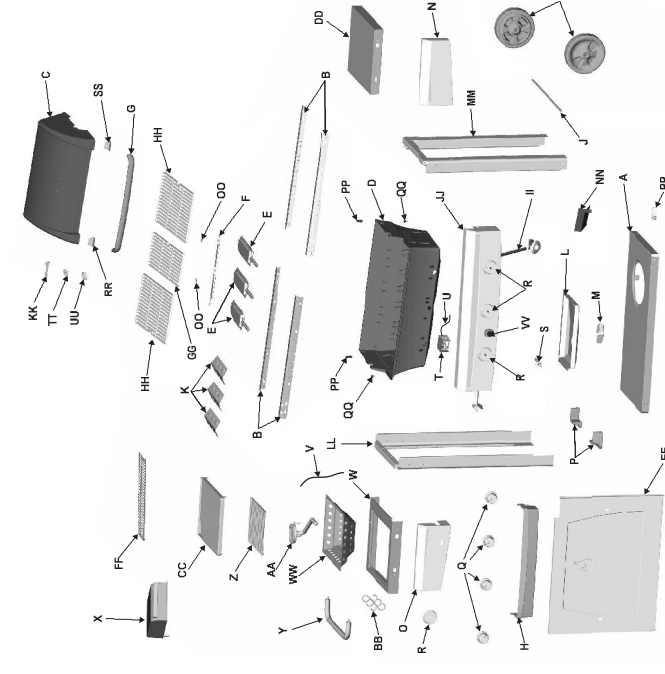

Advantage Series
Char-Broil
 KEEPERS OF THE FLAME

ASSEMBLY MANUAL
 463453305
 THIS GRILL IS FOR OUTDOOR USE ONLY

CAUTION: Read and follow all safety statements, assembly instructions and use and care directions before attempting to assemble and cook.

WARNING: Failure to follow all manufacturer's instructions could result in serious personal injury and/or property damage.

CAUTION: Some parts may contain sharp edges. Especially as noted in the manual. Wear protective gloves if necessary.

If you have any questions or need assistance during assembly, please call 1-800-241-7545.
 Write on the back of this manual.
 www.charbroil.com

PRECISION GRILLING TECHNOLOGY

Printed in USA
 © 2005 W. C. Bradley Co., All Rights Reserved
 7001103_463453305 (05-16-05) - 1