

This Owner's Manual is provided and hosted by [Appliance Factory Parts](#).



Charbroil 463452206 Owner's Manual

[Shop genuine replacement parts for Charbroil
463452206](#)



[Find Your Charbroil Grill Parts - Select From 3592 Models](#)

----- Manual continues below -----

1 Items to Assemble

- 1 Long Leg Assembly
- 1 Short Leg Assembly
- 8 Screws

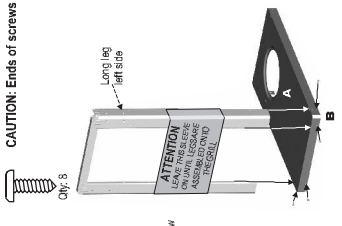

CAUTION: Ends of screws have sharp points.

Short leg right side

Long leg left side

Long leg assembled

Unlocks of bottom shelf

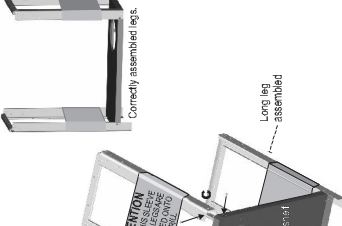

- ### 2 Items to Assemble
- 2 Leg Extenders
 - 1 U-Nut
 - 1 Cylinder thumbscrew
 - 2 Wheels
 - 1 Axle Rod
 - 2 Flat Washers
 - 1 Hitch Pin

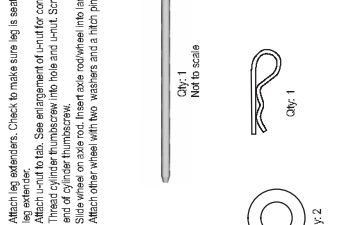

A Attach leg extenders. Check to make sure leg is sealed at the way into the leg extender.

B Attach cylinder thumbscrew into hole and turn. Screw flanged hex nut onto end of cylinder thumbscrew.

C Thread axle rod into large hole in bottom shelf.

D Slide washer on axle rod. Insert axle rod/washer into large hole in bottom shelf. Attach other wheel with two washers and a hitch pin.

Correctly assembled legs.

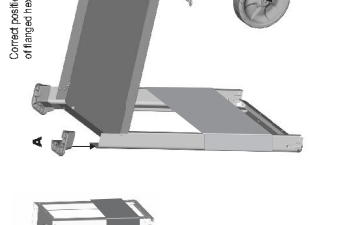

- ### 3 Items to Assemble
- 4 Rails (all identical)
 - 10 Screws

A Overlap rails and hook tabs into slots. Pull rails to slot.

B Attach one screw in center of each rail.

C Attach rail and legs with two screws in each corner.

4 Items to Assemble

- 2 Front Panel
- 2 Flat Pins

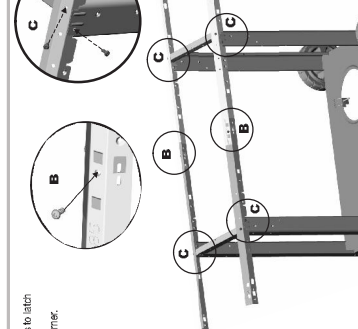
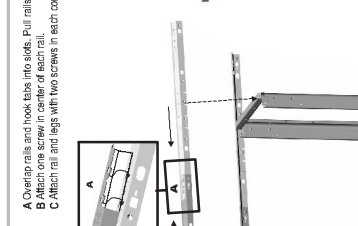

- ### 5 Items to Assemble
- 1 Burner Shield
 - 1 Screw

A Place tabs on front panel beside leg tabs.

B Insert push pins into front panel and legs.

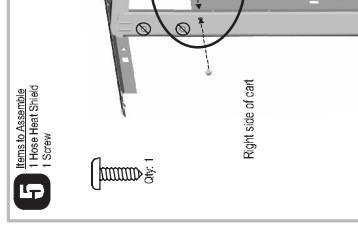

- ### 6 Items to Assemble
- 1 Burner Basket
 - 1 Flat Pin

Turn cart upside down.

Correct position of flanged hex nut.

Hub on wheel faces into grill bottom.

Correct position

Stand cart upright and remove cardboard sleeves

Parts List - Model 463452206

Key	Qty.	Description	Part#	Key	Qty.	Description	Part#
A	1	Bottom Shelf	7000506	AA	1	Steakburner Body	7000563
B	4	Rails	7000285	BB	1	Steakburner Handle	7000059
C	1	Logo Plate	4157147	CC	2	Washer Head Hex Nuts	7000271
D	1	Top Casting	7000826	DD	1	Shelf	7000268
E	1	Bottom Casting	7000559	EE	1	Steakburner Grate	4155276
F	3	Burners	7000093	FF	1	Front Panel	7000518
G	1	Canyover Tube	7000279	GG	1	Warning Rack	7000181
H	2	Pin Nuts	7000132	HH	1	Cook Grid, 8x15	7000029
I	3	U Nuts	7000185	II	2	Cook Grates, 12x15	7000030
J	2	Casting Bumpers	7000184	JJ	2	10x3/8 Self-Tap Screw	7001017
K	1	Handle Assembly	7000178	KK	1	Valve/Pressure Regulator	7000083
L	1	Fascia, Left	7001021	LL	1	Control Panel	7001004
M	1	Condoment Basket	7000370	MM	1	Ignition Module	7000544
N	2	Wheels	7000282	NN	1	Thumbscrew	7000365
O	1	Axle Rod	7001149	OO	1	24" Ignitor Wire	7000864
P	3	Vaporizer Fittings	7000391	PP	1	Leg Assembly, Long	7000522
Q	1	Heat Shield	7000398	QQ	1	Leg Assembly, Short	7000523
R	1	Grease Tray Assy	7000043	RR	1	Match Holder w/Chain	7000084
S	1	Grease Pan	7000046	SS	1	Push Pin	4080112
T	1	Steakburner Burner	7000036	..	1	Hardware Bag	7001402
U	2	Leg Extenders	7000230				
V	4	Control Knobs	7000589				
W	1	Electrode	7000378				
X	1	Ignition Button	7000161				
Y	1	Temperature Gauge	7000361				
Z	1	Temperature Gauge Bezel	4157169				

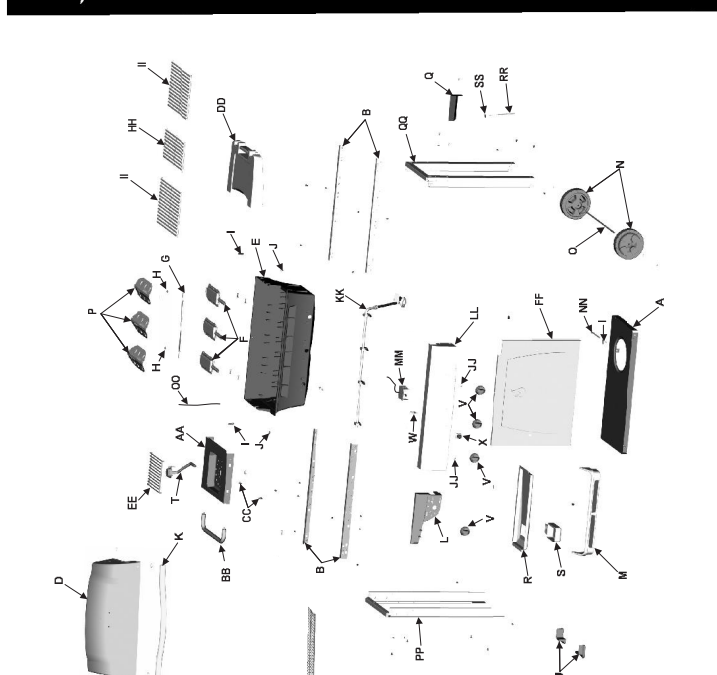

Char-Broil

KEEPERS OF THE FLAME

PERFORMANCE SERIES

PRECISION GRILLING TECHNOLOGY

CAUTION: Read and follow all safety statements, assembly instructions and use and care directions before attempting to assemble and cook.

INSTALLER/ASSEMBLER: Leave these instructions with consumer.

CONSUMER: Keep this manual for future reference.

WARNING: Failure to follow all manufacturer's instructions could result in serious personal injury and/or property damage.

CAUTION: Some parts in certain sharp edges especially as noted in the manual. Wear protective gloves if necessary.

If you have any questions or need assistance during assembly, please call 1-800-241-7548.

Visit us on the web: www.charbroil.com

ASSEMBLY MANUAL
463452206
THIS GRILL IS FOR
OUTDOOR USE ONLY

© 2005 W. C. Bradley Co., All Rights Reserved

7 **Items to Assemble:**
 1 Grill Bottom Assembly
 4 Screws

A Angle grill bottom assembly around and under the rails.
CAUTION: Be careful not to dislodge burner tubes.
 B Make sure ribs on each side of bottom casting are nested into notches on casting seat.
 C Attach four screws inside grill bottom and into casting seat.

Qty: 4

8 **Items to Assemble:**
 2 LP Nuts

A Place LP nut as shown into insert on left and right side of grill bottom.

Qty: 2
 Not to scale

9 **Items to Assemble:**
 1 Electronic Wiring Nut or Nut

A Inside bottom casting insert electrode and finger tighten with wiring nut or nut.

View of electrode attached and secured with a nut in the burner.

Front

10 **Items to Assemble:**
 3 Screws
 1 Control Panel

Loosen long wire and place behind front panel. Do not connect at this time.

A Align control panel slots to bottom burner tubes (see intermediate view). Rotate panel up and rest flange over rail.
 B Insert regulator into opening in front panel.
 C Position valves into burner tubes (see intermediate view). Rotate panel up and rest flange over rail.
 D Attach control panel to legs with a screw in top hole. On right side attach a screw in second hole.

Qty: 3

Correctly assembled burner tube and valve.

11 **Items to Assemble:**
 1 Shelf

A Shows a close up of the rectangle hole that holds the shelf in place. Slide side shelf firmly onto the rails until it is fully secured to the rails.
 B Shows shelf properly attached.

Rectangular holes

Tab fully secured

12 **Items to Assemble:**
 1 Sideburner Assembly
 1 Sideburner Burner
 1 Wing Nut
 1 Sideburner Grate

A Slide sideburner assembly onto rails. Attach with 4 screws.
 B Insert sideburner burner into sideburner body. Make sure valve fits into tube before attaching.
 C Place sideburner grate onto sideburner body.

Sideburner tube and valve properly engaged.

Only 1 Wing nut required

13 **Items to Assemble:**
 1 Fascia
 1 Screw

A Insert tabs on fascia into 2 slots on sideburner body. Fasten fascia into second hole through control panel and leg.
 B Attach long wire from electronic ignition module to electronic version sideburner.

Qty: 1

Looking underneath sideburner

Tab on fascia correctly attached

16 **Items to Assemble:**
 3 Reporcer Tents
 3 Warming Racks
 1 Warming Rack

A Note correct position of reporcer tents directly over burners.
 B Place grease as shown.
 C Place warming rack in slots on bottom casting.

14 **Items to Assemble:**
 1 Logo Plate
 1 Temperature Gauge

A Insert logo plate into grill lid.
 B Carefully engage logo plate on grill lid.
 C Lid. Gently press temperature gauge down to engage.
 Note: Do not force on temperature gauge and trim piece on grill lid. This may damage the locking device on the temperature gauge.

Logo Plate

Grill Lid

Back side of Temperature Gauge showing locking device.

15 **Items to Assemble:**
 1 Handle
 2 Screws
 1 Top Casting
 2 Shoulder Bolts
 4 Control Knobs
 1 Ignition Button
 1 AA Battery

A Place handle onto the top casting. Attach wing nut to stud.
 B Attach top casting with shoulder bolts. Note correct position to hold igniter button. Push on button once to engage seat.
 C If back of button looks like D, push button onto igniter module and turn right 1/4 turn to lock in place.
 E Place knobs on valve stems.

Qty: 2

Back of button

Turn 1/4

Correct position

18 **Items to Assemble:**
 1 Grease Tray Assembly

A Slide grease tray into brackets on bottom casting.
 B Slide grease pan into brackets on grease tray.

17 **Items to Assemble:**
 1 LP Tank

LP tank is sold separately. Use only with an (over-all protection device) OPD equipped LP tank. Fill and leak check before attaching to grill and regulator.
 Place LP tank into hole in bottom shelf. Tighten thumb screw to hold LP tank securely in place.

BACK

Back of cart

CAUTION

- Tank collar opening must face to front of cart once tank is attached.
- Failure to install tank correctly may allow gas hose to be damaged in operation, resulting in the risk of fire.

See the Use & Care manual to correctly install the LP Tank Leak Test and do the Burner Flame Check.

CAUTION

Failure to install the grease tray will cause hot grease to drip from bottom of grill with risk of fire or property damage.

CAUTION

You may leave hardware left over after completing assembly of your grill. This is normal as in some cases we have included extra hardware to ensure you have enough.